

ELECTRIC HEATER

75012474

RP
A

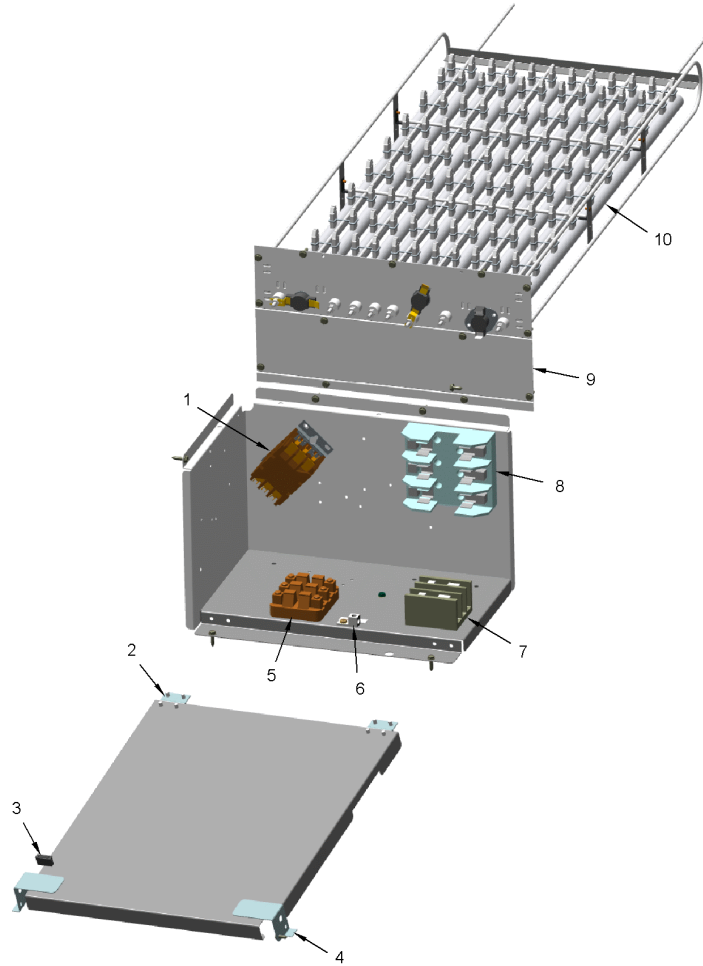

This is a typical illustration. The unit in the field may not appear exactly as shown.

Part No.	Reference No.	Quantity	Description
75012474_HTRZUP1_345923~P	*		HTRZUP1 PARTS LIST

ELECTRIC HEATER

75012474

RP
A

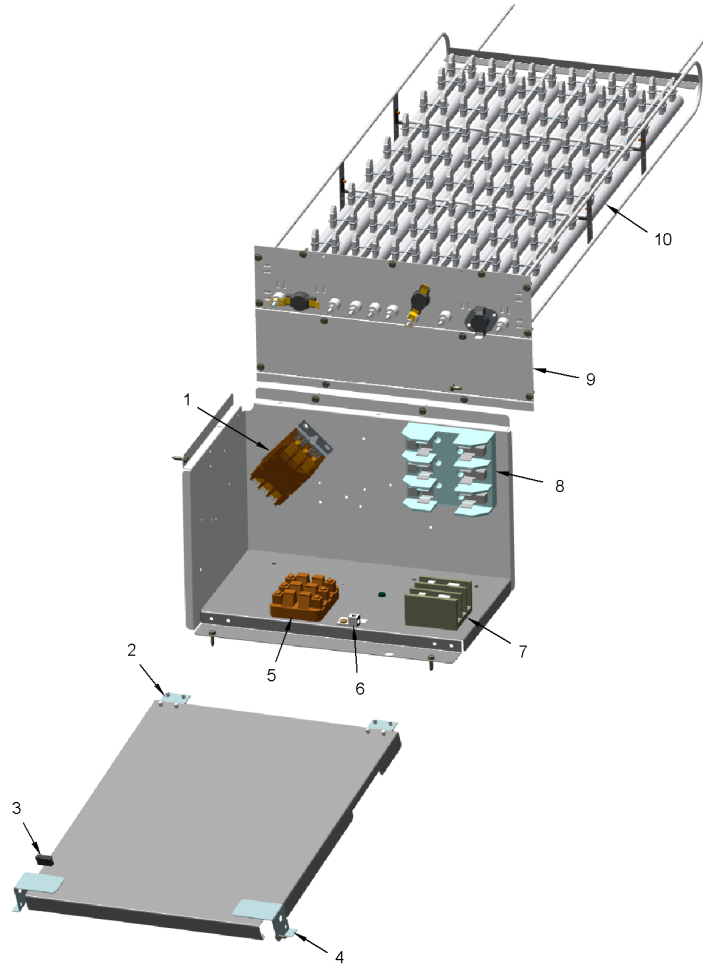

This is a typical illustration. The unit in the field may not appear exactly as shown.

Part No.	Reference No.	Quantity	Description
CTR00818	1	1	CONTACTOR; 3 POLE, 40 AMP, 24V
HNG00051	2	2	HINGE; 1.42 X 1.50 LG
CAT00043	3	2	CATCH; MAGNETIC SNAP-IN
BRK03601	4	2	BRACKET; DOOR STOP, ELECTRIC HEAT
BLK01506	5	1	FUSEBLOCK; ASSEMBLY, 3P, 60A, 300V, CLASS T
FUS00690	5	3	FUSE; FAST ACTING, 300VAC, JJN-60, 60 AMP
CON00077	6	1	CONNECTOR, ELECTRIC GROUND, 14-2 AWG SOLDERLESS
BLK01573	7	1	BLOCK; TERMINAL, 3P 175A 600V
BLK00076	8	1	BLOCK; FUSE, 60A/250V, 3 POLE
FUS00179	8	3	FUSE; TIME DELAY, 250V, RK5-60
PNL32385	9	1	PANEL; ELECTRIC HEAT