

# AM30 SERIES

SEPTEMBER 30, 1996

Supersedes May 23, 1994

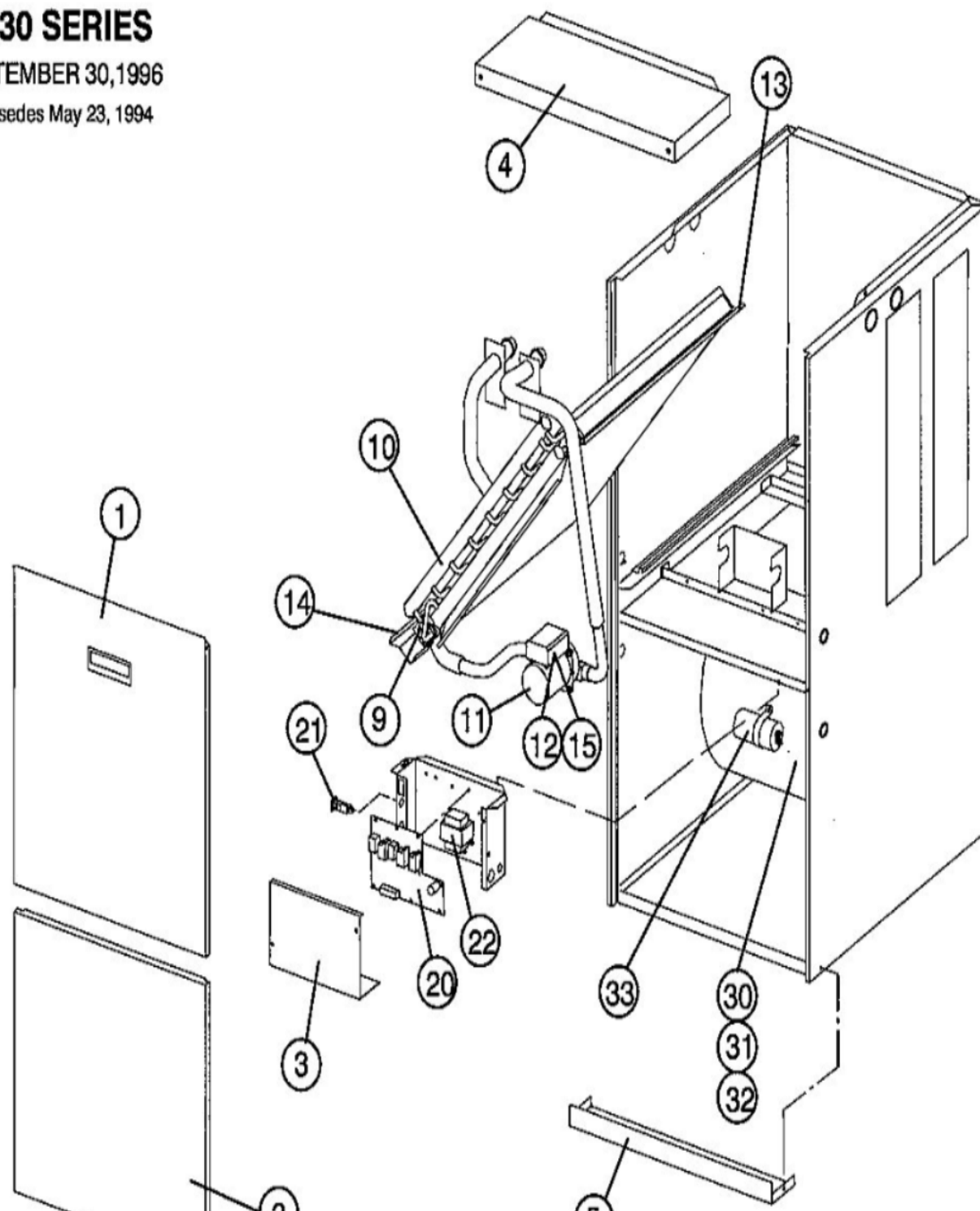

Revision Number - 2

## \*OPTIONAL PARTS-FIELD INSTALLED

Callout	Name	Quantity	Description
	VENT-AIR BLEED Cat #: 29K49 Model/Part #: 29K4901	1	3/4"
	VENT-AIR BLEED Cat #: 29K50 Model/Part #: 29K5001	1	1"
	THERMOSTAT Cat #: 49K94 Model/Part #: 49K9401	1	FACTORY INSTALLED AFTER 4/96
	VALVE-CHECK Cat #: 66J62 Model/Part #: 66J6201	1	VALVE-INLINE CHECK
	ADAPTER Cat #: P-8-4556 Model/Part #: P-8-4556	2	ADAPTOR, WROT COPPER
ANTI K	ANTI SIPHON KIT Cat #: 73J84 Model/Part #: LB-68561A	1	INC NEXT 2 PARTS
FRZ KT	FREEZESTAT KIT Cat #: 64K78 Model/Part #: LB-90503A	1	INC NEXT PART
NSE KT	NOISE KIT Cat #: 54K70 Model/Part #: LB-90007A	1	ELECTRICAL NOISE- MOV

## BLOWER PARTS FOR Q2 BLOWER

Callout	Name	Quantity	Description
	PLATE-CUTOFF Cat #: 67J38 Model/Part #: LB-65858	1	CUTOFF PLATE
30	HOUSING-BLOWER Cat #: 50J03 Model/Part #: LB-65790F	1	HOUSING-BLR
31	MOTOR-BLOWER Cat #: 21L90 Model/Part #: 21L9001	1	1/5HP, 1075 RPM, 115/60/1
32	WHEEL-BLOWER Cat #: 21709 Model/Part #: LB-29333BH	1	1/2" BORE, 10" X 7"
33	CAPACITOR	1	5MFD, 370VAC

Callout	Name	Quantity	Description
	Cat #: 22W78 Model/Part #: 59C9201		

## CABINET PARTS

Callout	Name	Quantity	Description
	FILTER Cat #: 31J81 Model/Part #: 31J8101	1	14" X 25" X 1" (Q2, Q2/3)
	HANDLE-DOOR Cat #: 77C15 Model/Part #: 77C1501	1	DOOR
	DOOR Cat #: 50J74 Model/Part #: LB-65608	1	FILTER (Q2, Q2/3)
	CLIP Cat #: 50J78 Model/Part #: LB-65612	1	FILTER
	PANEL-SET Cat #: 48L85 Model/Part #: LB-95973A	1	COIL & BLR ACCESS SET INCL HANDLE (Q2,Q2)
3	COVER Cat #: LB-66568 Model/Part #: LB-66568	1	CONTROL BOX (6" HEIGHT)
3	COVER Cat #: 27L52 Model/Part #: LB-91412	1	CONTROL BOX (7" HEIGHT)
4	CAP Cat #: 89J72 Model/Part #: LB-87476A	1	TOP (Q2, Q2/3)
5	CAP Cat #: 27L20 Model/Part #: LB-65478	1	BOTTOM (Q2, Q2/3)

## CONTROL PANEL PARTS

Callout	Name	Quantity	Description
	HARNESS-WIRING Cat #: 23M30 Model/Part #: LB-100429G	1	KIT REPLACES PUMP & CTL BOX HARNESS
	HARNESS-WIRING Cat #: 74J19 Model/Part #: LB-66649	1	PUMP
	HARNESS-WIRING Cat #: 74J24 Model/Part #: LB-66650	1	POWER (FEMALE)

<b>Callout</b>	<b>Name</b>	<b>Quantity</b>	<b>Description</b>
	HARNESS-WIRING Cat #: 74J23 Model/Part #: LB-66651	1	CONTROL BOX
	HARNESS-WIRING Cat #: 74J22 Model/Part #: LB-68527	1	INTERCONNECT (HI VOLT)
	HARNESS-WIRING Cat #: 89J63 Model/Part #: LB-68575	1	INTERCONNECT (LO VOLT)
	HARNESS-WIRING Cat #: 50J98 Model/Part #: LB-73867	1	POWER (MALE)
15	CAPACITOR Cat #: 73J96 Model/Part #: 73J9601	1	REPL
20	MODULE Cat #: 59K21 Model/Part #: LB-90403A	1	CONTROL BOARD (ACH1)
21	BREAKER-CIRCUIT Cat #: 37J56 Model/Part #: 37J5601	1	CIRCUIT BREAKER-250V
22	TRANSFORMER Cat #: 42J32 Model/Part #: 42J3201	1	120VPRI, 24VSEC, 40VA

## HEATING PARTS

<b>Callout</b>	<b>Name</b>	<b>Quantity</b>	<b>Description</b>
	KIT-CARTRIDGE Cat #: 73J78 Model/Part #: 73J7801	1	PUMP(-40 & -70 UNITS)
	KIT-CASING Cat #: 73J79 Model/Part #: 73J7901	1	PUMP(-40 & -70 UNITS)
	"KIT-""O""RING" Cat #: 73J82 Model/Part #: 73J8201	1	PUMP
	CAPACITOR Cat #: 73J96 Model/Part #: 73J9601	1	REPL
9	THERMOSTAT Cat #: 49K94 Model/Part #: 49K9401	1	FREEZESTAT
10	COIL ASSY Cat #: 73J69 Model/Part #: LB-66617A	1	(Q2-40 UNITS)
11	PUMP	1	COIL (-40 & -70

<b>Callout</b>	<b>Name</b>	<b>Quantity</b>	<b>Description</b>
	Cat #: 53J75 Model/Part #: 53J7501		UNITS)
12	BUSHING Cat #: 60F40 Model/Part #: P-8-7865	1	PUMP-STRAIN RELIEF
13	SUPPORT Cat #: 59M81 Model/Part #: LB-65473	1	COIL-TOP (Q2, Q2/3)
14	SUPPORT Cat #: 59M82 Model/Part #: LB-65471	1	COIL-BOTTOM (Q2, Q2/3)

**Note:**

Note1: UNIT WAS PRODUCED WITH RESILIENT (LB-97863A) OR BELLY BAND (LB-101207 & 62A5701) TYPE MOTOR MOUNTS. CUSTOMER MUST TELL YOU WHAT'S IN THE UNIT NOW. THESE MOUNTS ARE NOT INTERCHANGEABLE.