

Parts List Number :000086760

Model Number :A4MXD4248AC6HAA

<b>Part No.</b>	<b>Reference No.</b>	<b>Quantity</b>	<b>Description</b>
000086774~S	*		COIL
0000101896~S	*		MODEL NUMBER DESCRIPTION

Part No.	Reference No.	Quantity	Description
000002521~P	*		MULTI-POSITION CASED COIL

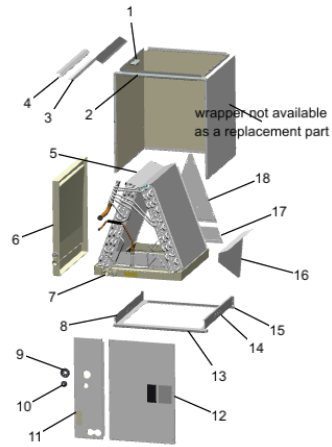

Part No.	Reference No.	Quantity	Description
4AYTXVH4A4860A	*	1	KIT-TXV ADJ R410A
BAYORIACHP0077	*	1	KIT RESTRICTOR ORIFICE
WAS01180	*	1	WASHER; TEFLON, 0.46 ID X 0.56 OD X 0.056 THK
GRD00938	3	1	GUARD; SPLASH, 19.29 X 8.00
BAF01201	4	1	BAFFLE; DRAIN, 1.27 X 20.75, V-SHAPED CHANNEL
PAN03221	6	1	PAN; SECONDARY DRAIN PAN ASSEMBLY, PLASTIC, 25.48 X 21.10 X 1.50
PAN03218	7a	1	PAN; DRAIN PAN ASSEMBLY, PLASTIC, 23.28 X 21.10 X 2.54
PLU00457	7b	1	PLUG; DRAIN PAN
SUP06651	8	1	SUPPORT; COIL SHIELD
GRM00863	9	1	GROMMET; SUCTION GROMMET
GRM00864	10	1	GROMMET; CONE GROMMET, LIQUID LINE
PNL36847	11	1	PANEL; INSULATION ASM-LINESET
PNL36857	12	1	PANEL; INSULATION ASM-COIL
BRK05159	13	1	BRACKET; BOTTOM
SUP06650	14	1	SUPPORT; COIL SHIELD
PLT05399	17	2	PLATE; COIL BAFFLE-LOWER, 17.59 L X 5.50 H
PLT05412	18	2	PLATE; COIL BAFFLE, TOP, 13.70 W X 16.52 H

Part No.	Reference No.	Quantity	Description
000009819~P	*		MODEL NUMBER GRAPHIC

MODEL NUMBER DESCRIPTION  
COILS

75013902

REV  
A

*Example Model Number:*  
**A 4 M X B 3 6 4 2 A C 6 H A A**  
1 - - - 5 - - - 10 - - - 15

**Digit 1 – Brand**

A = RunTru Brand

**Digit 2 – Refrigerant Type**

4 = R410a

**Digit 3 – Position**

M = Multi-position (Up/Down/Left/Right)

**Digit 4 – Coil Design**

X = Direct Expansion Evaporator Coil

**Digit 5 – Cabinet Width**

A = 14.5"

B = 17.5"

C = 21.0"

D = 24.5"

**Digit 6,7 – Minimum Capacity**

BTU/HOUR x 1000

**Digit 8,9 – Maximum Capacity**

BTU/HOUR x 1000

**Digit 10 – Major Development Sequence**

**Digit 11 – Efficiency**

C = Standard

**Digit 12 – Refrigerant Control**

3 = TXV

6 = FCCV (Flow Control/Check Valve)

**Digit 13 –Coil Circuitry**

H - Heat Pump

C - Cooling

**Digit 14 – Minor Design Modifications**

**Digit 15 – Unit Parts Identifier**

