

| Part No. | Reference No. | Quantity | Description |
|-----------------|----------------------|-----------------|--------------------------|
| 0000087749~S | * | | CABINET |
| 0000087750~S | * | | CONTROLS |
| 0000087748~S | * | | FAN |
| 0000087747~S | * | | GENERAL |
| 0000101891~S | * | | MODEL NUMBER DESCRIPTION |
| 0000087752~S | * | | OPTIONAL ACCESSORIES |
| 0000087751~S | * | | REFRIGERATION |

| Part No. | Reference No. | Quantity | Description |
|-------------|---------------|----------|--------------------|
| 000003686~P | * | | CABINET PARTS LIST |



CABINET PARTS LIST

Parts List Number :0000087746

Model Number :A4HP4060A1000BA

| Part No. | Reference No. | Quantity | Description |
|-----------------|----------------------|-----------------|-----------------------|
| PAN04325 | * | 1 | PAN; BASE |
| COV05852 | 1 | 1 | COVER; TOP SR 4 |
| SPC00512 | 2 | 1 | SPACER; TUBING |
| COV05853 | 3 | 1 | COVER; CONTROLS SR |
| PNL37038 | 5 | 1 | PANEL; CONTROL SR 4.6 |
| PNL37030 | 6 | 3 | PANEL; WRAPPER SR 4.6 |

| Part No. | Reference No. | Quantity | Description |
|--------------|---------------|----------|---------------------|
| 0000016820~P | * | | CONTROLS PARTS LIST |

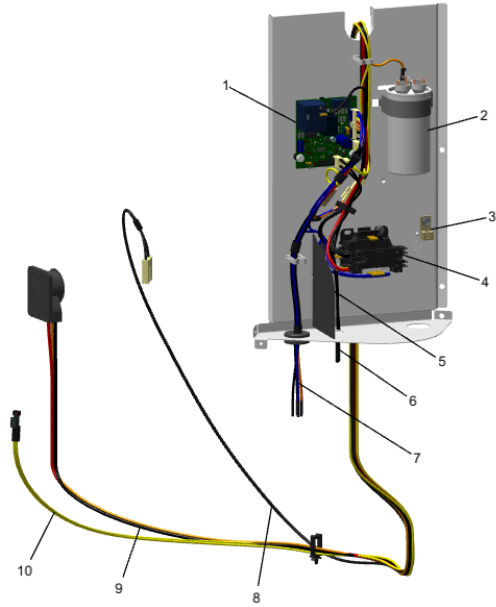

| Part No. | Reference No. | Quantity | Description |
|-----------------|----------------------|-----------------|--|
| CNT08177 | 1 | 1 | CONTROL; DEFROST |
| CPT02657 | 2 | 1 | CAPACITOR; 70+7.5 MFD 370V |
| LUG00012 | 3 | 1 | LUG, GROUND |
| CTR03143 | 4 | 1 | CONTACTOR; (LUG STYLE) |
| SEN02352 | 6 | 1 | SENSOR; ASSEMBLY, AMBIENT, 19 IN WIRE LENGTH, -40C TO 105C OP TEMP RANGE, 14 IN WIRE LENGTH, BLACK WIRES |
| WIR09851 | 7 | 1 | WIRE; CONTROL PANEL HARNESS, J4 ON DFC TO MS, TO SOV HARNESS |
| WIR09853 | 8 | 1 | WIRE; SOV EXT HARNESS |
| PLU01345 | 9 | 1 | PLUG; SCROLL COMPRESSOR HARNESS >3T |
| SEN02852 | 10 | 1 | SENSOR; COIL TEMP, YELLOW WIRES |

| Part No. | Reference No. | Quantity | Description |
|--------------|---------------|----------|----------------|
| 0000016976~P | * | | FAN PARTS LIST |



| Part No. | Reference No. | Quantity | Description |
|-----------------|----------------------|-----------------|---|
| MOT19274 | 1 | 1 | MOTOR; FAN 1/5TH HP 8-POLE |
| GRL02245 | 2 | 1 | GRILLE; FAN (SR4) (BLACK) |
| SCR02086 | 3 | 4 | SCREW; 10-32 TR-3 HXW 3/8 S |
| FAN05525 | 5 | 1 | FAN; 2 SWEPT BLADES, 27.50 IN DIA, 27 DEG PITCH, 0.50 IN BORE, CCW, ALUMINUM, 1 SET SCREW-STEEL, SPIDER 0.050 THK |

| Part No. | Reference No. | Quantity | Description |
|-------------|---------------|----------|--------------------------|
| 000004381~P | * | | GENERAL ASSEMBLY GRAPHIC |



| Part No. | Reference No. | Quantity | Description |
|-------------|---------------|----------|----------------------|
| 000009817~P | * | | MODEL NUMBER GRAPHIC |

| MODEL NUMBER DESCRIPTION | 75013900 | REV A |
|---|----------|----------|
| OUTDOOR UNITS | | |
| <i>Example Model Number:</i> A 4 C A 4 0 3 6 A 1 0 0 0 A A 1 - - - 5 - - - 10 - - - 15 | | |
| Digit 1 – Brand | | |
| A = RunTru Brand | | |
| Digit 2 – Refrigerant Type | | |
| 4 = R410a | | |
| Digit 3,4 – Product Family | | |
| AC = Air Conditioner | | |
| HP = Heat Pump | | |
| Digit 5 – Nominal Efficiency Rating | | |
| 3 = 13 SEER | | |
| 4 = 14 SEER | | |
| 6 = 16 SEER | | |
| Digits 6,7,8 – Nominal Capacity | | |
| BTU/Hour x 1000 | | |
| Digit 9 – Major Design Modifications | | |
| Digit 10 – Electric Power Supply | | |
| 1 = 200-230/1PH/60Hz or 208-230/1PH/60Hz | | |
| Digit 11,12,13 – Secondary Function | | |
| 000 = No Secondary Function | | |
| Digit 14 – Minor Design Modifications | | |
| Digit 15 – Unit Parts Identifier | | |
| 1 of 1 | | |

| Part No. | Reference No. | Quantity | Description |
|-------------|---------------|----------|---------------------------|
| 000004143~P | * | | OPTIONAL ACCESSORIES LIST |

| Part No. | Reference No. | Quantity | Description |
|---------------|---------------|----------|---|
| AY28X079 | * | 1 | KIT; LOW TEMP COOLING (AY28X079) |
| BAYCCHT301RES | * | 1 | KIT; CRANKCASE HEATER FOR SCROLLS, 60W, 230V (BAYCCHT301RES), 6.5-7.5 DIA, 74 IN LENGTH |
| BAYISLT101 | * | 1 | KIT; ISOLATOR (BAYISLT101) (CONTAINS A QTY OF 5 ISOLATORS) |
| BAYSKT267 | * | 1 | KIT; COMPRESSOR START KIT |
| BAYLEGS004 | * | 1 | KIT; SNOW LEGS, CONTAINS (4) 4" MOUNTING LEGS |
| BAYLEGS007 | * | 1 | KIT; SNOW LEGS, CONTAINS (4) 7" MOUNTING LEGS |
| BAYLOAM108 | * | 1 | LOW AMBIENT KIT |
| BAYSDEN004 | * | 1 | KIT; SOUND ENCLOSURE, (BAYSDEN004), (MODELS WITH LARGE FRAME (QUEST) SCROLL COMPRESSORS NO LARGER THAN 17.3" TALL OR 7.3" IN DIAMETER |
| PNL37058 | * | 1 | PANEL; WRAPPER, DURA WRAP, LOWER LTL BARRIER - 4 SR |

| Part No. | Reference No. | Quantity | Description |
|-------------|---------------|----------|--------------------------|
| 000003706~P | * | | REFRIGERATION PARTS LIST |

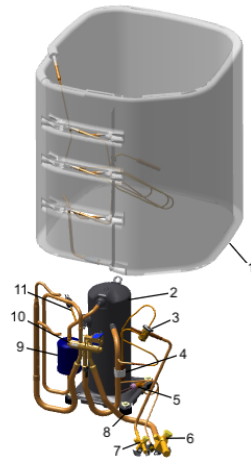

| Part No. | Reference No. | Quantity | Description |
|----------|---------------|----------|--|
| COL29613 | 1 | 1 | COIL; ASM-REPL PACKOUT |
| COM11769 | 2 | 1 | COMPRESSOR; SCROLL; ALLIANCE; SBA051B1CPA, 4.25 TON; 51,000 BTUH; 208/230-60-1; R-410A; BRAZED; SUCTION 7/8; DISCHARGE 1/2; RLA 27.1 |
| VAL19427 | 3 | 1 | VALVE; TXV (HXCE-3-ZX200, 86 PSIG) |
| CLP00181 | 4 | 1 | CLIP; BULB |
| SWT03892 | 5 | 1 | SWITCH; LOW PRESSURE, 35 PSIG OPEN, 55 PSIG RESET SWITCH |
| VAL19480 | 6a | 1 | VALVE; SUCTION (SMV-JA7YHTLA-L19) |
| CAP01315 | 6b | 1 | CAP; SERVICE LIQUID VALVE, BRASS, 1.06 OD X 0.81 ID X 15/16- 20UNEF-2B |
| VAL09293 | 7a | 1 | VALVE, SERVICE LIQUID, .38 OD X .38 OD, VALVE ASSY |
| CAP01336 | 7b | 1 | CAP; SERVICE LIQUID VALVE, BRASS, 0.75 OD X 0.57 ID X 11/16- 28UN-2B |
| SCR01914 | 8 | 1 | SCREW, ASSEMBLY COMPRESSOR, 5/16-12 TYPE B, W/WASHER & SLEEVE |
| MFL00806 | 9 | 1 | MUFFLER; 1/2 ODF CONNECTION (DRIER COULD BE PAINTED EITHER SMOKE GRAY OR NAVY BLUE) |
| VAL08884 | 10 | 4 | VALVE; SWITCHOVER, 6 TON, 5/8 IN ODF X 7/8 IDF CONNECTION (INCLUDES SOLENOID COIL) |
| SWT03277 | 11 | 1 | SWITCH, HIGH PRESSURE, SPST, OPEN AT 650 PSIG, CLOSE AT 500 PSIG, 91 IN. YELLOW AND RED LEAD |