

| Part No. | Reference No. | Quantity | Description |
|-----------------|----------------------|-----------------|--------------------------|
| 0000087749~S | * | | CABINET |
| 0000087750~S | * | | CONTROLS |
| 0000087748~S | * | | FAN |
| 0000087747~S | * | | GENERAL |
| 0000101891~S | * | | MODEL NUMBER DESCRIPTION |
| 0000087752~S | * | | OPTIONAL ACCESSORIES |
| 0000087751~S | * | | REFRIGERATION |

| Part No. | Reference No. | Quantity | Description |
|-------------|---------------|----------|--------------------|
| 000003324~P | * | | CABINET PARTS LIST |



CABINET PARTS LIST

Parts List Number :0000087746

Model Number :A4HP4017A1000AA

| Part No. | Reference No. | Quantity | Description |
|-----------------|----------------------|-----------------|------------------------|
| COV05854 | 1 | 1 | COVER; TOP |
| SPC00512 | 2 | 1 | SPACER; TUBING |
| COV05853 | 3 | 1 | COVER; CONTROLS SR |
| PNL37043 | 5 | 1 | PANEL; CONTROL SR 1A.2 |
| PNL37041 | 6 | 3 | PANEL; WRAPPER 1A.2 |

CONTROLS

Parts List Number :0000087746

Model Number :A4HP4017A1000AA

| Part No. | Reference No. | Quantity | Description |
|-------------|---------------|----------|--------------------|
| 000003659~P | * | | CONTROL PARTS LIST |

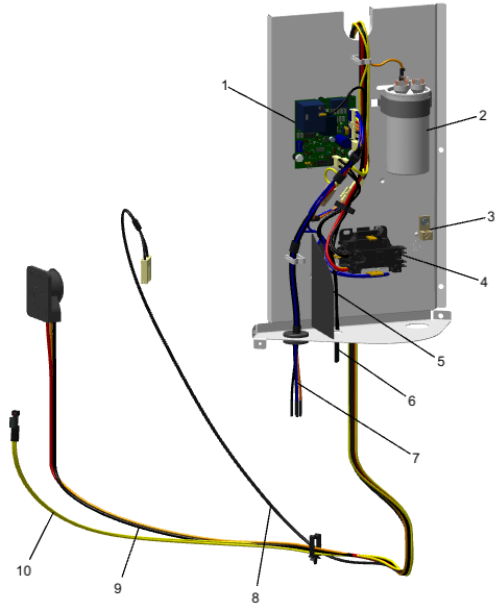

| Part No. | Reference No. | Quantity | Description |
|-----------------|----------------------|-----------------|--|
| CNT07932 | 1 | 1 | CONTROL; DEFROST |
| CPT01843 | 2 | 1 | CAPACITOR, RUN, 30/5 MFD, 370V, ROUND, W/O RESISTOR |
| LUG00012 | 3 | 1 | LUG, GROUND |
| CTR03142 | 4 | 1 | CONTACTOR; (LUG STYLE) |
| PNL31534 | 5 | 1 | PANEL; VOLTAGE BARRIER; 4.45 X 3.06, BLACK POLYPROPYLENE |
| SEN02352 | 6 | 1 | SENSOR; ASSEMBLY, AMBIENT, 19 IN WIRE LENGTH, -40C TO 105C OP TEMP RANGE, 14 IN WIRE LENGTH, BLACK WIRES |
| WIR09851 | 7 | 1 | WIRE; CONTROL PANEL HARNESS, J4 ON DFC TO MS, TO SOV HARNESS |
| WIR09852 | 8 | 1 | WIRE; SOV EXT HARNESS |
| PLU01344 | 9 | 1 | PLUG; SCROLL COMPRESSOR HARNESS <3T |
| SEN02853 | 10 | 1 | SENSOR; COIL TEMP |

| Part No. | Reference No. | Quantity | Description |
|-------------|---------------|----------|----------------|
| 000003315~P | * | | FAN PARTS LIST |



| Part No. | Reference No. | Quantity | Description |
|-----------------|----------------------|-----------------|---------------------------------------|
| MOT19272 | 1 | 1 | MOTOR; FAN 1/12TH HP 8-POLE |
| GRL02242 | 2 | 1 | GRILLE; FAN (SR-1A) (BLACK) |
| SCR02086 | 3 | 4 | SCREW; 10-32 TR-3 HXW 3/8 S |
| GRD01715 | 4 | 1 | GUARD; TROUGH-LEAD, 11 IN L X 0.83 OD |
| BLD01360 | 5 | 1 | BLADE; FAN BASE 1 PADDLE |

| Part No. | Reference No. | Quantity | Description |
|-------------|---------------|----------|--------------------------|
| 000004381~P | * | | GENERAL ASSEMBLY GRAPHIC |



| Part No. | Reference No. | Quantity | Description |
|-------------|---------------|----------|----------------------|
| 000009817~P | * | | MODEL NUMBER GRAPHIC |

| MODEL NUMBER DESCRIPTION | 75013900 | REV A |
|---|----------|----------|
| OUTDOOR UNITS | | |
| <i>Example Model Number:</i> A 4 C A 4 0 3 6 A 1 0 0 0 A A 1 - - - 5 - - - 10 - - - 15 | | |
| Digit 1 – Brand A = RunTru Brand | | |
| Digit 2 – Refrigerant Type 4 = R410a | | |
| Digit 3,4 – Product Family AC = Air Conditioner HP = Heat Pump | | |
| Digit 5 – Nominal Efficiency Rating 3 = 13 SEER 4 = 14 SEER 6 = 16 SEER | | |
| Digits 6,7,8 – Nominal Capacity BTU/Hour x 1000 | | |
| Digit 9 – Major Design Modifications | | |
| Digit 10 – Electric Power Supply 1 = 200-230/1PH/60Hz or 208-230/1PH/60Hz | | |
| Digit 11,12,13 – Secondary Function 000 = No Secondary Function | | |
| Digit 14 – Minor Design Modifications | | |
| Digit 15 – Unit Parts Identifier | | |
| 1 of 1 | | |

| Part No. | Reference No. | Quantity | Description |
|-------------|---------------|----------|---------------------------|
| 000003651~P | * | | OPTIONAL ACCESSORIES LIST |

| Part No. | Reference No. | Quantity | Description |
|---------------|---------------|----------|--|
| AY28X079 | * | 1 | KIT; LOW TEMP COOLING (AY28X079) |
| BAYCCHT302RES | * | 1 | KIT; CRANKCASE HEATER FOR SCROLLS, 40W, 230V (BAYCCHT302RES), 5.5 DIA, 74 IN LENGTH |
| BAYISLT101 | * | 1 | KIT; ISOLATOR (BAYISLT101) (CONTAINS A QTY OF 5 ISOLATORS) |
| BAYKSKT267 | * | 1 | KIT; COMPRESSOR START KIT |
| BAYLEGS004 | * | 1 | KIT; SNOW LEGS, CONTAINS (4) 4" MOUNTING LEGS |
| BAYLEGS007 | * | 1 | KIT; SNOW LEGS, CONTAINS (4) 7" MOUNTING LEGS |
| BAYLOAM108 | * | 1 | LOW AMBIENT KIT |
| BAYSDEN003 | * | 1 | KIT; SOUND ENCLOSURE, (BAYSDEN003), (MODELS WITH SMALL FRAME (QUANTUM) SCROLL COMPRESSORS NO LARGER THAN 16.4" TALL OR 6.6" IN DIAMETER EXCEPT IN CABI |
| PNL37055 | * | 1 | PANEL; WRAPPER, DURA WRAP, LOWER LTL BARRIER - 1 SR |

| Part No. | Reference No. | Quantity | Description |
|-------------|---------------|----------|--------------------------|
| 000003693~P | * | | REFRIGERATION PARTS LIST |

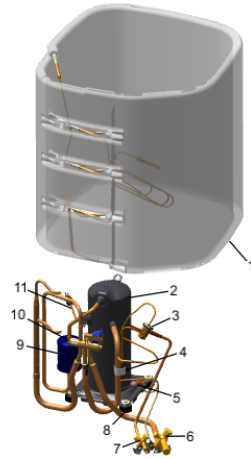

| Part No. | Reference No. | Quantity | Description |
|----------|---------------|----------|---|
| COL29605 | 1 | 1 | COIL; ASM-REPL PACKOUT |
| COM12081 | 2 | 1 | COMPRESSOR; SCROLL; ALLIANCE; SBA016C1CPA; 1.5 TON; 16,000 BTUH; 208/230-60-1; R-410A; BRAZED; SUCTION 3/4; DISCHARGE 1/2 |
| VAL19423 | 3 | 1 | VALVE; TXV (HXCE-1-ZX200, 84 PSIG) |
| CLP00210 | 4 | 1 | CLIP; BULB |
| SWT03876 | 5 | 1 | SWITCH; LOW PRESSURE, OPENS AT 35 PSI AND CLOSSES AT 55 PSI. |
| VAL19479 | 6a | 1 | VALVE; SUCTION (SMV-JA6YHTLA-L16) |
| CAP01315 | 6b | 1 | CAP; SERVICE LIQUID VALVE, BRASS, 1.06 OD X 0.81 ID X 15/16-20UNEF-2B |
| VAL09293 | 7a | 1 | VALVE, SERVICE LIQUID, .38 OD X .38 OD, VALVE ASSY |
| CAP01336 | 7b | 1 | CAP; SERVICE LIQUID VALVE, BRASS, 0.75 OD X 0.57 ID X 11/16-28UN-2B |
| SCR01914 | 8 | 4 | SCREW, ASSEMBLY COMPRESSOR, 5/16-12 TYPE B, W/WASHER & SLEEVE |
| MFL00806 | 9 | 1 | MUFFLER; 1/2 ODF CONNECTION (DRIER COULD BE PAINTED EITHER SMOKE GRAY OR NAVY BLUE) |
| VAL09013 | 10 | 1 | VALVE; SWITCHOVER, 2 TON, .625 ID X .500 OD, W/ 24V SOLENOID COIL |
| SWT03274 | 11 | 1 | SWITCH, HIGH PRESSURE, SPST, OPEN @ 650 PSIG, CLOSE @ 500 PSIG, 75" YELLOW LEAD |