

<b>Part No.</b>	<b>Reference No.</b>	<b>Quantity</b>	<b>Description</b>
4TXUUP1_4TXUUP1_147268~P	*		4TXUUP1 PARTS LIST
75010850#4TXUUP1~S	*		GENERAL ASSEMBLY CONCEALED (DUCT) 1.5 TON
75010846#4TXUUP1~S	*		MODEL NOMENCLATURE

NO GRAPHIC AVAILABLE

75013702

REV  
A

**NO  
GRAPHIC  
AVAILABLE**

MODEL NUMBER DESCRIPTION  
INDOOR PRO SERIES MODEL NOMENCLATURE

75010846

REV.  
A

*Example Model Number:*  
**4UXC2018A10N0AA**  
1 - - - 5 - - - - 10 - - - - 15

**Digit 1 – Refrigerant**

4 = R-410A

**Digit 2 – Brand**

U = Pro Series  
M = Indoor Unit

**Digit 3 – Functional Type**

X = Heat Pump Inverter

**Digit 4 – Configuration Indoor Unit**

C = Cassette Unit  
D = Concealed (Duct) Unit  
L = Cassette Covers

**Digits 5, 6 – Efficiency Tier**

20 = Up to 20 SEER Pro Series

**Digits 7, 8 – Nominal Capacity (Btu/h x 1,000)**

18 = 18,000 Btu/h  
24 = 24,000 Btu/h  
30 = 30,000 Btu/h  
36 = 36,000 Btu/h  
42 = 42,000 Btu/h  
48 = 48,000 Btu/h

**Digit 9 – Major Development Sequence**

A = First Development Sequence

**Digit 10 – Electric Power Supply**

1 = 208-230/60/1

**Digit 11 – Reserved for Future Use**

0 = Not Currently Used

**Digit 12 – Regional Markets Served**

N = North America Market

**Digit 13 – Reserved for Future Use**

0 = Not Currently Used

**Digit 14 – Minor Design Sequence**

A = First Design Sequence

**Digit 15 – Service Digit**

A = First Sequence

Part No.	Reference No.	Quantity	Description
75010846_4TXUUP1_182410~P	*		MODEL NOMENCLATURE PARTS LIST

MODEL NUMBER DESCRIPTION  
INDOOR PRO SERIES MODEL NOMENCLATURE

75010846

REV.  
A

*Example Model Number:*  
**4UXC2018A10N0AA**  
1 - - - 5 - - - - 10 - - - - 15

**Digit 1 – Refrigerant**

4 = R-410A

**Digit 2 – Brand**

U = Pro Series  
M = Indoor Unit

**Digit 3 – Functional Type**

X = Heat Pump Inverter

**Digit 4 – Configuration Indoor Unit**

C = Cassette Unit  
D = Concealed (Duct) Unit  
L = Cassette Covers

**Digits 5, 6 – Efficiency Tier**

20 = Up to 20 SEER Pro Series

**Digits 7, 8 – Nominal Capacity (Btu/h x 1,000)**

18 = 18,000 Btu/h  
24 = 24,000 Btu/h  
30 = 30,000 Btu/h  
36 = 36,000 Btu/h  
42 = 42,000 Btu/h  
48 = 48,000 Btu/h

**Digit 9 – Major Development Sequence**

A = First Development Sequence

**Digit 10 – Electric Power Supply**

1 = 208-230/60/1

**Digit 11 – Reserved for Future Use**

0 = Not Currently Used

**Digit 12 – Regional Markets Served**

N = North America Market

**Digit 13 – Reserved for Future Use**

0 = Not Currently Used

**Digit 14 – Minor Design Sequence**

A = First Design Sequence

**Digit 15 – Service Digit**

A = First Sequence

GENERAL ASSEMBLY

75010850

REV.  
A

INDOOR 1.5 TON PRO SERIES HEAT PUMP INVERTER CONCEALED  
TYPICAL ILLUSTRATION

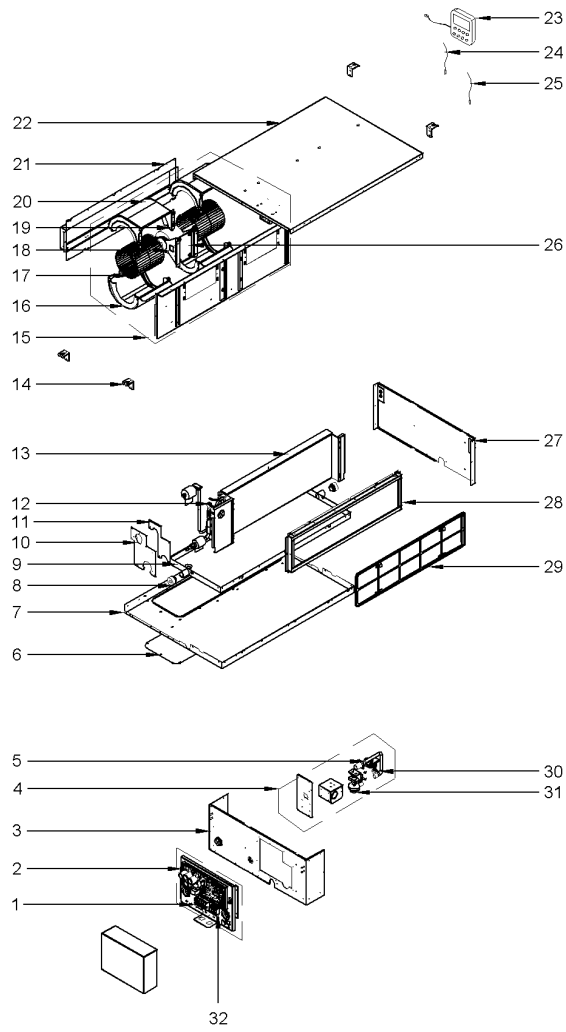

Parts List Number :4TXUUP1#4TXUUP1

Model Number :4UXD2018A10N0AA

Part No.	Reference No.	Quantity	Description
75010850_4TXUUP1_367468~P	*		GENERAL ASSEMBLY CONCEALED (DUCT) 1.5 TON PARTS LIST

GENERAL ASSEMBLY

75010850

REV.  
A

INDOOR 1.5 TON PRO SERIES HEAT PUMP INVERTER CONCEALED  
TYPICAL ILLUSTRATION

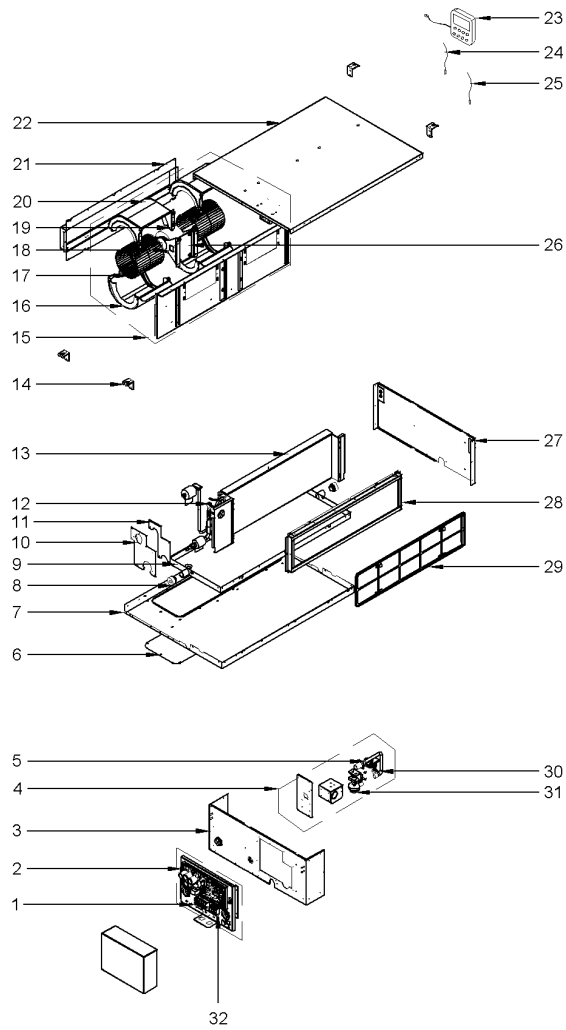

Parts List Number :4TXUUP1#4TXUUP1

Model Number :4UXD2018A10N0AA

Part No.	Reference No.	Quantity	Description
BRD05239	1	1	BOARD; TERMINAL
BRD05256	2	1	BOARD; MAIN
PNL32152	3	1	PANEL; LEFT SIDE PLATE ASSY
PMP02195	4	1	PUMP; WATER, ASSY
PIP02079	5	1	PIPE; PUMP DRAIN
COV04933	6	1	COVER; OF AIR-IN
PNL32133	7	1	PANEL; BOTTOM COVER PLATE
PLU01260	8	2	PLUG; CHOKE OF WATER PIPE, DRAIN
PAN03862	9	1	PAN; WATER TRAY ASSY, DRAIN
SEL01262	10	1	SEAL; OF LEFT SIDE PLATE SUB-ASSY
SEL01263	11	1	SEAL; OF CONNECTION PIPE
FLR07800	12	1	FILTER;
COL25486	13	1	COIL; GREE, 01025394
BRK04554	14	4	BRACKET; HOOK
FAN05469	15	1	FAN; CENTRIFUGAL FAN ASSY, COMPLETE
HUS04182	16	2	HOUSING; PROPELLER, BOTTOM CLAMSHELL
FAN05463	17	2	FAN; CENTRIFUGAL
SUP05932	18	1	SUPPORT; SUPPORTER
MOT17026	19	1	MOTOR; FAN
HUS04183	20	2	HOUSING; FRONT VOLUTE CASING, TOP CLAMSHELL
PNL32143	21	1	PANEL; RETURN AIR FRAME SUB-ASSY
COV04938	22	1	COVER; TOP BOARD SUB-ASSY
BRD05262	23	1	BOARD; DISPLAY (WIRED CONTROLLER XK60)
SEN02375	24	1	SENSOR; TEMPERATURE
SEN02373	25	1	SENSOR; AMBIENT TEMPERATURE
SUP05931	26	2	SUPPORT; MOTOR, SUB-ASSY
PNL32149	27	1	PANEL; RIGHT SIDE PLATE SUB-ASSY
PNL32144	28	1	PANEL; SIDE PLATE SUB- ASSY OF RETURN AIR FRAME
FLR08134	29	1	FILTER;
SWT03733	30	1	SWITCH; WATER LEVEL
PMP02194	31	1	PUMP; WATER
BRD05246	32	1	BOARD; TERMINAL