

Part No.	Reference No.	Quantity	Description
0000112567~S	*		COIL AND CABINET
0000112568~S	*		MODEL NUMBER DESCRIPTION

Part No.	Reference No.	Quantity	Description
0000013077~P	*		COIL AND CABINET PARTS LIST

ALUMINUM CASED HORIZONTAL FLAT COIL

75010933

REV.
A

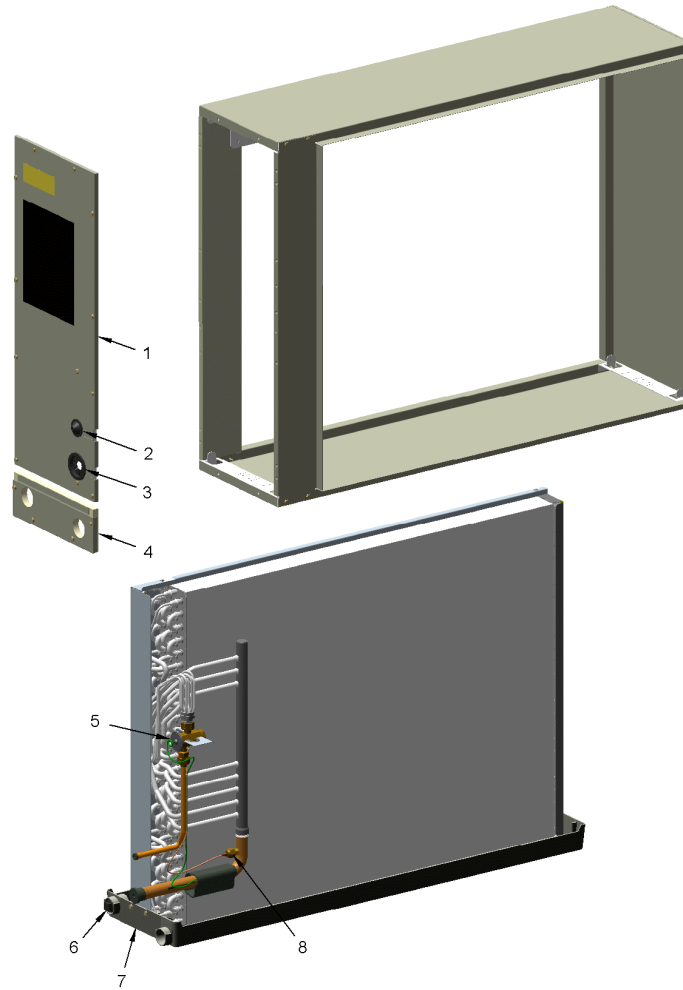

This is a typical illustration. The unit in the field may not appear exactly as shown.

Part No.	Reference No.	Quantity	Description
2AYTXVH3H1836A	*	1	KIT; FIELD MOUNTED TXV (R-22)
BAF01402	*	1	BAFFLE; COIL
CMP01450	*	1	CLAMP; HOSE, 11/16 - 1-1/4, 1/2 W, 5/16 HEX SCREW, STAINLESS STEEL
PNL37680	1	1	PANEL; ASM-INSUL FRONT
GRM00864	2	1	GROMMET; CONE GROMMET, LIQUID LINE
GRM00863	3	1	GROMMET; SUCTION GROMMET
PNL25625	4	1	PANEL; DRAIN, 3.41 X 10.16
VAL12848	5	1	VALVE; TEV HXCE 2 KX200 B15 R410A
PLU00457	6	1	PLUG; DRAIN PAN
PAN03224	7	1	PAN; DRAIN, 37.09 X 8.90
BOD00114	8a	1	BODY; VALVE, BRASS, 7/16 HEX, 7/16 -20 UNF-2A
CAP00209	8b	1	CAP; THREADED, 9/16
COR00103	8c	1	CORE; VALVE, .79 LENGTH, .206-36 UNS-1 MOD. THD

Part No.	Reference No.	Quantity	Description
0000013076~P	*		MODEL NUMBER GRAPHIC

Model Number Description		75008020	REV E
Heat Pump/Cooling Coil			
Model No.	4TX C A O 36 A C 4 H C A A		
Digit No.	1 2 3 4 5 6 7 8 9 10 11 12 13 14 15		
DIGIT 1 Refrigerant Type	2 = R22 4 = R410A	DIGIT 10 Efficiency	C = Standard S = Hi Efficiency
DIGIT 2 Product Family	T = Premium (Heat Pump or Convertible Coil) C = Standard (Cooling only)	DIGIT 11 Flow Control	2 = Capillary Tube 3 = TXV - Non Bleed 4 = Accutron Flow Control 5 = TXV - Bleed 6 = Fixed Orifice Accutron Flow Control
DIGIT 3 Airflow	X = Direct Expansion Evaporator Coil	DIGIT 12 Coil Circuitry	H = Heat Pump C = Cooling Only D = Dual Circuit Cooling
DIGIT 4 Product Family	C = Cased Convertible A Coil A = Uncased A Coil F = Cased Horizontal Flat Coil	DIGITS 13 Airflow Application	A = Upflow Only B = Upflow/Downflow H = Horizontal Only C = Convertible-Upflow, Downflow, Left Airflow M = Convertible-Upflow, Downflow, Left or Right Airflow
DIGIT 5 Coil Width (Cased/Uncased)	A = 14.5"/13.3" B = 17.5"/16.3" C = 21.0"/19.8" D = 24.5"/23.3" H = 10.5"	DIGIT 14 Minor Modification	A = Minor Design Change
DIGIT 6 Field Fitting	O = Brazed	DIGIT 15 Service Digit	A = Service Digit
DIGITS 7 & 8 Capacity Nominal Capacity in 000's of BTUH's			
DIGIT 9 Major Modification	A = Major Design Change		

