

Part No.	Reference No.	Quantity	Description
0000131327~S	*		CASED COIL
0000131328~S	*		MODEL NUMBER DESCRIPTION
0000131329~S	*		OPTIONAL TXV KITS

Part No.	Reference No.	Quantity	Description
0000019136~P	*		CASED COIL PARTS LIST

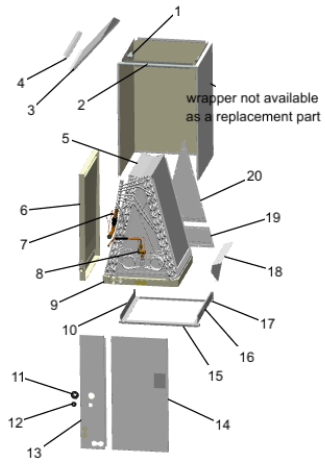

Part No.	Reference No.	Quantity	Description
4TXCB004DS3HCB	*	1	COIL: ASSEMBLY, WITH DRAIN PAN
CLP00182	*	1	CLIP, EXPANSION VALVE
KIT17350	*	1	KIT; BAG ASSEMBLY 4 SCREWS AND 4 INSULATORS
GRD00938	3	1	GUARD; SPLASH, 19.29 X 8.00
BAF01201	4	1	BAFFLE; DRAIN, 1.27 X 20.75, V-SHAPED CHANNEL
BAF01523	5	1	BAFFLE; TOP
PAN03220	6	1	PAN; SECONDARY DRAIN PAN ASSEMBLY, PLASTIC, 21.23 X 21.10 X 1.50
BOD00114	7	1	BODY; VALVE, BRASS, 7/16 HEX, 7/16 -20 UNF-2A
VAL12849	8a	1	VALVE; TEV HXCE 3 ZX200 B15 R410A
TUB13776	8b	1	TUBE; ASSEMBLY, LIQUID. INCLUDES FLANGE FITTING, HEX NUT AND INLET SCREEN
PAN03216	9a	1	PAN; DRAIN PAN ASSEMBLY, PLASTIC, 16.28 X 21.10 X 2.54
PLU00457	9b	1	PLUG; DRAIN PAN
SUP06651	10	1	SUPPORT; COIL SHIELD
GRM00863	11	1	GROMMET; SUCTION GROMMET
GRM00864	12	1	GROMMET; CONE GROMMET, LIQUID LINE
PNL36846	13	1	PANEL; INSULATION ASM-LINESET
PNL37950	14	1	PANEL; INSULATION ASM-COIL
BRK05157	15	1	BRACKET; BOTTOM
SUP06650	16	1	SUPPORT; COIL SHIELD

MODEL NUMBER DESCRIPTION
Parts List Number :0000131310
Model Number :4TXCB004DS3HCBV

Part No.	Reference No.	Quantity	Description
0000019156~P	*		MODEL NUMBER GRAPHIC

MODEL NUMBER DESCRIPTION

75010729

REV.
A

Heat Pump / Cooling Coils

Example Model Number:

4 T X C B 0 3 6 A C 3 H C A A
1 - - - 5 - - - 10 - - - 15

Digit 1 – Refrigerant Type

4 = R-410A

Digit 2 – Series

T = Premium (Heat Pump)
N = Premium (Cooling and HP)
P = Premium High Efficiency - Dedicated
position (Cooling and HP)
C = Standard (Cooling Only)
F = Entry Level (Cooling Only)

Digit 3 – Coil Design

X = Direct Expansion Evaporator Coil

Digit 4 – Coil Feature

C = Cased A Coil
A = Uncased A Coil
F = Cased Horizontal Flat Coil

Digit 5 – Coil Width (Cased/Uncased)

A = 14.5" / 13.3"
B = 17.5" / 16.3"
C = 21.0" / 19.8"
D = 24.5" / 23.3"
H = 10.5"

Digit 6 – Refrigerant Line Coupling / Airflow Configuration

0 = Brazed
U = Upflow only, convertible to Horizontal Left
D = Downflow only, convertible to Horizontal
Right

Digits 7,8 – Nominal Capacity in 1000's (BTUH) / Model Number Distinguisher

Digit 9 – Major Design Change

Digit 10 – Efficiency

C = Standard
S = High Efficiency (derived from 10 SEER
products)
Z = High Efficiency (TXV modulates to 50%)

Digit 11 – Refrigerant Control

3 = TXV - Non-Bleed

Digit 12 – Coil Circuitry

H = Heat Pump
C = Cooling

Digit 13 – Airflow Configuration

A = Upflow
U = Upflow / Downflow
D = Downflow
R = Downflow / Horizontal Right
H = Horizontal Left / Right
C = Convertible - Upflow, Downflow,
Left or Right

Digit 14 – Minor Design Change

Digit 15 – Service Digit, Not Orderable

OPTIONAL TXV KITS

Parts List Number :0000131310

Model Number :4TXCB004DS3HCBV

Part No.	Reference No.	Quantity	Description
0000019137~P	*		OPTIONAL TXV KITS LIST

Part No.	Reference No.	Quantity	Description
2AYTXVH3H1836A	*	1	KIT; FIELD MOUNTED TXV (R-22)
4AYTXVH4A3042A	*	1	KIT-TXV ADJ R410A
BAYGSKT001A0	*	1	KIT-DOWNFLOW INSULATE GSK