

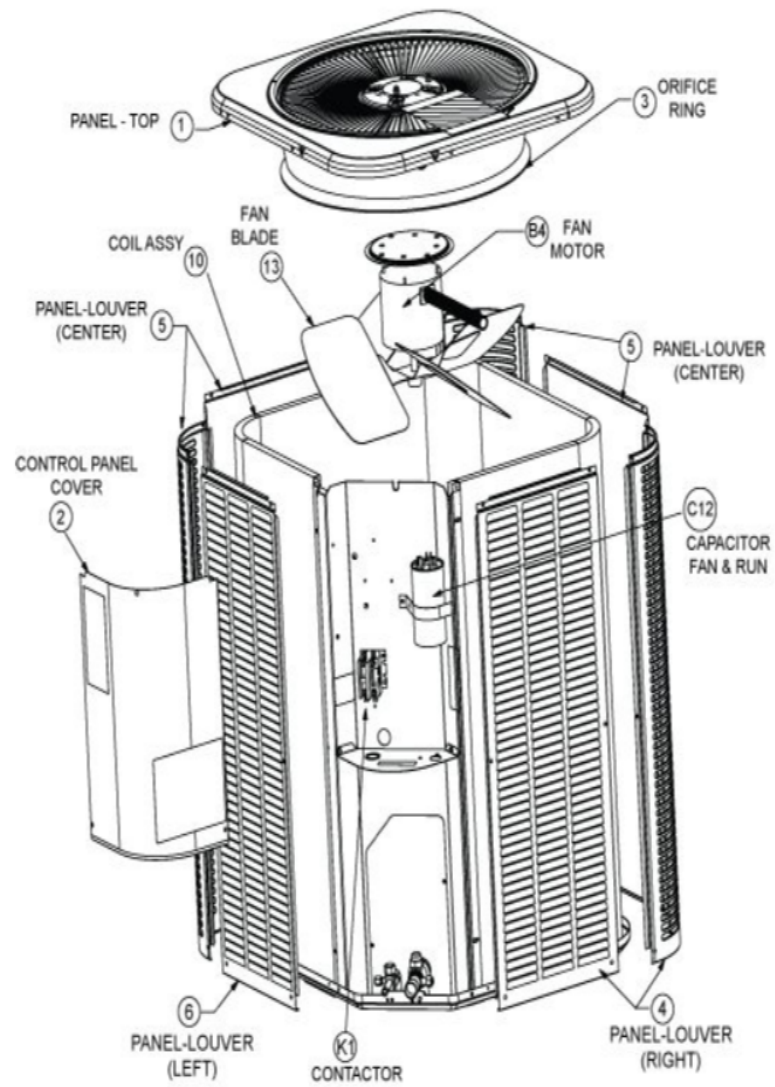

ML14XC1 UNIT



Revision Number - 9A

*OPTIONAL PARTS-FIELD INSTALLED

Callout	Name	Quantity	Description
	SWITCH-PRESS Cat #: 84M96 Model/Part #: 100216-01	1	"IN 55+5PSIG,OUT 25+5PSIG"
	SEAL CAP Cat #: 95M45 Model/Part #: 100275-01	1	1/4 INCH FLARE SEAL CAP
	CAPACITOR-START Cat #: 63A06 Model/Part #: 63A0601	1	CAPACITOR 176-216 MFD @ 320V ROUND
	RELAY-POTENTIAL Cat #: 58327 Model/Part #: P-8-3577	1	SPNC
LC KIT	LOSS OF CHARGE KIT Cat #: 84M23 Model/Part #: LB-110135A	1	INC NEXT 3 PARTS
ST KIT	START KIT Cat #: 88M91 Model/Part #: LB-31200BAR	1	START KIT (INCL NEXT 2 PARTS)

CABINET PARTS

Callout	Name	Quantity	Description
	NUT-CAP Cat #: 85M56 Model/Part #: 100094-01	4	NUT 8-32 HEX CAP W/SERRATION
	PANEL - LOUVER (LEFT) Cat #: 61W59 Model/Part #: 603095-04	1	PANEL - LOUVER (LEFT)
	COVER Cat #: 69J03 Model/Part #: 69J0301	1	SOUND-COMPRESSOR (OPTIONAL)
	LEG Cat #: 94J45 Model/Part #: LB-87156A	1	BASE(SET OF 4)
1	PANEL-TOP Cat #: 14X39 Model/Part #: 614380-02	1	TOP-LOUVER (32.25 X 32.25) DUCANE
2	COVER-CONTROL BOX Cat #: 61W01 Model/Part #: 102072-02	1	COVER, CONTROL PANEL (DUCANE GRAY)

Callout	Name	Quantity	Description
3	ORIFICE Cat #: 32W55 Model/Part #: 100001-02	1	ORIFICE RING (26 I.D. X 6)
4	PANEL - LOUVER (RIGHT) Cat #: 61W51 Model/Part #: 603093-04	1	PANEL - LOUVER (RIGHT)
5	PANEL - LOUVER (CENTER) Cat #: 61W55 Model/Part #: 603094-04	2	PANEL - LOUVER (CENTER)

CONTROL PANEL PARTS

Callout	Name	Quantity	Description
C12	CAPACITOR-FAN&RUN Cat #: 29W09 Model/Part #: 100335-39	1	CAPACITOR 70 + 10 MFD @ 440V ROUND
K1	CONTACTOR Cat #: 95M56 Model/Part #: 100438-02	1	CONTACTOR-SPST 35FLA/40RES

COOLING PARTS

Callout	Name	Quantity	Description
	CORE-VALVE Cat #: 95M48 Model/Part #: 100210-01	1	CORE-VALVE SCHRADER
	DRIER Cat #: 95M52 Model/Part #: 100214-03	1	LIQUID LINE(FOOTNOTE 1)
	KIT RFC (.097) Cat #: 10M13 Model/Part #: 100484-57	1	KIT RFC (.097)
	THERMOSTAT SPST OPEN@70°F CLOSE@50°F 40" Cat #: 95M54 Model/Part #: 100503-01	1	THERMOSTAT CC HEATER OPEN 70F, CLOSE 50F
	FITTING-PRESS TAP Cat #: 95M47 Model/Part #: 100520-01	1	FITTING PRESSURE TAP (BRASS)
	HARNESS-COMPRESSOR MOLDED PLUG Cat #: 13U63 Model/Part #: 104162-03	1	HARNESS-COMPRESSOR

Callout	Name	Quantity	Description
			MOLDED PLUG
	DRIER Cat #: 88K44 Model/Part #: 88K4401	1	SUCTION LINE (OPTIONAL)
10	ASSY-REPAIR PART (COIL) Cat #: 13T48 Model/Part #: 614262-07	1	REPAIR COIL PACKAGE ASSY
11	VALVE SERVICE 3/8 Cat #: 10M23 Model/Part #: 103881-01	1	VALVE SERVICE 3/8 - LIQUID LINE
12	VALVE-BALL SERVICE 1-1/8 X 7/8 Cat #: 77W35 Model/Part #: 102831-06	1	VALVE-BALL SVC 1-1/8 X 7/8 - SUCTION
13	FAN Cat #: 21W10 Model/Part #: 100060-11	1	FAN 26 INCH 4 BLADE 22 PITCH CCW
B1	COMPRESSOR ABG051KAC Cat #: 12Y73 Model/Part #: 104161-09	1	COMPRESSOR ABG051KAA
B4	MOTOR-FAN Cat #: 69W97 Model/Part #: 100483-30	1	MOTOR-FAN 1/3 HP 208/230 V 60HZ 825 RPM
HR1	HEATER-CRANKCASE Cat #: 93M06 Model/Part #: 100499-03	1	HEATER- CRANKCASE
S4	SWITCH-HI PRESS AUTO RESET Cat #: 11Y35 Model/Part #: 103736-06	1	SWITCH-HI PRESS AUTO RESET

Note:

Note1: Compressor uses POE oil. The filter drier MUST BE replaced at time of compressor change. Please advise customer of this requirement at time of order. (The filter drier is excluded from the Lennox Quality Care Limited Warranty).