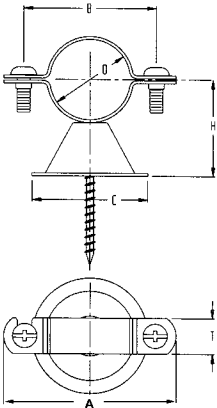

**FIG. 129CT VAN (BELL TYPE) HANGER, EPOXY COATED (COPPER-GARD)
 FIG. 129CTP VAN (BELL TYPE) HANGER, COPPER PLATED**



Material: Carbon steel.
Finish: Copper plated, copper epoxy coated (*COPPER-GARD*) (with stainless steel screws).
Service: Designed to support copper tubing to wall. Supports the pipe 1" from the back of pipe to wall. The wood screw is concealed upon installation.
Ordering: Specify tube size, finish and figure number.

TUBE SIZE	D TUBE OD	A	B	C	H	T	WGT EACH (lbs) WITH SCREW
1/2	0.625	2 ³ / ₁₆	1 ⁹ / ₁₆	1 ⁵ / ₈	1 ¹ / ₁₆	1/2	0.06
3/4	0.875	2 ³ / ₈	1 ³ / ₄	1 ⁵ / ₈	1 ³ / ₁₆	1/2	0.06
1	1.125	2 ⁷ / ₁₆	1 ⁷ / ₈	1 ⁵ / ₈	1 ⁵ / ₁₆	1/2	0.06
1 ¹ / ₄	1.375	2 ¹¹ / ₁₆	2 ¹ / ₈	1 ⁵ / ₈	1 ⁷ / ₁₆	1/2	0.08
1 ¹ / ₂	1.625	3 ¹ / ₁₆	2 ⁷ / ₁₆	1 ⁵ / ₈	1 ⁹ / ₁₆	1/2	0.08
2	2.125	4 ⁷ / ₁₆	2 ¹³ / ₁₆	1 ⁵ / ₈	1 ¹³ / ₁₆	1/2	0.09

ASSEMBLED WITH #6 X 2 COARSE THREAD DRYWALL SCREW

FIG. 131CT MILFORD HANGER, COPPER TUBE SIZE

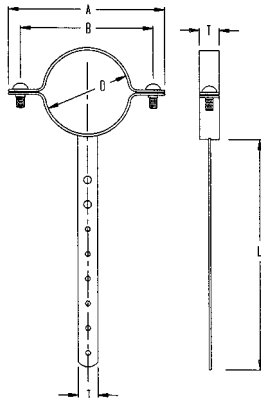

Material: Carbon Steel.
Finish: Copper epoxy coated (*COPPER-GARD*)
Service: Designed for the support of copper tube supply lines. Attaches to wood members.
Ordering: Specify tube size, length and figure number.

TUBE SIZE	D TUBE OD	A	B	T	L	WGT EACH (lbs)	
						6"	12"
1/2	0.625	2 ³ / ₁₆	1 ⁹ / ₁₆	1/2	6" or 12"	0.08	0.12
3/4	0.875	2 ³ / ₈	1 ³ / ₄	1/2	6" or 12"	0.08	0.12
1	1.125	2 ⁷ / ₁₆	1 ⁷ / ₈	1/2	6" or 12"	0.08	0.12
1 ¹ / ₄	1.375	2 ¹¹ / ₁₆	2 ¹ / ₈	1/2	6" or 12"	0.10	0.14
1 ¹ / ₂	1.625	3 ¹ / ₁₆	2 ⁷ / ₁₆	1/2	6" or 12"	0.10	0.14
2	2.125	3 ⁷ / ₁₆	2 ¹³ / ₁₆	1/2	6" or 12"	0.10	0.14