

**12ACB SERIES**  
OCTOBER 25, 1994

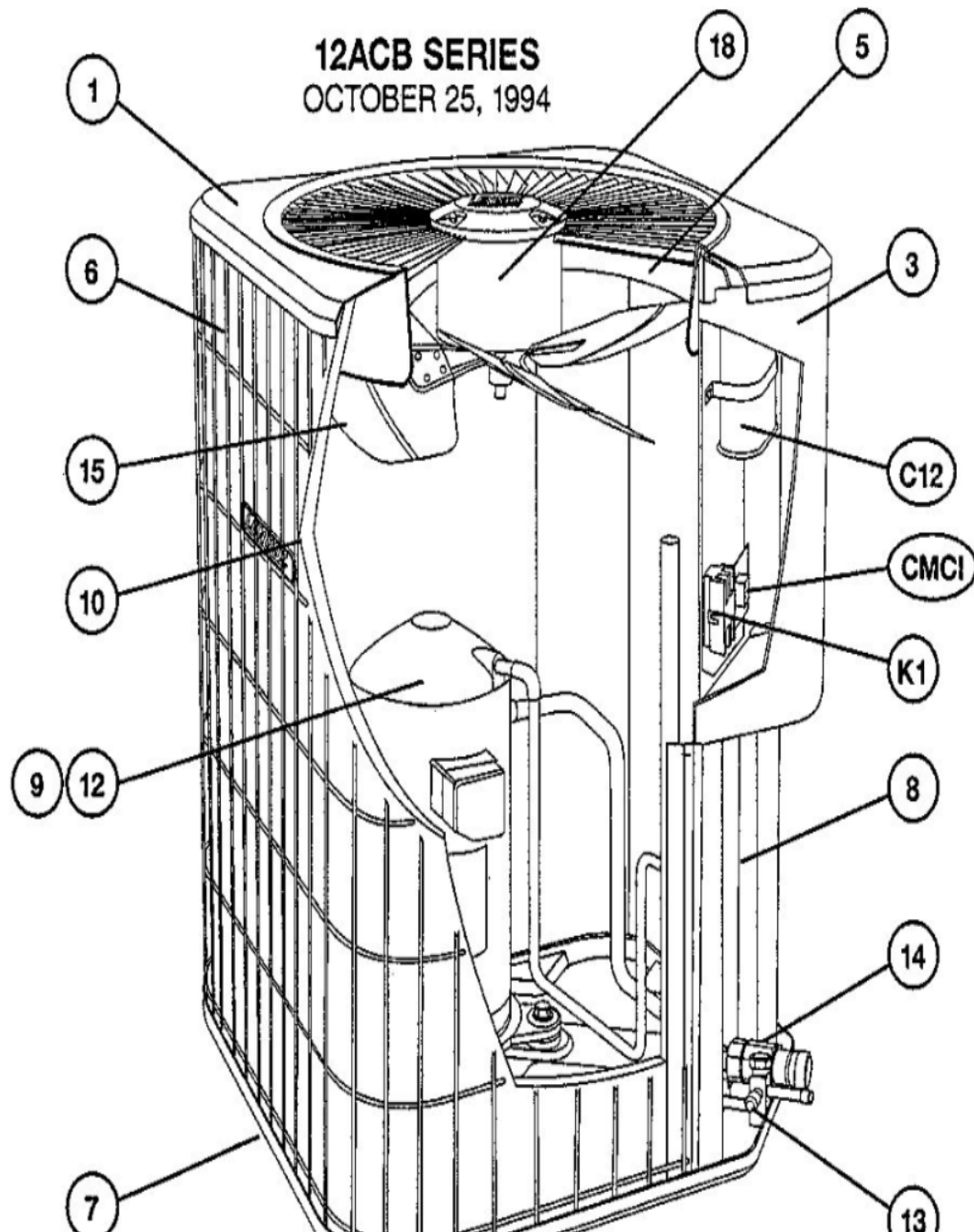

Revision Number - 1P

## \*OPTIONAL PARTS-FIELD INSTALLED

Callout	Name	Quantity	Description
	CAPACITOR-START Cat #: 21J29 Model/Part #: 21J2901	1	"270-324MFD,330VAC"
	VALVE-SADDLE Cat #: 65G91 Model/Part #: 65G9101	1	"3/8""
	SWITCH-HI PRESS Cat #: 86H31 Model/Part #: 86H3101	1	OUT 410+10PSIG
	SWITCH-LO PRESS Cat #: 87265 Model/Part #: P-8-10978	1	"IN 55+5PSIG,OUT 25+5PSIG"
	RELAY-POTENTIAL Cat #: 58327 Model/Part #: P-8-3577	1	SPNC
HP KIT	HI PRESS CUTOFF KIT Cat #: 94J46 Model/Part #: LB-87619A	1	INC NEXT 2 PARTS
LC KIT	LOSS OF CHARGE KIT Cat #: 94J47 Model/Part #: LB-87620A	1	INC NEXT 2 PARTS
ST KIT	START-KIT Cat #: 81J69 Model/Part #: LB-31200BW	1	INC NEXT 2 PARTS

## CABINET PARTS

Callout	Name	Quantity	Description
	NUT-CAP Cat #: 68J41 Model/Part #: 68J4101	4	TOP PANEL
1	PANEL-TOP Cat #: 35K42 Model/Part #: LB-86264B	1	TOP PANEL (28 X 28) BROWN
3	COVER-CONTROL BOX Cat #: 37K56 Model/Part #: LB-86268B	1	COVER-CONTROL PANEL (BROWN)
5	ORIFICE Cat #: 68J47 Model/Part #: 68J4701	1	"22""
6	GUARD-COIL	1	COIL GUARD 36 in.

Callout	Name	Quantity	Description
	Cat #: 68J44 Model/Part #: 68J4401		
7	LEG Cat #: 94J45 Model/Part #: LB-87156A	1	BASE(SET OF 4)
8	COVER Cat #: 59L51 Model/Part #: LB-86272B	1	PATCH PLATE
9	COVER Cat #: 69J03 Model/Part #: 69J0301	1	SOUND- COMPRESSOR

## CONTROL PANEL PARTS

Callout	Name	Quantity	Description
C12	CAPACITOR-FAN&RUN Cat #: 49K50 Model/Part #: 49K5001	1	"80+7.5MFD,370VAC(ROUND)"
C12	CAPACITOR-FAN&RUN Cat #: 68J09 Model/Part #: 68J0901	1	"80+7.5MFD,370VAC(OVAL)"
CMC1	CONTROL-TIMED OFF Cat #: 47J35 Model/Part #: LB-61378A	1	(TOC1-2)
K1	CONTACTOR Cat #: 68J37 Model/Part #: 68J3701	1	"DPDT,24V"

## COOLING PARTS

Callout	Name	Quantity	Description
	RELAY-OVERLOADCOMP-INTERNAL Cat #: Model/Part #:	1	
	DRIER Cat #: 12L71 Model/Part #: 12L7101	1	LIQUID LINE(OPT REPLACEMENT)
	DRIER Cat #: 15B63 Model/Part #: 15B6301	1	SUCTION LINE(OPT REPLACEMENT)
	HEATER-CRANKCASE Cat #: 31J20 Model/Part #: 31J2001	1	COMP(240V)
	MOUNT PKG-COMP Cat #: 74J30 Model/Part #: 74J3001PR	1	MOUNT PKG-COMP

<b>Callout</b>	<b>Name</b>	<b>Quantity</b>	<b>Description</b>
	WELL-THERMOMETER Cat #: 10J33 Model/Part #: LB-83856A	1	THERMOMETER WELL ASSY.
10	COIL-OUTDOOR Cat #: 94J34 Model/Part #: LB-87170T	1	W/MANIFOLD
12	COMPRESSOR Cat #: 53J06 Model/Part #: 53J0601	1	"5TON,208- 230/60/1,COPE"
13	VALVE-SERVICE Cat #: 68J10 Model/Part #: 68J1001	1	"LIQUID LINE,3/8""
14	VALVE-SERVICE Cat #: 31J50 Model/Part #: 31J5001	1	"SUCTION LINE,7/8""
15	FAN Cat #: 68J43 Model/Part #: 68J4301	1	"1/2""BORE,22""DIA,4 BLADE"
18	MOTOR-FAN Cat #: 68J24 Model/Part #: 68J2401	1	"1/3HP,1075RPM,208- 230/60/1"

**Note:**

There are no technical notes for this product.