

12ACB SERIES
OCTOBER 25, 1994

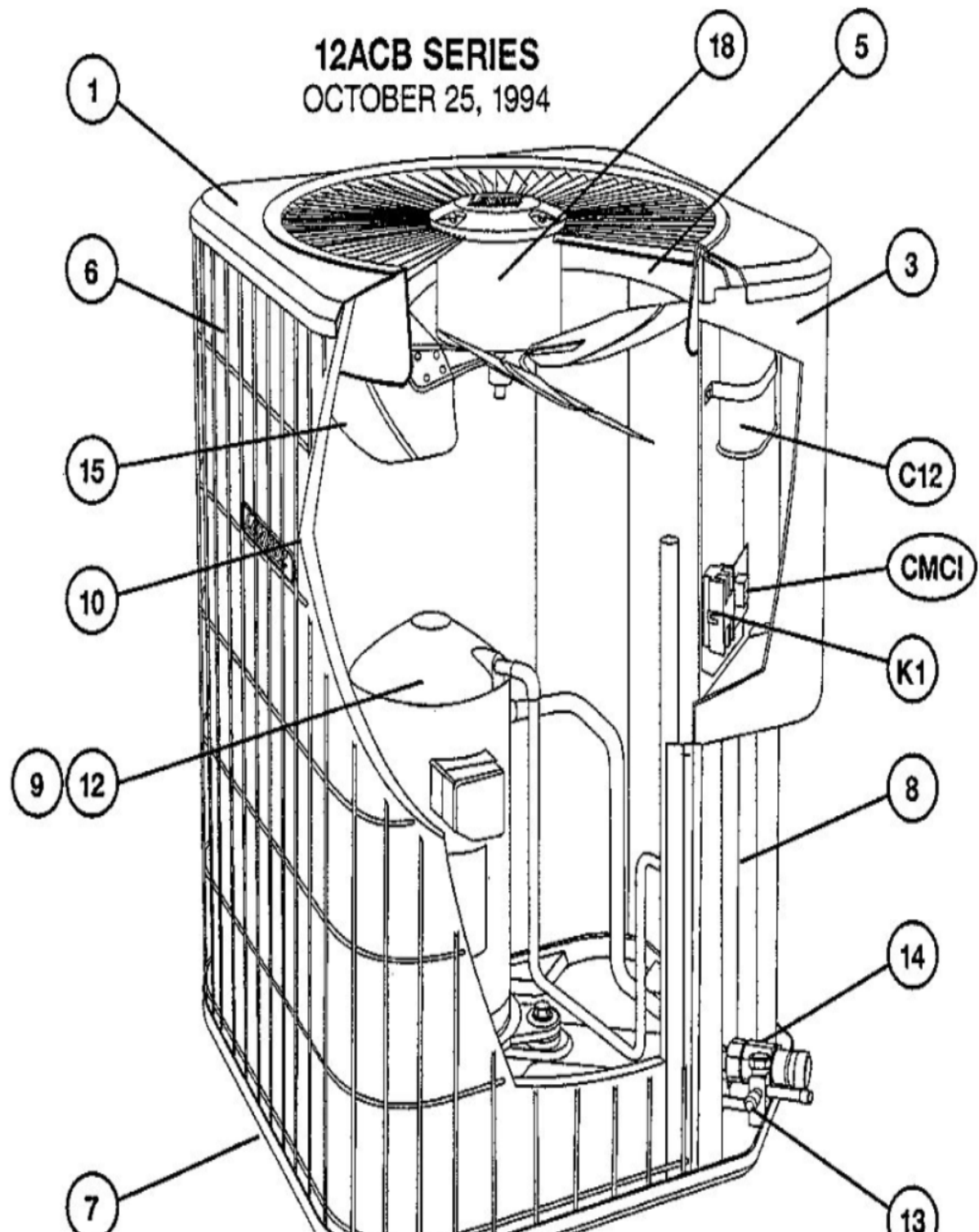

Revision Number - 5P

*OPTIONAL PARTS-FIELD INSTALLED

Callout	Name	Quantity	Description
	CAPACITOR-START Cat #: 47A60 Model/Part #: 47A6001	1	"88MFD,330VAC"
	VALVE-SADDLE Cat #: 65G91 Model/Part #: 65G9101	1	"3/8""
	SWITCH-HI PRESS Cat #: 86H31 Model/Part #: 86H3101	1	OUT 410+10PSIG
	SWITCH-LO PRESS Cat #: 87265 Model/Part #: P-8-10978	1	"IN 55+5PSIG,OUT 25+5PSIG"
	RELAY-POTENTIAL Cat #: 58327 Model/Part #: P-8-3577	1	SPNC
HP KIT	HI PRESS CUTOFF KIT Cat #: 94J46 Model/Part #: LB-87619A	1	INC NEXT 2 PARTS
LC KIT	LOSS OF CHARGE KIT Cat #: 94J47 Model/Part #: LB-87620A	1	INC NEXT 2 PARTS
ST KIT	START KIT Cat #: 10J42 Model/Part #: 10J42	1	INC NEXT 2 PARTS

CABINET PARTS

Callout	Name	Quantity	Description
	NUT-CAP Cat #: 68J41 Model/Part #: 68J4101	4	TOP PANEL
1	PANEL-TOP Cat #: 26K58 Model/Part #: LB-86265L	1	TOP PANEL (24X24)(BEIGE) (PM)
3	COVER-CONTROL BOX Cat #: 37K03 Model/Part #: LB-86268L	1	COVER-CONTROL PANEL (BEIGE)
5	ORIFICE Cat #: 68J46 Model/Part #: 68J4601	1	"18""
6	GUARD- COIL	1	COIL GUARD 32 in.

Callout	Name	Quantity	Description
	Cat #: 41K71 Model/Part #: 41K7101		
7	LEG Cat #: 94J45 Model/Part #: LB-87156A	1	BASE(SET OF 4)
8	COVER Cat #: 32K99 Model/Part #: LB-86272A	1	PATCH PLATE
9	COVER Cat #: 69J03 Model/Part #: 69J0301	1	SOUND- COMPRESSOR

CONTROL PANEL PARTS

Callout	Name	Quantity	Description
C12	CAPACITOR-FAN&RUN Cat #: 32M96 Model/Part #: 32M9601	1	"50+5MFD,370VAC(ROUND)"
C12	CAPACITOR-FAN MTR Cat #: 72H76 Model/Part #: 72H7601	1	"50+5MFD,370VAC(OVAL)"
K1	CONTACTOR Cat #: 65C69 Model/Part #: 65C6901	1	"SPST,24V"

COOLING PARTS

Callout	Name	Quantity	Description
	RELAY-OVERLOADCOMP-INTERNAL Cat #: Model/Part #:	1	
	DRIER Cat #: 12L71 Model/Part #: 12L7101	1	LIQUID LINE(OPT REPLACEMENT)
	HARNESS-COMPRESSOR Cat #: 15M35 Model/Part #: 15M3501	1	MOLDED PLUG
	HEATER-CRANKCASE Cat #: 31J20 Model/Part #: 31J2001	1	COMP(240V)
	DRIER Cat #: 58A64 Model/Part #: 58A6401	1	SUCTION LINE(OPT REPLACEMENT)
	MOUNT PKG-COMP Cat #: 74J30 Model/Part #: 74J3001PR	1	MOUNT PKG-COMP

Callout	Name	Quantity	Description
	WELL-THERMOMETER Cat #: 10J33 Model/Part #: LB-83856A	1	THERMOMETER WELL ASSY.
10	COIL-OUTDOOR Cat #: 16K39 Model/Part #: LB-87170AD	1	W/MANIFOLD
12	COMPRESSOR Cat #: 97M94 Model/Part #: 15M6601	1	"3TON,208-230/60/1,COPE(AFTER 6/01 PROD)
12	COMPRESSOR Cat #: 97M94 Model/Part #: 66J4401	1	"3TON,208-230/60/1,COPE"
13	VALVE-SERVICE Cat #: 68J10 Model/Part #: 68J1001	1	"LIQUID LINE,3/8""
14	VALVE-SERVICE Cat #: 68J98 Model/Part #: 68J9801	1	"SUCTION LINE,7/8""
15	FAN Cat #: 68J27 Model/Part #: 68J2701	1	"1/2""BORE,18""DIA,4 BLADE"
18	MOTOR-FAN Cat #: 68J97 Model/Part #: 68J9701	1	"1/6HP,1075RPM,208-230/60/1"

Note:

There are no technical notes for this product.