

**12ACB SERIES**  
OCTOBER 25, 1994

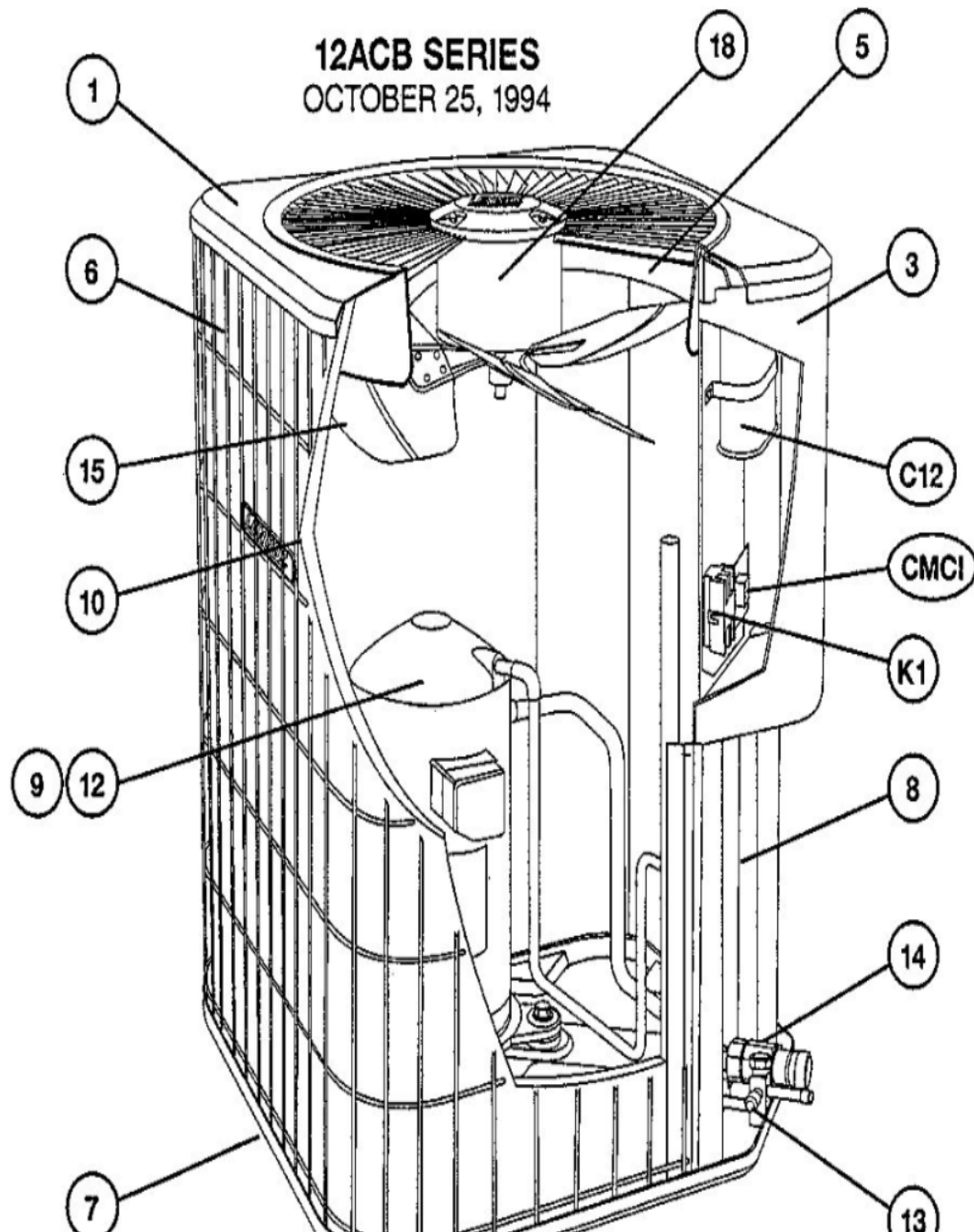

Revision Number - 6P

## \*OPTIONAL PARTS-FIELD INSTALLED

| Callout | Name  | Quantity | Description                      |
|---------|---|----------|----------------------------------|
|         | CAPACITOR-START<br>Cat #: 47A60 Model/Part #: 47A6001       | 1        | "88MFD,330VAC"                   |
|         | VALVE-SADDLE<br>Cat #: 65G91 Model/Part #: 65G9101          | 1        | "3/8""                           |
|         | SWITCH-HI PRESS<br>Cat #: 86H31 Model/Part #: 86H3101       | 1        | OUT 410+10PSIG                   |
|         | SWITCH-LO PRESS<br>Cat #: 87265 Model/Part #: P-8-10978     | 1        | "IN<br>55+5PSIG,OUT<br>25+5PSIG" |
|         | RELAY-POTENTIAL<br>Cat #: 58327 Model/Part #: P-8-3577      | 1        | SPNC                             |
| HP KIT  | HI PRESS CUTOFF KIT<br>Cat #: 94J46 Model/Part #: LB-87619A | 1        | INC NEXT 2<br>PARTS              |
| LC KIT  | LOSS OF CHARGE KIT<br>Cat #: 94J47 Model/Part #: LB-87620A  | 1        | INC NEXT 2<br>PARTS              |
| ST KIT  | START KIT<br>Cat #: 10J42 Model/Part #: 10J42               | 1        | INC NEXT 2<br>PARTS              |

## CABINET PARTS

| Callout | Name  | Quantity | Description                      |
|---------|---|----------|----------------------------------|
|         | NUT-CAP<br>Cat #: 68J41 Model/Part #: 68J4101             | 4        | TOP PANEL                        |
| 1       | PANEL-TOP<br>Cat #: 26K58 Model/Part #: LB-86265L         | 1        | TOP PANEL<br>(24X24)(BEIGE) (PM) |
| 3       | COVER-CONTROL BOX<br>Cat #: 37K03 Model/Part #: LB-86268L | 1        | COVER-CONTROL<br>PANEL (BEIGE)   |
| 5       | ORIFICE<br>Cat #: 68J46 Model/Part #: 68J4601             | 1        | "18""                            |
| 6       | GUARD- COIL   | 1        | COIL GUARD 32 in.                |

| Callout | Name  | Quantity | Description          |
|---------|---|----------|----------------------|
|         | Cat #: 41K71 Model/Part #: 41K7101            |          |                      |
| 7       | LEG<br>Cat #: 94J45 Model/Part #: LB-87156A   | 1        | BASE(SET OF 4)       |
| 8       | COVER<br>Cat #: 32K99 Model/Part #: LB-86272A | 1        | PATCH PLATE          |
| 9       | COVER<br>Cat #: 69J03 Model/Part #: 69J0301   | 1        | SOUND-<br>COMPRESSOR |

## CONTROL PANEL PARTS

| Callout | Name  | Quantity | Description      |
|---------|---|----------|------------------|
| C12     | CAPACITOR-FAN&RUN<br>Cat #: 53H25 Model/Part #: 39H8201 | 1        | "40+5MFD,370VAC" |
| K1      | CONTACTOR<br>Cat #: 65C69 Model/Part #: 65C6901         | 1        | "SPST,24V"       |

## COOLING PARTS

| Callout | Name   | Quantity | Description                      |
|---------|--|----------|----------------------------------|
|         | RELAY-OVERLOADCOMP-INTERNAL<br>Cat #: Model/Part #:      | 1        |                                  |
|         | DRIER<br>Cat #: 12L71 Model/Part #: 12L7101              | 1        | LIQUID LINE(OPT<br>REPLACEMENT)  |
|         | HARNESS-COMPRESSOR<br>Cat #: 15M35 Model/Part #: 15M3501 | 1        | MOLDED PLUG                      |
|         | HEATER-CRANKCASE<br>Cat #: 31J20 Model/Part #: 31J2001   | 1        | COMP(240V)                       |
|         | DRIER<br>Cat #: 58A64 Model/Part #: 58A6401              | 1        | SUCTION LINE(OPT<br>REPLACEMENT) |
|         | MOUNT PKG-COMP<br>Cat #: 74J30 Model/Part #: 74J3001PR   | 1        | MOUNT PKG-COMP                   |
|         | WELL-THERMOMETER<br>Cat #: 10J33 Model/Part #: LB-83856A | 1        | THERMOMETER WELL<br>ASSY.        |

| <b>Callout</b> | <b>Name</b>   | <b>Quantity</b> | <b>Description</b>                              |
|----------------|---|-----------------|---|
| 10             | COIL-OUTDOOR<br>Cat #: 16K38 Model/Part #: LB-87170AC | 1               | W/MANIFOLD                                      |
| 12             | COMPRESSOR<br>Cat #: 15M61 Model/Part #: 15M6101      | 1               | "2TON,208-<br>230/60/1,COPE<br>(AFTER 6/01 PROD |
| 12             | COMPRESSOR<br>Cat #: 68J72 Model/Part #: 68J7201      | 1               | "2TON,208-<br>230/60/1,COPE"                    |
| 13             | VALVE-SERVICE<br>Cat #: 68J10 Model/Part #: 68J1001   | 1               | "LIQUID-LINE,3/8""                              |
| 14             | VALVE-SERVICE<br>Cat #: 68J95 Model/Part #: 68J9501   | 1               | "SUCTION LINE,3/4""                             |
| 15             | FAN<br>Cat #: 68J26 Model/Part #: 68J2601             | 1               | "1/2""BORE,18""DIA,3<br>BLADE"                  |
| 18             | MOTOR-FAN<br>Cat #: 31L19 Model/Part #: 31L1901       | 1               | "1/6HP,1075RPM,208-<br>230/60/1"                |

**Note:**

There are no technical notes for this product.