

1223375**

If your fill valve appears like the one below, replace with 1468017



1161319**

GP1138930



78132

1001958

1248135

1060306

85307

GP1229656

1244399

GP1059291

GP83996

K-4733-RL**

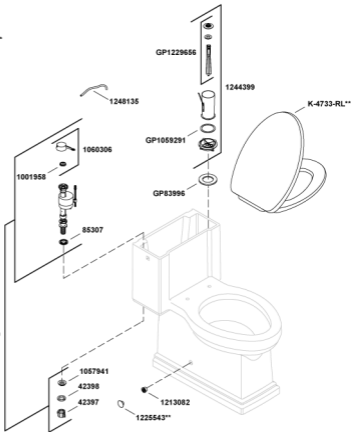

1225468



K-5383 (10" Rough-in)
1265868 (12" Rough-in)
K-5381 (14" Rough-in)



1232059