

Original Faucet Version 2

For model revisions AA to EG (K-14406**),
 For model revisions AA to DF (K-14408**),
 For model revisions AA to DG (K-14410**),
 For model revisions FG to GG (K-14406**), EF (K-14408**),
 DH (K-14410**), see Original Faucet Version 2.)

Revision Code:

AA to EG (K-14406**),
 AA to DF (K-14408**),
 AA to DG (K-14410**)

KOHLER

P/N: K-596-CP XX

MFG. DATE: XX/XX/XX

DO NOT REMOVE

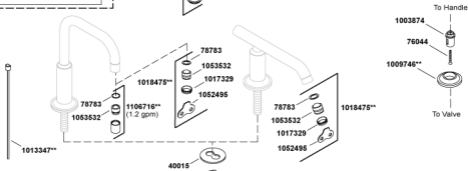
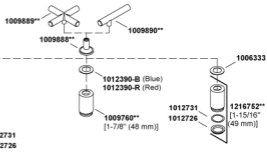

Compare the valve in your faucet to those shown below.
 Click on the drawing to view a colored image of the part.
 Components are not interchangeable between assemblies.

