

PIPE ATTACHMENTS

FLOOR SUPPORTS

Figure 125SP

Figure 136SP

Both Figure 125SP and 136SP are intended to support piping from below where there is no axial or transverse movement. Made special to customer design requirements, either may be furnished with holes in the base for bolting, or with no holes for welding.

Material: Carbon Steel, Stainless Steel.

Finish: Plain, Painted, Electro-Galvanized, Hot-Dip Galvanized.

Ordering: Specify pipe size, pipe material, load, overall height, figure number, finish, and base plate bolting if needed. For Metric applications specify Figure M125SP or M136SP.

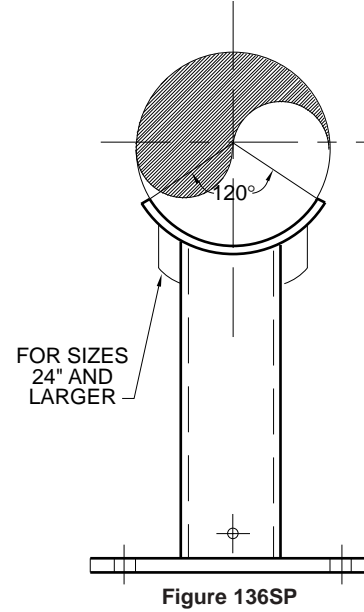
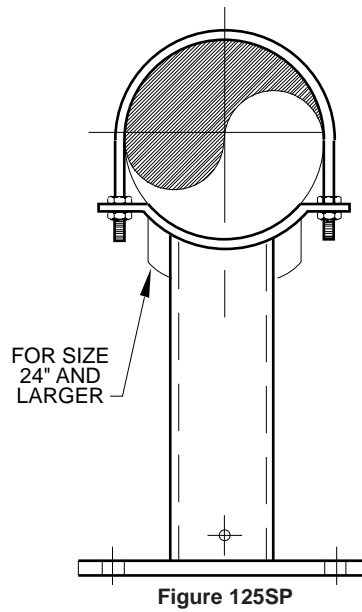

EXTENSION RISER CLAMP

Figure 126

The Figure 126 is designed for the support or steadying of vertical pipe risers. It is made of carbon steel and is designed to hold tight to the pipe, transmitting the load to the structure through the ears on each end. When possible the clamp should be placed under a coupling, hub, or lugs welded to the pipe.

NOTE: This product is not designed to be supported with rods. Use our Figure 124 when hanger rods are required. Install using the maximum suggested torque values shown in the Technical Section of this catalog.

Material: Carbon Steel.

Compliance: Federal Specification A-A-1192A Type 8, MSS-SP-69 (Type 8) and BSPSS-BS3974.

Finish: Plain, Painted, Electro-Galvanized, Hot-Dip Galvanized.

Ordering: Specify figure number, finish, and pipe size. For Metric applications specify M126.

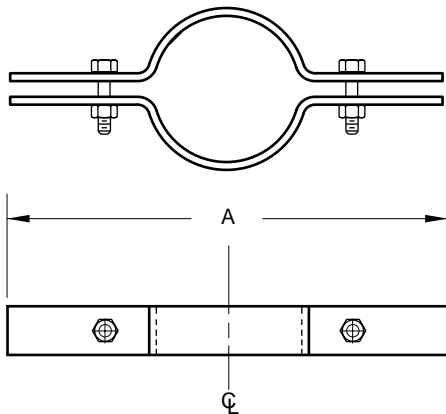

DIMENSIONS	TEMPERATURE	LOADS	WEIGHT
INCHES	FAHRENHEIT	POUNDS	POUNDS
MILLIMETERS	CELSIUS	NEWTONS	KILOGRAMS

FIGURE 126 – EXTENSION RISER CLAMP

PIPE SIZE	MAXIMUM LOAD	A	WEIGHT EACH
1/2	255	9	1.00
15	1134	229	0.45
3/4	255	9 3/8	1.08
20	1134	238	0.49
1	255	9 3/8	1.08
25	1134	238	0.49
1 1/4	255	10	1.16
32	1134	254	0.52
1 1/2	255	10 1/4	1.22
40	1134	260	0.55
2	255	10 3/4	1.30
50	1134	273	0.59
2 1/2	390	11 1/4	1.74
65	1735	286	0.79
3	530	12	1.98
80	2358	305	0.90
3 1/2	670	12 7/8	2.14
90	2980	327	0.97
4	810	13 5/8	2.28
100	3603	346	1.03
5	1160	13 3/4	3.60
125	5160	349	1.63
6	1570	15 1/4	3.68
150	6984	387	1.67
8	2500	18 1/2	7.26
200	11121	470	3.29
10	2500	20 3/4	11.00
250	11121	527	4.99
12	2700	22 3/4	15.94
300	12011	578	7.23
14	2700	24	17.36
350	12011	610	7.87
16	2900	26	29.68
400	12900	660	13.46
18	2900	28	31.64
450	12900	711	14.35
20	2900	30	34.84
500	12900	762	15.80
24	2900	34	50.00
600	12900	864	22.68