

AT-8100 Series Remote Setpoint Adjuster

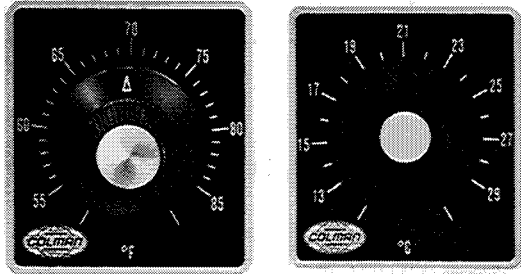

These setpoint adjusters are to be used when the setpoint is to be remote from either the TP-8101 or CP-8102. Calibration is not normally required when used. Scale plate 1-7/8" by 2-1/16". Allow 1-1/2" depth behind mounting surface. 3/8" hole required.

ASP-500 Series Indicating Meter

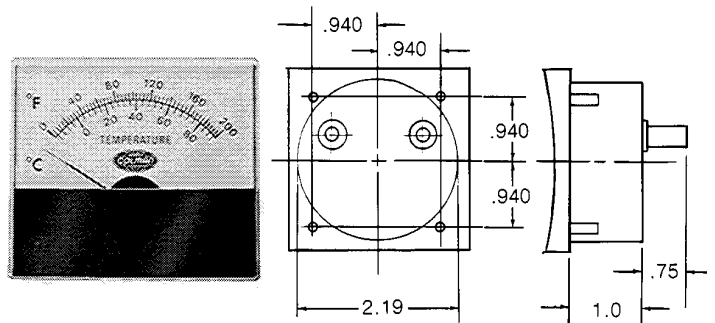

These meters are designed for use with TSP or HSP transmitters. The meter can be used for either local or remote indication of the sensed variable. All meters of the ASP-500 series are zero suppressed - taut band - 100° flat arc movement type with a sensitivity of 5000 ohm/volt. The meters are high accuracy 2% meters with a 1-1/2% repeatability and symmetry. All meters are 1 to 11 Vdc movements.

These meters are ruggedized plastic with a black cover and clear face for easy viewing of the 2-1/2" scale length. Calibration is not normally a field adjustment. If the meter is out of calibration it should be replaced.

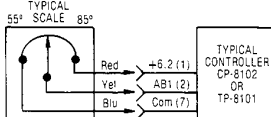
Part No.	Description*	Application	Requirements
AT-8158	13° to 29°C (55° to 85°F)	TP-8101 or CP-8102	Voltage: +6.2 ± .4 Vdc Current: 1.2 mA Wiring: 
AT-8122	-6° to 49°C (20° to 120°F)		
AT-8155	10° to 66°C (50° to 250°F)	CP-8102	

*Scales dual marked in °C and °F. Optional deviation scale for night setback with AT-8122 is AT-8258-101. Scale marked ± 8°C (± 15°F); Order separately.

Part No.	Meter Face Dimensions	Scale Range*	
		°C	°F
ASP-521	3-1/4" Wide, 2-3/4" High	10 to 38	50 to 100
ASP-522		-1 to 26	30 to 80
ASP-561		-40 to 71	-40 to 160
ASP-562	2-1/2" Scale	-17 to 93	0 to 200
ASP-563		4 to 116	40 to 240
ASP-581		20 to 80% RH	

*Scales dual marked in °C and °F.

AD-8301 Positioner

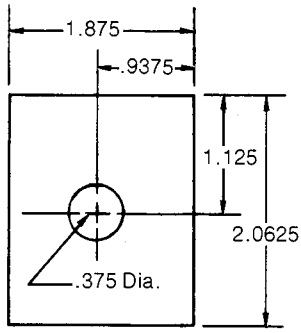

Depth Behind MTG Surface: 1-1/2

For either manual or minimum positioning control of 8000 Series controlled devices. Applied in 8000 system between controllers and controlled devices. Scale plate 1-7/8" by 2-1/16". Allow 1-1/2" depth behind mounting surface. 3/8" hole required.

Application	Operation	Requirements
Manual Control (Knob Pulled Out)	A 6 to 9 Vdc swing between min. and max. markings. CCW to CW rotation produced 1 to 15 Vdc. Calibration by positioning knob to scale.	
Minimum Positioner (Knob Pushed In)	A 6 to 9 Vdc min. position level adjustable between min. to max. markings. CCW to CW rotation produces 1 to 15 Vdc. Calibration by positioning knob to scale.	

Copyright 2008, TAC
All brand names, trademarks and registered trademarks are the property of their respective owners. Information contained within this document is subject to change without notice.

TAC
1354 Clifford Avenue
P.O. Box 2940
Loves Park, IL 61132-2940
www.tac.com

F-25795-2

t.a.c.
by Schneider Electric