

# Ellipse Access Areas to be Modified

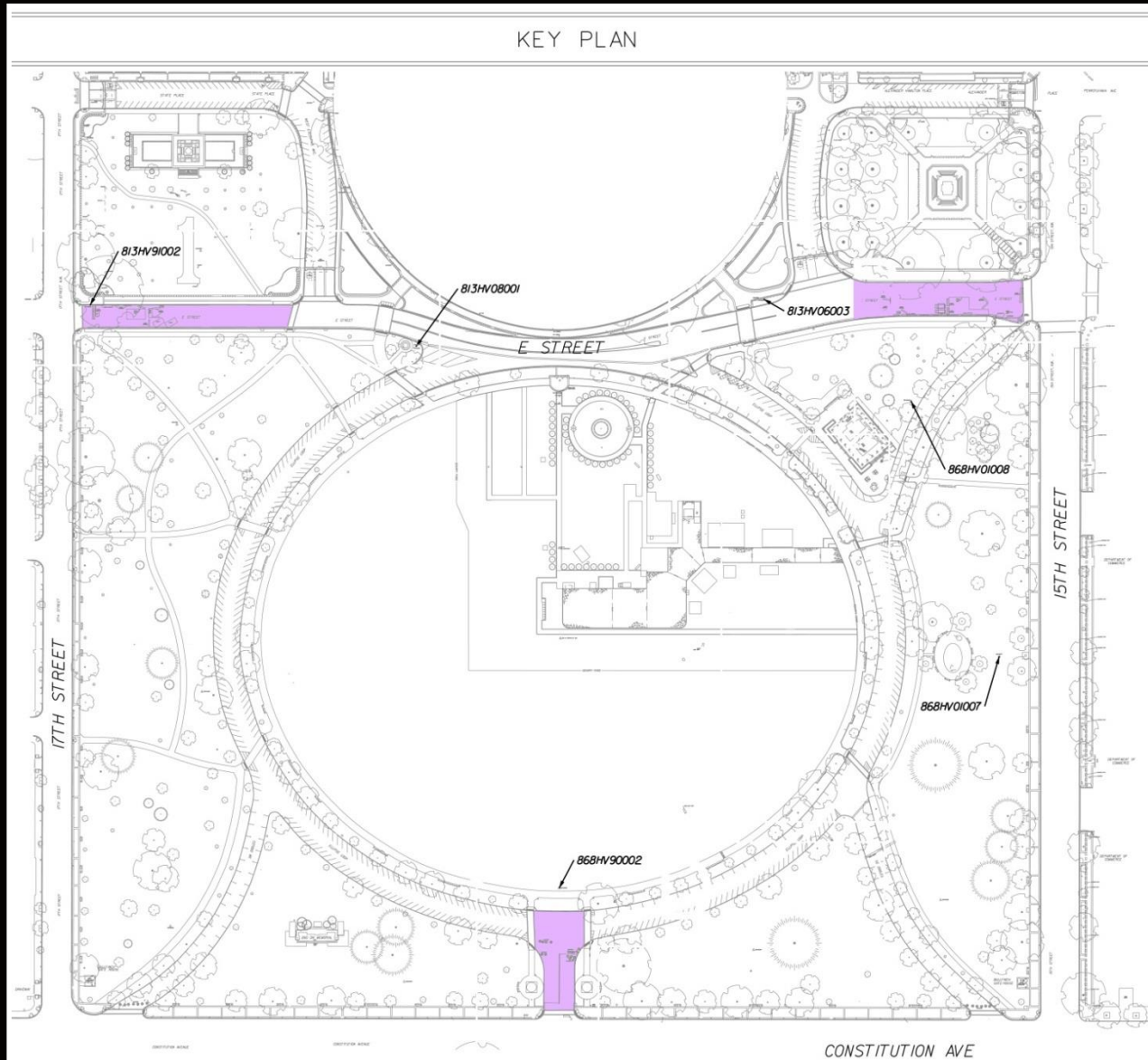

# 15<sup>th</sup> & E Street Existing Condition



View looking west at 15<sup>th</sup> & E Street entrance



# 15<sup>th</sup> & E Street Improved Condition



Rendering of improvements



# 15<sup>th</sup> & E Street Before & After





# 16<sup>th</sup> & Constitution Existing Condition



View looking north at 16<sup>th</sup> & Constitution entrance



# 16<sup>th</sup> & Constitution Improved Condition



Rendering of improvements

# 16<sup>th</sup> & Constitution Before & After





# 17<sup>th</sup> & E Street Existing Condition



View looking northeast at 17<sup>th</sup> & E entrance



# 17<sup>th</sup> & E Street Improved Condition



Rendering of improvements



# 17<sup>th</sup> & E Street Before & After





# Temporary Fence Improvements

(Note: the mock-up pictured was constructed with "pencil points" at a 7° angle, however this proposal would reduce the angle to 5° as shown in the following sketch





# Temporary Fence Improvements

