

ISO 9002



ANVIL[®]
INTERNATIONAL, INC.

CAST IRON FITTINGS

PRICE SHEET
Including Weights
and Packaging

PF-C.I. 1.04

EFFECTIVE January 5, 2004

(Cancels Price Sheet PF-C.I. 5.01 of November 18, 2002)

APPLIES TO:
**CAST IRON SCREWED – DRAINAGE, FLANGED
FITTINGS AND FLANGES
FLOOR AND CEILING PLATES
SAFETY VALVE DISCHARGE ELBOWS**

***SUBJECT TO CHANGE WITHOUT NOTICE
GO TO WEB SITE FOR MOST CURRENT
LIST PRICE INFORMATION/CHANGES
OR CONTACT AN ANVIL REPRESENTATIVE***

F.O.B. TERMS:

All prices are F.O.B. point of shipment. Title of goods shall pass to the buyer upon delivery of the shipment to the carrier.

LOSS OR DAMAGE CLAIMS:

All goods are shipped at buyer's risk. Shipments should be carefully examined upon delivery and before the carrier's delivery receipt is signed. If any loss or damage is evident, the buyer should make an appropriate notation on the delivery receipt and insist that the carrier's driver initial such exception. The contents of all packages should be carefully examined for concealed damage as soon as possible after delivery, so that the carrier can be requested, within 48 hours after delivery, to arrange for prompt inspection of the damaged goods.

FREIGHT TERMS:

Shipments weighing 2,500 pounds or more will be forwarded prepaid to any point in the United States (except Alaska and Hawaii).

Shipments weighing less than 2,500 pounds will be shipped prepaid. The buyer will be invoiced for freight costs at the applicable published class, exception or commodity rate(s), or charge(s).

Anvil reserves the right to select the carrier for all shipments.

NOTE:

Prices apply **only to Standard Sizes** as listed in catalogs.

Non-standard sizes produced to order only — prices on application. Sale is final not subject to cancellation, except upon agreement to make payment for work performed.

NOTE:

On orders received for cartoned items in less than "carton (not container) quantities," we reserve the right to adjust to the next carton quantity above the number of pieces shown on the order.

NOTE:

All orders are accepted on the basis or prices in effect at the time of shipment.

NOTE:

To the prices and terms quoted, there will be added any Manufacturer's or Sales Tax payable on the transaction under any effective statute.

**UPC numbers and SPIN commodity identification
numbers are available upon request.
Please contact your local ANVIL representative.**

CAST IRON FITTINGS

STANDARD SCREWED CAST IRON FITTINGS



90° ELBOW FIG. 351

SIZE	LIST PRICE EACH				QTY CARTON EACH	WGT PER 100
	ORDER QTY.	BLACK \$/EA.	ORDER QTY.	GALV. \$/EA.		
1/4	—	\$5.50	—	—	—	16
3/8	—	\$7.95	—	—	—	25
1/2	□ blk	\$3.49	—	—	150	40
3/4	□ blk	\$3.64	—	—	100	60
1	□ blk	\$4.31	—	—	45	92
1 1/4	□ blk	\$6.12	—	—	25	144
1 1/2	□ blk	\$8.45	—	—	15	195
2	□ blk	\$13.20	—	—	20	313
2 1/2	—	\$31.68	—	—	Bulk	494
3	—	\$51.85	—	—	Bulk	721
3 1/2	—	\$140.85	—	—	Bulk	967
4	—	\$96.14	—	—	Bulk	1217
5	—	\$204.82	—	—	Bulk	2146
6	—	\$265.41	—	—	Bulk	3133
8	—	\$649.01	—	—	Bulk	6456



90° ELBOW,
FLANGE & SCREW FIG. 371

SIZE	LIST PRICE EACH				QTY CARTON EACH	WGT PER 100
	ORDER QTY.	BLACK \$/EA.	ORDER QTY.	GALV. \$/EA.		
2 1/2	—	\$244.62	—	—	Bulk	1022
3	—	\$298.46	—	—	Bulk	1325
4	—	\$346.99	—	—	Bulk	2156
6	—	\$771.05	—	—	Bulk	4050
8	—	\$751.26	—	—	Bulk	8006



45° ELBOW FIG. 356

SIZE	LIST PRICE EACH				QTY CARTON EACH	WGT PER 100
	ORDER QTY.	BLACK \$/EA.	ORDER QTY.	GALV. \$/EA.		
1/4	—	\$6.59	—	—	Bulk	16
3/8	—	\$7.08	—	—	Bulk	23
1/2	—	\$5.33	—	—	150	37
3/4	—	\$5.37	—	—	100	55
1	□ blk	\$6.30	—	—	60	83
1 1/4	—	\$8.47	—	—	35	133
1 1/2	—	\$14.04	—	—	25	179
2	□ blk	\$16.19	—	—	20	289
2 1/2	—	\$42.13	—	—	Bulk	429

STANDARD SCREWED CAST IRON FITTINGS

45° ELBOW FIG. 356 (cont.)

SIZE	LIST PRICE EACH				QTY CARTON EACH	WGT PER 100
	ORDER QTY.	BLACK \$/EA.	ORDER QTY.	GALV. \$/EA.		
3	—	\$66.73	—	—	Bulk	644
3 1/2	—	\$148.04	—	—	Bulk	842
4	—	\$138.73	—	—	Bulk	1064
5	—	\$304.22	—	—	Bulk	1696
6	—	\$390.39	—	—	Bulk	2602
8	—	\$780.93	—	—	Bulk	5017



22 1/2° ELBOW FIG. 356A

SIZE	LIST PRICE EACH				QTY CARTON EACH	WGT PER 100
	ORDER QTY.	BLACK \$/EA.	ORDER QTY.	GALV. \$/EA.		
3/4	—	\$28.34	—	—	Bulk	52
1	—	\$28.92	—	—	Bulk	80
1 1/4	—	\$44.05	—	—	Bulk	140
1 1/2	—	\$59.05	—	—	Bulk	164
2	—	\$76.17	—	—	Bulk	250
2 1/2	—	\$104.21	—	—	Bulk	395



90° ELBOW,
REDUCING FIG. 352

SIZE	LIST PRICE EACH				QTY CARTON EACH	WGT PER 100
	ORDER QTY.	BLACK \$/EA.	ORDER QTY.	GALV. \$/EA.		
1/2 x 3/8	—	\$10.79	—	—	Bulk	34
1/2 x 1/4	—	\$8.60	—	—	Bulk	40
3/4 x 1/2	—	\$7.33	—	—	120	51
1 x 3/4	□ blk	\$6.13	—	—	70	76
1 x 1/2	□ blk	\$5.44	—	—	70	67
1 1/4 x 1	□ blk	\$7.71	—	—	40	121
1 1/4 x 3/4	□ blk	\$8.80	—	—	50	102
1 1/4 x 1/2	□ blk	\$8.65	—	—	55	107
1 1/2 x 1 1/4	□ blk	\$15.59	—	—	25	174
1 1/2 x 1	□ blk	\$14.24	—	—	30	144
1 1/2 x 3/4	□ blk	\$14.24	—	—	25	155
1 1/2 x 1/2	□ blk	\$15.28	—	—	25	153
2 x 1 1/2	□ blk	\$20.85	—	—	25	259
2 x 1 1/4	□ blk	\$22.30	—	—	25	233
2 x 1	—	\$20.85	—	—	Bulk	208
2 x 3/4	—	\$20.85	—	—	Bulk	220
2 x 1/2	—	\$23.77	—	—	Bulk	222
2 1/2 x 2	—	\$42.11	—	—	Bulk	401
2 1/2 x 1 1/2	—	\$47.50	—	—	Bulk	368
2 1/2 x 1 1/4	—	\$48.64	—	—	Bulk	341
2 1/2 x 1	—	\$48.64	—	—	Bulk	293
3 x 2 1/2	—	\$79.52	—	—	Bulk	644
3 x 2	—	\$73.25	—	—	Bulk	535
3 x 1 1/2	—	\$79.52	—	—	Bulk	565
3 x 1 1/4	—	\$79.52	—	—	Bulk	598

Weights are for Black Fittings.

For Galvanized, add 100% to the Black List Price unless the Galvanized List Price is listed.

□ - Sold in box only

CAST IRON FITTINGS

STANDARD SCREWED CAST IRON FITTINGS

90° ELBOW, REDUCING FIG. 352 (cont.)

SIZE	LIST PRICE EACH				QTY CARTON EACH	WGT PER 100
	ORDER QTY.	BLACK \$/EA.	ORDER QTY.	GALV. \$/EA.		
3½ x 3	—	\$96.43	—	—	Bulk	895
4 x 3	—	\$135.66	—	—	Bulk	1063
4 x 2½	—	\$135.66	—	—	Bulk	1127
4 x 2	—	\$135.66	—	—	Bulk	1189
5 x 4	—	\$303.62	—	—	Bulk	1647
6 x 5	—	\$402.06	—	—	Bulk	2666
6 x 4	—	\$402.06	—	—	Bulk	2353
6 x 3	—	\$402.06	—	—	Bulk	1943

45° REDUCING ELBOW

SIZE	LIST PRICE EACH				QTY CARTON EACH	WGT PER 100
	ORDER QTY.	BLACK \$/EA.	ORDER QTY.	GALV. \$/EA.		
1 x 1½	—	\$10.34	—	—	Bulk	95



TEE FIG. 358

SIZE	LIST PRICE EACH				QTY CARTON EACH	WGT PER 100
	ORDER QTY.	BLACK \$/EA.	ORDER QTY.	GALV. \$/EA.		
¼	—	\$8.61	—	—	Bulk	22
⅜	—	\$8.37	—	—	Bulk	35
½	—	\$5.44	—	—	100	56
¾	—	\$6.35	—	—	60	84
1	□ blk	\$5.64	—	—	30	125
1¼	□ blk	\$10.30	—	—	20	203
1½	□ blk	\$13.40	—	—	20	270
2	□ blk	\$18.65	—	—	10	423
2½	—	\$48.46	—	—	Bulk	667
3	—	\$74.36	—	—	Bulk	1000
3½	—	\$149.99	—	—	Bulk	1329
4	—	\$145.05	—	—	Bulk	1633
5	—	\$385.82	—	—	Bulk	2733
6	—	\$438.01	—	—	Bulk	4085
8	—	\$990.23	—	—	Bulk	7900

STANDARD SCREWED CAST IRON FITTINGS



TEE REDUCING FIG. 359

SIZE	LIST PRICE EACH				QTY CARTON EACH	WGT PER 100
	ORDER QTY.	BLACK \$/EA.	ORDER QTY.	GALV. \$/EA.		
½ x ½ x ⅜	—	\$11.31	—	—	Bulk	57
½ x ½ x ¼	—	\$13.05	—	—	Bulk	57
¾ x ¾ x ½	—	\$8.82	—	—	70	76
¾ x ¾ x ⅜	—	\$10.51	—	—	Bulk	75
¾ x ¾ x ¼	—	\$11.33	—	—	Bulk	62
¾ x ½ x ¾	—	\$10.24	—	—	Bulk	75
¾ x ½ x ½	—	\$10.24	—	—	Bulk	64
¾ x ¼ x ¾	—	\$14.59	—	—	Bulk	79
½ x ½ x ¾	—	\$10.24	—	—	Bulk	68
1 x 1 x ¾	—	\$7.65	—	—	45	111
1 x 1 x ½	□ blk	\$6.37	—	—	50	101
1 x 1 x ¼	—	\$12.77	—	—	Bulk	101
1 x ¾ x 1	—	\$8.52	—	—	Bulk	113
1 x ¾ x ¾	—	\$10.63	—	—	50	100
1 x ¾ x ½	—	\$11.59	—	—	Bulk	89
1 x ½ x 1	□ blk	\$8.41	—	—	45	108
1 x ½ x ¾	—	\$11.59	—	—	Bulk	91
1 x ½ x ½	—	\$12.71	—	—	Bulk	90
1 x ¼ x 1	—	\$13.25	—	—	Bulk	108
¾ x ¾ x 1	—	\$10.37	—	—	Bulk	99
½ x ½ x 1	—	\$11.79	—	—	Bulk	100
¼ x ¼ x 1	□ blk	\$10.19	—	—	20	173
¼ x ¼ x ¾	□ blk	\$11.05	—	—	25	157
¼ x ¼ x ½	□ blk	\$10.17	—	—	30	147
¼ x 1 x ¼	□ blk	\$11.24	—	—	20	179
¼ x 1 x 1	□ blk	\$10.19	—	—	20	153
¼ x 1 x ¾	—	\$11.66	—	—	30	136
¼ x 1 x ½	□ blk	\$10.31	—	—	35	127
¼ x ¾ x ¼	—	\$15.02	—	—	25	173
¼ x ¾ x 1	—	\$18.40	—	—	Bulk	143
¼ x ¾ x ¾	—	\$18.40	—	—	Bulk	127
¼ x ½ x ¼	—	\$15.73	—	—	25	164
¼ x ½ x 1	—	\$18.46	—	—	Bulk	138
¼ x ½ x ½	—	\$24.29	—	—	Bulk	100
1 x 1 x ¼	□ blk	\$12.20	—	—	20	149
½ x ½ x ¼	□ blk	\$18.88	—	—	25	244
½ x ½ x 1	□ blk	\$13.27	—	—	30	213
½ x ½ x ¾	□ blk	\$14.34	—	—	20	195
½ x ½ x ½	□ blk	\$13.27	—	—	20	184
½ x ¼ x ½	□ blk	\$18.88	—	—	10	250
½ x ¼ x ¼	□ blk	\$18.88	—	—	20	228
½ x ¼ x 1	□ blk	\$13.27	—	—	20	197
½ x ¼ x ¾	□ blk	\$15.18	—	—	20	179
½ x ¼ x ½	□ blk	\$14.34	—	—	25	167
½ x 1 x ½	□ blk	\$15.74	—	—	25	229
½ x 1 x ¼	—	\$21.85	—	—	Bulk	208
½ x 1 x 1	□ blk	\$18.88	—	—	20	172
½ x 1 x ¾	—	\$21.14	—	—	Bulk	170
½ x 1 x ½	—	\$21.85	—	—	Bulk	175
½ x ¾ x ½	—	\$20.57	—	—	Bulk	218
½ x ½ x ½	—	\$21.06	—	—	20	214
½ x ½ x ¼	—	\$23.93	—	—	Bulk	193

□ - Sold in box only

Weights are for Black Fittings.

For Galvanized, add 100% to the Black List Price unless the Galvanized List Price is listed.

CAST IRON FITTINGS

TEE REDUCING FIG. 359 (cont.)						TEE REDUCING FIG. 359 (cont.)					
SIZE	ORDER QTY.	LIST PRICE EACH		QTY CARTON EACH	WGT PER 100	SIZE	ORDER QTY.	LIST PRICE EACH		QTY CARTON EACH	WGT PER 100
		BLACK \$/EA.	ORDER QTY.					GALV. \$/EA.	BLACK \$/EA.		
1/4 x 1/4 x 1/2	☐ blk	\$18.88	—	20	229	2 x 1/2 x 2/2	—	\$55.00	—	Bulk	546
1/4 x 1 x 1/2	—	\$18.88	—	Bulk	207	2 x 1/4 x 2/2	—	\$63.70	—	Bulk	454
1 x 1 x 1/2	—	\$19.67	—	Bulk	184	2 x 1 x 2/2	—	\$63.70	—	Bulk	488
2 x 2 x 1/2	☐ blk	\$22.34	—	15	359	1/2 x 1/2 x 2/2	—	\$63.70	—	Bulk	415
2 x 2 x 1/4	☐ blk	\$21.13	—	15	338	3 x 3 x 2/2	—	\$95.76	—	Bulk	892
2 x 2 x 1	☐ blk	\$18.82	—	15	305	3 x 3 x 2	—	\$82.36	—	Bulk	775
2 x 2 x 3/4	☐ blk	\$18.82	—	20	286	3 x 3 x 1/2	—	\$95.76	—	Bulk	710
2 x 2 x 1/2	☐ blk	\$18.82	—	20	274	3 x 3 x 1/4	—	\$88.23	—	Bulk	675
2 x 1/2 x 2	☐ blk	\$25.67	—	15	370	3 x 3 x 1	—	\$80.64	—	Bulk	627
2 x 1/2 x 1/2	—	\$28.91	—	15	324	3 x 3 x 3/4	—	\$126.12	—	Bulk	606
2 x 1/2 x 1/4	—	\$29.48	—	Bulk	298	3 x 3 x 1/2	—	\$126.12	—	Bulk	608
2 x 1/2 x 1	☐ blk	\$18.82	—	20	266	3 x 2/2 x 3	—	\$95.76	—	Bulk	913
2 x 1/2 x 3/4	☐ blk	\$21.54	—	20	246	3 x 2/2 x 2/2	—	\$95.76	—	Bulk	766
2 x 1/2 x 1/2	☐ blk	\$21.54	—	25	234	3 x 2/2 x 2	—	\$95.76	—	Bulk	681
2 x 1/4 x 2	☐ blk	\$25.67	—	15	371	3 x 2/2 x 1/2	—	\$126.12	—	Bulk	623
2 x 1/4 x 1/2	—	\$33.95	—	Bulk	313	3 x 2/2 x 1/4	—	\$91.25	—	Bulk	592
2 x 1/4 x 1/4	—	\$29.51	—	Bulk	290	3 x 2/2 x 1	—	\$126.12	—	Bulk	551
2 x 1/4 x 1	—	\$33.15	—	Bulk	273	3 x 2 x 3	—	\$95.76	—	Bulk	879
2 x 1/4 x 3/4	—	\$37.55	—	Bulk	250	3 x 2 x 2/2	—	\$91.25	—	Bulk	710
2 x 1/4 x 1/2	—	\$33.95	—	Bulk	248	3 x 2 x 2	—	\$95.76	—	Bulk	729
2 x 1 x 2	☐ blk	\$29.73	—	15	346	3 x 2 x 1/2	—	\$95.76	—	Bulk	683
2 x 1 x 1/2	—	\$27.58	—	Bulk	285	3 x 1/2 x 3	—	\$95.76	—	Bulk	813
2 x 1 x 1/4	—	\$33.95	—	Bulk	294	3 x 1/4 x 3	—	\$95.76	—	Bulk	846
2 x 1 x 1	—	\$33.15	—	15	270	3 x 1 x 3	—	\$95.76	—	Bulk	830
2 x 3/4 x 2	—	\$26.94	—	15	331	3 x 3/4 x 3	—	\$98.09	—	Bulk	825
2 x 3/4 x 1/2	—	\$33.95	—	Bulk	340	3 x 1/2 x 3	—	\$117.32	—	Bulk	760
2 x 3/4 x 1/4	—	\$33.95	—	Bulk	250	2/2 x 2/2 x 3	—	\$95.76	—	Bulk	809
2 x 1/2 x 2	—	\$29.51	—	10	330	2/2 x 2 x 3	—	\$95.76	—	Bulk	735
2 x 1/2 x 1/2	—	\$33.95	—	Bulk	295	2 x 2 x 3	—	\$86.39	—	Bulk	787
1/2 x 1/2 x 2	☐ blk	\$20.65	—	10	323	3/2 x 3/2 x 2	—	\$218.59	—	Bulk	994
1/2 x 1/4 x 2	—	\$28.91	—	Bulk	307	3/2 x 3/2 x 1/2	—	\$218.59	—	Bulk	887
1/2 x 1 x 2	—	\$29.51	—	Bulk	291	4 x 4 x 3	—	\$186.74	—	Bulk	1412
1/4 x 1/4 x 2	—	\$29.33	—	Bulk	281	4 x 4 x 2/2	—	\$176.18	—	Bulk	1285
1/4 x 1 x 2	—	\$34.94	—	Bulk	266	4 x 4 x 2	—	\$168.64	—	Bulk	1163
1 x 1 x 2	—	\$37.55	—	Bulk	270	4 x 4 x 1/2	—	\$191.18	—	Bulk	1075
2/2 x 2/2 x 2	—	\$54.95	—	Bulk	588	4 x 4 x 1/4	—	\$209.51	—	Bulk	1038
2/2 x 2/2 x 1/2	—	\$56.26	—	Bulk	514	4 x 4 x 1	—	\$232.00	—	Bulk	1040
2/2 x 2/2 x 1/4	—	\$54.95	—	Bulk	483	4 x 4 x 3/4	—	\$251.79	—	Bulk	1058
2/2 x 2/2 x 1	—	\$53.89	—	Bulk	448	4 x 3 x 4	—	\$191.18	—	Bulk	1504
2/2 x 2/2 x 3/4	—	\$54.95	—	Bulk	429	4 x 3 x 3	—	\$251.79	—	Bulk	1250
2/2 x 2/2 x 1/2	—	\$61.07	—	Bulk	400	4 x 3 x 2/2	—	\$182.18	—	Bulk	1125
2/2 x 2 x 2/2	—	\$55.18	—	Bulk	600	4 x 3 x 2	—	\$195.84	—	Bulk	1021
2/2 x 2 x 2	—	\$56.26	—	Bulk	517	4 x 2/2 x 4	—	\$191.18	—	Bulk	1575
2/2 x 2 x 1/2	—	\$61.07	—	Bulk	442	4 x 2/2 x 2/2	—	\$234.23	—	Bulk	1178
2/2 x 2 x 1/4	—	\$63.70	—	Bulk	426	4 x 2 x 4	—	\$191.18	—	Bulk	1389
2/2 x 2 x 1	—	\$54.95	—	Bulk	392	4 x 2 x 2	—	\$195.84	—	Bulk	1134
2/2 x 2 x 3/4	—	\$53.89	—	Bulk	362	4 x 1/2 x 4	—	\$182.18	—	Bulk	1347
2/2 x 2 x 1/2	—	\$63.70	—	Bulk	357	4 x 1/4 x 4	—	\$182.18	—	Bulk	1435
2/2 x 1/2 x 2/2	—	\$63.70	—	Bulk	582	4 x 1 x 4	—	\$166.07	—	Bulk	1352
2/2 x 1/2 x 2	—	\$63.70	—	Bulk	485	3 x 3 x 4	—	\$228.64	—	Bulk	1280
2/2 x 1/2 x 1/2	—	\$63.70	—	Bulk	423	2/2 x 2/2 x 4	—	\$248.12	—	Bulk	1403
2/2 x 1/4 x 2/2	—	\$63.70	—	Bulk	540	5 x 5 x 4	—	\$419.32	—	Bulk	2383
2/2 x 1/4 x 2	—	\$63.70	—	Bulk	496	5 x 5 x 3	—	\$431.97	—	Bulk	2000
2/2 x 1 x 2/2	—	\$56.26	—	Bulk	536	5 x 5 x 2/2	—	\$419.32	—	Bulk	1884
2/2 x 1 x 2	—	\$63.70	—	Bulk	503	5 x 5 x 2	—	\$431.97	—	Bulk	1743
2/2 x 3/4 x 2/2	—	\$56.20	—	Bulk	510	4 x 4 x 5	—	\$431.97	—	Bulk	2088
2/2 x 1/2 x 2/2	—	\$57.53	—	Bulk	520	4 x 4 x 6	—	\$431.92	—	Bulk	2636
2 x 2 x 2/2	—	\$47.92	—	Bulk	517	6 x 6 x 5	—	\$539.07	—	Bulk	3700

Weights are for Black Fittings.

For Galvanized, add 100% to the Black List Price unless the Galvanized List Price is listed.

☐ - Sold in box only

CAST IRON FITTINGS

STANDARD SCREWED CAST IRON FITTINGS

TEE REDUCING FIG. 359 (cont.)

SIZE	LIST PRICE EACH				QTY CARTON EACH	WGT PER 100
	ORDER QTY.	BLACK \$/EA.	ORDER QTY.	GALV. \$/EA.		
6 x 6 x 4	—	\$555.32	—	—	Bulk	3244
6 x 6 x 3	—	\$539.07	—	—	Bulk	2746
6 x 6 x 2½	—	\$555.32	—	—	Bulk	2567
6 x 4 x 4	—	\$539.07	—	—	Bulk	3000



CROSS FIG. 360

SIZE	LIST PRICE EACH				QTY CARTON EACH	WGT PER 100
	ORDER QTY.	BLACK \$/EA.	ORDER QTY.	GALV. \$/EA.		
½	—	\$14.99	—	—	Bulk	280
¾	—	\$14.99	—	—	Bulk	103
1	—	\$17.45	—	—	Bulk	159
1¼	—	\$24.62	—	—	Bulk	242
1½	—	\$34.18	—	—	Bulk	321
2	—	\$45.26	—	—	Bulk	528
2½	—	\$105.98	—	—	Bulk	807
3	—	\$185.52	—	—	Bulk	1184
4	—	\$324.51	—	—	Bulk	1963
5	—	▲\$623.12	—	—	Bulk	3116
6	—	\$660.34	—	—	Bulk	4767



CROSS REDUCING FIG. 361

SIZE	LIST PRICE EACH				QTY CARTON EACH	WGT PER 100
	ORDER QTY.	BLACK \$/EA.	ORDER QTY.	GALV. \$/EA.		
1 x 1 x ¾ x ¾	—	\$23.77	—	—	Bulk	130
1¼ x 1¼ x 1 x 1	—	\$28.31	—	—	Bulk	204
1½ x 1½ x 1 x 1	—	\$33.67	—	—	Bulk	251
1½ x 1½ x 1¼ x 1¼	—	\$39.40	—	—	Bulk	395
1½ x 1½ x 1¼ x 1	—	\$53.70	—	—	Bulk	390
1½ x 1¼ x 1 x 1	—	\$39.40	—	—	Bulk	267
1½ x 1 x 1 x 1	—	\$45.75	—	—	Bulk	274
2 x 2 x 1¼ x 1¼	—	\$50.47	—	—	Bulk	400
2 x 2 x 1 x 1	—	\$46.08	—	—	Bulk	322
2 x 2 x 1½ x 1½	—	\$45.21	—	—	Bulk	408
2 x 1½ x 1¼ x 1¼	—	\$86.56	—	—	Bulk	418
2 x 1½ x 1¼ x 1	—	\$86.56	—	—	Bulk	425
2 x 1½ x 1 x 1	—	\$67.95	—	—	Bulk	357
2½ x 2½ x 2 x 2	—	\$121.12	—	—	Bulk	682
2½ x 2½ x 1½ x 1½	—	\$124.59	—	—	Bulk	568
2½ x 2½ x 1¼ x 1¼	—	\$135.22	—	—	Bulk	526

STANDARD SCREWED CAST IRON FITTINGS

CROSS REDUCING FIG. 361 (cont.)

SIZE	LIST PRICE EACH				QTY CARTON EACH	WGT PER 100
	ORDER QTY.	BLACK \$/EA.	ORDER QTY.	GALV. \$/EA.		
2½ x 2½ x 1¼ x 1	—	\$135.22	—	—	Bulk	539
2½ x 2½ x 1 x 1	—	\$124.59	—	—	Bulk	506
2½ x 2 x 2 x 2	—	\$135.22	—	—	Bulk	723
2½ x 2 x 1½ x 1½	—	\$135.22	—	—	Bulk	613
2½ x 2 x 1 x 1	—	\$135.22	—	—	Bulk	511
3 x 3 x 2 x 2	—	\$214.16	—	—	Bulk	885
3 x 3 x 1½ x 1½	—	\$214.16	—	—	Bulk	791
4 x 4 x 2 x 2	—	\$369.99	—	—	Bulk	1200



**FLANGED UNION
GASKET TYPE FIG. 487**

SIZE	LIST PRICE EACH				QTY CARTON EACH	WGT PER 100
	ORDER QTY.	BLACK \$/EA.	ORDER QTY.	GALV. \$/EA.		
½	—	\$46.83	—	\$107.00	Bulk	175
¾	—	\$61.76	—	▲\$129.59	Bulk	200
1	—	\$59.83	—	\$129.59	Bulk	225
1¼	—	\$70.78	—	▲\$162.27	Bulk	475
1½	—	\$65.32	—	▲\$189.38	Bulk	500
2	—	\$76.88	—	\$194.89	Bulk	650
2½	—	\$104.09	—	\$293.34	Bulk	850
3	—	\$117.75	—	\$388.89	Bulk	1100
3½	—	\$199.77	—	—	Bulk	1275
4	—	\$160.13	—	\$515.95	Bulk	1800
5	—	\$373.21	—	—	Bulk	2200
6	—	\$350.35	—	\$698.63	Bulk	3000
8	—	▲\$778.90	—	\$1,728.55	Bulk	5100



**SCREWED HEX
COUPLING FIG. 366**

SIZE	LIST PRICE EACH				QTY CARTON EACH	WGT PER 100
	ORDER QTY.	BLACK \$/EA.	ORDER QTY.	GALV. \$/EA.		
1	—	\$7.44	—	—	60	82

□ - Sold in box only

Weights are for Black Fittings.

▲ Extended lead times and or minimum order quantities

CAST IRON FITTINGS

STANDARD SCREWED CAST IRON FITTINGS



CONCENTRIC REDUCER FIG. 367

SIZE	LIST PRICE EACH				QTY CARTON EACH	WGT PER 100
	ORDER QTY.	BLACK \$/EA.	ORDER QTY.	GALV. \$/EA.		
3/4 x 1/2	—	\$9.76	—	—	Bulk	40
1 x 3/4 (Hex)	□ blk	\$6.60	—	—	70	63
1 x 1/2 (Hex)	□ blk	\$5.00	—	—	80	54
1 1/4 x 1	—	\$17.14	—	—	Bulk	107
1 1/4 x 3/4	□ blk	\$14.65	—	—	20	107
1 1/4 x 1/2	—	\$19.16	—	—	Bulk	84
1 1/2 x 1 1/4	—	\$24.27	—	—	Bulk	145
1 1/2 x 1	—	\$24.27	—	—	Bulk	150
1 1/2 x 3/4	—	\$27.09	—	—	Bulk	120
1 1/2 x 1/2	—	\$30.11	—	—	Bulk	100
2 x 1 1/2	—	\$31.72	—	—	Bulk	198
2 x 1 1/4	—	\$33.15	—	—	Bulk	178
2 x 1	—	\$28.26	—	—	Bulk	183
2 x 3/4	—	\$31.72	—	—	Bulk	190
2 x 1/2	—	\$35.23	—	—	Bulk	200
2 1/2 x 2	—	\$45.10	—	—	Bulk	298
2 1/2 x 1 1/2	—	\$50.16	—	—	Bulk	310
3 x 2 1/2	—	\$69.56	—	—	Bulk	440
3 x 2	—	\$55.27	—	—	Bulk	396
3 x 1 1/2	—	\$79.98	—	—	Bulk	435
3 x 3/4	—	\$75.96	—	—	Bulk	431
4 x 3	—	\$142.57	—	—	Bulk	701
4 x 2 1/2	—	\$142.57	—	—	Bulk	778
4 x 2	—	\$142.57	—	—	Bulk	650
5 x 4	—	\$195.51	—	—	Bulk	1048
6 x 5	—	\$226.04	—	—	Bulk	1553
6 x 4	—	\$258.39	—	—	Bulk	1383
8 x 6	—	\$1,125.50	—	—	Bulk	2910



ECCENTRIC REDUCER FIG. 368

SIZE	LIST PRICE EACH				QTY CARTON EACH	WGT PER 100
	ORDER QTY.	BLACK \$/EA.	ORDER QTY.	GALV. \$/EA.		
3/4 x 1/2	—	\$20.53	—	—	Bulk	45
1 x 3/4	—	\$22.17	—	—	Bulk	61
1 x 1/2	—	\$21.55	—	—	Bulk	57
1 1/4 x 1/2	—	\$35.42	—	—	Bulk	100
1 1/4 x 1	—	\$33.02	—	—	Bulk	100
1 1/4 x 3/4	—	\$32.09	—	—	Bulk	90
1 1/2 x 1 1/4	—	\$44.78	—	—	Bulk	126
1 1/2 x 1	—	\$46.83	—	—	Bulk	121
1 1/2 x 3/4	—	\$46.83	—	—	Bulk	117
1 1/2 x 1/2	—	\$44.60	—	—	Bulk	111
2 x 1 1/2	—	\$59.37	—	—	Bulk	193
2 x 1 1/4	—	\$58.20	—	—	Bulk	187
2 x 1	—	\$61.11	—	—	Bulk	186
2 x 3/4	—	\$65.60	—	—	Bulk	183
2 x 1/2	—	\$58.20	—	—	Bulk	180
2 1/2 x 2	—	\$88.17	—	—	Bulk	295

STANDARD SCREWED CAST IRON FITTINGS

ECCENTRIC REDUCER FIG. 368 (cont.)

SIZE	LIST PRICE EACH				QTY CARTON EACH	WGT PER 100
	ORDER QTY.	BLACK \$/EA.	ORDER QTY.	GALV. \$/EA.		
2 1/2 x 1 1/2	—	\$90.28	—	—	Bulk	294
2 1/2 x 1 1/4	—	\$90.28	—	—	Bulk	280
2 1/2 x 1	—	\$90.28	—	—	Bulk	274
3 x 2 1/2	—	\$131.37	—	—	Bulk	480
3 x 2	—	\$109.31	—	—	Bulk	461
3 x 1 1/2	—	\$121.45	—	—	Bulk	416
3 x 1 1/4	—	\$142.57	—	—	Bulk	380
3 x 1	—	\$142.57	—	—	Bulk	395
3 1/2 x 2	—	\$198.03	—	—	Bulk	523
4 x 3	—	\$257.20	—	—	Bulk	764
4 x 2 1/2	—	\$257.20	—	—	Bulk	726
4 x 2	—	\$257.20	—	—	Bulk	691
4 x 1 1/2	—	\$239.26	—	—	Bulk	661
4 x 1 1/4	—	\$257.20	—	—	Bulk	658
5 x 4	—	\$314.63	—	—	Bulk	1119
5 x 3	—	\$292.68	—	—	Bulk	1144
5 x 2 1/2	—	\$292.68	—	—	Bulk	1138
6 x 4	—	\$398.90	—	—	Bulk	1536
6 x 3	—	\$398.90	—	—	Bulk	1466



HEX BUSHING FIG. 383

SIZE	LIST PRICE EACH				QTY CARTON EACH	WGT PER 100
	ORDER QTY.	BLACK \$/EA.	ORDER QTY.	GALV. \$/EA.		
1 1/2 x 1	□ blk	\$4.78	□ galv	\$9.35	25	50
1 1/2 x 3/4	□ blk	\$5.44	□ galv	\$10.36	25	47
1 1/2 x 1/2	□ blk	\$5.44	—	\$10.36	25	42
1 1/2 x 3/8	—	\$8.11	—	\$13.32	25	47
1 1/2 x 1/4	—	\$7.16	—	\$13.32	25	47
2 x 1 1/4	□ blk	\$6.54	□ galv	\$12.08	15	81
2 x 1	□ blk	\$6.54	□ galv	\$12.08	15	73
2 x 3/4	□ blk	\$6.84	□ galv	\$12.08	15	71
2 x 1/2	□ blk	\$8.64	□ galv	\$13.00	15	70
2 x 3/8	—	\$9.71	—	\$15.45	15	75
2 x 1/4	—	\$7.71	—	\$15.08	15	75
2 1/2 x 1 1/2	—	\$10.45	—	\$19.79	Bulk	129
2 1/2 x 1 1/4	—	\$12.02	—	\$21.98	Bulk	124
2 1/2 x 1	—	\$12.02	—	\$21.98	Bulk	116
2 1/2 x 3/4	—	\$12.02	—	\$21.98	Bulk	125
2 1/2 x 1/2	—	\$11.20	—	\$21.98	Bulk	128
3 x 2 1/2	—	\$14.07	—	\$24.21	Bulk	163
3 x 2	—	\$12.13	—	▲\$22.55	Bulk	190
3 x 1 1/2	—	\$16.25	—	\$26.10	Bulk	179
3 x 1 1/4	—	\$16.25	—	\$28.32	Bulk	177
3 x 1	—	\$16.25	—	\$29.00	Bulk	190
3 x 3/4	—	\$17.66	—	\$29.00	Bulk	192
3 x 1/2	—	\$18.08	—	\$29.00	Bulk	193
3 1/2 x 3	—	\$28.48	—	\$51.49	Bulk	196
3 1/2 x 2 1/2	—	\$31.62	—	\$51.49	Bulk	256
3 1/2 x 2	—	\$30.88	—	\$51.49	Bulk	242
3 1/2 x 1 1/2	—	\$31.62	—	\$51.49	Bulk	323
3 1/2 x 1 1/4	—	\$31.62	—	\$47.01	Bulk	254

Weights are for Black Fittings.

▲ Extended lead times and or minimum order quantities

For Galvanized, add 100% to the Black List Price unless the Galvanized List Price is listed.

□ - Sold in box only

CAST IRON FITTINGS

STANDARD SCREWED CAST IRON FITTINGS

HEX BUSHING FIG. 383 (cont.)

SIZE	LIST PRICE EACH				QTY CARTON EACH	WGT PER 100
	ORDER QTY.	BLACK \$/EA.	ORDER QTY.	GALV. \$/EA.		
3½ x 1	—	\$31.62	—	\$47.01	Bulk	265
4 x 3½	—	\$36.81	—	\$60.78	Bulk	250
4 x 3	□ blk	\$27.37	—	\$47.34	25	315
4 x 2½	—	\$33.12	—	\$60.78	Bulk	329
4 x 2	□ blk	\$27.37	—	\$47.34	20	311
4 x 1½	—	\$33.90	—	\$60.78	Bulk	344
4 x 1¼	—	\$36.81	—	\$60.78	Bulk	354
4 x 1	—	\$36.81	—	\$60.78	Bulk	359
5 x 4	—	\$55.73	—	\$100.36	Bulk	394
5 x 3½	—	\$58.21	—	—	Bulk	400
5 x 3	—	\$57.39	—	\$102.75	Bulk	483
5 x 2½	—	\$63.78	—	\$93.80	Bulk	487
5 x 2	—	\$63.78	—	\$102.75	Bulk	512
6 x 5	—	\$65.79	—	\$116.26	Bulk	524
6 x 4	—	\$56.95	—	\$109.67	Bulk	683
6 x 3	—	\$65.80	—	\$116.26	Bulk	775
6 x 2½	—	\$73.12	—	—	Bulk	772
6 x 2	—	\$65.80	—	\$116.26	Bulk	800
8 x 6	—	\$123.97	—	\$202.66	Bulk	1319
8 x 5	—	\$128.12	—	—	Bulk	1365
8 x 4	—	\$137.73	—	—	Bulk	1393
8 x 3	—	\$164.73	—	—	Bulk	1550
10 x 8	—	\$508.01	—	—	Bulk	2200
10 x 6	—	\$503.19	—	—	Bulk	2450



FACE BUSHING FIG. 385

SIZE	LIST PRICE EACH				QTY CARTON EACH	WGT PER 100
	ORDER QTY.	BLACK \$/EA.	ORDER QTY.	GALV. \$/EA.		
3 x 2	—	\$35.82	—	—	Bulk	1330
4 x 3	—	▲\$68.15	—	—	Bulk	1920
4 x 2½	—	\$62.20	—	—	Bulk	2550



SQUARE HEAD PLUGS,
CORED FIG. 387

SIZE	LIST PRICE EACH				QTY CARTON EACH	WGT PER 100
	ORDER QTY.	BLACK \$/EA.	ORDER QTY.	GALV. \$/EA.		
½	—	—	—	\$12.78	381	10
¾	□ blk	\$1.75	—	\$3.55	120	13
1	□ blk	\$1.75	□ galv	\$3.55	60	25
1¼	□ blk	\$2.80	□ galv	\$5.91	30	39
1½	□ blk	\$3.96	□ galv	\$7.98	25	50
2	□ blk	\$4.62	□ galv	\$9.90	15	82
2½	—	\$11.24	—	\$20.95	Bulk	132
3	□ blk	\$13.03	—	\$26.84	25	187
3½	—	\$31.77	—	\$49.00	Bulk	250
4	—	\$26.32	—	\$71.62	Bulk	400

STANDARD SCREWED CAST IRON FITTINGS



SQUARE HEAD PLUGS,
SOLID FIG. 388

SIZE	LIST PRICE EACH				QTY CARTON EACH	WGT PER 100
	ORDER QTY.	BLACK \$/EA.	ORDER QTY.	GALV. \$/EA.		
½	□ blk	\$1.55	—	\$3.27	150	10
¾	—	\$4.69	—	\$9.38	120	17
1	□ blk	\$5.00	—	\$10.63	60	32
1¼	—	\$5.75	—	\$11.58	30	53
1½	—	\$8.15	—	\$15.45	25	76
2	—	\$10.53	—	\$22.02	15	123
2½	—	\$15.56	—	\$28.33	Bulk	200
3	—	\$26.55	—	\$49.99	Bulk	318
3½	—	\$61.03	—	—	Bulk	438



BAR PLUGS, CORED FIG. 389

SIZE	LIST PRICE EACH				QTY CARTON EACH	WGT PER 100
	ORDER QTY.	BLACK \$/EA.	ORDER QTY.	GALV. \$/EA.		
4	—	\$26.82	—	\$52.05	Bulk	382
5	—	\$50.43	—	\$103.48	Bulk	650
6	—	\$65.84	—	\$117.71	Bulk	994
8	—	\$143.72	—	\$265.37	Bulk	2026



BAR PLUGS, SOLID FIG. 380

SIZE	LIST PRICE EACH				QTY CARTON EACH	WGT PER 100
	ORDER QTY.	BLACK \$/EA.	ORDER QTY.	GALV. \$/EA.		
4	—	\$59.06	—	—	Bulk	568
5	—	▲\$109.74	—	—	Bulk	960
6	—	\$131.11	—	—	Bulk	1478



COUNTER SUNK PLUGS FIG. 390

SIZE	LIST PRICE EACH				QTY CARTON EACH	WGT PER 100
	ORDER QTY.	BLACK \$/EA.	ORDER QTY.	GALV. \$/EA.		
1	—	\$6.04	—	\$11.24	60	20
1¼	—	\$6.32	—	\$11.89	30	32
1½	—	\$7.57	—	\$15.97	25	47
2	—	\$11.17	—	\$22.35	15	84
2½	—	\$17.66	—	—	Bulk	140
3	—	\$28.83	—	—	Bulk	225
3½	—	\$50.00	—	—	Bulk	302
4	—	\$77.72	—	—	Bulk	376

□ - Sold in box only

Weights are for Black Fittings.

▲ Extended lead times and or minimum order quantities

CAST IRON FITTINGS

STANDARD SCREWED CAST IRON FITTINGS



CAP FIG. 381

SIZE	LIST PRICE EACH				QTY CARTON EACH	WGT PER 100
	ORDER QTY.	BLACK \$/EA.	ORDER QTY.	GALV. \$/EA.		
2½	—	\$29.89	—	—	Bulk	255
3	—	\$39.33	—	—	Bulk	410
4	—	\$56.57	—	—	Bulk	640
5	—	\$86.15	—	—	Bulk	1070
6	—	\$107.91	—	\$404.08	Bulk	1420
8	—	\$297.51	—	\$549.76	Bulk	2723



LOCKNUT FIG. 370

SIZE	LIST PRICE EACH				QTY CARTON EACH	WGT PER 100
	ORDER QTY.	BLACK \$/EA.	ORDER QTY.	GALV. \$/EA.		
2½	—	\$19.62	—	—	Bulk	113
3	—	\$25.67	—	—	Bulk	160
4	—	\$38.90	—	—	Bulk	350



**FLOOR FLANGE
FIG. 1006**

SIZE	LIST PRICE EACH				QTY CARTON EACH	WGT PER 100
	ORDER QTY.	BLACK \$/EA.	ORDER QTY.	GALV. \$/EA.		
¼	—	\$8.22	—	\$21.29	Bulk	39
⅜	—	\$8.22	—	\$16.56	Bulk	43
½	—	\$9.01	—	\$21.26	90	73
¾	—	\$9.01	—	\$21.26	90	80
1	—	\$11.31	—	\$19.40	60	113
1¼	—	\$11.31	—	\$25.79	50	114
1½	—	\$14.56	—	\$33.06	35	155
2	—	\$17.51	—	\$41.97	Bulk	240

STANDARD SCREWED CAST IRON FITTINGS X.H. STANDARD SCREWED C.I. FITTINGS



X. H. 90° ELBOW FIG. 421

SIZE	LIST PRICE EACH				QTY CARTON EACH	WGT PER 100
	ORDER QTY.	BLACK \$/EA.	ORDER QTY.	GALV. \$/EA.		
¼	—	\$19.32	—	—	Bulk	37
½	—	\$17.31	—	—	Bulk	75
¾	—	\$18.29	—	—	Bulk	113
1	—	\$22.13	—	—	Bulk	179
1¼	—	\$32.94	—	—	Bulk	300
1½	—	\$40.87	—	—	Bulk	405
2	—	\$50.43	—	—	Bulk	676
2½	—	\$117.95	—	—	Bulk	1056
3	—	\$155.79	—	—	Bulk	1525
4	—	\$326.31	—	—	Bulk	2615



X. H. 45° ELBOW FIG. 424

SIZE	LIST PRICE EACH				QTY CARTON EACH	WGT PER 100
	ORDER QTY.	BLACK \$/EA.	ORDER QTY.	GALV. \$/EA.		
½	—	\$24.68	—	—	Bulk	66
¾	—	\$23.83	—	—	Bulk	104
1	—	\$28.59	—	—	Bulk	156
1¼	—	\$47.13	—	—	Bulk	270
1½	—	\$51.85	—	—	Bulk	355
2	—	\$73.74	—	—	Bulk	607
2½	—	\$127.33	—	—	Bulk	979



X. H. TEE FIG.425

SIZE	LIST PRICE EACH				QTY CARTON EACH	WGT PER 100
	ORDER QTY.	BLACK \$/EA.	ORDER QTY.	GALV. \$/EA.		
¼	—	\$28.47	—	—	Bulk	47
⅜	—	\$28.47	—	—	Bulk	70
½	—	\$27.31	—	—	Bulk	120
¾	—	\$27.28	—	—	Bulk	157
1	—	\$32.94	—	—	Bulk	243
1¼	—	\$49.12	—	—	Bulk	394
1½	—	\$63.19	—	—	Bulk	531
2	—	\$78.42	—	—	Bulk	901
2½	—	\$167.33	—	—	Bulk	1423
3	—	\$228.22	—	—	Bulk	2095
4	—	\$443.03	—	—	Bulk	3398

Weights are for Black Fittings.

▲ Extended lead times and or minimum order quantities

For Galvanized, add 100% to the Black List Price unless the Galvanized List Price is listed.

☐ - Sold in box only

CAST IRON FITTINGS

STANDARD SCREWED CAST IRON FITTINGS X.H. STANDARD SCREWED C.I. FITTINGS



X. H. REDUCING TEE FIG. 426

SIZE	ORDER QTY.	LIST PRICE EACH		GALV. \$/EA.	QTY CARTON EACH	WGT PER 100
		BLACK \$/EA.	ORDER QTY.			
3/4 x 3/4 x 1/2	—	\$48.61	—	—	Bulk	137
1 x 1 x 3/4	—	\$49.38	—	—	Bulk	219
1 x 1 x 1/2	—	\$57.97	—	—	Bulk	203
1/4 x 1/4 x 1	—	\$77.10	—	—	Bulk	349
1/4 x 1/4 x 3/4	—	\$65.68	—	—	Bulk	321
1/2 x 1/2 x 1	—	\$97.56	—	—	Bulk	498
1/2 x 1/2 x 1	—	\$97.56	—	—	Bulk	426
1/2 x 1/2 x 3/4	—	\$97.56	—	—	Bulk	402
2 x 2 x 1/2	—	\$132.65	—	—	Bulk	769
2 x 2 x 1/4	—	\$132.65	—	—	Bulk	711
2 x 2 x 1	—	\$113.00	—	—	Bulk	657
2 x 2 x 3/4	—	\$107.59	—	—	Bulk	624

CAST IRON DRAINAGE

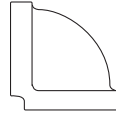

90° SHORT TURN ELBOW FIG. 701*

SIZE	LIST PRICE EACH				QTY CARTON EACH	WGT PER 100
	ORDER QTY.	UNFINISHED \$/EA.	ORDER QTY.	GALV. \$/EA.		
1 1/2	—	\$20.98	—	\$29.38	—	191
2	—	\$31.57	—	\$42.44	—	304
3	—	\$118.62	—	\$167.79	—	709
4	—	\$187.86	—	\$326.54	—	1369

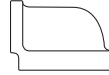

90° REDUCING SHORT TURN ELBOW FIG. 701R*

SIZE	LIST PRICE EACH				QTY CARTON EACH	WGT PER 100
	ORDER QTY.	UNFINISHED \$/EA.	ORDER QTY.	GALV. \$/EA.		
1 1/2 x 1 1/4	—	\$36.76	—	—	—	169
2 x 1 1/2	—	\$42.90	—	—	—	249

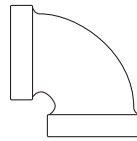

90° LONG TURN ELBOW FIG. 702*

SIZE	LIST PRICE EACH				QTY CARTON EACH	WGT PER 100
	ORDER QTY.	UNFINISHED \$/EA.	ORDER QTY.	GALV. \$/EA.		
1 1/2	—	\$29.34	—	\$33.40	—	224
2	—	\$43.69	—	\$57.34	—	361
3	—	\$27.80	—	—	—	904
4	—	\$264.64	—	—	—	1640

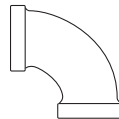

90° EXTRA LONG TURN ELBOW FIG. 702A*

SIZE	LIST PRICE EACH				QTY CARTON EACH	WGT PER 100
	ORDER QTY.	UNFINISHED \$/EA.	ORDER QTY.	GALV. \$/EA.		
1 1/2	—	\$37.89	—	—	—	262
2	—	\$65.53	—	—	—	454

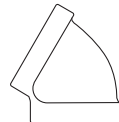

60° SHORT TURN ELBOW FIG. 703

SIZE	LIST PRICE EACH				QTY CARTON EACH	WGT PER 100
	ORDER QTY.	UNFINISHED \$/EA.	ORDER QTY.	GALV. \$/EA.		
1 1/2	—	\$37.97	—	—	—	234

□ - Sold in box only

* Tapped Pitched 1/4" to foot Weights are for Black or Unfinished Fittings.

▲ Extended lead times and or minimum order quantities

For Galvanized, add 100% to the Black List Price unless the Galvanized List Price is listed.

CAST IRON FITTINGS

CAST IRON DRAINAGE

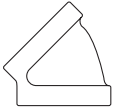

45° SHORT TURN ELBOW FIG. 705

SIZE	LIST PRICE EACH				QTY CARTON EACH	WGT PER 100
	ORDER QTY.	UNFINISHED \$/EA.	ORDER QTY.	GALV. \$/EA.		
1½	—	\$20.50	—	\$29.04	—	171
2	—	\$29.59	—	\$41.55	—	279
3	—	\$115.90	—	\$144.59	—	631
4	—	\$181.16	—	\$236.28	—	1144

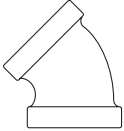

45° LONG TURN ELBOW FIG. 706

SIZE	LIST PRICE EACH				QTY CARTON EACH	WGT PER 100
	ORDER QTY.	UNFINISHED \$/EA.	ORDER QTY.	GALV. \$/EA.		
1½	—	\$28.80	—	\$33.05	—	214

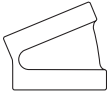

22½° ELBOW FIG. 707

SIZE	LIST PRICE EACH				QTY CARTON EACH	WGT PER 100
	ORDER QTY.	UNFINISHED \$/EA.	ORDER QTY.	GALV. \$/EA.		
1½	—	\$25.84	—	\$31.50	—	165
2	—	\$34.43	—	\$47.09	—	165



11¼° ELBOW FIG. 708

SIZE	LIST PRICE EACH				QTY CARTON EACH	WGT PER 100
	ORDER QTY.	UNFINISHED \$/EA.	ORDER QTY.	GALV. \$/EA.		
1½	—	\$27.50	—	—	—	181
2	—	\$49.80	—	—	—	269

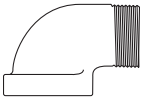

90° STREET ELBOW FIG. 718*

SIZE	LIST PRICE EACH				QTY CARTON EACH	WGT PER 100
	ORDER QTY.	UNFINISHED \$/EA.	ORDER QTY.	GALV. \$/EA.		
1½	—	\$29.89	—	\$37.19	—	205
2	—	▲\$39.57	—	\$58.28	—	310

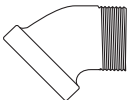

45° STREET ELBOW FIG. 719

SIZE	LIST PRICE EACH				QTY CARTON EACH	WGT PER 100
	ORDER QTY.	UNFINISHED \$/EA.	ORDER QTY.	GALV. \$/EA.		
1½	—	\$27.93	—	\$38.50	—	164
2	—	\$45.19	—	\$59.24	—	267

CAST IRON DRAINAGE

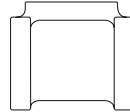

TEE FIG. 722*

SIZE	LIST PRICE EACH				QTY CARTON EACH	WGT PER 100
	ORDER QTY.	UNFINISHED \$/EA.	ORDER QTY.	GALV. \$/EA.		
1½	—	\$34.46	—	\$44.16	—	259
2	—	\$56.97	—	\$73.90	—	466

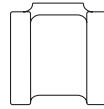

REDUCING TEE FIG. 723*

SIZE	LIST PRICE EACH				QTY CARTON EACH	WGT PER 100
	ORDER QTY.	UNFINISHED \$/EA.	ORDER QTY.	GALV. \$/EA.		
2 x 2 x 1½	—	\$64.86	—	—	—	377

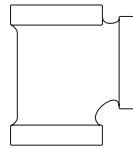

**90° SHORT TURN
Y-BRANCH TEE PATTERN FIG. 726**

SIZE	LIST PRICE EACH				QTY CARTON EACH	WGT PER 100
	ORDER QTY.	UNFINISHED \$/EA.	ORDER QTY.	GALV. \$/EA.		
1½	—	\$33.83	—	\$44.69	—	309
2	—	\$55.77	—	\$73.05	—	508
3	—	\$199.46	—	\$283.22	—	1177
4	—	\$304.26	—	\$352.59	—	2125

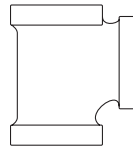

**90° REDUCING SHORT TURN
Y-BRANCH TEE PATTERN FIG 727***

SIZE	LIST PRICE EACH				QTY CARTON EACH	WGT PER 100
	ORDER QTY.	UNFINISHED \$/EA.	ORDER QTY.	GALV. \$/EA.		
2 x 2 x 1½	—	\$57.34	—	—	—	416
2 x 1½ x 1½	—	\$57.34	—	—	—	433

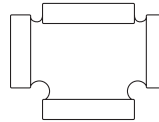

**90° REDUCING SHORT TURN
Y-BRANCH TEE PATTERN FIG. 729***

SIZE	LIST PRICE EACH				QTY CARTON EACH	WGT PER 100
	ORDER QTY.	UNFINISHED \$/EA.	ORDER QTY.	GALV. \$/EA.		
2 x 1½	—	\$85.19	—	—	—	582

* Tapped Pitched ¼" to foot. Weights are for Black or Unfinished Fittings.

▲ Extended lead times and or minimum order quantities

For Galvanized, add 100% to the Black List Price unless the Galvanized List Price is listed.

□ - Sold in box only

CAST IRON FITTINGS

CAST IRON DRAINAGE

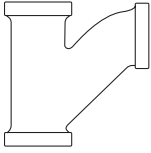

**90° LONG TURN
Y-BRANCH TEE PATTERN FIG. 730***

SIZE	LIST PRICE EACH				QTY CARTON EACH	WGT PER 100
	ORDER QTY.	UNFINISHED \$/EA.	ORDER QTY.	GALV. \$/EA.		
1½	—	\$56.55	—	—	—	443
2	—	\$88.17	—	\$134.68	—	669

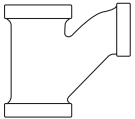

**90° REDUCING LONG TURN
Y-BRANCH TEE PATTERN FIG. 731***

SIZE	LIST PRICE EACH				QTY CARTON EACH	WGT PER 100
	ORDER QTY.	UNFINISHED \$/EA.	ORDER QTY.	GALV. \$/EA.		
2 x 2 x 1½	—	\$92.54	—	—	—	523

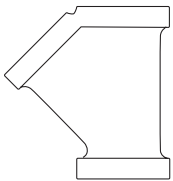

45° Y-BRANCH FIG. 734

SIZE	LIST PRICE EACH				QTY CARTON EACH	WGT PER 100
	ORDER QTY.	UNFINISHED \$/EA.	ORDER QTY.	GALV. \$/EA.		
1½	—	\$41.44	—	\$49.58	—	403
2	—	\$77.29	—	\$99.38	—	556
3	—	\$259.23	—	\$342.74	—	1200
4	—	\$397.74	—	\$540.71	—	2451

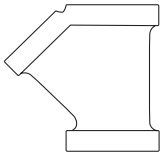

**45° REDUCING
Y-BRANCH FIG. 735**

SIZE	LIST PRICE EACH				QTY CARTON EACH	WGT PER 100
	ORDER QTY.	UNFINISHED \$/EA.	ORDER QTY.	GALV. \$/EA.		
2 x 2 x 1½	—	\$76.42	—	\$106.93	—	483
4 x 4 x 3	—	\$415.35	—	—	—	2063

CAST IRON DRAINAGE

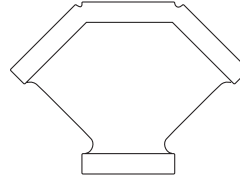

**45° DOUBLE
Y-BRANCH FIG. 736**

SIZE	LIST PRICE EACH				QTY CARTON EACH	WGT PER 100
	ORDER QTY.	UNFINISHED \$/EA.	ORDER QTY.	GALV. \$/EA.		
1½	—	\$100.47	—	—	—	509



COUPLING FIG. 753

SIZE	LIST PRICE EACH				QTY CARTON EACH	WGT PER 100
	ORDER QTY.	UNFINISHED \$/EA.	ORDER QTY.	GALV. \$/EA.		
1½	—	\$69.96	—	\$63.46	—	175

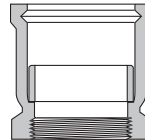

TUCKER CONNECTION FIG. 744

SIZE	LIST PRICE EACH				QTY CARTON EACH	WGT PER 100
	ORDER QTY.	UNFINISHED \$/EA.	ORDER QTY.	GALV. \$/EA.		
1½	—	\$57.79	—	—	—	404
2	—	\$71.08	—	—	—	540
4	—	\$284.49	—	—	—	2000

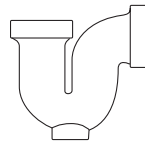

P-TRAP FIG. 752

SIZE	LIST PRICE EACH				QTY CARTON EACH	WGT PER 100
	ORDER QTY.	UNFINISHED \$/EA.	ORDER QTY.	GALV. \$/EA.		
1½	—	\$61.57	—	\$80.18	—	469
2	—	\$98.57	—	\$140.35	—	718
3	—	\$309.81	—	\$431.11	—	1687
4	—	\$741.46	—	\$1,061.29	—	3057

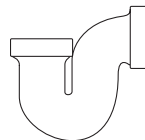

BATH P-TRAP FIG. 754

SIZE	LIST PRICE EACH				QTY CARTON EACH	WGT PER 100
	ORDER QTY.	UNFINISHED \$/EA.	ORDER QTY.	GALV. \$/EA.		
1½	—	\$63.34	—	—	—	387
2	—	\$101.40	—	—	—	625

□ - Sold in box only

* Tapped Pitched ¼" to foot Weights are for Black or Unfinished Fittings.

▲ Extended lead times and or minimum order quantities

For Galvanized, add 100% to the Black List Price unless the Galvanized List Price is listed.

CAST IRON FITTINGS

CAST IRON FLANGED, STANDARD

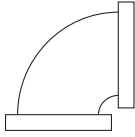

90° FLANGED ELBOW FIG. 801

SIZE	LIST PRICE EACH				QTY CARTON EACH	WGT PER 100
	ORDER QTY.	BLACK \$/EA.	ORDER QTY.	GALV. \$/EA.		
1½	—	\$301.04	—	—	Bulk	900
2	—	\$183.58	—	▲\$360.12	Bulk	1400
2½	—	\$198.59	—	\$492.62	Bulk	1900
3	—	\$165.75	—	\$485.61	Bulk	2400
3½	—	▲\$460.69	—	—	Bulk	3100
4	—	\$205.00	—	\$442.71	Bulk	4100
5	—	\$485.50	—	\$933.12	Bulk	5200
6	—	▲\$320.95	—	\$712.77	Bulk	6800
8	—	\$554.20	—	\$1,110.26	Bulk	11000
10	—	\$1,214.64	—	\$2,054.52	Bulk	175000
12	—	\$2,445.15	—	\$3,428.30	Bulk	25000



45° FLANGED ELBOW FIG. 802

SIZE	LIST PRICE EACH				QTY CARTON EACH	WGT PER 100
	ORDER QTY.	BLACK \$/EA.	ORDER QTY.	GALV. \$/EA.		
1½	—	▲\$363.49	—	—	Bulk	800
2	—	\$266.01	—	—	Bulk	1200
2½	—	\$283.74	—	—	Bulk	1700
3	—	\$275.92	—	\$265.62	Bulk	2000
4	—	\$310.56	—	\$639.20	Bulk	3600
5	—	\$744.17	—	—	Bulk	4500
6	—	\$507.74	—	\$891.66	Bulk	6000
8	—	\$742.47	—	\$1,337.35	Bulk	9400
10	—	\$1,568.85	—	\$2,559.54	Bulk	14500
12	—	\$2,397.20	—	\$3,909.45	Bulk	22000

CAST IRON FLANGED, STANDARD

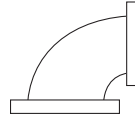

**90° REDUCING FLANGED
ELBOW FIG. 803**

SIZE	LIST PRICE EACH				QTY CARTON EACH	WGT PER 100
	ORDER QTY.	BLACK \$/EA.	ORDER QTY.	GALV. \$/EA.		
2½ x 2	—	\$583.92	—	—	Bulk	1800
3 x 2½	—	\$614.09	—	—	Bulk	2200
3 x 2	—	\$562.94	—	—	Bulk	1900
4 x 3	—	\$454.77	—	—	Bulk	3300
4 x 2½	—	\$695.06	—	—	Bulk	3100
4 x 2	—	\$695.06	—	—	Bulk	2900
5 x 4	—	\$890.95	—	—	Bulk	4800
5 x 3	—	\$940.23	—	—	Bulk	4000
6 x 5	—	\$958.10	—	—	Bulk	6000
6 x 4	—	\$563.96	—	—	Bulk	5600
6 x 3	—	\$1,001.65	—	—	Bulk	4700
8 x 6	—	\$822.82	—	—	Bulk	9000
8 x 5	—	\$1,465.80	—	—	Bulk	8200
8 x 4	—	\$1,109.58	—	—	Bulk	7700
10 x 8	—	\$1,566.69	—	—	Bulk	15000
10 x 6	—	\$2,288.56	—	—	Bulk	12500
12 x 10	—	\$3,002.30	—	—	Bulk	22000
12 x 8	—	\$3,967.42	—	—	Bulk	19000
12 x 6	—	\$4,186.90	—	—	Bulk	16500



**90° REDUCING
LONG RADIUS ELBOW FIG. 804**

SIZE	LIST PRICE EACH				QTY CARTON EACH	WGT PER 100
	ORDER QTY.	BLACK \$/EA.	ORDER QTY.	GALV. \$/EA.		
2	—	\$494.41	—	—	Bulk	1600
2½	—	\$516.92	—	—	Bulk	2300
3	—	\$534.07	—	—	Bulk	2800
4	—	\$489.81	—	—	Bulk	4800
5	—	930.92	—	—	Bulk	6200
6	—	\$708.47	—	—	Bulk	8500
8	—	\$1,361.77	—	—	Bulk	14500
10	—	\$2,119.87	—	—	Bulk	23000
12	—	\$4,368.09	—	—	Bulk	35000

For Galvanized, add 100% to the Black List Price unless the Galvanized List Price is listed.

☐ - Sold in box only

Weights are for Black Fittings. ▲ Extended lead times and or minimum order quantities

* Faced only, Not Stocked. Galvanized Fittings Not Stocked in all types and sizes, but may be produced to order.

CAST IRON FITTINGS

CAST IRON FLANGED, STANDARD



**90° FLANGED LONG RADIUS
REDUCING ELBOW FIG. 804R**

SIZE	LIST PRICE EACH				QTY CARTON EACH	WGT PER 100
	ORDER QTY.	BLACK \$/EA.	ORDER QTY.	GALV. \$/EA.		
4 x 3	—	\$1,165.86	—	—	Bulk	4600
5 x 4	—	\$1,314.25	—	—	Bulk	5800
6 x 5	—	\$1,613.83	—	—	Bulk	8100
6 x 4	—	\$1,521.72	—	—	Bulk	7800
8 x 6	—	\$2,812.77	—	—	Bulk	13000
10 x 8	—	\$4,677.20	—	—	Bulk	20500



**90° FLANGED BASE ELBOW
FIG. 805**

SIZE	LIST PRICE EACH				QTY CARTON EACH	WGT PER 100
	ORDER QTY.	BLACK \$/EA.	ORDER QTY.	GALV. \$/EA.		
3	—	\$832.76	—	—	Bulk	3600
4	—	\$796.53	—	—	Bulk	5900
6	—	\$1,357.11	—	—	Bulk	11000
8	—	\$1,798.52	—	—	Bulk	15800
10	—	\$3,019.76	—	—	Bulk	22400
12	—	\$4,158.68	—	—	Bulk	32400



**90° FLANGED SIDE
OULET ELBOW FIG. 808**

SIZE	LIST PRICE EACH				QTY CARTON EACH	WGT PER 100
	ORDER QTY.	BLACK \$/EA.	ORDER QTY.	GALV. \$/EA.		
4	—	\$2,570.16	—	—	Bulk	5900
6	—	\$3,301.02	—	—	Bulk	9600
8	—	\$4,128.95	—	—	Bulk	15000

CAST IRON FLANGED, STANDARD



FLANGED TEE FIG. 811

SIZE	LIST PRICE EACH				QTY CARTON EACH	WGT PER 100
	ORDER QTY.	BLACK \$/EA.	ORDER QTY.	GALV. \$/EA.		
1½	—	\$346.11	—	—	Bulk	1500
2	—	\$201.01	—	\$339.77	Bulk	2100
2½	—	\$292.79	—	\$458.76	Bulk	3000
3	—	\$205.19	—	\$460.62	Bulk	3700
4	—	\$312.14	—	\$729.23	Bulk	6400
5	—	\$836.14	—	—	Bulk	8100
6	—	\$452.94	—	\$1,002.66	Bulk	10500
8	—	\$773.84	—	\$1,580.78	Bulk	16500
10	—	\$2,082.19	—	\$3,000.32	Bulk	27000
12	—	\$3,270.94	—	\$4,583.36	Bulk	38000



**FLANGED REDUCING
TEE FIG. 812**

SIZE	LIST PRICE EACH				QTY CARTON EACH	WGT PER 100
	ORDER QTY.	BLACK \$/EA.	ORDER QTY.	GALV. \$/EA.		
3 x 3 x 2½	—	\$609.13	—	—	Bulk	3500
3 x 3 x 2	—	\$476.82	—	—	Bulk	3400
3 x 3 x 1½	—	\$639.59	—	—	Bulk	3200
3 x 2 x 3	—	\$611.77	—	—	Bulk	3300
4 x 4 x 3	—	\$642.46	—	—	Bulk	5700
4 x 4 x 2½	—	▲\$701.61	—	—	Bulk	5600
4 x 4 x 2	—	\$642.46	—	—	Bulk	5100
4 x 3 x 4	—	\$1,536.33	—	—	Bulk	5900
4 x 3 x 3	—	\$1,567.07	—	—	Bulk	5300
4 x 2½ x 4	—	\$900.13	—	—	Bulk	5600
4 x 2 x 4	—	\$1,463.17	—	—	Bulk	5000
3 x 3 x 4	—	\$857.26	—	—	Bulk	5600
5 x 5 x 4	—	\$1,350.62	—	—	Bulk	8000
5 x 5 x 3	—	\$1,350.62	—	—	Bulk	7100
6 x 6 x 5	—	\$1,203.81	—	—	Bulk	10500
6 x 6 x 4	—	\$619.48	—	—	Bulk	9700
6 x 6 x 3	—	\$899.72	—	—	Bulk	9200
6 x 6 x 2½	—	\$1,203.81	—	—	Bulk	9000
6 x 6 x 2	—	\$1,264.01	—	—	Bulk	8600
6 x 5 x 4	—	\$1,862.45	—	—	Bulk	9100
6 x 4 x 6	—	\$712.58	—	—	Bulk	9400
6 x 4 x 4	—	\$787.62	—	\$1,320.67	Bulk	8800
6 x 3 x 6	—	\$1,832.17	—	—	Bulk	9100
4 x 4 x 6	—	\$1,206.48	—	—	Bulk	8800
8 x 8 x 6	—	\$966.17	—	\$2,021.71	Bulk	15600
8 x 8 x 4	—	\$1,160.99	—	▲\$2,060.84	Bulk	14300

☐ - Sold in box only

Weights are for Black Fittings.

▲ Extended lead times and or minimum order quantities

CAST IRON FITTINGS

CAST IRON FLANGED, STANDARD

FLANGED REDUCING TEE FIG. 812 (cont.)

SIZE	LIST PRICE EACH				QTY CARTON EACH	WGT PER 100
	ORDER QTY.	BLACK \$/EA.	ORDER QTY.	GALV. \$/EA.		
8 x 8 x 3	—	\$2,151.54	—	—	Bulk	14000
8 x 6 x 8	—	\$1,534.17	—	—	Bulk	15900
8 x 6 x 6	—	\$1,161.17	—	—	Bulk	14400
8 x 6 x 4	—	\$1,968.49	—	—	Bulk	12500
8 x 4 x 8	—	\$1,992.40	—	—	Bulk	14600
8 x 4 x 6	—	\$2,056.52	—	—	Bulk	14000
6 x 6 x 8	—	\$1,534.17	—	—	Bulk	14200
10 x 10 x 8	—	\$2,208.64	—	—	Bulk	26200
10 x 10 x 6	—	\$2,568.60	—	—	Bulk	24000
10 x 10 x 4	—	\$2,508.44	—	—	Bulk	22500
10 x 8 x 10	—	\$3,395.91	—	—	Bulk	26200
10 x 8 x 8	—	\$2,441.11	—	—	Bulk	23200
10 x 8 x 6	—	\$3,395.91	—	—	Bulk	22000
12 x 12 x 10	—	\$3,822.89	—	—	Bulk	36200
12 x 12 x 8	—	\$3,878.12	—	—	Bulk	33000
12 x 12 x 6	—	\$3,277.63	—	—	Bulk	32300
12 x 8 x 12	—	\$5,127.38	—	—	Bulk	34000
12 x 8 x 8	—	\$5,127.38	—	—	Bulk	29800



FLANGED CROSS FIG. 821

SIZE	LIST PRICE EACH				QTY CARTON EACH	WGT PER 100
	ORDER QTY.	BLACK \$/EA.	ORDER QTY.	GALV. \$/EA.		
2	—	\$634.47	—	—	Bulk	2800
2½	—	\$583.41	—	—	Bulk	3900
3	—	\$612.58	—	—	Bulk	4800
4	—	\$800.18	—	—	Bulk	8200
6	—	\$1,675.81	—	—	Bulk	13500
8	—	\$2,698.99	—	—	Bulk	21000
10	—	\$3,201.75	—	—	Bulk	33000



**FLANGED LATERAL
FIG. 823**

SIZE	LIST PRICE EACH				QTY CARTON EACH	WGT PER 100
	ORDER QTY.	BLACK \$/EA.	ORDER QTY.	GALV. \$/EA.		
2	—	\$725.03	—	—	Bulk	2500
2½	—	\$820.73	—	—	Bulk	3600
3	—	\$877.93	—	—	Bulk	4400
4	—	\$1,146.06	—	—	Bulk	7500
5	—	\$1,730.71	—	—	Bulk	9600
6	—	\$1,743.55	—	—	Bulk	12500
8	—	\$2,856.91	—	—	Bulk	21000

CAST IRON FLANGED, STANDARD



**FLANGED CONCENTRIC
REDUCER FIG. 825**

SIZE	LIST PRICE EACH				QTY CARTON EACH	WGT PER 100
	ORDER QTY.	BLACK \$/EA.	ORDER QTY.	GALV. \$/EA.		
2 x 1½	—	\$576.86	—	—	Bulk	1200
2½ x 2	—	\$463.35	—	—	Bulk	1400
2½ x 1½	—	\$576.86	—	—	Bulk	1200
3 x 2½	—	\$367.84	—	\$570.17	Bulk	1900
3 x 2	—	\$367.84	—	—	Bulk	1600
3 x 1½	—	\$588.52	—	—	Bulk	1400
4 x 3	—	\$413.30	—	\$693.48	Bulk	2800
4 x 2½	—	\$444.57	—	\$823.29	Bulk	2600
4 x 2	—	\$491.37	—	▲\$823.29	Bulk	2400
5 x 4	—	\$639.09	—	—	Bulk	3900
5 x 3	—	\$726.94	—	—	Bulk	3200
5 x 2½	—	\$991.85	—	—	Bulk	3100
6 x 5	—	\$608.01	—	—	Bulk	5000
6 x 4	—	\$553.51	—	\$1,010.40	Bulk	4700
6 x 3	—	\$637.19	—	—	Bulk	3900
6 x 2½	—	\$840.63	—	—	Bulk	3700
6 x 2	—	\$1,111.48	—	—	Bulk	3400
8 x 6	—	\$696.62	—	\$1,169.81	Bulk	7700
8 x 5	—	\$1,261.40	—	—	Bulk	7100
8 x 4	—	\$802.47	—	—	Bulk	6600
10 x 8	—	\$1,436.64	—	—	Bulk	12000
10 x 6	—	\$1,564.75	—	—	Bulk	10000
10 x 5	—	\$2,565.50	—	—	Bulk	9000
10 x 4	—	\$2,565.50	—	—	Bulk	8500
12 x 10	—	\$2,477.96	—	—	Bulk	18000
12 x 8	—	\$2,738.82	—	—	Bulk	15500
12 x 6	—	\$2,863.63	—	—	Bulk	14000



**FLANGED ECCENTRIC
REDUCER FIG. 826**

SIZE	LIST PRICE EACH				QTY CARTON EACH	WGT PER 100
	ORDER QTY.	BLACK \$/EA.	ORDER QTY.	GALV. \$/EA.		
3 x 2	—	\$554.90	—	—	Bulk	1600
3 x 2½	—	\$562.94	—	—	Bulk	2200
4 x 3	—	\$670.83	—	—	Bulk	2800
4 x 2½	—	\$752.15	—	—	Bulk	2800
4 x 2	—	\$775.16	—	—	Bulk	2800
5 x 4	—	\$991.95	—	—	Bulk	3900
6 x 5	—	\$633.62	—	—	Bulk	5100
6 x 4	—	\$633.62	—	\$1,125.37	Bulk	5000
6 x 3	—	\$1,057.64	—	—	Bulk	4700
8 x 6	—	\$802.63	—	—	Bulk	7700
8 x 5	—	\$1,041.14	—	—	Bulk	7600
8 x 4	—	\$1,088.44	—	—	Bulk	7100
10 x 8	—	\$2,044.52	—	—	Bulk	12000
10 x 6	—	\$2,398.05	—	—	Bulk	10700
12 x 10	—	\$2,771.33	—	—	Bulk	18000
12 x 8	—	\$2,870.31	—	—	Bulk	15500

For Galvanized, add 100% to the Black List Price unless the Galvanized List Price is listed.

Weights are for Black Fittings.

▲ Extended lead times and or minimum order quantities

□ - Sold in box only

* Faced only, Not Stocked. Galvanized Fittings Not Stocked in all types and sizes, but may be produced to order.

CAST IRON FITTINGS

CAST IRON FLANGED FITTINGS EXTRA HEAVY 250 LBS. FACED ONLY, FACED & DRILLED*



**X. H. 90° FLANGED
ELBOW FIG. 831**

SIZE	LIST PRICE EACH				QTY CARTON EACH	WGT PER 100
	ORDER QTY.	BLACK \$/EA.	ORDER QTY.	GALV. \$/EA.		
2	—	\$471.06	—	—	Bulk	2000
2½	—	\$512.10	—	—	Bulk	3000
3	—	\$521.32	—	—	Bulk	4000
4	—	\$750.17	—	—	Bulk	6500
6	—	\$1,075.38	—	—	Bulk	11500
8	—	\$1,760.60	—	—	Bulk	18500



X. H. FLANGED TEE FIG. 841

SIZE	LIST PRICE EACH				QTY CARTON EACH	WGT PER 100
	ORDER QTY.	BLACK \$/EA.	ORDER QTY.	GALV. \$/EA.		
2½	—	\$666.60	—	—	Bulk	4600
3	—	\$746.48	—	—	Bulk	5800
4	—	\$1,183.42	—	—	Bulk	9900
6	—	\$1,751.44	—	—	Bulk	18000
8	—	\$2,956.54	—	—	Bulk	28000



**X. H. FLANGED REDUCING
TEES FIG. 842**

6 x 6 x 4	—	\$2,401.60	—	—	Bulk	16000
8 x 8 x 6	—	\$3,674.05	—	—	Bulk	25700

CAST IRON FLANGED FITTINGS EXTRA HEAVY 250 LBS. FACED ONLY, FACED & DRILLED*



**X. H. FLANGED CONCENTRIC
REDUCER FIG. 855**

SIZE	LIST PRICE EACH				QTY CARTON EACH	WGT PER 100
	ORDER QTY.	BLACK \$/EA.	ORDER QTY.	GALV. \$/EA.		
3 x 2½	—	\$894.39	—	—	Bulk	2900
3 x 2	—	\$894.39	—	—	Bulk	2500
4 x 3	—	\$1,211.26	—	—	Bulk	4400
4 x 2½	—	\$1,211.26	—	—	Bulk	4000
6 x 5	—	\$1,690.48	—	—	Bulk	8500
6 x 4	—	\$1,699.02	—	—	Bulk	7700
6 x 3	—	\$1,690.48	—	—	Bulk	6700
8 x 6	—	\$2,304.96	—	—	Bulk	13000
8 x 4	—	\$2,304.96	—	—	Bulk	10500
10 x 8	—	\$4,077.73	—	—	Bulk	19000
10 x 6	—	\$4,077.73	—	—	Bulk	17000

CAST IRON FITTINGS

IRON FLANGES , STANDARD



**CAST IRON
COMPANION FLANGE FIG. 1011**

SIZE	ORDER QTY.	LIST PRICE EACH			QTY CARTON EACH	WGT PER 100
		BLACK \$/EA.	ORDER QTY.	GALV. \$/EA.		
3/4 x 3 3/8	—	\$39.82	—	\$69.99	Bulk	150
1 x 4 1/4	—	\$26.78	—	\$57.31	Bulk	175
1 1/4 x 4 5/8	—	\$32.05	—	\$65.80	Bulk	200
1 1/2 x 5	—	\$29.63	—	\$67.32	Bulk	225
2 x 6	—	▲\$29.56	—	\$59.19	Bulk	400
2 1/2 x 7	—	\$34.58	—	\$69.25	Bulk	600
3 x 7 1/2	—	\$44.53	—	\$84.16	Bulk	763
3 1/2 x 8 1/2	—	\$62.41	—	—	Bulk	900
4 x 9	—	\$60.01	—	\$114.62	Bulk	1175
5 x 10	—	▲\$84.80	—	\$179.96	Bulk	1400
6 x 11	—	\$95.94	—	\$192.34	Bulk	1650
8 x 13 1/2	—	\$151.44	—	\$333.98	Bulk	2600
10 x 16	—	\$268.40	—	\$503.04	Bulk	3775
12 x 19	—	\$574.32	—	\$999.45	Bulk	5050



**CAST IRON
REDUCING FLANGE FIG. 1016**

SIZE	ORDER QTY.	LIST PRICE EACH			QTY CARTON EACH	WGT PER 100
		BLACK \$/EA.	ORDER QTY.	GALV. \$/EA.		
1 x 5	—	\$79.17	—	—	Bulk	275
1 x 6	—	\$75.44	—	—	Bulk	500
1 1/4 x 5	—	\$75.02	—	—	Bulk	250
1 1/4 x 6	—	\$72.30	—	—	Bulk	475
1 1/2 x 6	—	\$61.88	—	▲\$115.56	Bulk	450
1 1/2 x 7	—	\$79.79	—	\$117.90	Bulk	700
2 x 7	—	\$57.90	—	\$127.33	Bulk	675
1 x 7 1/2	—	\$114.22	—	—	Bulk	900
1 1/2 x 7 1/2	—	\$95.66	—	\$179.05	Bulk	875
2 x 7 1/2	—	\$77.19	—	\$171.56	Bulk	850
2 1/2 x 7 1/2	—	\$82.85	—	\$179.05	Bulk	800
3 x 8 1/2	—	\$150.49	—	—	Bulk	1000
1 1/2 x 9	—	\$141.29	—	\$226.81	Bulk	1400
2 x 9	—	\$104.91	—	\$240.36	Bulk	1400
2 1/2 x 9	—	\$112.58	—	—	Bulk	1350
3 x 9	—	▲\$104.91	—	\$240.36	Bulk	1275
3 1/2 x 9	—	\$127.26	—	—	Bulk	1200
3 x 10	—	\$193.95	—	\$286.60	Bulk	1700
4 x 10	—	\$162.34	—	\$308.09	Bulk	1600
1 1/2 x 11	—	\$248.69	—	—	Bulk	2700
2 x 11	—	\$191.88	—	\$361.64	Bulk	2600
2 1/2 x 11	—	\$227.97	—	\$388.02	Bulk	2500
3 x 11	—	\$191.88	—	\$361.64	Bulk	2300
4 x 11	—	\$158.24	—	\$358.09	Bulk	2100
5 x 11	—	\$200.55	—	\$361.64	Bulk	1900
2 x 13 1/2	—	\$351.68	—	—	Bulk	4400

IRON FLANGES , STANDARD

CAST IRON REDUCING FLANGE FIG. 1016 (cont.)

3 x 13 1/2	—	\$351.68	—	\$595.85	Bulk	4000
4 x 13 1/2	—	▲\$270.84	—	\$531.31	Bulk	3700
5 x 13 1/2	—	\$380.15	—	—	Bulk	3400
6 x 13 1/2	—	\$245.54	—	\$571.03	Bulk	3100
6 x 16	—	\$692.69	—	—	Bulk	5300
8 x 16	—	\$656.21	—	—	Bulk	5000
6 x 19	—	\$752.72	—	—	Bulk	8800
8 x 19	—	\$805.68	—	—	Bulk	8100



**CAST IRON
BLIND FLANGE FIG. 1018**

SIZE	ORDER QTY.	LIST PRICE EACH			QTY CARTON EACH	WGT PER 100
		BLACK \$/EA.	ORDER QTY.	GALV. \$/EA.		
1 x 1 1/4	—	\$42.63	—	\$69.04	Bulk	200
1 1/4 x 4 5/8	—	\$45.05	—	\$75.41	Bulk	225
1 1/2 x 5	—	\$47.82	—	—	Bulk	375
2 x 6	—	\$54.03	—	\$79.97	Bulk	400
2 1/2 x 7	—	\$59.38	—	—	Bulk	675
3 x 7 1/2	—	\$71.18	—	\$116.42	Bulk	800
3 1/2 x 8 1/2	—	\$105.13	—	—	Bulk	1100
4 x 9	—	\$91.15	—	\$162.93	Bulk	1400
5 x 10	—	\$148.10	—	\$265.99	Bulk	1800
6 x 11	—	\$161.13	—	\$282.39	Bulk	2300
8 x 13 1/2	—	\$252.81	—	\$373.32	Bulk	4000
10 x 16	—	\$373.99	—	—	Bulk	5900
12 x 19	—	\$682.20	—	—	Bulk	8800

Weights are for Black Fittings.

▲ Extended lead times and or minimum order quantities

For Galvanized, add 100% to the Black List Price unless the Galvanized List Price is listed.

□ - Sold in box only

CAST IRON FITTINGS

IRON FLANGES, EXTRA HEAVY



**X. H. CAST IRON
COMPANION FLANGE FIG. 1025**

SIZE	LIST PRICE EACH				QTY CARTON EACH	WGT PER 100
	ORDER QTY.	BLACK \$/EA.	ORDER QTY.	GALV. \$/EA.		
1¼ x 5¼	—	\$91.74	—	—	Bulk	375
1½ x 6½	—	\$107.69	—	—	Bulk	575
2 x 6½	—	\$81.96	—	\$177.51	Bulk	650
2½ x 7½	—	\$117.92	—	\$212.84	Bulk	950
3 x 8½	—	\$128.21	—	\$253.34	Bulk	1233
4 x 10	—	\$208.17	—	\$342.82	Bulk	2000
5 x 11	—	\$279.15	—	—	Bulk	2400
6 x 12½	—	\$341.81	—	—	Bulk	3200
8 x 15	—	\$579.15	—	—	Bulk	5100



**X. H. CAST IRON
REDUCING FLANGE FIG. 1030**

SIZE	LIST PRICE EACH				QTY CARTON EACH	WGT PER 100
	ORDER QTY.	BLACK \$/EA.	ORDER QTY.	GALV. \$/EA.		
2 x 8¼	—	\$261.33	—	—	Bulk	1425
2½ x 8¼	—	\$261.18	—	—	Bulk	1350
3 x 10	—	\$378.62	—	—	Bulk	2275
4 x 11	—	\$296.08	—	—	Bulk	3000
4 x 12½	—	\$565.15	—	—	Bulk	3950



**X. H. CAST IRON
BLIND FLANGE FIG. 1021**

1½ x 6½	—	\$118.75	—	—	Bulk	525
2 x 6½	—	\$136.58	—	—	Bulk	700
2½ x 7½	—	\$157.95	—	—	Bulk	1100
3 x 8¼	—	\$181.26	—	—	Bulk	1400
4 x 10	—	\$264.90	—	—	Bulk	2300
5 x 11	—	\$349.95	—	—	Bulk	3100
6 x 12½	—	\$456.23	—	—	Bulk	4200
8 x 15	—	\$735.08	—	—	Bulk	7000

HIGH HUB FLANGES FOR C. I. PIPE



**CAST IRON
FLANGES FOR CAST IRON PIPE FIG. 1010T**

SIZE	LIST PRICE EACH				QTY CARTON EACH	WGT PER 100
	ORDER QTY.	BLACK \$/EA.	ORDER QTY.	GALV. \$/EA.		
3 x 7½	—	\$95.23	—	—	Bulk	750
4 x 9	—	\$100.17	—	—	Bulk	1300
6 x 11	—	\$141.35	—	—	Bulk	1720
8 x 13½	—	\$235.80	—	—	Bulk	2900
10 x 16	—	\$401.65	—	—	Bulk	4200
12 x 19	—	\$545.37	—	—	Bulk	6000

MALLEABLE IRON FLANGES 125 LB. STANDARD MALLEABLE IRON

COMPANION FLANGES FIG. 1035

SIZE	LIST PRICE EACH				QTY CARTON EACH	WGT PER 100
	ORDER QTY.	BLACK \$/EA.	ORDER QTY.	GALV. \$/EA.		
2 x 6	—	—	—	\$124.30	Bulk	400
2½ x 7	—	—	—	\$174.69	Bulk	600
3 x 7½	—	—	—	\$215.87	Bulk	763
4 x 9	—	—	—	\$348.11	Bulk	1175
5 x 10	—	—	—	\$322.59	Bulk	1400
6 x 11	—	—	—	\$470.49	Bulk	1650

SAFETY VALVE DISCHARGE ELBOWS

SCREWED CAST IRON FIG. 1538

SIZE	LIST PRICE EACH				QTY CARTON EACH	WGT PER 100
	ORDER QTY.	BLACK \$/EA.	ORDER QTY.	GALV. \$/EA.		
2½	—	\$713.23	—	—	Bulk	1200
3	—	\$765.76	—	—	Bulk	1500
4	—	\$1,032.95	—	—	Bulk	2700
6	—	\$1,979.37	—	—	Bulk	5300
8	—	▲\$7,182.41	—	—	Bulk	10400

☐ - Sold in box only

Weights are for Black Fittings.

▲ Extended lead times and or minimum order quantities



ANVIL[®]
INTERNATIONAL, INC.

Corporate Offices
110 Corporate Drive, Suite 10 • P.O. Box 3180
Portsmouth, NH 03802-3180
Tel: 603-422-8000 • Fax: 603-422-8033
E-mail address — Webmaster@anvilintl.com
www.anvilintl.com

ANVIL MANUFACTURED PRODUCTS

Columbia, PA Foundry

1411 Lancaster Avenue
Columbia, PA 17512
Tel: 717-684-4400 • Fax: 717-684-6868
Paul Suor — Plant Manager

Henderson, TN Plant

2870 Old Jackson Road
Henderson, TN 38340
Tel: 731-989-3551 • Fax: 731-989-4144
Rich Brooks — Plant Manager

Canvil

390 Second Avenue
Simcoe, ON Canada N3Y 4K9
Tel: 519-426-4551 • Fax: 519-426-5509
Brent Widdifield — Plant Manager

Longview, TX Plant

305 Simms
Longview, TX 75604
Tel: 903-759-4417 • Fax: 903-759-1782
Van O'Keefe — Plant Manager

J.B. Smith

6618 Navigation
Houston, TX 77011
Tel: 713-928-5711 • Fax: 713-928-6733
Ray Mullenix — Plant Manager

North Kingstown, RI Plant

160 Frenchtown Road
North Kingstown, RI 02852
Tel: 401-886-3001 • Fax: 401-886-3010
Robert Taylor — General Manager

ENGINEERED PIPE SUPPORTS

- Structural Fabrication
 - Field Services
 - Non-destructive Testing
- Contact: North Kingstown, RI Plant
401-886-3001

**For Sales and Service
Information Contact the
Regional Service Center
Nearest You or Visit Our Web-
site at www.anvilintl.com**

NORTH EAST REGION

Regional Service Center: Servicing Connecticut, Delaware, Maine, Maryland, Massachusetts, New Hampshire, New Jersey, New York, East Pennsylvania, Rhode Island, Vermont, Virginia

2530 Pearl Buck Road
Bristol, PA 19007
Tel: 215-788-4056 • Fax: 215-788-4475
Toll Free: 1-800-451-2935
Dean Taylor — Regional Vice President

MID WEST REGION

Regional Service Center: Servicing Illinois, Indiana, Iowa, Kansas, Kentucky, Michigan, Minnesota, Missouri, Nebraska, North and South Dakota, Ohio, West Pennsylvania, West Virginia, Wisconsin

750 Central Avenue
University Park, IL 60466
Tel: 708-534-1414 • Fax: 708-534-5441
Toll Free: 1-800-301-2701
Dean Taylor — Regional Vice President

Satellite Offices

1201 W. 96th Street
Bloomington, MN 55431
Tel: 952-884-7131 • Fax: 952-887-1501
Toll Free: 1-800-733-7131

9530 Le Saint Drive
Fairfield, OH 45014
Tel: 513-682-2330 • Fax: 513-870-0109
Toll Free: 1-800-837-2424

8615 East 33rd Street
Indianapolis, IN 46226
Tel: 317-895-2424 • Fax: 317-895-2430
Toll Free: 1-800-837-1515

1930 Warren Street
Kansas City, MO 64116
Tel: 816-474-0500 • Fax: 816-221-7150
Toll Free: 1-800-877-7007

24600 Northline Road
Taylor, MI 48180
Tel: 734-947-3083 • Fax: 734-947-4682
Toll Free: 1-800-279-1601

WESTERN REGION

Regional Service Center: Servicing Alaska, Arizona, California, Hawaii, Idaho, Montana, Nevada, Oregon, Utah, Washington

1385 Greg Street
Sparks, NV 89431
Tel: 775-331-7029 • Fax: 775-331-5075
Toll Free: 1-800-572-0051
Bob Arison — Regional Vice President

Satellite Offices

P.O. Box 10206
Portland, OR 97210
Tel: 503-223-7101 • Fax: 503-223-7130
14103 Borate St.
Sante Fe Springs, CA 90670
Tel: 562-802-7459 • Fax: 562-802-7519

SOUTH WEST AND SOUTH EAST REGION

Regional Service Center: Servicing Alabama, Arkansas, Colorado, Florida, Georgia, Louisiana, Mississippi, New Mexico, North and South Carolina, Oklahoma, Tennessee, Texas, Wyoming

1313 Avenue R
Grand Prairie, TX 75050
Tel: 972-343-9206 • Fax: 972-641-8946
Toll Free: 1-800-451-4414
Bob Arison — Regional Vice President

Satellite Offices

6999 Old Clinton Rd
Houston, TX 77020
Tel: 713-675-6371 • Fax: 713-678-7858

2600 W. 42nd Street
Odessa, TX 79764
Tel: 432-366-2803 • Fax: 432-366-0890

4200 Holly Street
Denver, CO 80216
Tel: 303-394-2178 • Fax: 303-321-3050

Sales Offices

1202 Tech Blvd., Suite 103
Tampa, FL 33619
Tel: 813-663-9267 • Fax: 813-663-0811
Toll Free: 1-800-429-0703

CANADA — MUELLER-FLOW CONTROL

Kevin Fullan *Vice President*
Tel: 905-664-1459 ext 272

Doug Crawford *National Marketing Manager*
Tel: 905-664-1459 ext 248

Alberta

Calgary — Tel: 403-246-0033 • Fax: 403-246-0051
Edmonton — Tel: 780-452-9841 • Fax: 780-452-9873

British Columbia

Delta — Tel: 604-940-1449 • Fax: 604-940-9878
Nanaimo — Tel: 250-758-1551 • Fax: 250-758-1160
Prince George — Tel: 250-561-1219 • Fax: 250-561-7358
Vancouver City — Tel: 604-875-6990 • Fax: 604-875-6962

Manitoba

Winnipeg — Tel: 204-774-3461 • Fax: 204-786-5044

Ontario

Stoney Creek — Tel: 905-664-9230 • Fax: 905-664-9556
Toronto — Tel: 416-251-4171 • Fax: 416-251-7087
Sarnia — Tel: 519-336-7690 • Fax: 519-336-1621
Sudbury — Tel: 705-671-9600 • Fax: 705-671-8082

Quebec

Montreal — Tel: 514-342-2100 • Fax: 514-342-2177
Ste-Foy — Tel: 418-650-5766 • Fax: 418-266-0252

Saskatchewan

Regina — Tel: 306-543-5536 • Fax: 306-545-0390
Saskatoon — Tel: 306-242-6788 • Fax: 306-242-5089