

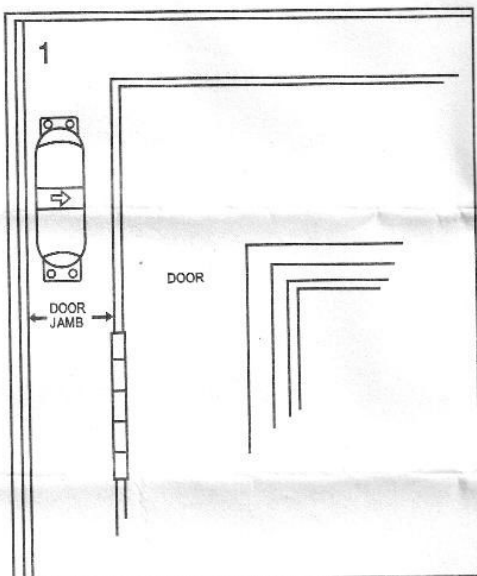

Min-Ultra

Mini Door Closer Installation Instructions



Fasten the main body of the door closer on the surface of the door jamb or door frame. The jamb or frame must be flush with the surface of the door.

Fasten with the four (4) screws furnished. Make sure the main body is square to the door and that the arrow points in the direction of the door lockset

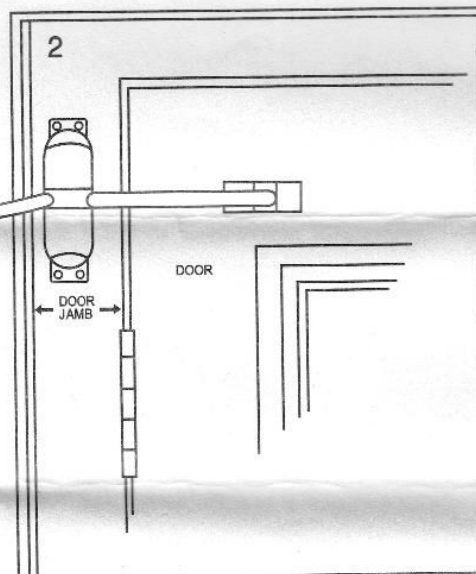

Turn the center ring with arrow facing you away from the door with the extra plain steel threaded rod and at the same time screw into position the roller arm into the hole closest to the door.

To increase the tension repeat the above, one hole at a time until the desired tension is obtained. (closing speed)

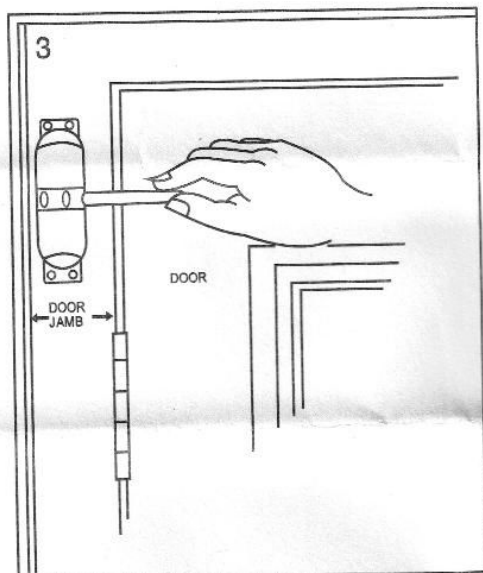

The tension regulates the closing speed of the door. To increase the closing speed, increase the tension by repeating the operation as stated in figure 2.

For proper adjustment, increase tension one hole at a time.

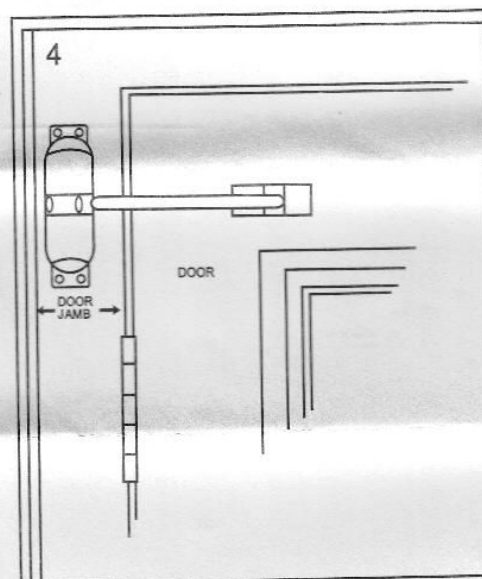

After proper tension and closing speed is obtained, position the plastic roller mat under the roller wheels with nail as supplied or glue to prevent the roller wheels from marking the door.