

INSTALLATION INSTRUCTIONS FOR TRIM OF PANIC EXIT DEVICE WHEN YOUR DOOR HAS CYLINDRICAL LOCK CUT-OUT

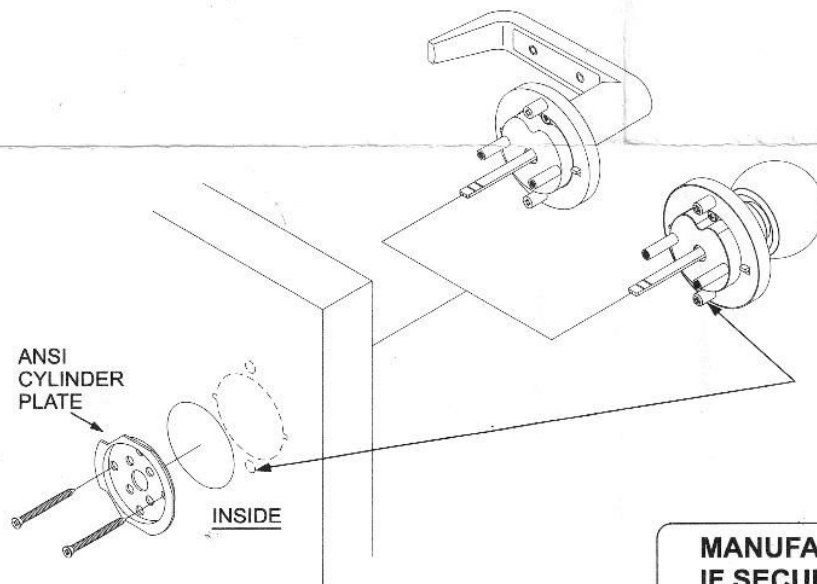

NOTE: IMPORTANT!

**ALIGNMENT STUDS MUST
ENTER INTO (2) 5/16" FIELD
DRILLED HOLES ON
OUTSIDE OF DOOR
(EXISTING SLOTS CAN BE
ELONGATED WITH A FILE)**

**MANUFACTURER'S WARRANTY VOID
IF SECURITY STUDS ARE REMOVED.**

*** IF KEY IN LEVER / KNOB INCLUDED WITH THE DEVICE**

- A. Prepare door to accept Key-in-Lever / Knob trim with ANSI door prep.
prepare door to accept device.
- B. Insert Key-in-Lever / Knob trim into outside face of door.
- C. Secure Key-in-Lever / Knob trim with inside of ANSI cylinder plate.
Insert (2) mounting screws thru ANSI cylinder plate and into trim
mounting posts. Tighten securely. Install screw for anti rotation.
- D. Using 1/4 device mounting screws mount device to door making sure
trim actuator shaft inserts into device cam. (Ref. View "A")
- E. Proceed with device installation.

