

Many owners of the SecuriTEST (#33-891) CCTV tester have complained about batteries not charging or not holding a charge. In version 1.0 of the operators manual the user is not told to place the main power switch on the side of the tester to the ON position when charging batteries. Due to a change in the product design to extend the life of the batteries, the charging circuit was changed so that the power switch does need to be in the ON position for the batteries to charge when the tester is plugged into a power source.

Version 2.0 of the manual reflects this change in operation.

The proper procedure for charging batteries in SecuriTEST is to:

1. Load six identical NimH or NiCd rechargeable batteries into the battery compartment.
2. Place the charge switch under the battery cover to the ON position (figure 1).
3. Place the main power switch (figure 2) to the ON position.
4. Connect either the AC or DC car adapter between a power source and the tester. Charge the batteries for eight hours.

Note: The charge LED will light when the DC connector is plugged into SecuriTEST even if the power adapter is not plugged into an outlet.

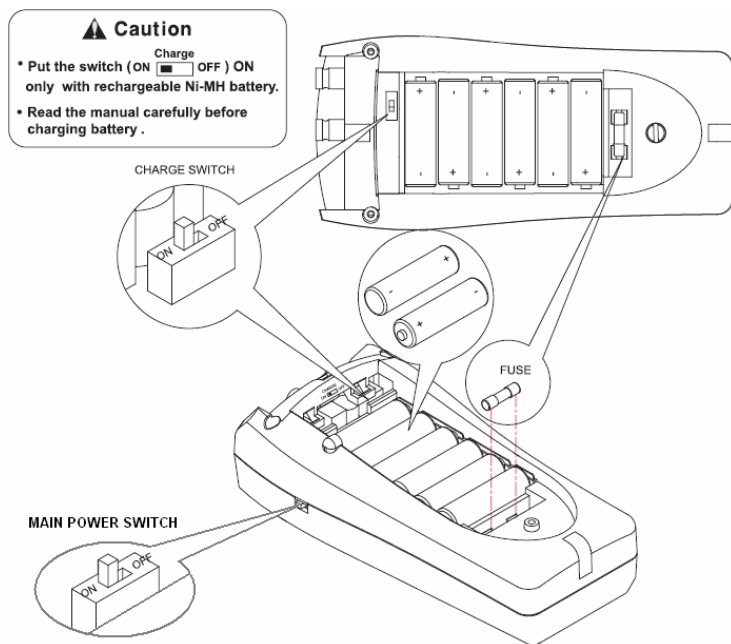

Figure 1

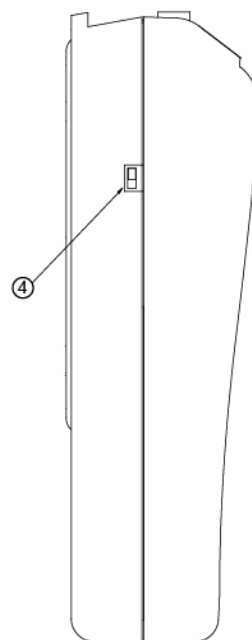

Figure 2

SecuriTEST (33-891) Battery Charging Problem

Dan Payerle
DataComm Product Manager
IDEAL Industries, INC.
(858) 715-7148
dan.payerle@idealindustries.com

IDEAL INDUSTRIES, Inc.
www.idealindustries.com
www.idealindustries.co.uk
www.idealindustries.de