



## ADCH10

### ENVIRONMENTAL CAMERA HOUSING



#### FEATURES

- Indoor/outdoor housing
- Space - efficient design accepts most cameras and lenses
- Cover opens 180° for easy camera access
- Tough, high-impact polymer construction
- IP4/NEMA-3R protection
- Automatic regulating heater available
- 24 VAC blower, optional
- 24 VAC heater, optional
- Tamper resistant
- Electrically isolated camera platform
- Multiple cable pass mounts available

The ADCH10 is a high quality environmental housing designed for most CCD cameras and zoom lenses. This polycarbonate housing provides excellent protection for the installed camera. The 180° opening of the cover provides full and easy access to the camera and lens for trouble-free installation and servicing.

The camera platform can be securely attached in any position along the full length of the housing. This platform is constructed of a rigid non-conductive material which helps to eliminate common grounding problems.

In cold weather climates, or where condensation problems exist, the optional low current heater and blower automatically regulate heat in the housing to maintain a clear viewing window.

## SPECIFICATIONS

### Model Numbers

ADCH10	.....	Environmental Camera Housing
ADCH10MT8	.....	Environmental Camera Housing with 8 inch wall mount
ADCH10HB*	.....	Environmental Camera Housing 24 VAC heater and blower installed
ADCH10HBMT8*	.....	Environmental Camera Housing with wall mount and 24 VAC heater and blower installed
ADCH10H*	.....	Environmental Camera Housing with heater
ADCH10B*	.....	Environmental Camera Housing with blower

\* This housing must be powered by a Class II source. This housing is to be used with a camera that meets Class II requirements.

### Mechanical

#### Construction

Housing	.....	Magnum® 941 Polymer
Viewing Window	.....	4.8 mm (0.19 in) Lexan®
Color	.....	Light gray
Finish	.....	Epoxy
Dimensions (H x W x D)	.....	163 x 146 x 348 mm (6.50 x 5.75 x 13.75 in)

#### Unit Weight

Without Sunshield	.....	1.4 kg (3.0 lbs)
Shipping Weight	.....	1.7 kg (3.8 lbs)
With Sunshield	.....	1.9 kg (4.4 lbs)
Cable Entry	.....	Via cable pass mount

#### Maximum Camera/

Lens Length	.....	253 mm (10 in)
-------------	-------	----------------

#### Heater

Type	.....	Thermostatically controlled pad heater
Supply Voltage	.....	24 VAC
Power	.....	0.63 A
Weight	.....	.68 g (0.15 lbs)

### Environmental

Weatherproof Standard	.....	IP4 (NEMA-3R)
Operating Temperature	.....	-23° to 43° C (-10° to 110° F) with heater and blower 85% (non-condensing)

### Accessories

ADCH10SS	.....	Sunshield
AD1314-H24	.....	24 VAC heater
AD1314-B24	.....	24 VAC blower

#### Recommended Housing Mounts

ADCHMTCEIL	.....	Ceiling mount 9.6 kg (20 lbs) capacity
ADCHMTWALL	.....	Wall mount 9.6 kg (20 lbs) capacity
ADCHMTPOLE	.....	Pole mount 9.6 kg (20 lbs) capacity
ADCHMTCRNR	.....	Corner mount 9.6 kg (20 lbs) capacity
ADCHMTPED	.....	Pedestal mount 9.6 kg (20 lbs) capacity

### Regulatory

Safety	.....	UL2044
--------	-------	--------



Housing with Sunshield



Housing in open position

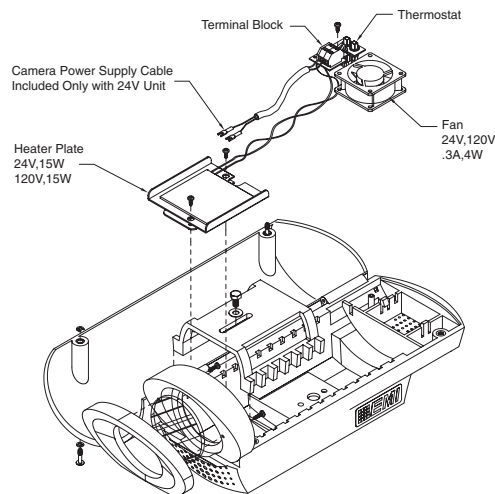

Housing

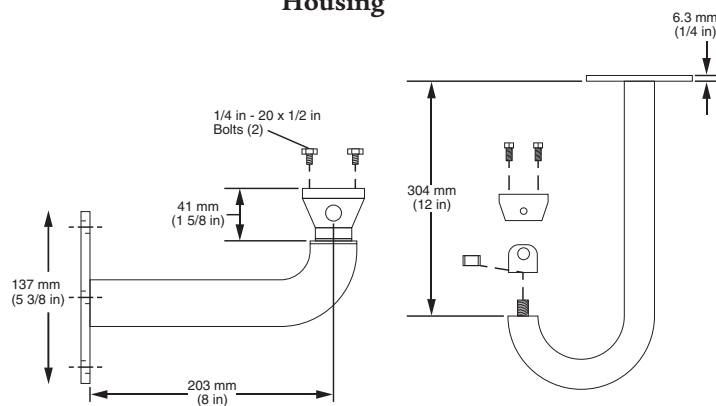

Wall Mount Side View  
ADCHMTWALL

Ceiling Mount Side View  
ADCHMTCEIL

### Mounts

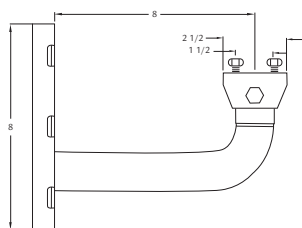

Pole Mount Side View  
ADCHMTPOLE

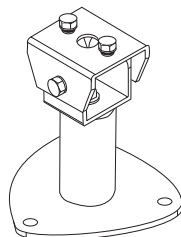

Pedestal Mount Side View  
ADCHMTPED

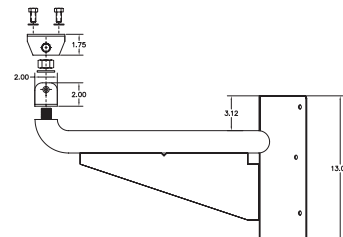

Corner Mount Side View  
ADCHMTCRNR