

# BU6 Series 650 TV lines

## High Resolution Camera Installation/Operation Manual 18 to 32 VAC (Revision A)

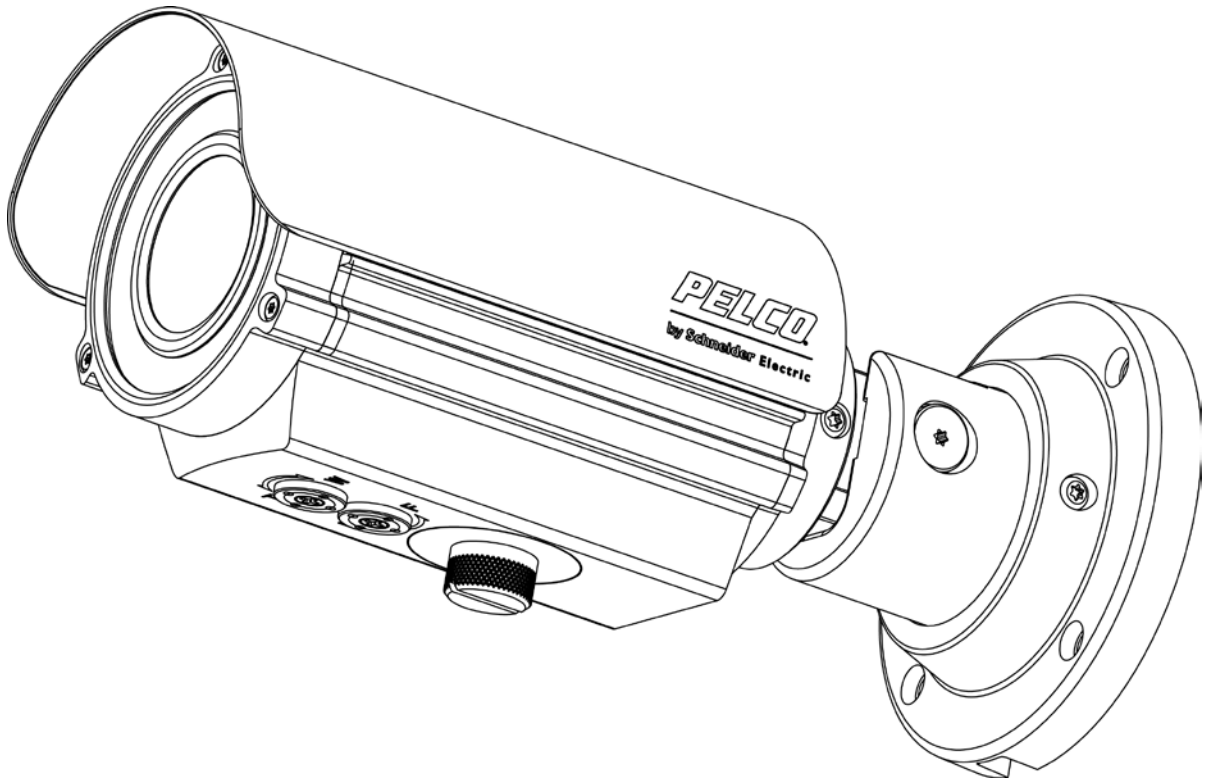

C3979M-A-EN (04/14)

Before attempting to connect or operate this product, please read these instructions carefully and save this manual for future use.

BU6 Series model names:

BU6-IRWV50-6  
BU6-IRWV50-6(X)

# CONTENTS

Important Safety Instructions.....	3
Important Notices.....	5
REGULATORY NOTICES [FCC CLASS B].....	5
RADIO AND TELEVISION INTERFERENCE.....	5
Warranty.....	5
1. Introduction.....	6
1.1 Before You Begin.....	6
1.2 Package Contents.....	6
1.3 Optional Accessories.....	6
1.4 Dimensions.....	6
2. Part Names and Locations.....	7
3. Installation.....	8
3.1 Mounting the Bracket.....	8
3.2 Cable Connection.....	9
3.3 Instructions for Using the BU-Adapter (Optional).....	10
3.4 Modify the Camera Position.....	11
3.5 Adjustment.....	12
4. OSD Menu.....	13
5. OSD Menu Settings.....	14
5.1 LENS.....	15
5.2 SHUTTER/AGC.....	16
5.3 WHITE BAL.....	17
5.4 HLC/BLC.....	18
5.5 PICTURE ADJUST.....	18
5.6 WDR.....	19
5.7 MOTION DET.....	19
5.8 PRIVACY.....	20
5.9 NR.....	20
5.10 CAMERA ID.....	20
5.11 SYNC.....	20
5.12 LANGUAGE.....	20
5.13 CAMERA RESET.....	20
5.14 EZOOM.....	21
5.15 DIS.....	21
5.16 FOCUS ADJ.....	21
5.17 ALARM.....	21
5.18 REMOTE.....	22
5.19 SAVE ALL.....	22
6. Specifications.....	23
Pelco Troubleshooting Contact Information.....	25
Note for Dimension Drawings.....	25

# Important Safety Instruction

## Important Safety Instructions

1. Read these instructions.
2. Keep these instructions.
3. Heed all warnings.
4. Follow all instructions.
5. Clean only with dry cloth.
6. Do not block any ventilation openings. Install in accordance with the manufacturer's instructions.
7. Do not install near any heat sources such as radiators, heat registers, stoves, or other apparatus (including amplifiers) that produce heat.
8. Protect the power cord from being walked on or pinched particularly at plugs, convenience receptacles, and the points where they exit from the apparatus.
9. Only use attachments/accessories specified by the manufacturer.
10. Use only with the cart, stand, tripod, bracket, or table specified by the manufacturer, or sold with the apparatus. When a cart is used, use caution when moving the cart/apparatus combination to avoid injury from tip-over.
11. Refer all servicing to qualified service personnel. Servicing is required when the apparatus has been damaged in any way, such as power-supply cord or plug is damaged, liquid has been spilled or objects have fallen into the apparatus, the apparatus has been exposed to rain or moisture, does not operate normally, or has been dropped.
12. Installation should be done only by qualified personnel and conform to all local codes.
13. Unless the unit is specifically marked as a NEMA Type 3, 3R, 3S, 4, 4X, 6, or 6P enclosure, it is designed for indoor use only and it must not be installed where exposed to rain and moisture.
14. Use only installation methods and materials capable of supporting four times the maximum specified load.
15. Use stainless steel hardware to fasten the mount to outdoor surfaces.
16. To prevent damage from water leakage when installing a mount outdoors on a roof or wall, apply sealant around the bolt holes between the mount and mounting surface.

# Important Safety Instruction

**CAUTION:** These servicing instructions are for use by qualified service personnel only. To reduce the risk of electric shock do not perform any servicing other than that contained in the operating instructions unless you are qualified to do so.

Only use replacement parts recommended by Pelco.

The product and/or manual may bear the following marks:



This symbol indicates that dangerous voltage constituting a risk of electric shock is present within this unit.

**CAUTION:** RISK OF ELECTRIC SHOCK. DO NOT OPEN.



This symbol indicates that there are important operating and maintenance instructions in the literature accompanying this unit



**WARNING:** This product is sensitive to Electrostatic Discharge (ESD). To avoid ESD damage to this product, use ESD safe practices during installation. Before touching, adjusting or handling this product, correctly attach an ESD wrist strap to your wrist and appropriately discharge your body and tools. For more information about ESD control and safe handling practices of electronics, please refer to ANSI/ESD S20.20-1999 or contact the Electrostatic Discharge Association ([www.esda.org](http://www.esda.org)).

# Important Notices

## REGULATORY NOTICES [FCC CLASS B]

This device complies with Part 15 of the FCC Rules. Operation is subject to the following two conditions: (1) this device may not cause harmful interference, and (2) this device must accept any interference received, including interference that may cause undesired operation.

## RADIO AND TELEVISION INTERFERENCE

This equipment has been tested and found to comply with the limits of a Class B digital device, pursuant to Part 15 of the FCC Rules. These limits are designed to provide reasonable protection against harmful interference in a residential installation. This equipment generates, uses, and can radiate radio frequency energy and, if not installed and used in accordance with the instructions, may cause harmful interference to radio communications. However there is no guarantee that the interference will not occur in a particular installation. If this equipment does cause harmful interference to radio or television reception, which can be determined by turning the equipment off and on, the user is encouraged to try to correct the interference by one or more of the following measures:

- Reorient or relocate the receiving antenna.
- Increase the separation between the equipment and the receiver.
- Connect the equipment into an outlet on a circuit different from that to which the receiver is connected.
- Consult the dealer or an experienced radio/TV technician for help.

You may also find helpful the following booklet, prepared by the FCC: "How to Identify and Resolve Radio-TV Interference Problems." This booklet is available from the U.S. Government Printing Office, Washington D.C. 20402.

Changes and Modifications not expressly approved by the manufacturer or registrant of this equipment can void your authority to operate this equipment under Federal Communications Commission's rules.

This Class B digital apparatus complies with Canadian ICES-003.

Cet appareil numérique de la classe B est conforme à la norme NMB-003 du Canada.

## Warranty

For information about Pelco's product warranty and thereto related information, refer to [www.pelco.com/warranty](http://www.pelco.com/warranty).

## Operating Notes:

Warning:

For BU6 (Revision A); released in 2014:

- Connect to 12 VDC or 18 to 32 VAC power adapter

For older BU6 cameras (Prior to Revision A)

- Connect to 12 VDC or 24 VAC power adapter.

## Operating Conditions

- Avoid viewing very bright objects (example, light fixtures) for extended periods.
- Avoid operating or storing the unit in the following locations:
  - Extremely humid, dusty, hot/cold environments where the operating temperature is outside the recommended range of -22°F to 131°F (-30°C to +50°C)
  - Close to sources of powerful radio or TV transmitters
  - Close to fluorescent lamps or objects reflecting light
  - Under unstable light sources (may cause flickering)

## 1. Introduction

The camera is ideal for outdoor installation in commercial environment.

### 1.1 Before You Begin

Please read this guide carefully before you install the camera. Keep this guide for future reference.

### 1.2 Package Contents

Check that the items received match those listed on the order form and packing slip. The bullet camera series packing box includes:

- One fully assembled camera
- One installation/operation manual
- One guide pattern
- One Hexagonal wrench
- Four screw anchors
- Four TP4x25mm tapping screws

If any parts are missing or damaged, contact the dealer you purchased the camera from.

### 1.3 Optional Accessories

- BU-Adapter

Use the BU-Adapter for cable management when the installation requires surface mounted conduit. See section 3.3 for details.

### 1.4 Dimensions

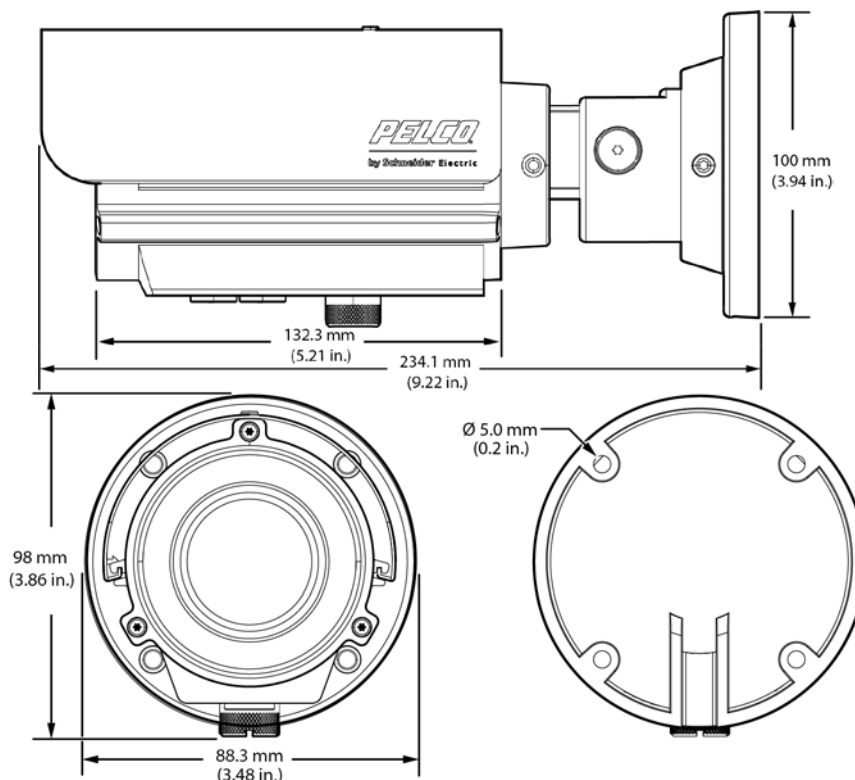

## 2. Part Names and Locations

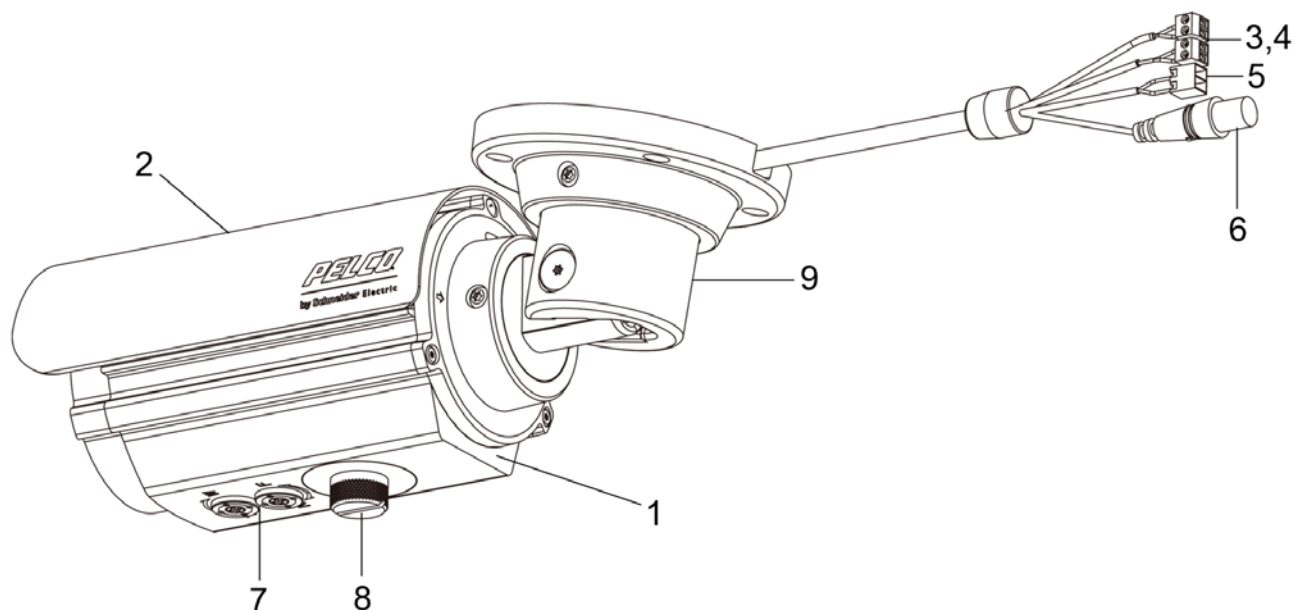

Figure 2 BU6-IRWV50-6/ BU6-IRWV50-6X

**1. Camera main body**

**2. Sun shield:** Minimize the effects of rain and sunlight on image quality.

**3. Alarm IN:** Connect to device that responds to alarm signals.

**4. Alarm Out:** Connect to device that triggers alarm signals.

**5. Power connector:** Connects to the external power source: 12VDC/18-32VAC (Positive: Red ,Negative: Black)

**Note:** When powering the camera using 12VDC, we recommend that the camera is installed with a separate, isolated power supply to minimize power-related video

interference.

**6. BNC connector:** Connects to the VIDEO IN connector of the Monitor Video Connector.

**7. Externally adjustable focal length & focus**

**8. OSD menu joystick:**

To use the OSD joystick control:

- Press the OSD joystick control straight down to enter the Main menu or a selected item.
- Move the OSD joystick control UP, DOWN, LEFT and RIGHT to navigate through menus and options.

**9. Mount bracket:** Connects to the Mount.

## 3. Installation

### 3.1 Mounting the Bracket

1. Drill mounting holes using the supplied Guide Pattern to drill four 5mm mounting holes.
2. Insert the supplied anchors into the holes.

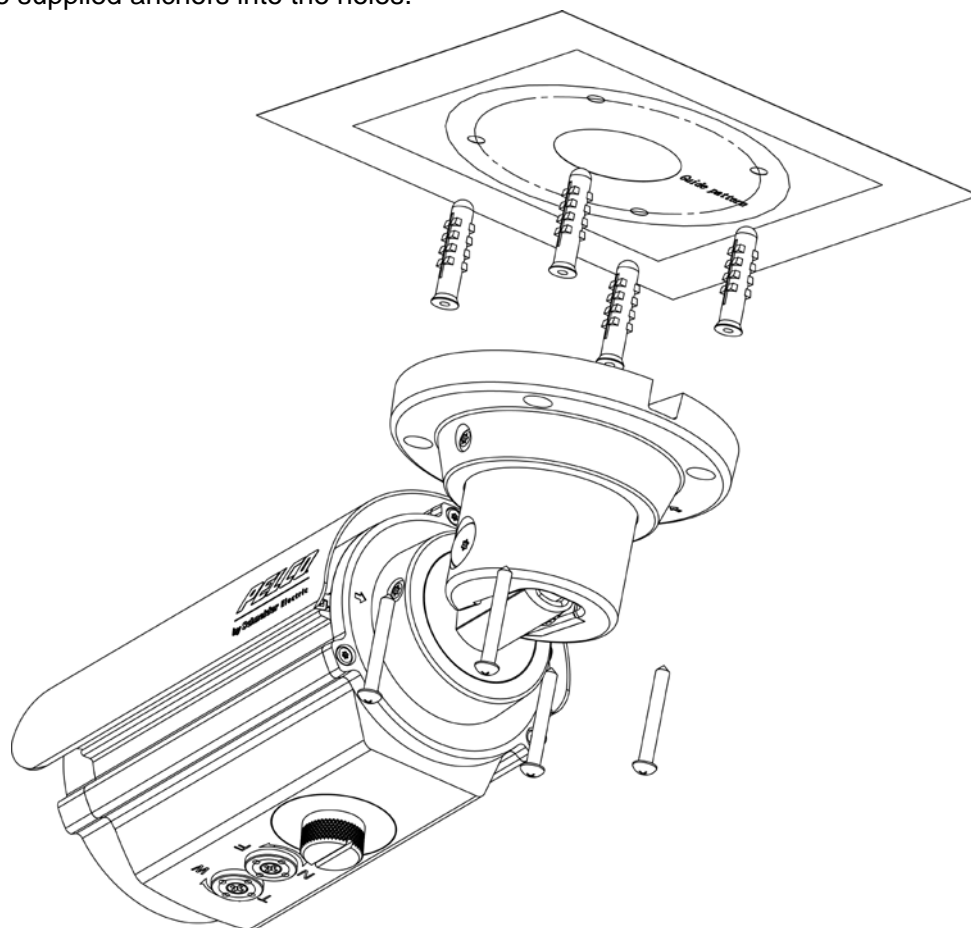
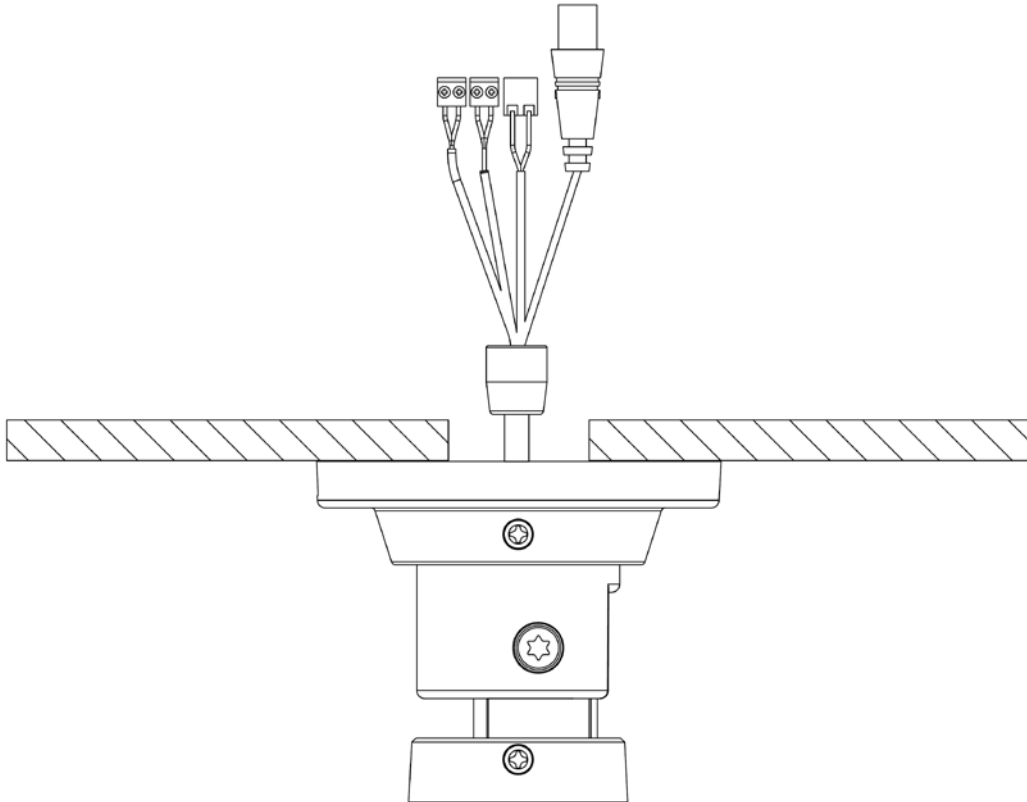

Figure 3-1 Mounting the Bracket



## 3.2 Cable Connection

1. Pass all the signal cables through the mounting bracket.
2. Connect the camera power/video cable and external power/video cable together. The mounting bracket also has a cable relief if the mounting surface cannot be penetrated.



**Figure 3-2 Cable Connection**

**Note:** For static electricity protection, ensure that the rubber pad is placed inside the mounting bracket base.

# Installation

## 3.3 Instructions for Using the BU-Adapter (Optional)

You can use the BU-Adapter with the recommended conduit boxes to protect cables from rain, heat, vandals and other harsh factors and make a tidy, professional installation on a surface mount installation.

### Descriptions for the Figure 3-3 Installation Guide (typical):

- ① Camera bracket(BU4/BU5 series shown)
- ② Camera cables
- ③ Rubber of BU-Adapter
- ④ Screws(provided)
- ⑤ Metal plate of BU- Adapter
- ⑥ Conduit box(See **Table 3.3-1 Compatible Conduit Boxes** for details)

### Installation Procedures(typical):

1. Pass all cables through the hole of rubber.

**Note:** Please identify both sides of the rubber. The side of the rubber with the inclined angle must be towards the terminals of the cables and metal plate to avoid water leakage. Refer to the figure below.

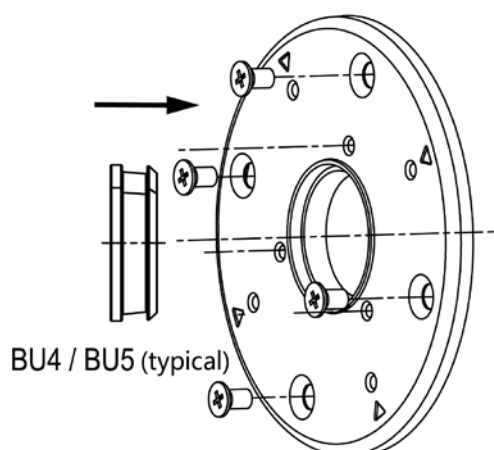

2. Insert the rubber into the center hole of metal plate.
3. Then install the metal plate in the conduit box and tighten the screws and finish the installation.

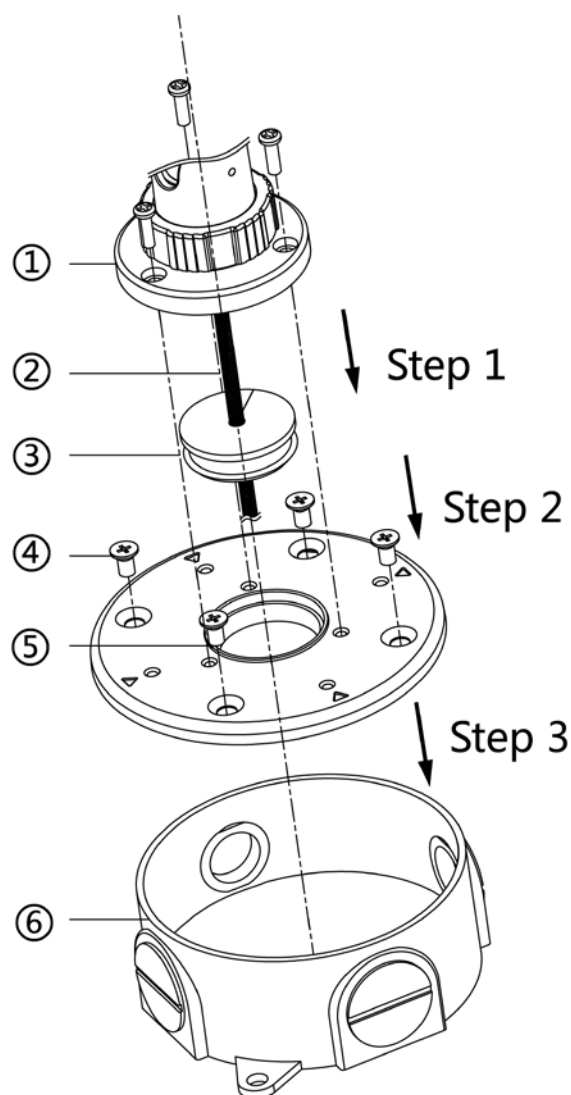

**Figure 3-3 Installation Guide (typical)**

The BU-Adapter can be used with the following conduit boxes:

Manufacturer	Part Number	Description
Teddico/BWF	RB-7V	ROUND OUTLET BOX 3/4" GREY 5 HOLE
Teddico/BWF	RB-5V	ROUND OUTLET BOX 1/2" GREY 5 HOLE
Raco	5361-0	4" Round Weatherproof Splice Box 5-1/2" Outlets
Raco	5372-0	4" Round Weatherproof Splice Box 5-3/4" Outlets
Orbit	RB50-5	4" ROUND 1/2" THREADED HOLE OUTDOOR WEATHERPROOF BOX
Orbit	RB75-5	4" ROUND 3/4" THREADED HOLE OUTDOOR WEATHERPROOF BOX
EGS	WRX50	Round WPRF Box 5-1/2"
EGS	WRX75	Round WPRF Box 5-3/4"

**Table 3.3-1 Compatible Conduit Boxes**

# Installation

## 3.4 Modify the Camera Position

1. Loosen the two screws (left and right) first (just rotate slightly one circle or the screws will fall down).
2. Rotate the Retaining ring then you will be able to hold the camera and adjust its angle.
3. Fasten the screws and retaining ring to ensure the desired angle.

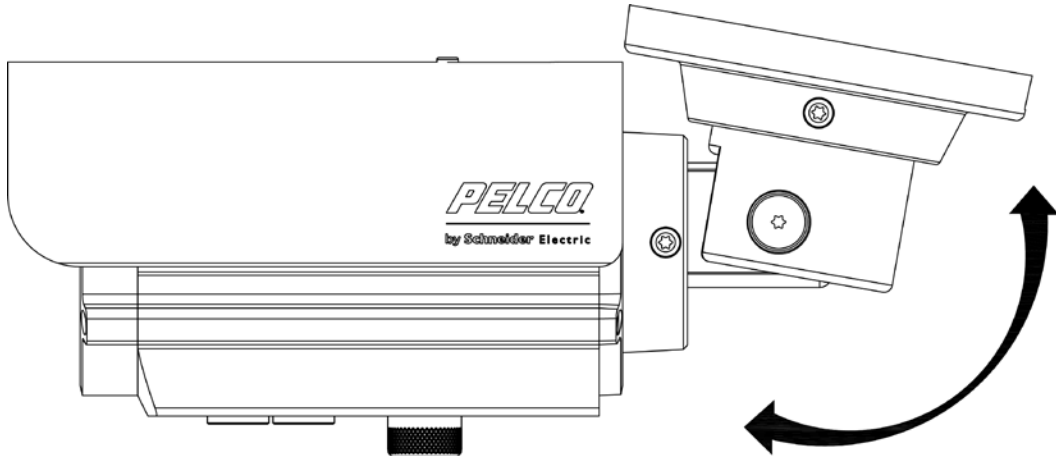

Figure 3-4-1 Modify the Camera Position

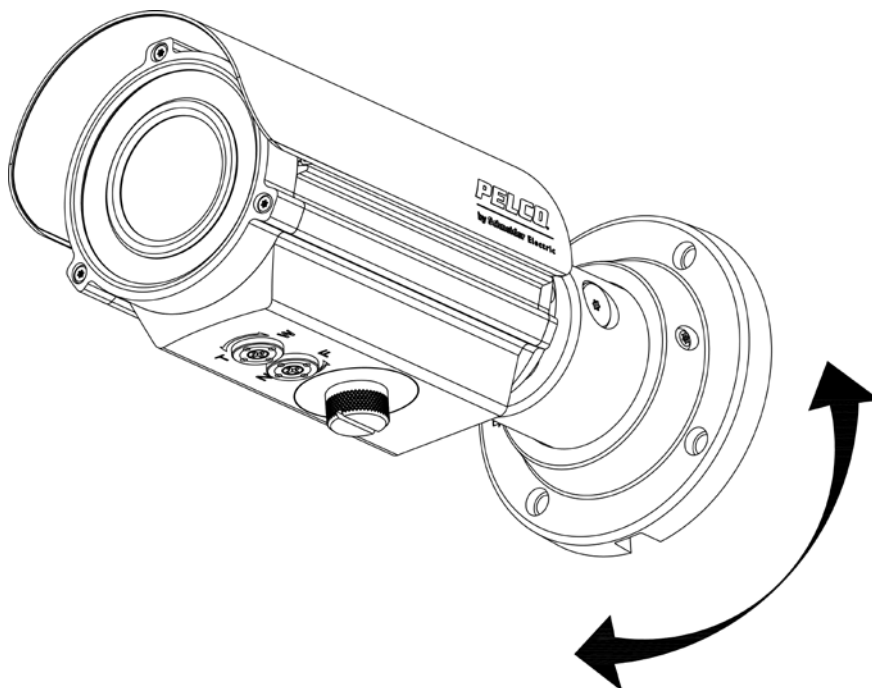
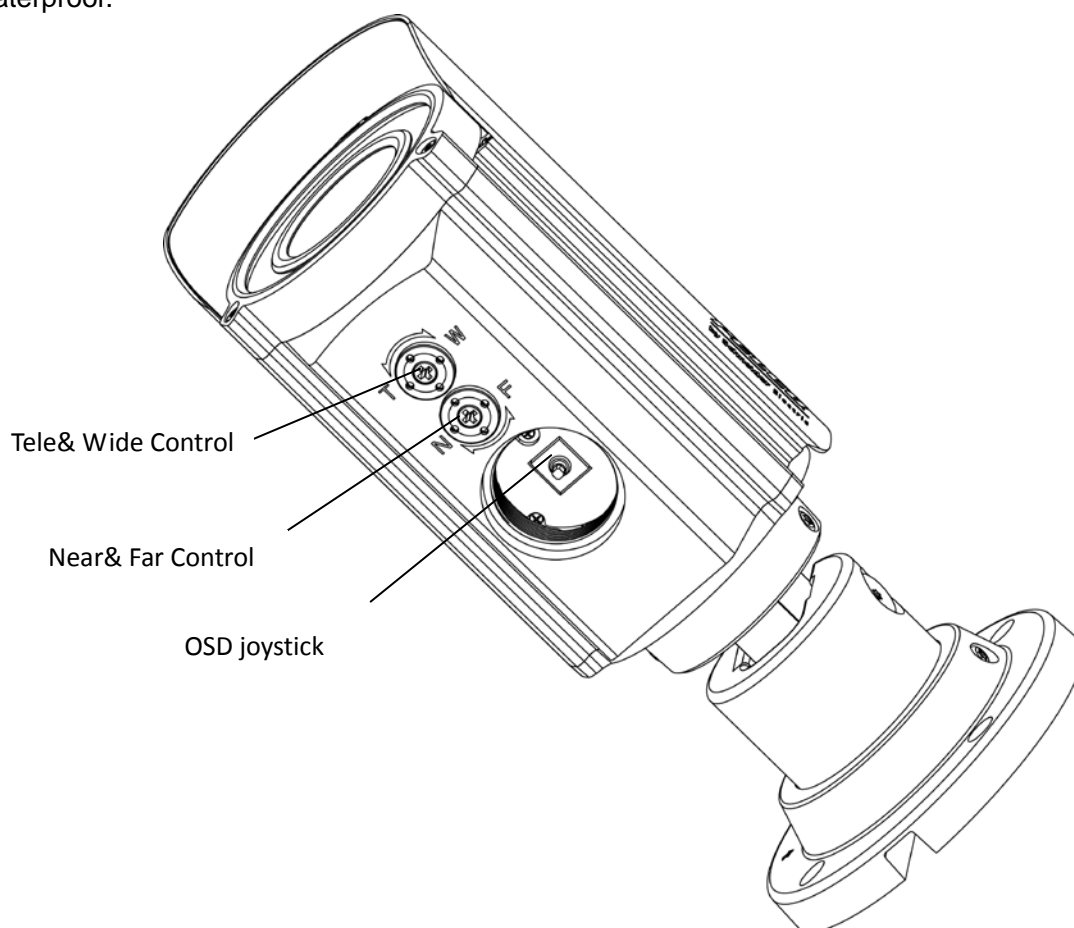

Figure 3-4-2 Modify the Camera Position

## 3.5 Adjustment

It can be adjusted once the screw is fully loosened. After adjustment, be sure to lock it tightly to keep it waterproof.



**Figure 3-5 Camera Adjustment**

**Note:** Please be careful when adjusting Tele/Wide and Near/Far so as to avoid damage to the lens.

## OSD Setup Menu

### 4. OSD Menu

Set up menu	Default set	Menu
Lens	AUTO	Auto / Manual
Shutter / AGC	Option	Auto (High Luminance, Low Luminance)
White / Bal	ATW	ATW, PUSH, USER1, USER2, Anti CR , MANUAL, PUSH LOCK
HLC / BLC	Option	OFF / BLC / HLC
Pic Adjust	Option	Flip, Contrast, Sharpness, Chroma, Blemish Det, Negative
WDR	Full WDR	OFF / Full WDR / Light WDR (Contrast)
Motion Det	OFF	OFF / ON (Detect Sense, Area Sel, Mode, Top, Bottom, Left, Right)
Privacy	Option	OFF / ON (Area Sel, Mode, Position, Color, Transp, Mosaic)
NR	Option	Level
Camera ID	OFF	OFF / ON
SYNC	INT	INT
Language	English	ENGLISH / SPANISH / RUSSIAN / GERMAN / FRENCH / JAPANESE or PORTUGUESE
Camera Reset	Option	
Ezoom	Option	Mag / Pan / Tilt
DIS	OFF	OFF/ON
Focus ADJ	Option	Focus Val
Alarm	Option	Defocus Txt, Alarm Out, Trigger, Normal Out
Back		
Exit		
Save All		

# 5. OSD Menu Settings

## Entering OSD Menu

Push in the joystick to open the Main menu. Use the UP/DOWN functions of the joystick to move the cursor to the item you want to modify. A selected menu item will be highlighted.

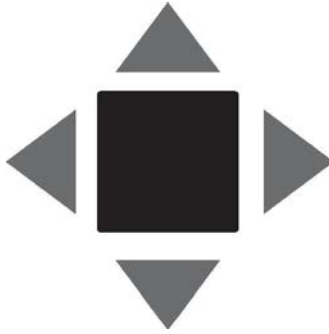

**Press UP:** Press to move the cursor up.

**Press Down:** Press to move the cursor down.

**Enter button:** Push in on the joystick to enter the selected item or change the settings of the selected item.

**Press Right:** Press to change the settings of the selected item.

**Press Left:** Press to change the settings of the selected item.

**Note:** When an item is selected, it will be highlighted.

After all the settings have been satisfied, move the cursor to the "Save All" item and press the enter button. Then move the cursor to the "EXIT" item and press the enter button to exit the OSD setup menu.

You can also restore the settings to factory default by moving the cursor to the "CAMERA RESET" item and then pressing the Enter button. Then move the cursor to the "Save All" item and press the Enter button.

# Menu Settings

Use the OSD menu to set up the camera for optimum performance.

SETUP MENU 1/3	
LENS	AUTO
SHUTTER/AGC	
WHITE BAL	ATW
HLC/BLC	
PICT ADJUST	
WDR	FULL WDR
MOTION DET	OFF
NEXT	
EXIT	SAVE ALL

SETUP MENU 2/3	
PRIVACY	
NR	
CAMERA ID	OFF
SYNC	INT
LANGUAGE	ENGLISH
CAMERA RESET	
BACK	NEXT
EXIT	SAVE ALL

SETUP MENU 3/3	
EZOOM	
DIS	OFF
FOCUS ADJ	
ALARM	
REMOTE	
BACK	
EXIT	SAVE ALL

**Note:** All the values or configurations shown in the following figures are camera default settings.

## 5.1 LENS

The LENS settings allow you to configure Lens and speed. The options are AUTO (Auto Iris lens) and MANUAL. The default setting is AUTO.

In the AUTO submenu, you can set the MODE as AUTO. Then select SPEED to adjust the DC Iris Lens convergence speed from 000~255.

If speed value is lower, the IRIS will be slower. If speed value is higher, the IRIS will be faster.

AUTO IRIS	
TYPE	DC
MODE	AUTO
SPEED	048
RETURN	

# Menu Settings

## 5.2 SHUTTER/AGC

You can set the SHUTTER/AGC as AUTO or MANUAL. The default setting is AUTO.

You can select HIGH LUMINANCE MODE OR LOW LUMINANCE MODE and adjust the BRIGHTNESS.

The brightness level ranges from 0~255. The IRIS level will be controlled by camera brightness.

### SUGGESTED USE:

DC Lens: When using DC lens, we recommend you set SHUTTER/AGC to AUTO mode. Enter the AUTO submenu as shown in the figure. Move the joystick control UP or DOWN to adjust HIGH LUMINANCE MODE to AUTO IRIS.

Manual Lens: When using MANUAL lens, we recommend you set SHUTTER/AGC to AUTO mode. Enter the AUTO submenu as shown in the figure below. Move the joystick control UP or DOWN to adjust HIGH LUMINANCE MODE and the LOW LUMINANCE setting.

AUTO SETUP	
HIGH LUMINANCE MODE	AUTO IRIS
BRIGHTNESS	034
LOW LUMINANCE MODE	AGC
BRIGHTNESS	-
RETURN	

The shutter speed is variable from 1/50(1/60) sec to the 1/10Ksec and the AGC is selectable depending on your environment condition.

### AUTO IRIS and SHUT+AUTO IRIS difference

- Use the DC lens and setting to AUTO IRIS mode for normal condition application environments. The IRIS level will be controlled by camera brightness.
- Use the DC lens and setting to SHUT+AUTO IRIS mode for high light application environments. The exposure will be controlled by AES or the DC Iris. The iris level will be controlled by the camera brightness.

In HIGH LUMINANCE MODE, the submenu is shown below. When the high luminance mode is on, the shut cannot be set.

HIGH LUMINANCE SETUP	
SHUT	-
RETURN	

Enter the LOW LUMINANCE MODE submenu as shown in the following figure. LOW LUMINANCE could be set as AGC, SLOW, AGC→SLOW, AGC→SLOW→AGC, and OFF. There are 10 levels for selection. Depending on your environment condition, the slow shut could be selected as OFF, x2, x4, x8, x16, x32, x64, x128, x256; the default slow shut is x4.

LOW LUMINANCE SETUP	
AGC	010
SLOW SHUT	x4
RETURN	



## Menu Settings

**Note:** These are the menu settings for Lens and Shutter/AGC.

- When the camera first starts up the menu setting for Lens=Auto (Mode=Auto) and the settings for Shutter/AGC= High Luminance=Auto Iris
- When you change Lens=Manual then the default settings for Shutter/AGC= High Luminance=Shut

### 5.3 WHITE BAL

WHITE BALANCE controls color on the screen. Options include ATW (Auto White Balance), PUSH, USER1, USER2, Anti CR (Anti Color Rolling Suppression), MANUAL or PUSH LOCK mode. The default is ATW. The color temperature range is 2500°K ~ 9500°K.

Enter the **ATW** submenu as shown in the figure below. Select ATW when the scene illumination varies between indoor scenes and outdoor scene lighting. The SPEED and DELAY CNT have 000~255 levels to select respectively. You can set ATW FRAME as x0.5, 1.0, 1.5, 2.0 or MAX.

In **Environment** submenu, you can choose the standard, indoor or outdoor according to your viewing environment.

ATW SETUP	
SPEED	016
DELAY CNT	016
ATW FRAME	x1.0
ENVIRONMENT	STANDARD
RETURN	

**Note:** When setting different value of ATW FRAME and application environment, the color temperature range of white balance will be changed. The color temperature range of x0.5 of ATW FRAME will be smaller than x2.0.

If you selected USER1 or USER2 mode as shown in the following figures, you can adjust B-GAIN and R-GAIN value from 000 to 255.

MANUAL WB	
LEVEL UP	PUSH ENTER
LEVEL DOWN	PUSH ENTER
PRESET	
RETURN	

If you select USER1 or USER2 mode as shown in the following figures, you can adjust the B-GAIN and R-GAIN value from 000 to 255.

USER1 WB		USER2 WB	
B-GAIN	029	B-GAIN	045
R-GAIN	050	R-GAIN	038
RETURN		RETURN	

## Menu Settings

If you select PUSH mode in the appropriate position, the whole area will perform white balance.

If you select PUSH LOCK mode in the appropriate position, WHITE BALANCE will perform once.

If you select Anti CR mode in the appropriate position, the whole area will effectively restrain color cast.

### 5.4 HLC/BLC

Set the BLC (Backlight compensation) function and the HLC (Highlight compensation) function. BLC and HLC Compensation are the functions that achieve the brightness of a selected area to an optimum image level. Due to the intense light coming from the back of objects in the area expected to view, the auto iris lens tends to close and areas you want to see become dark and invisible.

Available options include OFF, ON or AUTO mode. The default is OFF.

If HLC is selected, HLC is activated automatically when the camera detects high-luminance. When you select ON, the function controls the light level to overcome severe backlighting conditions. The clip level ranges from 000 to 255 and the scale has 15 levels.

HLC/BLC	
HLC	OFF
CLIP LEVEL	000
SCALE	010
BLC	-
RETURN	

### 5.5 PICTURE ADJUST

PICTURE ADJUST allows you to adjust picture settings for the optimal image. In the PICT ADJUST submenu, you can adjust picture Flip, Contrast, Sharpness, Chroma, Blemish detection, or Negative. The options: OFF, V-FLIP, H-FLIP, HV-FLIP are selectable in Flip line.

In the BLEMISH DET submenu, you can set the blemish compensation function. Press <SET> and waits to be confirmed. After that, the white blemish will be removed, then go back to the optimal image.

Contrast could be selected from 000 to 063, Sharpness is 000~015, and Chroma is 000~008.

PICT ADJUST	
FLIP	OFF
CONTRAST	038
SHARPNESS	008
CHROMA	002
BLEMISH DET	SET
NEGATIVE	OFF
RETURN	

# Menu Settings

## 5.6 WDR

Set the WDR (Wide Dynamic Range) function. The Wide Dynamic Range (WDR) function is intended to provide clear images even under back light circumstances where intensity of illumination can vary excessively.

The default setting is FULL WDR; it also has options of OFF and LIGHT WDR. In the WDR SETUP submenu, you can set CONTRAST as MID, MIDTHIGH, HIGH, LOW or MIDLOW to optimize the image. The submenu of Light WDR is same as the WDR SETUP submenu.

WDR SETUP	
CONTRAST	MID
RETURN	

## 5.7 MOTION DET

MOTION DET allows moving objects on the screen to be detected. The default is OFF. If you select ON, you will enter the MOTION DET submenu. You can set 4 motion areas to detect moving objects and adjust the motion detection sensitivity. The value of sensitivity is from 000 to 127.

MONITOR AREA	
DETECT SENSE	111
AREA SEL	1/4
MODE	ON
TOP	002
BOTTOM	003
LEFT	004
RIGHT	005
RETURN	

## Menu Settings

### 5.8 PRIVACY

PRIVACY function masks up to 15 privacy areas on the screen from video monitoring. The default setting is OFF. If you select ON, you will enter the PRIVACY submenu. You can configure up to 15 privacy areas and set color and transparency of the privacy zones. In addition, you can enable the MOSAIC function for the privacy zone.

PRIVACY	
AREA SEL	1/15
MODE	OFF
POSITION	-
COLOR	-
TRANSP	-
MOSAIC	-
RETURN	

**Note:** When TRANSP is 1.00, Mosaic function is not available.

-

### 5.9 NR

NR allows you to configure the DNR (Digital Noise Reduction) settings to reduce noise on the screen. In the NR submenu, you can adjust the NR LEVEL. When you enable the NR MODE, you can choose LOW, MIDLOW, MID, MIDHIGH, HIGH LEVEL depending on your environment condition.

NR SETUP	
LEVEL	OFF
RETURN	

### 5.10 CAMERA ID

CAMERA ID displays ON or OFF. The default setting is OFF. You can set the ON mode to add a camera title up to 26 characters on 1 line at the top of monitor screen.

### 5.11 SYNC

The default setting is INT. This has no adjustment.

### 5.12 LANGUAGE

O OSD supports 6 available languages. The default setting is English. Options include ENGLISH / SPANISH / RUSSIAN / GERMAN / FRENCH / JAPANESE or PORTUGUESE.

### 5.13 CAMERA RESET

Move to the CAMERA RESET mode then Press the ENTER key to recall factory settings.

## Menu Settings

### 5.14 EZOOM

Enter the EZOOM SETUP submenu as shown in the following figure. Move the joystick control LEFT or RIGHT to select PAN /TILT value for zoom in or zoom out the image. PAN range is 000~1023, TILT range is 000~5110.

EZOOM SETUP	
MAG	000
PAN	512
TILT	256
RETURN	

### 5.15 DIS

S Set DIS (DISPLAY) function. The default setting is OFF. When you choose DIS on, EZOOM can not be set.

### 5.16 FOCUS ADJ

In this function line, you can set a series of general parameters of ALARM. Press joystick control to enter the ALARM SETUP submenu as shown in the figure below

ADJUST FOCUD OF THE LENS	
FOCUS VAL	2121
RETURN	

### 5.17 ALARM

In this function line, you can set a series of general parameters of ALARM. Press joystick control to enter ALARM SETUP submenu as shown in the figure below.

ALARM SETUP	
DEFOCUS TXT	
ALARM OUT	
TRIGGER	AUX
NORMAL OUT	OPEN
RETURN	

#### For Submenu DEFOCUS TXT

Choose and press joystick control to enter DEFOUCUS TXT SETUP submenu as shown in figure below. The DEFOCUS TXT can be set as Off/ON, DEFOCUS LEVEL is 000~007. Use this feature when your application requires screen notification of a camera tamper. If this mode is selected, the Alarm Out will activate when defocusing occurs.

## Menu Settings

### DEFOCUS SETUP

DEFOCUS TXT	OFF
DEFOCUS LEV	003

RETURN

### For Submenu ALARM OUT

You can configure the ALARM OUT TRIGGER as AUX or MOTION DET. Choose AUX when your application requires that the Coaxitron® or D protocol remote control will be used to activate the Alarm Out. Choose MOTION DET when your application requires that when motion is sensed the Alarm Out is activated. Only one type of Alarm Out can be specified.

**Note:** The Alarm Out function when set to AUX will operate as follows from Coaxitron® or D protocol remote control:

- AUX 1: Activates Alarm Out
- AUX 2: Activates Alarm Out for 2 seconds and returns to deactivated state
- AUX 3: Deactivates Alarm Out

### For Submenu NORMAL OUT

The default setting is Relay Open. The option can be set to Relay Closed. Configure this setting to match your attached accessory logic.

## 5.18 REMOTE

The camera supports PELCO D protocol. You can view the camera by remote access connectivity. The ADDRESS is range from 001 to 255; BAUD RATE could be set as 4800, 9600, 1200 or 2400 bps.

Built in support for PELCO Coaxitron®. A single video cable connection is used to transmit a video signal

### REMOTE SETUP

PROTOCOL	PELCO D
ADDRESS	001
BAUD RATE	4800

RETURN

## 5.19 SAVE ALL

Save all settings and exit.

## Specification

### 6. Specifications

Camera System Type	BU6-IRWV50-6		BU6-IRWV50-6X	
Format	NTSC		PAL	
Optical System				
Imager Size	1/3"			
IR Cut Filter	Yes - D/N Switch			
Low Light Technology	ICR and LEDs only			
Electric				
Sync System	Internal			
Lens Options	F1.6, 6-50mm, DC AI			
Digital Zoom	Yes-255X			
Zoom/Focus Controls	Outside			
Horizontal Resolution	650 TVL			
Field Of View	fW 6mm: Horizontal: 46°; Vertical : 33° fT 50mm: Horizontal: 7°; Vertical : 5°			
Min. Object Distance	1.5m~∞			
Sensitivity	f/1.6; 2,850°K; 30 IRE Color (17 ms) 0.1 Lux Color (500 ms) 0.03 Lux Mono (with IR) 0 Lux		f/1.6; 2,850°K; 30 IRE Color (20 ms) 0.1 Lux Color (500 ms) 0.03 Lux Mono (with IR) 0 Lux	
Shutter	Auto: 1/60~1/100,000 Manual: 1/60~1/10,000 Slow shutter support: 2X-128X		Auto: 1/50~1/100,000 Manual: 1/50~1/10,000 Slow shutter support: 2X-128X	
White Balance	ATW / Push / USER1 / USER2 / ANTI CR / Manual / Push lock			
IR Illumination Type	"Adaptive"			
IR Illumination Distance	40 meters			
IR Sensitivity	850nm >40% Peak Response			
WDR	120 dB Minimum - True WDR (Double Sample)			
Noise Reduction-DNR	3D			
Motion Detection	Yes - Four (4) areas, sensitivity selectable			
Privacy Zones	Yes - 15 sizable windows			
Image Stabilization	Yes (under 10Hz)			
Camera Titles	Yes (20 Character)			
Camera ID	Yes -(Defocusing)			
Remote Access	RS485/Coaxitron			
Outputs	1 NO/NC			
Connection/Termination	Flying leads (through the mount). Mount must be integrated to the camera			
Set Up/OSD Input Device	Input Buttons/5 Way Rocker			
Multi Language	English, Russian, German, French, Spanish, Japanese		English, Russian, German, French, Spanish, Portuguese	
Power supply				
Power	18 to 32 VAC 50/60 Hz/12 VDC +10% to -15% (Revision A)			
Power Consumption	8W (IR on, without heater) 22W (IR on, with heater on)			
Environment				
Operating Temperature Range	-30° C to +50°C			
Operating humidity	98% Non-condensing			
Mechanism				
Construction	Aluminum Diecast			
Impact Resistance	IK10			

## Specifications

Positioning Mechanism/Adjustment	Bracket Panning Range: $\pm 360^\circ$ Tilting Range: $\pm 90^\circ$ Rotation Range: $\pm 360^\circ$
Sunshield	Yes
Dehumidifier	Yes
Dimension	98mm x 234.1mm
Weight(unit)	1550g
Sunshield	Yes



## Troubleshooting Information

### Pelco Troubleshooting Contact Information

If the instructions provided fail to solve your problem, contact Pelco Product Support at 1-800-289-9100 (USA and Canada) or +1-559-292-1981 (international) for assistance. Be sure to have the serial number available when calling.

Do not try to repair the unit yourself. Leave maintenance and repairs to qualified technical personnel only.

### Note for Dimension Drawings



**NOTE:** VALUES IN PARENTHESES ARE INCHES; ALL OTHERS ARE CENTIMETERS.

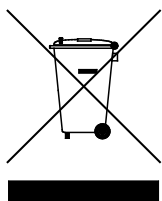

This equipment contains electrical or electronic components that must be recycled properly to comply with Directive 2002/96/EC of the European Union regarding the disposal of waste electrical and electronic equipment (WEEE). Contact your local dealer for procedures for recycling this equipment.

### REVISION HISTORY

Manual #	Date	Comments
C3908M	02/14	Original Version
C3908M	04/14	Revision A

Pelco, the Pelco logo, and other trademarks associated with Pelco products referred to in this publication are trademarks of Pelco, Inc. or its affiliates. ONVIF and the ONVIF logo are trademarks of ONVIF Inc. All other product names and services are the property of their respective companies. Product specifications and availability are subject to change without notice.

© Copyright 2014, Pelco, Inc.  
All rights reserved.



Pelco by Schneider Electric 3500 Pelco Way Clovis, California 93612-5699 United States  
USA & Canada Tel (800) 289-9100 Fax (800) 289-9150  
International Tel +1 (559) 292-1981 Fax +1 (559) 348-1120  
**[www.pelco.com](http://www.pelco.com) [www.pelco.com/community](http://www.pelco.com/community)**