



Quick Setup Guide For HYDRA HD™ Camera

Installation, servicing, alterations, and repairs should be performed only by qualified service personnel that are authorized by the equipment distributor.

MS12059B0100A

Package Contents

HYDRA HD™ Bullet Camera



Quick Setup Guide



Screw:
PHT1 5x25 (4pcs)

Warning

Before performing the camera installation, please ensure that this Quick Setup Guide is read and understood thoroughly.

Caution

	THIS SYMBOL INDICATES THAT DANGEROUS VOLTAGE CONSTITUTING A RISK OF ELECTRIC SHOCK IS PRESENT WITHIN THE UNIT.		THIS SYMBOL INDICATES THAT IMPORTANT OPERATING AND MAINTENANCE INSTRUCTIONS ACCOMPANY THIS UNIT.
TO REDUCE THE RISK OF ELECTRIC SHOCK, DO NOT DISASSEMBLE OR ALTER. NO USER SERVICEABLE PARTS INSIDE REFER SERVICING TO QUALIFIED SERVICE PERSONEL.			

WEEE (Waste Electrical and Electronic Equipment)



Correct disposal of this product (applicable in the European Union and other European countries with separate collection systems.) This product should be disposed of, at the end of its useful life, as per applicable local laws, regulations, and procedures.

Certificates

FCC Compliance

Information to the User: This equipment has been tested and found to comply with the limits for a Class A digital device. Pursuant to Part 15 of the FCC Rules, these limits are designed to provide reasonable protection against harmful interference in a residential installation. This equipment generates, uses, and can radiate radio frequency energy and, if not installed and used in accordance with the instruction manual, may cause harmful interference to radio communications. However, there is no guarantee that interference will not occur in a particular installation.

If this equipment does cause harmful interference to radio or television reception, which can be determined by turning the equipment off and on, the user is encouraged to try to correct the interference. For example, try reorienting or relocating the receiving antenna, increasing the separation between the equipment and receiver, or connecting the equipment to an outlet on a different circuit.

CE Compliance

Connector

- 1. Sun Shield
- 2. Front Case
- 3. Bottom Cap
- 4. Rear Case
- 5. Bracket
- 6. Cable

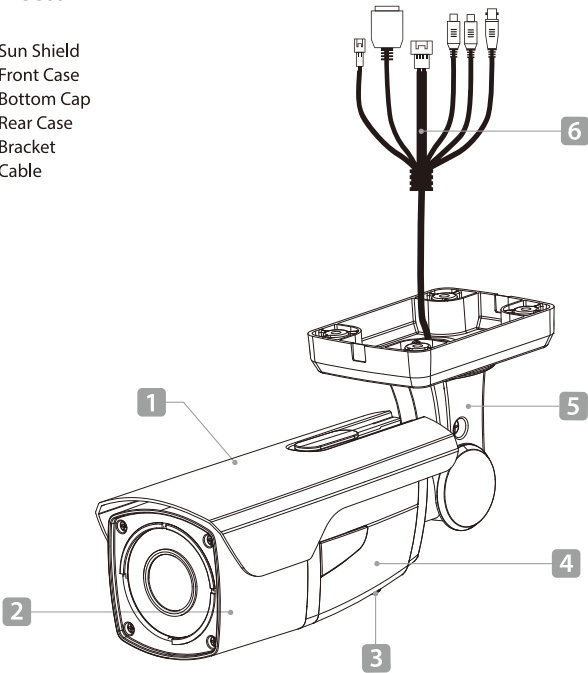

Cables

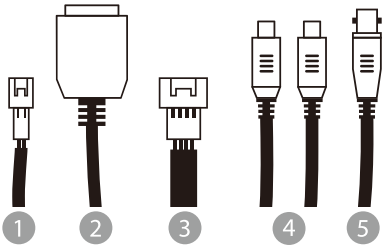

- 1. Power Cable**
Cable for power source.
- 2. P.O.E. / Ethernet connector**
Power Over Ethernet enabled RJ45 connection for video transmission and power source. Power over Ethernet only available if connected to PoE network device.
- 3. Alarm In/Out**
Camera supports use of 1 alarm input, and 1 alarm output connection.
- 4. Audio Jack**
For use with audio equipment. (Audio IN (Yellow), OUT(Red))
- 5. HD VIDEO**
BNC cable outputs for use with HYDRA HD™ recorders. (Output:1080p)

Adjustments

Adjusting Camera View

1. Install the mounting bracket at the desired location. Using the supplied screws, secure the mount base to the wall or the ceiling.
2. Loosen the screw on the side of the bracket with a screwdriver, then adjust the camera angle as shown. Tighten the screw firmly after the camera has been angled correctly.

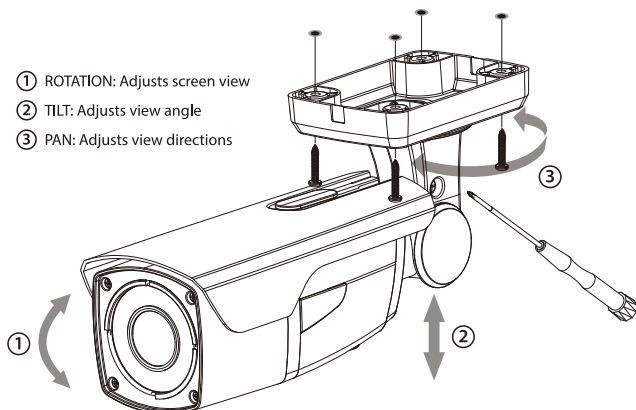

3. After the adjustments, slide the sun-shield onto the camera.

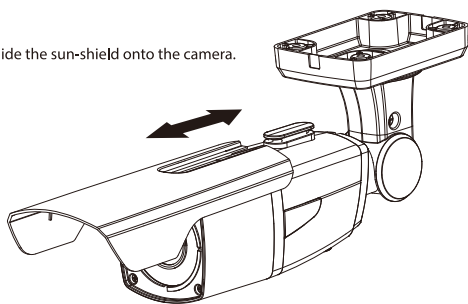

CAUTION To avoid smear, do not expose the camera directly to a strong light source such as the sun or spot light.

Vari-focal, DC Auto Iris Lens

1. Unscrew the front case from the rear case.
2. Loosen the zoom & focus levers and make necessary adjustments.
 - To widen the viewing angle turn the Zoom screw to "W" (Wide) to obtain a closer view turn it to "T" (Tele).
 - Turn the Focus screw to "N" (Near) or "∞" (Far) until the sharpest focus is made.
3. Tighten the front case back to the rear case.

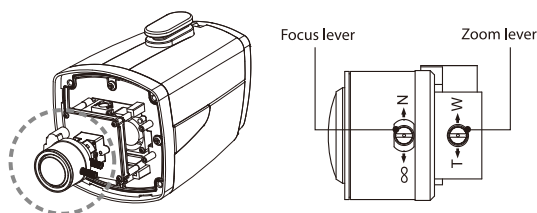

Installation (BNC with HYDRA HD™ recorders)

Connect the cables to the connectors on the camera unit before installation.

- 1) Connect the power input cables to a **DC12V** power supply.
- 2) Alarm In/Out cable
- 3) BNC cable to HD connector
- 4) Audio cable to audio In/Out connector.

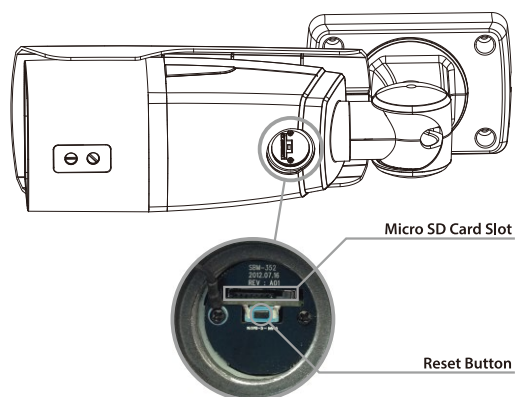

Reset

The HD Hybrid Camera has a reset button inside of the camera (See Location). Use this button to reset the camera.

- 1) Press the Reset button for 1 second.
- 2) Camera will take approximately 40 seconds to complete resetting to default.

Micro SD Card Slot

Remove the bottom cap of camera to insert the SD memory card.

Connecting the Power

Power can be supplied to the camera as follows:

- 1) **DC 12V, Red (+), Black (-)**
- 2) **P.O.E.**
 - Input Voltage : PoE (IEEE802.3af),
 - Input Voltage Range : PoE (36~57V)
 - Input Current : PoE (0.35Arms)

Connecting to the BNC

Our IP-Over-Coax technology allows you connect HYDRA HD™ cameras to HYDRA HD™ recorders using coaxial cable directly.

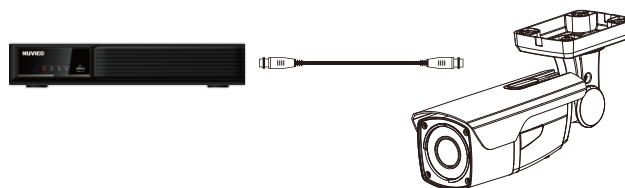

Installation (using ONVIF)

HYDRA HD™ recorders allocate IP addresses for each camera automatically by using the Auto IP Scan function.

HYDRA HD™ cameras support the use of the IP Discovery tool to discover and configure HYDRA HD™ Cameras.

A web based GUI is also available via network connection.

- Default IP : 192.168.0.251
- ID : admin
- Password : 000000

For installation tools and configuration manuals.

Please go to www.nuvico.com