

MODULAR SIMPLI-FLEX[®]

ESF-1002L/ESF-1015L ICE CREAM CONE DISPENSER INSTRUCTIONS

MOUNTING THE DISPENSER:

Elevator type dispensers may be mounted in any position.

1. Position wall brackets (no. 9) in desired location allowing sufficient height to dispense.
2. Mark location of screw holes on mounting surface.
3. Pre-drill holes for #10 x 3/4" mounting screws (no. 8) provided.
4. Screw wall brackets to mounting surface. **NOTE: screw anchors may be necessary when mounting on drywall or other thin substrate.**
5. Position dispenser tube brackets (no. 10) over wall brackets. Slide dispenser into wall bracket until snug.

LOADING THE DISPENSER:

Your Modular SIMPLI-FLEX[®] dispenser model ESF-1002 is completely self adjusting and can dispense virtually any shape of ice cream cone! See application chart on reverse for popular cone size cross reference. **Please clean dispenser before use - see below.**

1. Unwrap cones and gently push into dispenser tube, **BOTTOM OF CONE FACING OUT.**

CLEANING THE DISPENSER

All ice cream cones will chip and flake slightly. Your Modular SIMPLI-FLEX[®] dispenser is designed to minimize cone damage and provide an easy, means of dispensing. The dispenser can be completely disassembled without tools to make regular cleaning simple and painless! Regular cleaning will prolong the life of the dispenser, keep it looking new and ensure sanitary dispensing.

TO CLEAN DISPENSER:

1. Remove dispenser from wall or mounting location. Refer to figure 1.
2. Remove lid (4), clamp ring (3), gasket (2), spring (14), pusher (13) and optional sneeze guard (12).
3. Clean lid, clamp ring, gasket and sneeze guard in hot, soapy water. Air dry. **Note: these parts are dish washer safe.**
4. Rinse inside of dispenser tube and wipe with a non-toxic cleaner/sanitizer.
5. Exterior of tube may be cleaned with any glass cleaner and a soft cloth.
6. Reassemble dispenser in reverse of above.

FIGURE 1

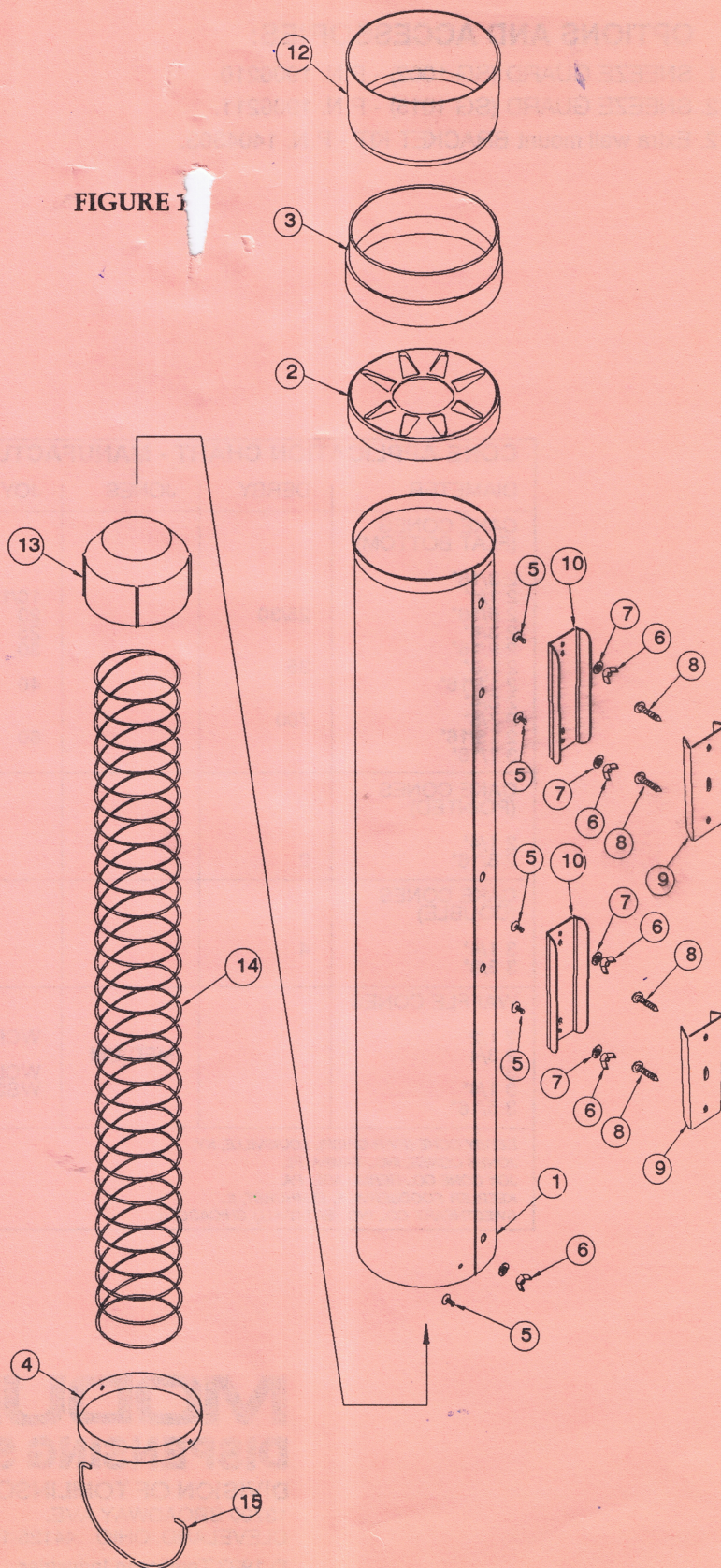

SPECIFICATIONS

DISPENSERS:

1. SIMPLI-FLEX® Dispenser (ESF-1002SL) - P.N. 1003854.
2. SIMPLI-FLEX® Dispenser (ESF-1015SL) - P.N. 1003855.

OPTIONS AND ACCESSORIES:

1. SNEEZE GUARD (SG-1002) - P.N. 1906210.
2. SNEEZE GUARD (SG-1015) - P.N. 1906211.
2. Extra wall mount BRACKET KIT - P.N. 1404303.

CONE APPLICATION CHART - MANUFACTURER/NUMBER					
DIAMETER	DERBY	JONES	JOY	KEEBLER	SWEETHEART
CAKE CONES (FLAT BOTTOM)					
2 3/16"					10
2 1/4"			10/15	33308	25/210
2 5/16"	25/30		20	33324	
2 3/8"			25		8/115
2 9/16"			30		
2 5/8"	35		40	33357	34
2 11/16"				33365	40
2 3/4"					
2 7/8"	700		60		70
2 15/16"					62
3 1/16"					
CAKE CONES (POINTED)					
2 1/4"				35915	1
2 3/16"	2				
CAKE CONES (DOUBLE)					
3 1/4"	4				119
3 3/8"					
WAFFLE CONES					
2 1/2"			WCR198		
2 3/4"					
3"		MEDIUM	WCL180		180DC
3 1/4"			WS225		180DCL
3 5/16"				39180	
DERBY CONE (EV-R-CRISP), LOUISVILLE, KY. JONES CONES, INC., TAMPA, FL. JOY CONE CO., HERMITAGE, PA. KEEBLER FOODSERVICE, ELMHURST, IL. SWEETHEART CO., INC. (EAT-IT-ALL) CHICAGO, IL.					

MODULAR®
DISPENSING SYSTEMS
 DIVISION OF TOMLINSON INDUSTRIES
 13700 BROADWAY AVE.
 CLEVELAND, OHIO 44125-1992
 © 1993 Tomlinson Industries