

Lever Retainer

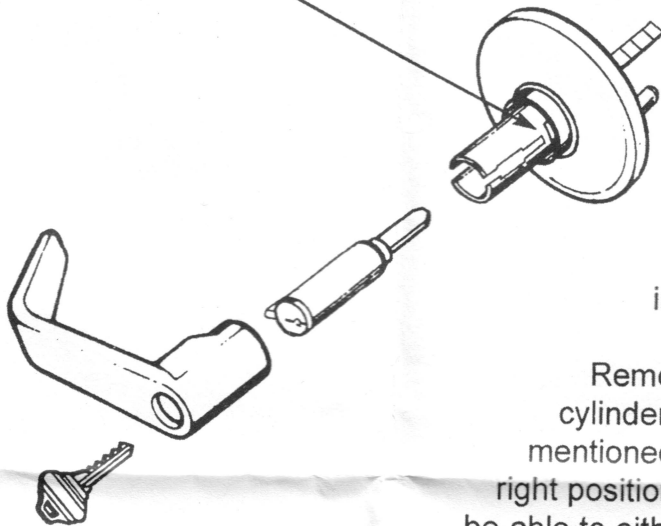

Removing and installing cylinder LHL500:

Turn Key clock-wise 90 degrees, this will lock the lever handle and permit you to push down Lever Retainer pin and disengage lever from lock. Please memorize the cylinder tail piece position, this will aid you in putting the lever back together and speed your installation process.

Remove black plastic cylinder retainer then remove cylinder. After performing service needed, reverse process mentioned above making sure that cylinder tail piece is in the right position. If tail piece is not in proper position, you will not be able to either assemble lock or remove key from cylinder.

Removing and installing cylinder BKL500:

Turn Key clock-wise 90 degrees, this will lock the knob and permit you to push down retainer and disengage knob from lock. Please memorize the cylinder tail piece position, this will aid you in putting the knob back together and speed your installation process.

Remove Cylinder Cap then remove Cylinder. After performing service needed, reverse process mentioned above making sure that cylinder tail piece is in the right position when cylinder was first removed. If tail piece is not in proper position, you will not be able to either assemble lock or remove key from cylinder.

Knob Retainer

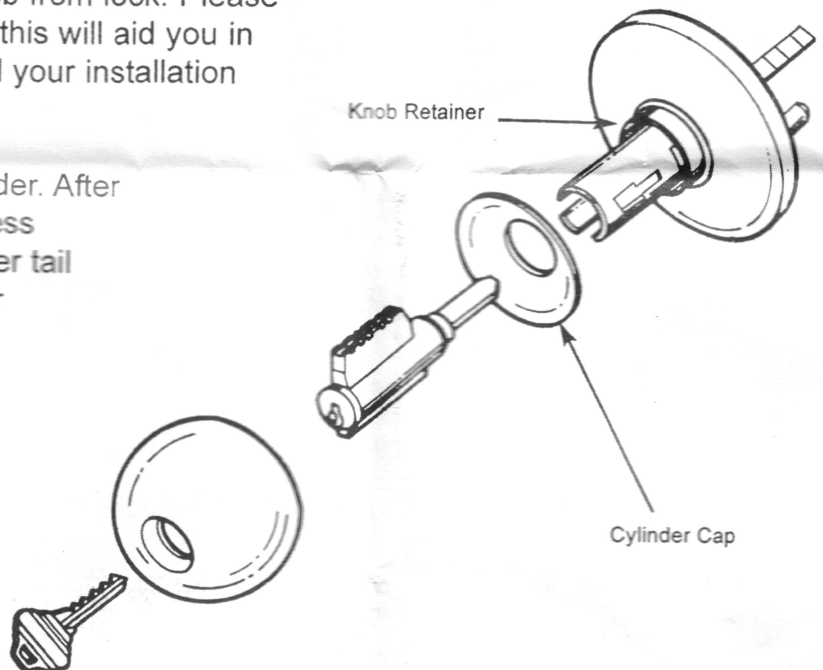

Cylinder Cap