

# **Safety Technology International**

Catalogs  
Master Index

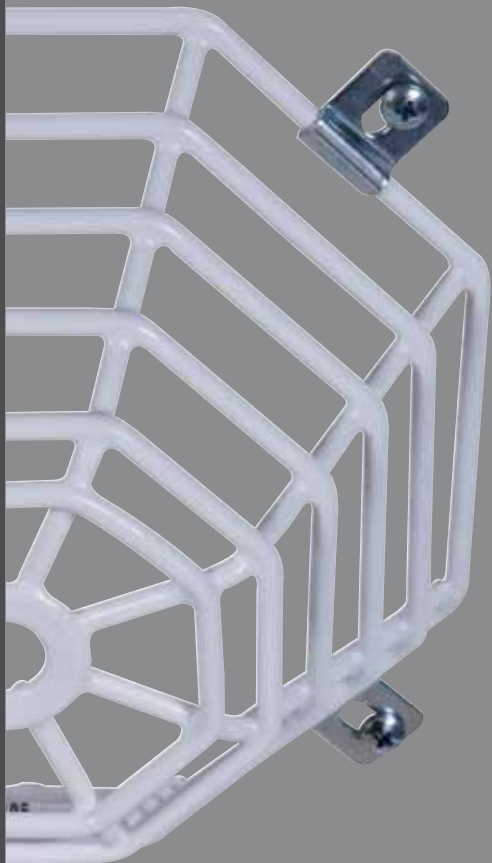



**Safety Technology  
International**



Product Catalog

[www.sti-usa.com](http://www.sti-usa.com)



It all started with  
The Original Stopper®

## ABOUT STI

# It all started with a solution to a challenge

### Who We Are

Family owned and operated for over 35 years, we take great pride in STI's products and exemplary service. Our entire team works just as hard to make you a satisfied customer as we do to make the world a safer place, one product at a time.

### What We Do

STI manufactures protective polycarbonate covers, enclosures, push buttons, wire cages and wireless alarms to help prevent theft and vandalism to important fire and safety devices. Covers and cages protect: detectors, lights, manual pull stations, and much more. Alarms protect: fire extinguishers, exit doors, etc. Many options and variations of products are available to protect the things that protect you.

### Where We Came From

The STI story begins three decades ago with a challenge made by a suburban Detroit school administrator who wanted to stop false fire alarms. Our Founder, Jack Taylor, used his expertise in security systems to invent the original Stopper® pull station protector. Today, STI has hundreds of innovative products that help make homes, businesses and workplaces around the world safe, smart and secure.

Learn more at [www.sti-usa.com](http://www.sti-usa.com)

## TABLE OF CONTENTS

### FIRE & SAFETY

Stopper II®	5
Weather Stopper®	5
Universal Stopper®	5
Break Glass Stopper®	5
Horn/Strobe/Damage Stopper®	6
Stopper® Dome	6
Horn/Strobe/Speaker	
Damage Stopper®	7

### ENCLOSURES, COVERS & CAGES

Metal Protective Cabinet		AED Protective Cabinets	14
with AC/Heat	9	Access Control Housing	14
Heated Polycarbonate Enclosure	9	Bopper Stoppers®	15
Stopper® Heated Enclosures	9	Single-Gang Protective Cover	15
Universal Stopper® Dome/Low		Bio Protectors	15
Profile	11	Thermostat Protector	15
Polycarbonate Covers/Enclosures		Smoke Detector Cages	17
/Cabinets	13	Exit, Clock/Bell, Camera, Light,	
Metal Protective Cabinets	13	Motion Detector Cages	18

### BUTTONS & SWITCHES

Stopper® Station Built It	21
Stopper® Stations	22
Universal Button	23
Momentary Emergency	
Button Kit	23
Universal Touch Free	23
Universal Pneumatic Button	23
Global ReSet	23

### HOME & WORK SERIES

Wireless Entry Alert®	25
Wireless Motion-Activated Sensor	25
Wireless Doorbell Chime	25
Rex Plus II® Electronic Watchdog	25

### WIRELESS PRODUCTS

Wireless Receivers	27
Wireless Transmitters	28
Wireless Exit Stopper®	29
Stopper® Station with Shield	29
Fire Extinguisher Theft Stopper®	29

### VANDALISM & THEFT

Exit Stopper®	31
Fire Extinguisher Theft Stopper®	31
Select-Alert Alarm	31
CCTV Housing	31

Indoor/outdoor polycarbonate cover helps stop false fire alarms without restricting legitimate operation of pull stations. It is ideal for schools, hospitals, nursing homes, stores, hotels and public buildings of almost every kind.

Other colors and models available. Three year guarantee against breakage of polycarbonate in normal use (one year on electro mechanical and electronic components).

## FIRE & SAFETY

# Universal Stopper®

### DESIGN

Protective cover with horn. Prevents false fire alarms, without hindering legitimate operation of a manual pull station in the event of an emergency.

### INSTALLATION

Quick & easy protection in minutes. Can accommodate flush or surface mount applications. Gaskets included.



### ELECTRONICS

95/105 dB self-contained alarm draws immediate attention to the area. Available with or without horn, powered by an included battery.

### CONSTRUCTION

Tough, clear UV-stabilized polycarbonate material. Housing can take the severest knocks preventing vandalism or accidental damage to the manual pull station.



1



2



3



4



5

#### 1. Stopper II®

Protective cover prevents false fire alarms. Does not restrict legitimate access. Self-contained alarm.

*STI-1100 Horn, Flush*

*STI-1130 Horn, Surface*

*STI-1200 Flush*

*STI-1230 Surface*

#### 2. Weather Stopper®

Waterproof cover protects pull stations, push buttons and more against ingress of dust or water.

*STI-3150*

*Without Horn, Surface*

*STI-1250*

*Without Horn, Flush*

#### 3. Universal Stopper®

Indoor/outdoor cover protects pull stations, push buttons and more.

*STI-13010FR Flush*

*STI-13020FR Horn, Flush*

*STI-13210 Surface*

*STI-13220FR Horn, Surface*

#### 4. Universal Stopper®

Indoor/outdoor cover protects pull stations, push buttons and more.

*STI-13410FR Without Horn, Enclosed Back Box, Sealed Mounting Plate, Surface*

*STI-13520FR Horn, Enclosed Back Box, Open Mounting Plate, Surface*

#### 5. Break Glass Stopper®

Designed for areas where a "break glass" cover is specified. Simple glass replacement.

*STI-6100 Small*

*STI-4100 Large*

*STI-4130 Large, with Spacer*



### 1. Horn/Strobe Damage Stopper®

Polycarbonate cover, slotted for horn and/or strobe appliances.

STI-1210D  
Open Back Box, Conduit Knockout

STI-1210A  
Encl. Back Box, 4" Deep

STI-1210B  
Encl. Back Box, Double-Gang Outlet Box

STI-1210C  
Open Back Box, External Mounting Tabs

STI-1210E  
Open Back Box, Flush



### 2. Strobe Damage Stopper®

Polycarbonate cover, solid for a strobe only unit.

STI-1221A  
Encl. Back Box, 4" Deep

STI-1221B  
Solid Encl. Back Box, Double-Gang Outlet Box

STI-1221C  
Open Back Box, External Mounting Tabs

STI-1221D  
Open Back Box, Conduit Knockout

STI-1221E  
Open Back Box



### 3. Stopper® Dome

Polycarbonate cover slotted for horn/strobe or speaker/strobe units

STI-1215  
Flush Mount

STI-1217  
Open Back Box

STI-1219  
Enclosed Back Box



1



The only  
UL Listed  
wire cage



2



3



4



#### 1. Horn/Strobe/Speaker Damage Stopper®

Wire guard provides protection for System Sensor SpectrAlert® series notification appliances.

STI-9708-R  
Surface Mount, Red

STI-9708  
Surface Mount, White

#### 2. Horn/Strobe/Speaker Damage Stopper®

Wire guard provides protection for System Sensor SpectrAlert® series notification appliances.

STI-9705  
Flush Mount, White

STI-9705-R  
Flush Mount, Red

#### 3. Horn/Strobe/Speaker Damage Stopper®

Wire guard provides protection for System Sensor units.

STI-9720  
Surface Mount

STI-9717  
Flush Mount

#### 4. Horn/Strobe/Speaker Damage Stopper®

Wire guard provides protection for System Sensor SpectrAlert® Series notification appliances.

STI-9711  
Flush Mount, White

STI-9714  
Surface Mount, White



With STI's environmental enclosures you can reduce costly equipment replacement and repairs, and assure operation of important devices.

Many models available. Three year guarantee against breakage of polycarbonate in normal use (one year on electro mechanical and electronic components).

## COVERS & CAGES

# Environmental Cabinets

### DESIGN

Protective cover with heat. Protects a wide range of devices, components and sensitive units from vandalism and accidental damage as well as weather, dirt, dust and grime.



### ELECTRONICS

With or without heat and/or AC. Heater offers three thermostats. Radiant heat plate prevents LCD from becoming sluggish or freezing. Operates on 12, 16.5, or 24 VAC/VDC.

### INSTALLATION

Several mounting options available. With or without lock. Mounting hardware and gaskets included.

### CONSTRUCTION

Tough, clear UV-stabilized polycarbonate material. Powder coated metal helps protect against corrosion.



1



2



3



4



5

### 1. Metal Protective Cabinet

Heavy-duty metal enclosure with A/C & heat.

STI-7560AC  
A/C, Window

STI-7560AH  
A/C, Heat, Window

STI-7561AC  
A/C, No Window

STI-7561AH  
A/C, Heat, No Window

### 2. Heated Polycarbonate Enclosure

Tough polycarbonate cover with heat.

STI-7520-HTR  
Key Lock

STI-7521-HTR  
Thumb Lock

### 3. Heated Polycarbonate Enclosure

Tough polycarbonate cover with heat.

STI-7510A-HTR  
Key Lock, Encl. Deep Back Box

STI-7510F-HTR  
Key Lock, Encl. Back Box

Thumb Lock Models Available

### 4. Stopper II® Heated Enclosure

Cover protects devices where temperatures or environmental conditions exceed operating range.

STI-1200A-HTR Heated  
Enclosure, 110VAC

STI-1200A-HTR240  
Heated Enclosure, 240VAC

### 5. Stopper® Dome Heated Enclosure

Type 4X environmental enclosure with heater for strobes only.

STI-1229HTR  
110VAC

STI-1229HTR240  
240 VAC

Indoor/outdoor polycarbonate cover helps prevent malicious or accidental damage to manual call points, electrical switches and more. It is ideal for public buildings of almost any kind.

Other colors and models available. Three year guarantee against breakage of polycarbonate in normal use (one year on electro mechanical and electronic components).

## COVERS & CAGES

# Universal Stoppers<sup>®</sup>

### DESIGN

Protective cover with or without horn. Prevents malicious or accidental damage to manual call points, electrical switches and the like.

### INSTALLATION

Quick and easy protection in minutes. Can accommodate flush or surface mount applications. Gaskets included.



### ELECTRONICS

95/105 dB self-contained alarm draws immediate attention to the area. Available with or without horn, powered by an included battery.

### CONSTRUCTION

Tough, clear UV-stabilized polycarbonate material. Housing can take the severest knocks preventing vandalism or accidental damage to the manual pull station.



#### 1. Universal Stopper®

Tough indoor/outdoor dome polycarbonate cover protects indoor/outdoor devices.

*STI-13310CG - Green  
Enclosed Flush Back Box,  
Custom Label*

*STI-13320CG - Green  
Horn, Enclosed Flush Back  
Box, Custom Label*

#### 2. Universal Stopper® Flat Low Profile

Tough indoor/outdoor low profile polycarbonate cover protects indoor/outdoor devices.

*STI-14400NY - Yellow  
Enclosed Back Box, Sealed  
Mounting Plate, No Label*

*STI-14500NY - Yellow  
Enclosed Back Box Open  
Mounting Plate, No Label*

#### 3. Universal Stopper® Dome

Tough indoor/outdoor dome clear polycarbonate cover protects devices.

*STI-13000NC  
Flush Mount*

*STI-13200NC  
Surface Mount*

*STI-13300NC  
Enclosed Flush Back Box*

#### 4. Universal Stopper® Flat Low Profile

Tough indoor/outdoor low profile clear polycarbonate cover protects devices.

*STI-14000NC  
Flush Mount*

*STI-14200NC  
Surface Mount*

*STI-14300NC  
Backplate for Flush Devices*

Shown are examples of our many different cover options. Use our online configurator to build your perfect cover.

[www.sti-usa.com/c1](http://www.sti-usa.com/c1)

With STI's polycarbonate covers, you can reduce costly equipment replacement and repairs, and assure operation of important safety and security devices.

Many models available. Three year guarantee against breakage of polycarbonate in normal use (one year on electro mechanical and electronic components).

## COVERS & CAGES

# Polycarbonate Protectors

### DESIGN

Helps protect a wide range of devices from vandalism and accidental damage while still allowing them to be accessible.

### INSTALLATION

Several mounting options available. With or without lock. Most models include mounting hardware.

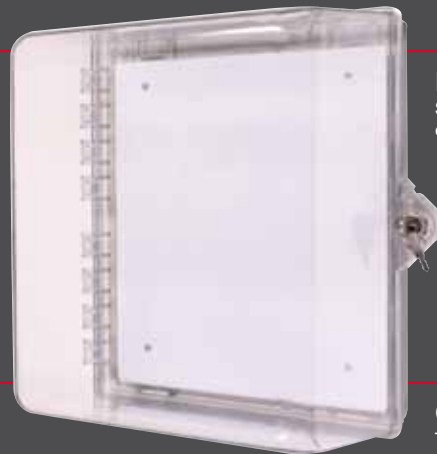

### ELECTRONICS

Select models available with a choice of alarm.

### CONSTRUCTION

Tough, clear UV-stabilized polycarbonate material.



1



2



3



4



5

#### 1. Polycarbonate Cover

Polycarbonate cover protects against vandalism and accidental damage.

STI-7730

Enclosed Back Box,  
Gasket, Lock

STI-7700

Open Back Box

STI-7710

Open Back Box, Lock

#### 2. Polycarbonate Enclosure

Multipurpose lockable enclosure with multiple back box options.

STI-7510A

Enclosed Deep Back  
Box

STI-7510B

Enclosed Back Box with  
Double-Gang Electrical Box

#### 3. Type 4X Protective Cabinet

Multipurpose lockable cabinet protects fire alarm controls and more against abuse and the environment.

STI-7520

Key Lock

STI-7521

Thumb Lock

#### 4. Metal Protective Cabinets

Enclosures for electrical and electronic equipment provide protection from hazardous parts.

STI-EM07123.5

STI-EM08073.5

STI-EM111103

STI-EM111504

STI-EM121204

STI-EM151804

#### 5. Type 4 Metal Protective Cabinets

Enclosures for electrical and electronic equipment provide protection from hazardous parts.

STI-7560

With Window

STI-7561

No Window



1



2

### 1. AED Protective Cabinet

Clear, polycarbonate cabinet for remote AED units requiring physical protection.

*STI-7535AED*  
Thumb Lock, Siren/Strobe

*STI-7531AED*  
Thumb Lock

### 2. Access Control Housing

Water resistant, sealed off-white cabinet mounts to a wall or pedestal. Ideal for access controls, keypads and wireless equipment.

*STI-7510A-OW*  
Key Lock, Enclosed Deep White Back Box

*STI-7520-OW*  
Key Lock, Backplate

*STI-7730-OW*  
Key Lock, Gasket, Enclosed Back Box



1



2



3



4



5

### 1. Bopper Stopper®

Cover with spring loaded hinge protects everything from electrical outlets to push buttons.

STI-6518  
Polycarbonate Cover

### 2. Single-Gang Protective Cover

Hinged polycarbonate cover has mounting plate molded into frame.

STI-6519  
Polycarbonate Cover

### 3. Mini Bopper Stopper®

Protective cover's stainless steel torsion spring maintains cover in a closed position.

STI-6516  
Clear Polycarbonate

### 4. Bio Protector

Identification reader cover helps protect fingerprint readers and similar devices.

STI-6520-S  
Smoke Color

STI-6520-C  
Clear Polycarbonate

### 5. Thermostat Protector

Holes in frame allow air to circulate freely for proper operation of protected thermostats, while second inner wall prevents tampering. Three sizes.

STI-9100  
Key Lock



These heavy-duty steel cages are designed to protect smoke detectors, PIRs, exit signs and more from vandalism and misuse, while leaving the devices fully accessible and operational.

Three year guarantee against breakage in normal use.

## COVERS & CAGES

# Steel Web Stoppers®

### DESIGN

These steel cages are designed to protect devices from vandalism and misuse. Designed so there is no interference with the operation of the protected unit.

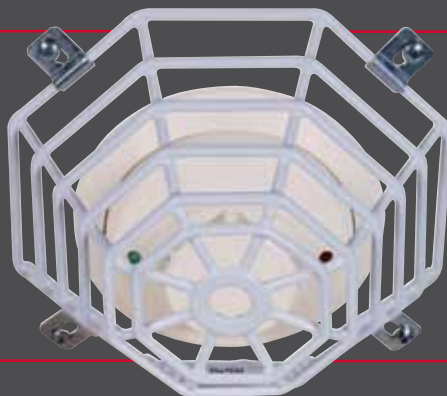

### OPTIONS

Stainless steel versions are available for flush or surface mount applications. Where additional security is required from theft or misuse, tamper resistant bits are available.

### INSTALLATION

Quick and easy installation, can retrofit and protect units within minutes.

### CONSTRUCTION

Constructed of 9-gauge steel wire with corrosion resistant polyester coating or 9-gauge stainless steel wire.

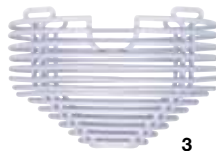

#### 1. Steel Web Stopper®

Steel wire guard helps protect smoke detectors where abuse is severe. Six sizes available.

STI-9604  
Flush

STI-9605  
Surface

See website for other sizes.

#### 2. Beam Smoke Damage Stopper®

Protects costly sensor units of beam type smoke detectors from damage leading to misalignment.

STI-9706  
Flush Mount

STI-9707  
Surface Mount

#### 3. Steel Web Stopper®

Steel wire guard protects photoelectric smoke detectors from abuse and damage.

STI-9712  
For Photoelectric Smoke  
Detector, Surface Mount

STI-9713  
Flush Mount UL Listed

#### 4. Smoke Detector Damage Stopper®

Heavy-duty steel cover for smoke detectors where abuse is severe.

STI-8200-W  
Flush, Coated Steel

STI-8230-W  
Surface, Coated Steel

Stainless Steel also available.

#### 5. Smoke Detector Damage Stopper®

Tough polycarbonate cover extremely effective in reducing malfunctions to smoke detectors where abuse is severe. Available in smoke, white and clear.

STI-8100  
Flush Mount

STI-8130  
Surface Mount

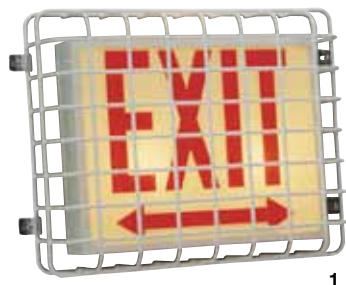

1

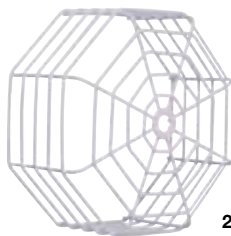

2



3



4



5

### 1. Exit Sign Damage Stopper®

Protects a wide range of exit signs from vandalism and damage.

STI-9640

Small

STI-9740

Large

STI-9741

Ceiling Mount

### 2. Clock/Bell Damage Stopper®

Highly recommended for gymnasiums and other areas where abuse is severe.

STI-9631

10.5" diameter

STI-9632

16.5" Diameter

STI-9633

20" Diameter

### 3. Camera Damage Stopper®

Designed to protect cameras from vandalism and damage.

STI-9729

Small

STI-9730

Large

### 4. Light Damage Stopper®

Protects outdoor lights where vandalism and damage are prevalent.

STI-9703

9-gauge Steel Wire Guard

### 5. Motion Detector Damage Stopper®

Tough cage extremely effective in reducing malfunctions to PIR units where abuse is severe.

STI-9620

9-gauge Steel Wire Guard

STI-9621

9-gauge Steel Wire Guard

STI-9622

9-gauge Steel Wire Guard

ADA Compliant multipurpose buttons/switches cover a wide range of applications indoors and outdoors. A number of standard models are available or STI can create custom units to meet specific needs exactly.

Other colors and models available. Three year guarantee against breakage of polycarbonate in normal use (one year on electro mechanical and electronic components).

## BUTTONS & SWITCHES

# Stopper<sup>®</sup> Stations

### DESIGN

Incorporates a unique, patented design that helps dramatically stop accidental activation.

### INSTALLATION

5VA flammability rating on backplate and spacer.



### ELECTRONICS

Multiple button functions available:

Key-to-Reset, Momentary, Turn-to-Reset, Pneumatic, Key-to-Activate

Three 12-24 volt LED color indicators.

### CONSTRUCTION

Station housing molded of tough polycarbonate. Stainless steel backplate.



BUILD IT YOUR WAY

# Build Your Stopper® Station Push Button



## SS2

### Step 1 Housing Color

0 = red  
1 = green  
2 = yellow  
3 = white  
4 = blue

### Step 2 Cover

3 = Universal Stopper,  
label shell (flush)  
4 = Universal Stopper,  
horn (flush)  
7 = Universal Stopper,  
label shell (surface)  
8 = Universal Stopper,  
horn (surface)  
2 = Shield (flush or  
surface)  
A = Shield with sound  
(flush or surface)  
0 = no cover

### Step 3 Activation

2. Key-to-Reset  
(Illuminated)  
5. Momentary (Illuminated)  
9. Turn-to-Reset  
(Illuminated)  
8. Pneumatic (Illuminated)  
0. Key-to-Reset  
1. Turn-to-Reset  
3. Key-to-Activate  
4. Momentary

### Step 4 Text

AB = ABORT  
EM = EMERGENCY  
EX = EMERGENCY EXIT  
PO = EMERGENCY  
POWER OFF  
ES = EMERGENCY STOP  
EV = EVACUATION  
XT = EXIT  
PS = FUEL PUMP SHUT  
DOWN  
HV = HVAC SHUT  
DOWN  
LD = LOCKDOWN  
PX = PUSH TO EXIT  
NT = No Text  
ZA = Custom Text

### Step 5 Language

EN = English  
ES = Spanish  
FR = French  
ZL = Other language

Custom labeling available (1 line, 13 characters or 2 lines, 20 characters max. including spaces).

**Models shown are examples. Visit our website to see over 3000 buttons.**



1

#### 1. Stopper® Station

ADA Compliant,  
multipurpose button/  
switches covers a wide  
range of applications.

SS2102XT-EN  
Key-to-Reset Illuminated,  
Green, EXIT Label

#### 2. Stopper® Station

ADA Compliant,  
multipurpose button/  
switches covers a wide  
range of applications.

SS2422LD-EN  
Key-to-Reset Illuminated,  
Blue, LOCKDOWN Label  
SS2005EM-EN  
Momentary Illuminated,  
Red, EMERGENCY Label



2

SS2209PS-EN  
Turn-to-Reset Illuminated,  
Yellow, FUEL PUMP SHUT-  
DOWN Label

SS2308ZA-EN  
Pneumatic Illuminated,  
White, CUSTOM Label

SS2102XT-EN  
Key-to-Reset Illuminated,  
Green, EXIT Label



3

#### 3. Stopper® Station

ADA Compliant,  
multipurpose button/  
switches covers a wide  
range of applications.

SS2249AB-EN  
Turn-to-Reset Illuminated,  
Yellow, ABORT Label,  
Universal Stopper® Cover



4

#### 4. Stopper® Station

All buttons available in  
Spanish.

SS2305ES-ES  
Momentary Illuminated,  
White, EMERGENCY STOP  
Label, Spanish



5

#### 5. Stopper® Station

All buttons available in  
French.

SS2402AB-FR  
Key-to-Reset Illuminated,  
Blue, ABORT Label, French



1



2



3



4



5



### 1. Universal Button

Momentary push button offers over 300 combinations in one convenient package.

UB-1  
Universal Button Kit

UB-2  
2" Universal Button

### 2. Universal Button White

This momentary button kit includes a white mounting plate with 2" activation button. Includes green and blue buttons, blue Emergency and green Exit plates, Push and Push to Exit button inserts.

UB-2WEE  
White Universal Button Kit

### 3. Universal Touch Free Button

Button with NoTouch® technology allows user to exit protected door without the touch of a button.

UB-1TF  
Universal Touch Free Button

UB-2TF  
2" Universal Touch Free Button

### 4. Universal Pneumatic Button

Pneumatic adjustable timer opens or closes a circuit and has a timed delay before reset

UB-1PN  
Pneumatic Push Button

### 5. Global ReSet

Resettable call point simulates break glass activation with no broken glass. Versatile mounting plate fits to U.S., European, double-gang and single-gang mounting box.

Available fall 2017

Wireless chimes greet visitors with a pleasant chime and lets you know when the door opens or a person enters the detection zone. All chimes are compatible with each other.

## HOME AND WORK

# Wireless Chimes

### DESIGN

All chimes are compatible with each other.

### INSTALLATION

Quick and easy to install—no wiring needed.



### ELECTRONICS

Up to 500' operating range. Receiver plugs into 120 VAC outlet and has a low and high volume adjustment. 433 MHz.

### CONSTRUCTION

UL/cUL Listed, FCC and IC Certified.



**Longest range  
on the market**



#### 1. Wireless Entry Alert®

Alerts when a door is opened. 500' operating range.

STI-3360  
Chime with Receiver

#### 2. Wireless Motion - Activated Sensor

Alerts when someone enters detection zone. 500' operating range.

STI-3610  
Chime with Receiver

#### 3. Wireless Doorbell Chime

Alerts when doorbell button is pressed. 500' operating range.

STI-3350  
Button with Receiver

#### 4. Rex Plus II® Electronic Watchdog

This barking dog will "see" through walls and detect movement alerting of a visitor or intruder.

ED-55  
Barking Dog Alarm

Easily monitor doors, windows, pools, driveways, mailboxes—without wires! Receivers monitor up to 4 or 8 different STI devices and will chime or speak custom voice messages when a monitored transmitter is triggered.

## WIRELESS PRODUCTS

# Wireless Receivers & Transmitters

### DESIGN

Receiver will sound programmable voice messages (English or Spanish), alerting a monitored area has been tripped.

### ELECTRONICS

Multiple transmitters. 433 MHz. Color LED zone indicators.

### INSTALLATION

Easy installation. Operates up to 1000' line of sight range between transmitters and receiver.

### CONSTRUCTION

Supervised battery and signal reception.





1



2



3



4

#### 1. Single Channel Slave Receiver

Small-sized receiver works in conjunction with a control panel.

*STI-34098*

#### 2. 4-Channel Voice Receiver

Sounds selectable tone or voice messages when alerted (select up to 4 of 53 words and 10 tones, English or Spanish). Supervised by zone, 433 MHz.

*STI-V34104  
4-Channel Voice Receiver*

#### 3. 8-Channel Receiver

Monitors up to 8 different STI transmitters.

*STI-34108  
8-Channel Receiver*

#### 4. Repeater

Extends the range of STI receivers up to an additional 1000'.

*STI-34109  
Extends range of STI-V34104 and  
STI-34108 Receivers*



#### UNIVERSAL TRANSMITTERS

For use with any STI Receiver (pg. 25).

Up to 1000' range (longest in industry).

433 MHz.

#### 1. Universal Alert

Will let a user know if a monitored site is tripped. Use as magnetic contact, tilt switch or remote contact.

STI-34401

#### 2. Wireless Indoor Motion Detector

Alerts when the sensor detects movement in a monitored area.

STI-34701

#### 3. Wireless Outdoor Motion Detector

Alerts when the sensor detects movement in a monitored area.

STI-34752

#### 4. Wireless Doorbell Button

Use as a doorbell button, call for a reception area or patient call. Operates up to 500' (line of sight).

STI-34601



#### 1. Wireless Exit Stopper®

Multifunction door alarm alerts to any unauthorized exits or entries.

*STI-6400WIR*

*Works with STI Receivers*

#### 2. Wireless Exit Stopper® for Double Door

Alarm alerts to any unauthorized use of double doors.

*STI-6402WIR*

*Works with STI Receivers*

#### 3. Stopper® Station Button with Stopper® Station Shield, Sound and Transmitter

Alerts when cover is lifted and sends signal to STI receiver.

*SS24A9LD-EN*

*Works with STI Receivers*

#### 4. Fire Extinguisher Theft Stopper®

Sounds warning horn and sends signal to STI receiver when extinguisher is moved.

*STI-6200WIR*

*Works with STI Receivers*

STI's highly effective alarm can help lessen the fear of security concerns. It helps stop unauthorized exits and entries into a building, as well as theft. When activated, it emits a piercing horn.

Many models available. Three year guarantee against breakage of polycarbonate in normal use (one year on electro mechanical and electronic components).

## VANDALISM & THEFT

# Alarms

### DESIGN

Highly visible "stop sign" design acts as a deterrent.



### ELECTRONICS

Set to sound for 30 seconds, 3 minutes or indefinitely. 95/105 dB warning horn.

### INSTALLATION

May be mounted on top, right, left or next to almost any door. Unit is completely self-contained.

### CONSTRUCTION

Virtually indestructible polycarbonate housing.



1



2



3



4



5

#### 1. Exit Stopper®

Multifunction door alarm alerts to any unauthorized exits or entries through protected door.

STI-6400  
Multifunction Door Alarm

#### 2. Exit Stopper® Double Door

Multifunction double door alarm alerts when protected door is opened.

STI-6402  
Double Door Alarm

#### 3. Fire Extinguisher Theft Stopper®

Alarm helps stop theft, vandalism or misuse of fire extinguisher without hindering legitimate use.

STI-6200  
Fire Extinguisher Alarm

#### 4. Select-Alert Alarm Mini Controller

Alarm and flashing LEDs alerts to any unauthorized use of important devices. Offers 32 siren choices, 5 colors. Separate alarm and strobe timing. Can be used for: access control button, alarm with cabinet, exit strobe, and more.

STI-SA5000-R  
Red

#### 5. CCTV Housing

Housing protects CCTV cameras from vandalism and tampering.

STI-7100K  
Aluminum with Heater, Blower, Sun Shield and Mounting Bracket



**Safety Technology  
International**

STI Corporate Headquarters 2306 Airport Road Waterford, MI 48327 U.S.A.

Phone: 248-673-9898 Toll-free: 800-888-4784 [www.sti-usa.com](http://www.sti-usa.com)



# Fire Protection Collection

working around the clock and around the world,  
stopping false fire alarms, vandalism and theft



*"We protect the things that protect you."*



**Safety Technology International, Inc.**



STI-1100



This unique and patented device has helped stop false fire alarms around the world for over 30 years, without restricting legitimate alarms. It is ideal for schools, colleges, hospitals, nursing homes, stores, hotels and public buildings of almost every kind where there is a threat of false fire alarms.

Stopper II consists of a clear, tamperproof, tough polycarbonate shield and frame that fits over manual pull stations. When lifted to gain access to the actual alarm, it sounds a piercing 95 or 105 dB or warning horn. Immediate attention is drawn to the area and a prankster will either run or be caught.

## FEATURES

- Proven effective for over 30 years in helping stop false fire alarms without restricting legitimate alarms.
- Three year guarantee against breakage of polycarbonate in normal use (one year on electro mechanical and electronic components).
- Can be used as a guard against physical damage to a manual pull station, with or without the optional warning horn.
- Available in red, blue, green or yellow with custom labeling.
- Larger sizes and surface mounted pull stations accommodated with STI-3100 conduit spacer.
- Weather resistant gaskets available. UL requires stations to be listed for outdoor use with cover (see STI-1250 spec sheet).
- Fits virtually all manual pull stations.
- Cover is UV-stabilized.
- Tested and accepted by fire prevention authorities and approved by testing organizations.
- Power source is 9 VDC alkaline battery on standard Stopper II. (Remote powered unit is available).
- Optional horn has choice of 95 or 105 dB.
- Polycarbonate tested -40° to 120°F (-40° to 49°C).

## Dimensions and Technical Information

- STI-1100** With horn for flush mounting
- STI-1130** With horn and conduit spacer for surface mounting
- STI-1200** Without horn for flush mounting
- STI-1230** Without horn, shipped with conduit spacer for surface mounting
- STI-1100R\*** For flush mounting with 24 VDC remote powered horn
- STI-1130R\*** Surface mounted version of the STI-1100R. Includes conduit spacer
- STI-1100C9\*** With battery powered horn and relay trigger for flush mounting
- STI-1130C9\*** Surface mounted version of the STI-1100C9. Includes conduit spacer
- STI-1100RC\*** With 24 VDC remote powered horn and relay contacts for flush mounting
- STI 1130RC\*** Surface mounted version of the STI-1100RC. Includes conduit spacer

\*These models not tested with UL or other listing agencies.

**NOTE:** For weather resistant models, please refer to STI Weather Stopper®. (STI-1250)

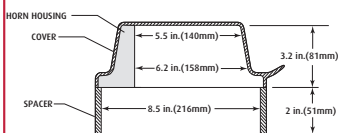

SIDE VIEW  
MODELS WITH HORN (STI-1100 Series)

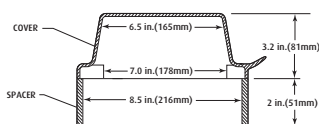

SIDE VIEW  
MODELS WITHOUT HORN (STI-1200 AND STI-3150 Series)

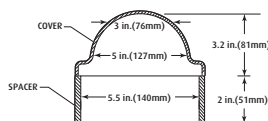

ALL MODELS END VIEW

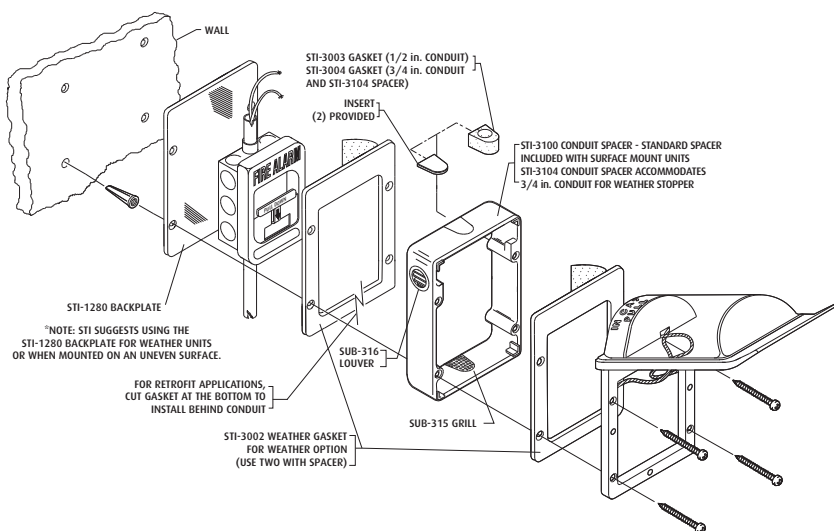

# Stopper II® with Heater



**ADA**  
Compliant

STI-1200A-HTR

The Stopper II is a patented device has helped stop false fire alarms around the world for over 30 years, without restricting legitimate alarms. This Stopper II enclosure with heater allows addressable dual monitor modules to be installed inside or outside in temperatures below UL/ULC Listing limits or in other NEMA 3R environments. UL/cUL and ULC Listing requires outdoor rated stations. The cover offers excellent protection against

physical damage (both accidental and intentional), as well as other environments inside and outside. Also ideal for the inside of walk-in freezers.

Stopper II® with heater consists of a clear, tough polycarbonate shield, frame and heater. The Stopper II is mounted on a NEMA 3R enclosure with a heater which allows an addressable manual pull station to be installed inside or outside in cold temperatures.

## FEATURES

- For use in areas where temperature or environmental conditions exceed the operating range of addressable manual pull stations.
- UL/ULC Listed for dual monitor addressable modules using a standard outdoor listed station down to -70°F (-57°C).
- Enclosure rated to NEMA 3R Standards.
- UL/ULC Listing does not require standby or secondary power for 110 VAC 60 Hz heaters.
- The thick, clear polycarbonate cover is UV-stabilized.
- Fan runs continuously to maintain a uniform temperature inside the enclosure.
- Heater unit cycles as required to maintain the correct range of operating temperature.
- Polycarbonate backed by a three year guarantee against breakage in normal use (one year on electro mechanical and electronic components).

# Stopper II® with Heater

## Dimensions and Technical Information

**Model Available**

**STI-1200A-HTR**

Stopper II with Heater - heated enclosure for addressable dual monitor modules working with manual stations.

**STI-HK3**

Replacement heater.

STI Fire Protection

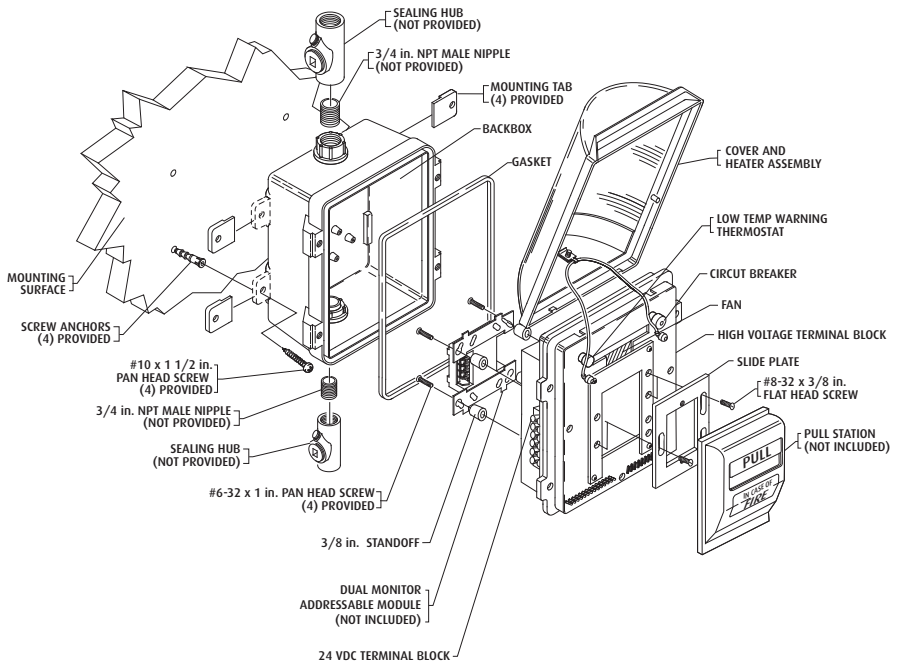
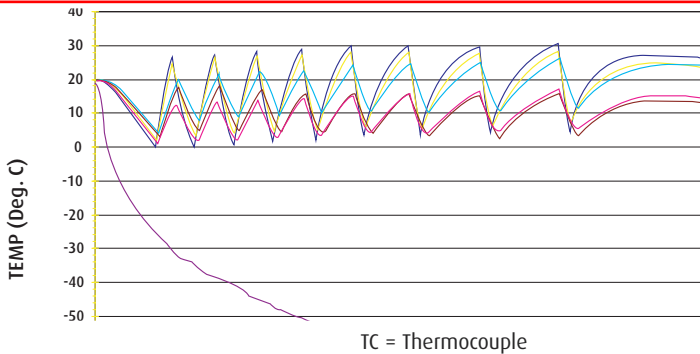



STI-3150



This tough, clear polycarbonate cover helps dramatically to extend the life and reliability of weather exposed manual pull stations, push buttons and similar devices as well as protect them in harsh indoor conditions. Using the same tough cover as the Stopper II® device but without the warning horn, it is especially useful in increasing the lifespan of units in saltwater areas or other severe environments. Two versions are offered:

STI-1250 for flush mounted stations and STI-3150 for surface mounted units.

Because this strong, durable cover can take the toughest knocks, it also guards against physical damage and thereby helps reduce false fire alarms. It is UV-stabilized and in addition protects against damage from dust and grime. Weather Stopper carries a three year guarantee against breakage in normal use.

### FEATURES

- Molded of thick, tough polycarbonate material.
- Protection against physical damage, dust, grime and severe environments inside and out.
- Serves as an inexpensive weather cover as well as helps stop vandalism and accidental damage.
- Fast, easy installation.
- Widely used to extend the life of equipment in saltwater areas such as aboard oceangoing ships, on oil rigs or at beachfront condos.
- UV-stabilized.
- When used outdoors, can pay for itself many times over. (UL requires pull stations to be listed for outdoor use with cover).
- Available in red, blue, green and yellow with custom labeling.
- UL tested to NEMA 3R requirements for weather rating for moisture resistance.
- Three year guarantee against breakage of polycarbonate in normal.
- Polycarbonate tested -40° to 120°F (-40° to 49°C).

## Dimensions and Technical Information

### Models Available

**STI-1250** Without warning horn for flush mount manual pull stations. Includes weather gasket

**STI-3150** Without warning horn for surface mount manual pull stations (those with exposed conduit). Includes two weather gaskets and a conduit gasket

**Note:** Smaller models are available. Please see Mini Weather Stopper® data sheet

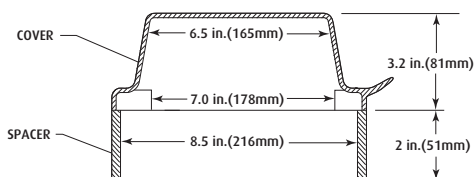
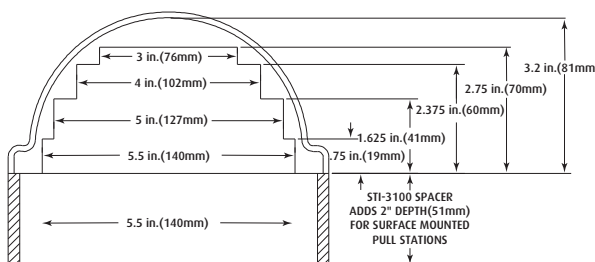

SIDE VIEW

MODELS WITHOUT HORN (STI-1200 AND STI-3150 Series)

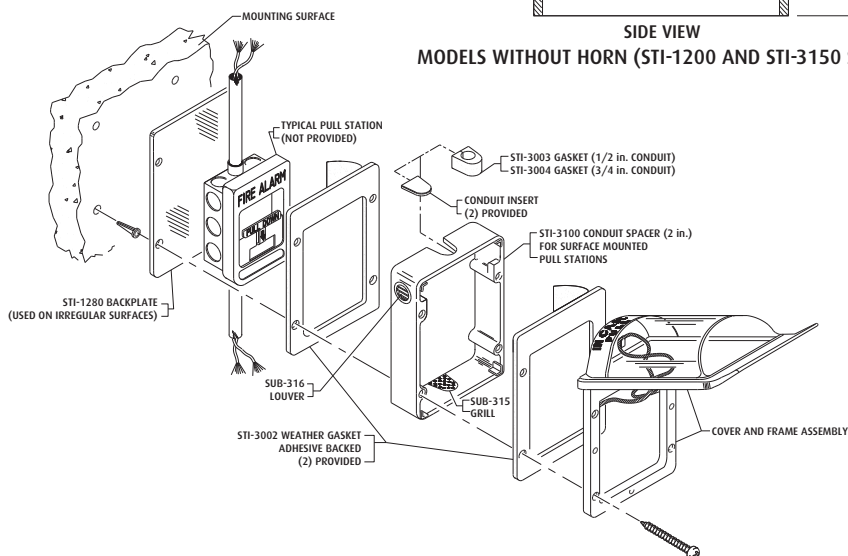



**STI-13010FR**



**STI-13510FR**

These indoor/outdoor covers help protect devices such as dual action pull stations, keypads for entry systems, intercom stations, emergency buttons, electrical light switches, duplex plugs, etc., without restricting legitimate operation. The versatile covers offer excellent protection against physical

damage (accidental or intentional), dust and grime as well as severe environments inside and outside.

Cover options: Dome or low profile, with or without horn, flush mount, surface mount or waterproof backbox models. Maximum protrusion is 4 inches deep.

## FEATURES

- Protects against vandalism, accidental damage, dust and grime and severe environments inside and outside.
- Protects pull stations, keypads for entry systems, intercom stations, emergency buttons, electrical light switches or duplex plugs.
- Flush frame, surface frame or waterproof backbox (with sealed or open internal mounting plate), enclosed flush backbox.
- Build the cover to specific specifications.
- Sized to fit most pull stations.
- High strength continuous hinge.
- Three year guarantee against breakage of polycarbonate in normal use (one year on electro mechanical and electronic components).



## STI Universal Stopper®

Dimensions and Technical Information

### BUILD YOUR MODEL STI-1

#### Cover Options

- 3 = Dome Cover
- 4 = Low Profile Cover\*

\*Only available with Hood/Horn option "0"

#### Mounting Options

- 0 = Flush Mount
- 2 = Surface Mount
- 3 = Enclosed Flush Backbox
- 4 = Enclosed Backbox & Sealed Mounting Plate\*\*
- 5 = Enclosed Backbox & Open Mounting Plate\*\*
- 8 = Enclosed Backbox & European Sealed Mounting Plate\*\*
- 9 = Enclosed Backbox & European Open Mounting Plate\*\*

\*\*all colors except NC

#### Hood/Horn

- 0 = No Label Hood (Label must start with 'N.' If Hood/Horn Option = 0 and Mounting Option = 0 or 3, the label must be NC)
- 1 = Label Hood without Horn\*\*
- 2 = With Horn\*\*
- 3 = With Horn & remote contact & power\*\*

\*\*all colors except NC

#### Special Electronics

- 0 = None
- 1 = Heat (available with Mounting Options 4, 5, 8 & 9)\*\*

\*\*Coming soon

#### Housing/Horn Color & Label

##### Fire label

FR = Red – Fire label

##### No label

NK = Black  
NB = Blue  
NC = Clear  
NG = Green  
NR = Red  
NW = White  
NY = Yellow

##### Free Custom label\*

CK = Black\*  
CB = Blue\*  
CG = Green\*  
CR = Red\*  
CW = White\*  
CY = Yellow\*

\*must provide custom label wording (20 characters, 2 lines maximum)

# Mini Stopper® Mini Weather Stopper®

## STI Fire Protection



STI-6535



STI-6500



STI-6525 and  
STI-6535 only

**MECA**

STI-6500 and  
STI-6505 only



This unique device has helped stop false fire alarms around the world for decades, without restricting legitimate operation of devices such as access controls, digital keypads, smaller manual pull stations, shutdown switches in computer rooms, workshops and many more. It offers excellent protection against physical damage (both accidental and intentional), dust and grime as well as severe environments inside and out. The Mini Stopper II consists of a clear,

tamperproof, tough polycarbonate cover and frame that fits over the protected unit. When lifted to gain access to the protected unit, its optional battery powered alarm emits a piercing 105 dB alarm. Immediate attention is drawn to the area and a prankster will either run or be caught. With gaskets, Mini Weather Stopper can dramatically extend the life of equipment mounted in saltwater areas or areas requiring frequent hosing down.

### FEATURES

- Protects against vandalism, accidental damage, dust and grime as well as severe environments inside and outside.
- Mini Weather Stopper dramatically extends the lifespan of devices in saltwater areas.
- Available with or without 105 dB horn.
- Weatherproofing available with a choice of gaskets.
- Cover is molded from thick, tough polycarbonate material.
- Available with red, green, blue or yellow label housing.
- Three year guarantee against breakage of polycarbonate in normal use (one year on electro mechanical and electronic components).
- Fast, easy installation.
- Perfect for protecting shutdown switches in computer rooms and workshops as well as other push button units.
- Matching spacer available for surface units.
- Polycarbonate tested -40° to 120°F (-40° to 49°C).

# Mini Stopper® Mini Weather Stopper®

## Dimensions and Technical Information

### Models Available

<b>STI-6500</b>	Clear cover for flush mounting
<b>STI-6505</b>	Clear cover, shipped with spacer for surface mounting
<b>STI-6510</b>	Clear cover for flush mounting, lockable
<b>STI-6525</b>	Weather resistant version of the STI-6540 for flush mount applications
<b>STI-6535</b>	Weather resistant version of STI-6545. Includes all necessary gaskets and a conduit spacer for surface mount applications
<b>STI-6540</b>	Mini Stopper® II without horn - with horn housing shell
<b>STI-6545</b>	Mini Stopper II without horn, with spacer and horn housing shell
<b>STI-6600</b>	Mini Stopper II with horn for flush mounting
<b>STI-6605</b>	Mini Stopper II with horn and spacer for surface mounting
<b>STI-6610</b>	Mini Stopper II with horn for flush mounting, lockable

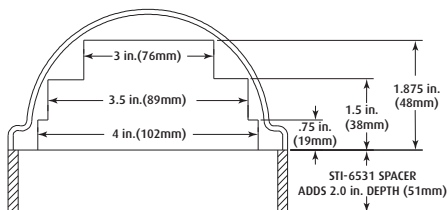

DEPTH CHART FOR MINI STOPPER  
AND CONDUIT SPACER

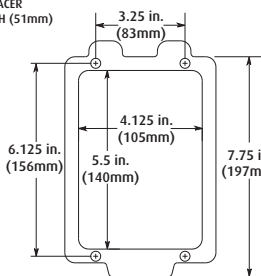

FRONT

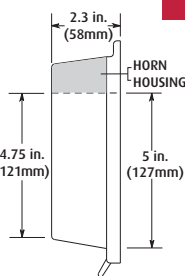

SIDE VIEW

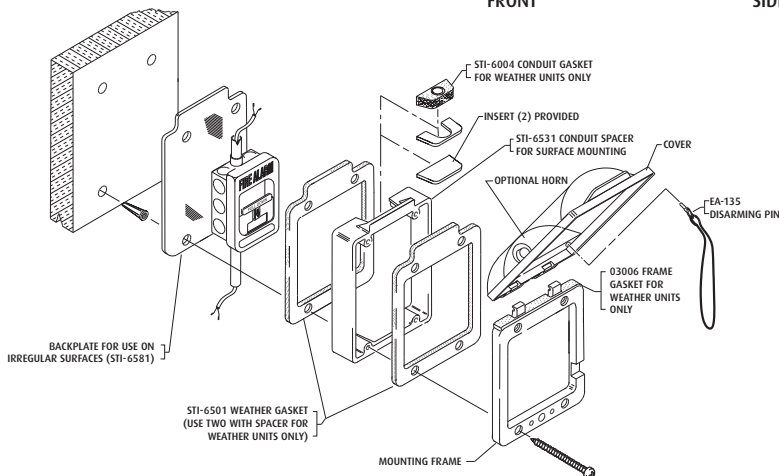



STI-6100

STI-4100

Accepted by fire marshals, these versions of the world famous STI Stopper II® are designed for areas where a "break glass" cover is specified, such as unsupervised areas. Each device consists of a red polycarbonate cover, mounting frame, a pane of single strength glass (easily replaced when broken), a glass breaking metal bar and anchors for installation. Two models are available for fire, the smaller STI-6100 and the larger STI-4100.

A spacer (STI-3100-R) is available for the STI-4100 to add 2" depth in order to accommodate surface mounted conduit installations. A third "generic" model (STI-6700) is available to cover devices other than manual pull stations. The same size as the STI-6100, it includes a wall mount hanging clip for keys, etc. This model for non-fire applications simply says "BREAK GLASS".

### FEATURES

- Housing is molded of tough polycarbonate material.
- Aesthetically appealing.
- Fire alarm remains clearly visible and accessible.
- Three year guarantee against breakage of polycarbonate in normal use.
- Fast, easy installation.
- Glass replacement is simple. (Suggestion: Order extra panes with each unit.)
- Accepted by fire marshals.
- Polycarbonate tested -40° to 120°F (-40° to 49°C).

## Dimensions and Technical Information

Models Available

<b>STI-4100</b>	Larger size Break Glass Stopper
<b>STI-4130</b>	Large Break Glass Stopper with Spacer
<b>STI-6100</b>	Standard size Break Glass Stopper
<b>STI-6700</b>	Generic Break Glass Stopper
<b>STI-3100-R</b>	Conduit Spacer (red) for STI-4100
<b>SUB-08</b>	Replacement Break Glass Tool
<b>SUB-09</b>	Replacement Glass for STI-6100
<b>SUB-10</b>	Replacement Glass for STI-4100
<b>SUB-67</b>	Replacement Glass for STI-6700 reads "Break Glass"
<b>STI-6702</b>	Tamperproof Screw Kit
<b>STI-1280</b>	Backplate for STI-4100

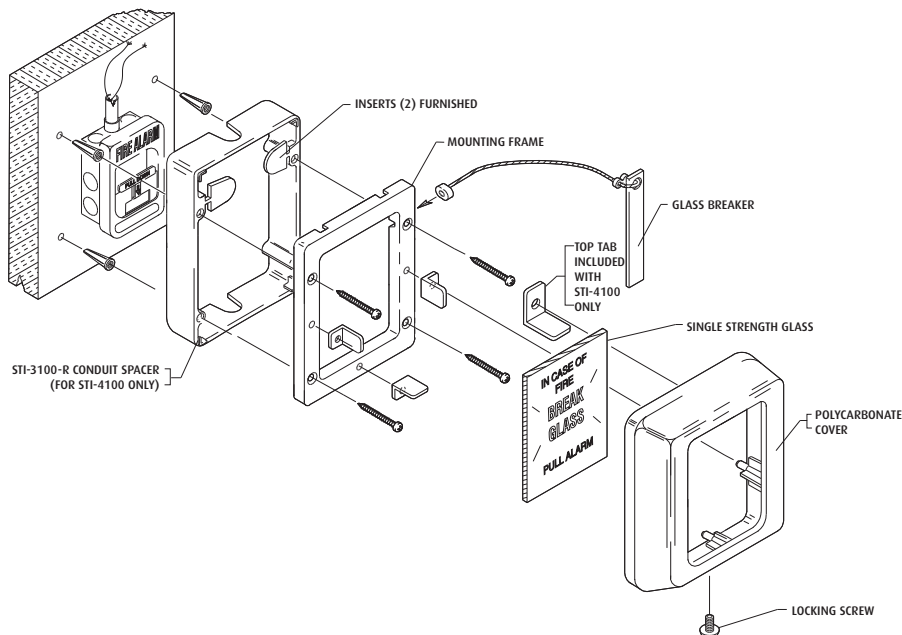
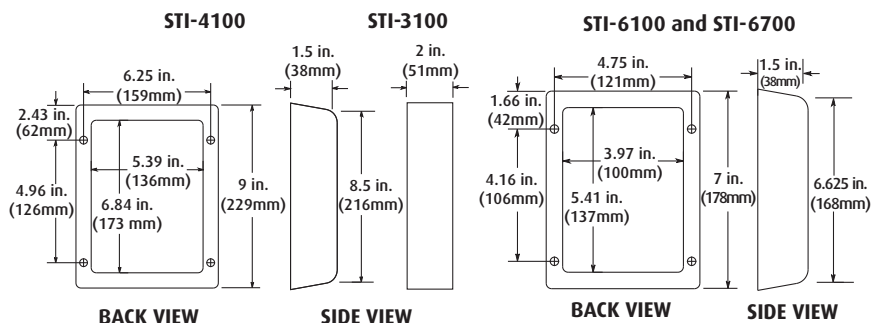

# NEMA 4X Stopper® Dome with Heater

STI Fire Protection



STI-1229HTR



Certain Models Only

**NEMA 4X**

**ADA**  
Compliant

Now there is a way to protect your signaling device located where temperature or environmental conditions exceed the suggested operation range. This protective cover with heater assembly for strobe appliances, is UL/cUL Listed to NEMA 4X Standards. Thermostatically controlled heater and a

continuous duty fan maintain a uniform temperature in the cover when located in a cold environment. Applications include, but are not limited to, refrigerators, freezers, meat packaging plants, arctic environments, ocean rigs, slaughter houses, etc. UL/cUL Listed down to -70°F (-57°C).

## FEATURES

- Maintains operating strobe appliance temperature with external temperatures to -70°F (-57°C).
- For use in areas where temperature or environmental conditions exceed the operational range of fire strobe signaling devices.
- Protects ADA compliant strobes to UL 1971 Standards.
- cUL Listing is for UL 1638 strobes only.
- Enables ADA compliance for visual fire protection systems where freezing temperatures or other harsh conditions exceed the operating limits of strobe signal devices.
- Enclosure rated to NEMA 4X Standards. Heater assembly rated to -70°F (-57°C).
- Prevents build up of snow on the unit or entry of moisture in wash down areas to assure that strobes remain clearly visible.
- Fan runs continuously to maintain a uniform temperature inside the enclosure.
- Heater units cycle as required to maintain the correct range of operating temperatures.
- The thick, clear polycarbonate cover is UV-stabilized against discoloration.
- Polycarbonate backed by a three year guarantee against breakage in normal use (one year on electro mechanical and electronic components).
- CSFM requires local approval only.

# NEMA 4X Stopper® Dome with Heater

## Dimensions and Technical Information

**Models Available**

**STI-1229HTR** NEMA 4X Stopper Dome with Heater  
**STI-HK2** Replacement heater for STI-1229HTR

STI Fire Protection

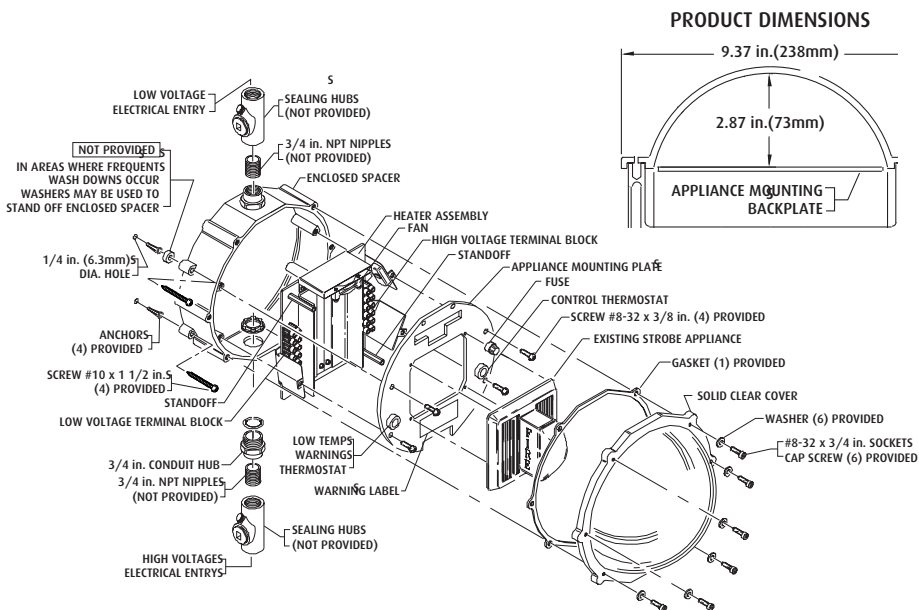
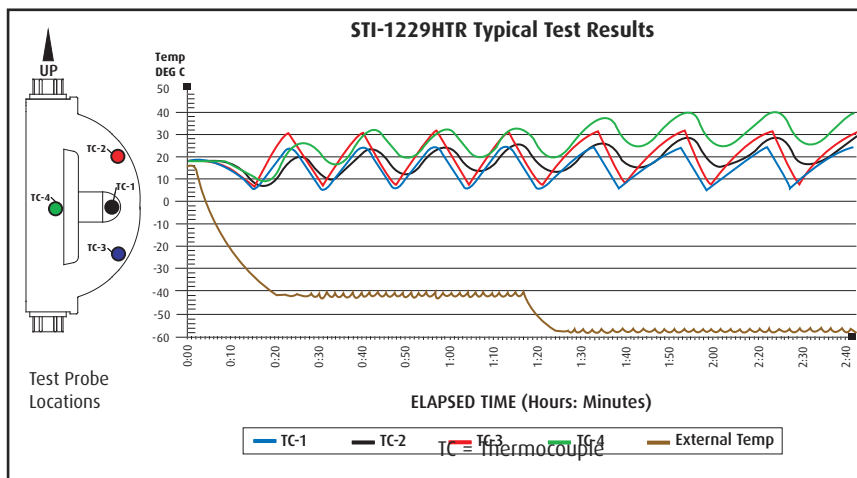



STI-1215



STI-1217



STI-1225



STI-1227



These virtually indestructible covers (slotted for horn or speaker units and solid for strobe only alarms) are designed to stop vandalism and accidental damage. Molded of clear, thick, UV-stabilized polycarbonate material, they are backed by a three year guarantee against breakage in normal use. Slots in the STI-1215, STI-1217 and STI-1219 allow the horn to be heard. STI-1225, STI-1227 and STI-1229 are for strobes only. Several

tough, clear spacers are available for larger strobe/horn units, retrofits, surface mount and an enclosed backbox for weather resistant applications. An appliance mounting plate comes with the STI-1219/STI-1229 and eliminates the need for an electrical backbox. Unique Enviro Kits are available for extreme conditions where dampness, water or dust are present.

## FEATURES

- Helps prevent accidental and intentional damage or vandalism to horn/strobe units.
- Three year guarantee against breakage of polycarbonate in normal use.
- Easy access for service.
- Enviro Kit available for extreme conditions.
- Several spacers are available to accommodate special applications.
- UV-stabilized.
- Contact STI for light and sound loss information.
- Polycarbonate tested -40° to 120°F (-40° to 49°C).
- See STI-1229 for NEMA 4X cover or STI-1229HTR for NEMA 4X cover with heater.



## Dimensions and Technical Information

- STI-1215** Horn/Speaker/Strobe protective cover for flush mount applications
- STI-1217** Horn/Speaker/Strobe protective cover for surface mount applications
- STI-1219** Horn/Speaker/Strobe cover with enclosed backbox
- STI-1225** Strobe protective cover for flush mount applications
- STI-1227** Strobe protective cover for surface mount applications
- STI-1229** NEMA 4X weatherproof strobe cover
- STI-1212** Spacer kit
- SUB-123** Enviro Kit includes three gaskets and mounting hardware

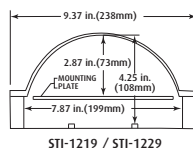
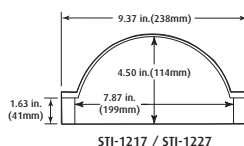
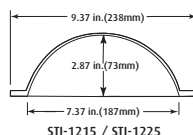

STOPPER DOME DIMENSIONS

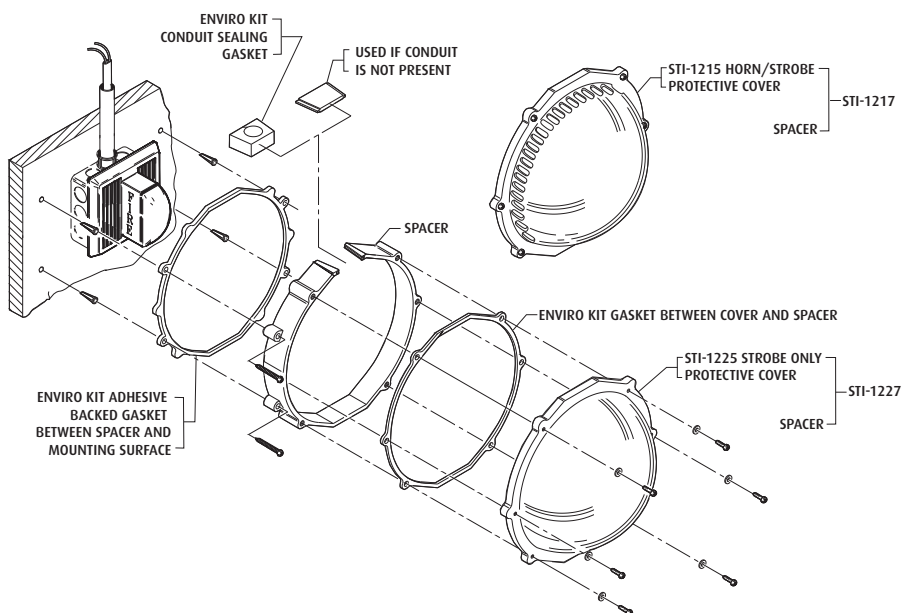

# Horn/Strobe Damage Stoppers®

## STI Fire Protection



STI-1210E  
(With Sub-121)



STI-1221E



**MEA**

These virtually indestructible covers (slotted for horn or speaker units and solid for strobe only alarms) are designed to stop vandalism and accidental damage. Molded of clear, thick, UV-stabilized polycarbonate material, they are backed by a three year guarantee against breakage in normal use. Slots in the STI-1210 B, C, D and E models allow the horn to be heard. STI-1221 B, C, D and E models are for strobes only. Many tough, clear spacers are available for larger strobe/horn units, retrofits, surface mount and weather resistant applications. For the

STI-1210/1221 series, spacer B has a solid back and is molded with an integral double gang outlet box. Spacer C has an open back for retrofit applications. Spacer D accommodates deeper units and applications with exposed conduit electrical connections. When not specified, units are sent with Spacer E, an open back frame for flush mount applications. An appliance mounting plate comes with the STI-1219/STI-1229. Unique Enviro Kits are available for extreme conditions where dampness, water or dust are present.

## FEATURES





- They help prevent accidental and intentional damage or vandalism.
- Easy access for service.
- Enviro Kit available for extreme conditions.
- UV-stabilized.
- See STI-1229 for NEMA 4X cover or STI-1229HTR for NEMA 4X cover with heater.
- Many spacer sizes are available to accommodate special applications.
- Contact STI for light and sound loss information.
- Polycarbonate tested -40° to 120°F (-40° to 49°C).
- Three year guarantee against breakage of polycarbonate in normal use.

# Dimensions and Technical Information

Models Available

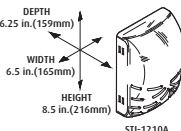
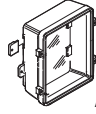
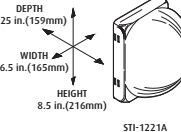
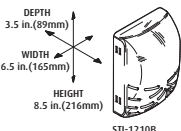
<b>STI-1210B</b>	Horn/Strobe with solid enclosed backbox and double gang outlet box
<b>STI-1210C</b>	Horn/Strobe with open backbox
<b>STI-1210D</b>	Horn/Strobe for surface mount applications
<b>STI-1210E</b>	Horn/Strobe with open back frame for flush mount applications
<b>STI-1221B</b>	Strobe with solid enclosed backbox and double gang outlet box
<b>STI-1221C</b>	Strobe with open backbox
<b>STI-1221D</b>	Strobe for surface mount applications
<b>STI-1221E</b>	Strobe with open back frame for flush mount applications
<b>SUB-121</b>	Enviro Kit for D and E models
<b>SUB-122</b>	Enviro Kit for B and C models
<b>SUB-06297D</b>	"D" spacer only
<b>SUB-06297E</b>	"E" spacer only

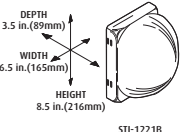
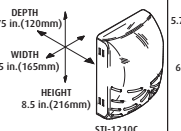
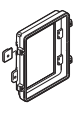
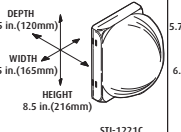
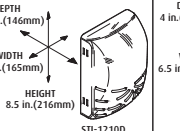
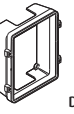
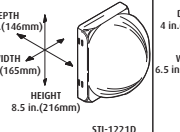
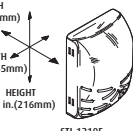
## STI-1210 SERIES HORN/STROBE COVERS

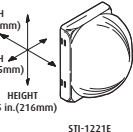
 <p>DEPTH 6.25 in. (159mm) WIDTH 6.5 in. (165mm) HEIGHT 8.5 in. (216mm)</p> <p>STI-1210A</p>  <p>A SPACER</p>  <p>DEPTH 6.25 in. (159mm) WIDTH 6.5 in. (165mm) HEIGHT 8.5 in. (216mm)</p> <p>STI-1221A</p>	 <p>DEPTH 3.5 in. (89mm) WIDTH 6.5 in. (165mm) HEIGHT 8.5 in. (216mm)</p> <p>STI-1210B</p>  <p>B SPACER</p>  <p>DEPTH 3.5 in. (89mm) WIDTH 6.5 in. (165mm) HEIGHT 8.5 in. (216mm)</p> <p>STI-1221B</p>	 <p>DEPTH 4.75 in. (120mm) WIDTH 6.5 in. (165mm) HEIGHT 8.5 in. (216mm)</p> <p>STI-1210C</p>  <p>C SPACER</p>  <p>DEPTH 4.75 in. (120mm) WIDTH 6.5 in. (165mm) HEIGHT 8.5 in. (216mm)</p> <p>STI-1221C</p>	 <p>DEPTH 5.75 in. (146mm) WIDTH 6.5 in. (165mm) HEIGHT 8.5 in. (216mm)</p> <p>STI-1210D</p>  <p>D SPACER</p>  <p>DEPTH 5.75 in. (146mm) WIDTH 6.5 in. (165mm) HEIGHT 8.5 in. (216mm)</p> <p>STI-1221D</p>	 <p>DEPTH 4 in. (102mm) WIDTH 6.5 in. (165mm) HEIGHT 8.5 in. (216mm)</p> <p>STI-1210E</p>  <p>E SPACER</p>  <p>DEPTH 4 in. (102mm) WIDTH 6.5 in. (165mm) HEIGHT 8.5 in. (216mm)</p> <p>STI-1221E</p>
--	--	--	--	--

## STI-1221 SERIES STROBE COVERS

Call us for additional literature  
Visit us at

**www.STI-USA.com**

**800-888-4STI**



*"We protect the things that protect you."*

**Safety Technology International, Inc.**

2306 Airport Road, Waterford, Michigan 48327

Phone: 248-673-9898 Fax: 248-673-1246

Email: [info@sti-usa.com](mailto:info@sti-usa.com) Web: [www.sti-usa.com](http://www.sti-usa.com)

**Safety Technology International, (Europe) Ltd.**

Unit 3 Olton Wharf, Richmond Rd., Olton, Solihull, Eng. B92 7RN

Telephone: 44 (0) 121 707 2999 Facsimile: 44 (0) 121 707 8999

Email: [info@sti-europe.com](mailto:info@sti-europe.com) Web: [www.sti-europe.com](http://www.sti-europe.com)

# The Wire Guard Collection

*"We Protect the Things that Protect You."*

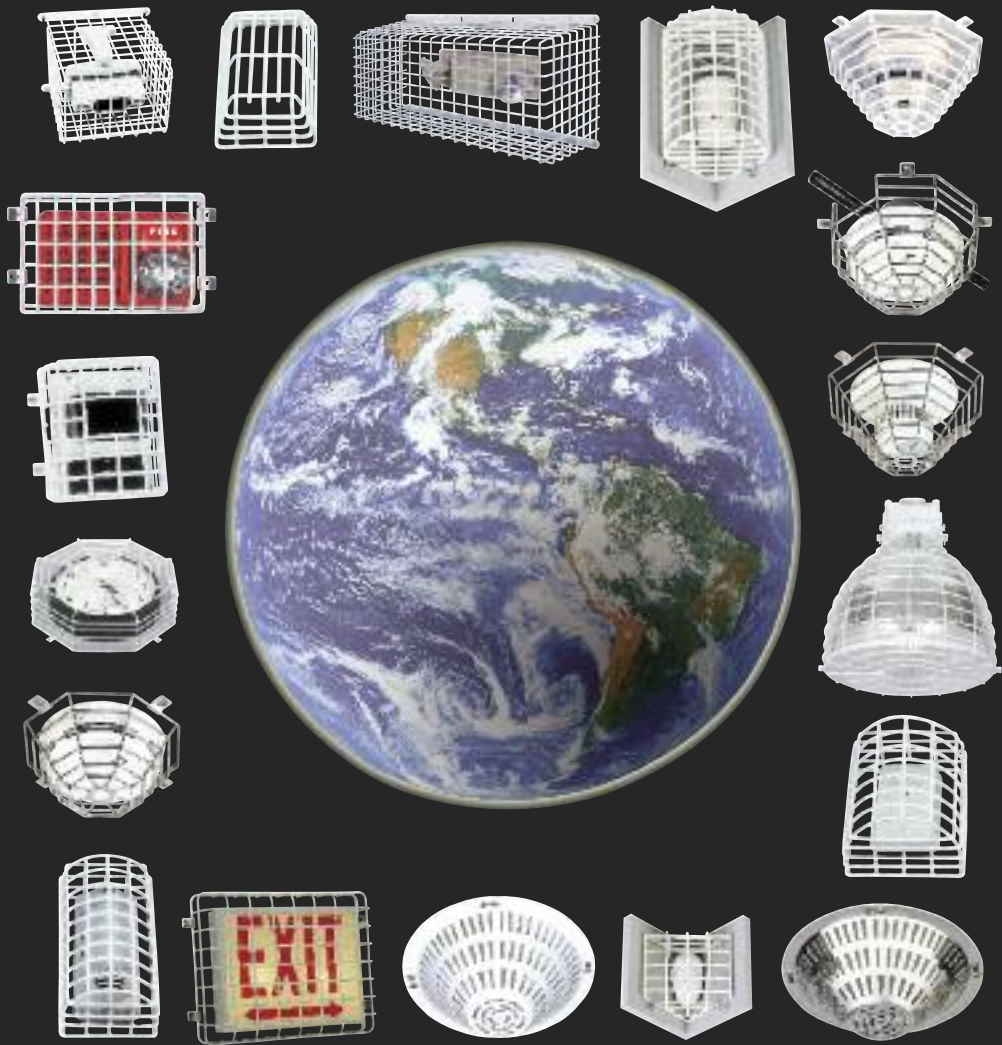

# Safety Technology International, Inc.

# Steel Web Stoppers®

## STI Wire Guards



STI-9601



STI-9602



STI-9605



STI-9604



STI-9609



STI-9610



STI-9713



These UL Listed guards are for areas where abuse to smoke detectors is severe. To create them, STI borrowed from nature's master builder, the spider, to create a web of protection from vandalism and accidental damage. Constructed of 9-gauge steel wire, with corrosion resistant polyester coating, these Stoppers are extremely difficult to break. Installation and service are easy with models for both flush and surface

mounting. Many models are available to fit virtually all smoke detectors. Models available for smoke detectors without conduits are the STI-9604 for smaller size units, the STI-9601 for low-profile detectors and the STI-9609 for high-profile units. Allowing for conduit spacing are the STI-9605 (for smaller size detectors), STI-9602 (low profile) and STI-9610 (high profile). The STI-9713 is for use with photoelectric smoke detectors.

## FEATURES

- Patented weblike octagon shape of 9-gauge coated steel wire makes them extremely difficult to break.
- Fast, easy installation.
- Tamper resistant hardware is available.
- Many models to fit virtually all smoke detectors available today.
- Simple removal for servicing detector.
- May be spray painted once prior to installation to match decor.
- UL and cUL Listed (No. S3504) and CSFM (7300-1416:100) approved.
- STI-9713 UL Listed (No. S3504) for specific detectors (see spec sheet for details).
- Three year guarantee against breakage in normal use.

## Dimensions and Technical Information

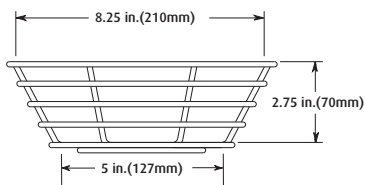

STI-9601

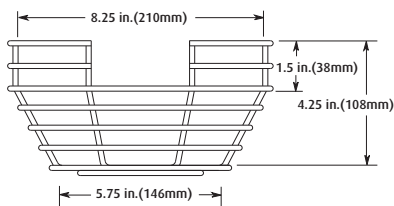

STI-9602

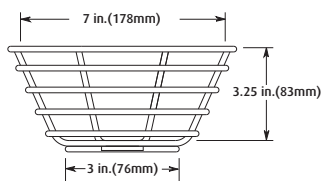

STI-9604

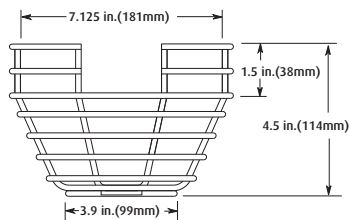

STI-9605

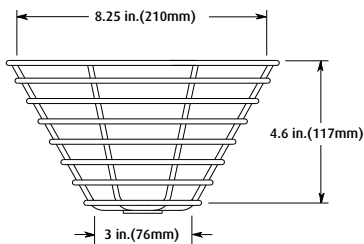

STI-9609

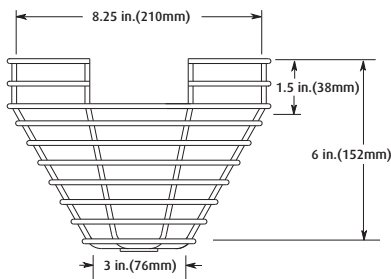

STI-9610

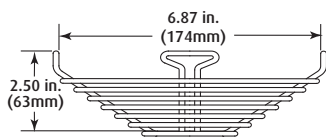

STI-9713

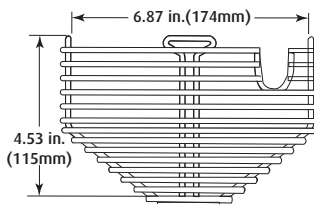

STI-9712

**NOTE:** All models are UL Listed except STI-9712.

# Steel Web Stoppers



STI-9604-SS



STI-9609-SS



STI-9605-SS



As their polyester coated cousins, these Stoppers feature 9-gauge stainless steel wire construction in a weblike design that creates protection against abuse to

smoke detectors. Many sizes available for flush and surface mounting.

See page 3 for product dimensions.

## FEATURES

- Patented weblike octagon shape of 9-gauge steel wire makes them extremely difficult to break.
- Tamper resistant hardware is available.
- Many models to fit virtually all smoke detectors available today.
- Simple removal for servicing detector.
- May be spray painted once prior to installation to match decor.
- UL and cUL Listed (No. S3504) and CSFM (7300-1416:100) approved.
- Three year guarantee against breakage in normal use.
- Fast, easy installation.



# Smoke Beam Guards

## STI Wire Guards



STI-9706



STI-9623



STI-9624



STI-9840



STI-9841



STI-9625

Protect projected beam type smoke detectors in large areas such as gymnasiums, warehouses and auditoriums. STI-9623 is used on Detection Systems 240 and DS 241 long-range projected beam smoke detectors.

STI-9625 designed for use on the 6424 System Sensor Infrared Beam Smoke Detector. STI-9624 designed to protect Fireray 50/100R. STI-9706 (flush mount) and STI-9707 (surface mount) are used on System Sensor 1224.

PART #	HEIGHT	WIDTH	DEPTH
STI-9623	7.75 in. (196 mm)	6 in. (152 mm)	6 in. (152 mm)
STI-9624	8.875 in. (225 mm)	5.5 in. (140 mm)	4.75 in. (120 mm)
STI-9625	7.875 in. (200 mm)	10.25 in. (260 mm)	12.625 in. (321 mm)
STI-9706	10.82 in. (275 mm)	9.32 in. (237 mm)	4 in. (120 mm)
STI-9707	11 in. (280 mm)	9.62 in. (244 mm)	5.5 in. (140 mm)
STI-9840	6.61 in. (168 mm)	6.61 in. (168 mm)	5.78 in. (147 mm)
STI-9841	11.52 in. (293 mm)	10 in. (256 mm)	3.58 in. (91 mm)

## FEATURES

- Tough construction of 9-gauge coated steel wire makes STI Smoke Beam Guards extremely difficult to break.
- Coated with a tough, corrosion resistant polyester shell.
- Protection against misalignment and false alarms.
- Designed to protect both transmitter and receiver units.
- Three year guarantee against breakage in normal use.

# Smoke Detector Damage Stopper®

## STI Wire Guards



STI-8230-SS



STI-8200-W



certain smoke detectors only

### Stainless Steel

This heavy-duty, 1.2 mm stainless steel cover features a natural resistance to corrosion. This makes it an excellent choice for any application where food is present as well as use in water treatment plants and correctional facilities. It is available for flush mount (STI-8200-SS) or with a conduit spacer for surface mount (STI-8230-SS, shown). Easy to install, it helps assure the smoke detector will remain operational in applications where vandalism and accidental damage are causing false fire alarms or high maintenance costs.

### Coated Cold Rolled Steel

Here is a protective cover for persons who prefer the strength and durability of steel but need not be concerned with the presence of food in the area. It is fabricated from 1.5 mm cold rolled steel with a white corrosion resistant polyester coating. As the stainless steel cover, it is available for flush mount (STI-8200-W, shown) or with a spacer for surface mount (STI-8230-W). Tamper resistant hardware is available for all models if added protection against vandalism is a concern.

#### Stainless Steel (1.2 mm)

STI-8200-SS	Smoke detector cover - flush mount
STI-8201-SS	Spacer for conduit applications
STI-8230-SS	Cover and Spacer - surface mount

#### Cold Rolled Steel coated white (1.5 mm)

STI-8200-W	Smoke detector cover - flush mount
STI-8201-W	Spacer for conduit applications
STI-8230-W	Cover and Spacer - surface mount
SUB-82	Tamperproof screws for flush mounted covers
19038	Snake eye bit for use with SUB-82
STI-8170	Mounting backplate for flush and surface mount models. Recommended for irregular and unstable mounting surfaces such as drop ceilings and beams.

## FEATURES

- Cover is UL and cUL Listed for System Sensor SSD-2251, FCI ASD-PL, Secutron MRI-2251, EST 2251F and Honeywell TC806B1001 for ceiling and wall mount applications.
- Aesthetically pleasing stainless steel or coated cold rolled steel.
- They help assure smoke detectors will be operational when needed.
- Exceptional durability.
- Covers protect against severe vandalism and accidental damage.
- Available conduit spacers allow them to be easily mounted over surface mount applications with or without conduit.
- Easy installation and easy removal for servicing detectors.
- Tamper resistant hardware is available for all models.

# Smoke Detector Damage Stopper®

## Dimensions and Technical Information

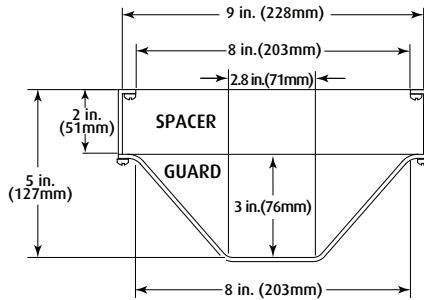
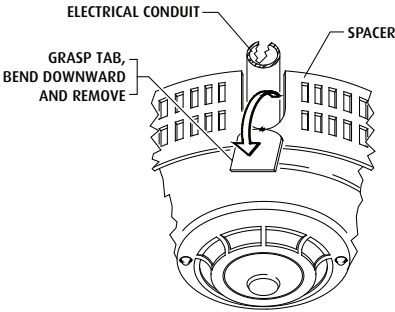

PRODUCT DIMENSIONS

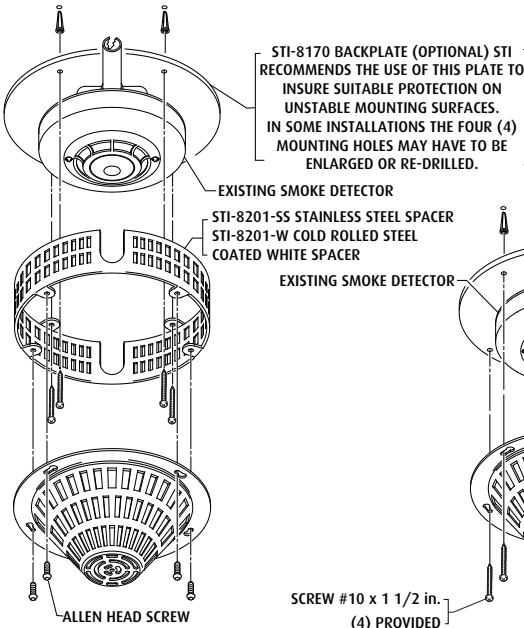

SURFACE MOUNT INSTALLATION

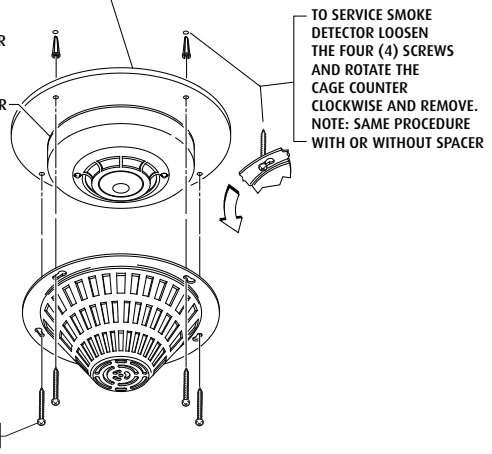

FLUSH MOUNT INSTALLATION

# Speaker/Strobe Damage Stopper® and Horn/Strobe/Speaker Damage Stopper®

## STI Wire Guards

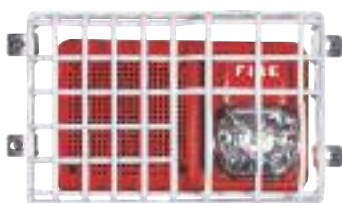

STI-9717



STI-9720

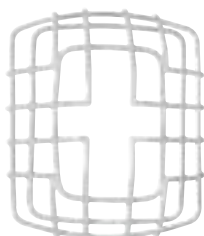

STI-9705



STI-9708-R



STI-9714



MODEL	HEIGHT	WIDTH	DEPTH
STI-9705	7.40 in. (188mm)	6.15 in. (156mm)	3.39 in. (84mm)
STI-9705-R	7.40 in. (188mm)	6.15 in. (156mm)	3.39 in. (84mm)
STI-9708	7.49 in. (190mm)	6.74 in. (171mm)	6.09 in. (155mm)
STI-9708-R	7.49 in. (190mm)	6.74 in. (171mm)	6.09 in. (155mm)
STI-9711	8.26 in. (210mm)	8.26 in. (210mm)	3.54 in. (90mm)
STI-9714	8.55 in. (217mm)	8.55 in. (217mm)	6.23 in. (158mm)
STI-9717	6.1 in. (155mm)	9.3 in. (238mm)	2.4 in. (61mm)
STI-9720	6.1 in. (155mm)	9.3 in. (238mm)	4.9 in. (125mm)

These tough wire guards are designed to protect appliances against vandalism and accidental damage. They consist of tough, 9-gauge steel wire coated with corrosion resistant white or red polyester,

which offers excellent security. Weblike shape helps unit take tough knocks in stride. Tamper resistant hardware and bit available.

## FEATURES

- Helps prevent accidental or intentional damage and vandalism.
- Weblike shape of 9-gauge steel wire makes them extremely difficult to break.
- STI-9717 and STI-9720 (not UL Listed) designed to fit over System Sensor notification appliances SP2R1224MC and SP2W1224MC.
- STI-9705, STI-9708, STI-9711 and STI-9714 are UL/cUL Listed.
- Simple removal for servicing or routine maintenance.
- Three year guarantee against breakage in normal use.



STI-9618



STI-9619



STI-9620



STI-9621



STI-9622

STI customers asked for them, tough guards to protect PIR, microwave or dual technology motion detectors. These Stoppers do the job. They are extremely effective in reducing malfunctions and high maintenance costs where vandalism

or accidental damage is prevalent. Plus, they do not interfere with effective range of detectors. Sizes to fit virtually all motion detectors, including two for corner mount applications. Tamper resistant hardware is available.

PART #	HEIGHT	WIDTH	DEPTH
STI-9618	4.62 in.(117 mm)	5.37 in.(136 mm)	3 in.(76 mm)
STI-9619	7.75 in.(196mm)	5.37 in.(136mm)	5.62 in.(142mm)
STI-9620	6.25 in.(159 mm)	4 in.(102 mm)	2.25 in.(57 mm)
STI-9621	7 in.(178 mm)	5.75 in.(146 mm)	4.5 in.(114 mm)
STI-9622	8.75 in.(222 mm)	4 in.(102 mm)	3.75 in.(95 mm)

## FEATURES

- Construction of 9-gauge, welded steel wire.
- Coated with a tough, corrosion resistant polyester shell.
- Protection against both vandalism and accidental damage.
- Designed so there is no interference with the operation or usefulness of the protected unit.
- Three year guarantee against breakage in normal use.

# Exit Sign Damage Stopper®

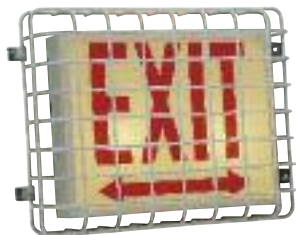

STI-9640



STI-9740

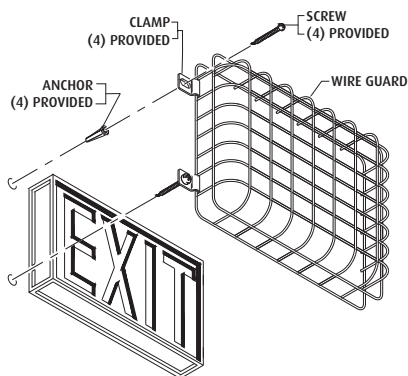

Wherever exit signs are at risk from either intentional or accidental damage, installation of these tough wire guards is the solution to the problem. These guards cover a wide range of exit sign models

available today. Installation is simple with anchors and screws provided. Tamper resistant screws (SUB-82) and a matching bit (19038) are available.

## FEATURES

- Tough construction of 9-gauge polyester coated steel wire makes it extremely difficult to break.
- Large enough to cover a wide range of exit signs.
- Simple removal for light bulb replacement.
- Tamper resistant hardware is available.
- May be painted prior to installation to match decor.
- Fast, easy installation.
- STI-9640 measures 13.75 in. wide x 10.5 in. high x 2.75 in. deep (349mm x 267mm x 70mm).
- STI-9740 measures 20.5 in. wide x 15.5 in. high x 6 in. deep (520mm x 394mm x 152mm).
- Guard may reduce projected light values. Verify correct exit light requirements when using guard (NFPA 101).
- Three year guarantee against breakage in normal use.

# Clock/Bell Damage Stopper®



STI-9632

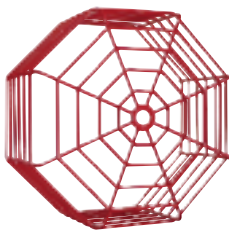

STI-9631-R



STI-9631-SS

These tough covers are designed to protect clocks, bells and similar instruments. Their octagon shape also helps them take tough knocks in stride. They are ideal for areas where abuse is severe. Because they are white in color, users report that their clock numbers

are easier to see than with darker competitive guards. Guards are also available in red for large volume orders. Multiple sizes and tamper resistant hardware are available. STI-9631-R and STI-9631-SS are available for larger quantity orders only.

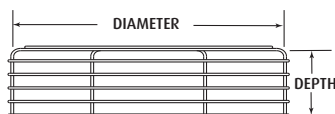
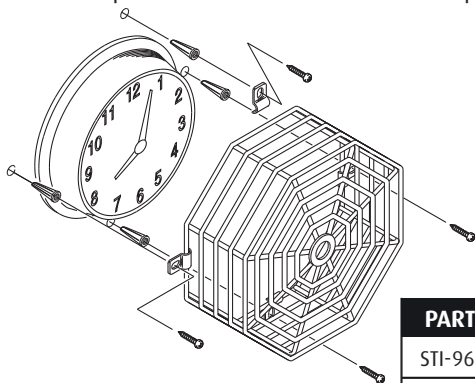

PART #	DIAMETER	DEPTH
STI-9631	10.5 in.(267mm)	6 in.(152mm)
STI-9632	16.5 in.(419mm)	6 in.(152mm)
STI-9633	20 in.(508mm)	6 in.(152mm)

## FEATURES

- Weblike octagon shape of 9-gauge coated steel wire makes them extremely difficult to break.
- Fast, easy installation.
- Simple removal for servicing or routine maintenance.
- Tamper resistant hardware is available.
- Many models to fit a wide range of

units.

- May be painted prior to installation to match decor.
- Three year guarantee against breakage in normal use.

# Bay Light Damage Stopper®

## STI Wire Guards



STI-9702



STI-9709

**Special order. Contact customer service for lead times.**

These tough, 9-gauge polyester coated steel wire guards help protect Hubbell® Superbay lights against both vandalism and accidental damage. They are easy to install with all fasteners provided. Guard bolts directly to the transformer

(not the reflective lens like most other guards) providing more strength to protect the expensive reflector. Light bulb replacement is easy without the removal of the guard.

### FEATURES

- Offers protection against vandalism and accidental damage for warehouse or sport facility lights.
- Constructed of tough 9-gauge steel wire.
- Installation is fast and simple with screws and nuts provided.
- Fits reflector mounting kit in all positions.
- STI-9702 fits 3 Hubbell models: WA-22, WD-22 and BL-WA22.
- STI-9709 fits existing Hubbell WA25 series.
- Three year guarantee against breakage in normal use.



# Light Damage Stopper® and Emergency Light Damage Stopper®



STI-9649



STI-9703

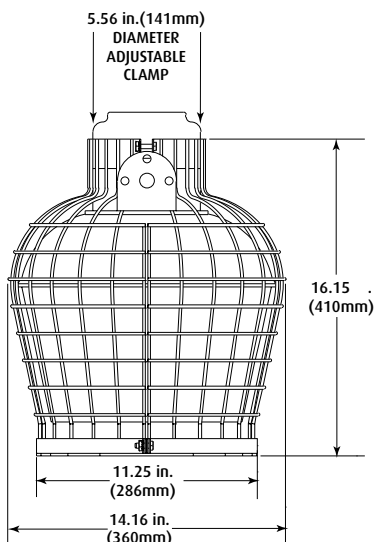

STI-9796

MODEL	HEIGHT	WIDTH	DEPTH
STI-9641	10.7 (271mm)	14.6 (370mm)	4 (101mm)
STI-9644	8.7 (220mm)	17.75 (450mm)	5.25 (133mm)
STI-9645	13.75 (349mm)	21.6 (548mm)	5.9 (149mm)
STI-9649	10.75 (273mm)	24.75 (629mm)	11.25 (286mm)
STI-9703	5.0 (127mm)	13.5 (343mm)	4 (101mm)
STI-9730	12 (305mm)	12 (305mm)	12 (305mm)

These Stoppers help protect important security devices from theft and vandalism. They are constructed of tough 9-gauge steel wire coated with corrosion

resistant polyester. Highly recommended for areas where abuse is severe or it is imperative security devices continue to operate.

## FEATURES

- Offers protection against vandalism and accidental damage for important security devices.
- Installation is fast and simple with screws and anchors provided.
- Constructed of tough 9-gauge steel wire coated with corrosion resistant polyester.
- Three year guarantee against breakage in normal use.

# Fluorescent Light Damage Stoppers®



STI-9651

**Special order. Contact customer service for lead times.**

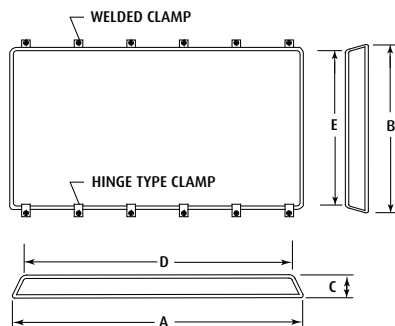

STI-9880 and STI-9881

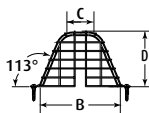

	A*	B	C	D
<b>STI-9651</b>	53.50 in. (1359mm)	29.50 in.(750mm)	50 in.(1270mm)	4 in.(102mm)
<b>STI-9880</b>	59 in. (1500mm)	9.5 in.(242mm)	4 in.(110mm)	6 in.(152mm)
<b>STI-9881</b>	94 in. (2400mm)			

\* **STI-9880** Adjustable length reduces to 47.25 in.(1200mm)

**STI-9881** Adjustable length reduces to 70.87 in.(1800mm)

Here is a way to help assure large fluorescent lights continue to illuminate important areas and to avoid frequent replacement of bulbs because of vandalism, accidental damage or other abuse. They are easy to install with all

screws and anchors provided. Constructed of tough wire coated with corrosion resistant polyester. To help accommodate various fluorescent twin-tube lighting fixtures, the STI-9880 and STI-9881 are adjustable in length.

## FEATURES

- Constructed of corrosion resistant, polyester coated steel wire.
- Helps assure continued illumination of key areas.
- The STI-9880 and STI-9881 are adjustable in length to help accommodate various fluorescent twin-tube lighting fixtures.
- Protects against vandalism and accidental damage.
- Easy to install and easy removal for service.
- Three year guarantee against breakage in normal use.

# Custom Wire Guards

## STI Wire Guards

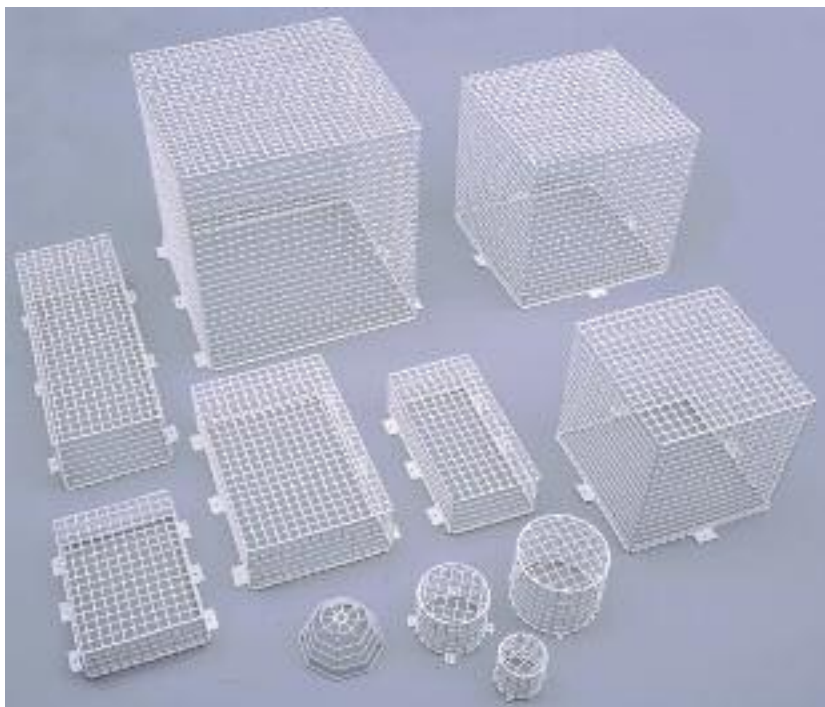

Custom wire guards in white, red or stainless steel are available for larger quantity orders. Please call for details. As all STI wire guards, they are backed by a three year guarantee against breakage in normal use.

Additional wire guards are available from our UK office. Constructed of tough, corrosion resistant, coated wire. These

web guards are designed to take tough knocks in stride. Designed for emergency lights, beacon sounders, smoke detectors, CCTVs, external lighting and exit lights. Guards range in size from approximately 3.64 in. dia. x 3.54 in. deep (95mm x 90mm) to approximately 25 in. square (635mm). There is a six week lead time required on most custom wire guards.

### FEATURES

- Offers protection against vandalism and accidental damage.
- Constructed of tough steel wire.
- Coated with corrosion resistant polyester.
- Three year guarantee against breakage in normal use.
- Tough construction makes these guards extremely difficult to break.
- Fast and easy to install.

Call us for additional literature  
or visit us at:

**[www.sti-usa.com/wl3](http://www.sti-usa.com/wl3)**  
**800-888-4784**



*"We Protect the Things that Protect You."*

**Safety Technology International, Inc.**

2306 Airport Road, Waterford, Michigan 48327

Phone: 248-673-9898 Fax: 248-673-1246

Email: [info@sti-usa.com](mailto:info@sti-usa.com) Web: [www.sti-usa.com](http://www.sti-usa.com)

**Safety Technology International, (Europe) Ltd.**

Unit 49G Pipers Road • Park Farm Industrial Estate • Redditch  
Worcestershire • B98 0HU • England • Tel: 44 (0) 1527 520 999  
Fax: 44 (0) 1527 501 999 • Freephone: 0800 085 1678 (UK only)  
E-mail: [info@sti-europe.com](mailto:info@sti-europe.com) • Web: [www.sti-europe.com](http://www.sti-europe.com)

# STI Wireless Chimes

*Home &  
Work Series*

*"Jingle Bells"*  
Door Entry



*"Westminster Chime"*  
Doorbell



*"Ding Dong"*  
Motion Detector



*"Star Spangled Banner"*  
Doorbell Extender



**Safety Technology  
International, Inc.**

[www.sti-usa.com](http://www.sti-usa.com)

800-888-4784



Now available from STI are wireless chimes. These easy to install chimes have adjustable volume control and offer 32 selectable privacy codes to avoid any interference from outside signals.

**All of these chimes are compatible with each other.**

---

#### **PRODUCT INFORMATION**

- Receiver has high, medium and low volume adjustment.
- 32 selectable codes to help block interference from outside signals.
- Compatible with Wireless Doorbell Extender, Entry Alert® Chime, Wireless Motion-Activated Chime, Wireless Chime Receiver, Wireless Button, Wireless Transmitter, Additional Wireless Motion Sensor.



**Visit our website for detailed product information**

**[www.sti-usa.com](http://www.sti-usa.com)**

**or call**

**800.888.4784**



# Wireless Motion-Activated Chime

Chime activates when motion is detected.



**STI-46100**

---

- Wireless Chime alerts when someone enters detection zone.
- Up to 100 foot operating range.
- Weather-sealed sensor for long life.
- 140° x 40 foot detection zone.
- Activation switch allows chime or alarm sounds.
- Uses 4 AA alkaline batteries (not included).
- Plays thirteen sounds:
  - Dong
  - Ding Dong
  - Westminster Chime
  - Star Spangled Banner
  - Hail, Hail, The Gang's All Here
  - Jingle Bells
  - Auld Lang Syne
  - Dixie
  - The Yellow Rose of Texas
  - Happy Birthday
  - Beethoven's 5th
  - Joy To The World
  - Take Me Out To The Ballgame

## ACCESSORIES





# Entry Alert® Chime

Lets you know when a monitored door is opened.



STI-32600

---

- Chimes when magnet and reed switch are separated (door or window is opened).
- Up to 150 foot operating range.
- Selectable chime or alarm mode.
- Ideal for offices, retail stores, homes, etc.
- Uses (1) 6 Volt alkaline battery (installed).
- Plays thirteen sounds:
  - Dong
  - Ding Dong
  - Westminster Chime
  - Star Spangled Banner
  - Hail, Hail, The Gang's All Here
  - Jingle Bells
  - Auld Lang Syne
  - Dixie
  - The Yellow Rose of Texas
  - Happy Birthday
  - Beethoven's 5th
  - Joy To The World
  - Take Me Out To The Ballgame

## ACCESSORIES







# Wireless Chime

Doorbell for new installations or replacing broken door chimes.



**STI-32500**

---

- Wireless doorbell chime is easy to install.
- No electrical wiring and no expensive through-the-wall drilling.
- Easily mount the button to the exterior of the door and plug the receiver unit into any indoor electrical outlet.
- Up to 250 foot operating range.
- Perfect for home, apartment, mobile home or RV.
- Includes (2) 3 Volt Lithium batteries.
- Plays thirteen sounds:

- Dong
- Ding Dong
- Westminster Chime
- Star Spangled Banner
- Hail, Hail, The Gang's All Here
- Jingle Bells
- Auld Lang Syne
- Dixie
- The Yellow Rose of Texas
- Happy Birthday
- Beethoven's 5th
- Joy To The World
- Take Me Out To The Ballgame

## ACCESSORIES





# Wireless Doorbell Extender

Hear your existing doorbell in remote areas of your home.



**STI-32000**

- Chime connects to existing doorbell.
- Receiver extends chime to hard-to-hear areas.
- The included receiver can be plugged into any standard electrical outlet.
- Up to 150 foot operating range between chime and receiver.
- Unit is UL Listed and FCC Certified.
- Plays six sounds:
  - Dong
  - Ding Dong
  - Westminster Chime
  - Star Spangled Banner
  - Hail, Hail, The Gang's All Here
  - Jingle Bells

## ACCESSORIES





## Batteries & Accessories



### **STI-32530**

#### Wireless Chime Receiver

Use as additional chime for STI wireless series systems to expand tone to additional rooms. Easily plugs into any standard electrical outlet.



### **STI-33010**

#### Wireless Button

This doorbell button can be purchased to place on an additional door or to be used as a call button.



### **STI-35500**

#### Wireless Transmitter

Additional transmitter and magnet to monitor a door or window.



### **STI-46010**

#### Wireless Motion Sensor

Additional sensor to monitor an additional door.



### **STI-30950**

#### 6 Volt Alkaline Battery

For use with Wireless Transmitter



### **STI-33950**

#### 3 Volt Lithium Battery

For use with Doorbell Button

Also available from 

**SOLAR POWERED LIGHTED  
HOUSE NUMBER**



STI-30325

**WIRELESS DRIVEWAY MONITOR**



STI-34100

**REX PLUS ELECTRONIC WATCHDOG**



ED-50

**THERMOSTAT COVERS**



STI-9110

**PERSONAL ALARM**



12006

**CABINET LIGHT**



STI-30460



[www.sti-usa.com](http://www.sti-usa.com) • 800-888-4784