



HAIFUAN

D6300 User Manual

(Password+Mechanical key+M1 Card) Series

Contents:

Part 1: Technical Parameters -----	2
Part 2: Product Structure Map -----	2
Part 3:Installing Instruction -----	3
Part 4:Operating Instructions -----	5

Part 1: Technical Parameters

Dimensions	160L*68W*36H (mm)
Material	Zinc Alloy
Weight	2KG
Operating Voltage	DC6V , 1.5V "AA" Alkaline Batteries
Static Current	≤20μA
Dynamic Current	≤200mA
Ways to open	Password+Mechanical key+M1 Card
User Management Capacity	100codes、 800cards、 120 remote controllers(Optional)
Center Distance	60mm or70mm
Door Thickness	30mm—60mm

Part 2: Product Structure Map

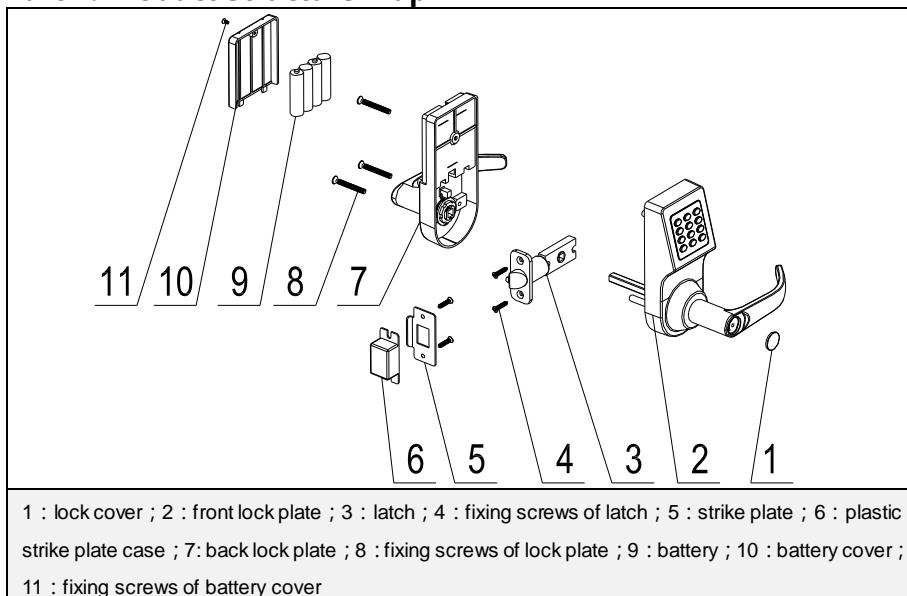

Part 3: Installing Instructions

3.1 Drilling Hole

- 1、 Mark on the door according to the drawing
- 2、 Drill holes correspondingly with electro drill
- 3、 Drill holes on the door frame with corresponding tools to install strike plate

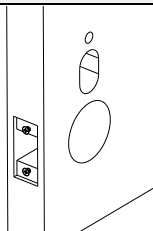

3.2 Installing latch and strike plate

- 1、 Fix the lock on the door broadside with two screws
- 2、 Fix the plastic bottom case and strike plate on the door frame with two screws

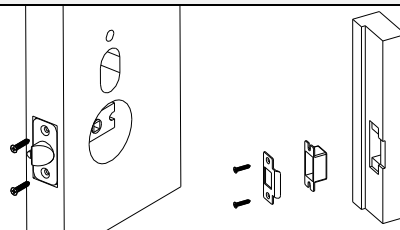

3.3 Installing square shaft of front lock plate

- 1、 Put the square shaft into square hole(on the front lock plate)
- 2、 Fix the square shaft with pin bolt in components bag and then open it

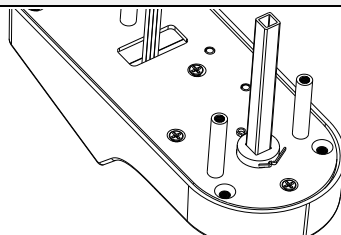

3.4 Installing front lock plate

- 1、 Install front panel, the two screw pillars should be aligned with the holes of the latch, pull the connecting line of front panel to the back of the door, in order to connect them.

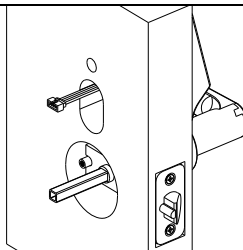

3.5 Installation of connecting line and back lock plate

- 1、 Open the battery cover
- 2、 Connect connecting lines of the front and the back lock plates.
- 3、 Fix the front and the back lock plates by 3 fixing screws.
- 4、 Positioning the lock plate properly, tighten the 3 screws to fix lock plates

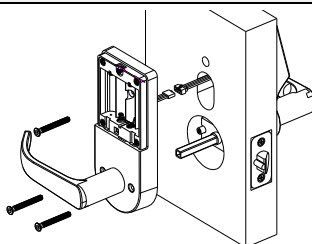

3.6 Equipping batteries

- 1、 Put 4 AA batteries into the battery case and pay attention to the directions.
- 2、 Close the battery case and fix it with screws.
- 3、 Installation finished.

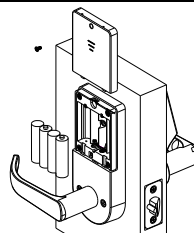

3.7 Test after installation

- 1、 The door can be opened normally when pushing the handle.
- 2、 After power on, the motor reverse, the handle will be idling when push it. Input the initial password to check door opening.
- 3、 Make sure the door can be opened normally by the mechanical key.

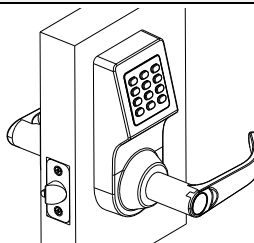

3.8 Usage of emergency mechanical key

- 1、 Take down the cylinder cover on front handle with plastic sucker.
- 2、 Insert the right mechanical key, turning 90 degrees.
- 3、 Push the handle, door opened.

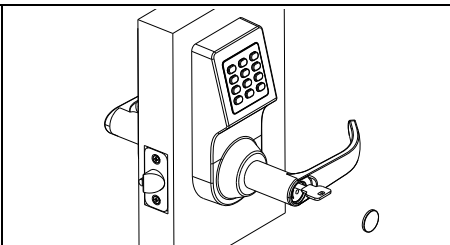

Part 4: Operation Instruction

1. Outline

Admin: code (remote controller and card cannot be used as admin).

User: code, card, and remote controller(optional).

User capacity: 1 admin code, 100 codes, 800 cards, and 120 remote controllers.

2. System initialization

Default admin code is “123456”. Please change the admin code after you install the lock to replace the default admin code (**You can not add user with default admin code**)

Initialization :

- Press RST button
for 6 seconds

 →

System initialization, recover to factory state, admin code
back to “123456”

You can also press “*” “#”, and then input the admin code to enter the system setting.

3. Operations

Functions		Operation	Description
System Setting	Passage Mode setting	0 → 1 → X	x : 1-Forbid , 2-Start. Default is 1
	Verification Mode setting	0 → 2 → X	x : 1-Single user , 2-doubel users , Default is 1
Admin Setting	Set Admin Code	1 → input Admin Code and #	New Management Code replaces the old one.
Add Users	Add code user	2 → input code and #	Add another code User after pressing #

	Add card User	2→swipe the card	Swipe the cards you want to add one by one
	Add remote control User	2→press the remote controller key	Press the remote controller keys you want to add one by one.
Delete Users	Delete one User	3→1→U	U stands for Users (input code/swipe card/press remote controller)
	Delete all Users	3→2	Delete all users except Admin

Press "*" → "#" → Admin Code → "#" to enter the following menu

Set Admin Code

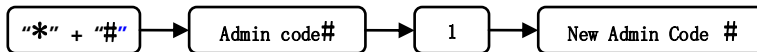

Set User Code:

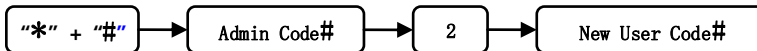

Set Card user:



Set Remote controller (Optional) :

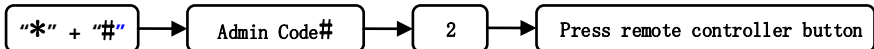

Users can change their codes by their own

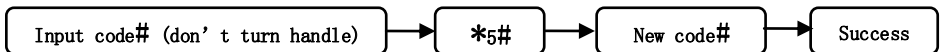

Delete Single user :



Delete All users :

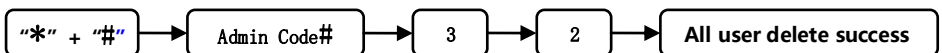

Passage Mode setting



Verification Mode setting

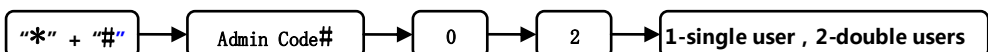

1. Others

- Admin User can set a new Admin code by revision. After the revision, the new Admin will replace the old

one. (the new Admin code will replace the old one)

- When entering the Passage Mode, the motor will not lock the door automatically after unlocking by card/code/remote controller, and everyone can unlock the door by turning the handle. Press # or swipe the card to cancel the Passage Mode.
- While inputting the password, please press # for confirmation, and press * for elimination.
- This lock has anti-peeking function, with which users can input innocent number before or after the password, e.g. XXX+password+XXX. (no more than 20 digits.)
- If you do not add any remote controllers, the remote control mode turns off which saves power. It will not work until you add the remote controller.
- Upon add users, input password and press “#” to confirm it, the password and card couldn't input same code or card, the password digits is 6-10 digits.
- The keypad will be locked for 3 minutes after a continuous inputting wrong password for 5 times.
- Low voltage alarm function : There will alarm to remind to change the batteries upon unlock the door when the voltage is below 4.8V. After that, the lock can be unlock 200 time.

Enclosed: drilling hole drawing

