

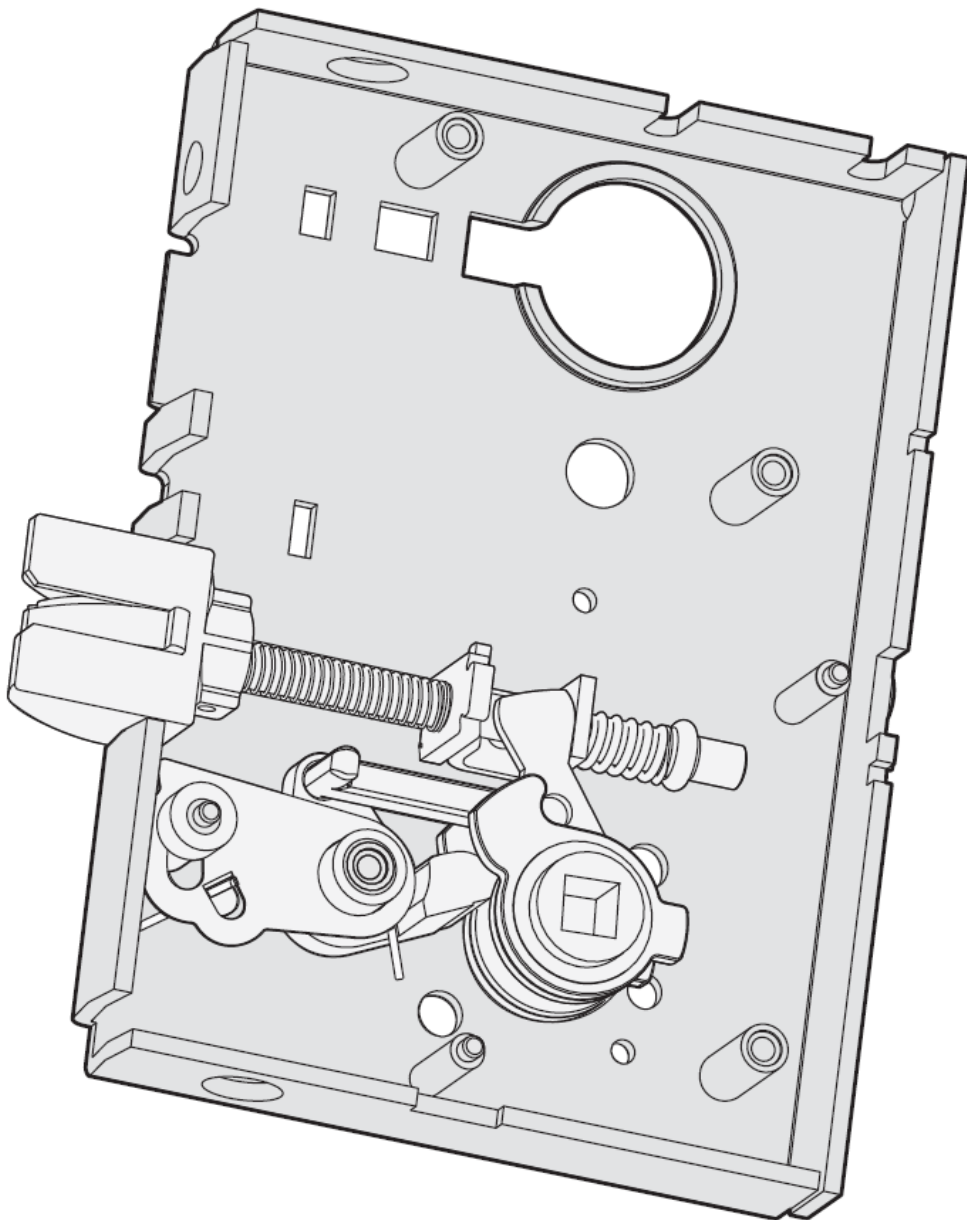

LK102



L-Series Mortise Lock Servicing



L9010 Passage set

L9010 Passage Set Assembly

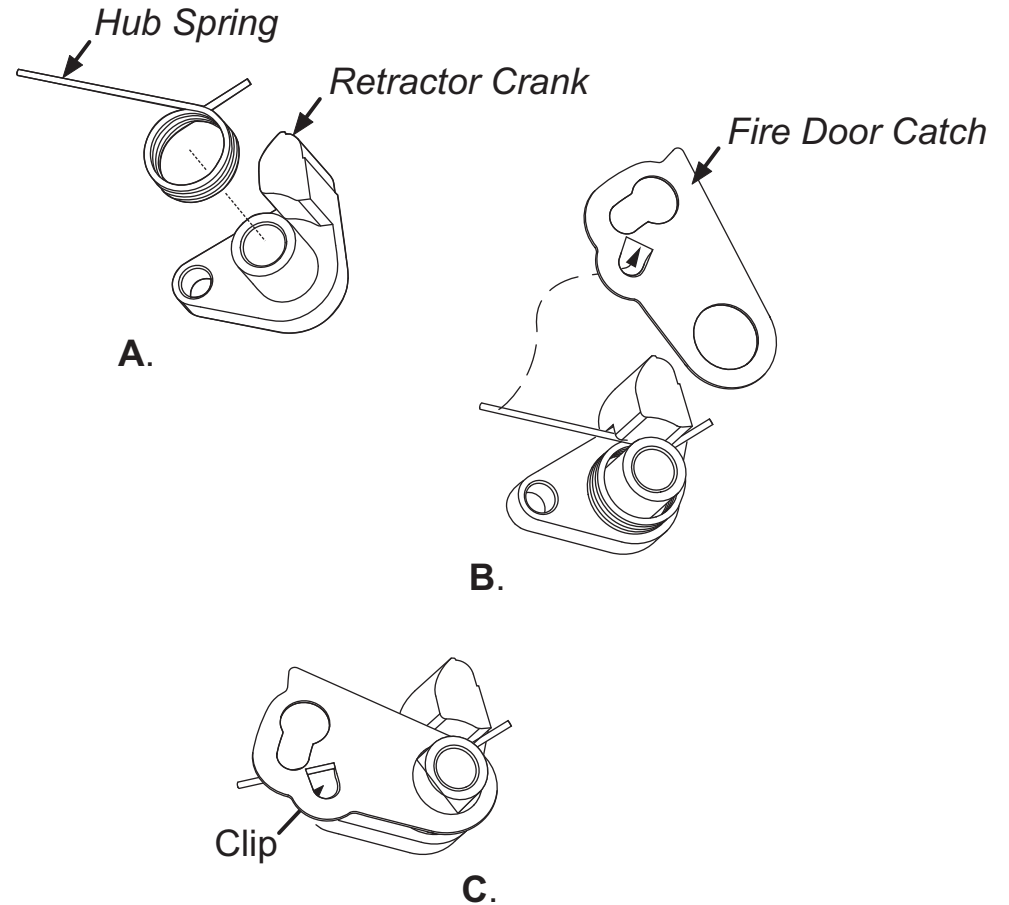
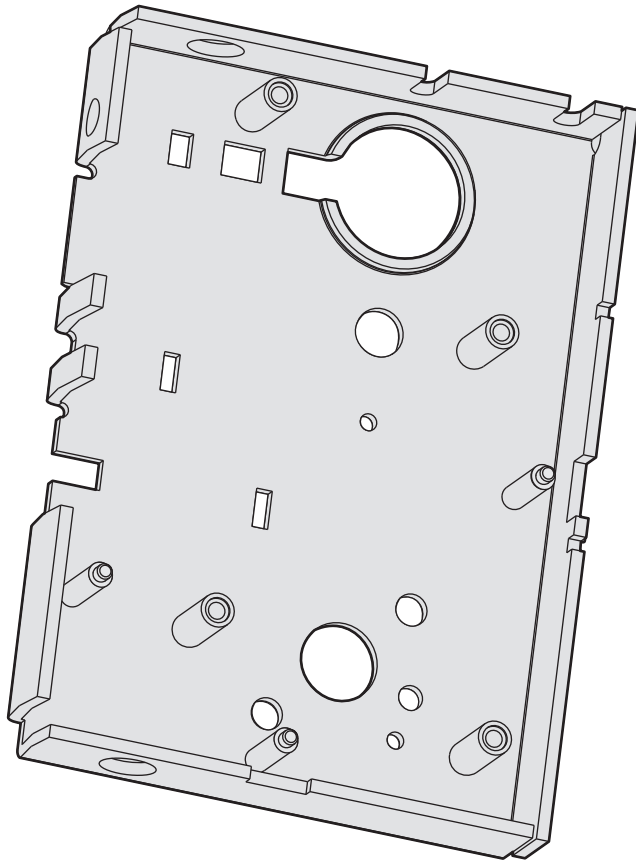

1.

Start with empty *L9000* lock case.

2. (Fire Catch Assembly)

A. Place *Hub Spring* on *Retractor Crank*.

B. Put *Fire Door Catch* on *Retractor Crank* tube.

C. Pull *Hub Spring* into *Clip* under *Fire Door Catch*.



L9010 Passage Set Assembly

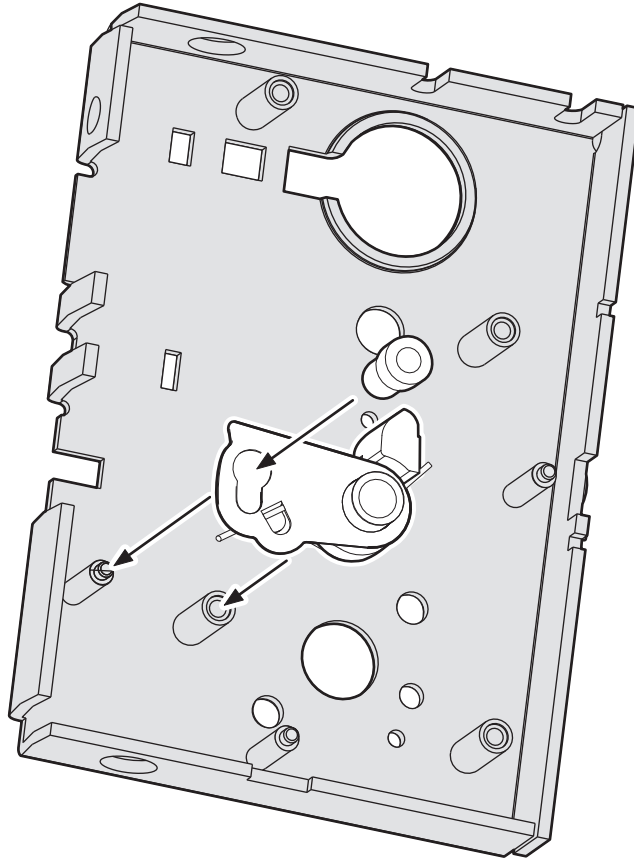

3.

Put *Fire Catch* assembly into case, followed by *Fire Door Fuse*.

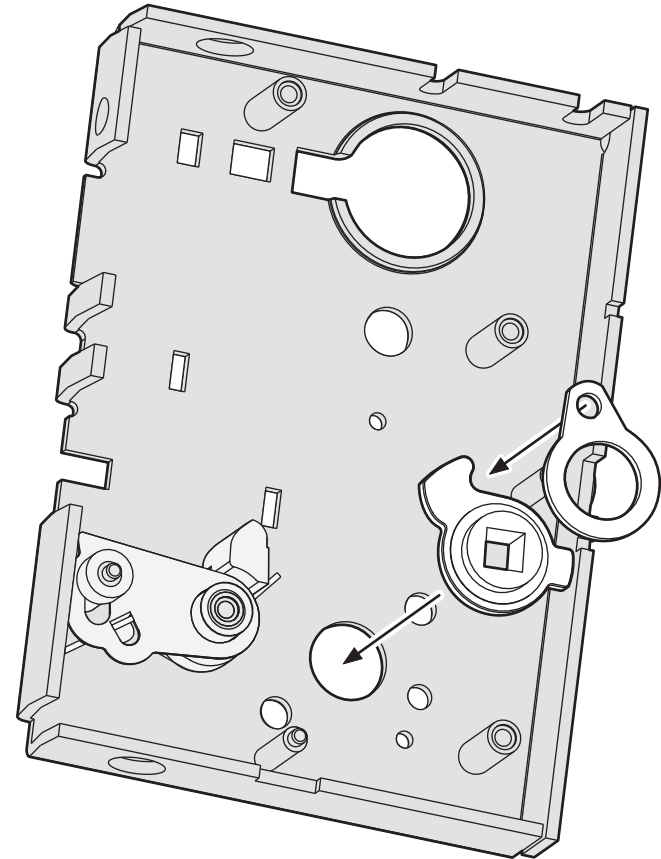

4.

Start building the *Hub Assembly*. Place *Hub Retractor* in Case; small tab pointed to 3 o'clock.

Install *Retractor Rocker* so the small hole is in front of hook on *Retractor Hub*.

L9010 Passage Set Assembly

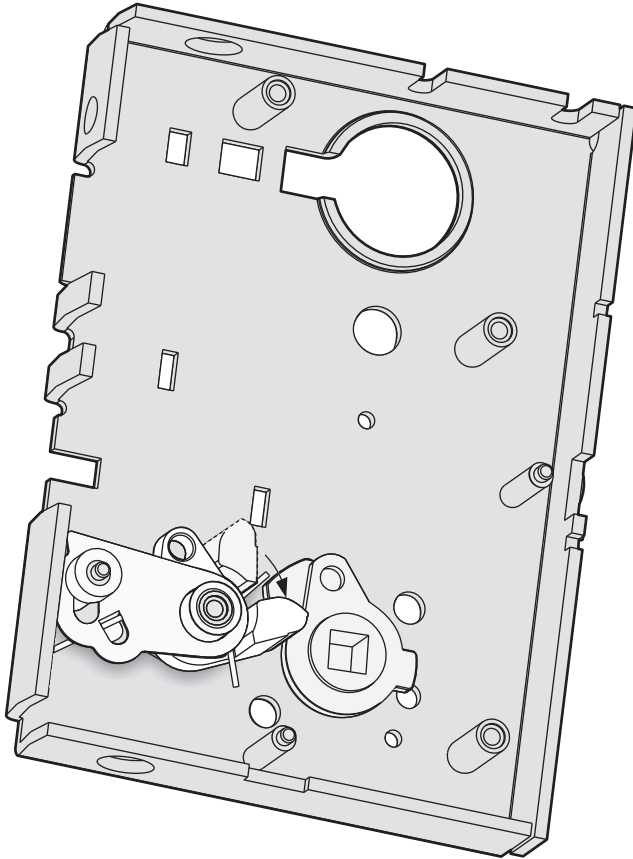

5.

Pull down on *Retractor Crank* lug so small hole is visible.

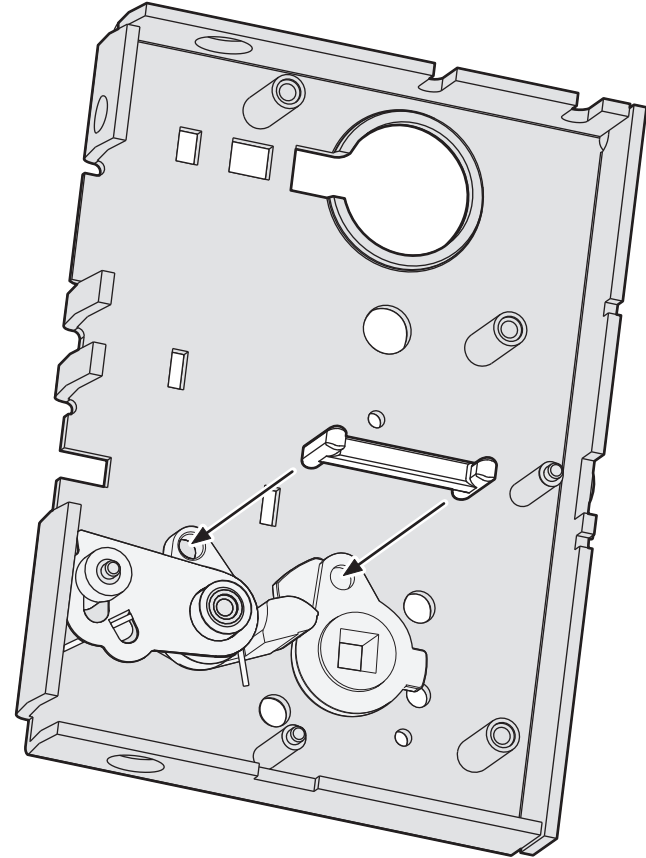

6.

Place *Retractor Link* in, connecting *Retractor Crank* and *Retractor Rocker*.

Slowly release *Retractor Crank* lug.



L9010 Passage Set Assembly

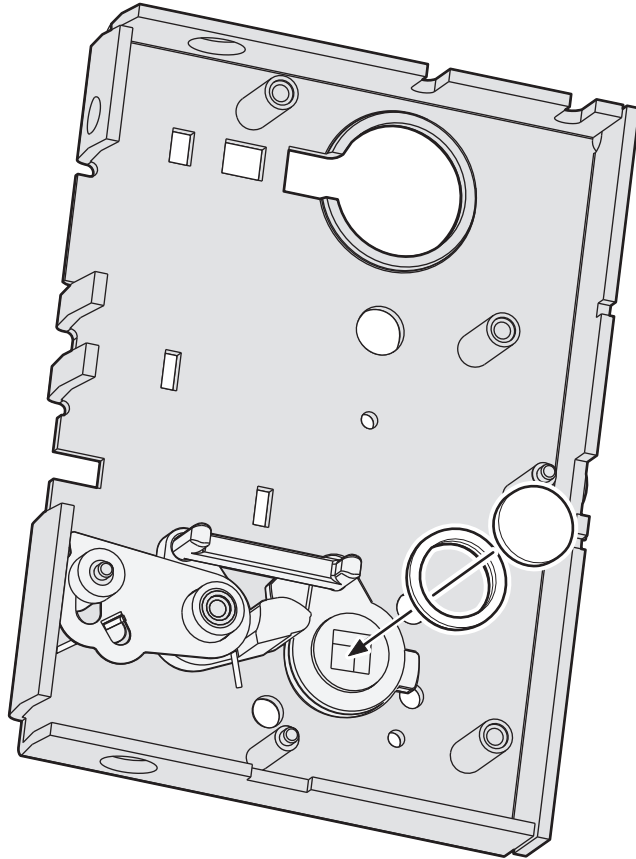

7.

Place *Hub spacer* on *Retractor Hub* and *Blocking Plate disk* inside *Hub Spacer*.

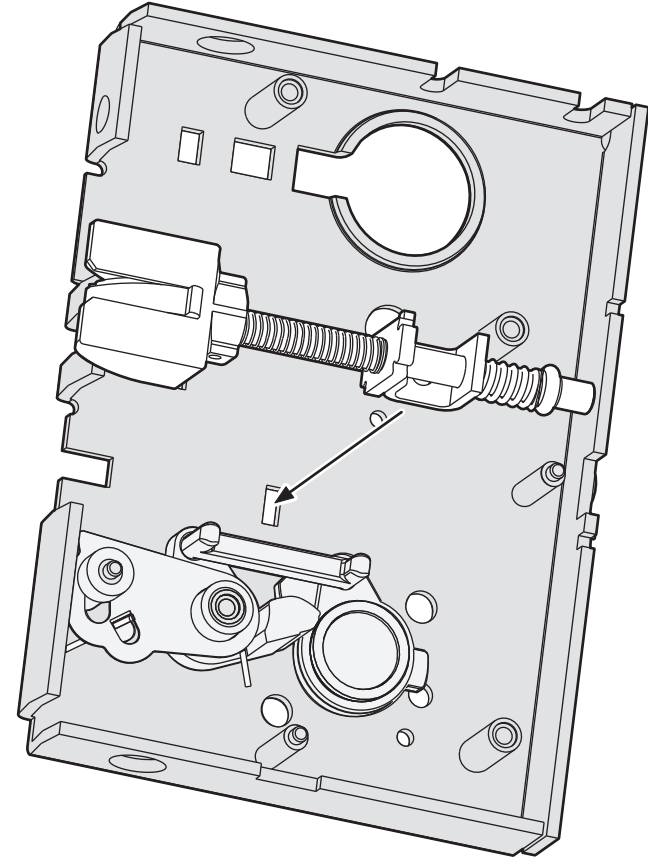

8.

Install *Latchbolt*; ensure anti-friction tongue is in correct position.



L9010 Passage Set Assembly

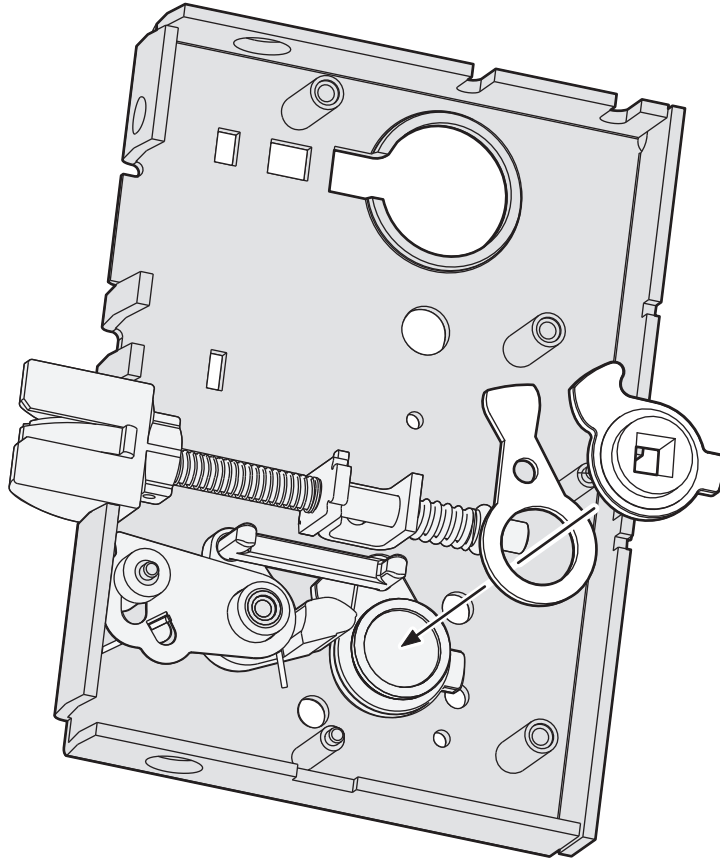

9.

Place *Retractor Lever* on *Hub assembly* and *Retractor Hub* on top of *Retractor Lever*.

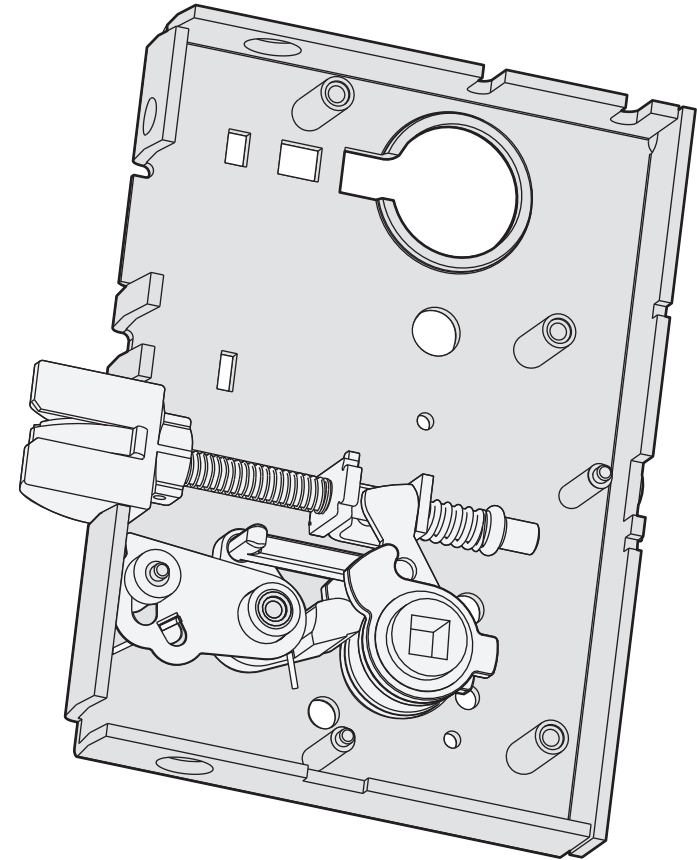

10.

L9010 Passage set is complete.
Normally, to finish the L9010, install *faceplate tabs*,
lock case cover and *cover screws*. For the class, please
leave as shown.





Universal Lock Case

L9050 Entry

L9060 Apartment Entry

L9070 Classroom

L9071 Classroom Security

Closet

Exit

Passage

Service

Storeroom

Utility

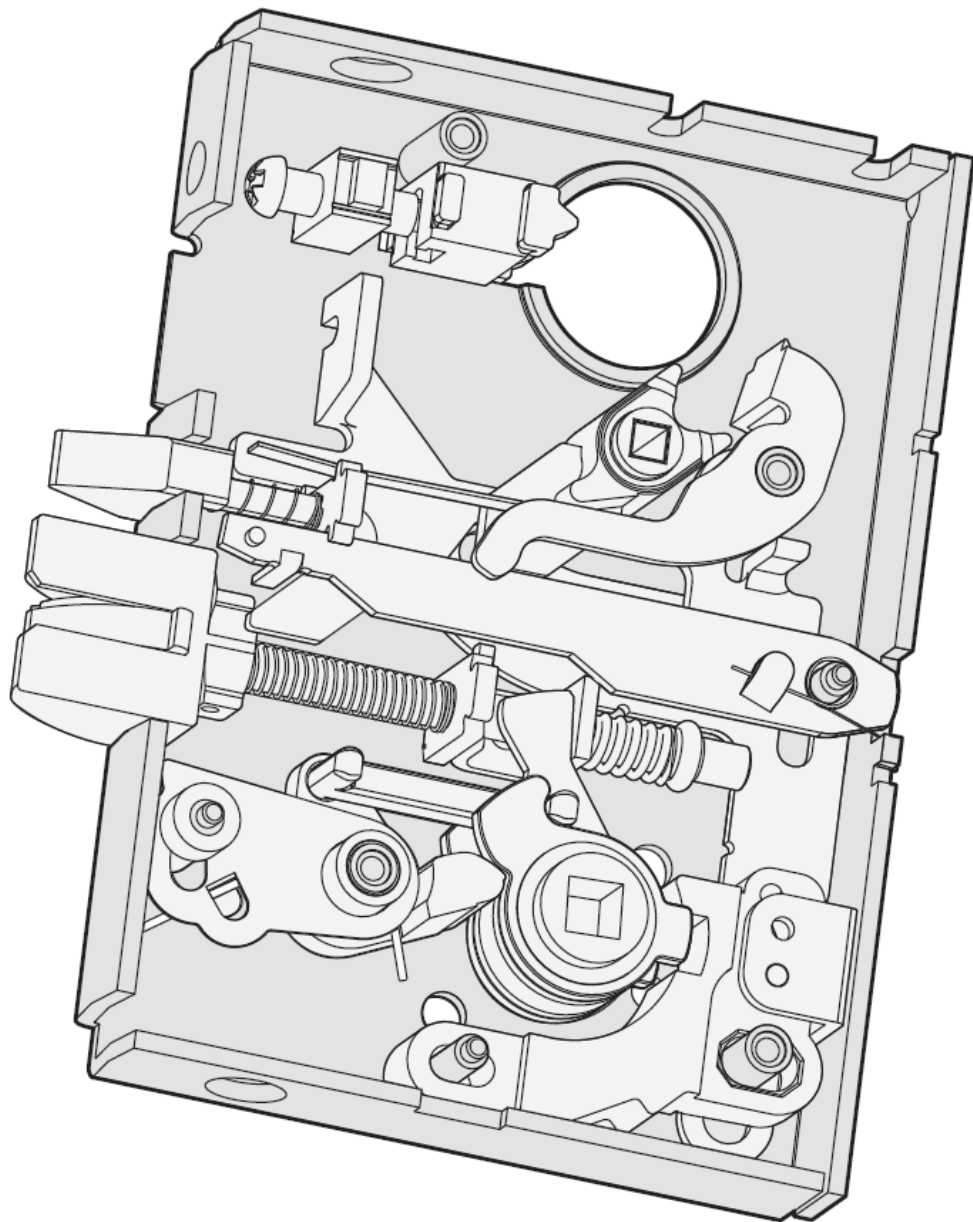

L9050, L9060, L9070, L9071 Universal Lock Case Assembly

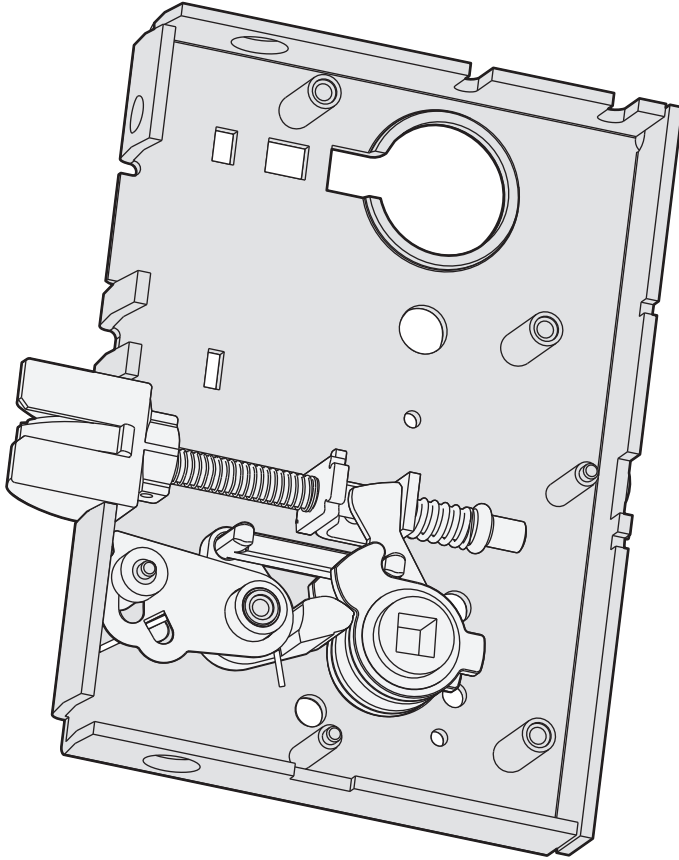

1.

Start the L9050 assembly beginning with the *L9010 Passage set*.

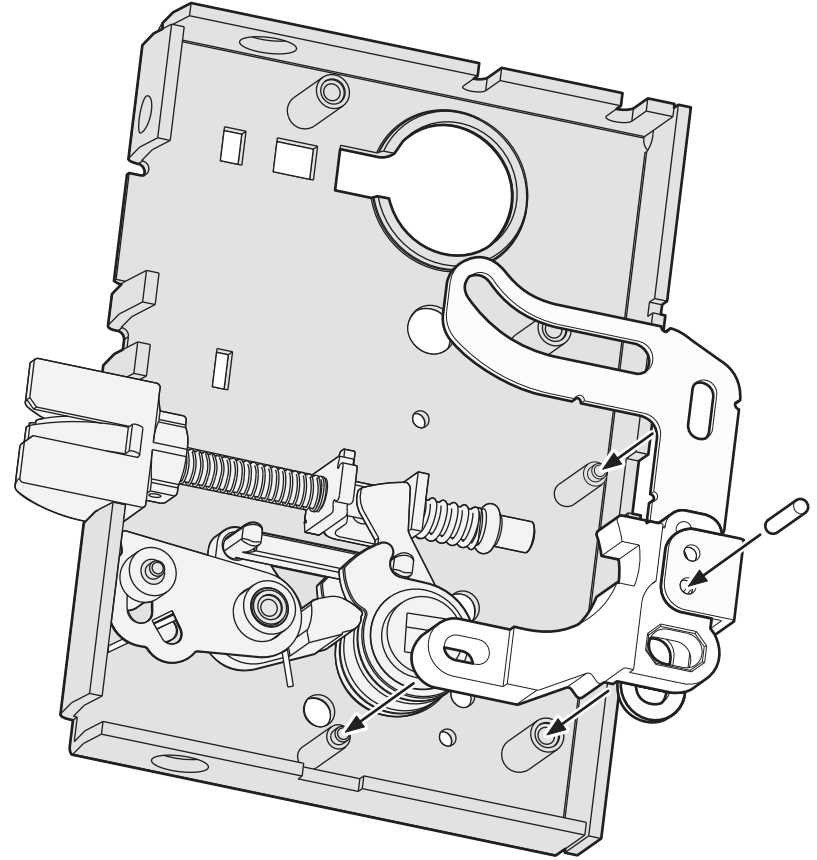

2.

Pre-assemble the *locking catch* and the *locking link*. Place the coupled parts in the case. Install the *link pin* in the bottom hole in *locking link*.



L9050, L9060, L9070, L9071 Universal Lock Case Assembly

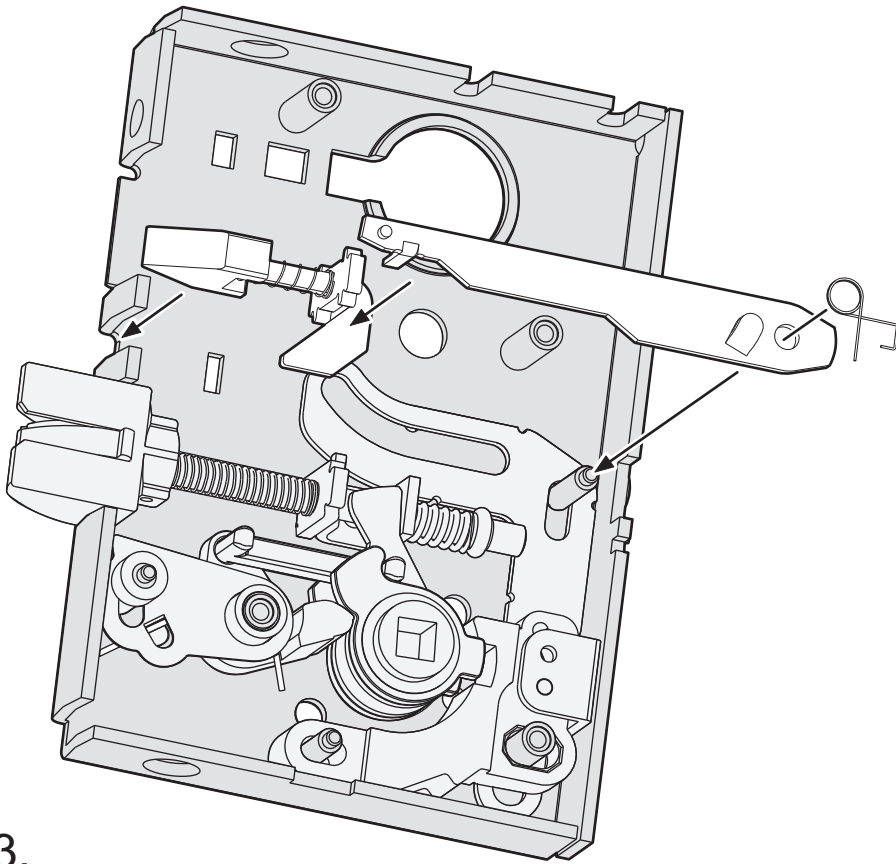

3.

Place *auxiliary latch* in lock case. Put the finger of the *auxiliary stop* in front of *auxiliary latch* tab, then other end of stop on case post.

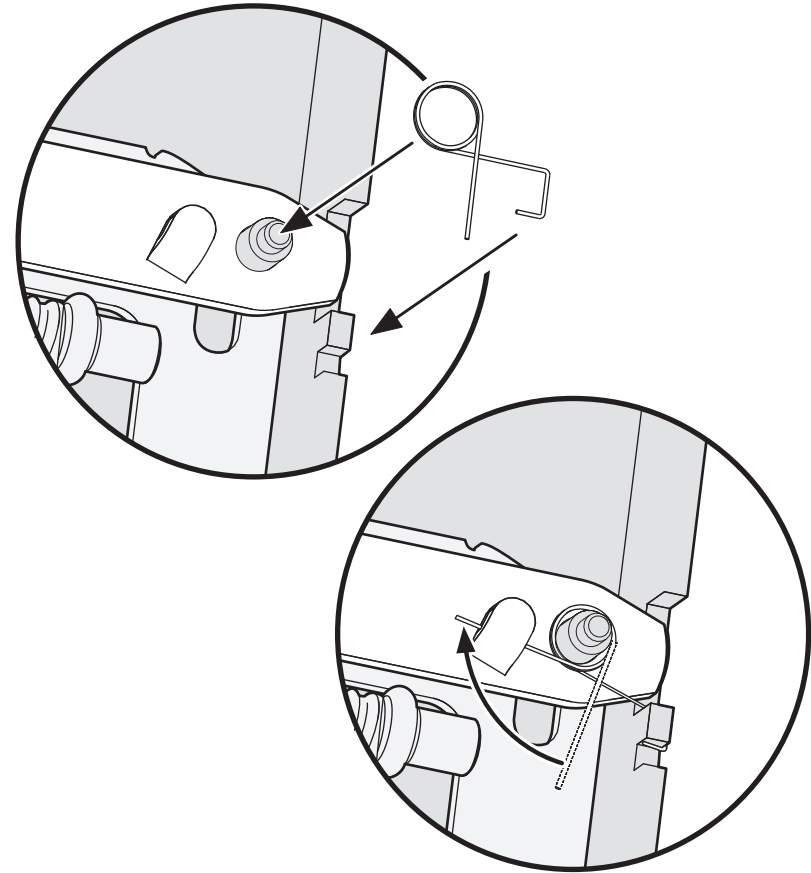

4.

1. Place bent leg of *spring* around tab in case.
2. Round part of *stop spring* goes over *lock case* post.
3. Pull loose spring leg up into clip on *auxiliary stop*.



L9050, L9060, L9070, L9071 Universal Lock Case Assembly

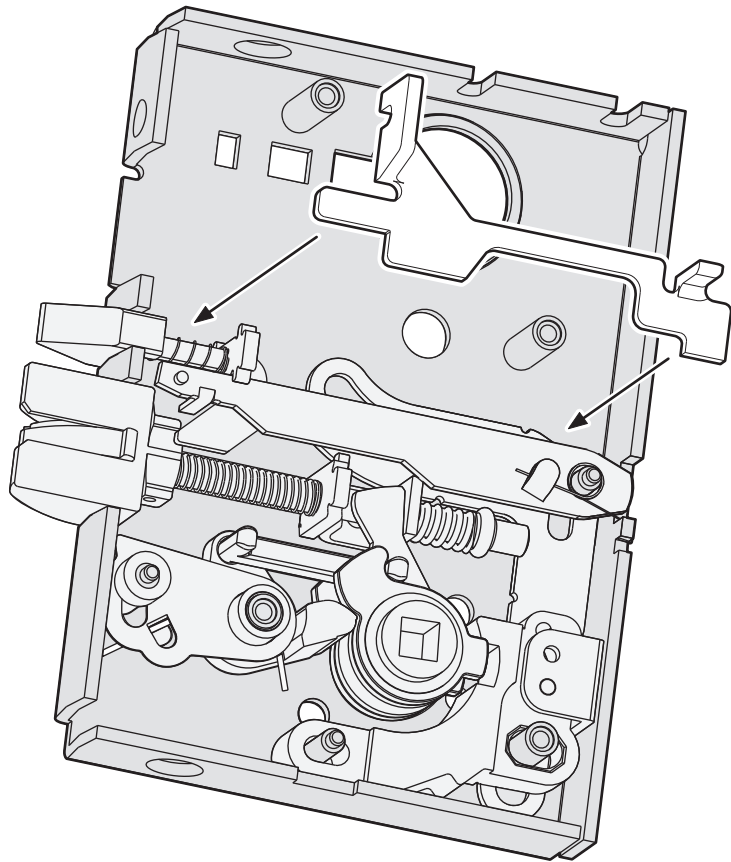

5.

Place *transfer lifter* on top of *locking link* and under *auxiliary stop*.

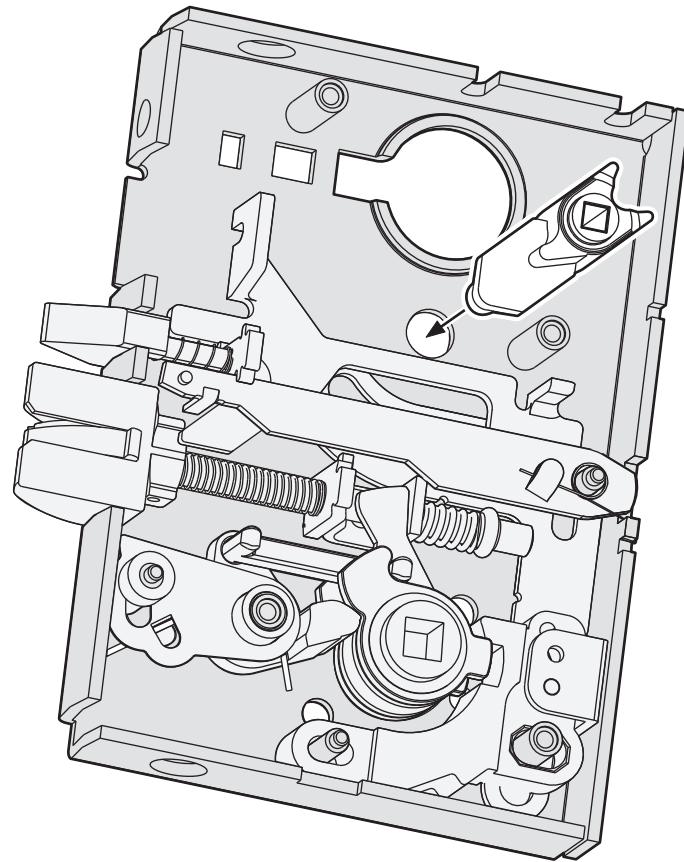

6.

Install one-piece *turn hub* so *turn hub* thumb goes over *transfer lifter* and into slot in *locking link*. Test *turn hub* by turning back and forth, leaving in position as shown.



L9050, L9060, L9070, L9071 Universal Lock Case Assembly

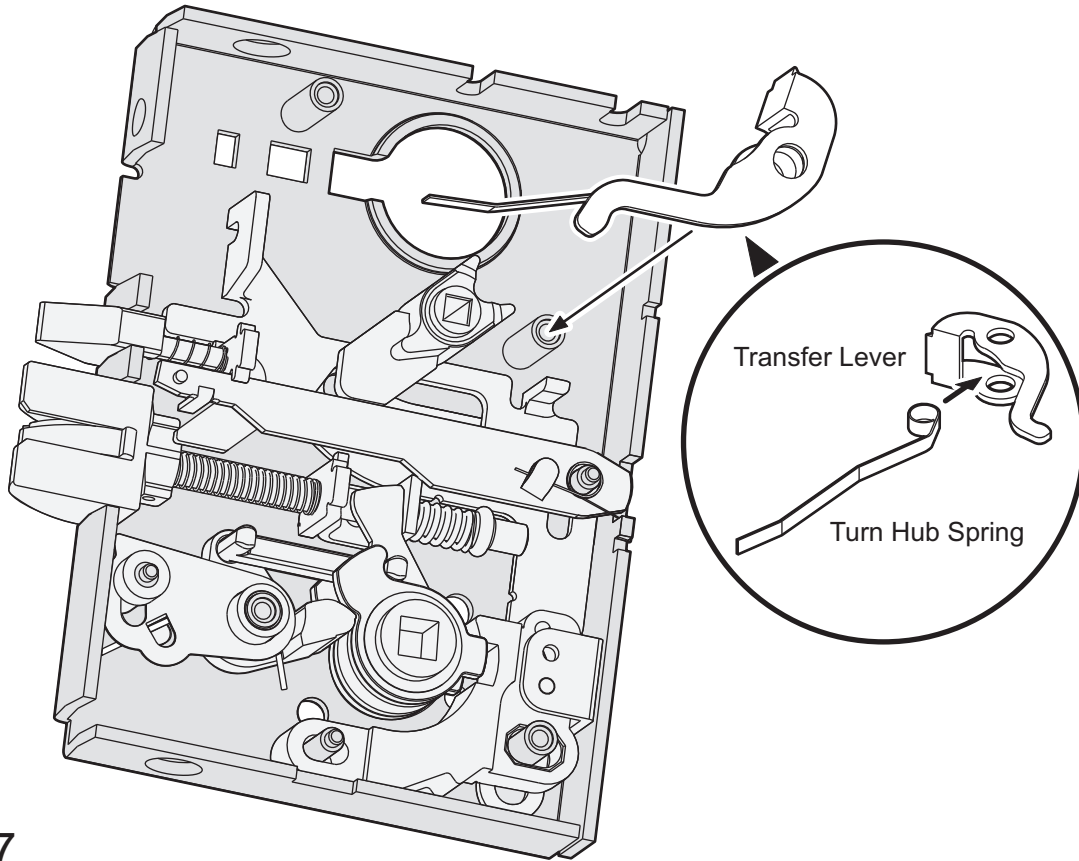

7.

Pre-assemble *transfer lever* and *turn hub spring*. Put *transfer lever* and spring on case post. While holding *turn hub* and *transfer lever*, pull *turn hub spring* to final position on top of *auxiliary latch guide*.

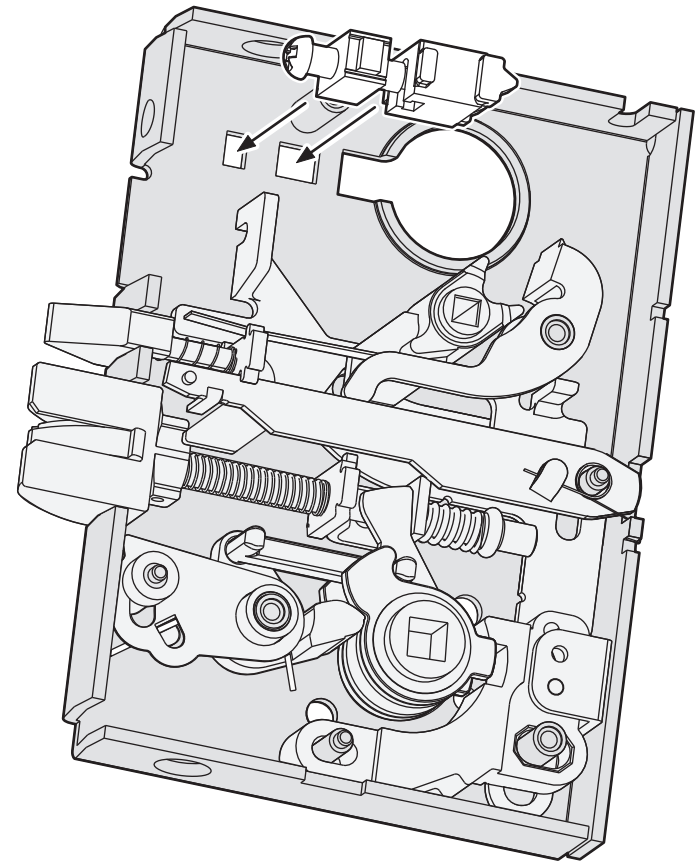

8.

Install the *cylinder retainer* assembly by putting the end of the *cylinder retainer screw* into T-slot in *cylinder retainer*, then place in case holes as shown.



L9050, L9060, L9070, L9071 Universal Lock Case Assembly

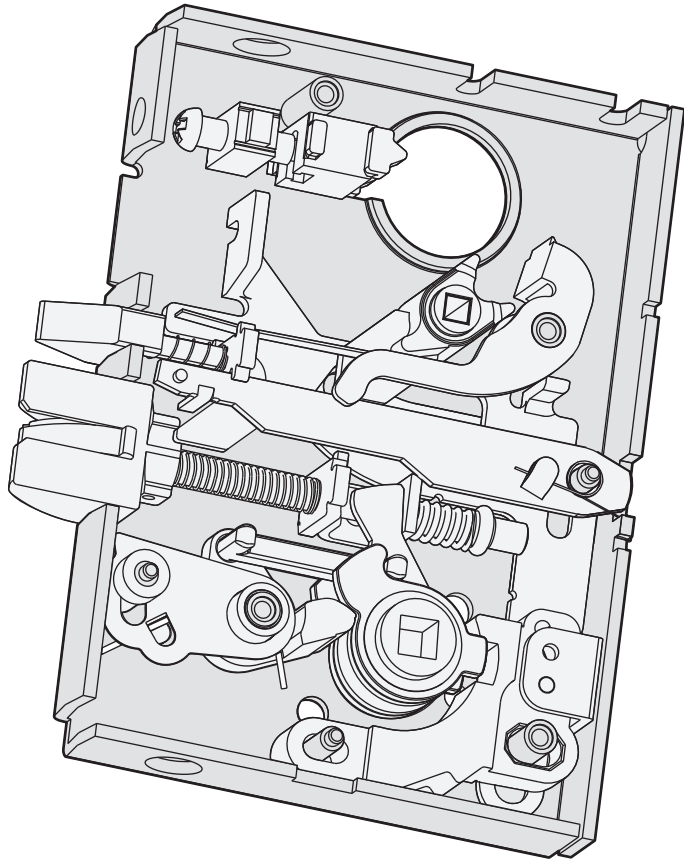

9.

Universal Lock Case is complete.

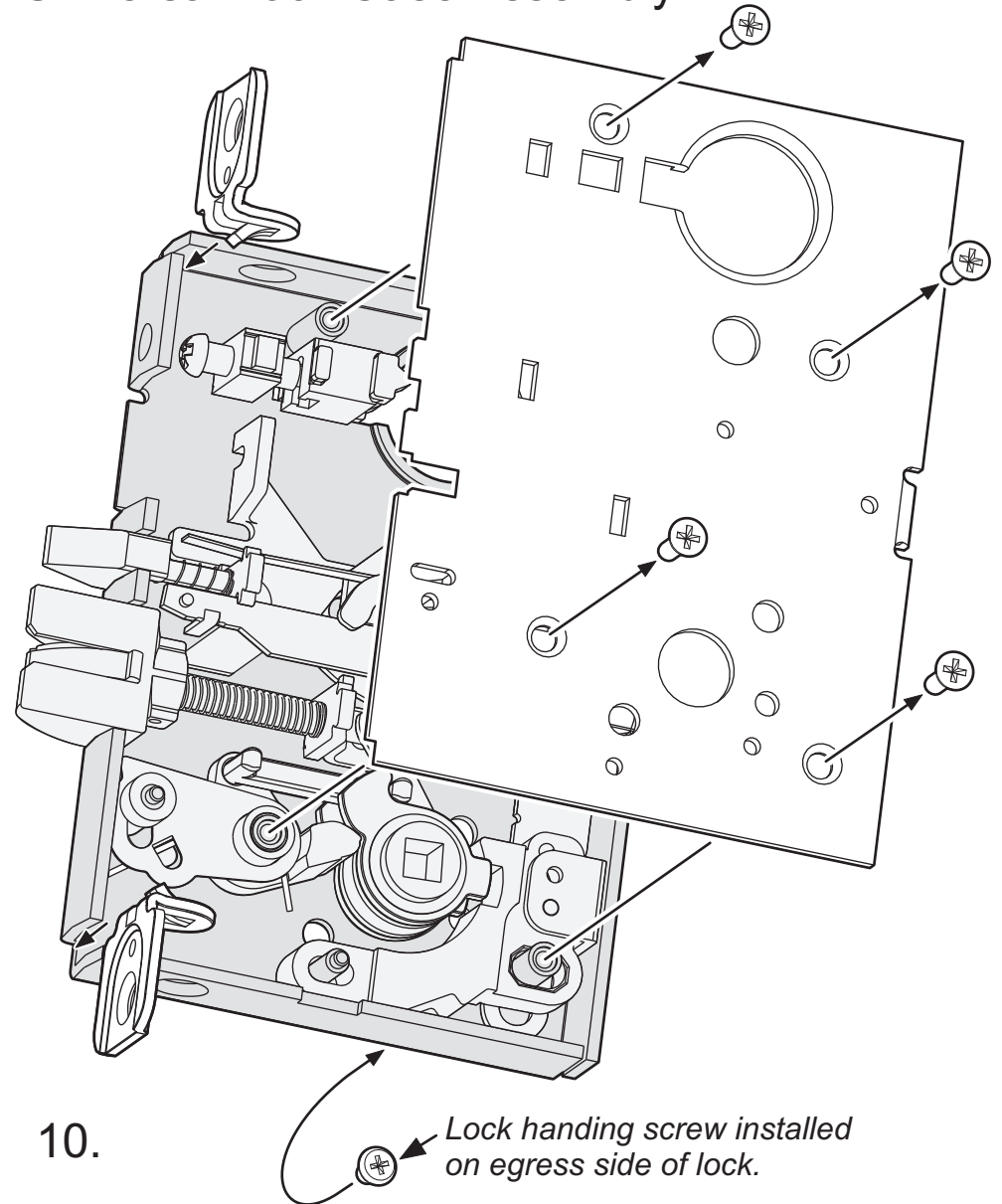

Install *faceplate tabs*, lock case cover and 4 case cover screws. Lock handing screw is installed on back of case.



Universal Lock Case Vandlgard

LV9050 Entry

LV9060 Apartment Entry

LV9070 Classroom

**LV9071 Classroom Security
Closet**

Exit

Passage

Service

Storeroom

Utility

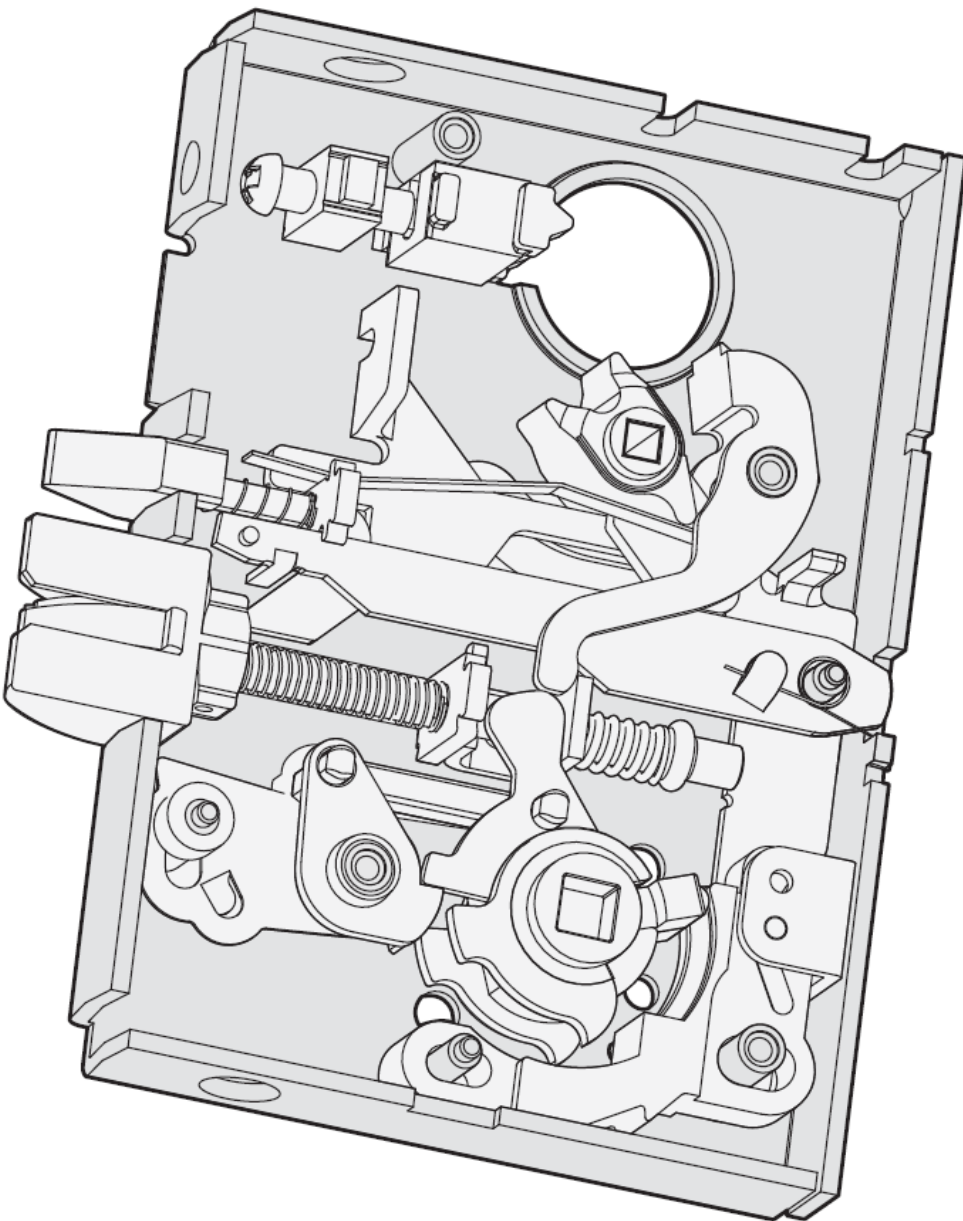

LV9050 Vandlgard Conversion from L9050

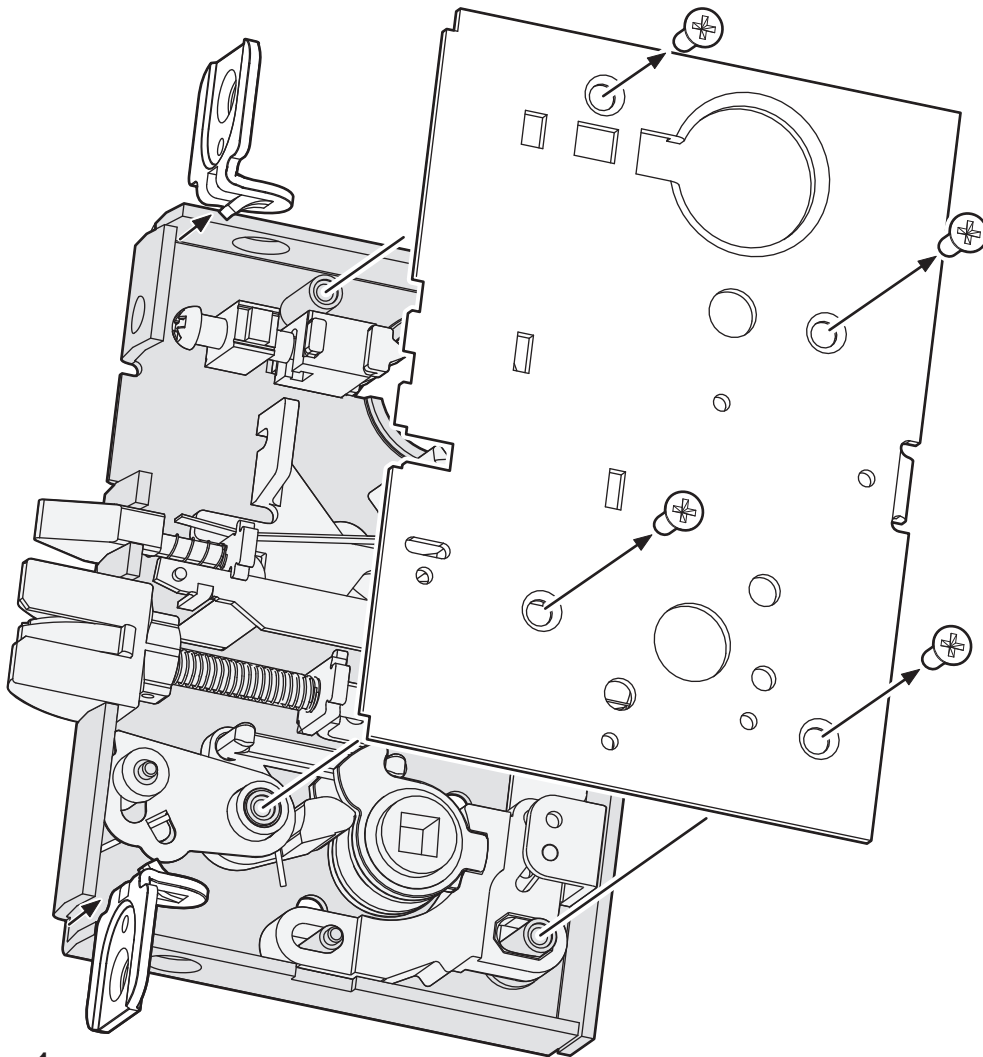

1.

Starting with the L9050, rotate the turn hub counter-clockwise to locked position. Remove case cover screws, lock case cover and faceplate tabs.

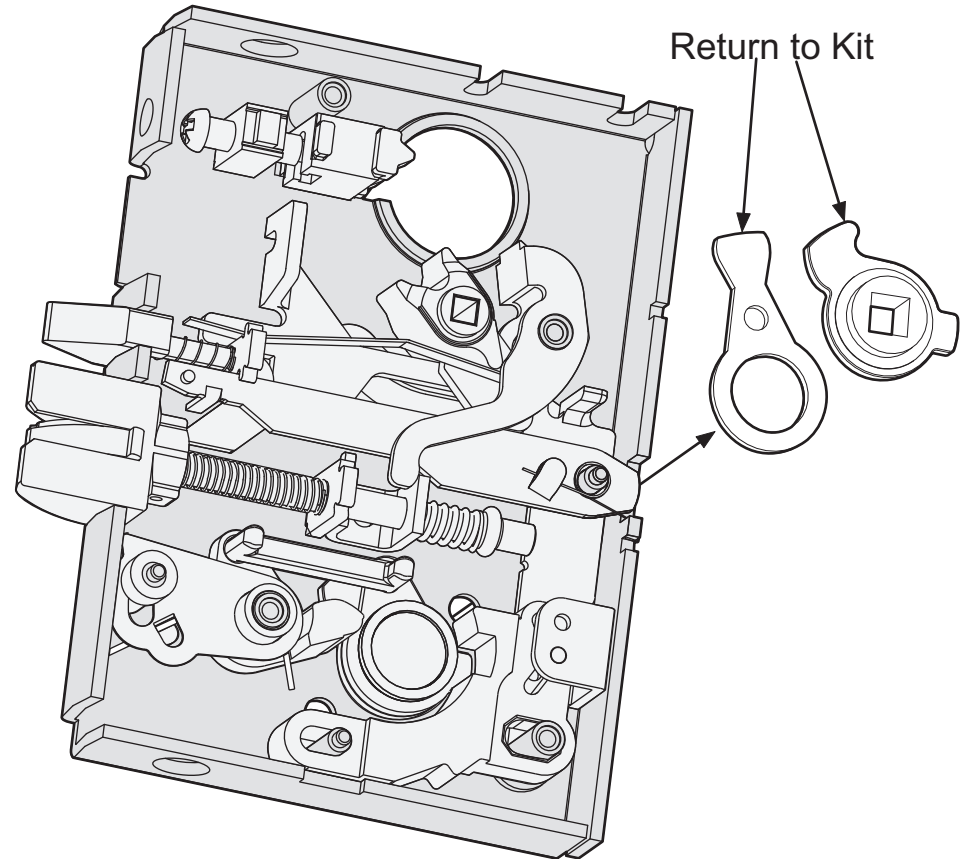

2.

Remove *retractor hub* and *retractor lever*. Place in training kit.



LV9050 Vandlgard Conversion from L9050

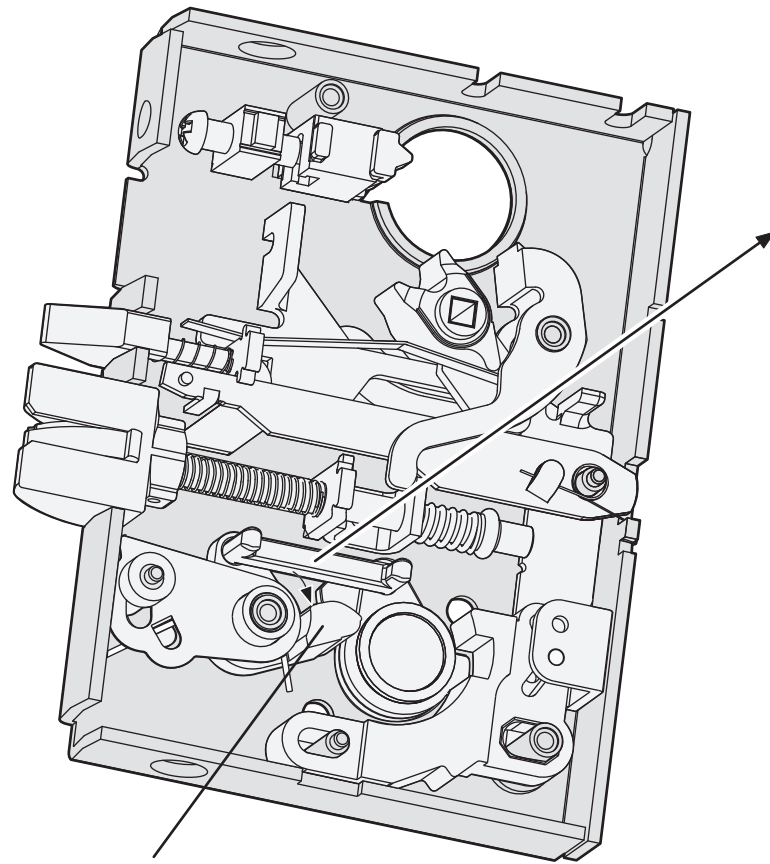

#1 Push down on
retractor crank lug

#2 Lift out
retractor link

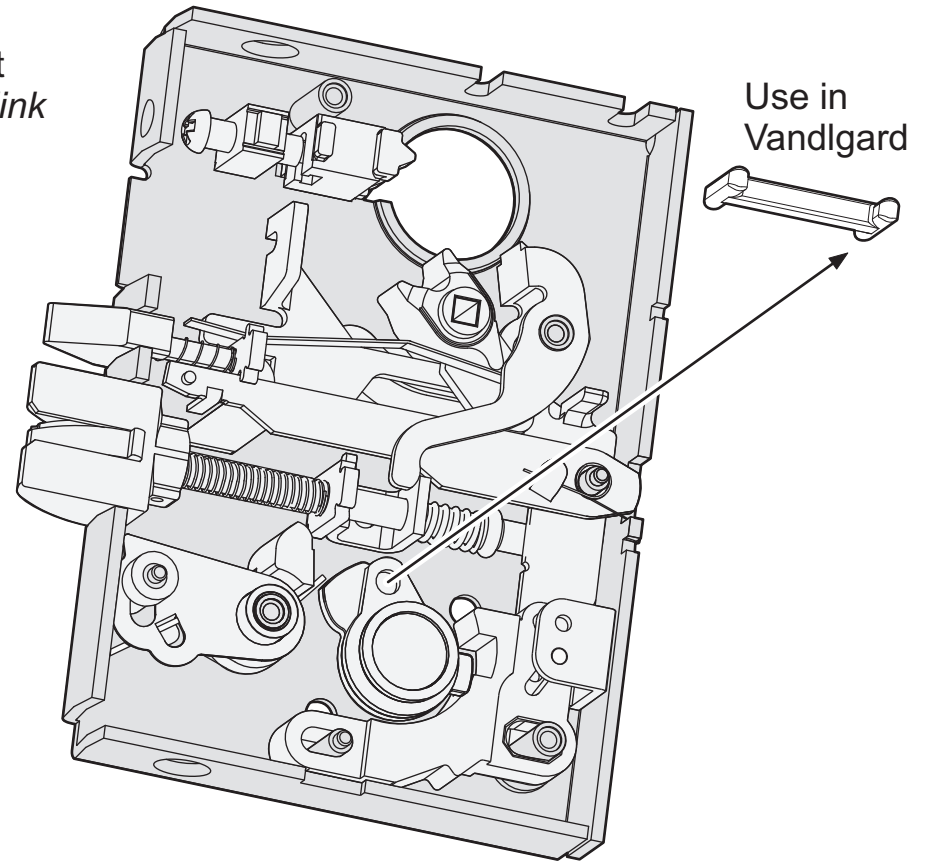

Use in
Vandlgard

3.

Push down on *retractor crank lug* and lift out *retractor link*. Slowly release *retractor crank*.

4.

Retractor Link is reused in LV9050.



LV9050 Vandlgard Conversion from L9050

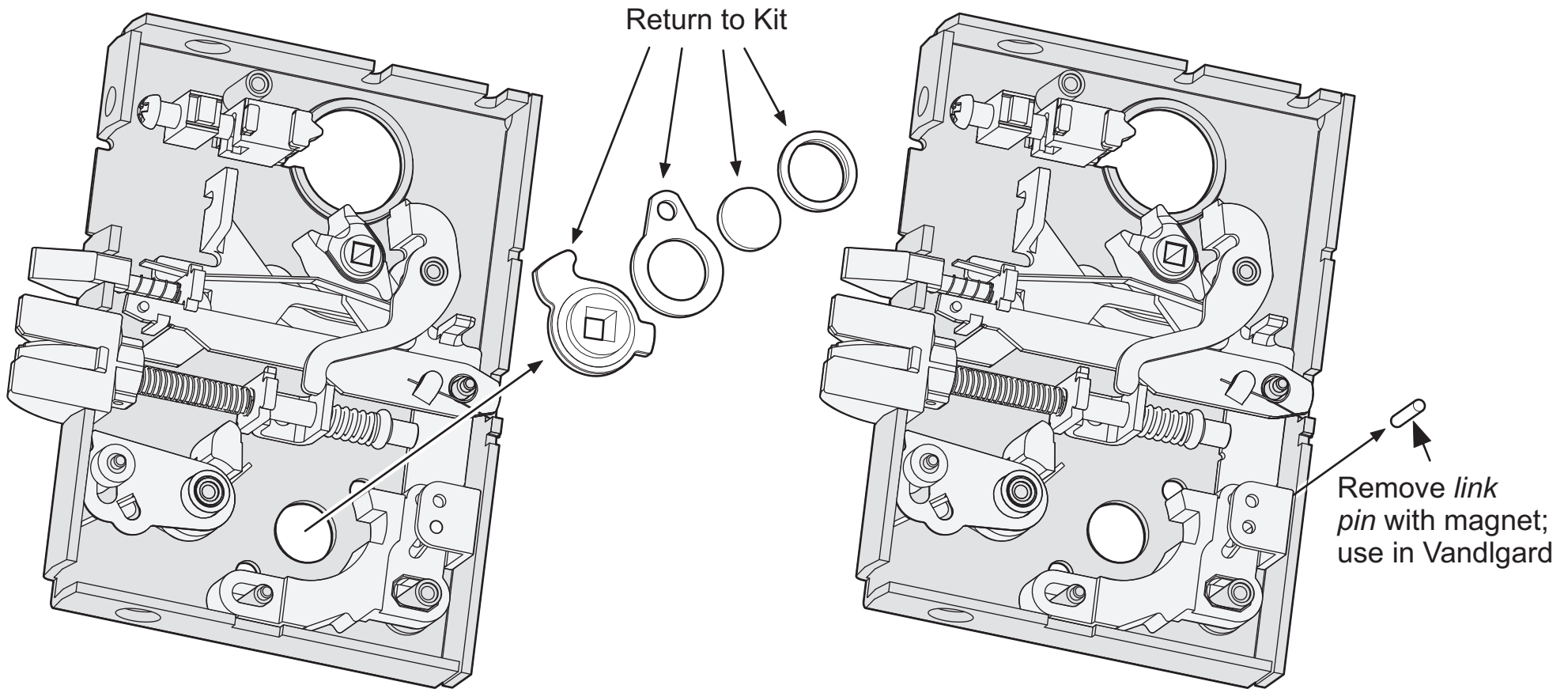

5.

Remove the *hub spacer*, *blocking plate*, *retractor rocker* and *retractor hub*. Put these back in training kit.

6.

Using magnet, remove *link pin*. Remember location when putting the *link pin* back in later. The *link pin* is used in the LV9050.



LV9050 Vandlgard Conversion from L9050

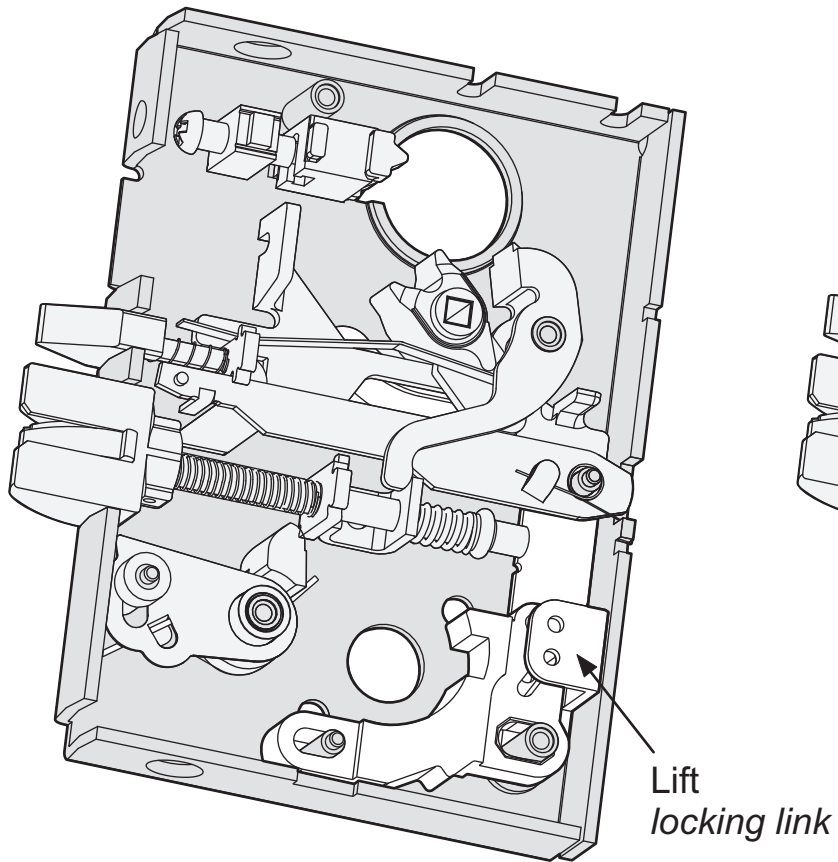

7.

Prepare to remove the *locking catch* by carefully lifting the *locking link*.

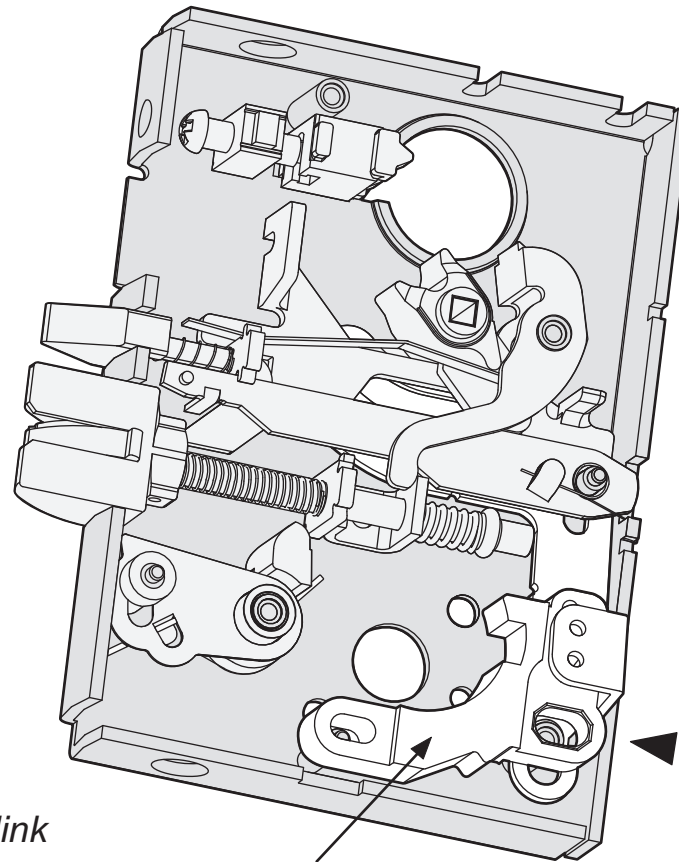

8.

Slide out the *locking catch* and put it back in the training kit.

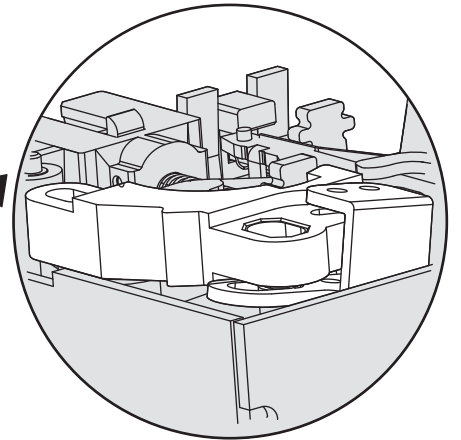

LV9050 Vandlgard Conversion from L9050

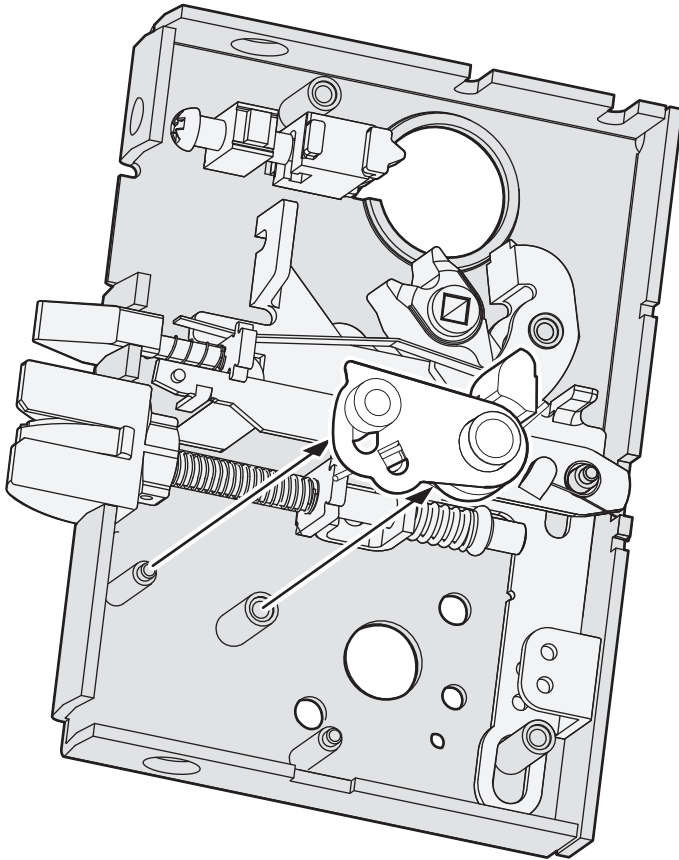

9.

Remove the fire catch assembly and disassemble as shown in next step.

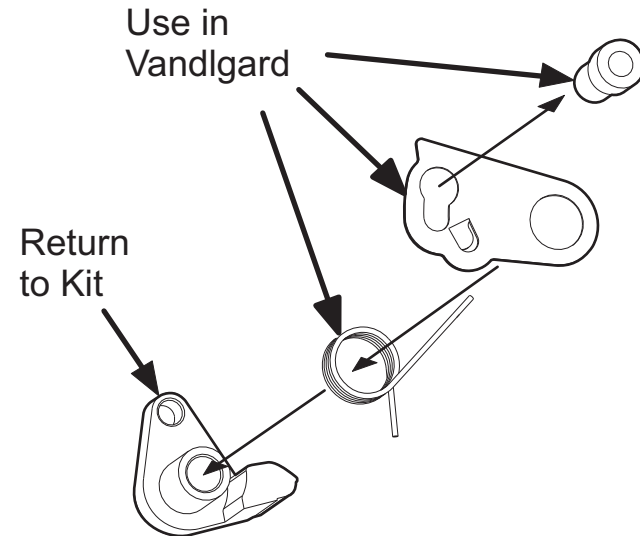

10.

Put the *retractor crank* back in the training kit. The *hub spring*, *fire door catch* and the *fire door fuse* will be used in the LV9050.



LV9050 Vandlgard Conversion from L9050

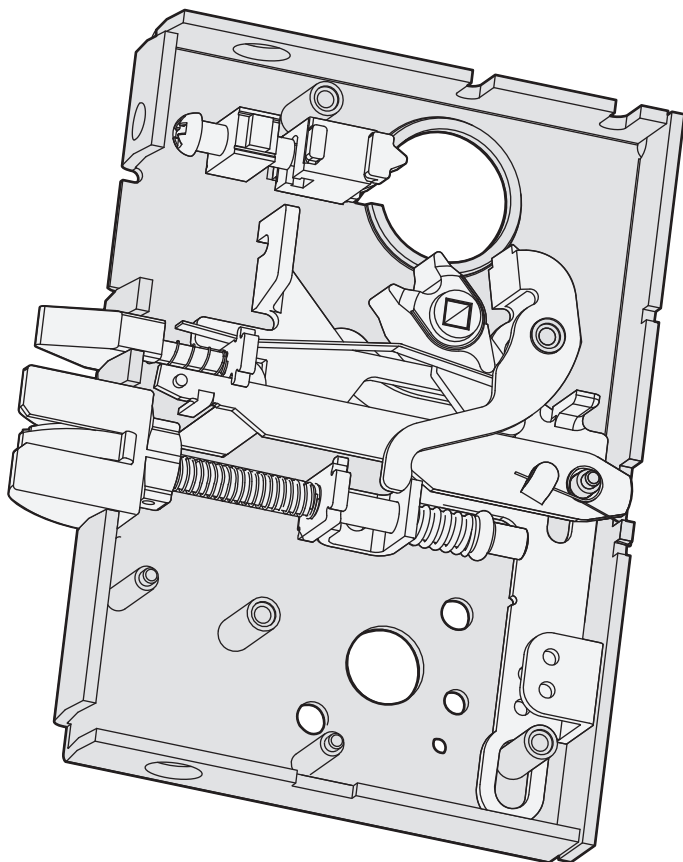

11.

Your lock case should look like drawing above. You are now ready to start converting the lock to Vandlgard.

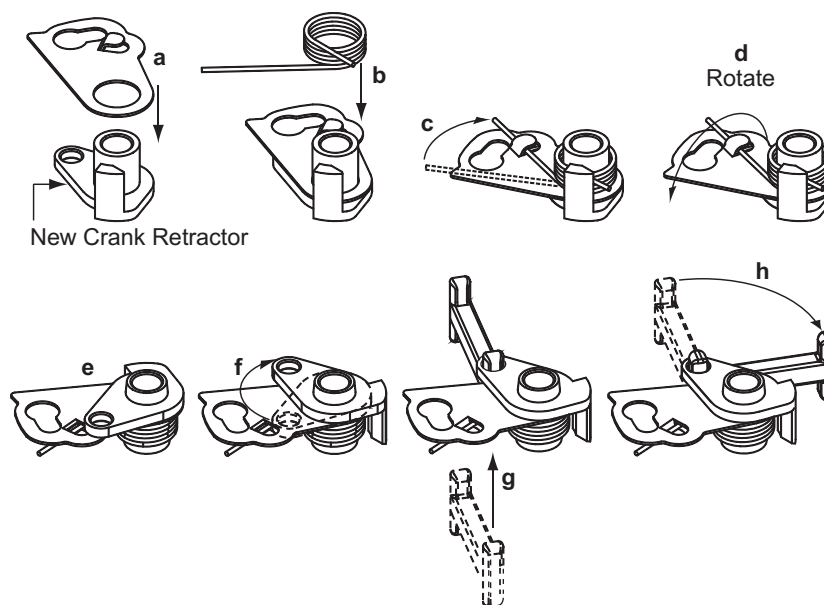

12.

Rebuild the Fire Door Assembly as shown using the new *crank retractor*.

LV9050 Vandlgard Conversion from L9050

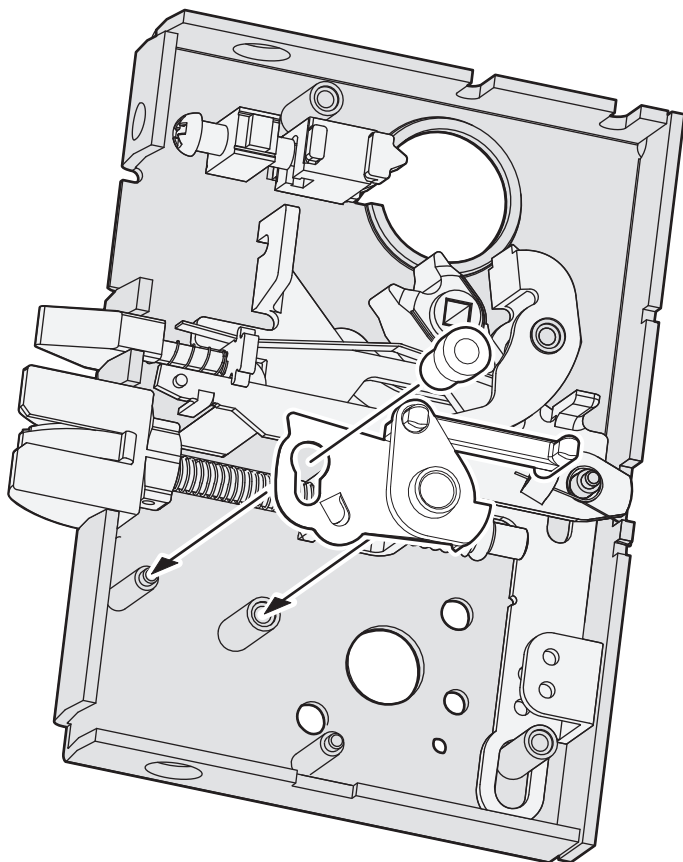

13.

Install the new fire door assembly in lock case, then put *fire door fuse* on case post.

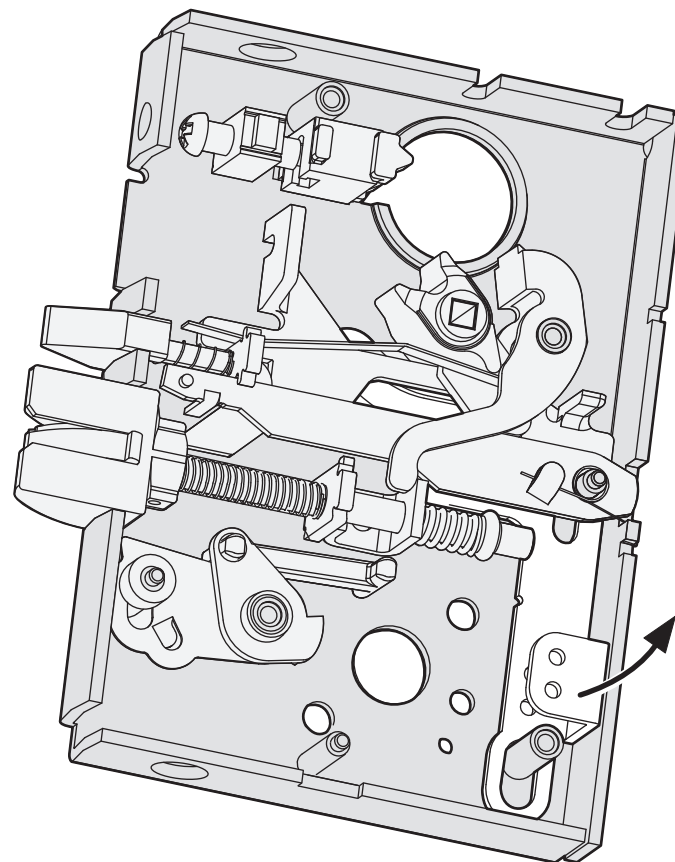

14.

Carefully lift and tilt *locking link* from bottom of lock case.

LV9050 Vandlgard Conversion from L9050

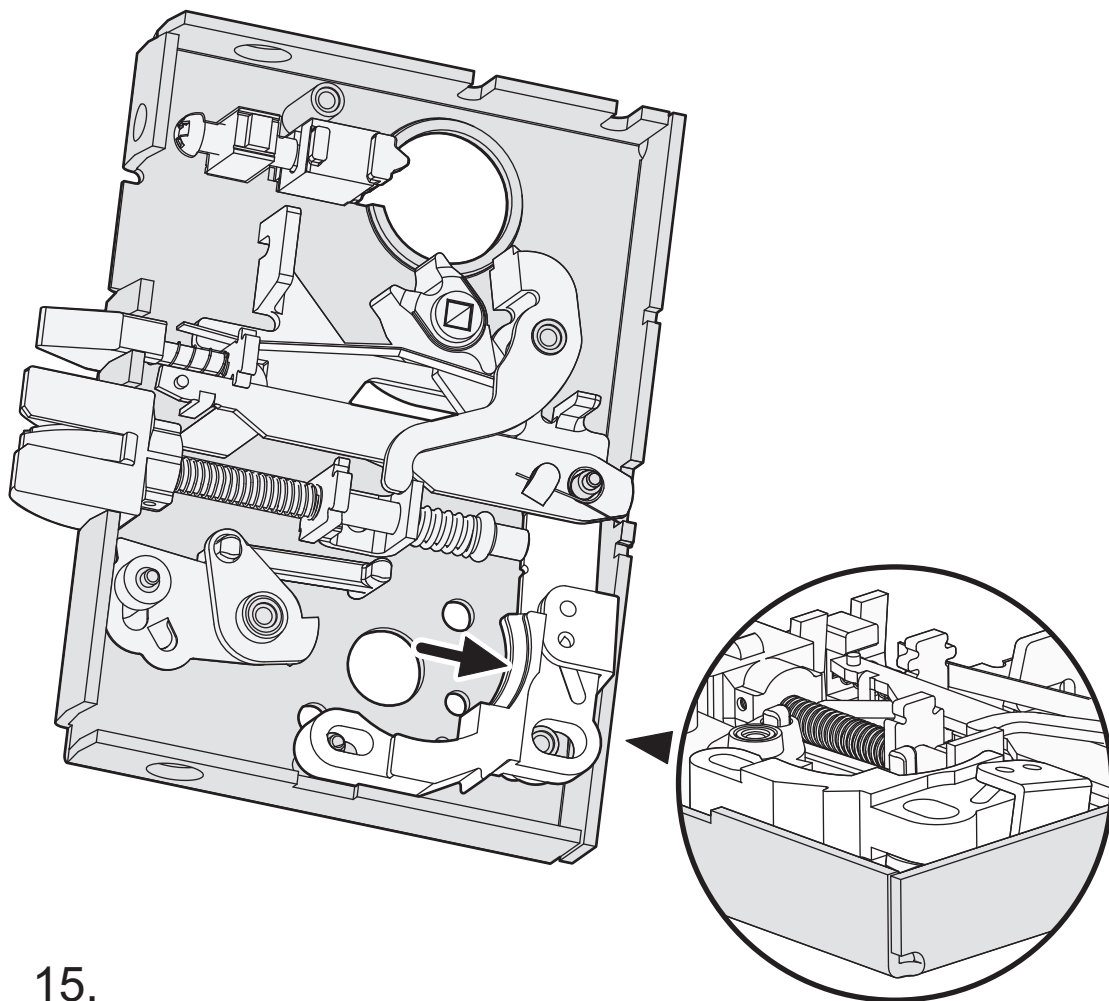

15.

Slide new *catch retractor* into *locking link* and lower both parts into case.

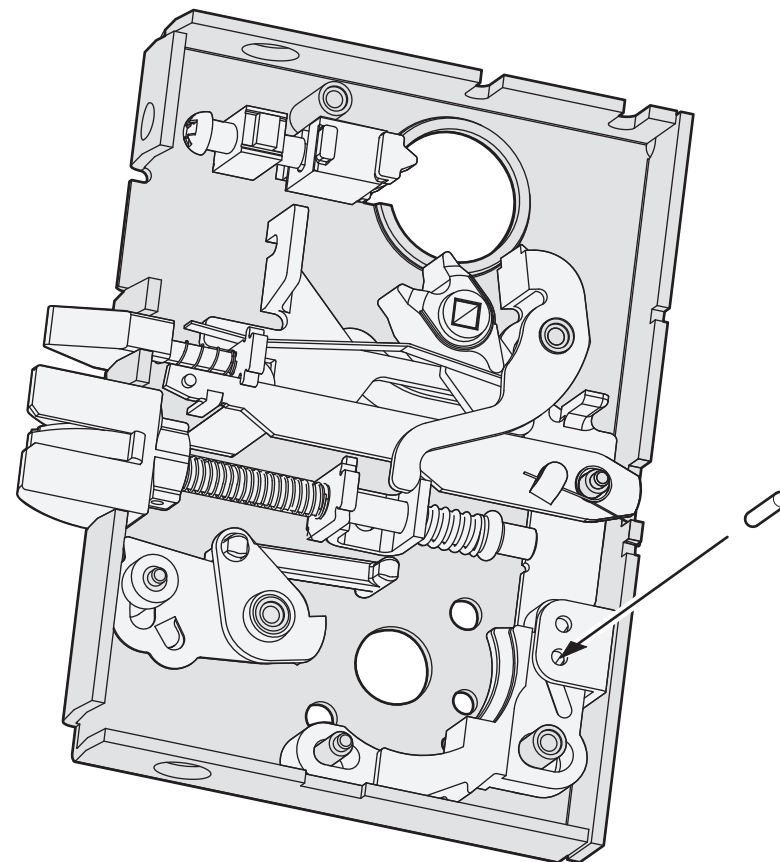

16.

Put *link pin* back in original hole.



LV9050 Vandlgard Conversion from L9050

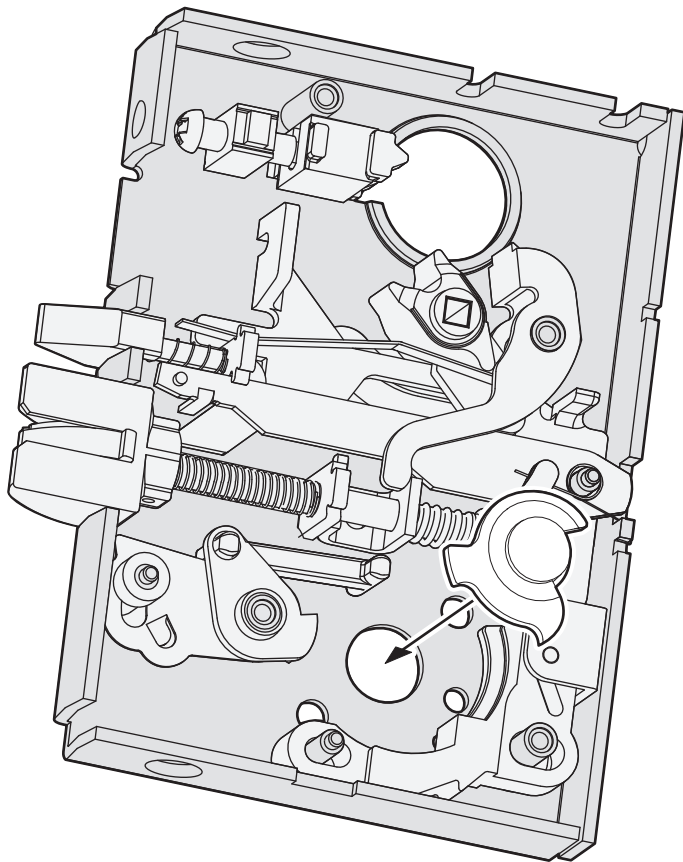

17.

Put *bottom hub* in large hole in lock case with *bottom hub* point facing bottom of case.

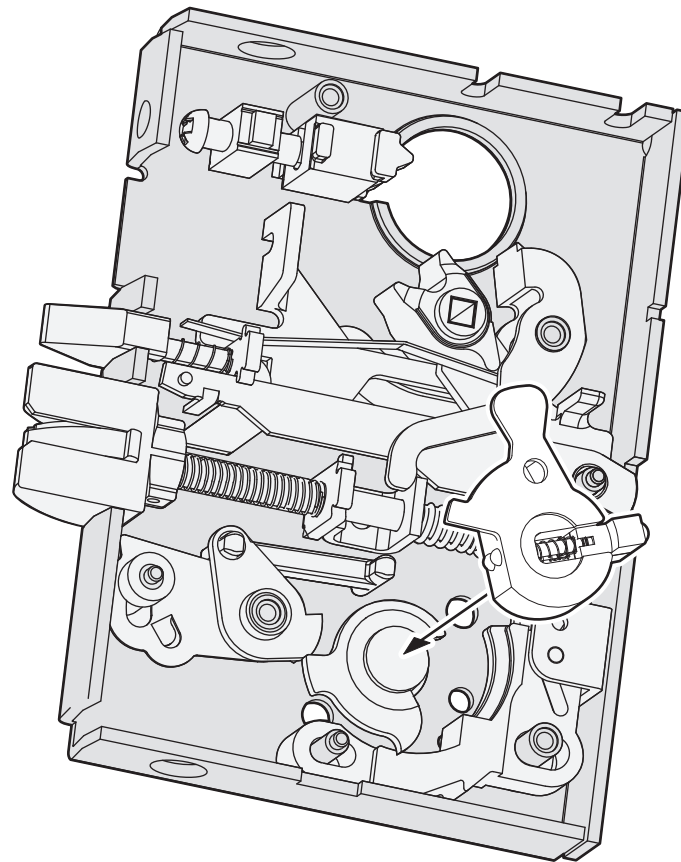

18.

Put *retractor assembly* on top of *bottom hub*.

LV9050 Vandlgard Conversion from L9050

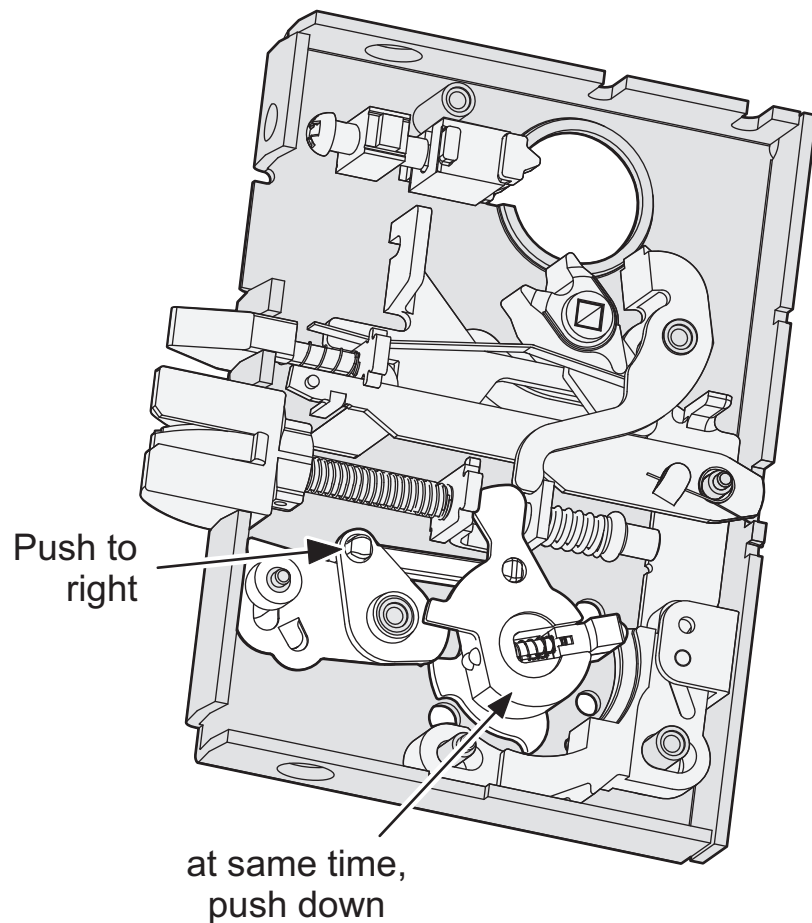

19.

Place a finger on the *retractor assembly*. While lightly pushing down on the *retractor assembly*, push *retractor link* to the right.

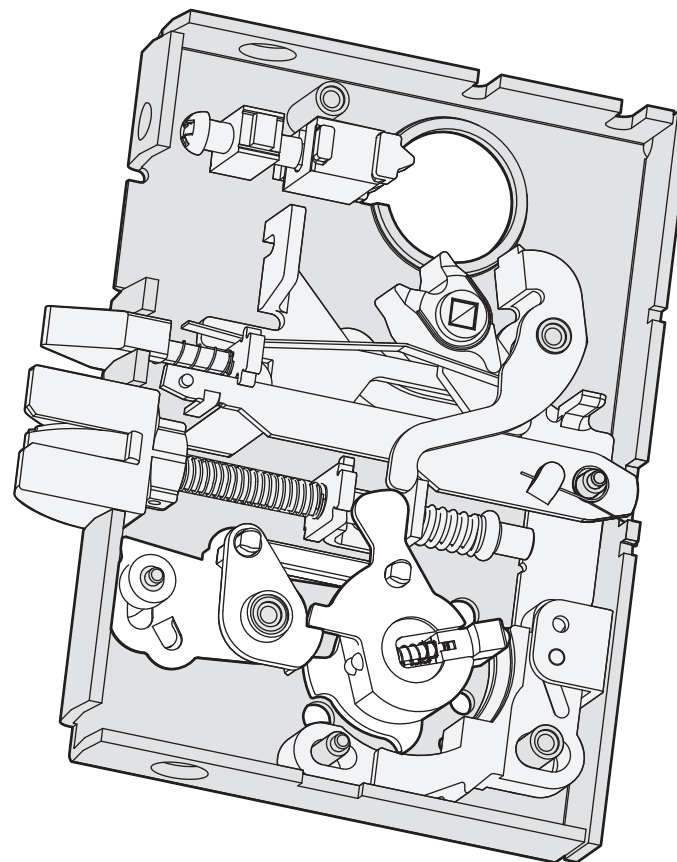

20.

Retractor assembly will snap into position as shown.

LV9050 Vandlgard Conversion from L9050

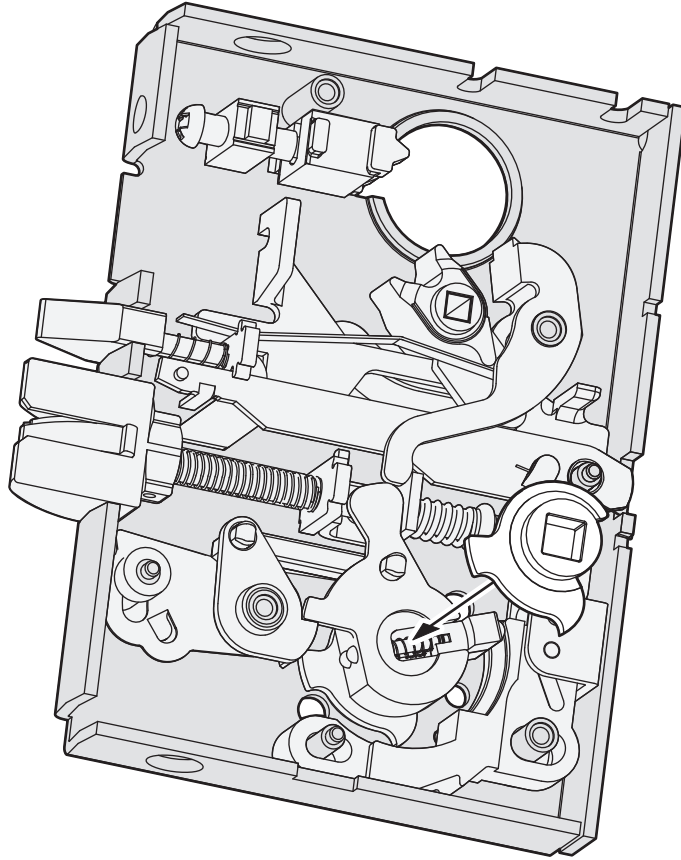

21.

Put top hub on retractor assembly. Align with bottom hub as shown.

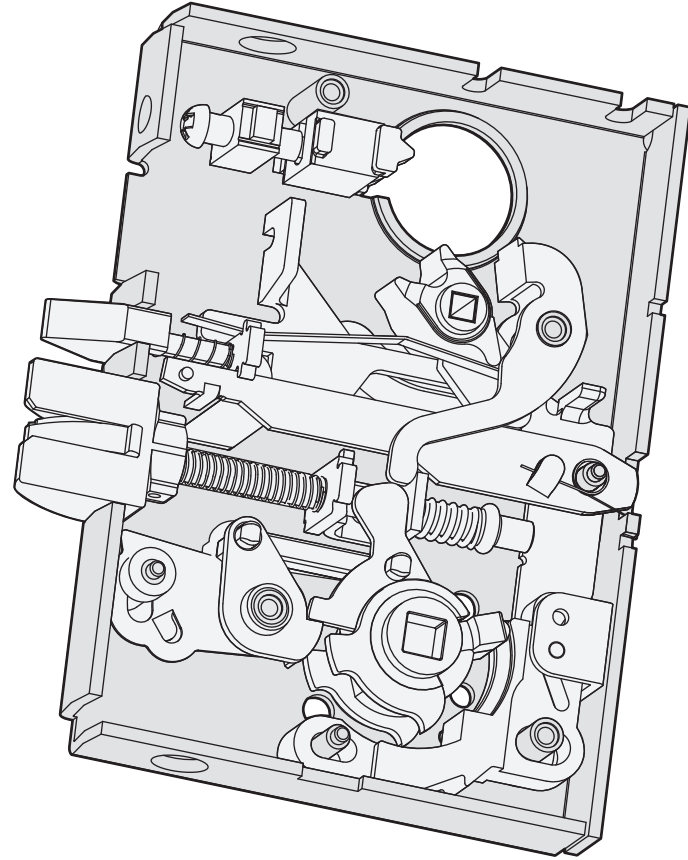

22.

The conversion to LV9050 is complete.



LV9050 Vandlgard Conversion from L9050

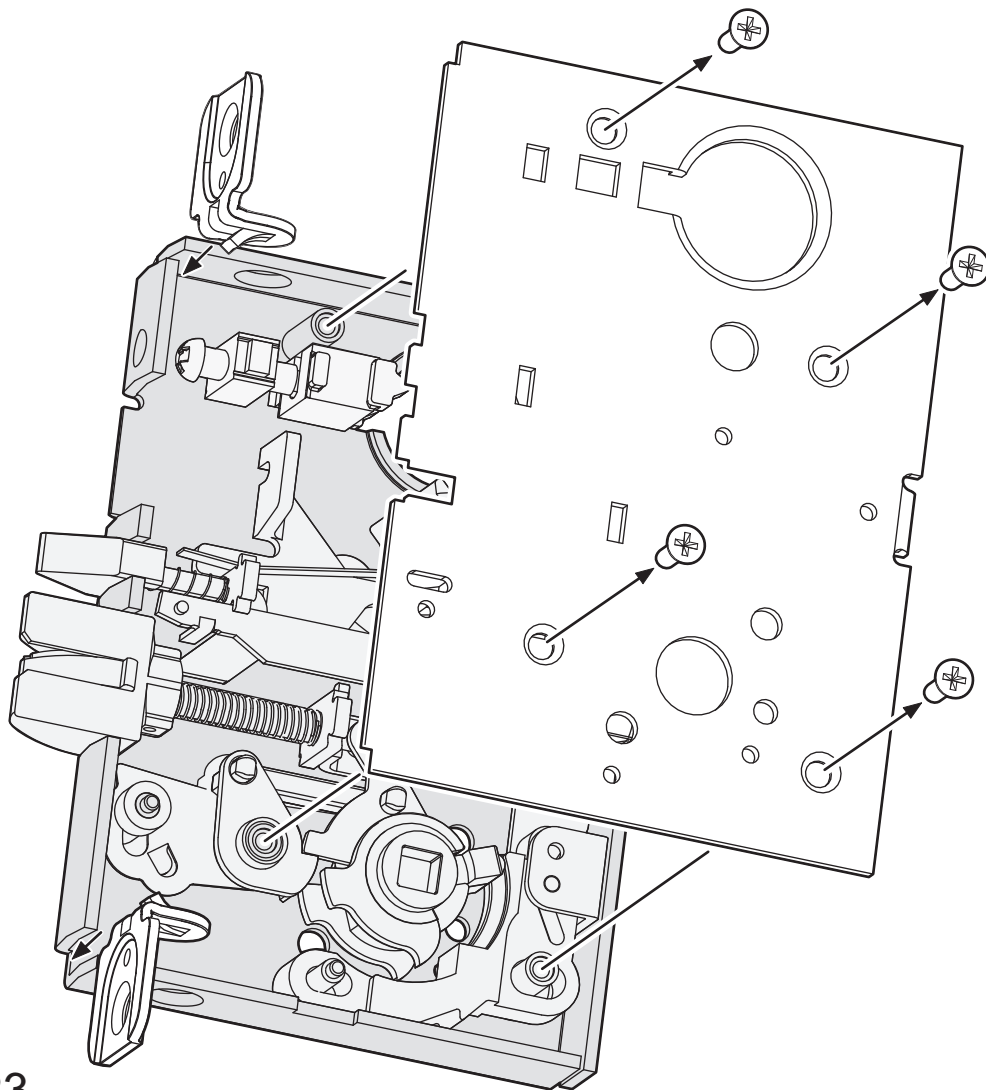

23.

Install *faceplate tabs*, *lock case cover* and *cover screws*.

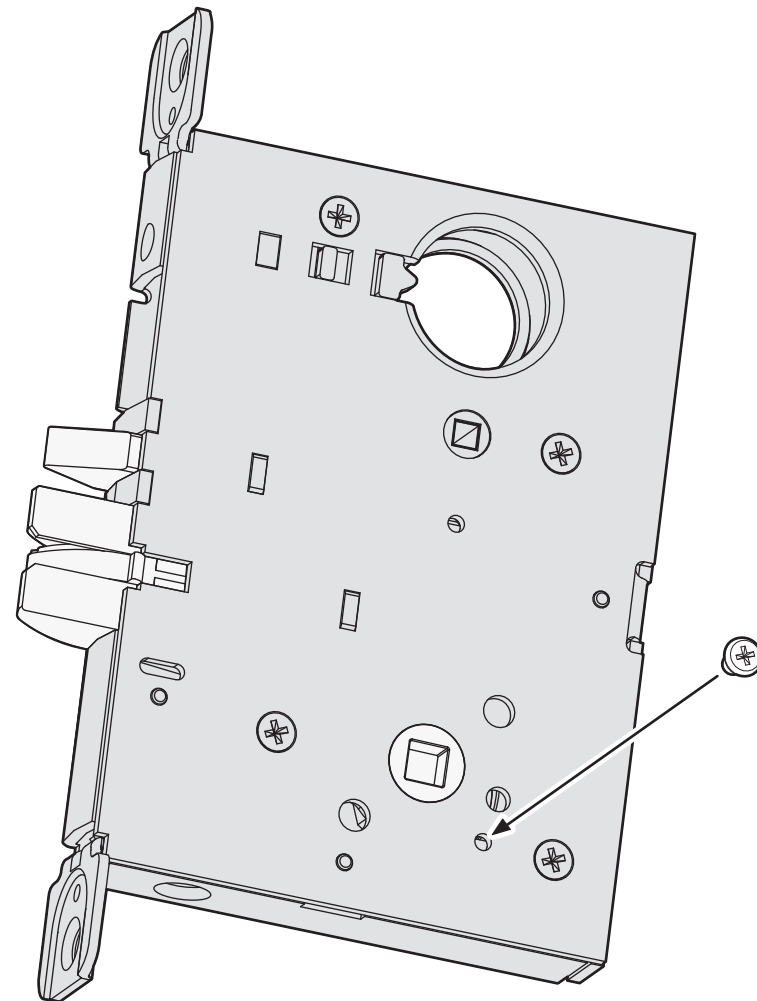

24.

For Vandlgard, *lock handling screw* is moved to the locked side.

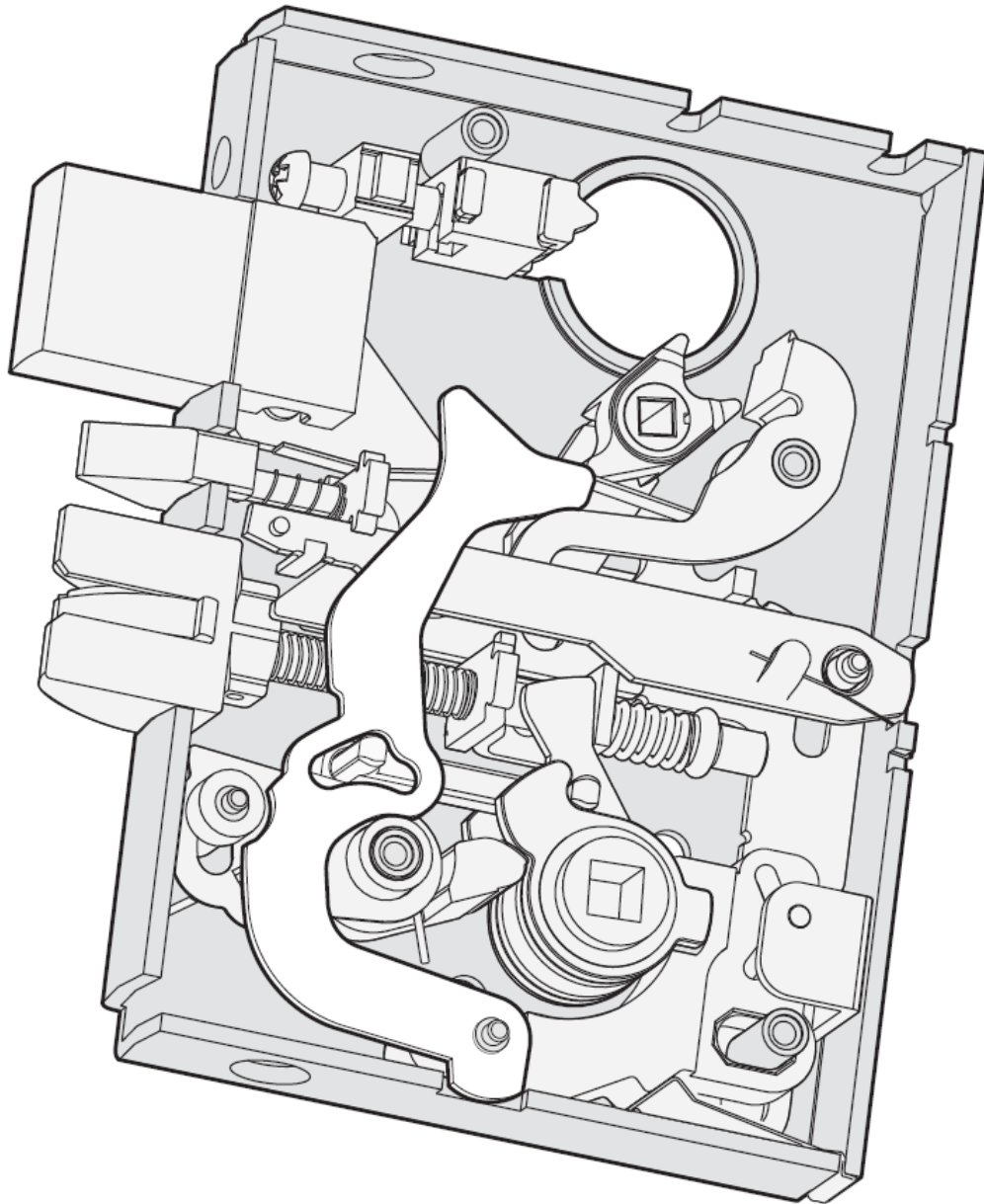

L9453 Entrance

L9453 Entrance with Deadbolt Assembly

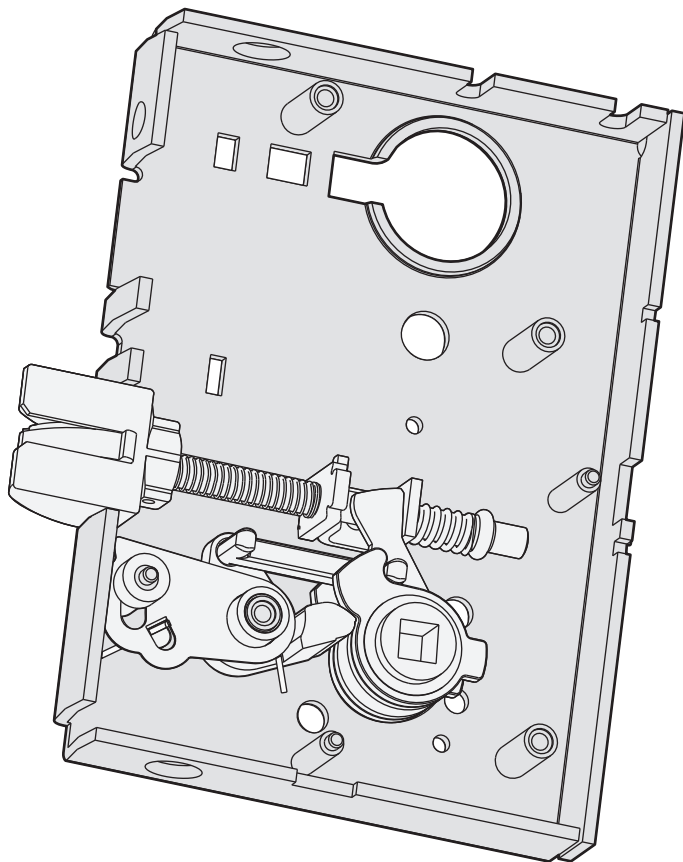

1.

Start with building L9010 to get to Step 1.

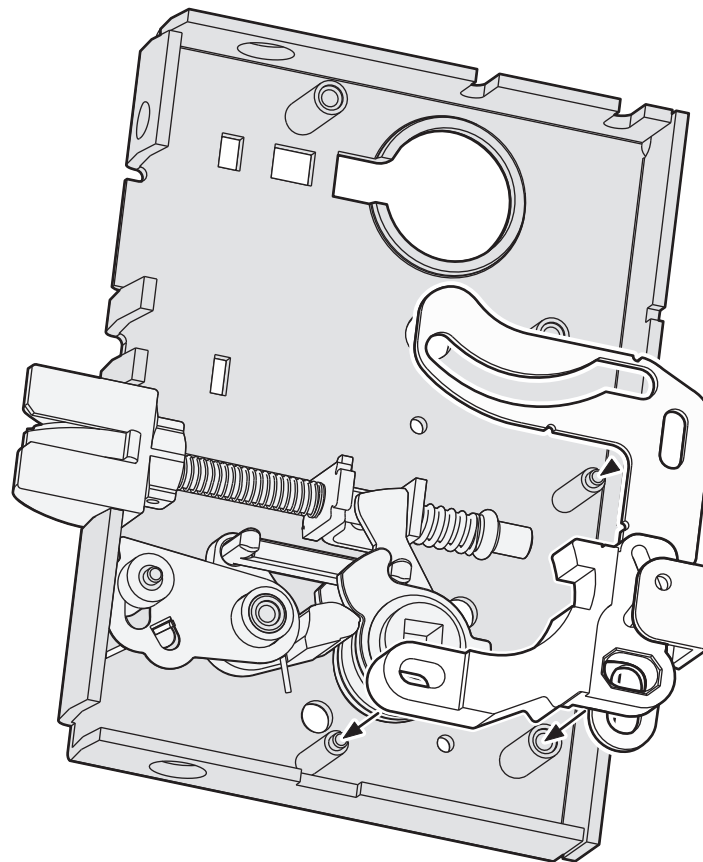

2.

1. Pre-assemble *locking catch and entrance link*.

2. Place assembled *locking catch and entrance link* into *lock case*.



L9453 Entrance with Deadbolt Assembly

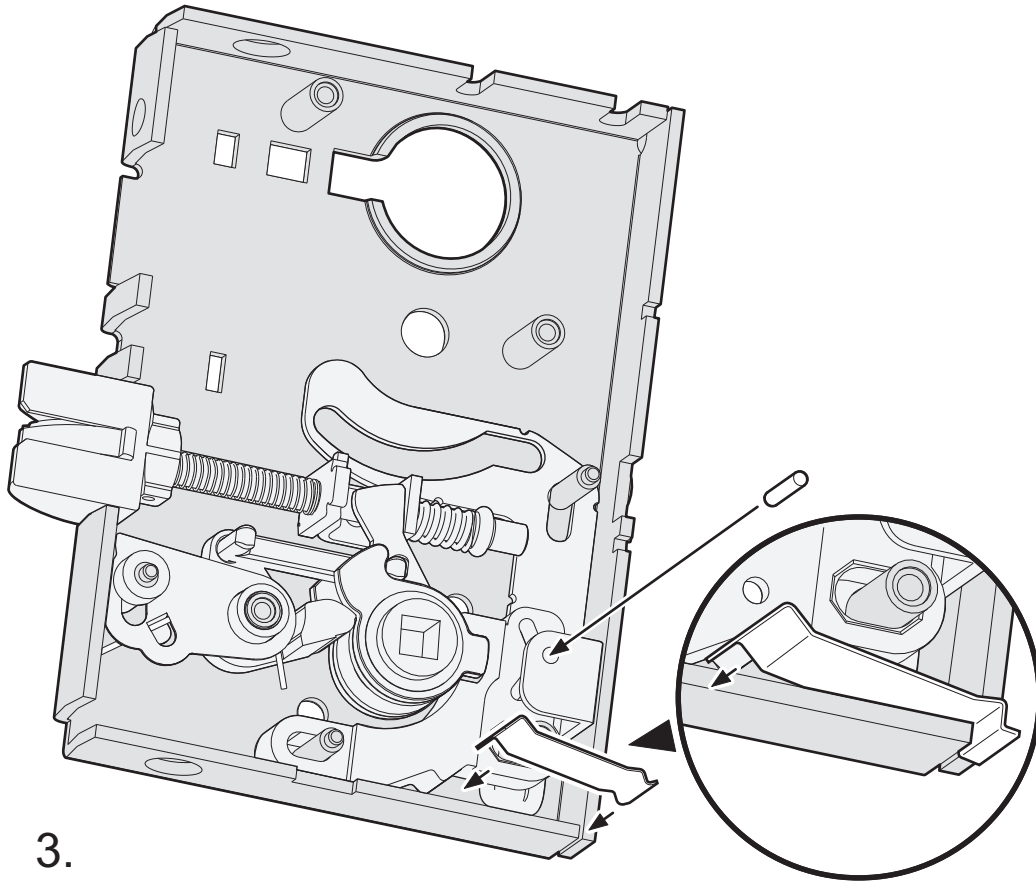

3.

1. Put *link pin* into hole in *entrance link*.
2. Install *catch spring* into bottom right corner of *lock case*.
3. Right end of *catch spring* interlocks with corner of *lock case*.

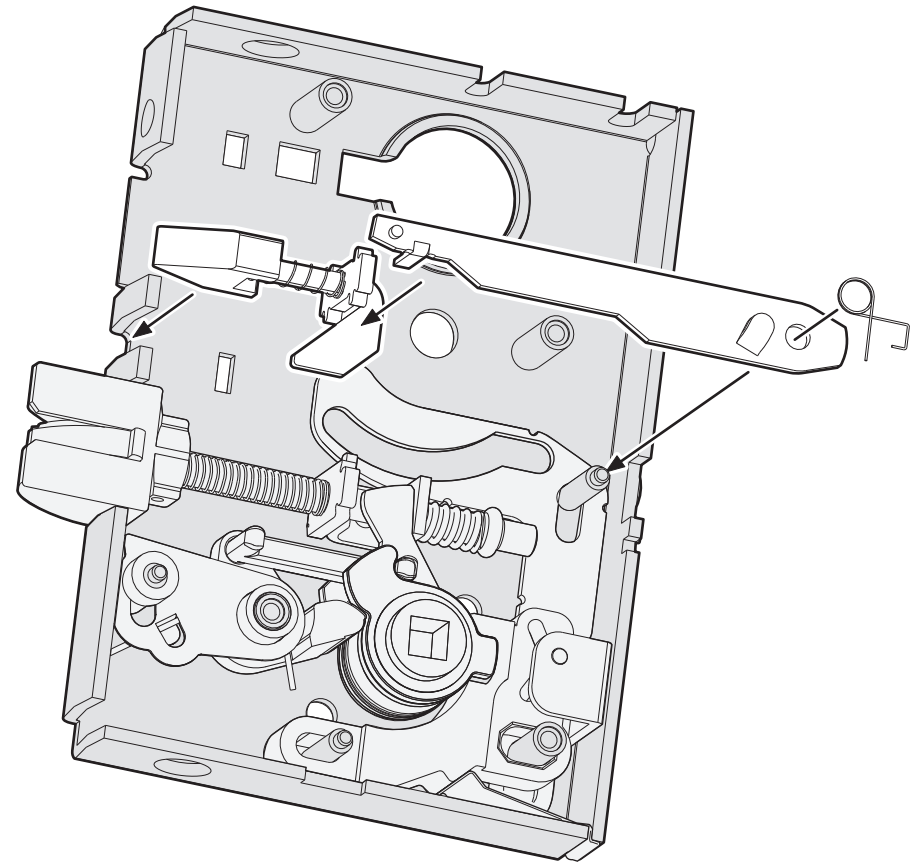

4.

Put a finger on the *hub assembly* and slide *entrance link* down so *locking catch* locks *hub*.

1. Install *auxiliary latch* as shown.
2. Place finger of *auxiliary stop* in front of angled tab on *auxiliary latch* and drop the right end of stop on *lock case post*.



L9453 Entrance with Deadbolt Assembly

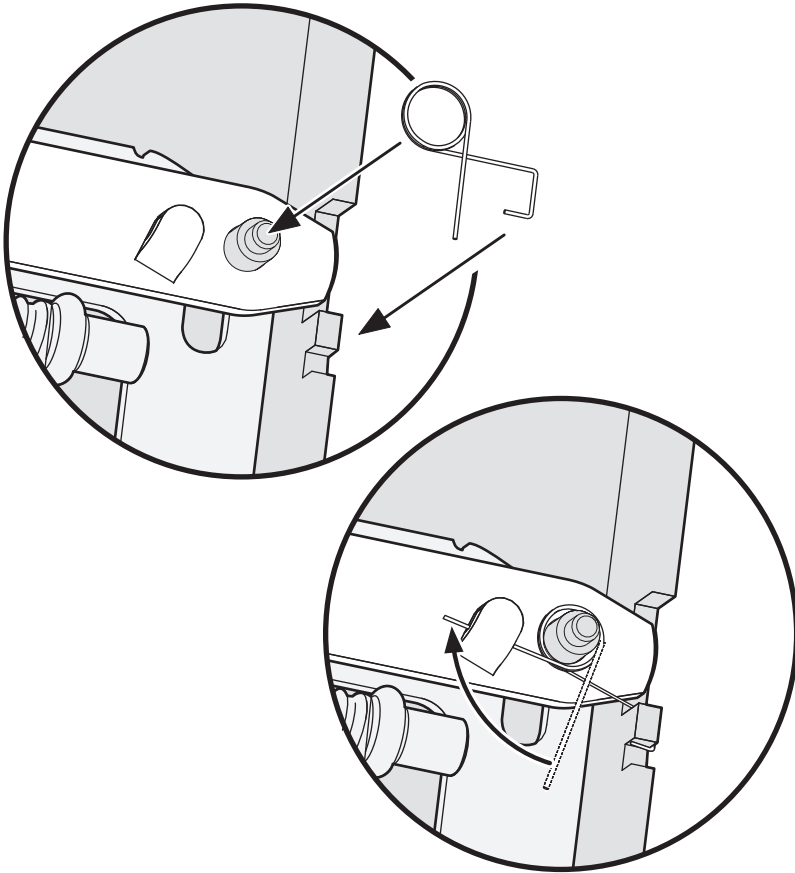

5.

1. Place bent leg of *spring* around tab in case.
2. Round part of *stop spring* goes over *lock case post*.
3. Pull loose spring leg up into clip on auxiliary stop.

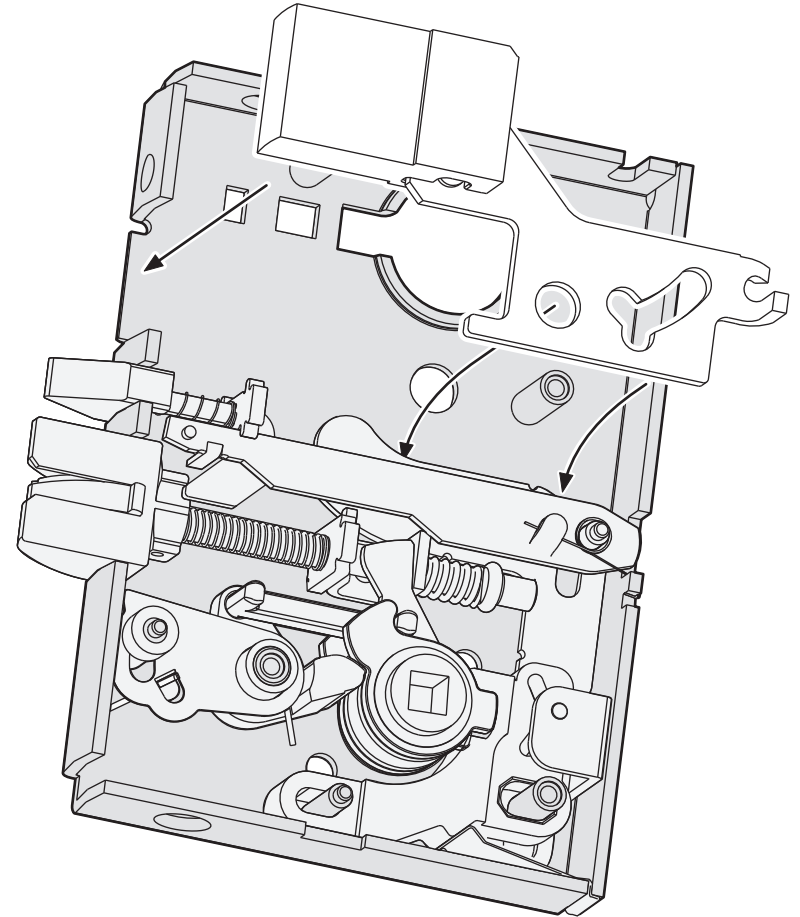

6.

Tilt the *deadbolt* a little so the bottom of the *draw bar* goes under the *auxiliary stop* and on top of the *entrance link*. Slide *deadbolt* back and forth to ensure operation. Finish with *deadbolt* extended.

L9453 Entrance with Deadbolt Assembly

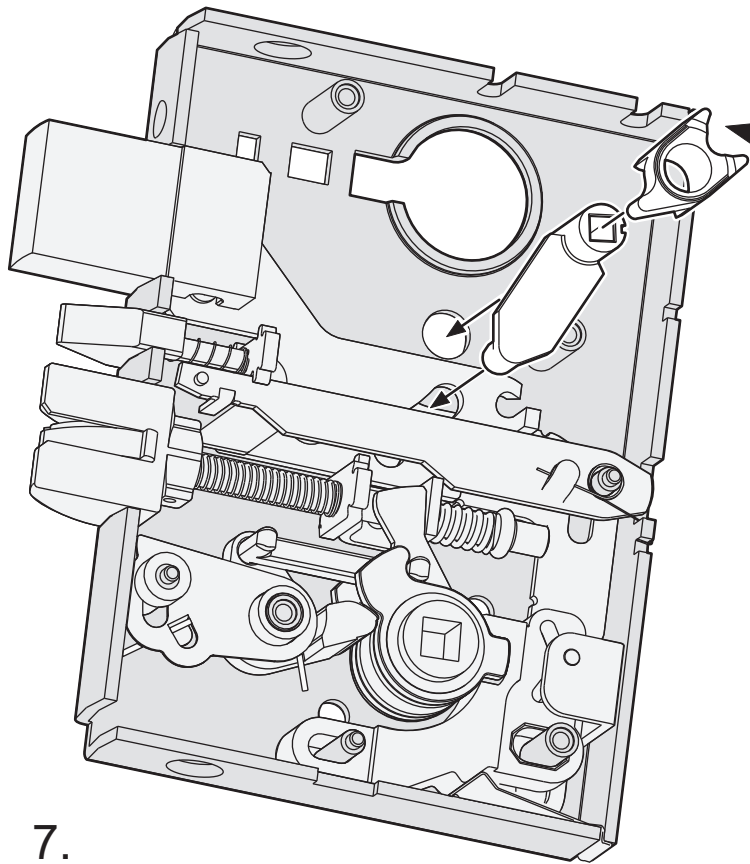

7.

1. Pre-assemble the *turn hub* by putting the *cam follower* on *entrance hub*.
2. Put thumb of *turn hub* into groove in *deadbolt* draw bar and round end of *hub* in *lock case* hole.
3. Turn *cam* and *hub* assembly testing *deadbolt*.
4. Finish with *deadbolt* extended.

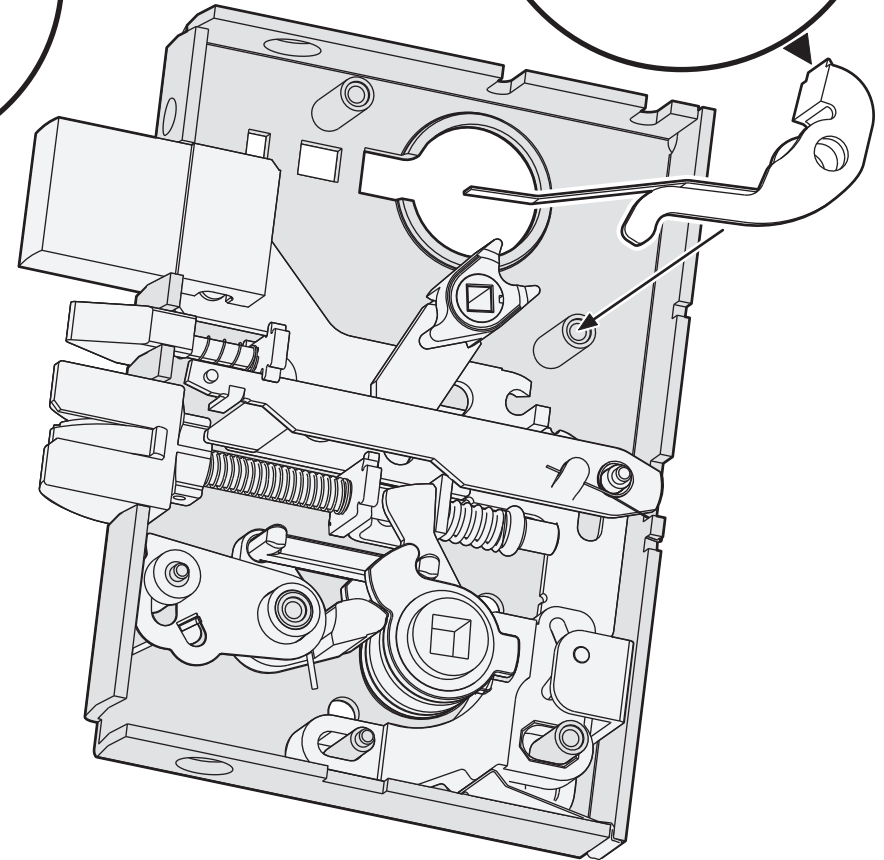
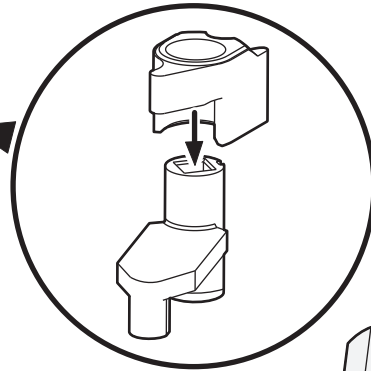

8.

1. Pre-assembly *transfer lever* and *turn hub spring*.
2. Put assembled lever and spring on *lock case* post.
3. Lightly place fingers on *transfer lever* and *turn hub*.
4. Pull left end of spring over top of *auxiliary latch* guide.

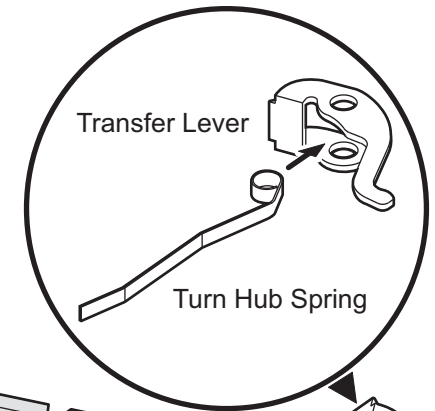

L9453 Entrance with Deadbolt Assembly

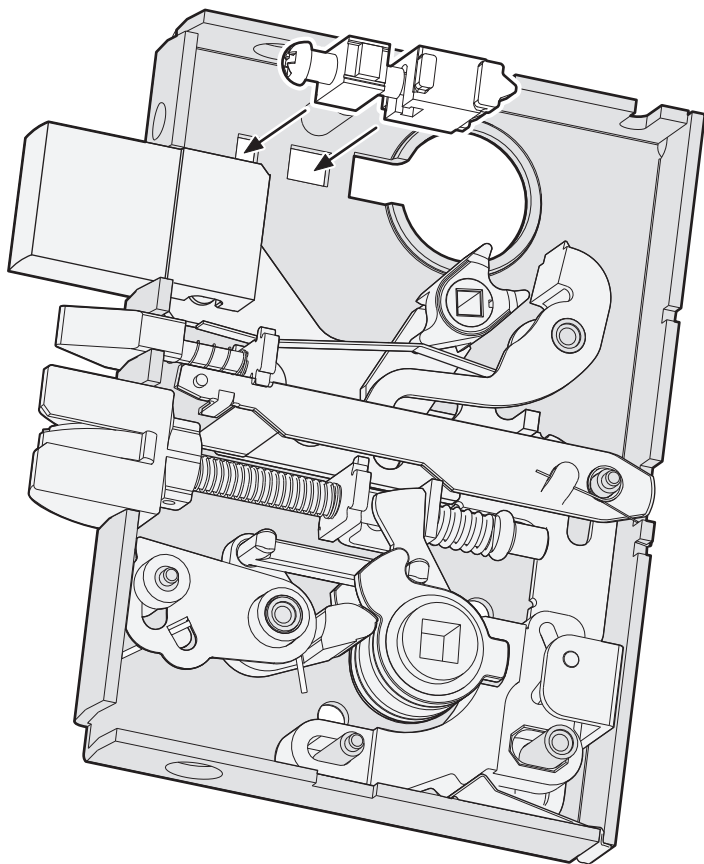

9.

Pre-assemble *cylinder retainer* and *cylinder plate* and screw. Install in lock case holes.

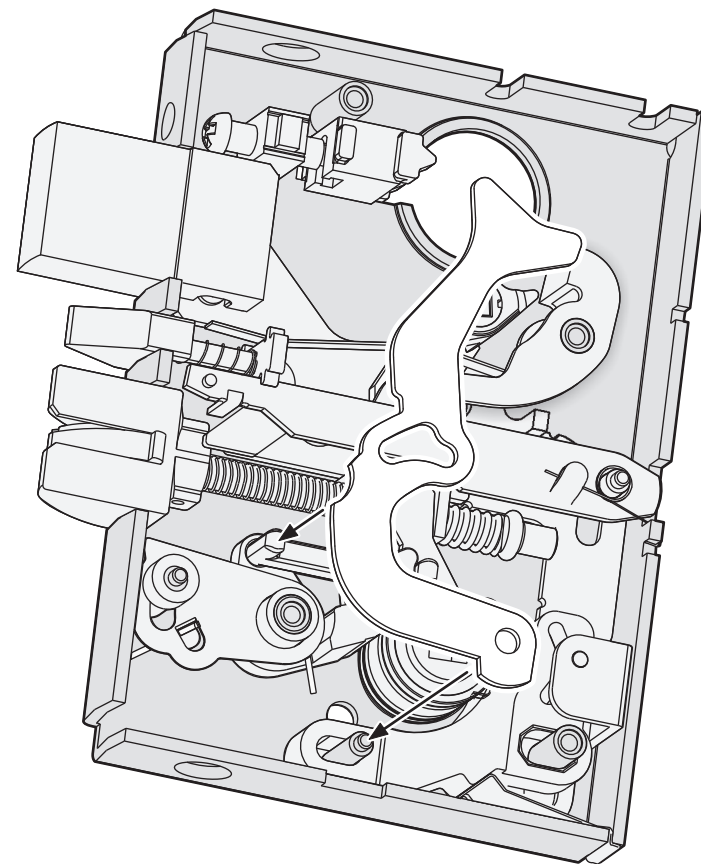

10.

Install *simultaneous retractor* on lock case post at bottom of case. Left leg of *retractor link* goes through hole at center of *simultaneous retractor*.



L9453 Entrance with Deadbolt Assembly

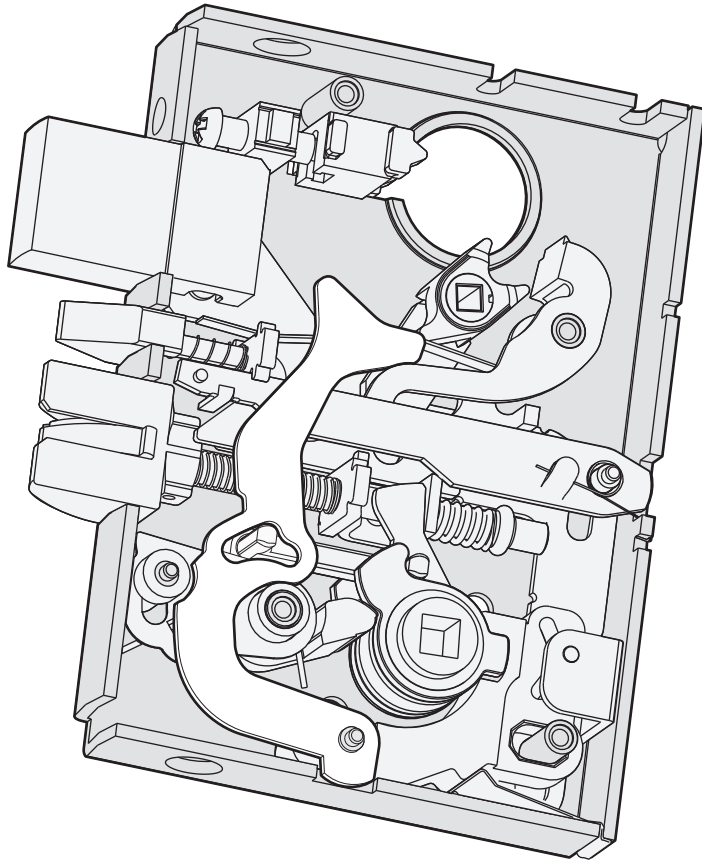

11.

Ensure top of *simultaneous retractor* is in correct position, as shown. L9453 lockset is complete.

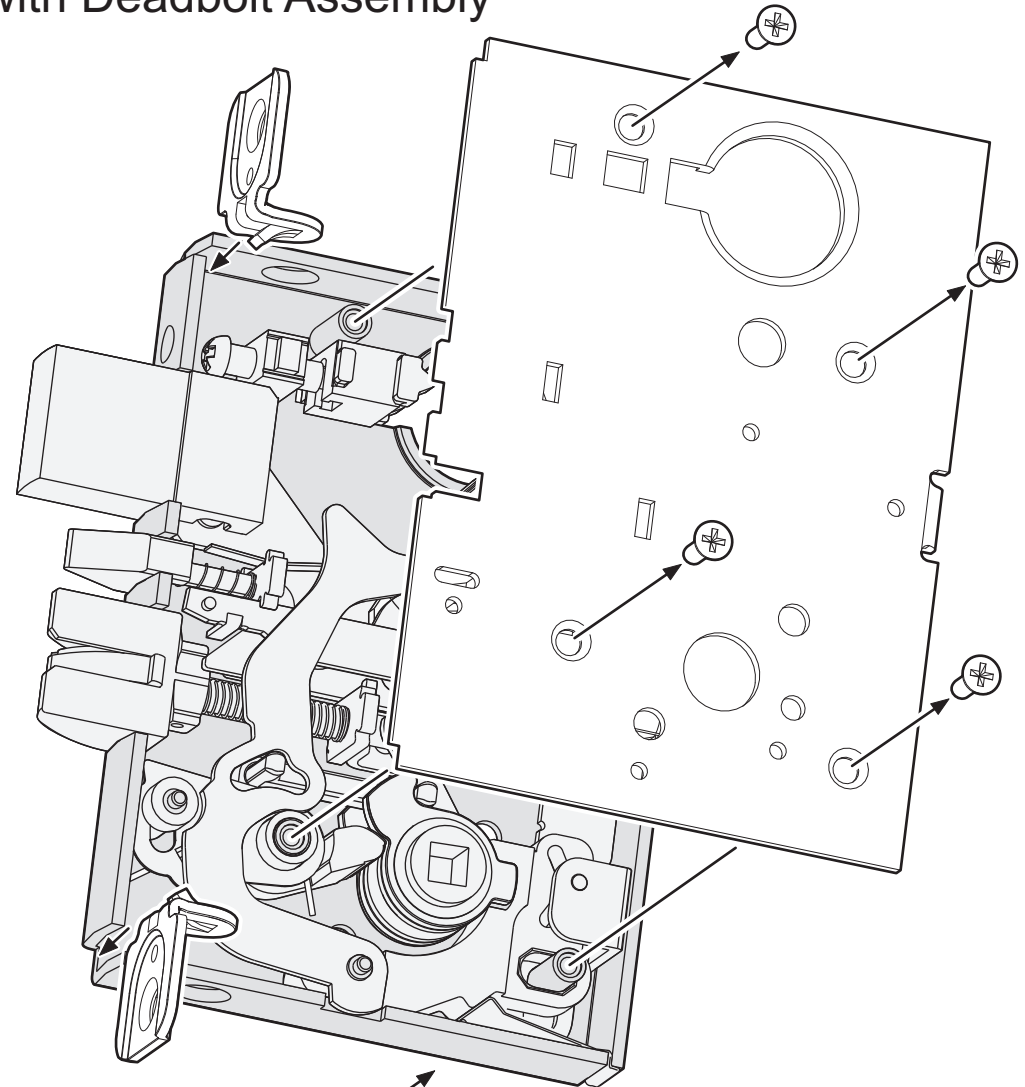

12.

Lock handing screw installed on egress side of lock.

Install *faceplate tabs*, lock case over and cover screws. Test operation of *turn hub*.