

RY57 PLUG SPINNER

Over 40,000 sold . . .

Congratulations on Your Purchase Today!

Sometimes a lock will resist picking open but will pick in the opposite direction. In cases like this the best solution is to spin the plug back past the shear line and over to the open position.

You need lots of speed and power to spin the cylinder plug past the shear line without causing the lock to relock. The Rytan RY57 Plug Spinner will do the job for you time and time again - all with the simple push of a button.

The RY57 Plug Spinner is a bidirectional tool.

INSTRUCTIONS

If the lock's plug must be turned to the right, the plug spinner must be readied by turning and locking it to the right. If the lock's plug must be turned to the left, the plug spinner must be readied by turning and locking it to the left.

TURN THE TOOL 1/2 TURN (180°)

The RY57 is readied by holding the tool by the two operating knobs with the blade facing away from your body. Separate the two operating knob assemblies by pulling them away from each other and begin turning the push button knob assembly in the direction the lock's plug must be rotated. Once the knobs have been turned about 1/4 turn, push the two knobs toward each other and continue turning until you have rotated 1/2 turn (180°) and you hear and feel the tool "CLICK" into its locked position.

Once your plug spinner is ready, insert the tip of the plug spinner's blade into the lock's keyway as far as possible. Turn the plug spinner and lock plug until the plug is 45° from either side, as required, of the locked position. Hold the tool steady by the push button knob assembly only and push the black push button with your thumb.

The lock's plug is now in the proper "picked open" position.

NOTE: If your RY57 Plug Spinner seems to have lost some of its original speed or power you need to replace your Blade.

Order RY57RB for replacement blades.

Rytan
INCORPORATED

455 Maple Avenue
Torrance, CA 90503 U.S.A.
(800) 447-9826
(310) 212-6002 fax

Copyright Rytan, Inc.

Rytan
INCORPORATED



PUSH BUTTON
Rytan invented push-button plug spinner technology in 1985.

**RY57RB
REPLACEMENT BLADE**

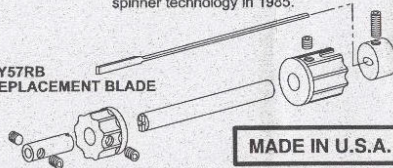

RYTAN RESERVES THE RIGHT TO MAKE CHANGES AT ANY TIME

RY57

Rytan
INCORPORATED

PLUG SPINNER

Over 40,000 sold . . .

SPIN

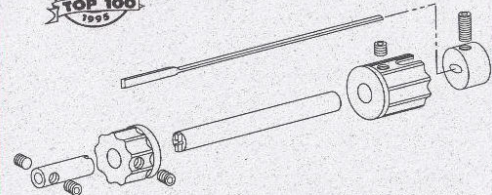

MADE IN U.S.A.

RYTAN RESERVES THE RIGHT TO MAKE CHANGES AT ANY TIME