

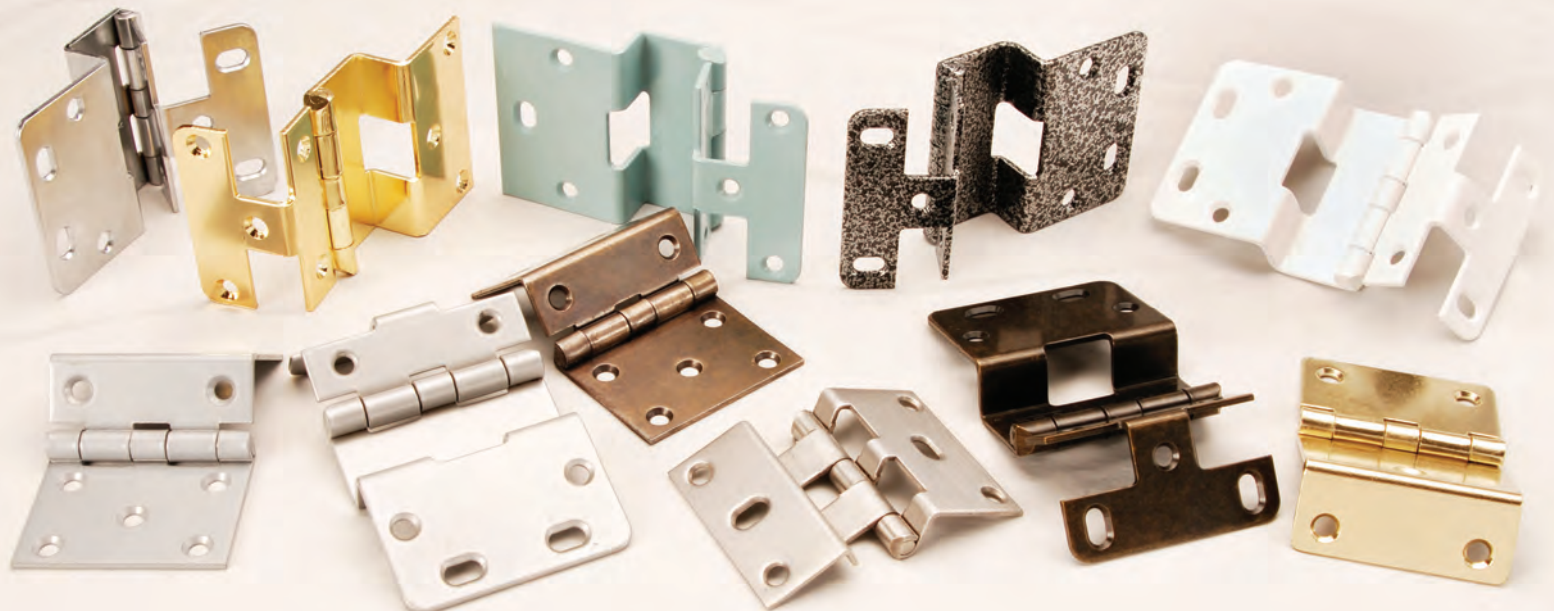

HINGES & HARDWARE



ISO 9001:2000 Registered

How do you define a qualified supplier?

As Rockford Process Control planned for a successful future, one of the questions we asked ourselves was: "What do we need to look for in establishing supplier partnerships to assure that we have a dependable, trustworthy and competitive supply chain?"

Our answer was to find companies with:

- Experience and leadership
- Expertise with the products
- A high level of customer service
- Consistent quality, on-time delivery and competitive pricing

We believe that if this concept is important to our company's future success, it should be important to our customers as well. That is why this definition has become our mantra for serving our customers.

Experience and expertise count. In 1983, Paul Colloton and Dick Gleichman founded RPC with the determination that quality was not an aim but a direct result of a consistent commitment to hard work and listening to customer needs. In 1987, they acquired the institutional market leading National Lock Casework Hardware hinge product line from Amerock. An emphasis was put on updating equipment and improving the quality control. This product offering is still the recognized standard for the institutional, hospital and educational markets.

To better serve our customers varied needs, RPC acquired the assets of Terry Hinge and Hardware in 2007. The Terry brand has a 50 year heritage of providing manufactured and imported product lines.

As our name suggests, Rockford Process Control's main competitive advantages are:

- Design
- Manufacturing
- Quality control processes
- Customer satisfaction

To remain competitive in this global market we have our own fulltime staff in Asia tasked with finding the best factories to build product to our designs and specifications. We do "in factory" inspections during manufacture to insure product consistency and quality.

When you, or your customer's, production schedule and reputation depend on timely delivery of quality hinges and hardware, you can put your trust in Rockford Process Control.

Green Hinges for Green Cabinets

Now you can specify hinges for your project's commercial and institutional cabinets to be GREEN or qualify for LEED™ certification points. Rockford Process Control domestically manufactured hinges reduce your environmental impact in a variety of ways: we utilize steel with recycled content, fabricate the component parts using water soluble lubricants, recycle all material punched out of the product during the fabrication process and package in fully recyclable shipping containers. When you see the "American Flag" icon on the following pages you can be assured that the product was manufactured in our centrally located factory in Rockford, Illinois.



Rockford Process Control – Your Hardware Solution Provider

Custom and Special Product Solutions

RPC/TERRY wants to provide products to meet your specific needs. If you need an application specific hinge, pull, stamped bracket or other piece of hardware, please don't hesitate to contact RPC's Sales Manager at 815-966-2000 or email "sales@rockfordprocess.com" with your exact needs.

Our engineering staff will evaluate your need and help you design the right product for your application. For a competitive quote, please send us a sketch or sample of your custom part including material and quantity requirements. If you have a target price you need to meet, let us know and we will strive to meet or beat your target.

We are always seeking new products to expand our ability to serve our customers, old and new. Please let us know what your needs are so we can provide solutions for your needs.

Import Expertise

RPC/TERRY has our own staff in China to find the best supplier for a product. Our importing capabilities include providing on going quality control, refining manufacturing techniques and obtaining the best possible value for our customers. Please talk to us about becoming your direct container supplier for all of your high-volume product needs.

LIMITED WARRANTY

Rockford Process Control, Inc. (RPC) warrants its Hinges and hardware against defects in material and workmanship for a period of twelve (12) months from the date of shipment.

RPC will send the original consumer purchaser, without charge, a new RPC/TERRY Hinge to replace any defective RPC/TERRY Hinge subject to this warranty. RPC specifically does not warrant removal of the defective Hinge or installation of a new Hinge. This warranty does not cover Hinges that have been incorrectly installed, exposed to excessive loads or abuse in any way. This warranty is a warranty of hardware replacement only. No other warranty is expressed or implied.

Alphabetical Index

Product	Page
Barrel Hinge	T-16
Butt Hinges	T-6-12
Button Catches	T-21
Café Hinges	T-15
Casework Hardware	T-20-23
Coat Hooks	T-23
Continuous Hinges	C-1-10
Door Hardware	R-8-10
Double Acting Hinges	T-15
Elbow Catches	T-20
Five-Knuckle Overlay Hinges	R-1-4, T-1-2
Five-Knuckle Lipped Hinges	R-5
Flush Hinges	R-7, T-3-4
Glass Door Hardware	T-17-19
Institutional Hinges	R-1-7, T-1
Leaf Hinges	T-14
Lid Supports	T-30-31
Lift-Off Hinges	T-14
Magnetic Catches	T-26-29
Magnetic Touch Latches	T-25
Non-Mortise Shutter Hinges	T-12-13
Pilasters and Steel Standards	T-34
Pivot Hinge	T-15
Pulls	T-24
Roller Catches	T-20
Screws	T-35
Shelf Pins	T-32
Shutter Pins	T-32-33
Traditional Hinges	T-16
Three-Knuckle Hinges	R-6
Wire Doors	R-11-12
Wrap-A-Round Hinges	T-5

PLEASE NOTE

Shutter Symbol indicates this product is part of the RPC Stock Shutter parts program.

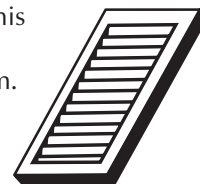

ORDERING INFORMATION

This catalog represents the blending of two companies' product lines. To minimize confusion by our valued customers, we have retained RPC product numbers and TERRY product numbers. This eliminates the need for you, our customers, to make changes in your computer systems.

RPC part numbers consist of the Model Number followed by the finish code as shown to the right.

Part No. 376-P28

Model No.:

376 Overlay Hinge, 3/4" x 13/16"

Finish Code:

P28 Chrome Powder Coat

TERRY part numbers consist of a product type, product number and finish code:

Product Type	Product Number	Finish
H03	30200	66
Hinge	Model 30200	White

Standard and Custom Finishes for Casework Hinges, Pulls and Wire Doors

RPC's in-house powder coating system allows us to match colors to meet your color specification. Our powder coating process provides you with a durable, epoxy-based finish.

Finish Codes: To simplify manufacturing and inventory control, RPC/TERRY has reviewed and consolidated its finish offerings into Standard and Special colors. Standard colors will be stocked as noted for a given product.

Special colors are available. Special color requests are subject to lead times, minimum order size, special materials up-charges and custom set-up charges.

Please contact RPC Customer Service to discuss minimums, lead times and up-charges for your Special or Custom color requirements and for color samples.

Standard Powder Coat Colors

1D	Gloss Black
12	Prime Coat
23	Matte Black
66	Gloss White
67	White Arizona
E47	Beige
E48	Dove Grey
P28	Chrome

Standard Plated Finishes

03	Bright Brass
05	Antique Brass
06	Antique Copper
	or Statuary Bronze
9R	Oil Rubbed Bronze
14	Nickel
17	White Zinc
26	Polished Chrome
26D	Dull Chrome
26S	Brushed Chrome
39	Black Oxide

Special Colors

2K	Black Krinkle
3X	Electro Polish
6K	White Krinkle
7K	Almond Krinkle
8S	Sun Gold
8J	Light Beige
9U	Matte Beige (replaced by E47)
18	Pewter (plated)
19	Black Zinc
47	Satin Black
B24	Brushed Aluminum
E50	Brown
E67	Haze
GK	Grey Krinkle
SF	Satin White
SE	Gloss White

HINGE TERMINOLOGY

Institutional Hinge

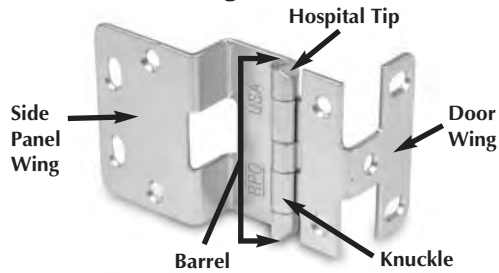

Barrel: The portion of a hinge formed by knuckles of the door leaf and side panel leaf when joined by the pin.

Door Wing: In a five-knuckle hinge, it is the hinge leaf that is mounted to the door. It has two knuckles.

End Play: The amount of axial movement between the leaves measured parallel to the axial centerline of the pin.

Flush: A solid door that sits within the cabinet opening so that the front surface of the door is even with the front of the cabinet side panel.

Gauge: The thickness of the material from which a hinge is produced.

Hospital Tip: A hinge barrel whose ends are beveled towards each other.

Inset: Regarding Wire Doors: The wire door sets or rests inside the cabinet opening with the vertical members flush with the side panels. See Flush.

Knuckle: The curled hollow portion of a hinge through which the hinge pin is inserted. Also known as the curl.

Leaf: The segment of the hinge extending outward from the knuckle, which rotates around the hinge pin.

Door Mounting Configurations

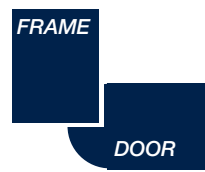

Lipped Door



Flush Door



Overlay Door

Leaf Width: The dimension from the centerline of the pin to the outside edge of the leaf measured perpendicular to the axial centerline of the pin.

Length: The dimension from one end of the hinge to the other measured parallel to the axial centerline of the pin.

Lipped: A door with a rabbet cut around the back edge of the door's perimeter. The back portion of the door recesses into the cabinet. The remaining front part of the door will overlay the cabinet side panel.

Non-Removable Pin: A hinge pin secured by a knurl on the pin and spun on both ends or by other means.

Onset: Regarding Wire Doors: The wire door frame sets or rests in front of the side panels.

Open Width: The dimension from one side of the hinge to the other outside edge measured perpendicular to the axial centerline of the pin.

Overlay: A door which is mounted to the front of the cabinet and covers a portion of the cabinet side panel.

Pin: The wire or rod which extends through the hinge about which the leaves revolve. The pin holds the leaves of a hinge together.

Pin Types

Spun Pin
Loose Pin
Double Oval Pin
Sheared Tight Pin (no head)
Staked Pin



Pitch: The dimension from a point on the knuckle to the same point on an adjacent knuckle on the same leaf.

Reveal: In an overlay door mounting application, the exposed portion of the cabinet side panel not covered by the door when closed.

Side Panel Wing: In a five-knuckle hinge, it is the hinge leaf that is mounted to the cabinet side panel. It has three knuckles.

Side Play: The amount of movement of the leaves perpendicular to the axial centerline of the pin. Caused by excessive clearance between the pin and the inside diameter of the knuckle.

Swaging: Forming one or both leaves toward or beyond the centerline of the pin. Swaging reduces the distance between the leaves when the hinge is closed to a parallel position.

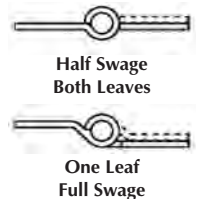

Continuous Hinge

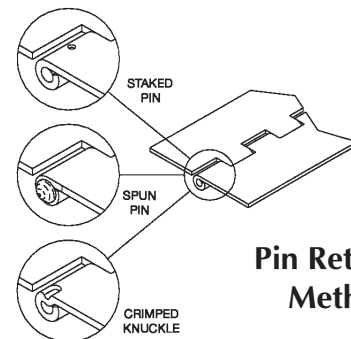
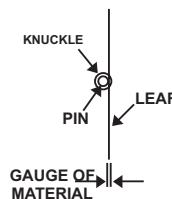
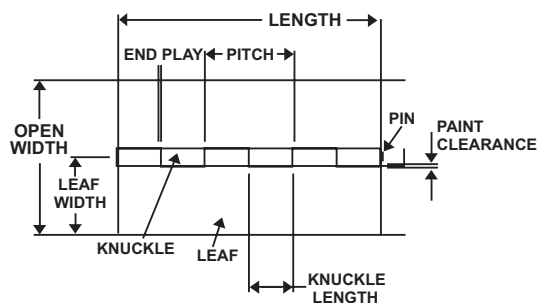

Pin Retention Methods

THE ROCKFORD HINGE™

*These hinges have been the industry standard for five-knuckle hinges for over 75 years!
They exceed ANSI/BHMA 156.9 Grade 1 requirements.*

*Hospital tips, 2-3/4" height, 270° opening angle, drilled knuckle ID with Teflon coated pins.
All mounting holes are countersunk for #8 flat head screws.*

Part Number: 374

Side Panel:	3/4" (19mm)
Door Thickness:	3/4" (19mm)
Hinge Overlay:	23/32" (18.3mm)
Door Overlay:	15/32" (11.9mm)
Gauge:	.095" (2.4mm)
Hole Pattern:	32mm centers with 37mm setback
Pack:	100/case, cell packed
	<i>Specify finish when ordering</i>



374

Part Numbers: 376, 376SS

Side Panel:	3/4" (19mm)
Door Thickness:	13/16" (20.6mm)
Hinge Overlay:	23/32" (18.3mm)
Door Overlay:	15/32" (11.9mm)
Gauge:	.095" (2.4mm)
Hole Pattern:	32mm centers with 37mm setback
Pack:	100/case, cell packed
	<i>Specify finish when ordering</i>
376SS	.090" Type 304 stainless steel
Pack:	50/case, cell packed

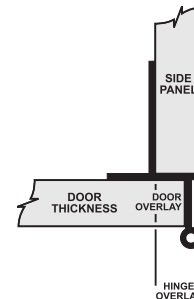

376, 376SS

Part Number: 375

Side Panel:	13/16" (20.6mm)
Door Thickness:	13/16" (20.6mm)
Hinge Overlay:	25/32" (19.8mm)
Door Overlay:	17/32" (13.5mm)
Gauge:	.095" (2.4mm)
Hole Pattern:	32mm centers with 37mm setback
Pack:	100/case, cell packed
	<i>Specify finish when ordering</i>



375

See page T-35 to order #8 flat head screws for mounting these hinges.

FIVE-KNUCKLE OVERLAY HINGES



454, 456

Part Number: 454

Side Panel:	3/4" (19mm)	
Door Thickness:	3/4" (19mm)	
Hinge Overlay:	23/32" (18.3mm)	
Door Overlay:	15/32" (11.9mm)	
Gauge:	.095" (2.4mm)	
Hole Pattern:	Side panel 32mm centers with 37mm setback, door wing holes 45mm on center	
Pack:	100/case, cell packed	
	<i>Specify finish when ordering</i>	



455

Part Number: 455

Side Panel:	13/16" (20.6mm)	
Door Thickness:	13/16" (20.6mm)	
Hinge Overlay:	25/32" (19.8mm)	
Door Overlay:	17/32" (13.5mm)	
Gauge:	.095" (2.4mm)	
Hole Pattern:	Side panel 32mm centers with 37mm setback, door wing holes 45mm on center	
Pack:	100/case, cell packed	
	<i>Specify finish when ordering</i>	

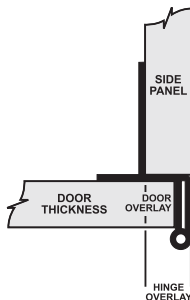

Part Number: 456

Side Panel:	3/4" (19mm)	
Door Thickness:	13/16" (20.6mm)	
Hinge Overlay:	23/32" (18.3mm)	
Door Overlay:	15/32" (11.9mm)	
Gauge:	.095" (2.4mm)	
Hole Pattern:	Side panel 32mm centers with 37mm setback, door wing holes 45mm on center	
Pack:	100/case, cell packed	
	<i>Specify finish when ordering</i>	



846

Part Number: 846

Side Panel:	3/4" (19mm)	
Door Thickness:	13/16" (20.6mm)	
Hinge Overlay:	23/32" (18.3mm)	
Gauge:	.095" (2.4mm)	
Hole Pattern:	Horizontal adjustment on side panel	
Pack:	100/case, cell packed	
	<i>Specify finish when ordering</i>	



847

Part Number: 847

Side Panel:	5/8" (15.9mm)	
Door Thickness:	3/4" (19mm)	
Hinge Overlay:	39/64" (15.5mm)	
Door Overlay:	11/32" (8.7mm)	
Gauge:	.090" (2.3mm)	
Hole Pattern:	Extended side panel leaf	
Pack:	100/case, cell packed	
	<i>Specify finish when ordering</i>	

See page T-35 to order #8 flat head screws for mounting these hinges.

FIVE-KNUCKLE OVERLAY HINGES

Part Number: 848

Side Panel:	3/8" (9.5mm)		
Door Thickness:	3/4" (19mm)		
Hinge Overlay:	11/32" (8.7mm)		
Door Overlay:	1/8" (3.2mm)		
Gauge:	.095" (2.4mm)		
Hole Pattern:	Staggered side panel mounting holes, can be used back-to-back on shared 3/4" side panel		
Pack:	100/case, cell packed <i>Specify finish when ordering</i>		



848

Part Number: 849

Side Panel:	3/8" (9.5mm)		
Door Thickness:	13/16" (20.6mm)		
Hinge Overlay:	11/32" (8.7mm)		
Door Overlay:	1/8" (3.2mm)		
Gauge:	.095" (2.4mm)		
Hole Pattern:	Staggered side panel mounting holes, can be used back-to-back on shared 3/4" side panel		
Pack:	100/case, cell packed <i>Specify finish when ordering</i>		

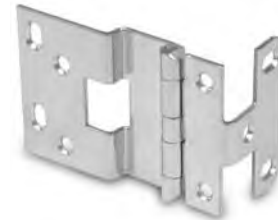

849

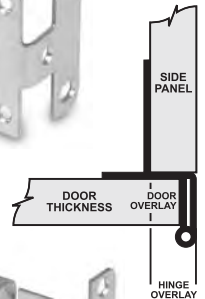

Part Number: 851

Side Panel:	3/4" (19mm),	
Door Thickness:	3/4" (19mm),	
Hinge Overlay:	23/32" (18.3mm)	
Door Overlay:	15/32" (11.9mm)	
Gauge:	.083" (2.1mm)	
Hole Pattern:	Extended side panel leaf	
Pack:	100/case, cell packed <i>Specify finish when ordering</i>	



851

Part Number: 853

Side Panel:	5/8" (15.9mm)
Door Thickness:	13/16" (20.6mm)
Hinge Overlay:	19/32" (15.1mm)
Door Overlay:	11/32" (8.7mm)
Gauge:	.095" (2.4mm)
Hole Pattern:	Staggered side panel mounting holes
Pack:	100/case, cell packed
	<i>Specify finish when ordering</i>



853

Part Numbers: 8314, 8314SS

Side Panel:	1/2" (12.7mm)		
Door Thickness:	1/2" (12.7mm)		
Hinge Overlay:	1/2" Door Overlay 9/32" (7.1mm)		
Gauge:	.090" (2.3mm)		
Hole Pattern:	Commonly used with Phenolic Materials, 32mm centers with 37mm setback		
8314SS	.090" Type 304 Stainless Steel		
8314 Pack:	100/case, cell packed		
8314SS Pack:	50/case, cell packed		
	<i>Specify finish when ordering</i>		



8314, 8314SS

See page T-35 to order #8 flat head screws for mounting these hinges.

FIVE-KNUCKLE OVERLAY HINGES



8362, 8362SS

Part Numbers: 8362, 8362SS

Side Panel:	5/8" (15.9mm)
Door Thickness:	13/16" (20.6mm)
Hinge Overlay:	19/32" (15.1mm)
Door Overlay:	11/32" (8.7mm)
Gauge:	.095" (2.4mm)
Hole Pattern:	32mm centers with 37mm setback
8362SS	.090" Type 304 Stainless Steel
8362 Pack:	100/case, cell packed
8362SS Pack:	50/case, cell packed
<i>Specify finish when ordering</i>	

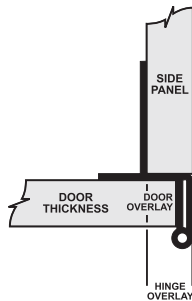

SPECIAL FIVE-KNUCKLE OVERLAY HINGES

These special overlay hinges will accommodate application requirements for doors with a thickness of up to 1-3/8" and side panels to 1" thick.

Part Number: 388

Side Panel:	1" (25.4mm)
Door Thickness:	13/16" (20.6mm)
Hinge Overlay:	1" (25.4mm)
Door Overlay:	25/32" (19.8mm)
Gauge:	.083" (2.1mm)
Hole Pattern:	1" side panel leaf
Pack:	100/case, cell packed
<i>Specify finish when ordering</i>	



388

Part Number: 844

Side Panel:	5/8" (15.9mm)
Door Thickness:	1-1/16" (27mm)
Hinge Overlay:	19/32" (15.1mm)
Door Overlay:	11/32" (8.7mm)
Gauge:	.095" (2.4mm)
Hole Pattern:	32mm centers
Pack:	100/case, cell packed
<i>Specify finish when ordering</i>	



844

Part Number: 7036

Side Panel:	3/4" (19mm),
Door Thickness:	1-3/8" (34.9mm)
Hinge Overlay:	23/32" (18.3mm)
Door Overlay:	15/32" (11.9mm)
Gauge:	.095" (2.4mm)
Hole Pattern:	1-1/4" side panel leaf.
Pack:	100/case, cell packed
<i>Specify finish when ordering</i>	



7036

See page T-35 to order #8 flat head screws for mounting these hinges.

FIVE-KNUCKLE LIPPED HINGES

RPC five-knuckle lipped hinges are designed for use with inset doors having a rabbet depth of 3/8". Hospital tips are standard, contact RPC regarding your special needs.

Part Number: 349

Rabbet Depth:	3/8" (9.5mm)
Side To Hinge Center:	25/64" (9.9mm)
Cabinet Wing Length:	13/16" (20.6mm)
Rabbet Width:	3/8" (10.3mm)
Height:	2-1/2" (63.5mm)
Gauge:	.072" (1.8mm)
Hole Pattern:	Vertical side panel slot, horizontal door slot for easy mounting
Pack:	100/case, cell packed
	<i>Specify finish when ordering</i>



349

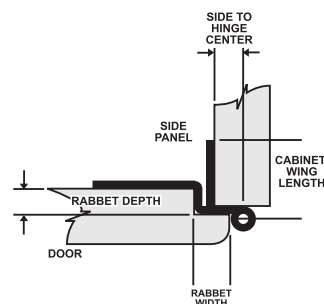

Part Number: 362, 362SS

Rabbet Depth:	3/8" (9.5mm)
Side To Hinge Center:	7/16" (11.1mm)
Cabinet Wing Length:	1-31/32" (50mm)
Rabbet Width:	1/2" (13.5mm)
Height:	2-3/4" (69.9mm)
Gauge:	.083" (2.1mm)
Hole Pattern:	horizontal mounting slots on both side panel and door
362SS	.078" Type 304 Stainless Steel
362 Pack:	100/case, cell packed
362SS Pack:	50/case, cell packed
	<i>Specify finish when ordering</i>



362, 362SS

RPC GRAVITY LOCKS

Secondary locking system for partitioned, two-door cabinets, door automatically locks when shut. Eliminates the need and expense of a keyed door lock on one door. Bolt and bracket are mounted on the cabinet partition, strike plate is mounted to the door.

Part Numbers: GL01, GL02, GL03

Partition Thickness:	GL01: 3/4" (19mm)
	GL02: 13/16" (20.6mm)
	GL03: 1" (25.4mm)
	Bolt, bracket and strike plate are made of brushed 304 stainless steel
Packaged:	lock, strike plate, one #9 x 2-1/2" Phillips pivot screw, two #6 x 1/2" Phillips SMS, all screws are bright zinc plated.
Pack:	B 250 cell packed/case
	P 25 poly bagged/case



GL01, GL02, GL03

THREE-KNUCKLE, NON-MORTISE, INSTITUTIONAL HINGES

Hinge height: 2-3/4", same as five-knuckle hinges

Woodwork Institute Certified

ANSI/BHMA 156.9 Grade 3 compliant



H08-9XE60, H08-9XG60

Part Number: H08-9XE60

Side Panel:	3/4" (19mm),
Door Thickness:	3/4" (19mm)
Hinge Overlay:	23/32" (18.3mm)
Door Overlay:	5/8" (15.9mm)
Gauge:	.090" (2.3mm)
Hole Pattern:	32mm centers with 37mm setback, 51mm (2") door wing
Pack:	100/case
Specify finish when ordering	

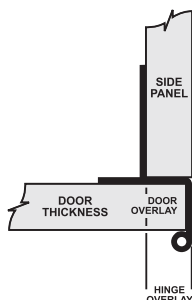

Part Number: H08-9XG60

Side Panel:	3/4" (19mm),
Door Thickness:	13/16" (20.6mm)
Hinge Overlay:	23/32" (18.3mm)
Door Overlay:	5/8" (15.9mm)
Gauge:	.090" (2.3mm)
Hole Pattern:	32mm centers with 37mm setback, 51mm (2") door wing
Pack:	100/case
Specify finish when ordering	



Part Number: H08-9XN60

Side Panel:	3/4" (19mm),
Door Thickness:	3/4" (19mm)
Hinge Overlay:	23/32" (18.3mm)
Door Overlay:	5/8" (15.9mm)
Gauge:	.090" (2.3mm)
Hole Pattern:	32mm centers with 37mm setback, 45mm (1-25/32") door wing
Pack:	100/case
Specify finish when ordering	



H08-9XN60, H08-9XP60

Part Number: H08-9XP60

Side Panel:	3/4" (19mm),
Door Thickness:	13/16" (20.6mm)
Hinge Overlay:	23/32" (18.3mm)
Door Overlay:	5/8" (15.9mm)
Gauge:	.090" (2.3mm)
Hole Pattern:	32mm centers with 37mm setback, 45mm (1-25/32") door wing
Pack:	100/case
Specify finish when ordering	



See page T-35 to order #8 flat head screws for mounting these hinges.

FLUSH HINGES

RPC flush hinges with hospital tips come in heights of 2", 2-1/2" and 2-3/4"

Part Number: 860

Door Thickness: 3/4" (19mm),
Door Clearance: 7/32" (5.6mm)
Cabinet Wing Length: 1-59/64" (48.8mm)
Barrel Height: 2-1/2" (63.5mm)
Gauge: .083" (2.1mm)
Pack: 100/case, cell packed
Specify finish when ordering



860

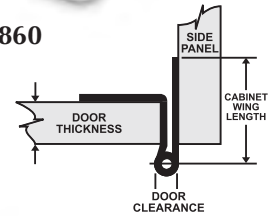

Part Number: 2107

Door Thickness: 13/16" (20.6mm)
Door Clearance: 1/4" (6.4mm)
Cabinet Wing Length: 2-3/16" (55.6mm)
Barrel Height: 2-3/4" (69.9mm)
Gauge: .095" (2.4mm)
Pack: 100/case, cell packed
Specify finish when ordering



2107

Part Number: 8313

Height: 2-3/4" (69.9mm)
Door Thickness: 13/16" (20.6mm)
Hinge Overlay: 19/32"
Door Clearance: 1/4" (6.4mm)
Cabinet Wing Length: 3-5/8" (92mm)
Gauge: .090" (2.3mm)
Hole Pattern: Vertical adjustment side panel
Pack: 100/case, cell packed
Specify finish when ordering



8313

Part Number: 8581

Door Thickness: 13/16" (20.6mm)
Door Clearance: 7/32" (5.6mm)
Cabinet Wing Length: 1-7/8" (47.6mm)
Barrel Height: 2" (50.8mm)
Gauge: .083" (2.1mm)
Pack: 100/case, cell packed
Specify finish when ordering



8581

See page T-35 to order #8 flat head screws for mounting these hinges.

DOOR HARDWARE

Hardware for use on cabinet side panels and solid doors, and for use on wire doors.

RPC offers wood door hardware to match the mounting configuration also used on wire door cabinet designs such as the 2107 hinge and cabinet door hasps shown here.



2101

Part Number: 2101 Wood Door Label Holder

Size: 3-3/16" wide x 1-1/2" high
Specify finish when ordering



2102

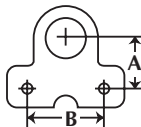

Part Number: 2102 Inset Cabinet Hasp

Height (A): 63/64" (25mm)
Distance Between Holes (B): 1-37/64" (40mm)
Specify finish when ordering



2103

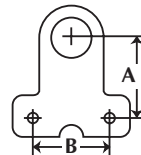

Part Number: 2103 Onset Cabinet Hasp

Height (A): 1-21/32" (42mm)
Distance Between Holes (B): 1-37/64" (40mm)
Specify finish when ordering



2104

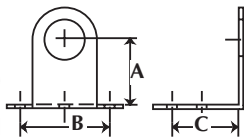

Part Number: 2104 Onset Solid Door Hasp

Height (A): 1-17/32" (34mm)
Distance Between Holes (B): 1-37/64" (40mm)
Mounting Hole Location (C): 1-1/2" (38.2mm)
Specify finish when ordering



2105

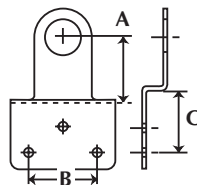

Part Number: 2105 Cabinet Hasp For Overlay Solid Doors

Height (A): 1-1/2" (38.2mm)
Distance Between Holes (B): 1-37/64" (40mm)
Mounting Hole Location (C): 1" (25.4mm)
Overlay: 35/64" (14mm)
Specify finish when ordering



DOOR HARDWARE

Part Number: 2106

Door Plate

Size: 1-37/64" (40mm) x 2-23/64" (60mm)
 Vertical Slot: 10mm x 40mm
Specify finish when ordering

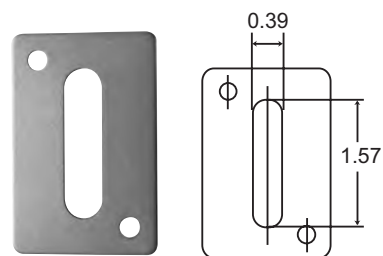

2106

Part Number: 2107

Flush Mount Hinge

Door Thickness: 13/16" (20.6mm)
 Door Clearance: 1/4" (6.4mm)
 Cabinet Wing Length: 2-3/16" (55.6mm)
 Barrel Height: 2-3/4" (69.9mm)
 Gauge: .095" (2.4mm)
Specify finish when ordering



2107



2802-26B
Left Hand
Cabinet Latch

2801-26B
Right Hand
Cabinet Latch

Part Numbers: 2801-26B, 2802-26B

Right Hand Cabinet Latch – 2801-26B (for doors hinged on LH side)

Left Hand Cabinet Latch – 2802-26B (for doors hinged on RH side)

Height (A): 1-5/8" (41.3mm)
 Distance Between Holes (B): 1-25/32" (45mm)
 Mounting Hole Location (C): 2-1/4" (57.2mm)
Available bright chrome plated only



2801-26B
(symmetrically opposite)

2802-26B
(shown)

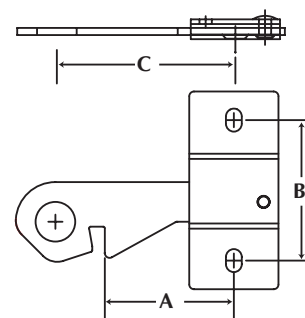

DOOR HARDWARE



2804-26B

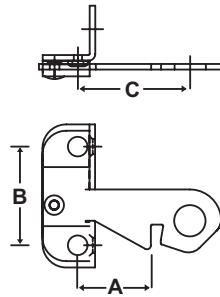

Part Numbers: 2804-26B Double Solid Door Latch

Height (A): 3/4" (19.1mm)
Distance Between Holes (B): 1-37/64" (40mm)
Mounting Hole Location (C): 1/2" (12.7mm)

Available bright chrome plated only



2813-26B
Solid Door Strike

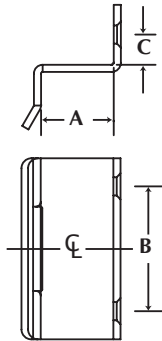

Part Number: 2813-26B

Solid Door Strike Plate

Height (A): 29/32" (23mm)
Distance Between Holes (B): 1-37/64" (40mm)
Mounting Hole Location (C): 21/64" (8.4mm)
Pack: 100/case

Available bright chrome plated only



2814-26B

Part Number: 2814-26B Thru Door Strike Plate for 13/16" Doors

Dimension: 2-3/8" (60mm) x 1-9/16" (40mm)
Distance Between Holes: 1-37/64" (40mm)
Mounting Hole Location: 1-1/16" (27mm)
Pack: 100/case

Available bright chrome plated only



WIRE DOORS

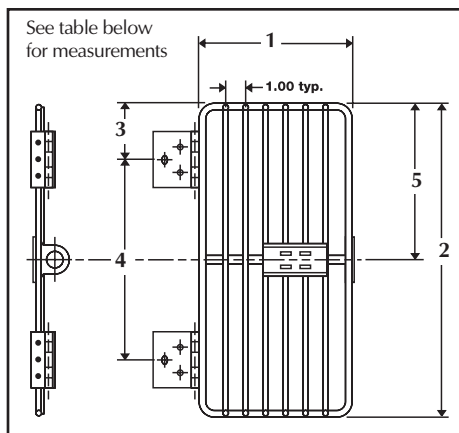

RPC wire doors are suitable for music room, instrument and uniform storage as well as other commercial applications. Choose from RPC's wide selection of standard size wire doors. We can also supply doors to meet your custom size requirements. RPC can match your standard or custom color choice using a durable powder coat finish.

The doorframe wire is 5/16" in diameter. Vertical door wires are 3/16" in diameter and have beveled ends to produce a clean, finished look.

Wire doors are supplied complete with 5-knuckle hinges, a hasp welded to the doorframe and a label holder welded to the vertical wires. A mating Cabinet Hasp - Inset (No. 2102) is included with each door. A No. 2103 Cabinet Hasp - Onset, may be substituted for use in onset applications.

Stay Close Wire Door Latch

RPC now offers an enhanced stay close wire door latch option. The cabinet latch and door strike are constructed of 13 gauge steel and are available in a bright chrome finish. This system allows the doors to be used in either a right or left hand application. The contour of the latch allows it to travel over the hasp until it falls into a positive locked position.



This latching arrangement is available for both solid and wire grille doors. For security, the door can be locked with a padlock.

Ordering Information: To order wire doors with the Stay Close latch feature, add an "S" after the standard wire door part number (i.e., No. 2022S). The mating latch (left or right handed) will be included in your order.

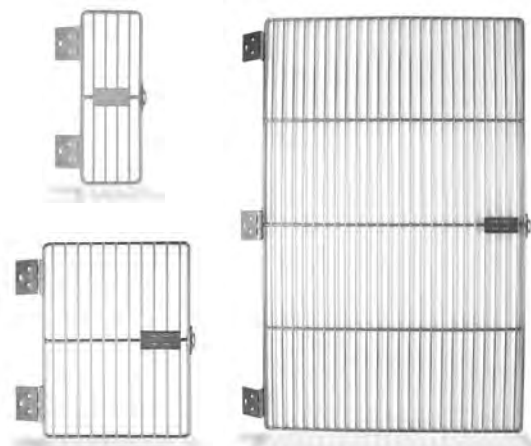

Compartment Type	Part No.	Door Width in. (mm)	Door Height in. (mm)	Hinge Location in. (mm)	Distance Between Outside Hinges	Centerline Location	Number of Hinges	Comments
A*	2022	7.40" (188mm)	15.67" (398mm)	2.83" (72mm)	10.00" (254mm)	7.84" (199mm)	2	
B*	2024	11.77" (299mm)	15.67" (398mm)	2.83" (72mm)	10.00" (254mm)	7.84" (199mm)	2	
C*	2026	24.88" (632mm)	26.30" (668mm)	2.83" (72mm)	20.64" (524mm)	13.15" (334mm)	2	
D*	2028	24.88" (632mm)	39.61" (1006mm)	2.83" (72mm)	33.95" (862mm)	19.80" (503mm)	3	
E*	2030	22.83" (580mm)	79.45" (2018mm)	4.09" (104mm)	71.27" (1810mm)	39.73" (1009mm)	3	Double door w/label holder
E*	2031	22.83" (580mm)	79.45" (2018mm)	4.09" (104mm)	71.27" (1810mm)	39.73" (1009mm)	3	Double door w/o label holder
F*	2032	24.88" (632mm)	79.45" (2018mm)	4.09" (104mm)	71.27" (1810mm)	39.73" (1009mm)	3	
	2259	22.88" (581mm)	39.61" (1006mm)	2.83" (72mm)	33.95" (862mm)	19.80" (503mm)	3	Double door w/label holder
	2260	22.88" (581mm)	39.61" (1006mm)	2.83" (72mm)	33.95" (862mm)	19.80" (503mm)	3	Double door w/o label holder
	2261	22.88" (581mm)	26.30" (668mm)	2.83" (72mm)	20.64" (524mm)	13.15" (334mm)	2	Double door w/label holder
	2262	22.88" (581mm)	26.30" (668mm)	2.83" (72mm)	20.64" (524mm)	13.15" (334mm)	2	Double door w/o label holder
	2020	7.40" (188mm)	39.61" (1006mm)	2.83" (72mm)	33.95" (862mm)	19.80" (503mm)	2	
	2384	7.40" (188mm)	26.30" (668mm)	2.83" (72mm)	20.64" (524mm)	13.15" (334mm)	2	
Tolerances		+/- .06 (+/- 1.5)	+/- .06 (+/- 1.5)	+/- .03 (+/- 0.8)	+/- .06 (+/- 1.5)	+/- .03 (+/- 0.8)	N/A	

* Standard Wire Door Sizes

WIRE DOORS continued on next page.

WIRE DOORS

Typical wire door cabinet dimension and design configurations are shown below. Contact RPC application engineering with your questions or your special requirements. See back cover for contact information.

Applications for STANDARD WIRE DOORS

15 "A" Doors: (fig. 1)	3 compartments wide inside dimension = 8.00" (203.2mm) 5 compartments high inside dimension = 14.85" (377.2mm)
9 "A", 1 "C" Doors: (fig. 2)	3 compartments wide inside dimension = 8.00" (203.2mm) 3 (top) compartments high inside dimension = 14.85" (377.2mm) 1 compartment high inside dimension = 25.67" (652mm) 1 spacer, recessed approx. 1", 5.03" high (25.4mm, 127.8mm)
10 "B" Doors: (fig. 3)	2 compartments wide inside dimension = 12.375" (314.3mm) 5 compartments high inside dimension = 14.85" (377.2mm)
6 "B", 1 "C" Doors: (fig. 4)	2 compartments wide inside dimension = 12.375" (314.3mm) 3 (top) compartments high inside dimension = 14.85" (377.2mm) 1 compartment high inside dimension = 25.67" (652mm) 1 spacer, recessed approx. 1", 5.03" high (25.4mm, 127.8mm)
3 "C" Doors: (fig. 5)	1 compartment wide inside dimension = 25.50" (647mm) 3 compartments high inside dimension = 25.67" (652mm)
2 "D" Doors: (fig. 6)	1 compartment wide inside dimension = 25.50" (647mm) 2 compartments high inside dimension = 38.63" (981.2mm)
"E" Doors (pair): (fig. 7)	Cabinet (outside dm): = 48"w x 30"d x 84"h (1219.2mm x 762mm x 2133.6mm) Toe Kick: 4" (101.5mm) from floor to bottom of shelf, recessed approx. 3" (76.2mm) Vertical Members = 3/4" thick (19.1mm) Top Horizontal Member = 3/4" thick (19.1mm) Shelf 1" (25.4mm) thick, recessed approx. 1" (25.4mm) 1 compartment wide inside dimension = 46.50" (1181mm) 1 compartment high inside dimension = 78.25" (1987.6mm)
1 "F" Door: (fig. 8)	1 compartment wide inside dimension = 25.50" (647.7mm) 1 compartment high inside dimension = 78.25" (1987.6mm)

Cabinets for STANDARD WIRE DOORS

(fig. 1 thru 6, and fig. 8)

Cabinet: (outside dimensions):	27" w x depth x 84" h, w/ 4" toe kick (685mm x depth x 2134mm, w/ 101.6mm toe kick)
Vertical Members:	3/4" Thick (19.1mm)
Top Horizontal Member:	3/4" Thick (19.1mm)
Shelves:	1" (25.4mm) Thick, recessed

To Calculate WIRE DOORS for NON-STANDARD CABINETS

Door Width* inside compartment opening minus 9/16" (14.2mm)

Door Height..... inside compartment opening plus 23/32" (18.3mm)

**If the inside compartment opening is greater than 36-9/16" (928.6mm) in width, two doors will be required, or if double compartment doors are desired, calculate the door width as follows: Inside compartment opening minus 27/32" (21.4mm) divided by 2.*

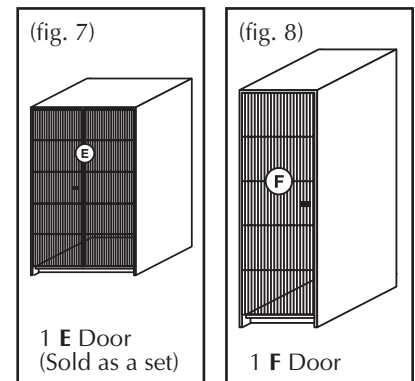
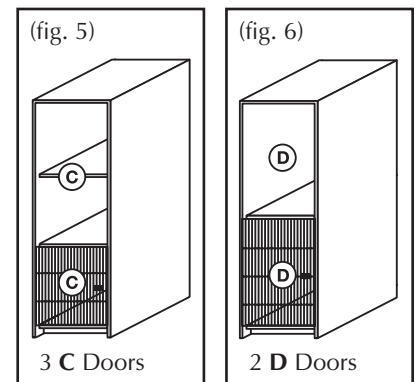
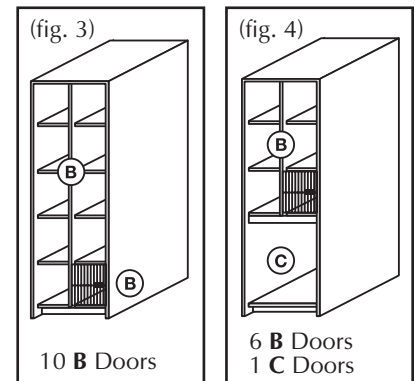
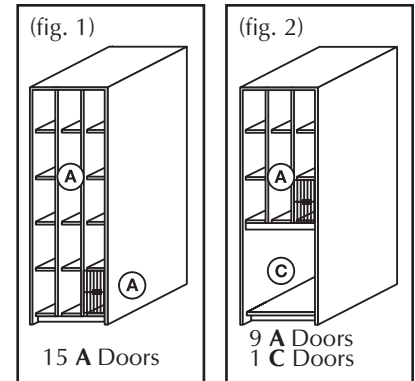

CONTINUOUS HINGES

Continuous Hinge Ordering Codes:

C P 2 - 2 2 0 3 S - 7 2			
Hinge Type (always "C")	Knuckle Configuration/ Gauge/Pin Diameter	Stock Length In inches	Pin Material
Hinge Material			
"A" - Aluminum	100 = 1/2"/.040/.090		"A" - Aluminum
"B" - Brass	110 = 1/2"/.050/.135		"B" - Brass
"C" - Stainless Steel	115 = 1/2"/.060/.120		"C" - Stainless Steel
"S" - Steel	116 = 1/2"/.060/.120 (3 1/2 width or greater)		"S" - Steel
"P" - Pre-plated (pp)	117 = 1"/.060/.120		
	120 = 1/2"/.060/.187		
	122 = 1"/.060/.187		
	125 = 1"/.074/.187		
	130 = 1"/.074/.250		
	133 = 2"/.074/.250		
	140 = 2"/.090/.250		
	161 = 2"/.120/.375		
	189 = 1/2"/.074/.250		
	220 = 1/2"/.040/.090 (pp Nickel)		
	330 = 1/2"/.040/.090 (pp Brass)		
	350 = 1/2"/.040/.090 (Brushed Antique Brass)		
	610 = 1/2"/.040/.090 (Brushed Antique Copper)		
Blank or Hole Pattern		Width (open & flat)	
1 = Blank		1 = 1-1/16"	
2 = 2" centers (countersunk "ctsk")		2 = 1-1/4"	
3 = 2" centers (no ctsk)		3 = 1-1/2"	
4 = 4" centers, 2" staggered (ctsk)		4 = 1-3/4"	
5 = 4" centers, 2" staggered (no ctsk)		5 = 2"	
6 = Import		6 = 2-1/4"	
8 = Per print		7 = 2-1/2"	
9 = Unequal leaf		8 = 2-3/4"	
		9 = 3"	

Example: CP2-2203S-72 = Continuous hinge, pre-plated with 2" centers (ctsk), 1/2" joint length, .040" thickness, .090" pin diameter, 1 1/2" open width, steel pin material at 72 inches.

HOLE PATTERNS AND FINISHES

RPC has in-house powder coating capabilities for institutional and continuous hinges to be able to provide quick turn-a-round. This permits us to offer custom colors and color matching hinges and pulls for the same cabinet.



Holes countersunk on 2" centers



Holes countersunk on 4" centers staggered



We have the capability to run a combination of holes and/or slots in-line on standard 2" and 4" centers.

Finishes:

Nickel
Brass
Antique Copper
Antique Brass
Oil Rubbed Bronze
Custom Plating
Custom Powder Coated

SPECIAL CONTINUOUS HINGES

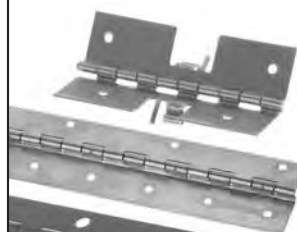

Please contact our friendly and knowledgeable sales representatives when any need arises for an unequal leaf, special hole pattern or non-stock finish.

Our special hinges are the most competitively priced in the market!

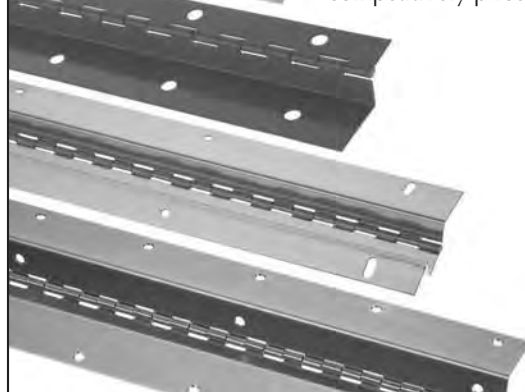

STEEL CONTINUOUS HINGES

(Type CR1010) Blank Hole Pattern

21 Gauge Steel (.035" - .9mm) - Light Gauge .090" Steel Pin and 1/4" Joint Length

Stock No.	Effective Open Width (in.)	Stock Leaf Width (in.)	Length (Ft.)	Inventory Code
CS1-0401S	1-1/16	0.454	-	SPEC
CS1-0402S	1-1/4	0.547	-	SPEC
CS1-0403S	1-1/2	0.673	-	SPEC

19 Gauge Steel (.040" - 1.0mm) Medium Light Gauge .090" Steel Pin and 1/2" Joint Length

Stock No.	Effective Open Width (in.)	Stock Leaf Width (in.)	Length (Ft.)	Inventory Code
CS1-1001S	1-1/16	0.443	-	SPEC
CS1-1002S	1-1/4	0.537	6, 8	STK
CS1-1003S	1-1/2	0.662	-	SPEC
CS1-1004S	1-3/4	0.787	-	SPEC
CS1-1005S	2	0.912	-	SPEC

18 Gauge Steel (.050" - 1.3mm) Medium Gauge .135" Steel Pin and 1/2" Joint Length

Stock No.	Effective Open Width (in.)	Stock Leaf Width (in.)	Length (Ft.)	Inventory Code
CS1-1102S	1-1/4	0.515	-	SPEC
CS1-1103S	1-1/2	0.640	6	STK
CS1-1105S	2	0.890	-	SPEC
CS1-1107S	2-1/2	1.140	-	SPEC

16 Gauge Steel (.060" - 1.5mm) Medium Heavy Gauge .120" Steel Pin and 1/2" Joint Length

Stock No.	Effective Open Width (in.)	Stock Leaf Width (in.)	Length (Ft.)	Inventory Code
CS1-1153S	1-1/2	0.630	-	STD
CS1-1154S	1-3/4	1.755	-	SPEC
CS1-1155S	2	0.880	-	STD
CS1-1159S	3	1.380	-	SPEC
CS1-1163S	4	1.880	-	SPEC

16 Gauge Steel (.060" - 1.5mm) Medium Heavy Gauge .120" Steel Pin and 1" Joint Length

Stock No.	Effective Open Width (in.)	Stock Leaf Width (in.)	Length (Ft.)	Inventory Code
CS1-1179S	3	1.380	-	SPEC

16 Gauge Steel (.060" - 1.5mm) Medium Heavy Gauge .187" Steel Pin and 1/2" Joint Length

Stock No.	Effective Open Width (in.)	Stock Leaf Width (in.)	Length (Ft.)	Inventory Code
CS1-1202S	1-1/4	0.472	-	SPEC
CS1-1203S	1-1/2	0.597	-	SPEC
CS1-1205S	2	0.847	-	SPEC
CS1-1207S	2-1/2	1.097	-	SPEC
CS1-1209S	3	1.347	-	SPEC

If no Stock Length is indicated, this is a non-stocked but standard product that will be manufactured to your finish and length requirements in about 4 weeks.

Inventory Codes: STK - Stock, STD - Standard, SPEC - Special

Custom finishes and powder coat colors can be provided to meet your specific needs.

Please contact RPC Customer Service for details and lead times.

STEEL CONTINUOUS HINGES

(Type CR1010) Blank Hole Pattern Continued

14 Gauge Steel (.074" – 1.9mm) - Heavy Gauge .250" Steel Pin and 1" Joint Length

Stock No.	Effective Open Width (in.)	Stock Leaf Width (in.)	Length (Ft.)	Inventory Code
CS1-1303S	1-1/2	0.551	-	SPEC
CS1-1305S	2	0.801	-	SPEC

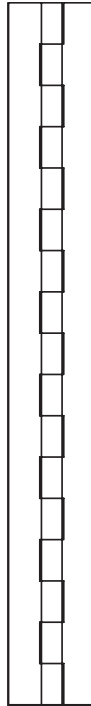

14 Gauge Steel (.074" – 1.9mm) - Heavy Gauge .250" Steel Pin and 2" Joint Length

Stock No.	Effective Open Width (in.)	Stock Leaf Width (in.)	Length (Ft.)	Inventory Code
CS1-1325S	2	0.801	-	SPEC

If no Stock Length is indicated, this is a non-stocked but standard product that will be manufactured to your finish and length requirements in about 4 weeks.

Inventory Codes: STK - Stock, STD - Standard, SPEC - Special

Custom finishes and powder coat colors can be provided to meet your specific needs.

Please contact RPC Customer Service for details and lead times.

(Type CR1010) Standard Hole Pattern Countersunk on 2" Centers

21 Gauge Steel (.035" – .9mm) .090" Steel Pin and 1/4" Joint Length

Stock No.	Effective Open Width (in.)	Stock Leaf Width (in.)	Screw Hole Size	Length (Ft.)	Inventory Code
CS2-0401S	1-1/16	.4538	4	-	SPEC
CS2-0402S	1-1/4	.5475	5	-	SPEC
CS2-0403S	1-1/2	.6725	5	-	SPEC

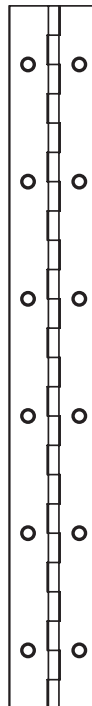

18 Gauge Steel (.050" – 1.3mm) .135" Steel Pin and 1/2" Joint Length

Stock No.	Effective Open Width (in.)	Stock Leaf Width (in.)	Screw Hole Size	Length (Ft.)	Inventory Code
CS2-1102S	1-1/4	.515	6	-	SPEC
CS2-1103S	1-1/2	.640	6	-	SPEC
CS2-1105S	2	.890	6	-	SPEC
CS2-1107S	2-1/2	1.140	6	-	SPEC

19 Gauge Steel (.040" – 1.0mm) .090" Steel Pin and 1/2" Joint Length

Stock No.	Effective Open Width (in.)	Stock Leaf Width (in.)	Screw Hole Size	Length (Ft.)	Inventory Code
CS2-1001S	1-1/16	.4428	4	-	STD
CS2-1002S	1-1/4	.5365	5	-	SPEC
CS2-1003S	1-1/2	.6615	5	-	STD
CS2-1004S	1-3/4	.7865	5	-	SPEC
CS2-1005S	2	.9105	5	-	STD

16 Gauge Steel (.060" – 1.5mm) Medium Heavy Gauge .120" Steel Pin and 1/2" Joint Length

Stock No.	Effective Open Width (in.)	Stock Leaf Width (in.)	Length (Ft.)	Inventory Code
CS2-1153S	1-1/2	0.630	-	STD
CS2-1154S	1-3/4	1.755	-	SPEC
CS2-1155S	2	0.880	-	STD
CS2-1159S	3	1.380	-	SPEC

STEEL CONTINUOUS HINGES

(Type CR1010) Staggered Hole Pattern Countersunk on 4" Centers

21 Gauge Steel (.035" – .9mm) .090" Steel Pin and 1/4" Joint Length

Stock No.	Effective Open Width (in.)	Stock Leaf Width (in.)	Screw Hole Size	Length (Ft.)	Inventory Code
CS4-0401S	1-1/16	.4538	4	-	SPEC
CS4-0402S	1-1/4	.5475	5	-	SPEC
CS4-0403S	1-1/2	.6725	5	-	SPEC

19 Gauge Steel (.040" – 1.0mm) .090" Steel Pin and 1/2" Joint Length

Stock No.	Effective Open Width (in.)	Stock Leaf Width (in.)	Screw Hole Size	Length (Ft.)	Inventory Code
CS4-1001S	1-1/16	.4428	4	-	SPEC
CS4-1002S	1-1/4	.5365	5	-	SPEC
CS4-1003S	1-1/2	.6615	5	-	SPEC
CS4-1004S	1-3/4	.7865	5	-	SPEC
CS4-1005S	2	.9105	5	-	SPEC

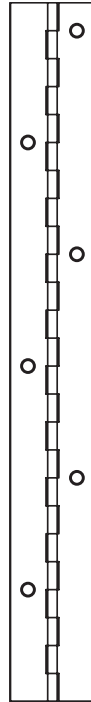

18 Gauge Steel (.050" – 1.3mm) .135" Steel Pin and 1/2" Joint Length

Stock No.	Effective Open Width (in.)	Stock Leaf Width (in.)	Screw Hole Size	Length (Ft.)	Inventory Code
CS4-1102S	1-1/4	.515	6	-	SPEC
CS4-1103S	1-1/2	.640	6	-	SPEC
CS4-1105S	2	.890	6	-	SPEC
CS4-1107S	2-1/2	1.140	6	-	SPEC

16 Gauge Steel (.060" – 1.5mm) Medium Heavy Gauge .120" Steel Pin and 1/2" Joint Length

Stock No.	Effective Open Width (in.)	Stock Leaf Width (in.)	Length (Ft.)	Inventory Code
CS4-1153S	1-1/2	0.630	-	STD
CS4-1154S	1-3/4	1.755	-	SPEC
CS4-1155S	2	0.880	-	STD
CS4-1159S	3	1.380	-	SPEC

If no Stock Length is indicated, this is a non-stocked but standard product that will be manufactured to your finish and length requirements in about 4 weeks.

Inventory Codes: STK - Stock, STD - Standard, SPEC - Special

Custom finishes and powder coat colors can be provided to meet your specific needs. Please contact RPC Customer Service for details and lead times.

STAINLESS STEEL CONTINUOUS HINGES

(Type 304) Blank Hole Pattern

21 Gauge Steel* (.035" - .9mm) - Light Gauge .090" Steel Pin and 1/4" Joint Length

Stock No.	Effective Open Width (in.)	Stock Leaf Width (in.)	Length (Ft.)	Inventory Code
CC1-0401C	1-1/16	.4538	-	SPEC
CC1-0402C	1-1/4	.5475	-	SPEC
CC1-0403C	1-1/2	.6725	-	SPEC

*Manufacturing transitioning from 21 gauge steel to
19 gauge steel to improve quality.

19 Gauge Steel (.040" - 1.0mm) Medium Light Gauge .090" Steel Pin and 1/2" Joint Length

Stock No.	Effective Open Width (in.)	Stock Leaf Width (in.)	Length (Ft.)	Inventory Code
CC1-1001C	1-1/16	.443	-	SPEC
CC1-1002C	1-1/4	.537	-	SPEC
CC1-1003C	1-1/2	.662	-	STD
CC1-1005C	2	.912	-	STD

18 Gauge Steel (.050" - 1.3mm) Medium Gauge .135" Steel Pin and 1/2" Joint Length

Stock No.	Effective Open Width (in.)	Stock Leaf Width (in.)	Length (Ft.)	Inventory Code
CC1-1103C	1-1/2	.640	-	SPEC
CC1-1105C	2	.890	-	SPEC
CC1-1107C	2-1/2	1.140	-	SPEC

16 Gauge Steel (.060" - 1.5mm) Medium Gauge .120" Steel Pin and 1/2" Joint Length

Stock No.	Effective Open Width (in.)	Stock Leaf Width (in.)	Length (Ft.)	Inventory Code
CC1-1152C	1-1/4	.505	-	SPEC
CC1-1153C	1-1/2	.630	-	SPEC
CC1-1155C	2	.880	-	SPEC
CC1-1159C	3	1.380	-	SPEC
CC1-1163C	4	1.880	-	SPEC

14 Gauge Steel (.074" - 1.9mm) - Heavy Gauge .250" Steel Pin and 1" Joint Length

Stock No.	Effective Open Width (in.)	Stock Leaf Width (in.)	Length (Ft.)	Inventory Code
CC1-1305C	2	.801	-	SPEC
CC1-1309C	3	1.301	-	SPEC

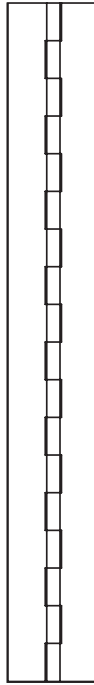

If no Stock Length is indicated, this is a non-stocked but standard product that will be
manufactured to your finish and length requirements in about 4 weeks.

Inventory Codes: STK - Stock, STD - Standard, SPEC - Special

Custom finishes and powder coat colors can be provided to meet your specific needs.
Please contact RPC Customer Service for details and lead times.

STAINLESS STEEL CONTINUOUS HINGES

(Type 304) Standard Hole Pattern Countersunk on 2" Centers

21 Gauge Steel (.035" - .9mm) .090" Steel Pin and 1/4" Joint Length

Stock No.	Effective Open Width (in.)	Stock Leaf Width (in.)	Screw Hole Size	Length (Ft.)	Inventory Code
CC2-0401C	1-1/16	.4538	4	-	SPEC
CC2-0402C	1-1/4	.5475	5	-	SPEC
CC2-0403C	1-1/2	.6725	5	-	SPEC

19 Gauge Steel (.040" - 1.0mm) .090" Steel Pin and 1/2" Joint Length

Stock No.	Effective Open Width (in.)	Stock Leaf Width (in.)	Screw Hole Size	Length (Ft.)	Inventory Code
CC2-1001C	1-1/16	.4428	4	-	STD
CC2-1002C	1-1/4	.5365	5	-	SPEC
CC2-1003C	1-1/2	.6615	5	-	STD
CC2-1005C	2	.9105	5	-	STD

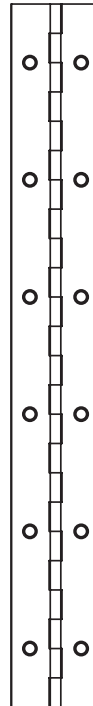

18 Gauge Steel (.050" - 1.3mm) .135" Steel Pin and 1/2" Joint Length

Stock No.	Effective Open Width (in.)	Stock Leaf Width (in.)	Screw Hole Size	Length (Ft.)	Inventory Code
CC2-1103C	1-1/2	.640	6	-	SPEC
CC2-1105C	2	.890	6	-	SPEC

If no Stock Length is indicated, this is a non-stocked but standard product that will be manufactured to your finish and length requirements in about 4 weeks.
Inventory Codes: STK - Stock, STD - Standard, SPEC - Special

Custom finishes and powder coat colors can be provided to meet your specific needs.
Please contact RPC Customer Service for details and lead times.

ALUMINUM CONTINUOUS HINGES

(Type 5052) Blank Hole Pattern

19 Gauge Aluminum (.040" - 1.0mm) Medium Gauge .090" Aluminum Pin and 1/4" Joint Length

Stock No.	Effective Open Width (in.)	Stock Leaf Width (in.)	Length (Ft.)	Inventory Code
CA1-0401A	1-1/16	.4538	-	SPEC
CA1-0402A	1-1/4	.5475	-	SPEC
CA1-0403A	1-1/2	.6725	-	SPEC

19 Gauge Aluminum (.040" - 1.0mm) Medium Light Gauge .090" Aluminum Pin and 1/2" Joint Length

Stock No.	Effective Open Width (in.)	Stock Leaf Width (in.)	Length (Ft.)	Inventory Code
CA1-1001A	1-1/16	.443	-	SPEC
CA1-1002A	1-1/4	.537	-	SPEC
CA1-1003A	1-1/2	.662	-	SPEC
CA1-1005A	2	.912	-	SPEC

Continues On Next Page

If no Stock Length is indicated, this is a non-stocked but standard product that will be manufactured to your finish and length requirements in about 4 weeks.
Inventory Codes: STK - Stock, STD - Standard, SPEC - Special

Custom finishes and powder coat colors can be provided to meet your specific needs.
Please contact RPC Customer Service for details and lead times.

ALUMINUM CONTINUOUS HINGES

(Type 5052) Blank Hole Pattern Continued

18 Gauge Aluminum (.050" – 1.3mm) Medium Gauge .135" Aluminum Pin and 1/2" Joint Length

Stock No.	Effective Open Width (in.)	Stock Leaf Width (in.)	Length (Ft.)	Inventory Code
CA1-1103A	1-1/2	.635	-	STD
CA1-1105A	2	.885	-	SPEC
CA1-1107A	2-1/2	1.140	-	SPEC
CA1-1109A	3	1.390	-	SPEC

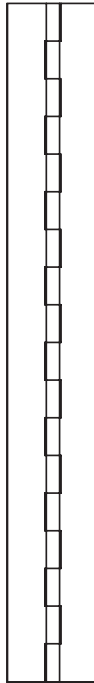

16 Gauge Aluminum (.060" – 1.5mm) Medium Gauge .120" Aluminum Pin and 1/2" Joint Length

Stock No.	Effective Open Width (in.)	Stock Leaf Width (in.)	Length (Ft.)	Inventory Code
CA1-1153A	1-1/2	.630	-	SPEC
CA1-1155A	2	.880	-	SPEC
CA1-1159A	3	1.380	-	SPEC
CA1-1163A	4	1.880	-	SPEC

If no Stock Length is indicated, this is a non-stocked but standard product that will be manufactured to your finish and length requirements in about 4 weeks.
Inventory Codes: STK - Stock, STD - Standard, SPEC - Special

Custom finishes and powder coat colors can be provided to meet your specific needs.
Please contact RPC Customer Service for details and lead times.

(Type 5052) Standard/Staggered Hole Patterns

Holes on 2" Standard Centers, Countersunk 19 Gauge Aluminum (.040" – 1.0mm) .090" Aluminum Pin and 1/2" Joint Length

Stock No.	Effective Open Width (in.)	Stock Leaf Width (in.)	Screw Hole Size	Length (Ft.)	Inventory Code
CA2-1001A	1-1/16	.4428	4	-	STD
CA2-1002A	1-1/4	.5365	5	-	SPEC
CA2-1003A	1-1/2	.6615	5	-	STD
CA2-1005A	2	.9105	5	-	STD

Holes on 4" Staggered Centers, Countersunk 19 Gauge Aluminum (.040" – 1.0mm) .090" Aluminum Pin and 1/2" Joint Length

Stock No.	Effective Open Width (in.)	Stock Leaf Width (in.)	Screw Hole Size	Length (Ft.)	Inventory Code
CA4-1001A	1-1/16	.4428	4	-	SPEC
CA4-1002A	1-1/4	.5365	5	-	SPEC
CA4-1003A	1-1/2	.6615	5	-	STD
CA4-1005A	2	.9105	5	-	SPEC

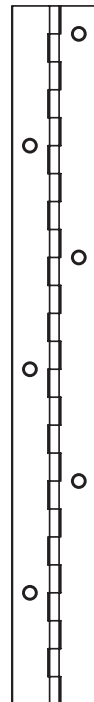

Holes on 4" Staggered Centers, Not Countersunk 19 Gauge Aluminum (.040" – 1.0mm) Medium Light Gauge .090" Aluminum Pin and 1/2" Joint Length

Stock No.	Effective Open Width (in.)	Stock Leaf Width (in.)	Screw Hole Size	Length (Ft.)	Inventory Code
CA5-1001A	1-1/16	.4428	4	-	SPEC
CA5-1002A	1-1/4	.5365	5	-	SPEC
CA5-1003A	1-1/2	.6615	5	-	SPEC
CA5-1005A	2	.9105	5	-	SPEC

Staggered
Holes Shown

PRE-PLATED CONTINUOUS HINGES

Standard Hole Pattern Countersunk on 2" Centers

Brass Plated

19 Gauge Steel (.040" – 1.0mm)

.090" Steel Pin and 1/2" Joint Length

Stock No.	Effective Open Width (in.)	Stock Leaf Width (in.)	Screw Hole Size	Length (Ft.)	Inventory Code
CP2-3301S	1-1/16	.4428	4	6,8	STK
CP2-3302S	1-1/4	.5365	5	6,8	STK
CP2-3303S	1-1/2	.6615	5	6,8	STK
CP2-3305S	2	.9105	5	6,8	STK

Brass Plated

18 Gauge Steel (.050" – 1.3mm)

.135" Steel Pin and 1/2" Joint Length

Stock No.	Effective Open Width (in.)	Stock Leaf Width (in.)	Screw Hole Size	Length (Ft.)	Inventory Code
CP2-3309S	3	1.3755	6	7	STD

Nickel Plated

19 Gauge Steel (.040" – 1.0mm)

.090" Steel Pin and 1/2" Joint Length

Stock No.	Effective Open Width (in.)	Stock Leaf Width (in.)	Screw Hole Size	Length (Ft.)	Inventory Code
CP2-2201S	1-1/16	.4428	4	6	STK
CP2-2202S	1-1/4	.5365	5	6	STK
CP2-2203S	1-1/2	.6615	5	6	STK
CP2-2205S	2	.9105	5	-	STD

Nickel Plated

18 Gauge Steel (.050" – 1.3mm)

.135" Steel Pin and 1/2" Joint Length

Stock No.	Effective Open Width (in.)	Stock Leaf Width (in.)	Screw Hole Size	Length (Ft.)	Inventory Code
CP2-2209S	3	1.3755	6	-	SPEC

Staggered Hole Pattern Countersunk on 4" Centers

Brass Plated

19 Gauge Steel (.040" – 1.0mm)

.090" Steel Pin and 1/2" Joint Length

Stock No.	Effective Open Width (in.)	Stock Leaf Width (in.)	Screw Hole Size	Length (Ft.)	Inventory Code
CP4-3303S	1-1/2	.6615	5	-	STD
CP4-3305S	2	.9105	5	-	STD

Nickel Plated

19 Gauge Steel (.040" – 1.0mm)

.090" Steel Pin and 1/2" Joint Length

Stock No.	Effective Open Width (in.)	Stock Leaf Width (in.)	Screw Hole Size	Length (Ft.)	Inventory Code
CP4-2203S	1-1/2	.6615	5	-	SPEC
CP4-2205S	2	.9105	5	-	STD

If no Stock Length is indicated, this is a non-stocked but standard product that will be manufactured to your finish and length requirements in about 4 weeks.
Inventory Codes: STK - Stock, STD - Standard, SPEC - Special

Custom finishes and powder coat colors can be provided to meet your specific needs.
Please contact RPC Customer Service for details and lead times.

PRE-PLATED CONTINUOUS HINGES

Continuous Hinges in 100' Coils Countersunk on 2" Centers .090" Steel Pin and 1/2" Joint Length

Stock No.	Effective Open Width (in.)	Stock Leaf Width (in.)	Material Thickness	Screw Hole Size	Finish	Inventory Code
CP6-2202S	1-1/4	0.54	01.0mm	5	Nickel	STK
CP6-2203S	1-1/2	0.66	01.0mm	5	Nickel	STK
CP6-3302S	1-1/4	0.54	01.0mm	5	Brass	STK
CP6-3303S	1-1/2	0.66	01.0mm	5	Brass	STK

Continuous Hinges in 100' Coils European Gauge - Countersunk on 60mm Centers .065" Steel Pin and 5/8" Joint Length

Stock No.	Effective Open Width (in.)	Stock Leaf Width (in.)	Material Thickness	Screw Hole Size	Finish	Inventory Code
CP6-6103S	1-1/2	.68	0.7mm	5	Stat Bronze	SPEC

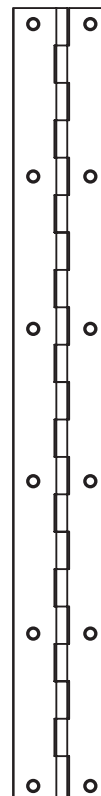

If no Stock Length is indicated, this is a non-stocked but standard product that will be manufactured to your finish and length requirements in about 4 weeks.

Inventory Codes: STK - Stock, STD - Standard, SPEC - Special

Custom finishes and powder coat colors can be provided to meet your specific needs.
Please contact RPC Customer Service for details and lead times.

SPECIAL CONTINUOUS HINGES

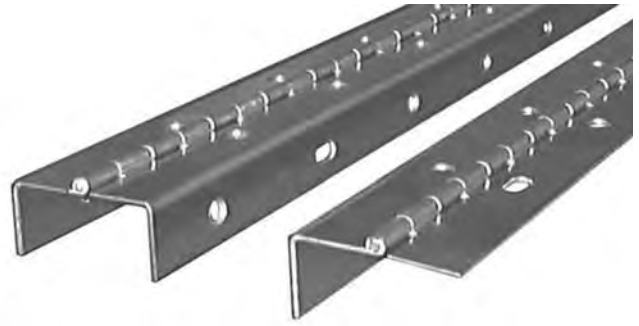

Formed Hinges
19 Gauge Steel (.040" – 1.0mm)
.090" Steel Pin and 48" Lengths

Stock No.	Open Width (in.)	Wrap Width (in.)	Effective Leaf Width	Screw Hole Size	Finishes	Wrap	Packaged With Screw	Inventory Code
CP8-4780S	2-23/25	3/4	1.415	5	Brass	Double Wrap	CPP-4780S	STD
CP9-4781S	2-1/4	3/4	1.415 / .745	5	Brass	Single Wrap	CPP-4781S	SPEC
CS8-4830S	2-23/25	3/4	1.415	5	Antique Brass	Double Wrap	CSP-4830S	SPEC
CS9-4831S	2-1/4	3/4	1.415	5	Antique Brass	Double Wrap	CSP-4831S	SPEC

Distributor Packaged Sets (Packaged individually with screws)
19 Gauge Steel (.040" – 1.0mm)
.090" Steel Pin and 48" Lengths

Stock No.	Packaged Set of Of 10 / Without Screws	Open Width (in)	Effective Leaf Width (in)	Screw Hole Size	Inventory Code
CP7-2201S-721		1-1/16	0.44	4	STD
CP7-2202S-721	AP2-2202S-721	1-1/4	0.54	5	STD
CP7-2203S-301		1-1/2	0.66	5	STD
CP7-2203S-481		1-1/2	0.66	5	STD
CP7-2203S-721	AP2-2203S-721	1-1/2	0.66	5	STD
CP7-2203S-961		1-1/2	0.66	5	STD
CP7-2205S-481		2	0.91	5	STD
CP7-2205S-721	AP2-2205S-721	2	0.91	5	STD
CP7-2205S-961		2	0.91	5	STD
CP7-2209S-961		3	1.39	6	STD
CP7-3301S-361		1-1/16	0.44	4	STD
CP7-3301S-481		1-1/16	0.44	4	STD
CP7-3301S-601		1-1/16	0.44	4	STD
CP7-3301S-721		1-1/16	0.44	4	STD
CP7-3301S-721		1-1/16	0.44	4	STD
CP7-3302S-721	AP2-3302S-721	1-1/4	0.54	5	STD
CP7-3303S-301		1-1/2	0.66	5	STD
CP7-3303S-3C1		1-1/2	0.66	5	STD
CP7-3303S-481		1-1/2	0.66	5	STD
CP7-3303S-601		1-1/2	0.66	5	STD
CP7-3303S-721	AP2-3303S-721	1-1/2	0.66	5	STD
CP7-3303S-961		1-1/2	0.66	5	STD
	AP2-3305S-721	1-1/2	0.66	5	STD
CP7-3309S-961		3	1.39	6	STD
CP7-3503S-721		1-1/2	0.66	5	STD
CP7-6103S-721		1-1/2	0.66	5	STD

If no Stock Length is indicated, this is a non-stocked but standard product that will be manufactured to your finish and length requirements in about 4 weeks.

Inventory Codes:

STK - Stock, STD - Standard, SPEC - Special

Custom finishes and powder coat colors can be provided to meet your specific needs.

Please contact RPC Customer Service for details and lead times.

OVERLAY HINGES

This TERRY™ five-knuckle institutional hinge was designed and manufactured to provide a quality hinge at a value price to meet the needs of today's competitive market place.

Exceeds ANSI/BHMA 156.9 Grade 1 requirements.

Hospital tips, 2-3/4" hinge height, 270° opening angle

All mounting holes are countersunk for #8 flat head screws.

Part Number: 74

Side Panel:	3/4" (19mm)
Door Thickness:	3/4" (19mm)
Door Overlay:	15/32" (11.9mm)
Gauge:	.090" (2.3mm)
Hole Pattern:	32mm centers with 37mm setback
Finishes:	Plated dull chrome – 26D Chrome (powder coat) – CPC Black (powder coat) - BL
Pack:	100/case, poly bagged



74



76

Part Number: 76

Side Panel:	3/4" (19mm)
Door Thickness:	13/16" (20.6mm)
Door Overlay:	15/32" (11.9mm)
Gauge:	.090" (2.3mm)
Hole Pattern:	32mm centers with 37mm setback
Finishes:	Plated dull chrome – 26D Chrome (powder coat) – CPC Black (powder coat) - BL
Pack:	100/case, poly bagged

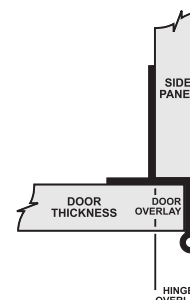

Part Number: H08-98T60-03

Side Panel:	3/4" (19mm)
Door Thickness:	3/4" (19mm)
Hinge Overlay:	47/64" (18.37mm)
Door Overlay:	1/2" (12.7mm)
Gauge:	.090" (2.3mm)
Hole Pattern:	32mm centers with 40mm setback on side panel
Pack:	100/case <i>Available in bright brass only</i>



H08-98T60-03

See page T-35 to order #8 flat head screws for mounting these hinges.

OVERLAY HINGES



HC8-98S01-B1

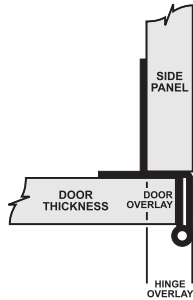

Part Number: HC8-98S01-B1

Height:	3" (76.2mm)
Side Panel:	3/4" (19mm)
Door Thickness:	13/16" (20.6mm)
Door Overlay:	9/16" (14.3mm)
Gauge:	.105" (2.7mm)
Hole Pattern:	32mm centers with 37mm setback Type 304 stainless steel, brushed
Pack:	150/case, poly bagged



H08-9MX83-03

Part Number: H08-9MX83-03

Hinge Height:	2" (50.8mm)
Door Thickness:	5/8" (15.9mm)
Hinge Overlay:	3/4" (19mm)
Door Overlay:	5/8" (15.9mm)
Gauge:	.060" (1.5mm)
Hole Pattern:	Slotted holes
Pack:	200/case <i>Available in bright brass only</i>

FLUSH HINGES

Part Number: H03-62243-39

Height: 1-1/2" (38.1mm)
Return: 7/8" (22.2mm)
Door Thickness: 11/16" (17.5mm)
Countersunk*: Outside
Gauge: .050" (1.2mm)
Screw Size: #6
Pack: 600/case
Available in black oxide only

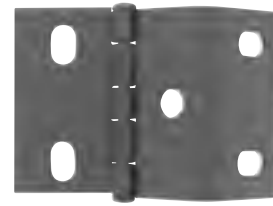

H03-62243-39

Part Number: H03-60843

Height: 1-1/2" (38.1mm)
Return: 1-1/8" (28.6mm)
Door Thickness: 3/4" (19mm)
Countersunk*: Outside
Gauge: .050" (1.2mm)
Pack: 400/case
Available in bright brass and antique brass only



H03-60843

Part Number: H08-49750

Height: 2-1/2" (63.5mm)
Door Thickness: 1-1/2" (38.1mm)
Door Clearance: 3/16" (4.8mm)
Cabinet Wing Length: 1-3/4" (44.5mm)
Countersunk*: Outside
Gauge: .090" (2.3mm)
For framed cabinet use
Pack: 100/case
Only available in bright brass and beige



H08-49750

Part Number: H08-60641

Height: 2-1/2" (63.5mm)
Door Thickness: 1-1/4" (31.8mm)
Door Clearance: 5/32" (4mm)
Cabinet Wing Length: 1-3/4" (44.5mm)
Countersunk*: Inside
Gauge: .065" (1.6mm)
For face mount use
Pack: 100/case
Available in nickel, gloss white and oil rubbed bronze only; some stock remaining in pewter, pearl white and double antique brass



H08-60641

*Note: Inside Countersink – Shutter Application
Outside Countersink – Furniture Application

FLUSH HINGES



H03-67340

Part Number: H03-67340

Height: 2-1/2"
Return: 1" (25.4mm)
Door Thickness: 3/4" (19mm)
Countersunk*: Inside
Gauge: .050" (1.2mm)
Pack: 400/case
Available in antique brass only



H03-62Y41

Part Number: H03-62Y41

Height: 2-1/2" (63.5mm)
Return: 1" (25.4mm)
Door Thickness: 1-1/8" (28.6mm)
Countersunk*: Inside
Gauge: .065" (1.6mm)
Screw Size: #6
Pack: 50/case
Available in bright brass, antique copper and oil rubbed bronze only

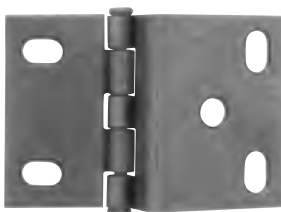

H08-13243-05

Part Number: H08-13243-05

Height: 1-1/2"
Return: 1-1/8"
Door Thickness: 1/4" (6.4mm)
Countersunk: Outside
Gauge: .050" (1.2mm)
Pack: 1000/case
Available in antique brass finish only

*Note: Inside Countersink – Shutter Application
Outside Countersink – Furniture Application

WRAP-A-ROUND HINGE

Part Number: H03-63K53-14

Height: 1-1/2" (38.1mm)
Return: 1-1/4" (31.8mm)
Door Thickness: 5/8" (15.9mm)
Countersunk: Double wrap
Gauge: .050" (1.2mm)
Pack: 250/case
Available in nickel only



H03-63K53-14

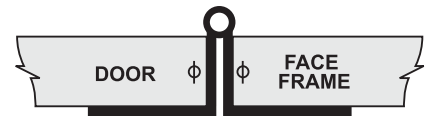

Part Number: H03-63853

Height: 1-1/2" (38.1mm)
Return: 1-3/32" (27.8mm)
Door Thickness: 3/4" (19mm)
Countersunk: Double wrap
Gauge: .050" (1.2mm)
Pack: 200/case
Available in antique brass and black zinc only



H03-63853

STEEL BUTT HINGES – LIGHT GAUGE



H03-20000

Part Number: H03-20000

Height: 1" (25.4mm)
Open Width: 1-1/16" (27mm)
Type Swaging: Flat
Holes Per Leaf: 2
Pin: Sheared Pin
Gauge: .035" (.9mm)
Screw Size: #4
Pack: 2,500/case
Available in bright brass only



H03-20200

Part Number: H03-20200

Height: 1-1/2" (25.4mm)
Open Width: 1-1/16" (27mm)
Type Swaging: Flat
Holes Per Leaf: 2
Pin: Sheared Pin
Gauge: .035" (.9mm)
Screw Size: #4
Pack: 1,000/case
Available in bright brass, antique brass, antique copper and black zinc only



H03-30200

Part Number: H03-30200

Height: 1-1/2" (38.1mm)
Open Width: 1-3/8" (34.9mm)
Type Swaging: Flat
Holes Per Leaf: 2
Pin: Sheared Pin
Gauge: .040" (1mm)
Screw Size: #5
Pack: 1,000/case
Available in bright brass, antique brass, antique copper, nickel, white zinc and black oxide only

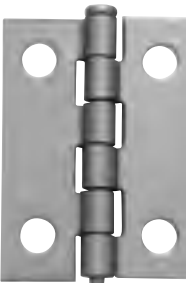

H03-30151

Part Number: H03-30151

Height: 1-1/2" (38.1mm)
Open Width: 1-1/16" (27mm)
Type Swaging: Full
Holes Per Leaf: 2
Pin: Loose Pin
Gauge: .040" (1mm)
Screw Size: #4
Pack: 1,000/case
Available in antique copper, nickel, double antique brass only

STEEL BUTT HINGES – LIGHT GAUGE

Part Number: H03-30103-03

Height: 1-1/2" (38.1mm)
Open Width: 1-1/16" (27mm)
Type Swaging: Flat
Holes Per Leaf: 2
Pin: Tight Pin
Gauge: .040" (1mm)
Screw Size: #4
Pack: 1,000/case
Available in bright brass only



H03-30103-03

Part Number: HR8-30303-14

Height: 1-1/2" (38.1mm)
Open Width: 1-1/2" (38.1mm)
Type Swaging: Flat
Holes Per Leaf: 2
Pin: Tight Pin, radius corners
Gauge: .040" (1mm)
Screw Size: #4
Pack: 1,000/case
Available in nickel finish only



HR8-30303-14

Part Number: H03-30500

Height: 2" (50.8 mm)
Open Width: 1-13/16" (46mm)
Type Swaging: Flat
Holes Per Leaf: 3
Pin: Sheared Pin
Gauge: .040" (1mm)
Screw Size: #5
Pack: 1,000/case
Available in bright brass and antique brass only



H03-30500

Part Number: H08-37480-05

Height: 1-3/4" (44.5 mm)
Open Width: 1-1/16" (26.9mm)
Type Swaging: Flat
Holes Per Leaf: 2
Pin: Sheared Pin
Gauge: .035" (0.9mm)
Screw Size: #5
Pack: 500/case
Available in antique brass only



H08-37480-05

STEEL BUTT HINGES – MEDIUM GAUGE



H03-40151

Part Number: H03-40151

Height: 1-1/2" (38.1mm)
Open Width: 1-3/4" (44.5mm)
Type Swaging: Full
Holes Per Leaf: 2
Pin: Loose Pin
Gauge: .050" (1.3mm)
Screw Size: #5
Pack: 500/case

Available in bright brass, antique brass, double antique brass, prime coat, nickel, gloss white, and oil rubbed bronze only



H08-50500

Part Number: H08-50500

Height: 2" (50.8mm)
Open Width: 1-1/2" (38.1mm)
Type Swaging: Flat
Holes Per Leaf: 2
Pin: Sheared Pin
Gauge: .060" (1.5mm)
Screw Size: #5
Pack: 200/case

Available in raw or plated finish only



H03-40253

Part Number: H03-40253

Height: 2" (50.4mm)
Open Width: 1-23/32" (43.7mm)
Type Swaging: Full
Holes Per Leaf: 2
Pin: Tight Pin
Gauge: .050" (1.3mm)
Screw Size: #6
Pack: 200/case

Available in bright brass and antique brass only



H03-40403

Part Number: H03-40403

Height: 2" (50.8mm)
Open Width: 2" (50.8mm)
Type Swaging: Flat
Holes Per Leaf: 2
Pin: Tight Pin
Gauge: .050" (1.3mm)
Screw Size: #6
Pack: 200/case

Available in bright brass and zinc only

STEEL BUTT HINGES – MEDIUM GAUGE

Part Number: H03-40651-03

Height: 2-1/2" (63.5 mm)
Open Width: 2-9/16" (65 mm)
Type Swaging: Full
Holes Per Leaf: 3
Pin: Loose Pin
Gauge: .050" (1.3mm)
Screw Size: #6
Pack: 500/case
Available in bright brass only



H03-40651-03

Part Number: H03-40753-17

Height: 2-1/2" (63.5 mm)
Open Width: 2-1/16" (52.3mm)
Type Swaging: Full
Holes Per Leaf: 3
Pin: Tight Pin
Gauge: .050" (1.3mm)
Screw Size: #6
Pack: 250/case
Available in zinc only



H03-40753-17

Part Number: H03-41453

Height: 2-1/2" (63.5mm)
Open Width: 2-1/16" (52.3mm)
Type Swaging: Full
Holes Per Leaf: 3
Pin: Tight Pin, Radius corners
Gauge: .050" (1.3mm)
Screw Size: #6
Pack: 200/case
Specify finish when ordering



H03-41453

Part Number: H03-25T02

Height: 2-1/2" (63.5mm)
Open Width: 2" (50.8mm)
Type Swaging: Flat
Holes Per Leaf: 3, slotted center hole on each leaf
Pin: Loose Pin, radius corners
Gauge: .060" (1.5mm)
Screw Size: #6
Pack: 100/case
Specify finish: SE – white semi-gloss, SF – cream white, semi-gloss



H03-25T02

STEEL BUTT HINGES – HEAVY GAUGE

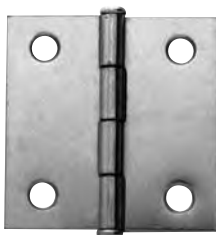

H03-57451

Part Number: H03-57451

Height:	2" (50.8mm)
Open Width:	1-13/16" (46mm)
Type Swaging:	Full
Holes Per Leaf:	2
Pin:	Loose Pin
Gauge:	.065" (1.7mm)
Screw Size:	#6
Pack:	100/case

Available in bright brass, gloss white, white Arizona and oil rubbed bronze only



H03-57551

Part Number: H03-57551

Height:	2" (50.8mm)
Open Width:	2" (50.8mm)
Type Swaging:	Full
Holes Per Leaf:	2
Pin:	Loose Pin
Gauge:	.065" (1.7mm)
Screw Size:	#6
Pack:	100/case

Available in bright brass, gloss white, white Arizona, nickel, oil rubbed bronze and antique brass only



H03-51251

Part Number: H03-51251

Height:	2-1/2" (63.5mm)
Open Width:	1-1/2" (38.1mm)
Type Swaging:	Full
Holes Per Leaf:	3
Pin:	Loose Pin
Gauge:	.065" (1.7mm)
Screw Size:	#6
Pack:	100/case

Available in bright brass, antique brass, prime coat, satin nickel, zinc, satin black, gloss white, white Arizona, oil rubbed bronze and square beige



H03-55451

Part Number: H03-55451

Height:	2-1/2" (63.5mm)
Open Width:	1-11/16" (42.9 mm)
Type Swaging:	Full
Holes Per Leaf:	3
Pin:	Loose Pin
Gauge:	.065" (1.7mm)
Screw Size:	#6
Pack:	100/case

Available in bright brass, antique brass, satin nickel, oil rubbed bronze only



STEEL BUTT HINGES – HEAVY GAUGE

Part Number: H03-57651

Height:	2-1/2" (63.5mm)
Open Width:	2" (50.8mm)
Type Swaging:	Full
Holes Per Leaf:	3
Pin:	Loose Pin
Gauge:	.065" (1.7mm)
Screw Size:	#6
Pack:	100/case
<i>Available in bright brass, antique brass, prime coat, nickel, gloss white, brushed chrome and oil rubbed bronze only</i>	

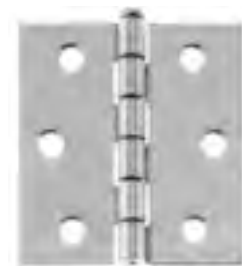

H03-57651

Part Number: H03-57702-03

Height:	2-1/2" (63.5mm)
Open Width:	2-1/2" (63.5mm)
Type Swaging:	Flat
Holes Per Leaf:	3
Pin:	Fixed Pin, Spun
Gauge:	.065" (1.7mm)
Screw Size:	#6
Pack:	200/case
<i>Available in bright brass only</i>	

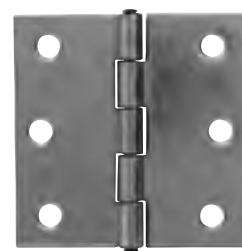

H03-57702-03

Part Number: H03-57751

Height:	2-1/2" (63.5mm)
Open Width:	2-1/2" (63.5mm)
Type Swaging:	Full
Holes Per Leaf:	3
Pin:	Loose Pin
Gauge:	.065" (1.7mm)
Screw Size:	#6
Pack:	100/case
H02-57751	same as H03-57751 packed in poly bag with screws <i>Specify finish when ordering</i>



H03-57751

Part Number: H03-55551

Height:	3" (76.2mm)
Open Width:	2-3/4" (69.9mm)
Type Swaging:	Full
Holes Per Leaf:	3
Pin:	Loose Pin
Gauge:	.074" (1.9mm)
Screw Size:	#8
Pack:	100/case
<i>Available in antique brass, prime coat and oil rubbed bronze only</i>	

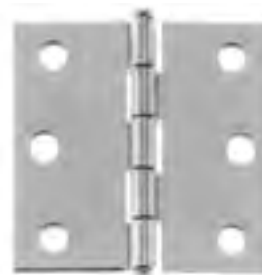

H03-55551

STEEL BUTT HINGES – HEAVY GAUGE



H03-55803-03

Part Number: H03-55803-03

Height: 3" (76.2mm)
Open Width: 3-1/4" (82.6mm)
Type Swaging: Flat
Holes Per Leaf: 3
Pin: Tight Pin
Gauge: .065" (1.7mm)
Screw Size: #8
Pack: 100/case
Available bright brass only

NON-MORTISE HINGES



H03-041A5

Part Number: H03-041A5

Height: 2" (50.8mm)
Large Leaf Width: 5/8" (15.9mm)
Pin: Tight Pin, .030" offset
Gauge: .050" (1.3mm)
Screw Size: #5
Pack: 1,000/case
Available in antique brass, antique copper and black oxide



H03-03500-03

Part Number: H03-03500-03

Height: 2" (50.8 mm)
Large Leaf Width: 43/64" (17.1mm)
Pin: Tight Pin
Gauge: .050" (1.3mm)
Screw Size: #4
Pack: 500/case
Available in bright brass only

NON-MORTISE HINGES

Part Number: H03-03205

Height: 2-1/2" (63.5mm)
Large Leaf Width: 3/4" (19mm)
Pin: Tight Pin
Gauge: .054" (1.4mm)
Screw Size: #5
Pack: 100/case
Available in bright brass and antique copper only



H03-03205

Part Number: H03-03305

Height: 3" (76.2mm)
Large Leaf Width: 13/16" (20.6mm)
Pin: Tight Pin
Gauge: .054" (1.4mm)
Screw Size: #5
Pack: 500/case
Available in antique copper only



H03-03305

Part Number: H03-03C81

Height: 3" (76.2mm)
Large Leaf Width: 1" (25.4mm)
Pin: Loose Pin
Gauge: .060" (1.5mm)
Screw Size: #6
Pack: 300/case
Available in zinc and sky white only



H03-03C81

Part Number: H03-09502-03 Surface Mount Strap Hinge

Height: 1-1/32" (26.2mm)
Open Width: 4" (101.6mm)
Pin: Tight Pin
Gauge: .053" (1.4mm)
Screw Size: #5
Pack: 500/case
Available in bright brass only



H03-09502-03

LIFT-OFF & THREE LEAF HINGES



H57-80250/H56-80250

Part Number: H57-80250/H56-80250

Height: 2-3/8" (60.3mm)
Open Width: 2-3/64" (52mm)
Type Swaging: Full
Gauge: .050" (1.3mm)
Screw Size: #6
Pack: 800/case
Specify finish when ordering



H57-80450/H56-80450

Part Number: H57-80450/H56-80450

Height: 2-1/8" (54mm)
Open Width: 1-9/16" (52mm)
Type Swaging: Full
Gauge: .050" (1.3mm)
Screw Size: #4
Pack: 2,000/case
Specify finish when ordering



H03-03970

Part Number: H03-03970

Height: 3-7/16" (87.3mm)
Open Width: 2-5/16" (58.7mm)
Type Swaging: Full
Gauge: .050" (1.3mm)
Screw Size: #6
Pack: 500/case
Available in bright brass, antique brass, nickel, gloss white and oil rubbed bronze only



DOUBLE ACTING SCREEN HINGES

Part Number: H03-04001-03

Height: 1-3/4" (44.5mm)
Width: for 3/4" panels or doors
Gauge: .040" (1.1mm)
Screw Size: #6
Pack: 400/case
Available in bright brass only



H03-04001

Part Number: H01-04004-03 Gravity Pivot Hinge Set w/Screws For Café or Bar Doors

Height: 1-1/4" (44.5mm)
Width: 1" (25.4mm) For 3/4" to 1-3/4" panels
Screw Size: #8 x 3/4"
Pack: 100/case
Available in bright brass only



H01-04004

PIVOT HINGE

Part Number: H02-X4100-39

Gage: .060" (1.5mm)
Height: 3/4" (19mm)
Length: 5/8" (16mm)
Each Set Includes: w/(2) #6 x 1/2" pan head screws and (2) 5mm plastic bushings
Pack: 2,000/case, poly bagged set
Available in black oxide only



H02-X4100-39

Part Number: H02-00159-23 Set With Top & Bottom Hinges, Screws & Bushings

Type Hinge: end pivot
Length: 2-1/16" (52mm)
Height: 5/8" (15.2mm)
Width: 9/16" (14mm)
Pack: 125 sets/case, poly bagged
Available in matte black only



H02-00159-23

TRADITIONAL FACE FRAME HINGES

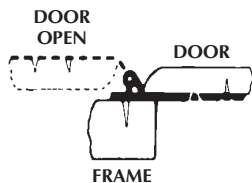

H03-9S163-05

Part Number: H03-9S163-05

Self Closing

Barrel Height: 1-5/8" (41.3mm)
Flush mount
Screw Size: #5
Pack: 500/case
Available in antique brass only



H03-9S013-05

Part Number: H03-9S013-05

Self Closing

Barrel Height: 1-7/8" (47.6mm)
Overlay: 1/4" (6.4mm)
Screw Size: #5
Pack: 25/carton - 400/case
Available in antique brass only



H03-9S410

Part Number: H03-9S410

Self Closing

Barrel Height: 1-13/16" (46mm)
Overlay: 1/2" (12.7mm)
Screw Size: #5
Pack: 400/case
Available in bright brass, antique English & antique black oxide only

BARREL HINGE



H03-05010-03

Part Number: H03-05010-03

Hinge Dimensions Closed: .39" x .85" (10mm x 21.6mm)
Door Thickness: 1/2" (12.7mm)
Pack: 1200/case
Available in bright brass only

GLASS DOOR HARDWARE

Part Number: H02-00090-26

Set With Top & Bottom Hinges, Screws & Shims

Glass Thickness: 3/16" (5mm)
Height: 9/16" (13.5mm)
Length: 1-9/16" (40mm)
Pack: 125 sets/case, poly bagged
Available in polished chrome only

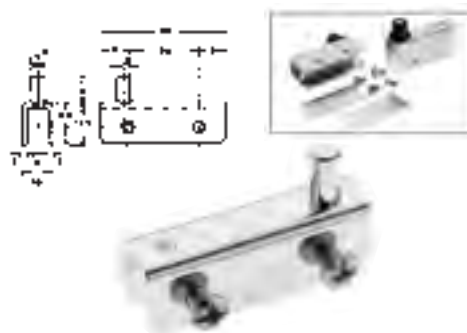

H02-00090-26

Part Number: H02-X0090-33

Glass Thickness: 3/16" (5mm)
Height: 9/16" (13.5mm)
Length: 1-9/16" (40mm)
Pack: 250/case, poly bagged set
Available in solid brass only



H02-X0090-33

Part Number: H02-XS090

Glass Thickness: 3/16" (5mm)
Height: 9/16" (13.5mm)
Length: 1-9/16" (40mm)
Pack: 250/case, poly bagged set
Same as **H02-X0090-334** except shorter pivot point 5/32" (4mm)
Available in satin chrome and black matte only



H02-XS090

Part Number: H02-00091-26

Set With Top & Bottom Hinges, Screws & Grommets

Glass Thickness: 1/4" (6.5mm)
Height: 33/64" (13.3mm)
Length: 1-9/16" (40mm)
Pack: 125/carton – 250/case, poly bagged set
Available in polished chrome finish only



H02-00091-26

GLASS DOOR HARDWARE



H02-00B90-19

Part Number: H02-00B90-19

Glass Thickness: 3/16" (5mm)
 Height: 9/16" (13.5mm)
 Length: 1-9/16" (40mm)
 Each set includes (4) 5/16-24 screws w/black Plastisol tip,
 no shim plate required
 Pack: 250/case, poly bagged set
Available in black finish only

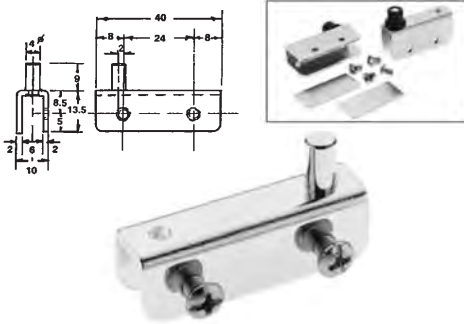

H02-00P90-19

Part Number: H02-00P90-19

Glass Thickness: 3/16" (5mm)
 Height: 9/16" (13.5mm)
 Length: 1-9/16" (40mm)
 Each set includes (4) 5/16-18 plastic set screws, no shim plate required
 Pack: 250/case, poly bagged set
Available in black finish only

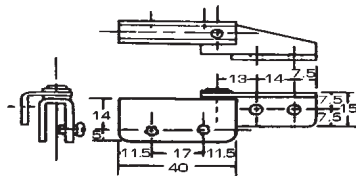

H02-00095

Part Number: H02-00095 Set With Top & Bottom Hinges

Glass Thickness: 1/4" (6.5mm)
 Height: 13/16" (19mm)
 Length: 2-1/2" (40mm)
 Pack: 200 sets/case, poly bagged
Available in black or solid brass only



H02-00A95-19

Part Number: H02-00A95-19

Glass Thickness: 1/4" (6.5mm)
 Height: 59/64" (23.4mm)
 Length: 1-7/8" (47.6mm) open
 Has adjustable mounting slots for #6 pan head screws not included
 Pack: 125/carton – 250/case, poly bagged set
Available in black finish only

GLASS DOOR HARDWARE

Part Number: H08-00110-08

Glass Thickness: 3/16" (5mm)
Height: .3/4" (19mm)
Length: 1-1/2" (38.1mm)
Pack: 400 sets/case, cell packed
Available in dull brass finish only



H08-00110-08

Part Number: H08-00220-33

Glass Thickness: 3/16" (5mm)
Height: 5/8" (16mm)
Length: 1-1/2" (38.1mm)
Pack: 400 sets/case, cell packed
Available in solid brass only



H08-00220-33

Part Number: B02-00131

Can Be Used As Handle Or Strike Plate.
Has Self-Adhesive Rubber Pad For Cushion.

Glass Thickness: 3/16" (4.8mm) or 1/4" (6.5mm)
Height: 1" (25.4mm)
Length: 1-9/16" (39.7mm)
Pack: 1000 case, poly bagged
Available in dull brass, polished chrome, and polished solid brass only



B02-00131

Part Number: H08-07205-33

Glass Door Hinge Requires Hole In Glass

Type Of Hinge: 1/4" (6.4mm) Overlay
Bore: 6.6mm
Height: 2" (50.8mm)
Screw Size: #6
Pack: Each poly bag contains (1) hinge, (2) washers,
(1) felt pad, (1) button, and (1) screw
500 poly bags/case
Available in solid brass only

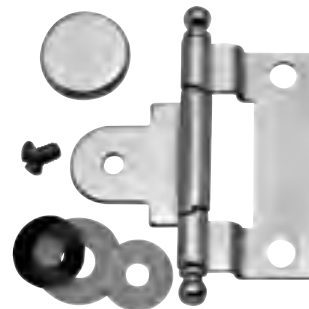

H08-07205-33

CASEWORK HARDWARE



M03-99389-17

Part Number: M03-99389-17
Elbow Catch Set With Catch & Plate

Length: 2-1/4" (57.2mm)
Width: 1-1/8" (28.6mm)
Height: 1" (25.4mm)
Pack: 100 sets/case
Available in white zinc only



M03-00039-26

Part Number: M03-00039-26
Elbow Catch Set With Catch, Plate & Screws

Length: 1-1/4" (31.8mm)
Width: 1" (25.4mm)
Height: 1-1/8" (28.6mm)
Pack: Poly bagged set, 100 sets/case
Available in bright chrome only



M03-A9307

Part Number: M03-A9307-17
Roller Catch Set With Catch & Plate

Length: 1-1/8" (28.6mm)
Width: 1-3/8" (34.9 mm)
Height: 5/8" (15.9 mm)
Pack: 100 sets/case
Available in white zinc only



M08-99391

Part Number: M08-99391-17
Jumbo Roller Catch Set With Catch & Plate

Length: 1-9/16" (39.7mm)
Width: 1-7/8" (47.6mm)
Height: 15/16" (23.8mm)
Pack: 50 sets/case
Available in white zinc only

CASEWORK HARDWARE

Part Number: B03-07000 Button Catch Inside Clip

Length: 5/8" (15.9mm)
Width: 1-1/8" (28.6mm)
Height: 1" (25.4mm)
Pack: 500 case
Available in bright brass, antique brass & white zinc only



B03-07000

Part Number: B03-07001 Button Catch Reverse Clip

Length: 1" (25.4mm)
Width: 5/8" (15.9mm)
Height: 3/4" (19mm)
Pack: 500 case
Available in bright brass, white zinc & white only



B03-07001

Part Number: B03-07002-17 Button For Catch

Length: 7/8" (22.2mm) with screw
Width: 1/2" (12.7mm) diameter
Height: 5/16" (7.9mm)
Pack: 500 case
Available in white zinc only



B03-07002-17

Part Number: B03-07003-17 Receiver Catch

Length: 3/8" (9.5 mm)
Width: 5/8" (15.9mm)
Height: 1/2" (12.7mm)
Pack: 7500/case
Available in white zinc finish only



B03-07003-17

Part Numbers: M03-00033-03, M03-00035-03 Insert Bullet Catch Set With Nail

Diameter: 3/8" (9.5mm) – **M03-00033**
Diameter: 1/4" (4.4mm) – **M03-00035**
Pack: 500 sets/case
Available in bright brass only



M03-00033-03, M03-00035-03

CASEWORK HARDWARE



M03-4400B-03

Part Number: M03-4400B-03
Double Ball Catch – Solid Brass

Length: 1-45/64" (43.3mm)
Width: 5/16" (7.9mm)
Height: 3/8" (9.5mm)
Pack: 100 sets/case
Available in solid brass only



M03-4900B-03

Part Number: M03-4900B-03
Double Ball Catch – Solid Brass

Length: 1-59/64" (48.8mm)
Width: 11/32" (8.7mm)
Height: 7/16" (11.1mm)
Pack: 100 sets/case
Available in solid brass only



M03-99388-06

Part Number: M03-99388-06
Nylon Roller Catch

Length: 1-1/8" (28.6mm)
Width: 1-1/4" (31.8mm)
Height: 1/2" (12.7mm)
Pack: 100 sets/case
Available in statuary bronze only



M03-99398-06

Part Number: M03-99398-06
Nylon Roller High-Rise Catch

Length: 1-5/8" (41.3mm)
Width: 1-1/16" (27mm)
Height: 13/16" (20.6mm)
Pack: 100 sets/case
Available in statuary bronze only

CASEWORK HARDWARE

Part Number: B02-06512-A6

Double Wardrobe Hook With Screws

Height: 2-1/4" (57.2mm)
Hook Width: 2-7/8" (73mm)
Base Width: 1-1/2" (38.1mm)
Pack: 50/carton; 500/case
Available in polished aluminum only



B02-06512-A6

Part Number: B02-06513-A6

Double Ceiling Hook With Screws

Height: 2-1/4" (57.2mm)
Hook Width: 3-1/4" (82.6mm)
Base Width: 1-7/8" (47.6mm)
Pack: 30/carton; 300/case
Available in polished aluminum only



B02-06513-A6

Part Number: N03-01000-33

Cast Bottle Opener

Length: 2-1/2" (63.5mm)
Width: 2-5/8" (66.7mm)
Height: 3-1/8" (79.4mm)
Screw Size: #5
Pack: 200 sets/case, poly bagged
Available in solid brass only



N03-01000-33

Part Number: B02-00040-03

Ice Box Name Plate With Screws

Length: 3-1/2" (88.9mm)
Height: 1-1/2" (38.1mm)
Pack: 100 sets/case, poly bagged
Available in bright brass only



B02-00040-03

Part Number: B01-03855-03

Sash Lock

Base Width: 2-5/8" (67.7mm)
Height: 1" (25.4mm)
Pack: 25 sets/carton; 250 sets/case
Available in bright brass only



B01-03855-03

TERRY pulls are available with 4" or 96mm mounting hole centers. They are brushed stainless steel or carbon steel with a powder coat finish or dull chrome plating. Pulls use two #8-32 machine screws which are not provided.

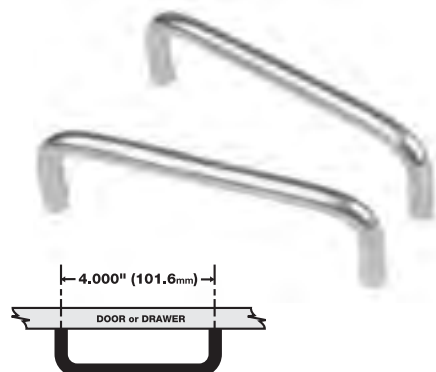

P604, P604SS, P604AL

Part Number: P604, P604SS, P604AL

Material Diameter:	5/16" (8mm)
On Center Hole Spacing:	4" (101.6mm)
Protrusion:	1-1/4" (31.8mm)
Pack:	100 /case, cell packed
	<i>Available chrome plated or powder coat</i>
P604SS	Type 304 stainless steel
Pack:	50/case, poly bagged
P604AL	Aluminum
Pack:	50/case, poly bagged
P4604ERSS	4" OC mounting holes with longer off set. Handle protrudes 1.44" for greater clearance for ADA applications

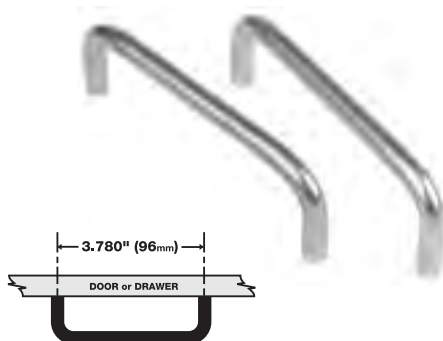
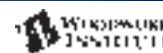

P605, P605SS

Part Number: P605, P605SS

Material Diameter:	5/16" (8mm)
On Center Hole Spacing:	96mm (3-25/32")
Protrusion:	1-1/4" (31.8mm)
Pack:	100/case, cell packed
	<i>Available chrome plated or powder coat</i>
P605SS	Type 304 stainless steel
Pack:	50/case, cell packed

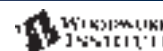

P607

Part Number: P607

Material Diameter:	3/8" (10mm)
On Center Hole Spacing:	4" (101.6mm)
Protrusion:	1-1/4" (31.8mm)
Pack:	100/case, cell packed
	<i>Available in gloss black, polished chrome and dull chrome powder coat only</i>
P607SS	Type 304 stainless steel



P608AL

Part Number: P608AL

Material:	Extruded aluminum
On Center Hole Spacing:	4" (101.6mm)
Protrusion:	1" (25.4mm)
Pack:	100/case, poly bagged
	<i>Available in brushed aluminum only</i>

MAGNETIC TOUCH LATCHES

Part Number: B01-06969-55

Single Magnetic Touch Latch With 32mm Hole Centers

Length:	1-3/4" (44.5mm)
Width:	1-21/32" (42mm)
Height:	3/4" (19mm)
Screw Size:	#4
Pack:	100/case
	<i>Available in black only</i>

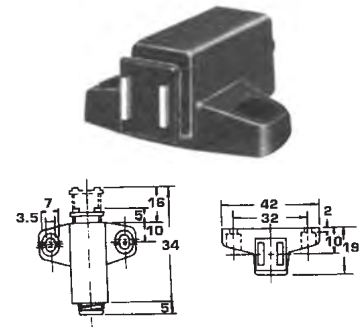

B01-06969-55

Part Number: B01-V6931

Double Magnetic Touch Latch

Length:	1-13/16" (46mm)
Width:	2-1/4" (57.2mm)
Height:	11/16" (17.5mm)
Screw Size:	#4
Pack:	125/case
	<i>Available in black, brown, white only</i>

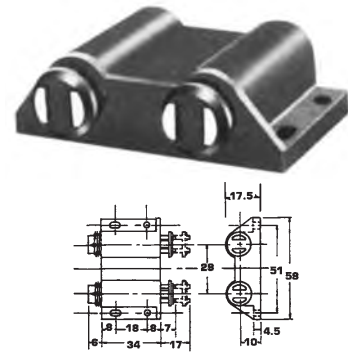

B01-V6931

Part Number: B01-X6950-55

Single Magnetic Touch Latch With 32mm Hole Centers

Length:	1-7/16" (36.5mm)
Width:	1-5/8" (41.3 mm)
Height:	5/8" (15.9mm)
Screw Size:	#4
Pack:	125/case
	<i>Available in black only</i>

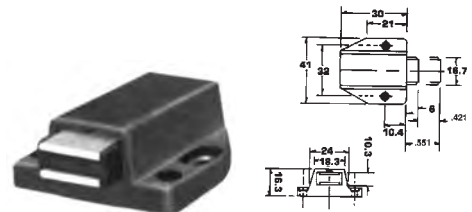

B01-X6950-55

Part Number: B08-06942-55

Mortise Type Magnetic Catch

Length:	1-1/32" (26.2mm)
Diameter:	11mm (7/16")
Pack:	500/case
	<i>Available in black only</i>
Suggest M04-02909 round strike plate – page T-29	

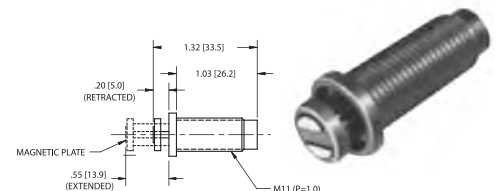

B08-06942-55

MAGNETIC CATCHES

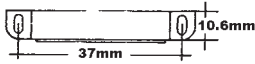

M03-03934-77

Part Number: M03-03934-77

Holding Power:	12 lbs
Length:	1-3/4" (45.2mm)
Width:	13/32" (10.6mm)
Height:	15/32" (11.9mm)
Screw Size:	#4
Pack:	300/case
<i>Available in brown only</i>	



M03-03920-77

Part Number: M03-03920-77

Holding Power:	9 lbs
Length:	1-7/8" (47.6mm)
Width:	3/4" (19mm)
Height:	5/8" (15.9mm)
Screw Size:	#5
Pack:	1000/case
<i>Available in brown only</i>	

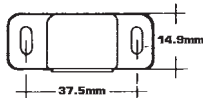
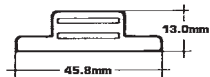
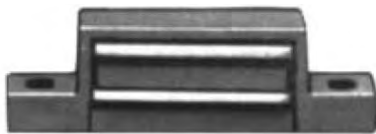

M03-X3921

Part Number: M03-X3921

Holding Power:	8.5 lbs
Length:	1-13/16" (45.8mm)
Width:	19/32" (14.9mm)
Height:	1/2" (13mm)
Screw Size:	#4
Pack:	250/case
<i>Available in white and brown only</i>	
M02-X3921	Poly bagged set with strike plate & screws
<i>Available in white and brown only</i>	

MAGNETIC CATCHES

Part Number: M03-03926

Holding Power:	9 lbs
Length:	1-7/8" (48mm)
Width:	3/4" (19mm)
Height:	9/16" (14.8mm)
Screw Size:	#4
Pack:	500/case
	<i>Available in brown or white only</i>
M02-03926-66	Poly bagged set with strike plate & screws
Pack:	400/carton – 800/case
	<i>Available in white only</i>



M03-03926

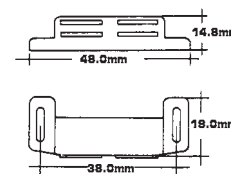

Part Number: M03-03932

Holding Power:	8 lbs
Length:	1-21/32" (41.8mm)
Width:	27/32" (21mm)
Height:	23/32" (18mm)
Screw Size:	#4
Pack:	250/case
	<i>Available in black or brown only</i>
M02-03932-77	Set w/magnetic catch and strike plate
Pack:	100/carton – 800/case, bulk
	<i>Available in brown only</i>



M03-03932

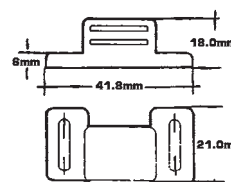

Part Number: M03-03923-77

Holding Power:	8 lbs
Length:	2-5/16" (51.6mm)
Width:	31/32" (24.6mm)
Height:	1/2" (12.3mm)
Screw Size:	#4
Pack:	250/case
	<i>Available in brown only</i>



M03-03923-77

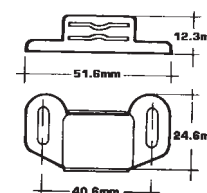

Part Number: M03-03925

Holding Power:	8 lbs
Length:	2" (50mm)
Width:	19/32" (20.2mm)
Height:	13/32" (14.8mm)
Screw Size:	#4
Pack:	500/case
	<i>Available in brown or white</i>



M03-03925

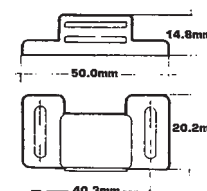

MAGNETIC CATCHES

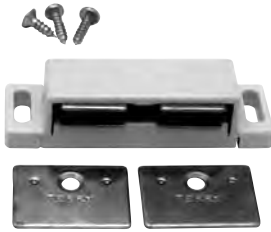

M07-03941-66 Set

Part Number: M03-03941-77

Holding Power:	8 lbs
Length:	2-7/8" (20.2mm)
Width:	13/16" (20.6mm)
Height:	23/32" (18.3mm)
Screw Size:	#5
Pack:	400/case
	Available in brown only
M07-03941-66	Poly bagged set with strike plates and screws
Pack:	400/case
	Available in white only



M09-03944-66

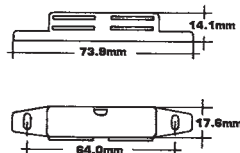

Part Number: M09-03944-66

Holding Power:	12 lbs
Length:	2-5/16" (73.9mm)
Width:	11/16" (17.6mm)
Height:	9/16" (14.1mm)
Screw Size:	#5
Pack:	500/case
	Available in white only



M03-03950

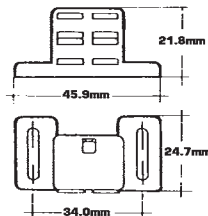

Part Number: M03-03950

Holding Power:	25 lbs
Length:	1-13/16" (45.9mm)
Width:	63/64" (24.7mm)
Height:	7/8" (21.8mm)
Screw Size:	#6
Pack:	50/carton – 500/case
	Available in brown or white only
M02-03950	Poly bagged set with strike plate & screws
Pack:	200/case



M03-03970-77

Part Number: M03-03970-77

Holding Power:	8#
Length:	1-1/4" (31.8mm)
Width:	15/16" (23.8mm)
Height:	23/32" (18.3mm)
Screw Size:	#6
Pack:	200/carton – 800/case
	Available in brown only

MAGNETIC CATCHES

Part Number: M02-X3946-01

Holding Power: 15lbs
Length: 2-1/4" (57.2mm)
Depth: 1" (25.4mm)
Height: 5/8" (15.9mm)
Pack: 100/carton – 500/case, poly bagged w/strike and screws
Available in aluminum only



M02-X3946-01

Part Number: M03-03915

Holding Power: 10 lbs
Length: 23/32" (18.3mm)
Width: 7/16" (11mm)
Depth: 21/32" (17mm)
Screw Size: #4
Pack: 3000/case
Available in black or brown only

Suggest **M04-02909** round strike plate – See below



M03-03915

Part Number: M04-02901 Rectangular Strike Plate

Length: 1-7/32" (31mm)
Width: 29/32" (23mm)
Screw Size: #5
Pack: 2000/case



M04-02901

Part Number: M04-02902-06 Rectangular Strike Plate

Length: 1-3/8" (34.9mm)
Width: 1/2" (12.7mm)
Screw Size: #5
Pack: 2000/case
Antique copper only



M04-02902-06

Part Number: M04-02909 Round Strike Plate

Diameter: 19/32" (15.1mm)
Screw Size: #5
Pack: 2000/case



M04-02909

LID SUPPORTS



LS3-61918-03

Part Number: LS3-61918-03

Hand: Reversible
Tension: Adjustable
Arm Length: 6-1/4" (158.8mm)
Arm Width: 9/16" (14.3mm)
Length Of Slot: 5-1/2" (139.7mm)
Screw Size: #5
Pack: 100/case
Available in bright brass only



LS3-6L919-03, LS3-6R919-03

Part Numbers: LS3-6L919-03, LS3-6R919-03

Hand: **6L919** – left, **6R919** - right
Tension: Adjustable
Arm Length: 6-1/4" (158.8mm)
Arm Width: 9/16" (14.3mm)
Length Of Slot: 5-1/2" (139.7mm)
Screw Size: #5
Pack: 200/case
Available in bright brass only



LS3-6R929-03

Part Numbers: LS3-6R929-03

Hand: right
Tension: Adjustable
Arm Length: 5" (127mm)
Arm Width: 9/16" (14.3mm)
Length Of Slot: 4-11/16" (119.1mm)
Screw Size: #5
Pack: 200/case
Available in bright brass only



LS3-61909-03

Part Number: LS3-61909-03

Hand: Reversible
Tension: Adjustable
Arm Length: 6-3/4" (171.5mm)
Arm Width: 3/4" (19mm)
Length Of Slot: 6" (152.4mm)
Screw Size: #5
Pack: 100/case
Available in bright brass only

LID SUPPORTS

Part Numbers: LSX-R1525-06, LSX-L1525-06 Self-Balancing Heavy-Duty Lid Support, Side Mounted

Hand: **R1525** – right, **L1525** - left
Tension: 35 lbs
Open Length: 6" (152.4mm)
Arm Width: 15/16" (23.8mm)
Screw Size: #6
Pack: 100/carton – 200/case
Available in statuary bronze only

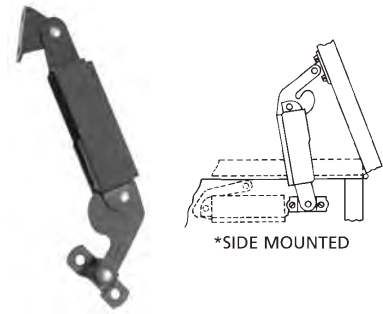

LSX-R1525-06, LSX-L1525-06

Part Numbers: LS6-R1575-06, LS6-L1575-06 Self-Balancing Heavy-Duty Lid Support, Back Mounted

Hand: **R1575** – right, **L1575** - left
Tension: 35 lbs
Open Length: 6" (152.4mm)
Arm Width: 15/16" (23.8mm)
Screw Size: #6
Pack: 100/carton – 200/case
Available in statuary bronze only

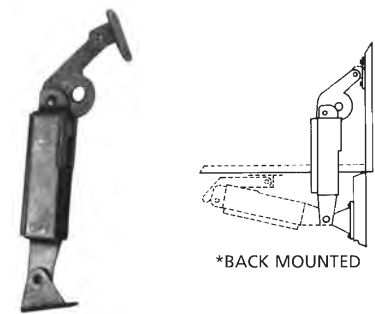

LS6-R1575-06, LS6-L1575-06

Part Number: H02-CH000-03 (pair) Combination Hinge & Support

Hand: left & right
Tension: none
Open Length: 3-3/4" (95.3mm)
Arm Width: 1" (25.4mm)
Length Of Slot: 5-1/2" (139.7mm)
Screw Size: #6
Pack: 50/case
Available in bright brass only

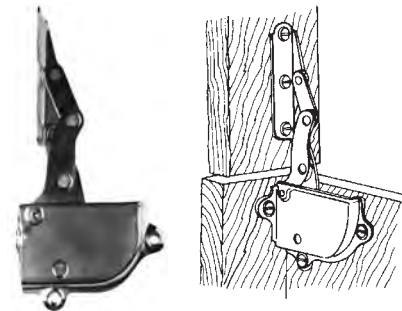

H02-CH000-03

Part Number: H08-96B05-03 Lid Hinge

Width: 2" (50.8mm)
Base Width: 3/4 - 1" (19mm - 25.4mm)
Return: 1/2" (12.7mm)
Gauge: .070" (1.8mm)
Screw Size: #6
Pack: 500/case
Available in bright brass only



H08-96B05-03

SHUTTER PINS & SHELF PINS

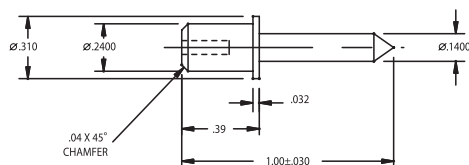

PN9-00500

Part Number: PN9-00500-01 Standard Shutter Pin

Pin Diameter: .140" (3.6mm)
Head Diameter: .240" (6.1mm)
Full Length: 1.035" (26.3mm)
Pack: 15000/case
Nylon



B01-34056

Part Number: B01-34056 Spoon Type Shelf Support

Bore: 3/16" (5mm)
Length: 3/4" (19mm)
Width: 5/16" (7.9mm)
Pack: 1000/case
Available in antique brass, bright brass or nickel only



B01-34050

Part Number: B01-34050 Spoon Type Shelf Support

Bore: 1/4" (6.5mm)
Length: 3/4" (19mm)
Width: 1/2" (7.9mm)
Pack: 1000/case
Available in Antique brass, black nickel, bright brass or nickel only



B01-34072-03

Part Number: B01-34072-03 Spoon Type Shelf Support

Bore: 3/16" (5mm)
Length: 11/16" (17.5mm)
Pack: 8/bag, 1000 bags/case
Available in bright brass only



B08-34051-14

Part Number: B08-34051-14 Right Angle Shelf Rest With Quake Pin Hole

Bore: 1/4" (6.5mm)
Length: 23/32" (18.2mm)
Width: 33/64" (13.2mm)
Pack: 1000/case
Available in nickel only

SHUTTER PINS & SHELF PINS

Part Number: B03-3406X-14

Right Angle Shelf Rest With Quake Pin Hole

Bore: 3/16" (5mm)
Length: 23/32" (18.2mm)
Width: 33/64" (13.2mm)
Pack: 1000/case
Available in nickel only



B03-3406X-14

Part Number: B01-34060

Right Angle Shelf Rest

Bore: 3/16" (5mm)
Length: 3/4" (19mm)
Width: 1/2" (12.7mm)
Pack: 1000/case
Available in antique copper or bright brass only



B01-34060

Part Number: B01-35060-03

Right Angle Shelf Rest With Hole & Slot

Bore: 3/16" (5mm)
Length: 3/4" (19mm)
Width: 1/2" (12.7mm)
Pack: 1000/case
Available in bright brass only



B01-35060-03

Part Number: B03-34070

Plastic Head Shelf Pin

Bore: 3/16" (5mm)
Length: 11/16" (17.5mm)
Width: 7/16" (11.1mm)
Pack: 1000/case
Available in clear, black, white, tan only



B03-34070

PILASTERS, CLIPS, STANDARDS & BRACKETS

Pilaster Standards Are Designed For Shelving & Bookcases For Surface Or Recessed Mounting



B01-58XX1-17

Width: 5/8" (15.9mm)
Depth: 3/16" (4.8mm)
Length: Per part number
Adjustments: every 1/2" (12.7mm)
Finish: Bright zinc
Pack: 100 same size/case

Part Numbers	Length
B01-58181-17	18"
B01-58241-17	24"
B01-58361-17	36"
B01-58481-17	48"
B01-58601-17	60"
B01-58721-17	72"
B01-58961-17	96"



B01-CLP11-17, B01-CLP12-17

Part Number: B01-CLP11-17, B01-CLP12-17 Clips For B01-58xxx Pilaster Standards

Pack: **B01-CLP11-17** - 100/box
B01-CLP12-17 - 1000/case
Finish: Bright zinc

Wall Standards & Brackets For Surface Mounting



B01-59XX1-17

Width: 7/8" (22.2mm)
Depth: 11/16" (17.5mm)
Length: Per part number
Adjustments: every 1/2" (12.7mm)
Finish: Bright zinc
Pack: 10/case

Part Numbers	Length
B01-59481-17	48"
B01-59721-17	72"
B01-59961-17	96"

Shelf Brackets For Wall Standards

Pack: 20/case
Finish: Brushed zinc



B01-53XX1-22

Part Numbers	Bracket Length
B01-53121-22	12"
B01-53141-22	14"
B01-53161-22	16"
B01-53181-22	18"
B01-53201-22	20"
B01-53221-22	22"
B01-53241-22	24"

SCREWS

Part Number	Description	Color	Order Quantity
J7-9639-1D-9	#8 X 5/8" PH FL HD SM	BLACK	900/bag
J7-9639-26D-9	#8 X 5/8" PH FL HD SM	DULL CHROME	900/bag
J7-9639-SS-9	#8x5/8" PH FL HD SM	STAINLESS STEEL	450/bag
TFP-04041-05	#4 X 1/2" PH FL HD SM	ANTIQUE BRASS	5000
TFP-04051-03	#4 X 5/8" PH FL HD SM	BRIGHT BRASS	5000
TFP-04051-05	#4 X 5/8" PH FL HD SM	ANTIQUE BRASS	5000
TFP-04051-06	#4 X 5/8" PH FL HD SM	ANTIQUE COPPER	5000
TFP-05052-03	#5 X 5/8" PH FL HD WD SCR	BRIGHT BRASS	5000
TFP-05052-05	#5 X 5/8" PH FL HD WD SCR	ANTIQUE BRASS	5000
TFP-05052-06	#5 X 5/8" PH FL HD WD SCR	ANTIQUE COPPER	5000
TFP-05052-17	#5 X 5/8" PH FL HD WD SCR	WHITE ZINC	5000
TFP-06052-03	#6 X 5/8" PH FL HD WD SCR	BRIGHT BRASS	5000
TFP-06052-17	#6 X 5/8" PH FL HD WD SCR	WHITE ZINC	5000
TFP-06052-19	#6 X 5/8" PH FL HD WD SCR	BLACK ZINC	5000
TFP-06062-03	#6 X 3/4" PH FL HD WD SCR, #17 PNT	BRIGHT BRASS	5000
TFP-06062-05	#6 X 3/4" PH FL HD WD SCR, #17 PNT	ANTIQUE BRASS	5000
TFP-06062-14	#6 X 3/4" PH FL HD WD SCR, #17 PNT	NICKEL	5000
TFP-06062-17	#6 X 3/4" PH FL HD WD SCR, #17 PNT	WHITE ZINC	5000
TFP-06062-66	#6 X 3/4" PH FL HD WD SCR, #17 PNT	WHITE	5000
TFP-06062-19	#6 X 3/4" PH FL HD WD SCR, #17 PNT	BLACK ZINC	5000
TFP-06072-01	#6 X 7/8" PH FL HD WD SCR COARSE THREAD	RAW STEEL	5000
TFP-06072-17	#6 X 7/8" PH FL HD WD SCR COARSE THREAD	WHITE ZINC	5000
TFP-07061-S1	#7 X 5/8" PH FL HD SM	STAINLESS STEEL	5000
TFP-08052-03	#8 X 5/8" PH FL HD SM	BRIGHT BRASS	5000
TFP-08062-17	#8 X 3/4" PH FL HD WD SCR	WHITE ZINC	5000
TFP-08081-03	#8 X 1" PH FL HD SM	BRIGHT BRASS	5000
TFP-08081-14	#8 X 1" PH FL HD SM	NICKEL	5000
TFP-08082-17	#8 X 1" PH FL HD SM	WHITE ZINC	5000

PH: Phillips Head

FL HD: Flat Head

SM: Sheet Metal Screw

WD SCR: Wood Screw

#17 PNT: Type 17 Drill Point Screw

NUMERICAL INDEX

Part Number	Page	Part Number	Page	Part Number	Page
74.....	T-1	2814.....	R-10	B02-00131.....	T-19
76.....	T-1	7036.....	R-4	B02-06512.....	T-23
349.....	R-5	8313.....	R-7	B02-06513.....	T-23
362.....	R-5	8314.....	R-3	B03-07000.....	T-21
374.....	R-1	8362.....	R-4	B03-07001.....	T-21
375.....	R-1	8581.....	R-7	B03-07002.....	T-21
376.....	R-1	362SS.....	R-5	B03-07003.....	T-21
388.....	R-4	376SS.....	R-1	B03-34050.....	T-32
454.....	R-2	8314SS.....	R-3	B03-34056.....	T-32
455.....	R-2	8362SS.....	R-4	B03-34070.....	T-33
456.....	R-2	AP2-2202S.....	C-10	B03-3406X.....	T-33
844.....	R-4	AP2-2203S.....	C-10	B08-06942.....	T-25
846.....	R-2	AP2-2205S.....	C-10	B08-34051.....	T-32
847.....	R-2	AP2-3302S.....	C-10	CA1-0401A.....	C-6
848.....	R-3	AP2-3303S.....	C-10	CA1-0402A.....	C-6
849.....	R-3	AP2-3305S.....	C-10	CA1-0403A.....	C-6
851.....	R-3	B01-03855.....	T-23	CA1-1001A.....	C-6
853.....	R-3	B01-06969.....	T-25	CA1-1002A.....	C-6
860.....	R-7	B01-34060.....	T-33	CA1-1003A.....	C-6
2020.....	R-11	B01-34072.....	T-32	CA1-1005A.....	C-6
2022.....	R-11	B01-35060.....	T-33	CA1-1103A.....	C-7
2024.....	R-11	B01-53121.....	T-34	CA1-1105A.....	C-7
2026.....	R-11	B01-53141.....	T-34	CA1-1107A.....	C-7
2028.....	R-11	B01-53161.....	T-34	CA1-1109A.....	C-7
2030.....	R-11	B01-53181.....	T-34	CA1-1153A.....	C-7
2031.....	R-11	B01-53201.....	T-34	CA1-1155A.....	C-7
2032.....	R-11	B01-53221.....	T-34	CA1-1159A.....	C-7
2101.....	R-8	B01-53241.....	T-34	CA1-1163A.....	C-7
2102.....	R-8	B01-58181.....	T-34	CA2-1001A.....	C-7
2103.....	R-8	B01-58241.....	T-34	CA2-1002A.....	C-7
2104.....	R-8	B01-58361.....	T-34	CA2-1003A.....	C-7
2105.....	R-8	B01-58481.....	T-34	CA2-1005A.....	C-7
2106.....	R-9	B01-58601.....	T-34	CA4-1001A.....	C-7
2107.....	R-7, R-9	B01-58721.....	T-34	CA4-1002A.....	C-7
2259.....	R-11	B01-58961.....	T-34	CA4-1003A.....	C-7
2260.....	R-11	B01-59481.....	T-34	CA4-1005A.....	C-7
2261.....	R-11	B01-59721.....	T-34	CA5-1001A.....	C-7
2262.....	R-11	B01-59961.....	T-34	CA5-1002A.....	C-7
2384.....	R-11	B01-CLP11.....	T-34	CA5-1003A.....	C-7
2801.....	R-9	B01-CLP12.....	T-34	CA5-1005A.....	C-7
2802.....	R-9	B01-V6931.....	T-25	CC1-0401C.....	C-5
2804.....	R-10	B01-X6950.....	T-25	CC1-0402C.....	C-5
2813.....	R-10	B02-00040.....	T-23	CC1-0403C.....	C-5

NUMERICAL INDEX

Part Number	Page	Part Number	Page	Part Number	Page
CC1-1001C.....	C-5	CP7-2203S.....	C-10	CS2-1003S.....	C-4
CC1-1002C.....	C-5	CP7-2205S.....	C-10	CS2-1004S.....	C-4
CC1-1003C.....	C-5	CP7-2209S.....	C-10	CS2-1005S.....	C-4
CC1-1005C.....	C-5	CP7-3301S.....	C-10	CS2-1102S.....	C-4
CC1-1103C.....	C-5	CP7-3302S.....	C-10	CS2-1103S.....	C-4
CC1-1105C.....	C-5	CP7-3303S.....	C-10	CS2-1105S.....	C-4
CC1-1107C.....	C-5	CP7-3309S.....	C-10	CS2-1107S.....	C-4
CC1-1152C.....	C-5	CP7-3503S.....	C-10	CS2-1153S.....	C-4
CC1-1153C.....	C-5	CP7-6103S.....	C-10	CS2-1154S.....	C-4
CC1-1155C.....	C-5	CP8-4780S.....	C-10	CS2-1155S.....	C-4
CC1-1159C.....	C-5	CP9-4781S.....	C-10	CS2-1159S.....	C-4
CC1-1163C.....	C-5	CPP-4780S.....	C-10	CS4-0401S.....	C-4
CC1-1305C.....	C-5	CS1-1179S.....	C-2	CS4-0402S.....	C-4
CC1-1309C.....	C-5	CS1-1202S.....	C-2	CS4-0403S.....	C-4
CC2-0401C.....	C-6	CS1-1203S.....	C-2	CS4-1001S.....	C-4
CC2-0402C.....	C-6	CS1-1205S.....	C-2	CS4-1002S.....	C-4
CC2-0403C.....	C-6	CS1-1207S.....	C-2	CS4-1003S.....	C-4
CC2-1001C.....	C-6	CS1-1209S.....	C-2	CS4-1004S.....	C-4
CC2-1002C.....	C-6	CS1-0401S.....	C-2	CS4-1005S.....	C-4
CC2-1003C.....	C-6	CS1-0402S.....	C-2	CS4-1102S.....	C-4
CC2-1005C.....	C-6	CS1-0403S.....	C-2	CS4-1103S.....	C-4
CC2-1103C.....	C-6	CS1-1001S.....	C-2	CS4-1105S.....	C-4
CC2-1105C.....	C-6	CS1-1002S.....	C-2	CS4-1107S.....	C-4
CP2-2201S.....	C-8	CS1-1003S.....	C-2	CS4-1153S.....	C-4
CP2-2202S.....	C-8	CS1-1004S.....	C-2	CS4-1154S.....	C-4
CP2-2203S.....	C-8	CS1-1005S.....	C-2	CS4-1155S.....	C-4
CP2-2205S.....	C-8	CS1-1102S.....	C-2	CS4-1159S.....	C-4
CP2-3301S.....	C-8	CS1-1103S.....	C-2	CS8-4830S.....	C-10
CP2-3302S.....	C-8	CS1-1105S.....	C-2	CS9-4831S.....	C-10
CP2-3303S.....	C-8	CS1-1107S.....	C-2	CSP-4781S.....	C-10
CP2-3305S.....	C-8	CS1-1153S.....	C-2	CSP-4830S.....	C-10
CP2-3309S.....	C-8	CS1-1154S.....	C-2	CSP-4831S.....	C-10
CP4-2203S.....	C-8	CS1-1155S.....	C-2	GL01.....	R-5
CP4-2205S.....	C-8	CS1-1159S.....	C-2	GL02.....	R-5
CP4-3303S.....	C-8	CS1-1163S.....	C-2	GL03.....	R-5
CP4-3305S.....	C-8	CS1-1303S.....	C-3	H02-00090.....	T-17
CP6-2202S.....	C-9	CS1-1305S.....	C-3	H02-00091.....	T-17
CP6-2203S.....	C-9	CS1-1325S.....	C-3	H02-00095.....	T-18
CP6-3302S.....	C-9	CS2-0401S.....	C-4	H02-00159.....	T-15
CP6-3303S.....	C-9	CS2-0402S.....	C-4	H02-0095A.....	T-18
CP6-6103S.....	C-9	CS2-0403S.....	C-4	H02-00B90.....	T-18
CP7-2201S.....	C-10	CS2-1001S.....	C-4	H02-00P90.....	T-18
CP7-2202S.....	C-10	CS2-1002S.....	C-4	H02-CH000.....	T-31

NUMERICAL INDEX

Part		Part		Part	
Number	Page	Number	Page	Number	Page
H02-X0090	T-17	H03-9S410	T-16	M03-03925	T-27
H02-X4100	T-15	H08-00110	T-19	M03-03926	T-27
H02-XS090	T-17	H08-00220	T-19	M03-03932	T-27
H03-03205	T-13	H08-07205	T-19	M03-03934	T-26
H03-03305	T-13	H08-13243	T-4	M03-03941	T-28
H03-03500	T-12	H08-37480	T-7	M03-03950	T-28
H03-03970	T-14	H08-49750	T-3	M03-03970	T-28
H03-03C81	T-13	H08-50500	T-8	M03-4400B	T-22
H03-04001	T-15	H08-60641	T-3	M03-4900B	T-22
H03-04004	T-15	H08-96B05-03	T-31	M03-99388	T-22
H03-041A5	T-12	H08-98T60	T-1	M03-99389	T-20
H03-05010	T-16	H08-9MX83	T-2	M03-99398	T-22
H03-09502	T-13	H08-9XE60	R-6	M03-A9307	T-20
H03-20000	T-6	H08-9XG60	R-6	M03-X3921	T-26
H03-20200	T-6	H08-9XN60	R-6	M04-02901	T-29
H03-25T02	T-9	H08-9XP60	R-6	M04-02902	T-29
H03-30103	T-7	H56-80250	T-14	M04-02909	T-29
H03-30151	T-6	H56-80450	T-14	M08-99391	T-20
H03-30200	T-6	H57-80250	T-14	M09-03944	T-28
H03-30500	T-7	H57-80450	T-14	N03-01000	T-23
H03-40151	T-8	HC8-98S01	T-2	P604	T-24
H03-40253	T-8	HR8-30303	T-7	P604AL	T-24
H03-40403	T-8	J7-9639	T-35	P604SS	T-24
H03-40651	T-9	LS3-61909	T-30	P605	T-24
H03-40753	T-9	LS3-61918	T-30	P605SS	T-24
H03-41453	T-9	LS3-6L919	T-30	P607	T-24
H03-51251	T-10	LS3-6R919	T-30	P608AL	T-24
H03-55451	T-10	LS3-6R929	T-30	PN9-00500	T-32
H03-55551	T-11	LS6-L1525	T-31	TFP-04041	T-35
H03-55803	T-12	LS6-L1575	T-31	TFP-04051	T-35
H03-57451	T-10	LS6-R1525	T-31	TFP-05052	T-35
H03-57551	T-10	LS6-R1575	T-31	TFP-06052	T-35
H03-57651	T-11	M02-03926	T-27	TFP-06062	T-35
H03-57702	T-11	M02-03932	T-27	TFP-06072	T-35
H03-57751	T-11	M02-03950	T-28	TFP-07061	T-35
H03-60843	T-3	M02-X3921	T-26	TFP-08052	T-35
H03-62243	T-3	M02-X3946	T-29	TFP-08062	T-35
H03-62Y41	T-4	M03-00033	T-21	TFP-08081	T-35
H03-63853	T-5	M03-00035	T-21	TFP-08082	T-35
H03-63K53	T-5	M03-00039	T-20		
H03-67340	T-4	M03-03915	T-29		
H03-9S013	T-16	M03-03920	T-26		
H03-9S163	T-16	M03-03923	T-27		

RPC-TERRY TERMS AND CONDITIONS

Payment Terms: Net 30 days on approved credit.

Freight: FOB, Rockford, Illinois.

RPC-TERRY Part Numbering: Please provide the complete part number and quantity when entering your order.

Minimum Order Quantity:

Institutional hinges are sold in case quantities only. For Special butt hinge, continuous hinge, shutter hinge or general casework hardware minimums, contact RPC Customer Service.

Minimum Order Amount: \$200.00 or an additional handling fee of \$25.00 will be assessed per order. Minimum order quantities for parts noted as Special will remain in effect. Contact RPC Customer Service for specific details.

Both RPC and Terry part numbers may be combined to reach the \$200.00 minimum order amount.

Order Acceptance: Order acceptance is subject to credit approval.

Return Policy: Buyer's request for return of catalog product must be submitted in writing to Rockford Process Control. A Return Material Authorization (RMA) number will be issued to the Buyer as authorization from RPC to return the product. The RMA number must be referenced on all Buyer's shipping and debit memo documents prior to Buyer's shipment of product to RPC.

For return of saleable catalog product, a minimum restocking charge of 25% of the value of the returned product will apply. Return freight is to be prepaid by the Buyer.

Product that is being returned due to defects in material or workmanship is to be shipped to RPC via best-way surface, freight collect.

Order Cancellations: Order cancellations must be submitted in writing and will be accepted only when reasonable and approved by Rockford Process Control. No cancellations will be accepted prior to 30 days of original ship date.

Pricing: Prices are subject to change without notice.

MEASUREMENT CROSS REFERENCE

Fraction	Inch	Millimeter
1/64	.0156	.3968
1/32	.0312	.7937
3/64	.0468	1.191
1/16	.0625	1.588
5/64	.0781	1.984
3/32	.0937	2.381
7/64	.1093	2.778
1/8	.125	3.175
9/64	.1406	3.572
5/32	.1562	3.969
11/64	.1718	4.366
3/16	.1875	4.763
13/64	.2031	5.159
7/32	.2187	5.556
15/64	.2343	5.953
1/4	.25	6.350
17/64	.2656	6.747
9/32	.2812	7.144
19/64	.2968	7.541
5/16	.3125	7.938
21/64	.3281	8.334
11/32	.3437	8.731
23/64	.3593	9.128
3/8	.375	9.525
25/64	.3906	9.921
13/32	.4062	10.319
27/64	.4218	10.715
7/16	.4375	11.113
29/64	.4531	11.509
15/32	.4687	11.906
31/64	.4844	12.303
1/2	.5	12.700

Fraction	Inch	Millimeter
33/64	.5156	13.097
17/32	.5312	13.494
35/64	.5468	13.891
9/16	.5625	14.288
37/64	.5781	14.684
19/32	.5937	15.081
39/64	.6093	15.478
5/8	.625	15.875
41/64	.6406	16.272
21/32	.6562	16.669
43/64	.6718	17.066
11/16	.6875	17.463
45/64	.7031	17.859
23/32	.7187	18.256
47/64	.7343	18.653
3/4	.75	19.050
49/64	.7656	19.447
25/32	.7812	19.844
51/64	.7968	20.241
13/16	.8125	20.638
53/64	.8281	21.034
27/32	.8437	21.431
55/64	.8593	21.828
7/8	.875	22.225
57/64	.8906	22.622
29/32	.9062	23.019
59/64	.9218	23.416
15/16	.9375	23.813
61/64	.9531	24.209
31/32	.9687	24.606
63/64	.9843	25.003
1	1	25.400

Millimeter to Inch Equivalents			
1	1/32	13.5	17/32
1.5	1/16	14	9/16
2	3/32	15	19/32
3	1/8	16	5/8
4	5/32	17	21/32
5	3/16	17.5	11/16
5.5	7/32	18	23/32
6	1/4	19	3/4
7	9/32	20	25/32
8	5/16	20.5	13/16
9	11/32	21	27/32
9.5	3/8	22	7/8
10	13/32	23	29/32
11	7/16	24	15/16
12	15/32	24.5	31/32
13	1/2	25.4	1

Millimeter to Inch Equivalents			
250	9-7/8	500	19-11/16
270	10-5/8	510	20-1/16
300	11-13/16	512	20-1/8
350	13-3/4	550	21-5/8
400	15-3/4	570	22-7/16
418	16-7/16	582	22-15/16
430	16-15/16	600	23-5/8
440	17-5/1	650	25
450	17-3/4	700	27-9/16
470	18-1/2	750	29-9/16

1 mm = .03937 inches
1 inch = 25.4 mm
1 meter = 3.2809 feet
1 kg = 2.2 lbs.

RPC Custom Manufacturing – Where Solutions Take Shape

Along with hinges, Rockford Process Control is known for our custom manufacturing capability supplying markets including ATV, Motorcycle, Golf Car, Construction Equipment, Seating, School Desk and Chair, Lawn and Garden with precision components manufactured to exacting specifications.



RPC's core strength is the ability to develop manufacturing processes to produce a part, no matter how complex, in order to consistently meet quality expectations as well as your on time delivery requirements.

Our primary manufacturing capabilities are:

- Component Welding
- Robotic Welding
- Tube Fabrication - CNC Bending, Cutting & Notching
- Precision Metal Stamping
- CNC Machining
- In House Powder Coating
- Component Assembly



These processes are supported and fostered by RPC's manufacturing engineering expertise and our dedication to fully understand our customers' needs and to fulfill them.

Recently one of our customers came to us with a safety critical frame component that he had awarded to another supplier but wanted RPC to quote. Our well thought out and planned manufacturing process, and use of a dedicated manufacturing cell, convinced the customer we could meet their exacting component standards and the product start up deadline.



From the time the project was awarded, new capital equipment was purchased, parts were approved by the customer and production was delivered well within the customer's stringent time requirements. We were able to provide the customer with the solution they were looking for and a high level of confidence in RPC's manufacturing capability.



RPC is an ISO 9001:2000 Registered company. Our quality system assures customers of components, which meet their high product quality standards. Our engineering organization is very responsive to and supportive of our customers' needs. RPC engineering capabilities consist of manufacturability analysis, process engineering, VA/VE, prototyping, progressive tool design, and fixture & gage design and build.

Contact us today with your manufacturing project requirements. RPC has the necessary manufacturing and support attributes that you expect of your top performing suppliers.



HINGES & HARDWARE



Wardrobe – Case Systems



Class Room – Westmark Products



Greenbriar Elementary – TMI Systems



Kaiser Permanete – TMI Systems



Lake Jr. High – TMI Systems

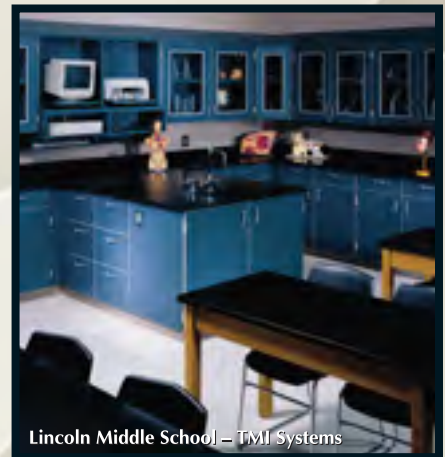

Lincoln Middle School – TMI Systems



2020 Seventh Street
Rockford, IL 61104
Toll Free 800-228-3779
Phone 815-966-2000
Fax 815-966-2026
Customer Service Hours:
7:30 AM - 5:00 PM CST
sales@rockfordprocess.com
www.rockfordprocess.com



TERRY™ is a trademark of Rockford Process Control, Inc. © 2010 Rockford Process Control, Inc.

0510-3K