

CAUTION

Before removing and disassembling valve, make certain there is no pressure in the cylinder. Remove any pressure by depressing the Schrader valve core. If cylinder contains pressure when valve is removed, serious injury could occur.

1. Remove valve from tank.
2. Remove pickup tube from valve body.
3. Clamp Wet Valve Tool (Part No. 550788) in vise, with dual pins in the up position.
4. Remove threaded top valve cap from valve body.
5. Turn valve up side down and position top opening of valve onto wet valve tool. Make certain dual pins on tool are inserted into dual holes in the valve piston.
6. Using a large, flat bladed screwdriver, turn the Cap/Seat Assembly counterclockwise to loosen it from the Stem Assembly.
7. Remove the Valve Stem Assembly from the inside of the valve body.
8. Remove valve body from wet valve tool and, push Valve Stem Molded Assembly from body.
9. Discard all internal components, except piston.
10. Remove O-rings from valve neck thread and valve cap. Discard O-Rings.
11. Carefully clean and dry all internal valve surfaces. Using a small diameter wire (paper clip), make certain vent hole in upper portion of valve body is open. Make certain not to scratch internal valve surfaces.
12. Lubricate the small O-ring on the valve stem assembly with Parker Super Lube or equal and insert valve stem assembly into valve body.
13. Install new spring unto valve stem assembly. Make certain small spring coil is toward seat end of valve stem assembly.
14. Lubricate the piston O-ring with Parker Super Lube or equal and install on piston.
15. Install piston to valve stem by utilizing a flat bladed screwdriver to turn the valve stem assembly while holding the piston in place with the wet valve tool. Tighten securely.
16. Push piston up and down a few times to make certain it moves freely.
17. Lubricate all new O-rings with Parker Super Lube or equal and install on valve cap and valve body. **Note:** Do not apply lubricate to stem seat material.
18. Reinstall valve cap securely to top of valve body.

19. See instructions in the regulator rebuild kit (Part No. 551061) for rebuilding the regulator assembly.
20. When all rebuilding is complete, reinstall pickup tube to valve body, add the required amount of agent, and tighten valve into tank. The tank assembly is now ready to be pressurized.

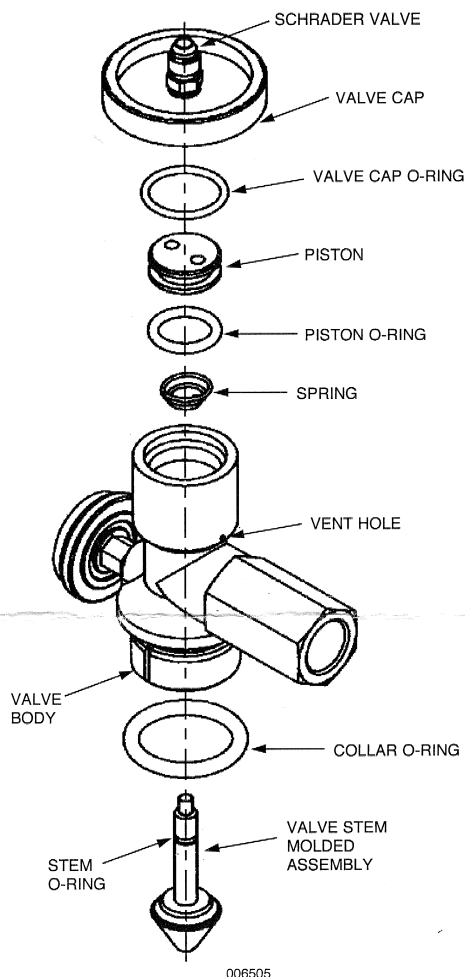

Safety Data Sheets (SDS) are available at www.pyrochem.com

PYRO-CHEM, and the product names listed in this material are marks and/or registered marks. Unauthorized use is strictly prohibited.