

# Pass-thru Window Assembly (PTW-WDF, PTW-WDT, PTW-WDB)

*Sash frame assembly*

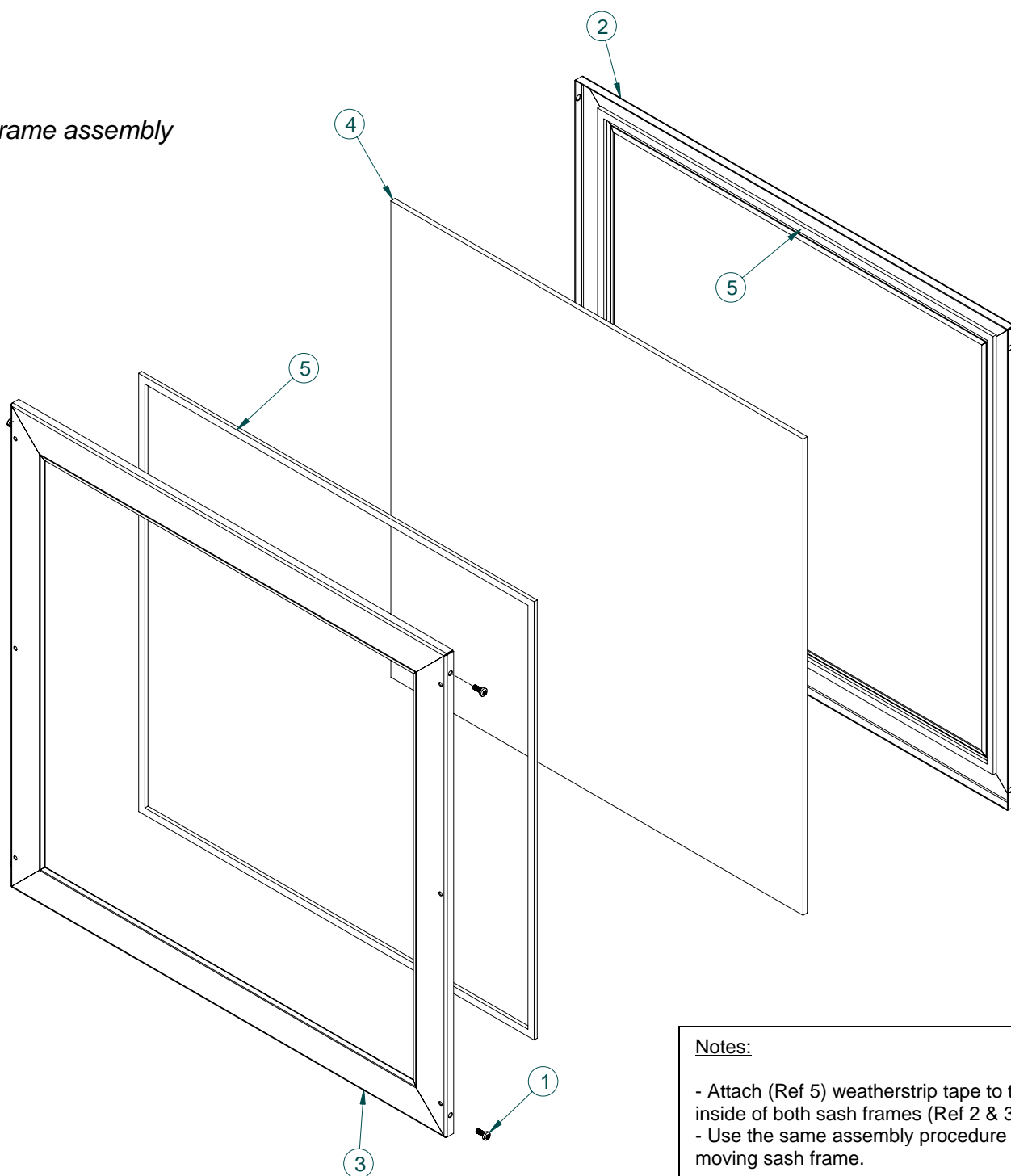

## Notes:

- Attach (Ref 5) weatherstrip tape to the inside of both sash frames (Ref 2 & 3).
- Use the same assembly procedure for the moving sash frame.

Ref	Part No.	Description	Qty	Material
1	91772A829	#10-32 x 0.5 Pan head machine screw	4	stainless steel
2	PTW-027	Fixed sash frame - B	1	stainless steel
3	PTW-022	Fixed sash frame - A	1	stainless steel
4	PTW-019r2	Glass pane	1	1/4" tempered glass
5	50561	Weatherstrip tape	2	Foam

### Moving sash frame w/ spiral balance

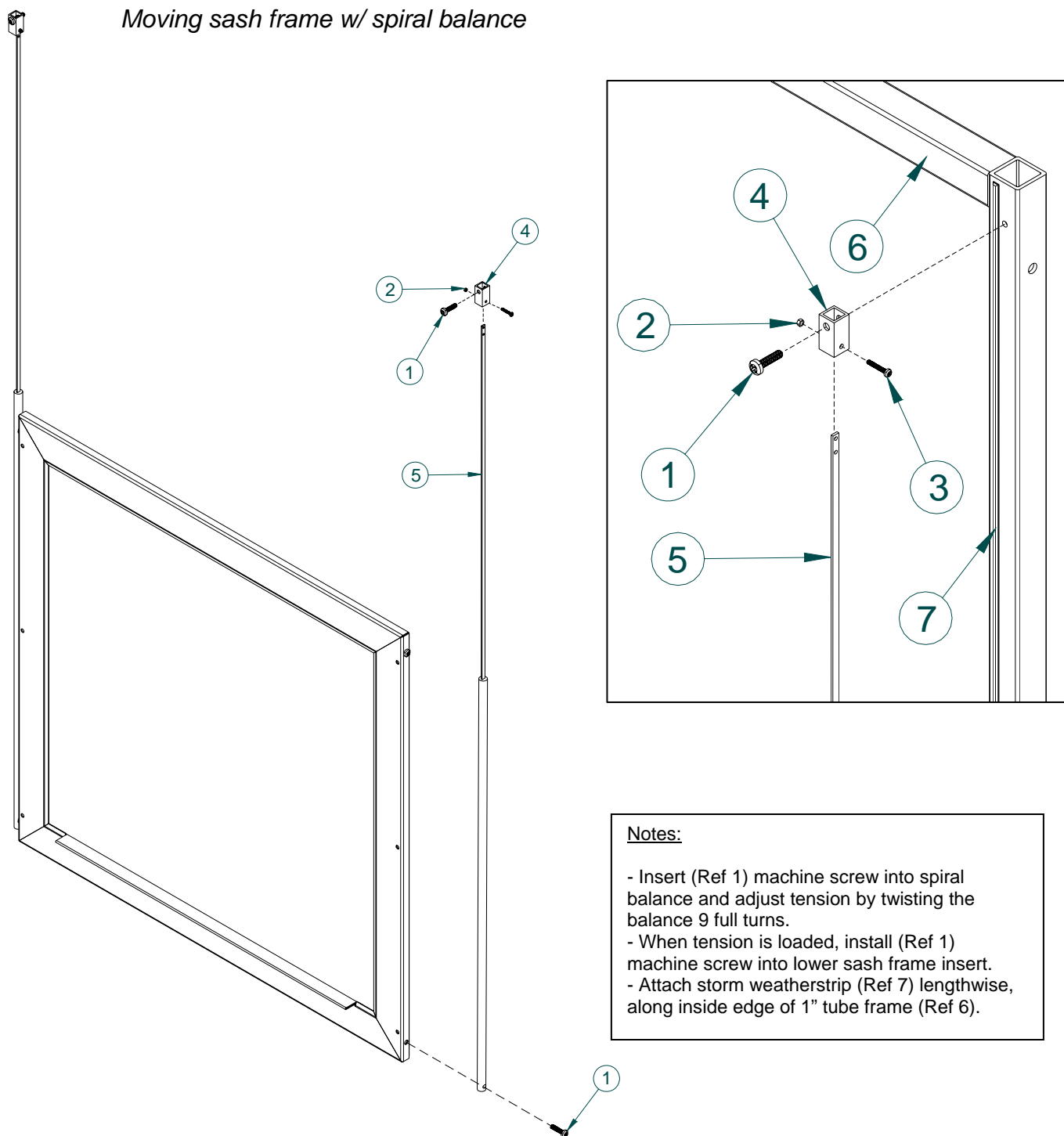

#### Notes:

- Insert (Ref 1) machine screw into spiral balance and adjust tension by twisting the balance 9 full turns.
- When tension is loaded, install (Ref 1) machine screw into lower sash frame insert.
- Attach storm weatherstrip (Ref 7) lengthwise, along inside edge of 1" tube frame (Ref 6).

Ref.	Part No.	Description	Qty.	Material
1	91772A831	#10-32 x 0.75 Pan head machine screw	2	stainless steel
2	91828A113	M2.5 Hex nut	2	stainless steel
3	92000A109	M2.5 x 16 Pan head machine screw	2	stainless steel
4	PTW-034	Balance attachment block	2	stainless steel
5	FBH38R24W	3/8" x 24" Spiral Balance	2	steel
6	PTW-001	1" tube frame for pass thru window	1	stainless steel
7	4267	Storm weatherstrip	2	woven pile

## Attaching fixed sash assembly to channel

### Notes:

- Make sure the holes on (Ref 2) fixed sash channel are facing the front face of the window frame (Ref 4).
- Attach fixed sash channel (Ref 2) by riveting it through the outer side of the window frame (Ref 4).

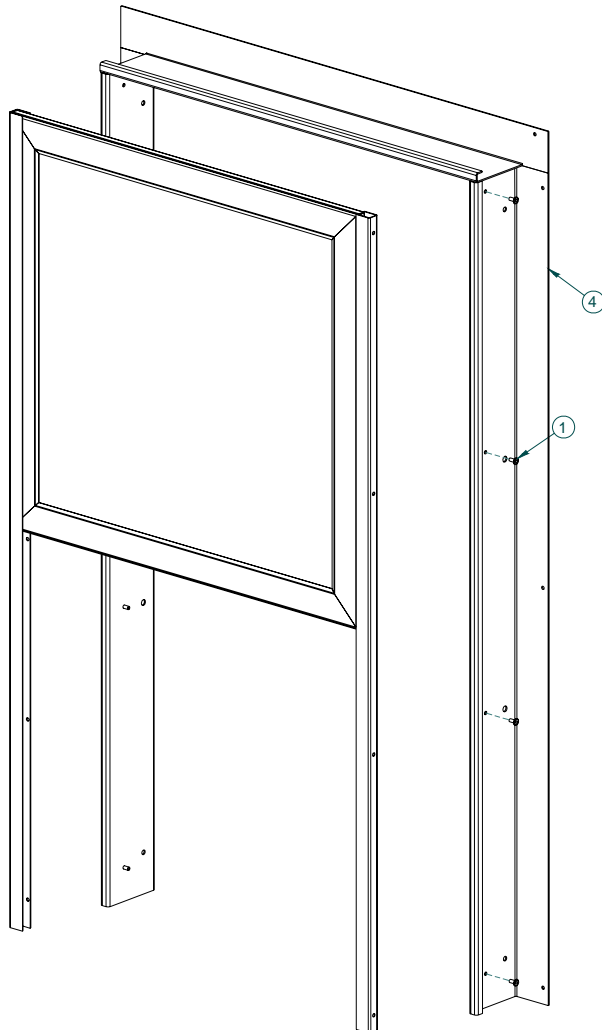
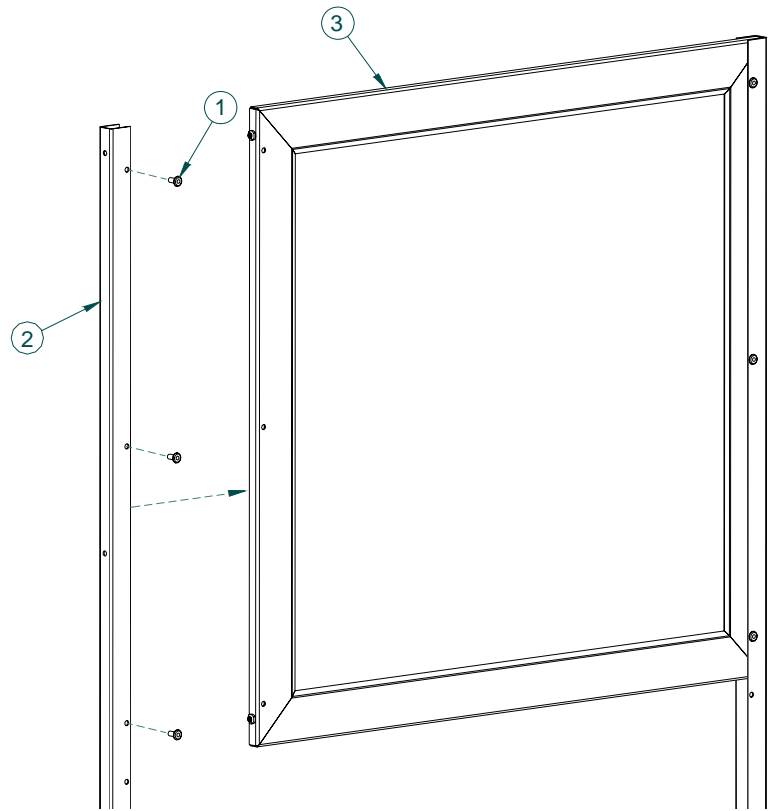

Ref	Part No.	Description	Qty	Material
1	97525A485	3/16" x 0.3" Blind Rivet	14	stainless steel
2	PTW-012r2	Fixed Sash Channel	2	stainless steel
3	N/A	Fixed Sash Assembly	1	multiple
4	PTW-005	Window Frame Assembly	1	stainless steel

## Attaching fixed sash channel to window frame

Ref	Part No.	Description	Qty	Material
1	PTW-005	Window Frame Assembly	1	stainless steel
2	PTW-001	1" Tube Frame for pass thru window	1	stainless steel
3	91771A544	0.25-20 x 1.25 Flat head machine screw	4	stainless steel

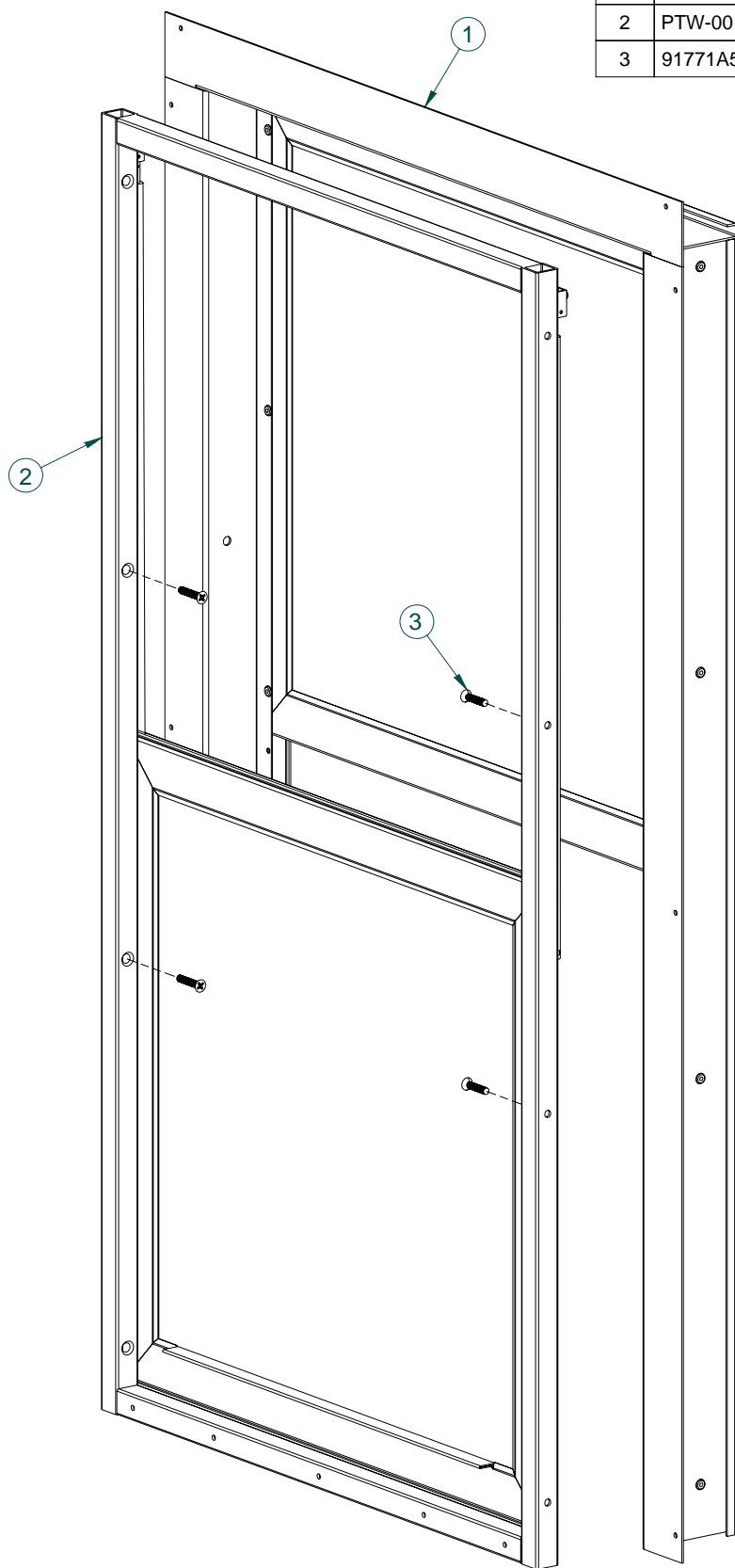

*Attaching 1" tube to window frame.*

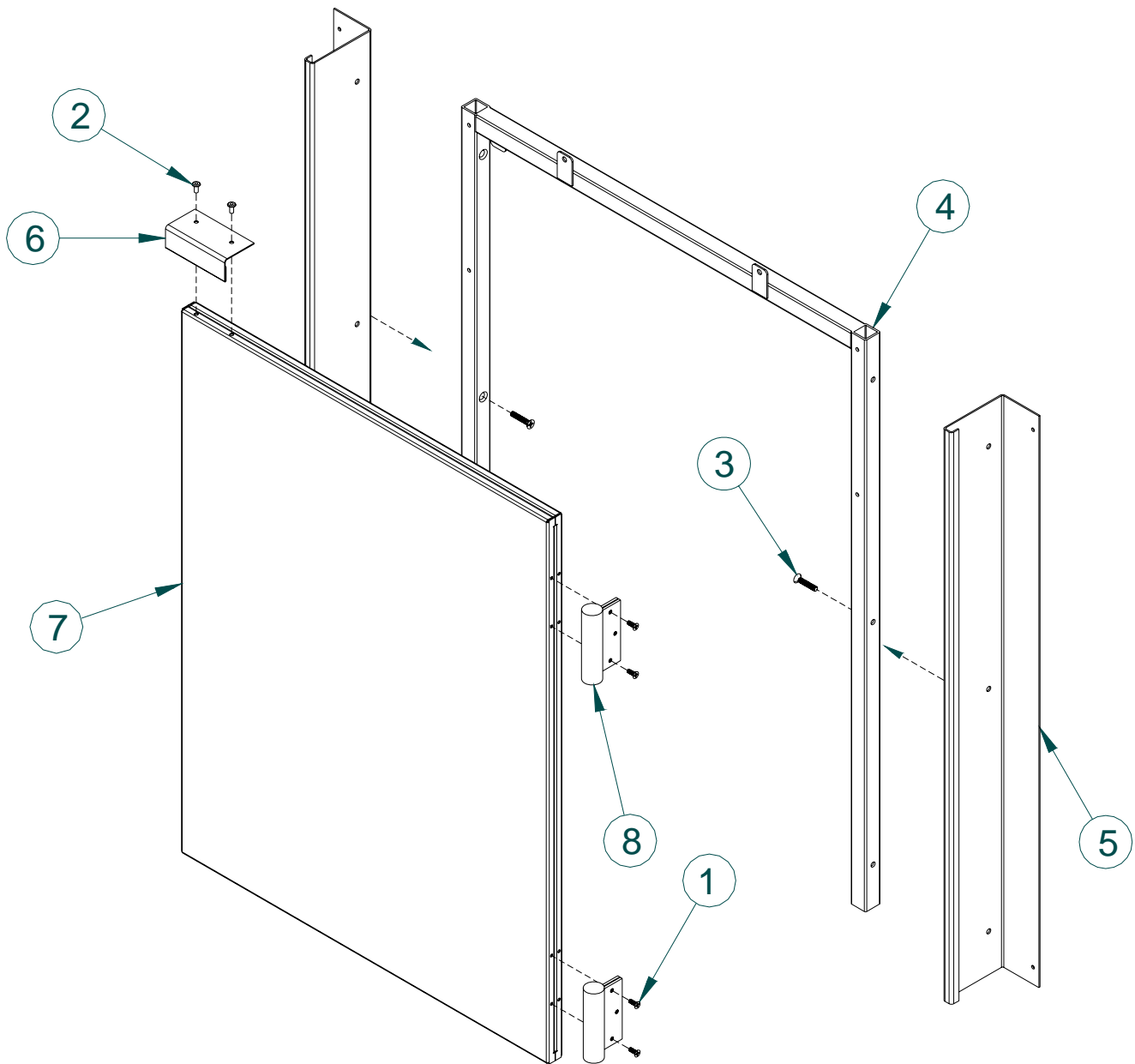

Ref	Part No.	Description	Qty	Material
1	91771A829	#10-32 x 0.5 Flat head machine screw	10	stainless steel
2	97525A485	3/16" x 0.3" Blind Rivet	2	stainless steel
3	91771A544	0.25-20 x 1.25 Flat head machine screw	2	stainless steel
4	PTW-002r3	1" Tube Frame for Pass-thru Door	1	stainless steel
5	PTW-007r2	Door Frame Upright	2	stainless steel
6	PTW-030	Door handle	1	stainless steel
7	PTW-017r2	Door half assembly	1	stainless steel
8	8401A73	Self closing spring loaded hinge	2	stainless steel