

LOCKING SLIDE BOLTS

74

4" Locking Neck Bolt

Smaller 4" version of model 79 bolt. 4" locking neck bolt complete with two types of strikes and fasteners. Laminated bolt has a full 1-1/8" throw and can be locked in the open or closed position. Offset of neck bolt is 3/4". Base size is 2" x 4-1/2". Will accept padlocks with shackles up to 1/4" diameter. Steel body is zinc plated.

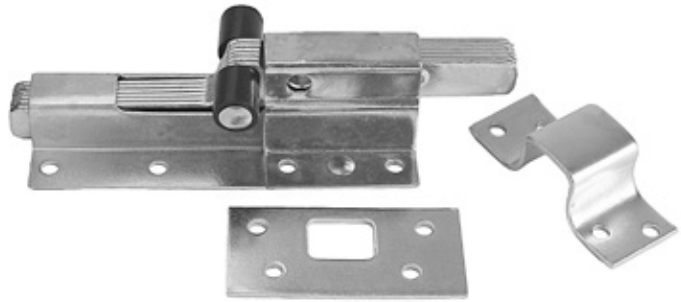

76

6" Locking Surface Bolt

6" locking surface bolt complete with two types of strikes and fasteners. Laminated bolt has a full 1-1/8" throw and can be locked in the open or closed position. Base size is 2" x 5-1/2". Will accept padlocks with shackles up to 11/32" diameter. Steel body is zinc plated.

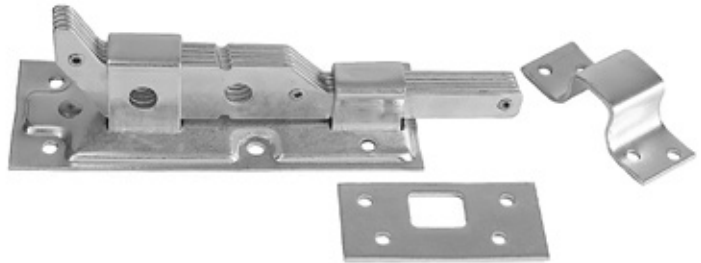

79

9" Locking Neck Bolt

Large 9" locking neck bolt complete with two types of strikes and fasteners. Laminated bolt has a full 1-1/2" throw and can be locked in the open or closed position. Offset of neck bolt is 1-1/4". Base size is 2-3/4" x 9". Will accept padlocks with shackles up to 7/16" diameter. Steel body is zinc plated.

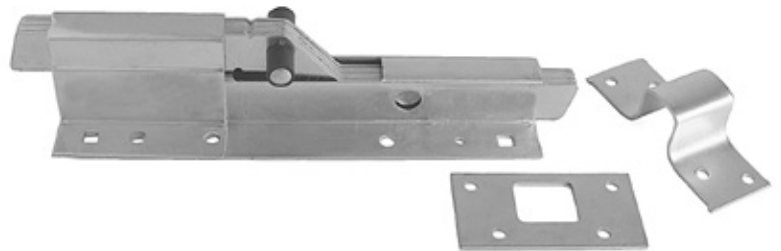

For new product updates and the latest up to the minute information, please sign up for e-mail bulletins at www.majormfg.com.