

4600 Series

NARROW STILE HEAVY DUTY COMMERCIAL APPLICATION



The Hager 4600 Series is designed and engineered to provide a lifetime of superior performance on narrow stile doors (2-inch minimum) in heavy duty commercial applications. The 4600 Series design complements aluminum and glass construction and provides excellent durability for a range of applications. Properly applied and maintained Hager 4600 Series Exit Devices and Trim are backed by a lifetime warranty, providing peace of mind from distributor to building owner. Go to www.hagerco.com for specific warranty conditions.

Hager 4600 Series Exit Devices are BHMA certified Grade 1 and meet Life Safety codes and Fire Safety requirements.

Extruded aluminum construction, stainless steel push bar covers, die cast caps and covers, and dead locking stainless steel Pullman type latchbolts provide premium security and performance at value pricing.





4600 SERIES - COMPLIANCE AND CERTIFICATIONS

4600 SERIES DEVICES

BHMA Certified ANSI A156.3 Grade 1



UL305 Listed for Panic Hardware



UL10C Positive Pressure Rated



UL10B Neutral Pressure Rated



Complies with ANSI A117.1 for Accessible Buildings and Facilities



4600 SERIES FIRE-RATED DEVICES

UL/cUL Listed for "A" Label Door Up to and Including 3 hours on 4' x 8' doors

Rim with Fire-rated Removable Mullion 4900UF UL/cUL Listed and Warnock Hersey Listed for "A" Label Door Up to and Including 3 hours on 8' x 8' doors





4600 SERIES - GENERAL INFORMATION

Installation Made Easy

For the convenience of our customers, Hager Companies introduced several key features to the exit device market.

- Thru-bolts are included with every model. Wood and machine screws are also provided standard in every package.
- Slotted strikes speed up installation, allowing the installer to make easy adjustments to align the latch to the strike.
- Non-handed device offers added versatility and means less inventory.
- Escutcheon trim is surface mounted with the locking mechanism built inside, reducing door preparation and installation time by requiring fewer holes in the door.

Shim Kits

Shim kits are available for devices on doors with glass bead kits or other interfacing moldings. Each kit contains two 1/8" (3.2 mm) shims and the appropriate longer fasteners.

Dogging

Cylinder dogging or less dogging are available to replace the standard hex key dogging on panic exit devices. For less dogging, specify LD on order. For cylinder dogging, specify CD on order or purchase 4926 for retrofit applications. Unit requires 1-1/8" (29 mm) mortise cylinder (part number 3902) with standard cam.

Sizing

The exit device is cut for 36" (914 mm) and 48" (1219 mm) wide doors. For other door widths, cut exit device to appropriate length. Recommended overall length of exit device is equal to the door width minus four inches.

Trim Functions	Part Number	Function Description	ANSI Number
Blank Escutcheon	46BE	Always operable (Passage)	14
Cylinder Escutcheon	46CE	Key locks or unlocks lever	08
Dummy	46DT	Pull when device is dogged down	02
Night Latch	46NL	Key retracts latchbolt	03
Night Lever	46NK	Key releases lever; trim locked when key removed	09

Applications

Single Door Panic Exit Hardware - Blade Stop Strike (4950) and Frame

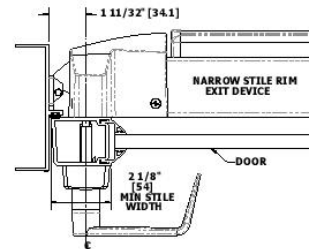

Single or Double Door with Panic Exit Hardware - Standard Strike (4920) and Frame

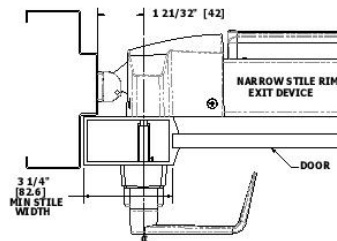

Single or Double Door with Panic Exit Hardware - Standard Strike (4920) and Mullion

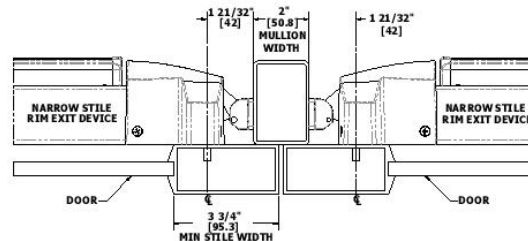

Single or Double Door with Panic Exit Hardware - Semi-Rush Mount Strike (4952) and Mullion

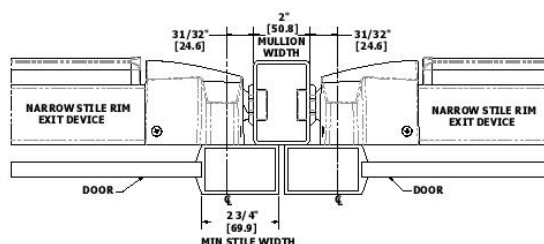



4600 SERIES - DEVICE PROFILE

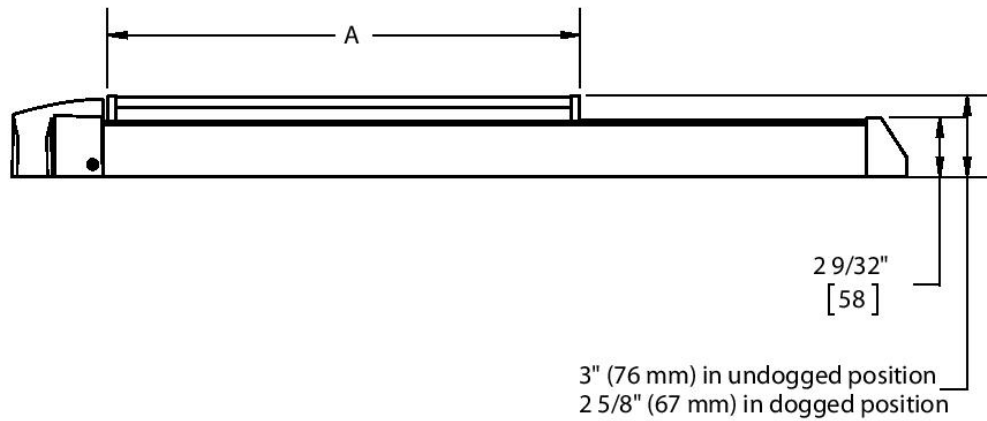
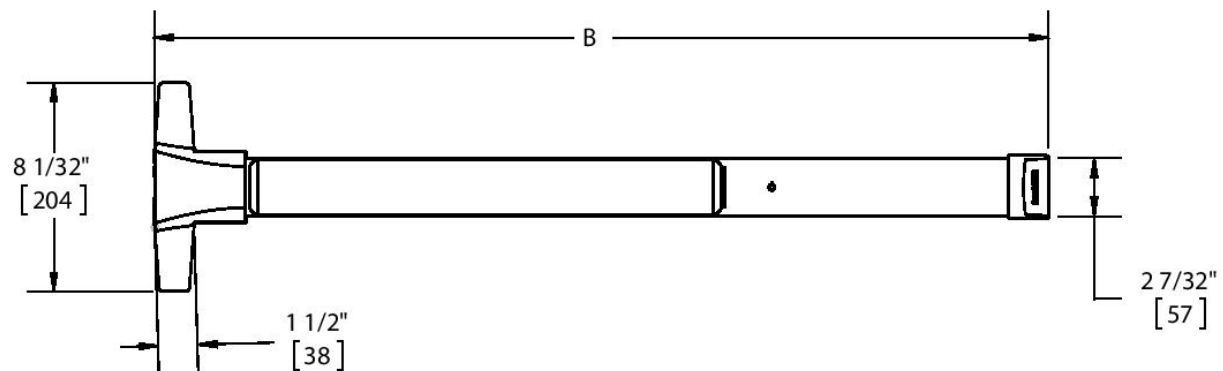

4600 SERIES	A	B
4600 PANIC -36"	$18 \frac{5}{32}$ " (461mm)	$34 \frac{3}{8}$ " (873mm)
4600 FIRE -36"		
4600 PANIC -48"	24" (609mm)	$45 \frac{13}{64}$ " (1148mm)
4600 FIRE -48"		





4600 SERIES - HOW TO ORDER

4600 SERIES EXIT DEVICE

4601	RIM	F	36"	US3	1-3/4"	ELR
Product Group 4600 Series, Grade 1	Type RIM - Rim Device	Rating F - Fire Rated O - Non-Fire Rated C - Cylinder Dogging L - Less Dogging	Size 36" 48"	Finish US3 US4 US10 US10B US26 US26D US32D	Door Thickness 1-5/8" 1-3/4" 2" 2-1/2" 3"	Electric Modifications ALK - Alarm Kit ALL - Alarm Kit w/ Tamper Switch and Latch Monitor ALM - Alarm Kit w/ Latch Monitor ALT - Alarm Kit w/ Tamper Switch ED - Electric Dogging EDRX - Electric Dogging w/ Request to Exit ELR - Electric Latch Retraction ELRX - Electric Latch Retraction w/ Request to Exit LM - Latchbolt Monitor RX - Request to Exit RX2 - Dual Request to Exit RXLM - Request to Exit w/ Latchbolt Monitor MLR - Motor Driven Electric Latch Retraction MLRX - Motor Driven Electric Latch Retraction w/ Request to Exit

4600 SERIES TRIM

46	CE	ARC	US3	1-3/4"	TW
Product Group 46 - 4600 Series, Grade 1	Trim/Function BE - Blank Escutcheon Function 14, always operable CE - Cylinder Escutcheon Function 08, key locks/unlocks lever DT - Dummy Trim Function 02, pull when dogged down NL - Night Latch (Not available for 3" door) Function 03, key retracts latchbolt (for use with 4600 Rim Device only) NK - Night Lever, Function 09, key releases lever, lever locked when key is removed	Lever Style ARC - Archer AUG - August WLM - William WTN - Withnell	Finish US3 US4 US10 US10B US26 US26D	Door Thickness 1-5/8" 1-3/4" 2" 2-1/2" 3"	Options TW - Tactile Warning A - Antimicrobial Coating

Notes:

1. Mortise cylinder 3902 with 3976 L cam is required for use with cylinder escutcheon trim and is sold separately.
2. Rim cylinder 3901 with long tailpiece is required for use with night latch trim and is sold separately.
3. For more cylinder information, please refer to Cylinder, Core & Keying in the Locks section of the catalog.
4. If using shim kit, specify total door thickness including shims.



4600 SERIES - GRADE 1 NARROW STILE RIM DEVICE

WARRANTY

Lifetime warranty

FEATURES

Certification:	BHMA Certified Grade 1 and meets life safety codes and fire-safety requirements. See page 32 for details and options.
Covers:	Stainless steel, zinc
Cover Tube:	Aluminum
Dogging:	<ul style="list-style-type: none">• Hex key dogging standard on panic-rated devices• Less dogging available on panic-rated devices, specify LD• Cylinder dogging available on panic-rated devices, specify CD 3902 1-1/8" (29 mm) mortise cylinder with standard cam sold separately
End Caps:	<ul style="list-style-type: none">• Zinc• Flush end cap option available
Fasteners:	<ul style="list-style-type: none">• Wood and machine screws• Thru-bolts supplied standard
Latchbolt:	3/4" (19 mm) throw, pullman type with automatic dead-latching, stainless steel
Strikes:	<ul style="list-style-type: none">• Blade stop (4950) - Standard with panic device• Fire-rated strike (4920F) - Standard with fire-rated device• Standard strike (4920) - Optional• Single rabbit strike (4951) - Optional• Semi-flush mount strike (4952) - Optional



SPECIFICATIONS

Door Thickness:	1-3/4" (44 mm) - Standard up to 3", except with night latch (NL) which is 2-1/2"
Door Width:	<ul style="list-style-type: none">• 36" (914 mm) field sizeable to 30" (762 mm) panic-rated door and 28" (711 mm) fire-rated door• 48" (1219 mm) field sizeable to 36" (914 mm) panic- or fire-rated door
Projection:	<ul style="list-style-type: none">• 3" (76 mm) in undogged position• 2-5/8" (67 mm) in dogged position
Stile Width:	<ul style="list-style-type: none">• 2-1/8" (54 mm) - Minimum stile width required for 1/2" (13 mm) blade stop frame and 4950 blade stop strike• 3-1/4" (83 mm) - Minimum stile width required for single door, 5/8" (16 mm) stop and 4920 standard strike• 3-3/4" (95 mm) - Minimum stile width required for double door x mullion x 4920 strike• 2-3/4" (70 mm) - Minimum stile width required for double doors with 2" (51 mm) mullion and 4952 semi-flush mount strike• All stile widths are measured from door edge
Notes:	Recommended for use on appropriately reinforced doors

TRIM

- 4600 Series escutcheon trim for rim device is surface mounted with a variety of lever options (p. 41)
- Rim cylinder x optional pull

FINISHES

- US3, US4, US10, US10B, US26, US26D, US32D
- Trim not available in US32D





4600 SERIES - GRADE 1 NARROW STILE RIM DEVICE - ELECTRIFIED

WARRANTY

- One-year on electrified components
- Lifetime on hardware components

FEATURES

Same as 4600 Series Narrow Stile Rim Device



SPECIFICATIONS

Door Width:

- 36" (914 mm) field sizeable to 30" (762 mm) panic-rated door and 28" (711 mm) fire-rated door for devices with any monitoring switches
- 48" (1219 mm) field sizeable to 36" (914 mm) panic- or fire-rated door for devices with any monitoring switches
- 36" field sizeable to 34" door minimum for devices with motorized electric latch retraction or delayed egress
- 36" door minimum for devices with solenoid electric latch retraction, electric dogging, or alarm kit
- 48" field sizeable to 42" door minimum for devices with solenoid electric latch retraction, electric dogging or alarm kit
- 48" field sizeable to 40" door minimum with motorized electric latch retraction or delayed egress

FUNCTIONS

- ELR - Electric Latch Retraction
- ED - Electric Dogging
- RX - Request to Exit (field installation kit 2-649-5001)
- RX2 - Dual Request to Exit
- ELRX - Electric Latch Retraction with Request to Exit
- EDRX - Electric Dogging with Request to Exit
- ALK - Alarm Kit (kit 4941, tamper switch 2-649-1090)
- LM - Latchbolt Monitor (2-649-0168)
- RXLM - Request to Exit with Latchbolt Monitor
- MLR - Motor Driven Electric Latch Retraction (field installation kit 2-649-5007)
- MLRX - Motor Driven Electric Latch Retraction with Request to Exit
- DE - Delayed Egress (must order with wall mount controller 2-679-0630 separately)

Electrical Specifications and Wire Requirements - See 4600 Series Electric Modifications page 39.



4600 SERIES - 4941 ALARM KIT

WARRANTY

- One-year on electrified components
- Lifetime on hardware components

SPECIFICATIONS

Battery:	<ul style="list-style-type: none">• Standard 9-Volt battery required• Audible chirp and alternating LED color flash when battery is low
Alarm:	100 decibel horn sounds immediately upon pressing push pad
Cylinder:	<ul style="list-style-type: none">• 1-1/8" or 1-1/4" Mortise cylinders acceptable• Hager standard cam required• Cylinder sold separately
Activation:	<ul style="list-style-type: none">• Alarm is armed by turning key clockwise• Alarm is disarmed by turning the key counter-clockwise• Alarm is turned to service mode by turning the key counter-clockwise twice
Alarm Timing:	<ul style="list-style-type: none">• Alarm will sound for either 1, 3, 5 minutes or continuously• Times are selectable by on board switches
Warning Decal:	"Emergency Exit Only – Alarm Will Sound" on push pad of exit device
Indicator:	<ul style="list-style-type: none">• LED Indicator• Red LED will illuminate intermittently when armed• Green LED will illuminate when unarmed• Blue LED will illuminate in service mode• Alternate colors flash when battery is low
Options:	<ul style="list-style-type: none">• Tamper Switch available that sounds alarm when end cap is removed• Latch monitor switch is available that sounds alarm when latch is retracted without actuating the push pad• Latch Monitor Switch typically used with Surface Vertical Rod devices• When utilizing the latch monitor, the outside trim unit will also sound alarm
Output:	Alarm is equipped with output port





4600 SERIES - ELECTRIC MODIFICATIONS

FUNCTION	#	DESCRIPTION
Electric Latch Retraction - Solenoid	ELR	Provides the means of locking or unlocking exit devices remotely. Requires the use of Hager 2901 or 2902 power supply or warranty voided. <i>Note: Mortise Exits require Motor Driven Latch Retraction (MLR).</i>
Electric Dogging	ED	Provides continuous latch retraction and dogging simultaneously.
Request to Exit	RX	Used to shunt an alarm, activate an alarm, provide release of magnetic locks, or signal a console.
Electric Latch Retraction with Request to Exit	ELRX	Provides the means of locking or unlocking exit devices remotely, along with an SPDT switch. Requires the use of Hager 2901 or 2902 power supply or warranty voided. <i>Note: Mortise Exits will require Motor Driven Latch Retraction.</i>
Electric Dogging with Request to Exit	EDRX	Provides continuous latch retraction and dogging simultaneously along with an SPDT switch.
Dual Request to Exit	RX2	Features two SPDT switches
Latchbolt Monitoring	LM	An internal SPDT switch that monitors the latchbolt to signal both egress and access of an opening.
Latchbolt Monitoring/Request to Exit	RXLM	Two internal SPDT switches that monitor the latchbolt and the pushbar simultaneously.
Delayed Egress	DE	Delays egress for 15 or 30 seconds when unauthorized egress is initiated. Wall mount controller (2-679-0630) provides digital countdown display with verbal instructions or alarm tone only and must be ordered separately.
Motor Driven Electric Latch Retraction	MLR	Provides the means of locking or unlocking exit devices remotely using an electric motor. Recommend Hager 2903 or 2904 Power Supply.
Motor Driven Electric Latch Retraction with Request to Exit	MLRX	Provides the means of locking or unlocking exit devices remotely using an electric motor, along with an SPDT switch. Recommend Hager 2903 or 2904 Power Supply.

ELECTRICAL SPECIFICATION/RATINGS AND WIRE REQUIREMENTS

Electrical
Specifications/
Ratings:

- ED; .225 AMP @ 24 Volt +/- 2V
- RX or LM; 125 VAC (3 AMP current); 30 VDC (2 AMP current)
- ELR; Requires 2901/2902 power supply
- MLR; 1 AMP in rush @ 24 VDC +/- 2V, 400 mA holding

Wire
Requirements:

- Status switches (i.e. RX, LM, etc.) require 2 wires per switch to monitor a normally open (NO) or normally closed (NC) position
- All devices provide 3 wires per switch so both NO and NC positions can be monitored
- Monitoring both positions will require 3 wires per switch

QUICK CONNECT

Available on ED, ELR, LM, MLR, and RX

POWER SUPPLIES

PRODUCT #	DESCRIPTION
2901	For use with 4500/4600 Series electric latch retraction (ELR)
2902	For use with 4500/4600 Series electric latch retraction in a day/night mode of operation (ELR)
2903	Provides 24 Volt DC power for Fail Safe or Fail Secure locking devices and interface with building alarm controls, card readers, keypads, and other door controls
2904	Provides 24 Volt DC power and control for openings with an electrified locking device and automatic door operator
2908	Provides up to 1 amp of 12 or 24 Volt DC power - modular
2909	Provides up to 2 amps of 12 or 24 Volt DC power - modular

ALARMED DEVICES - SPECIFY WHEN ORDERING: (Note: Alarm kit components may be purchased separately)

ALK - Alarm Kit

ALM - ALK with Latch Monitor Switch

ALT - ALK with Tamper Switch

ALL - ALK with Latch Monitor and Tamper Switch



4600 SERIES - ESCUTCHEON TRIM

WARRANTY	Lifetime on hardware components
SPECIFICATIONS	
Escutcheon:	1-11/16" x 7-7/8" (43 mm x 200 mm)
LEVERS	Archer, August, William or Withnell Levers
FINISHES	US3, US4, US10, US10B, US26, US26D (Not Available in US32D)



46BE

Blank Escutcheon

ANSI Function: 14 - Always operable (passage)



46CE

Cylinder Escutcheon

ANSI Function: 08 - Key locks or unlocks lever

Cylinder: Requires 3902 mortise cylinder with 3976 L cam (sold separately)



46DT

Dummy Trim

ANSI Function: 02 - Pull when device is dogged down



46NK

Night Lever

ANSI Function: 09 - Key locks or unlocks lever. Lever is locked when key is removed.

Cylinder: Requires 3902 mortise cylinder, with 3976 L cam (sold separately)



46NL

Night Latch

ANSI Function: 03 - Key retracts latchbolt

Cylinder: Requires 3901 rim cylinder with long tailpiece (sold separately)

Notes: Maximum door thickness compatibility is 2-1/2" (38 mm)



RIM Cylinder by Optional Pull

ANSI Function: 03 - Key retracts latchbolt

Finishes: US3, US4, US10, US10B, US26, US26D, US32D

Cylinder: Requires 3901 rim cylinder (sold separately). Standard (attached) and long tailpieces in every box.

Notes:

- For use with 4600 RIM
- For pull options see Trim & Auxiliary section





4600 SERIES - ESCUTCHEON TRIM - LEVER OPTIONS

ARCHER LEVER

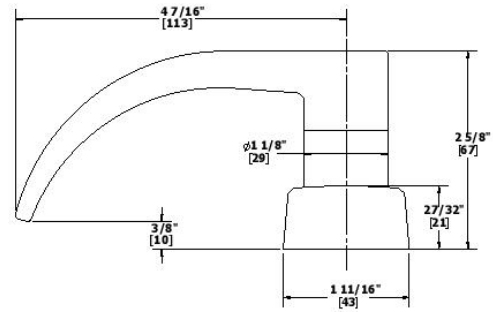

AUGUST LEVER

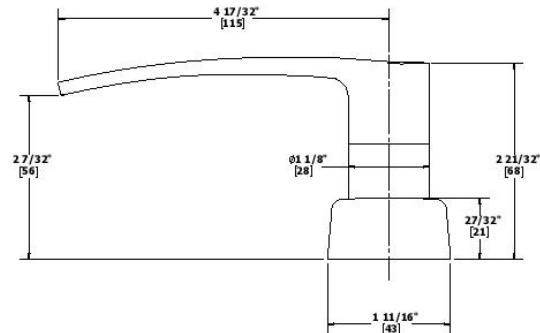

WILLIAM LEVER

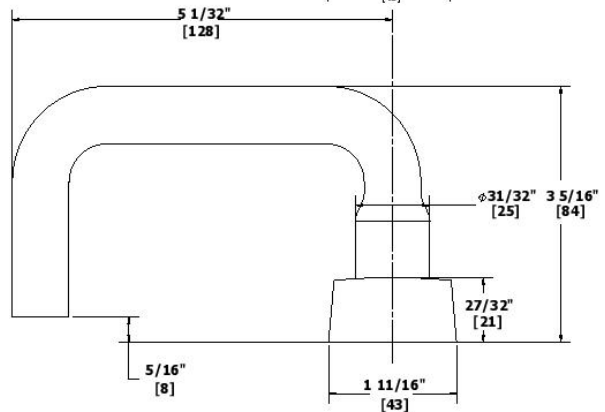

WITHNELL LEVER

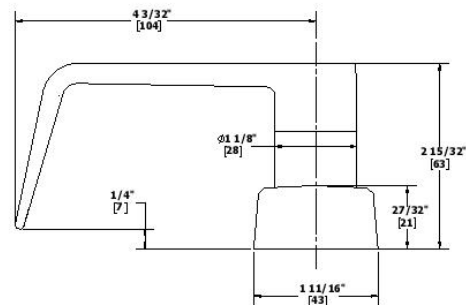



4600 SERIES - STRIKES

4600 SERIES - ACCESSORIES



4920 Strike

Optional strike to be used with 4600 Series Rim exit device; not for fire-rated doors

Finishes: US32D
Notes: For standard surface mounted applications



4920F Fire-rated Strike

Included standard with 4600 Series Fire-rated Rim exit device

Finishes: US32D
Notes: For standard surface mounted applications



4950 Blade Stop Strike

Included standard with 4600 Series Rim exit device; not for fire-rated doors

Finishes: US32D



4951 Single Rabbit Strike

Optional strike to be used with 4600 Series Rim exit device; not for fire-rated doors

Finishes: US32D



4952 Semi-Flush Mount Strike

Optional strike to be used with 4600 Series Rim exit device; not for fire-rated doors

Finishes: US32D



2-649-0250/2-649-0257 Photoluminescent

Push bar cover option for 4500 & 4600 Series exit devices

Description: 2-649-0250 - 4500/4600 36"
2-649-0275 - 4500/4600 48"
Features:
• Requires no wiring or maintenance
• Recharges with exposure to ambient light



4925R Cylinder Dogging Conversion Kit

Finishes: US3, US4, US10, US10B, US26, US26D, US32D

Packaging: One (1) each dogging plate, cylinder collar, cash box nut

Notes:
• Mortise cylinder 3902 with standard cam, sold separately
• Specify 36" (914 mm) or 48" (1219 mm)



4960R Shim Kit

To be used with 4600 Series Rim exit device where a glass bead kit would interfere with exit device

Finishes: US3, US4, US10, US10B, US26, US26D, US32D

Packaging: Two (2) each 1/8" (3 mm) shims and appropriate fasteners



4965 Head Cover

For use with 4600 Series Rim exit device

Finishes: US3, US4, US10, US10B, US26, US26D, US32D

Packaging: One (1) head cover and four (4) each M4 x 6mm MS

END CAPS



Standard



Flush

For use with all 4500 and 4600 Series exit devices

Packaging: One (1) each cap and bracket plus fasteners

Finishes:

	Standard	Flush
US3	(2-649-0038)	(2-649-0218)
US4	(2-649-0039)	(2-649-0220)
US10	(2-649-0040)	(2-649-0214)
US10B	(2-649-0041)	(2-649-0215)
US26	(2-649-0042)	(2-649-0216)
US26D	(2-649-0043)	(2-649-0217)
US32D	(2-649-0044)	(2-649-0219)

