



## THRESHOLDS & WEATHERSTRIPPING

### ASTRAGALS/MEETING STILES

Fire labeled Astragals & Meeting Stiles should only be mounted on pairs of doors with a gap that meets NFPA 80 2-3.1.7 ( $1/8"$   $\pm$   $1/16"$  for steel doors and not exceeding  $1/8"$  for wood doors)

Fasteners: #6 x 5/8" Pan head sheet metal screws

Notes:

- MIL finish weatherstripping is supplied with zinc plated screws
- Brass weatherstripping is supplied with brass screws
- Color anodized weatherstripping is supplied with screws plated to match
- Stainless steel weatherstripping is supplied with stainless steel screws

### 756S

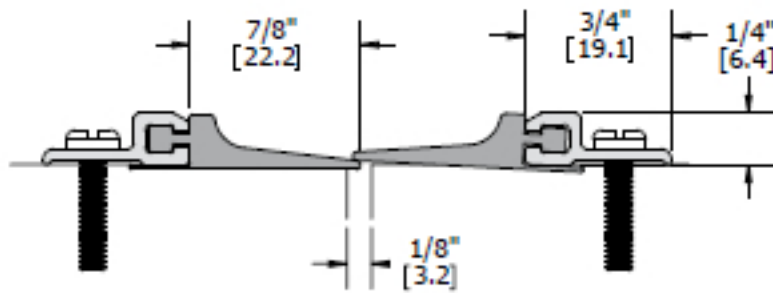

Finishes: MIL, DBA, GLD

Inserts: V

Category: H, J

Certifications:



Notes:

Order two (2) for a set

### 771S

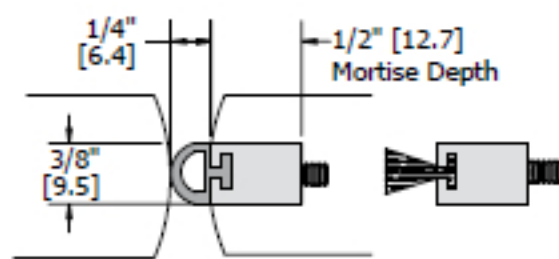

Finishes: MIL, DBA

Inserts: V, W, N, S

Category: J

Certifications:



Notes:

Order two (2) for a set

### 772S



Finishes:

MIL, DBA, GLD

Inserts:

V, W, N, S

Category:

J

Certifications:



### 774S

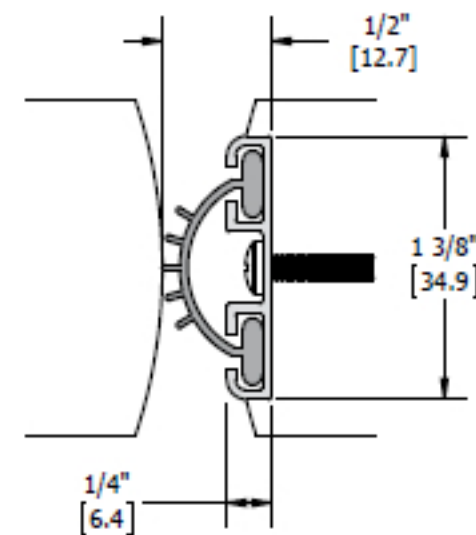

Finishes:

MIL, DBA

Inserts:

V, N

Category:

H, J

Certifications:



### 775S

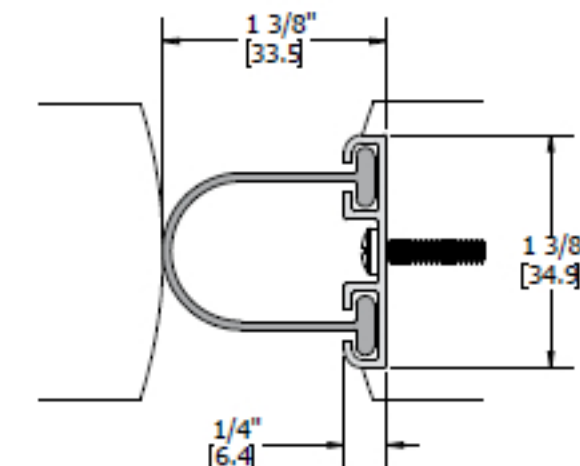

Finishes:

MIL, DBA

Inserts:

V

Category:

H, J

Certifications:





## ASTRAGALS/MEETING STILES (CONTINUED)

### 776S

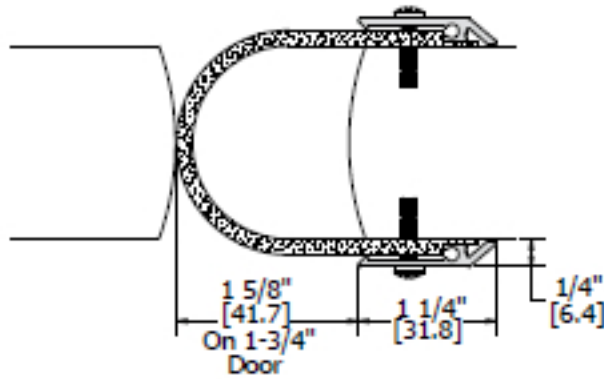

Finishes: DBA, GLD, CLR  
 Inserts: N  
 Category: H, J  
 Certifications:

### 836S

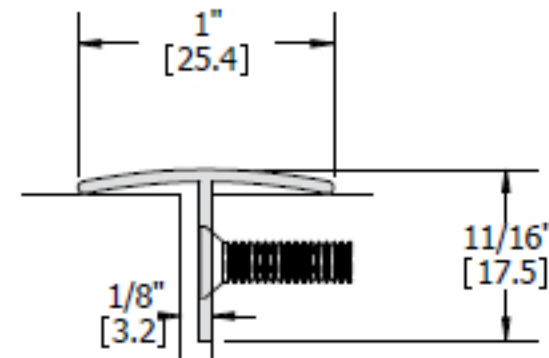

Finishes: MIL, DBA, GLD  
 Category: H, J  
 Certifications:

### 802S

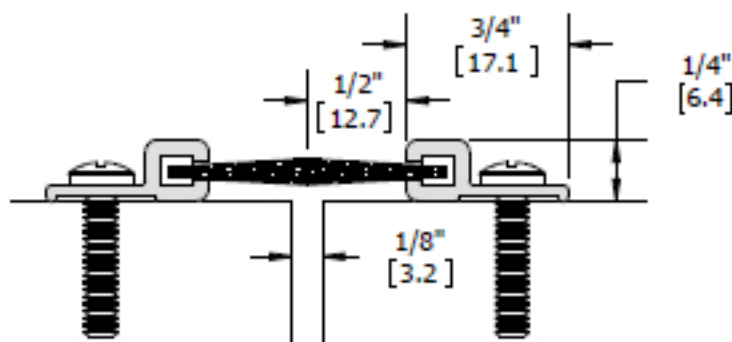

Finishes: MIL, DBA, GLD  
 Inserts: B  
 Category: H, J  
 Certifications:

Notes: Order two (2) for a set

### 837S

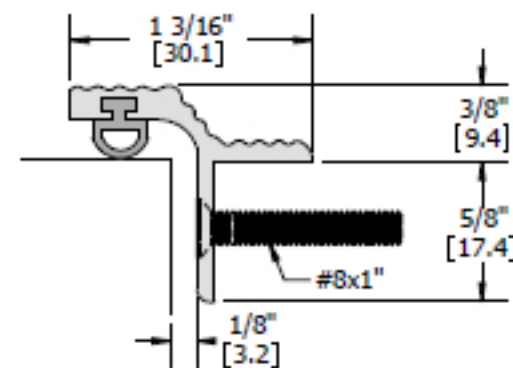

Finishes: MIL, DBA, GLD  
 Inserts: W, V, N, S  
 Category: H, J  
 Certifications:

### 835S

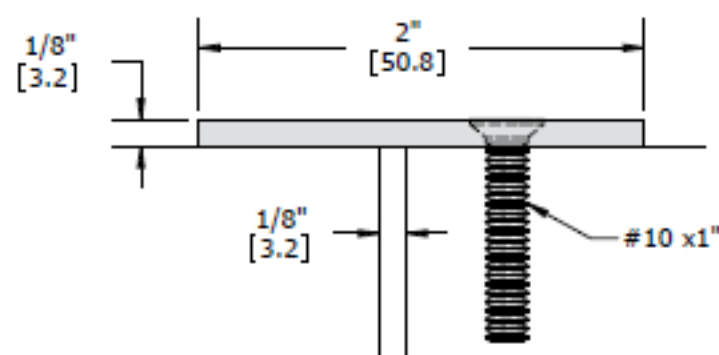

Finishes: MIL, DBA, GLD, US32D, USP  
 Category: J  
 Certifications:

Notes:
 

- Maximum length = 10 feet
- Available with thrubolts

### 838S

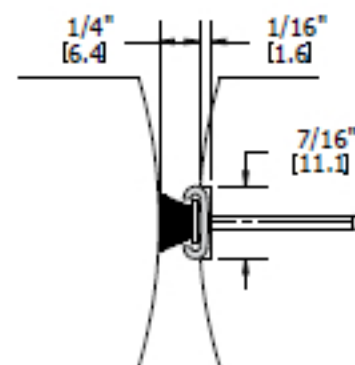

Finishes: MIL  
 Inserts: B  
 Category: J  
 Certifications:



## THRESHOLDS & WEATHERSTRIPPING

### ASTRAGALS/MEETING STILES (CONTINUED)

#### 839S

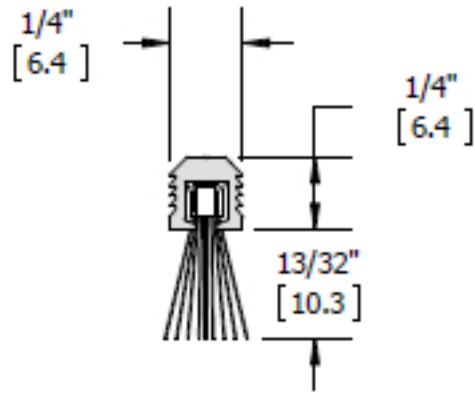

Finishes:  
Inserts:  
Category:  
Certifications:

MIL  
B  
J  
UL LISTED UBC 7.2 1997 PART 1

#### 845S | 846S

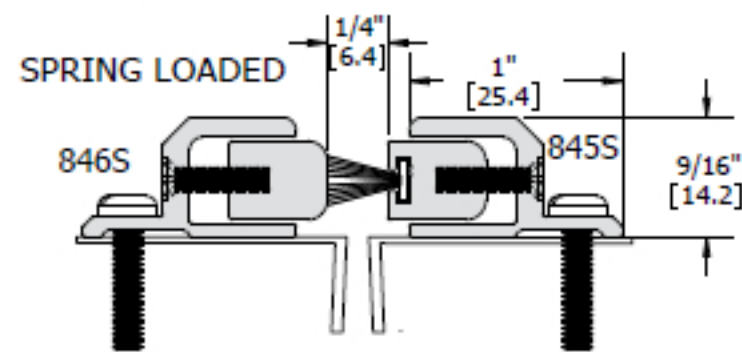

Finishes:  
Inserts:  
Category:  
Certifications:

MIL, DBA, GLD  
W  
J  
UL LISTED UBC 7.2 1997 PART 1

Notes:

- Adjustable
- Order two (2) for a set

#### 840S

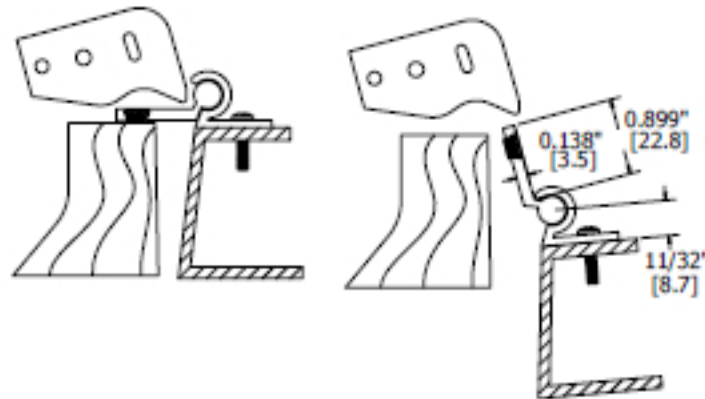

Finishes:  
Inserts:  
Notes:

MIL, DBA, GLD  
W  
96" maximum door height

#### 847S | 848S

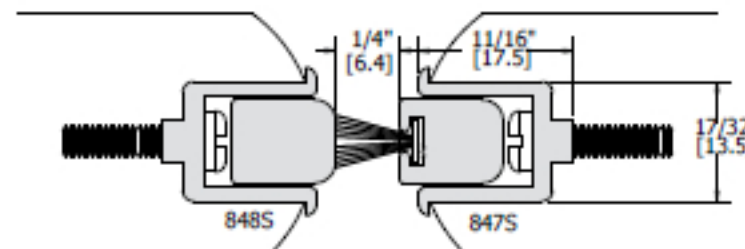

Finishes:  
Inserts:  
Category:  
Certifications:

MIL, DBA, GLD  
W  
J  
UL LISTED UBC 7.2 1997 PART 1

Notes:

- Adjustable
- Spring loaded
- Mortise depth = 21/32"

#### 844S

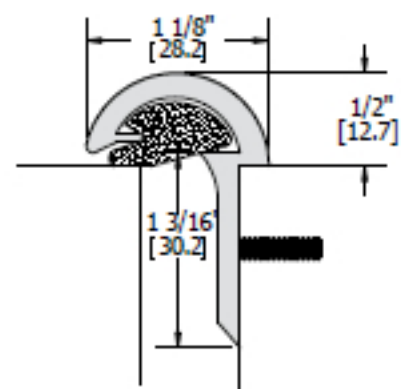

Finishes:  
Inserts:  
Category:  
Certifications:

MIL, DBA  
N  
H, J  
UL LISTED UBC 7.2 1997 PART 1

#### 849S

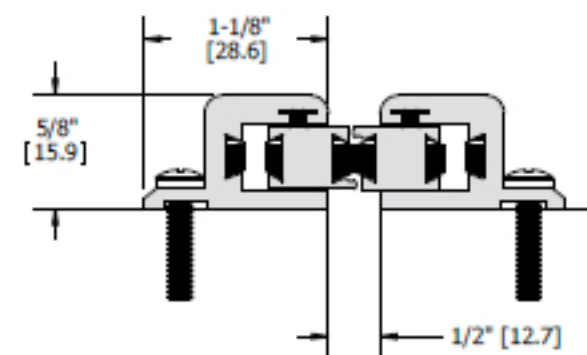

Finishes:  
Notes:

- MIL, DBA, GLD
- Magnetic
  - 96" maximum door height
  - Designed for use on 80" to 96" doors only
  - Sets shorter than 80" may not work properly







## ASTRAGALS/MEETING STILES (CONTINUED)

### 872S

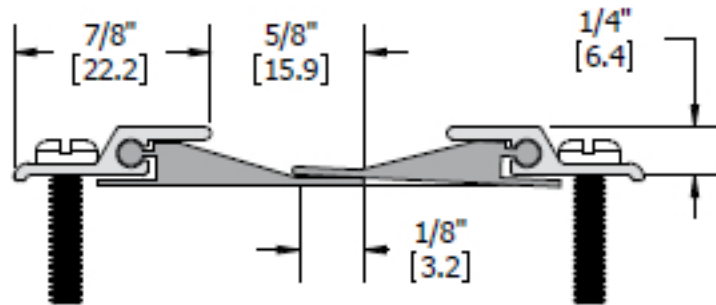

Finishes: DBA, GLD, MIB, CLR, US32D  
 Inserts: N  
 Category: H, J  
 Certifications:



Notes: • Order two (2) for a set

### 874S

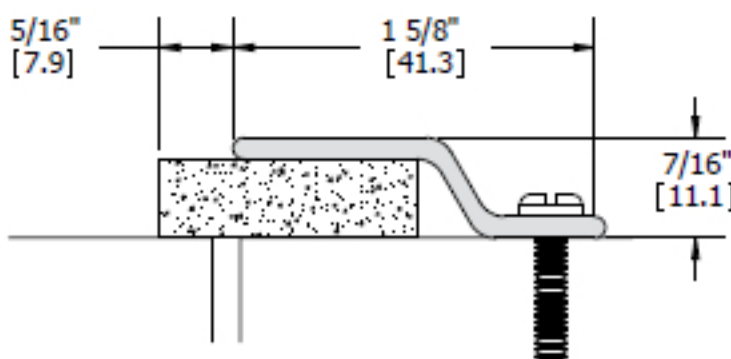

Finishes: MIL, DBA, GLD, US32D  
 Inserts: N  
 Category: H, J  
 Certifications:



## SPRING BRONZE

Constructed of high tempered 0.009" gauge bronze to provide a permanent spring. Hemmed edges.

Fasteners: #6 x 7/8" Nail, #4 wafer head drive nails available for metal door frames

### 820S

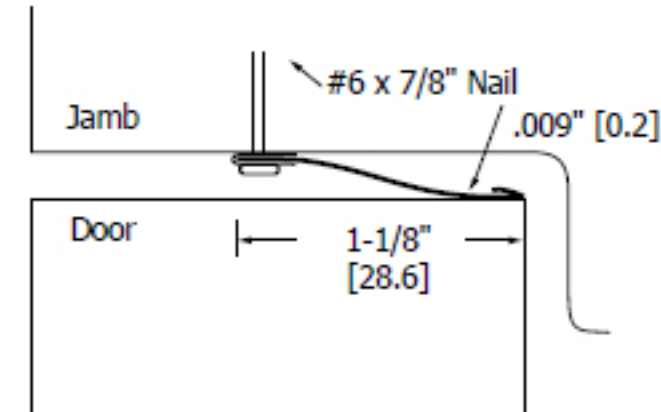

Finishes:  
 Notes:

MIB

- Spring bronze weatherstrip, for wood and wood casement windows
- Supplied with nails; nails should be 1-1/2" on center