

LIN-X800



- > Door weight (per door): max. 40 kg (88 lbs.)
- > Door thickness: 24–40 mm (15/16"–1 9/16")
- > Door height: max. 2400 or 2980 mm (94 1/2" or 117 5/16")
- > Door width: 750–850 mm (29 1/2"–33 7/16")
- > Door swings out laterally in a small radius compared to ordinary swing doors, ideal for tight spaces
- > Non handed
- > Adjustable in 4 directions: horizontal, vertical, depth, and parallel
- > Built-in dampers provide smooth soft closing movement
- > Ideal for closet entryways, large pantry doors, hidden rooms, etc.
- > Material: Aluminum/Steel

Note

Designed for overlay applications, but can be installed flush with cabinet or wall. For details contact customer service.

→ LIN-X800 Sets and Components

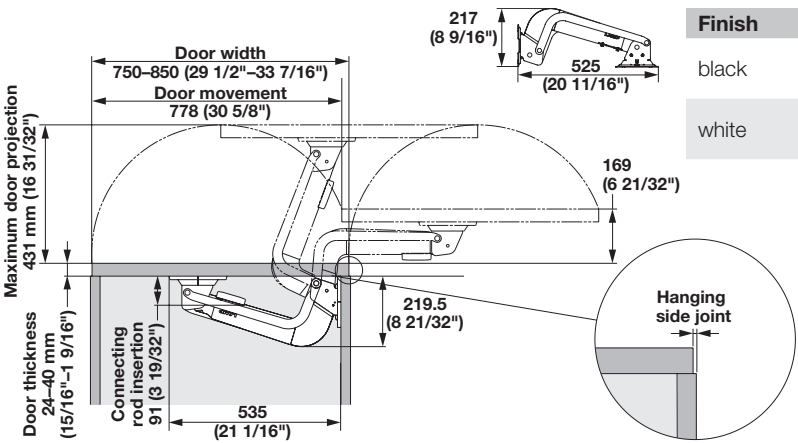

Finish	Height	Item No.
black	2400 (94 1/2")	409.43.711
	2980 (117 5/16")	409.43.713
white	2400 (94 1/2")	409.73.712
	2980 (117 5/16")	409.73.714