

Häfele Free Space

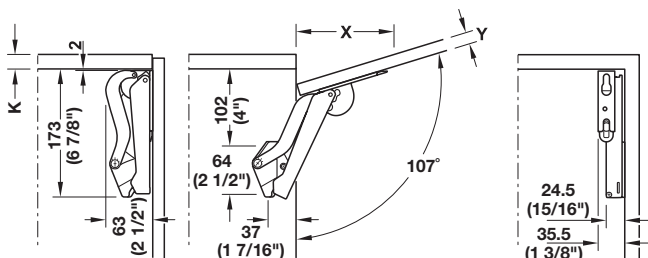

Front panel thickness Y	16 (5/8")	19 (3/4")	22 (7/8")	26 (1")
Distance X (with cabinet top panel thickness 16 mm (5/8"))	117 (4 5/8")	107 (4 1/4")	96 (3 7/8")	83 (3 1/4")

Note Dim X helps calculate space required when raised panels or crown moldings are used.

Measurements table for selecting the right model based on cabinet height and door weight including weight of handle. We recommend ordering the stronger fitting model if in doubt.

Model	Door Weight Ranges in Pounds							
	B		C		D		E	
Door height	Min.	Max.	Min.	Max.	Min.	Max.	Min.	Max.
225 (9")	5.1	9.5	8.4	15.6	14.1	20.5	20.2	29.5
250 (10")	4.2	8.6	7.5	14.1	12.8	20.0	18.3	27.7
275 (11")	4.2	7.7	6.8	12.8	11.7	18.0	16.5	26.4
300 (12")	3.7	7.0	6.2	11.7	10.6	16.5	15.2	24.2
325 (13")	3.5	6.6	5.7	10.8	9.7	15.4	14.1	22.4
350 (14")	3.3	6.2	5.3	10.1	9.0	14.3	13.0	20.9
375 (15")	2.9	5.7	4.8	9.5	8.4	13.2	12.1	19.4
400 (16")	2.6	5.3	4.6	8.8	7.9	12.3	11.4	18.3
425 (17")	2.4	5.1	4.4	8.4	7.5	11.7	10.8	17.2
450 (18")	2.2	4.6	4.2	7.7	7.0	11.0	10.1	16.1
475 (19")	2.2	4.4	4.0	7.5	6.6	10.3	9.5	15.4
500 (20")	2.0	4.2	3.7	7.0	6.4	9.9	9.0	14.5
525 (21")	2.0	4.0	3.5	6.6	5.9	9.5	8.6	13.9
550 (22")	1.8	3.7	3.3	6.4	5.7	9.0	8.1	13.2
575 (23")	1.8	3.7	3.1	6.2	5.5	8.6	7.9	12.5
600 (24")	1.8	3.5	3.1	5.9	5.3	8.1	7.5	12.1
625 (25")	1.5	3.3	2.9	5.5	5.1	7.9	7.3	11.7
650 (26")	1.5	3.3	2.9	5.3	4.8	7.7	7.0	11.2

Order suitable screw set for aluminum frame doors, see page 9.104.

→ Free Space 1.8 Push to Open

- > For doors without handle
- > For door heights up to 650 mm (26")
- > The fitting mounts to the side panels with a single pre-mounted Euro screw
- > The door mounts without tools and slides onto the mounting plates
- > A Pozi Drive #2 is required for all screw installations
- > Max. door overlay: 90° opening; max. 37 mm (1 1/4")
107° opening; max. 22 mm (7/8")
- > Material: Plastic/Steel
Steel finish: nickel-plated

Model	white	light gray	anthracite
B	372.27.705	372.27.505	372.27.355
C	372.27.706	372.27.506	372.27.356
D	372.27.707	372.27.507	372.27.357
E	372.27.708	372.27.508	372.27.358

Supplied With

- 2 Fittings (right/left)
- 2 Mounting brackets with screws
- 1 Free push catch
- 1 Set mounting instructions and paper drilling template

Important Notes

Selecting the correct model depends on door height and then door weight which should also consider the weight of the handle. We recommend ordering the stronger fitting if in doubt.

For aluminum framed doors order screws and collars set item 372.27.600, see accessories.
Minimum frame width is 45 mm (1 3/4")

The lever arms are spring loaded. There is a risk of injury and damage to the fitting!

After mounting the arms, do not press them down in the open position until the counterweight of the door is mounted.

A Pozi Drive #2 bit is required for all screw installations and adjustment features, otherwise damage to the screw head is likely.

Be certain that Euro screws which attach the fittings to the side panels are completely tight, drawing the fitting tight against the side wall.

For tension adjustment feature, we recommend using a cordless driver as these screws are geared very low. Be sure to adjust both sides to the same tensioning position.