

### Aximat®

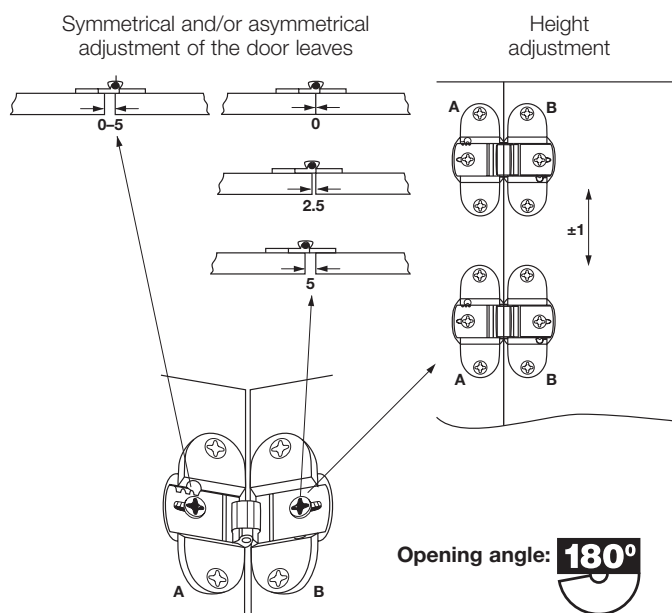

- > For free-swinging or guided folding doors
- > Door thickness: min. 13 mm (1/2")
- > Door width: up to 600 mm (23 5/8")
- > Same drilling pattern for both leaves
- > Gap range is adjustable from 0–10 mm (3/8")
- > Factory supplied with pre-set 3 mm (1/8") gap
- > Adjustable pivot point
- > Constant spring tension is maintained during all adjustments

### → Folding Door Hinge



> Material: Zinc

#### Finish

nickel

#### Item No.

343.91.600

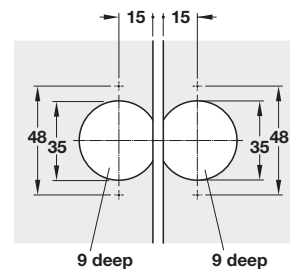
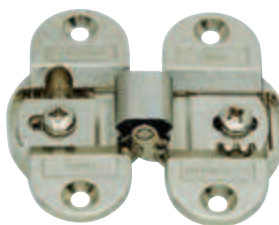

To hold the door leaves flat, install a support.

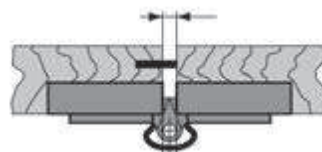

### Aximat 300 Accessories

### → Opening Angle Restraint

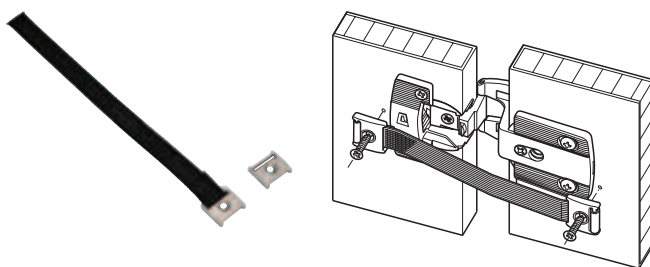

- > Opening angle: <120°
- > For screw mounting, hinge type independent
- > Individual opening angle by shortening the strip
- > Material: Strip: Plastic Fabric; Parts: Zinc Alloy

#### Finish

black/nickel-plated

#### Item No.

344.00.991