

Häfele Rafx System

ixconnect

→ Connecting Bolt

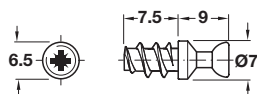

> Material: Zinc Alloy, galvanized

Drive type

PZ2 cross slot

Item No.

263.20.131

→ Connecting Bolt

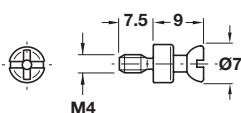

> With M4 thread
> Drive: Cross-slot Pozi #2 or flat blade
> Material: Steel

Finish

zinc-plated

Item No.

263.21.817

→ Spreading Dowel

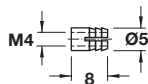

> With M4 internal thread; For drilled hole Ø5 mm
> Length: 8 mm
> Material: Brass

Item No.

051.45.004

→ Glue-in Sockets

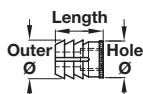

> Glue grooves; Internal thread M4
> Material: Nylon; Color: natural

Length

8

Item No.

039.33.140

10

039.33.042

→ Sleeve

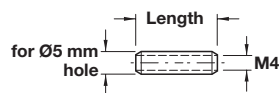

> With M4 internal thread
> Smooth sleeve suitable for double-sided assemblies
> Material: Steel

Finish	Length		
	15 mm	18 mm	22 mm
unfinished	267.00.011	267.00.012	267.00.013
zinc-plated	267.00.911	267.00.912	267.00.913

→ End Screw

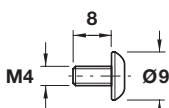

> With M4 internal thread
> Can be used as end bolt
> Material: Steel

Item No.

020.92.711

Supplied With 2000 pcs.

Dimensional data not binding. Dimensions in mm, inches are approximate. We reserve the right to alter specifications without notice.

Connectors and Shelf Supports