

LockerLock LL 200

→ Green Programming Add Key Tag



Item No.
917.42.003

→ Red Programming Delete Key Tag



Item No.
917.42.004

→ Gray User Key Tag



Item No.
917.44.085

→ Single Sleeves



- > M4 internal thread
- > Drill hole Ø: 8 mm (5/16")
- > External thread Ø: 8.5 mm (5/16")
- > Material: Plastic; Color: natural

Length L	Item No.
8 (5/16")	039.33.140
10 (3/8")	039.33.042

→ Angled Striking Plate

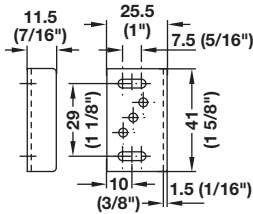

- > Slot for different bolt distances
- > Screw mounted
- > Material: Steel

Finish	Item No.
nickel-plated	239.47.604

Dimensional data not binding. Dimensions in mm, inches are approximate. We reserve the right to alter specifications without notice.

## Multi-Purpose Connectors

### → T-Nuts

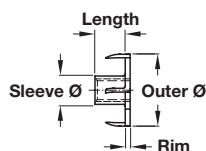

- > Pronged
- > Material: Steel, unfinished

Internal thread	Outer Ø	Sleeve Ø	Rim	Length	Item No.
M4	15	5.5	1	7.5	031.00.249
M6	19	7.5	1.3	8	031.00.267
M8	22.5	10	1.5	9.5	031.00.285
M10	26	11.5	2	11	031.00.301

### → Screw-in Sockets

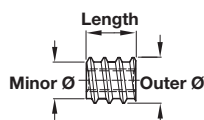

- > Screwdriver slot
- > Internal thread M4
- > Material: Steel, unfinished

Outer Ø	Minor Ø	Length	Item No.
8	5.5	8	030.00.100

Supplied With  
1000 pcs.

- > Internal thread M6

Outer Ø	Minor Ø	Length	Item No.
10	7	12	030.00.351

Internal thread	Outer Ø	Minor Ø	Length	Item No.
M8	14	11.5	15	030.00.404
M10	18.5	15	15	030.00.502

Supplied With  
100 pcs.

### → Glue-in Sockets

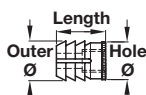

- > Glue grooves
- > Internal thread M4
- > Material: Nylon; Color: natural

Outer Ø	Hole Ø	Length	Item No.
8.5	8	8	039.33.140
8.5	8	10	039.33.042

- > Internal thread M6

Outer Ø	Hole Ø	Length	Item No.
8.5	8	11	039.33.462

- > Internal thread M6

Outer Ø	Hole Ø	Length	Item No.
11	10	11	039.33.266

Supplied With  
5000 pcs.

**Häfele Rafx System**

ixconnect

→ Connecting Bolt

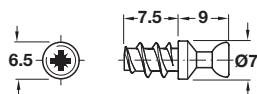

> Material: Zinc Alloy, galvanized

**Drive type**

PZ2 cross slot

**Item No.**

263.20.131

→ Connecting Bolt

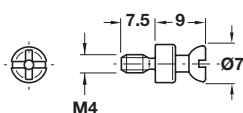

> With M4 thread  
> Drive: Cross-slot Pozi #2 or flat blade  
> Material: Steel

**Finish**

zinc-plated

**Item No.**

263.21.817

→ Spreading Dowel

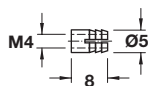

> With M4 internal thread; For drilled hole Ø5 mm  
> Length: 8 mm  
> Material: Brass

**Item No.**

051.45.004

→ Glue-in Sockets

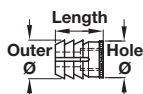

> Glue grooves; Internal thread M4  
> Material: Nylon; Color: natural

**Length**

8

**Item No.**

039.33.140

10

039.33.042

→ Sleeve

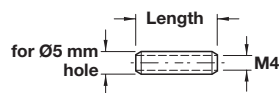

> With M4 internal thread  
> Smooth sleeve suitable for double-sided assemblies  
> Material: Steel

Finish	Length		
	15 mm	18 mm	22 mm
unfinished	267.00.011	267.00.012	267.00.013
zinc-plated	267.00.911	267.00.912	267.00.913

→ End Screw

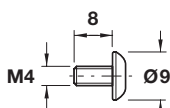

> With M4 internal thread  
> Can be used as end bolt  
> Material: Steel

**Item No.**

020.92.711

Supplied With 2000 pcs.

Dimensional data not binding. Dimensions in mm, inches are approximate. We reserve the right to alter specifications without notice.

Connectors and Shelf Supports

### Minifix® System

#### ixconnect

- > Connecting bolts with M6 thread for screw-attachment into dowels for single-sided installations
- > Dowels can be selected for 8 or 10 mm diameter holes

#### → M200 Connecting Bolt/cold-formed

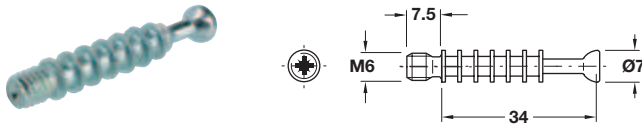

- > Drive: Pozi 2 or Phillips 2
- > Material: Steel, galvanized

	Item No.
	262.28.642

#### → S100 Connecting Bolt/turned



- > Material: Steel, galvanized

B	Item No.
24	262.27.949
34	262.28.946

The connecting bolts above can be used with the following parts:

#### → Spreading Dowel

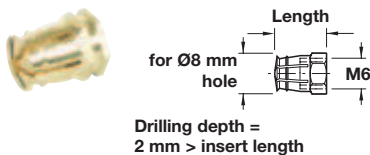

- > With M6 internal thread
- > Material: Brass, bright

Length	Item No.
9	039.00.267
12 w/nylon ball	039.00.061

#### → Glue-in Dowel

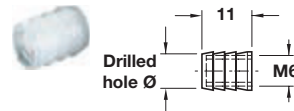

- > With M6 internal thread
- > Length: 11 mm
- > Material: Nylon; Color: natural

Drilled hole Ø	Item No.
8	039.33.462
10	039.33.266

The connecting bolt on left can be used with the following parts:

#### → S100 Connecting Bolt/turned



- > Connecting bolt, with M4 thread for screw attachment into dowels or sleeves for single or double-sided installations
- > Sleeves or dowels can be selected for holes between Ø5, 8, or 10 mm
- > Drive: Cross-slot 2 or flat blade
- > Material: Steel, galvanized

B	Item No.
24	262.27.930
34	262.28.937

#### → Glued Dowel

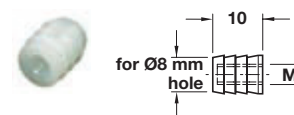

- > With M4 internal thread
- > Material: Nylon

Color	Item No.
natural	039.33.042

#### → Spreading Dowel



- > With M4 internal thread
- > Material: Brass, bright

	Item No.
	051.45.004

#### → Trim Cap

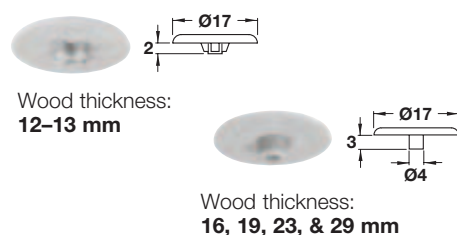

- > For Minifix® cams without flanged rims.
- > Material: Plastic

Wood thickness	white	pine	brown	gray	black
12-13	-	-	262.24.162	-	-
16, 19, 23, & 29	262.24.751	262.24.055	262.24.153	262.24.525	262.24.359