

- > For inset face frame doorsw
- > Quick and easy mounting
- > 2-way adjustable

→ Full Wrap Non-mortised Hinges

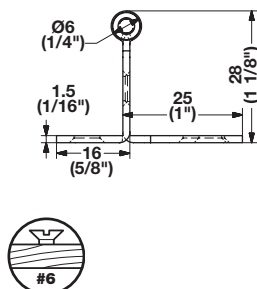

> Material: Steel

Finish	Minaret finial	Ball finial
antique brass	351.86.100	351.86.140
dark oil-rubbed bronze	351.86.110	351.86.150
copper bronze	351.86.180	351.86.185
chrome-plated	351.86.200	351.86.220
black	351.86.300	351.86.320
satin chrome	351.86.400	351.86.420
matt nickel	351.86.600	351.86.620
brass-plated	351.86.800	351.86.820
pewter	351.86.900	351.86.920

Note

Order #6 wood screws separately.

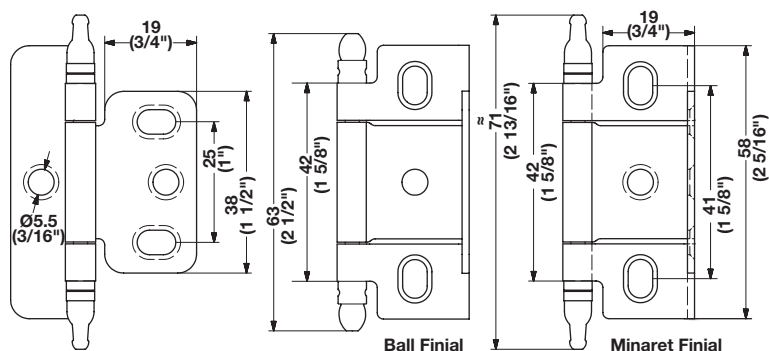

9

Hinges and Stays

→ Flat Head Countersunk Wood Screws

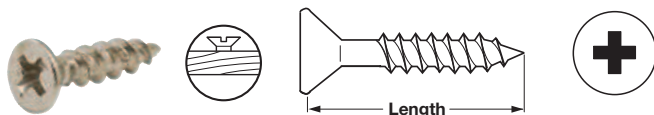

- > Deep thread design provides maximum holding power in a variety of different woods and man-made materials
- > With extra-deep Phillips Recess to help minimize bit slippage
- > Material: Steel, plated

Finish	Length (inches)	Item No.
antique brass	#6 x 5/8"	010.77.146
oil-rubbed bronze	#6 x 5/8"	010.77.546
copper bronze	#6 x 5/8"	010.77.046
polished chrome	#6 x 5/8"	010.77.246
black	#6 x 5/8"	010.77.346
satin chrome	#6 x 5/8"	010.77.446
satin nickel	#6 x 5/8"	010.77.646
polished brass	#6 x 5/8"	010.77.846
pewter	#6 x 5/8"	010.77.946

Supplied With

1000 pcs.

Dimensional data not binding. Dimensions in mm, inches are approximate. We reserve the right to alter specifications without notice.

- > For inset face frame doors
- > Quick and easy mounting
- > 2-way adjustable

→ Partial Wrap Non-mortise Hinges

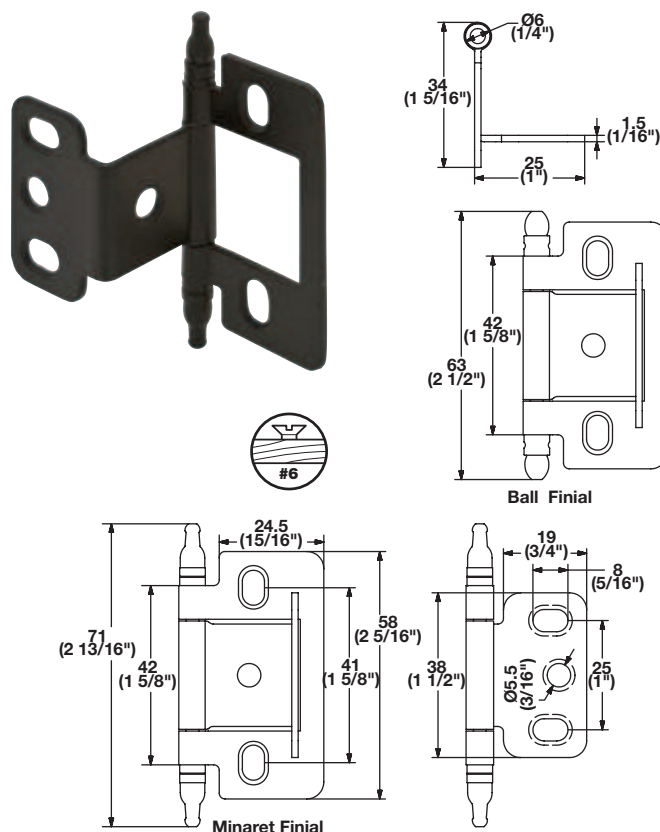

> Material: Steel

Finish	Minaret finial	Ball finial
antique brass	351.86.120	351.86.160
dark oil-rubbed bronze	351.86.130	351.86.170
copper bronze	351.86.190	351.86.195
chrome-plated	351.86.210	351.86.230
black	351.86.310	351.86.330
satin chrome	351.86.410	351.86.430
matt nickel	351.86.610	351.86.630
brass-plated	351.86.810	351.86.830
pewter	351.86.910	351.86.930

Note

Order #6 wood screws separately.

→ Flat Head Countersunk Wood Screws

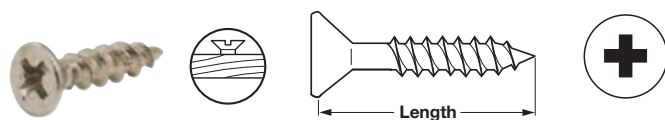

- > Deep thread design provides maximum holding power in a variety of different woods and man-made materials
- > With extra-deep Phillips Recess to help minimize bit slippage
- > Material: Steel, plated

Finish	Length	Item No.
antique brass	#6 x 5/8"	010.77.146
oil-rubbed bronze	#6 x 5/8"	010.77.546
copper bronze	#6 x 5/8"	010.77.046
polished chrome	#6 x 5/8"	010.77.246
black	#6 x 5/8"	010.77.346
satin chrome	#6 x 5/8"	010.77.446
satin nickel	#6 x 5/8"	010.77.646
polished brass	#6 x 5/8"	010.77.846
pewter	#6 x 5/8"	010.77.946

Supplied With
1000 pcs.

Special Application Screws

→ Flat Head Countersunk Wood Screws

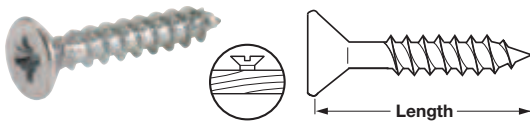

- > With Pozi drive
- > Length: #5 x 5/8"
- > Material: Steel

Finish	Item No.
zinc-plated	015.31.540

Supplied With
100 pcs.

→ Round Head Metal Brads



- > Length: 1.6 x 15 mm
- > Material: Steel

Finish	Item No.
nickel-plated	076.40.299

Supplied With
2000 pcs.

→ Pan Head Screws

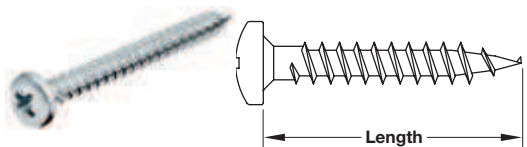

- > With Pozi drive
- > Length: #4 x 1/2"
- > Material: Steel

Finish	Item No.
zinc-plated	015.71.526

Supplied With
1000 pcs.

→ Pan Head Screws



- > #2 Phillips Drive
- > #4 x 1/2"
- > Material: Steel



Finish	Item No.
bronzed	020.45.040

Supplied With
1,000 pcs.

→ Flat Head Countersunk Wood Screws

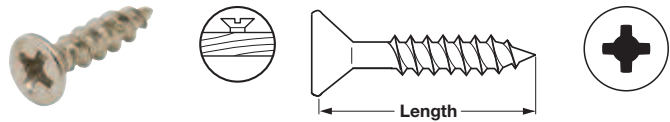

- > With Phillips drive
- > Deep thread design provides maximum holding power in a variety of different woods and man-made materials
- > With extra-deep Phillips recess to help minimize bit slippage
- > Material: Steel, plated

Finish	Length	Item No.
zinc	#4 x 1/2"	010.77.901
polished brass	#4 x 5/8"	010.77.502
zinc	#4 x 5/8"	010.77.902
antique english	#5 x 1/2"	010.77.103
zinc	#5 x 1/2"	010.77.903
polished brass	#5 x 5/8"	010.77.836
antique brass	#5 x 5/8"	010.77.136
antique english	#5 x 5/8"	010.77.104
oil-rubbed bronze	#5 x 5/8"	010.77.536
copper bronze	#5 x 5/8"	010.77.036
polished chrome	#5 x 5/8"	010.77.236
satin chrome	#5 x 5/8"	010.77.436
black	#5 x 5/8"	010.77.336
pewter	#5 x 5/8"	010.77.936
satin nickel	#5 x 5/8"	010.77.636
zinc	#5 x 5/8"	010.77.904
polished nickel	#5 x 5/8"	010.77.604
nickel	#6 x 1/2"	010.77.605
zinc	#6 x 1/2"	010.77.905
polished brass	#6 x 5/8"	010.77.846
antique brass	#6 x 5/8"	010.77.146
antique english	#6 x 5/8"	010.77.106
oil-rubbed bronze	#6 x 5/8"	010.77.546
copper bronze	#6 x 5/8"	010.77.046
polished chrome	#6 x 5/8"	010.77.246
satin chrome	#6 x 5/8"	010.77.446
black	#6 x 5/8"	010.77.346
pewter	#6 x 5/8"	010.77.946
satin nickel	#6 x 5/8"	010.77.646
zinc	#6 x 5/8"	010.77.906
nickel	#6 x 3/4"	010.77.610
nickel	#6 x 1"	010.77.612
nickel matt	#6 x 5/8"	010.77.607
polished nickel	#6 x 5/8"	010.77.606

Supplied With
1000 pcs.