

# LARGE FORMAT MORTISE IC HOUSING

- ▶ Compatible with original large format IC cores
- ▶ Interchangeable cams
- ▶ Solid brass construction
- ▶ 7 popular cams available



Model #	Type
CCM	LF Corbin IC Mortise Housing, Straight
SCM	LF Sargent IC Mortise Housing, Straight
ICS	LF Schlage IC Mortise Housing, Straight
YCM	LF Yale IC Mortise Housing, Straight
MCM	LF Medeco IC Mortise Housing, Straight

See page 28 for ICS specifications.

See page 29 for cams.

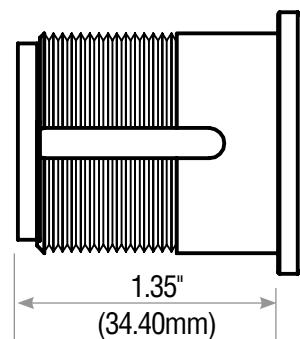
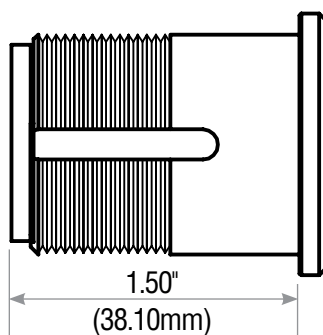
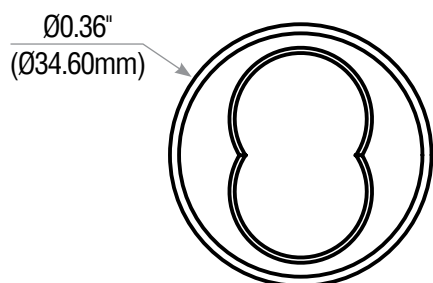
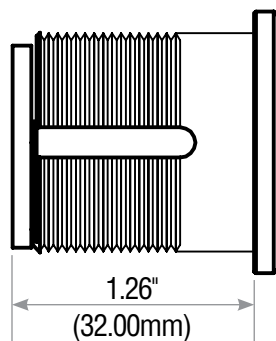
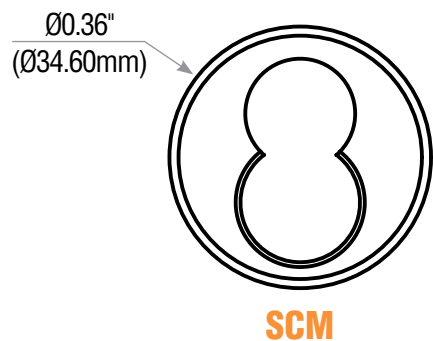
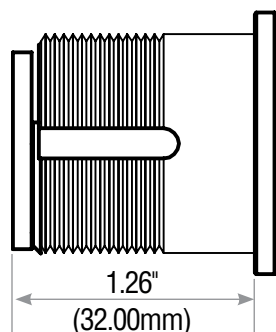
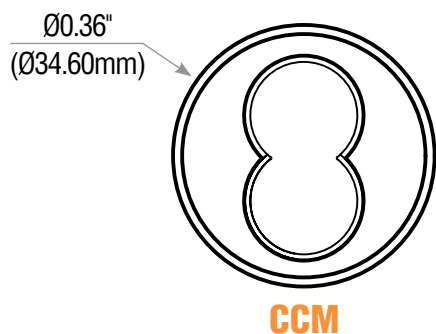

# LFIC Mortise Housing Schematic Drawings

## CCM

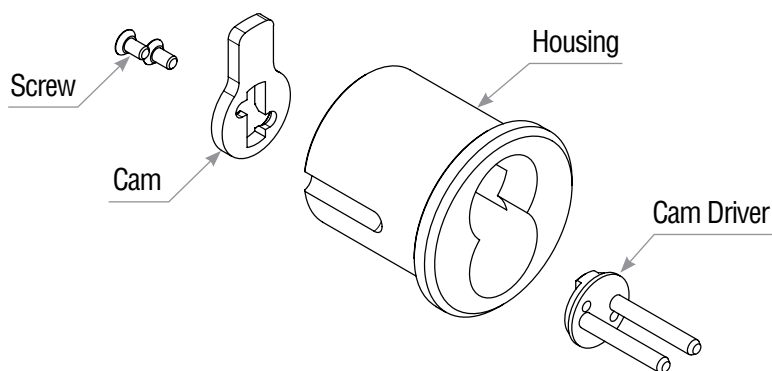

## SCM

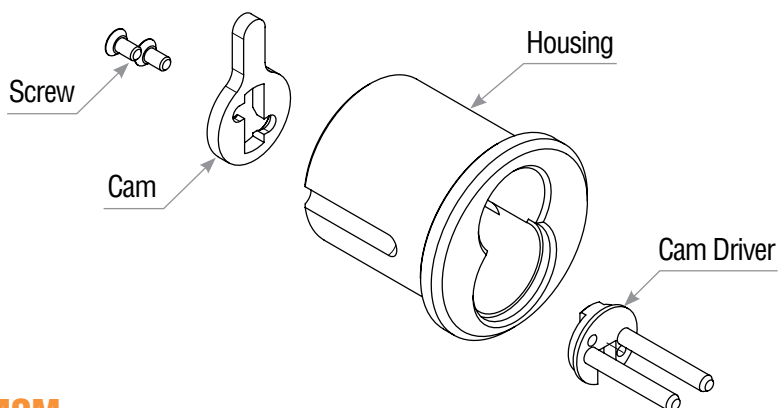

## YCM & MCM

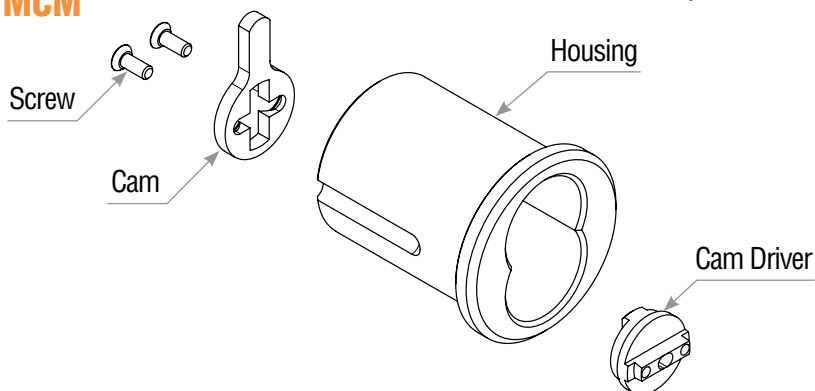

## Conversion Kits

Mounting Plate, Collar and Screws to convert from mortise to rim.

**KIT-CCXR Conversion Kit for CCM**

**KIT-ICXR Conversion Kit for ICXM**

**KIT-MCXR Conversion Kit for MCM**

**KIT-SCXR Conversion Kit for SCM**

**KIT-YCXR Conversion kit for YCM**

## How to Order LFIC Mortise Housings

		Finish	Cam
	Model #		
LF Corbin IC Mortise Housing, Straight	CCM	Polished Brass 3	AdamsRite AR
LF Sargent IC Mortise Housing, Straight	SCM	Satin Brass 4	Corbin CL
LF Yale IC Mortise Housing, Straight	YCM	Satin Bronze 10	Best BE
LF Medeco IC Mortise Housing, Straight	MCM	Satin Nickel 15	Sargent SA
		Polished Chrome 26	Schlage SL
		Satin Chrome 26D	Yale ST
		Oil Rubbed Bronze 10B	Falcon/Saflok TS
CCM		3	AL

See next page for ICS order information.

# LARGE FORMAT MORTISE IC HOUSING

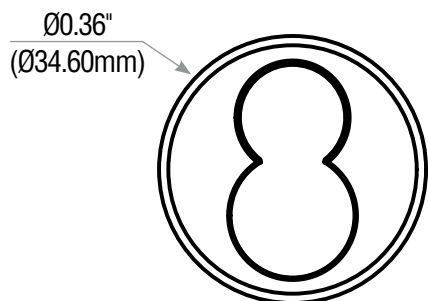

**ICS**

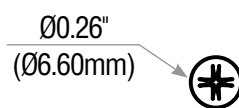
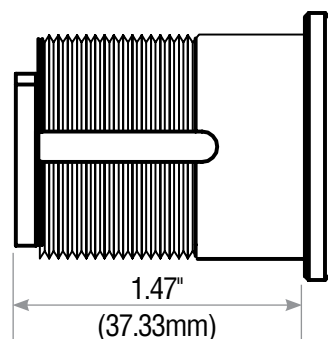

**SCR-5**

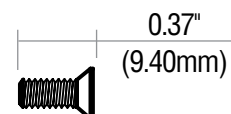

## ICS Mortise Housing Schematic Drawing

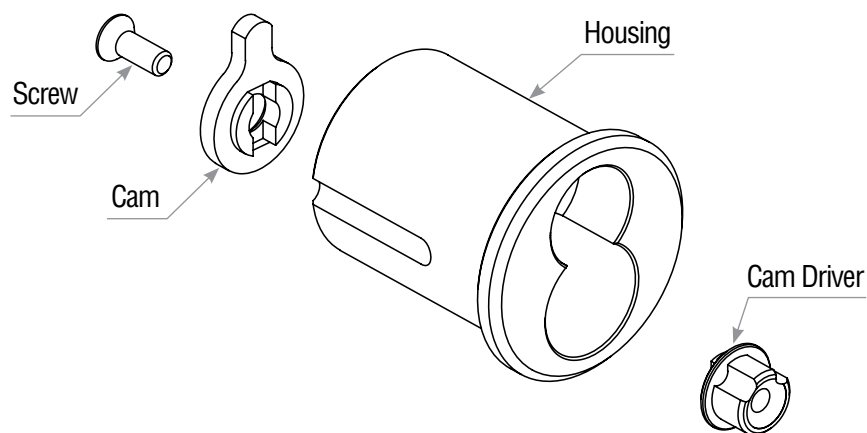

## How to Order ICS Large Format Mortise Housings

		Finish			
LF Schlage IC Mortise Housing	Model #	ICS	Polished Brass	3	Cam
		Satin Brass	4		
		Satin Bronze	10		
		Satin Nickel	15		
		Polished Chrome	26		
		Satin Chrome	26D		
		Oil Rubbed Bronze	10B		
				AdamsRite	AR
				Corbin	CL
				Sargent	SA
				Schlage	SL
				Yale	ST

**ICS**

**3**

**AR**

## Cams for SFIC & LFIC Mortise Housings (except for ICS and YCM)

The cams shown below are actual size.

Cam #	Description
CAM2-AR	AdamsRite Cam
CAM2-CL	Corbin Cam
CAM2-BE	Best Cam
CAM2-SA	Sargent Cam
CAM2-SL	Schlage Cam
CAM2-ST	Yale Cam
CAM2-TS	Falcon/Saflok Cam

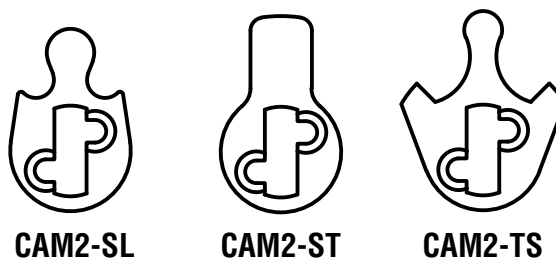
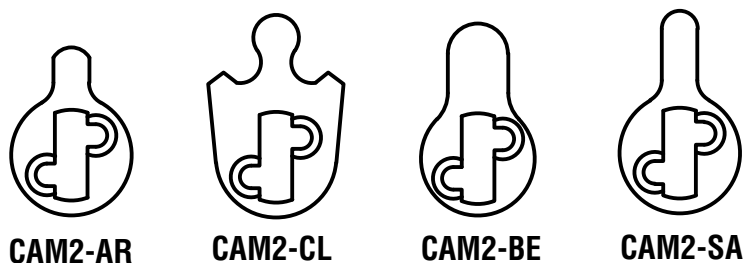

## Cams for ICS Large Format IC Housings

The cams shown below are actual size.

Cam #	Description
CAM3-AR	AdamsRite Cam
CAM3-CL	Corbin Cam
CAM3-SA	Sargent Cam
CAM3-SL	Schlage Cam
CAM3-ST	Yale Cam

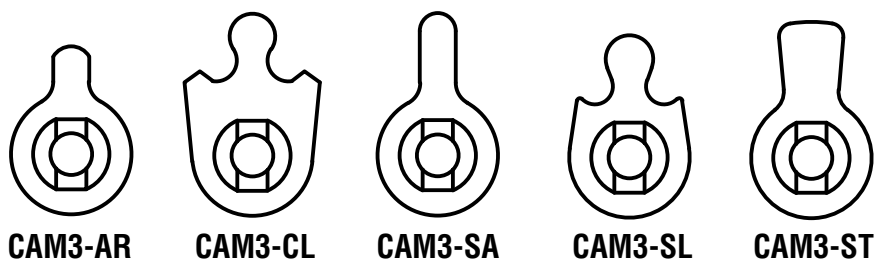

YCM mortise housing uses Cam1, see page 7.

