

24/25 Series channel cover plate options

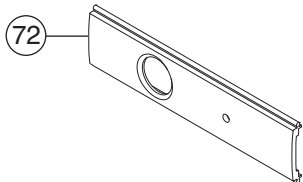
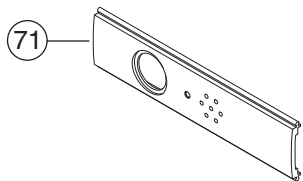
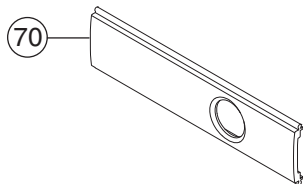
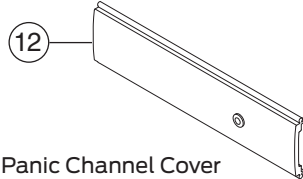
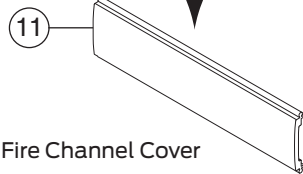
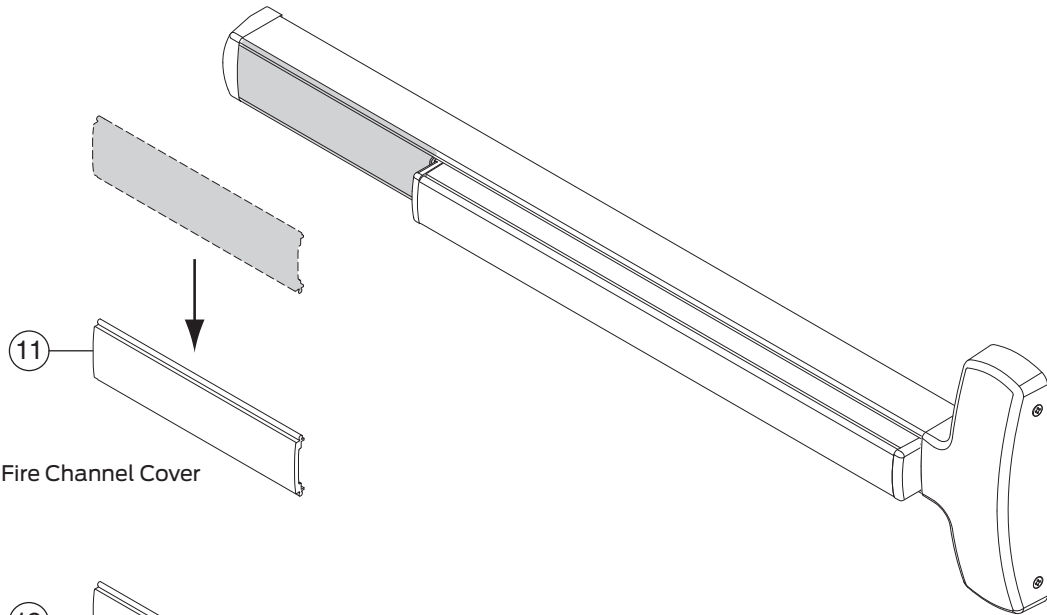

Cylinder Dogging Channel Cover

Exit Alarm Channel Cover

Key Override Channel Cover

| No. | Qty. | Part no. | Description | Notes |
|-----|------|----------|--|-------|
| 11 | 1 | 650227 | F-25 Channel Cover Plate 3' | A |
| | 1 | 650228 | F-25 Channel Cover Plate 4' | |
| | 1 | 650121 | F-24 Channel Cover Plate 3' | |
| | 1 | 650122 | F-24 Channel Cover Plate 4' | |
| 12* | 1 | 650191 | 25 Series Panic Channel Cover Plate 3' | |
| | 1 | 650192 | 25 Series Panic Channel Cover Plate 4' | |
| | 1 | 650187 | 24 Series Panic Channel Cover Plate 3' | |
| | 1 | 650188 | 24 Series Panic Channel Cover Plate 4' | |
| 70 | 1 | 650119 | 25 Series CD Channel Cover Plate 3' | |
| | 1 | 650120 | 25 Series CD Channel Cover Plate 4' | |
| | 1 | 650117 | 24 Series CD Channel Cover Plate 3' | |
| | 1 | 650116 | 24 Series CD Channel Cover Plate 4' | |
| 71 | 1 | 650135 | 25 Series EA Channel Cover Plate 3' | |
| | 1 | 650136 | 25 Series EA Channel Cover Plate 4' | |
| | 1 | 650131 | 24 Series EA Channel Cover Plate 3' | |
| | 1 | 650132 | 24 Series EA Channel Cover Plate 4' | |
| 72 | 1 | 650143 | 25 Series KOR Channel Cover Plate 3' | |
| | 1 | 650144 | 25 Series KOR Channel Cover Plate 4' | |
| | 1 | 650139 | 24 Series KOR Channel Cover Plate 3' | |
| | 1 | 650140 | 24 Series KOR Channel Cover Plate 4' | |

A Specify by finish: 313AN, US3, US4, US10, US26, US26D, US32, US32D, US28

* 24 and 25 Panic Channel Cover Plates are included in the Hex Dogging Kit (part numbers shown above are Hex Dogging Kit part numbers).