

EXIDOR

QUICK GUIDE RANGE BROCHURE

PANIC & EMERGENCY EXIT HARDWARE

MADE IN
BRITAIN 



BRITISH MANUFACTURED PANIC & EMERGENCY EXIT HARDWARE

Why Exidor

Exidor Ltd is a UK based engineering company manufacturing a comprehensive, high specification range of innovative panic and emergency exit hardware.

We've been meeting the needs of architects, specifiers, project managers, OEM's and building managers for more than 60 years. In that time, we've built an unrivalled record of developing and continually enhancing a product range that's known all over the world.

As a proud UK manufacturer, we are a member of the 'Made in Britain' campaign, which promotes and celebrates true UK manufacturing. We manufacture to a system which is approved to ISO9001. And we care – professionally – about quality.



RANGE GUIDE

200 SERIES

Market leading panic hardware range, suited to most panic and emergency escape environments.



400 SERIES

Highly aesthetic touchbar range, ideal for higher use environments, eg. Schools, hospitals and shopping centres.



500 SERIES

Slim line panic hardware range ideal for glazed doors and premium aesthetic requirements.



700 SERIES

Heavy duty range offering emergency egress for high security environments.



STANDARDS GUIDE

EN179: 2008

For push pad and lever handle devices which can only be used in areas where occupants of the building are familiar with the layout and means of escape, and where members of the public do not have access.

Application examples: factory, warehouse, offices



EN1125: 2008

For push bar and touch bar devices which can be used in any environment, particularly areas open to members of the public.

Application examples: shopping centres, areas of entertainment, public buildings



200 SERIES

BOLTS & LATCHES

Market leading panic hardware range, suited to most emergency escape environments.

FEATURES AND BENEFITS

- Non-handed
- Easy fitting
- Standard footprint
- Tested and certified to BS EN179 / BS EN1125
- 10 year warranty
- Tested to 200,000 cycles
- Anti-thrust mechanism to protect against attack
- Standard and adjustable bolts available
- Extensive range of accessories





293 Push Pad Bolt [BS EN179]



294 Push Bar Panic Bolt [BS EN1125]



296 Push Bar Panic Latch [BS EN1125]



297 Push Pad Latch [BS EN179]



285 Push Bar Double Door Set For
Rebated Double Doors [BS EN1125]



305 Panic Mortise Actuator with
Cylinder Mortise Night Latch
[BS EN1125]



298 Knob Outside Access Device
(non-changeable cylinder)



302 Knob Outside Access Device



322 Lever Outside Access Device

200 SERIES TECHNICAL INFORMATION

Applications

The 200 series is suitable for use in most environments and is our most popular panic hardware range. Unless specified the Exidor range is supplied with all the necessary fixings for timber frames and doors. However, for alternative fixings for steel and other door types are available, please contact your supplier.

A choice of finishes

All exit devices are available in a wide range of finishes, including standard powdercoat and plated finishes, but also through our in-house powder coating plant we can offer a range of RAL finishes to suit your client's needs.

Standard finishes:



Silver
(RAL 9022)



Black



White

Plated finishes available:



Stainless
steel effect*



Brass
effect*

*Plated finishes are not recommended for external use or outside access devices.

Standard sizes

Standard sized units are suitable for doors up to 1220mm wide and 2440mm high. The shoot bolts and cross bars can be cut down on site to suit the door height and width. For larger doors above 2440mm high special size top shoot bolt lengths are available up on request. The following lengths are available:

- 1210mm for doors up to 2440mm high (Standard size supplied)
- 2100mm for doors up to 3180mm high

PUSH PAD PANIC LATCH

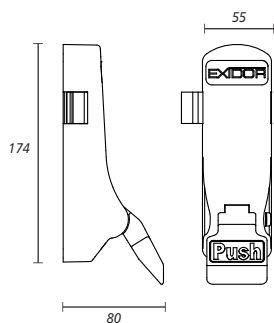

SINGLE PANIC BOLT

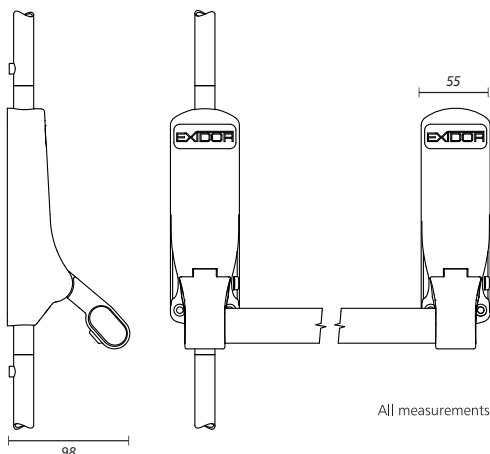

All measurements in mm

Construction

The main body and slave units are constructed of die cast aluminium with extruded aluminium guides. The internal components and shoot ends are of solid steel with tubular steel shoots, and the latch bolts are in extruded brass.

Pullman Latches

The Exidor Pullman latch kits can be supplied for any of the Exidor panic bolt range to upgrade a unit, and are suitable for doors that are subject to a high volume of traffic, or require smooth quiet latching.

The Pullman latches are available in both vertical and horizontal versions and provide a smooth and quiet alternative to the traditional top trip catch. They are recommended for interconnecting doors as well as external doors.



**Vertical
Pullman
Latch**



**Horizontal
Pullman Latch**

Mechanical Push Button Outside Access Devices

Mechanical Push Button Outside Access Devices:

- CL1 Push Button Mechanical Code Lock**
- CL2 Push Button Mechanical Code Lock with Passage Function**
- CL3 Quick Code Mechanical Code Lock**
(Code can be changed without removing the unit)
- CL4 Quick Code Mechanical Code Lock with Passage Function**
(Code can be changed without removing the unit)

Only suitable for use with the 296, 297, 305 & 306



CL1/CL2



CL3/CL4

Dogging Device

For use with the Exidor panic bolt and Pullman latch ranges, a holdback (dogging) device is available as an accessory. The dogging device allows the bolts to be withheld so that doors can be left unlatched when required.



299 Dogging Device

Alarm Unit

For use with the Exidor panic bolt and Pullman latch ranges, the alarm is activated when the panic device is operated or an attempt is made to remove the cover, and de-activated by a key. The unit is powered by a 9v battery.



304 Alarm

Keep Options

Exidor offer an extensive range of 200 series keeps to suit timber, steel and uPVC door types

For further information on the available range of keeps, or any other accessories, please visit exidor.co.uk or contact your local distributor for more details.

400 SERIES TOUCH BAR

Highly aesthetic touchbar range, ideal for higher use environments, eg. Schools, hospitals and shopping centre.



FEATURES AND BENEFITS

- Stylish and aesthetically pleasing
- Pullman Latches, offering smooth, quiet latching operation
- Non-handed
- Tested and certified to BS EN1125
- Easy fitting
- Tested to 200,000 cycles
- 10 year warranty
- Fits flush to door with additional patented lip, preventing accidental jamming
- Central latch with anti-thrust to protect against attack
- Extensive range of finishes and accessories



400 Dead locking latch for doors up to 900mm wide

401 Dead locking latch for doors up to 1200mm wide



402 Touch Bar Panic Bolt With Vertical Latches for Doors Up To 900mm Wide

403 Touch Bar Panic Bolt With Vertical Latches for Doors Up To 1200mm Wide

416 Touch Bar Panic Bolt With Horizontal Latches for Doors Up To 900mm Wide

417 Touch Bar Panic Bolt With Horizontal Latches for Doors Up To 1200mm Wide



404 Touch Bar Three Point Panic Bolt With Vertical Latches for Doors Up To 900mm Wide

405 Touch Bar Three Point Panic Bolt With Vertical Latches for Doors Up To 1200mm Wide

418 Touch Bar Three Point Panic Bolt With Horizontal Latches for Doors Up To 900mm Wide

419 Touch Bar Three Point Panic Bolt With Horizontal Latches for Doors Up To 1200mm Wide



420 Touch Bar Mortice Actuator With Cylinder Night Latch for Doors Up To 900mm Wide

421 Touch Bar Mortice Actuator With Cylinder Night Latch for Doors Up To 1200mm Wide



409 Knob Outside Access Device (non-changeable cylinder)



410 Lever Outside Access Device

411 Knob Outside Access Device

400 SERIES TECHNICAL INFORMATION

Applications

The many key attributes of the Exidor 400 Series Touchbar make it ideal for a multitude of environments including Schools, Hospitals, Hotels, Airports, Sports Stadiums, Shopping Centres, Prestigious Office Developments.

A choice of finishes

All exit devices are available in a wide range of finishes, including standard powdercoat and plated finishes, but also through our in-house powder coating plant we can offer a range of RAL finishes to suit your client's needs.

Standard finishes:



Silver
(RAL 9022)



White/Green



Black/Green

Plated finishes available:



Stainless
steel effect*



Brass
effect*

*Plated finishes are not recommended for external use or outside access devices.

Standard sizes

All touch bars configurations are available in two standard lengths:

- 653.5mm overall which suits door widths between 692mm to a maximum of 900mm
- 833.5mm overall which suits door widths between 872mm to a maximum of 1200mm

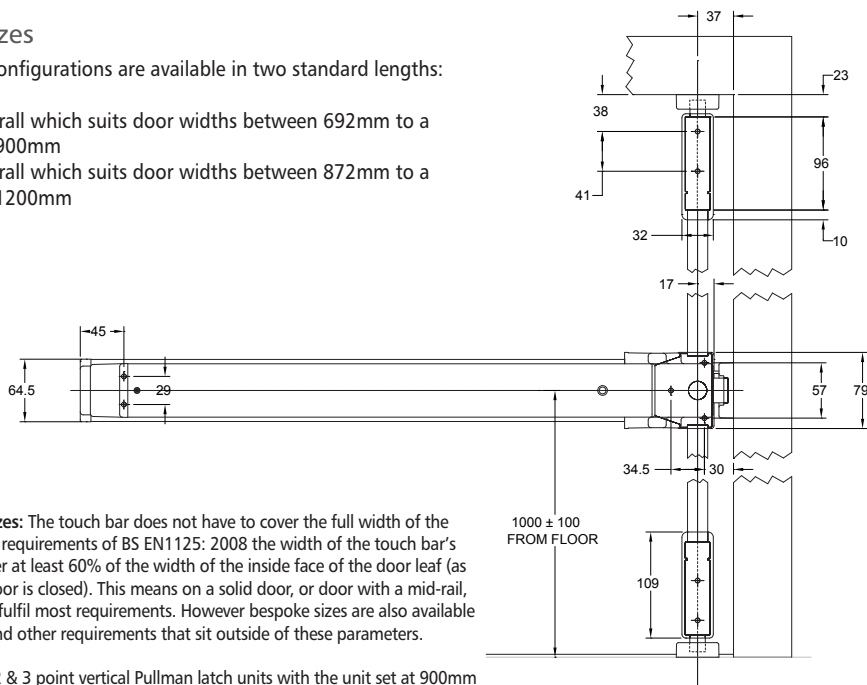

None standard Sizes: The touch bar does not have to cover the full width of the door. To satisfy the requirements of BS EN1125: 2008 the width of the touch bar's actuator must cover at least 60% of the width of the inside face of the door leaf (as visible when the door is closed). This means on a solid door, or door with a mid-rail, our standard sizes fulfil most requirements. However bespoke sizes are also available for glazed doors and other requirements that sit outside of these parameters.

Door Height: For 2 & 3 point vertical Pullman latch units with the unit set at 900mm from the floor the maximum door height is 2250mm. If the unit is set at 1100mm the maximum door height can be increased to 2450mm high. Options are also available on request for larger doors up 4m.

All measurements in mm

Construction

The main chassis is constructed out of steel with an aluminium head and end cover. The rods are steel with an extruded aluminium cover. Zinc diecast and steel are used for the internal components. The centre latch and Pullman latches are stainless steel.

Electronic Latch Retraction

The Exidor 400 series with electronic latch retraction can now be fully integrated with access control systems whilst still allowing safe and quick emergency exit from inside the building.

From the inside this system ensures that even in the event of power failure, speedy and safe egress can be achieved. However, from the outside of the door the Exidor 400 series electronic latch retraction unit is wired into the buildings access control system which means that on activation, a motor concealed within the touch bar assembly provides immediate retraction of the bolts and therefore access into the building.

Please visit exidor.co.uk or contact your distributor for more details.

Mechanical Push Button Outside Access Devices

Mechanical Push Button Outside Access Devices:

- CL1 Push Button Mechanical Code Lock**
- CL2 Push Button Mechanical Code Lock with Passage Function**
- CL3 Quick Code Mechanical Code Lock**
(Code can be changed without removing the unit)
- CL4 Quick Code Mechanical Code Lock with Passage Function**
(Code can be changed without removing the unit)



CL1/CL2

CL3/CL4

Dogging Facility

The 400 series units can be provided with a dogging facility, allowing the latches to be withheld in the retracted position when required. This is built in to the unit and must be specified at the time of order.

Micro Switch Facility

Units can be fitted with a micro-switch to allow door monitoring if required. This is built in to the unit and must be specified at the time of order.

Alarm

The 400 series can be alarmed again this is a built in function that must be specified at time of order.

Keep and Double Door Options

The 400 series also features keeps to suit double door and flush faced door applications – these are the 406B centre latch keep and the 406A horizontal Pullman latch keep. Please visit exidor.co.uk or contact your local distributor for more details.

500 SERIES

BOLTS & LATCHES

Slim line panic hardware range ideal for glazed doors and premium aesthetic requirements.



FEATURES AND BENEFITS

- Non-handed
- Easy fitting
- Narrow product ideal for glazed doors
- Universal uPVC fitting set available
- Stylish slim line contour
- Tested and certified to BS EN179 / BS EN1125
- Tested to 200,000 cycles
- 10 year warranty
- Extensive range of accessories



501B Push Bar Panic latch



502A-B Push Bar Emergency Exit Bolt with Shoot Bolts



503A-B Push Bar Three Point Emergency Exit Bolt with Shoot Bolts



512B Push Bar Emergency Exit Bolt with Vertical Pullman



513B Push Bar Three Point Emergency Exit Bolt with Vertical Pullman



522B Push Bar Emergency Exit Bolt with Horizontal Pullman



523B Push Bar Three Point Emergency Exit Bolt with Horizontal Pullman



500/L Lever Operated Outside Access Device



500/K Knob Operated Outside Access Device

Supplied with fitting for timber doors as standard:

- Use suffix UD for uPVC door fitting
- Use suffix AD for Aluminium door fittings

500 SERIES TECHNICAL INFORMATION

Applications

The Exidor 500 series panic and emergency hardware offers a modern, aesthetically pleasing style giving optimum safety and security, carries the Certifire quality mark, is fire rated and is certified to the European standards to ensure peace of mind.

Featuring a slim line design and a range of fixing options it is ideal for use on glazed doors and with a range of optional finishes and elegant narrow profile it can stand up to the demands of a highly aesthetic development.

A choice of finishes

All exit devices are available in a wide range of finishes, including standard powder coat and plated finishes, but also through our in-house powder coating plant we can offer a range of RAL finishes to suit your client's needs.

Standard finishes:



Silver
(RAL 9022)



White/Green



Black/Red

Plated finishes available:



Stainless
steel effect*



Brass
effect*

*Plated finishes are not recommended for external use or outside access devices.

Standard sizes

Standard sized units are suitable for doors up to 1220mm wide and 2440mm high. The shoot bolts and cross bars can be cut down on site to suit the door height and width.

For larger doors above 2440mm high special size top shoot bolt lengths are available upon request. The following lengths are stocked by Exidor Ltd.

- 1210mm for doors up to 2440mm high (Standard size supplied)
- 2100mm for doors up to 3180mm high

PUSH BAR THREE POINT PANIC BOLT

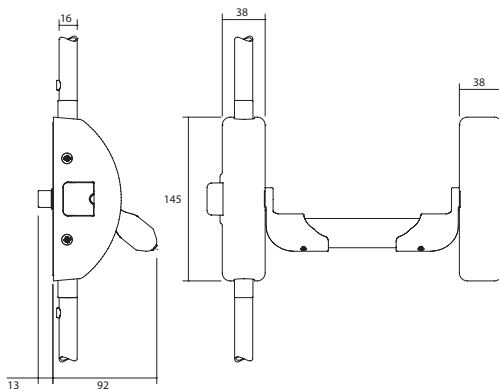

All measurements in mm

Construction

The main mechanisms are constructed from die cast zinc, with extruded aluminium guides. The shoot ends are of solid steel with tubular steel shoots. The centre latch bolts are nickle plated zinc, with stainless steel Pullman latches.

Push Pad

Each of the products can be supplied with a single push pad (conforming to EN179) rather than a push bar if required. Please discuss with your local distributor or visit www.exidor.co.uk for further details



Mechanical Push Button Outside Access Devices

Mechanical Push Button Outside Access Devices:

- CL1** Push Button Mechanical Code Lock
- CL2** Push Button Mechanical Code Lock with Passage Function
- CL3** Quick Code Mechanical Code Lock
(Code can be changed without removing the unit)
- CL4** Quick Code Mechanical Code Lock with Passage Function
(Code can be changed without removing the unit)



CL1/CL2

CL3/CL4

Keep and Double Door Options

The 500 series can be supplied with a range of different keeps to suit double doors and different door types. The range includes a universal keep and fixing set for uPVC doors, a keep and fitting kit for timbers doors and also for aluminium doors. Depending on your requirement please add the following suffix:

- UD** = uPVC door keeps and fixings
- AD** = Aluminium door keeps and fixings
- No suffix** = Timber door keeps and fixings

Beyond the standard keep sets we offer a variety of other keeps to suit many door configurations. Please speak with your local distributor or visit www.exidor.co.uk

700 SERIES BOLTS & LATCHES

Heavy duty range offering emergency egress for high security environments.

FEATURES AND BENEFITS

- High security panic hardware
- Tested and approved to LPS1175 level 6 Burglary Resistance Test
- Sold Secure Silver Standard
- 30mm bolt throw
- Anti-thrust bottom bolt and latch bolt to prevent physical attack
- Robust and heavy duty
- Tested and certified to BS EN179 / BS EN1125
- Tested to 200,000 cycles
- 10 year warranty





702B/30S two point locking for single steel doors

702B/30T two point locking for single timber doors



703B/30S three point locking for single steel doors

703B/30T three point locking for single timber doors



704B/30S four point locking for single steel doors

742B/30T four point locking for single timber doors



742B/30S four point locking for double steel doors

742B/30T four point locking for double timber doors



743B/30S five point locking for rebated double steel doors

743B/30T five point locking for rebated double timber doors



709 Knob Operated Outside Access Device

710 Lever Operated Outside Access Device

700 SERIES TECHNICAL INFORMATION

Applications

The Exidor 700 series heavy duty high security system combines the requirements of safety and security with the functions of a panic and emergency exit device. The range has been specifically developed to meet the demands required against a physical attack without compromising safety.

The 700 series is British manufactured from high quality steel for strength and rigidity, and available in both steel and timber door versions.

A choice of finishes

Finished in RAL 7016 anthracite grey as standard, however satin stainless steel plated finish and other RAL finishes are also available on request. A solid stainless steel option is also available.

Standard finishes:



Anthracite grey
(RAL 7016)

Plated finishes available:



Stainless
steel effect*

*Plated finishes are not recommended for external use or outside access devices.

Solid Stainless Steel

In addition to these finishes we can also offer the 700 series range in solid stainless steel for use in harsh environments.

Standard sizes

Standard sized units are suitable for doors up to 1220mm wide and 2440mm high. The shoot bolts and cross bars can be cut down on site to suit the door height and width.

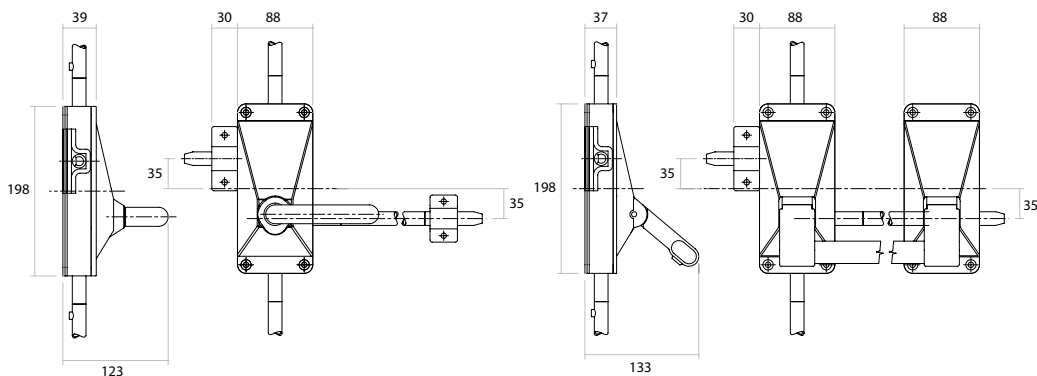

All measurements in mm

Construction

The main body and slave units are constructed from a mixture of steel and stainless steel. The internal components are manufactured from steel and shoot ends are solid steel with tubular steel rods.

Single Door Locking Points

Single Door Latch

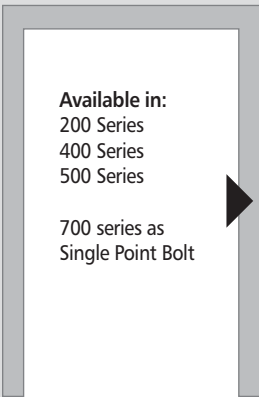

2 Point Vertical Locking



2 Point Horizontal Locking

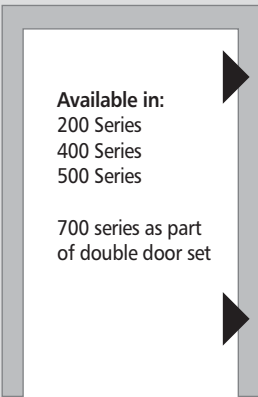

3 Point Vertical Locking



3 Point Horizontal Locking

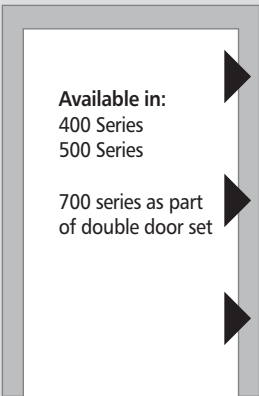

4 Point Locking



Locking Type Examples



Centre Latch



Centre Bolt



Mortice Night
Latch



Shoot Bolt



Vertical Pullman
Latch



Horizontal Pullman
Latch

EXIDOR

Door Controls

Exidor also offers a complete range of high end door controls including overhead, concealed, transom and electromagnetic closers, as well as a full range of floor springs and accessories.

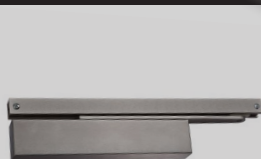

Visit our website for the latest
Exidor product literature,
technical data and product gallery.

exidor.co.uk

EXIDOR

www.exidor.co.uk

Exidor Limited

Progress Drive, Cannock
Staffordshire, WS11 0JE
England, UK

Tel: +44 (0)1543 578661

Fax: +44 (0)1543 570050

Email: sales@exidor.co.uk

Every effort has been made to ensure the accuracy of the particulars contained in this brochure. All details and specifications were deemed correct at time of going to press. However, Exidor Limited reserve the right to alter specifications with or without prior notice and at such times in a manner they think fit.

Customers are advised to call Exidor Limited on +44 (0) 1543 578661 if they require further details or clarification of specifications.



A subsidiary of

chamberlin plc

**MADE IN
BRITAIN** 

Issue 2 EX380