

TIMBERLINE INTERCHANGEABLE LOCK PLUG SYSTEM

One Lock Plug Fits All Cylinder Body Applications



WHY INTERCHANGEABLE LOCK PLUGS?

If a new key is required to work a series of locks, substantial time is spent removing the locks and rekeying them. In some instances, the cabinet locks are so difficult to rekey they are replaced and the old locks are scrapped – that cost adds up over time. With an interchangeable lock plug system, key changes are easy – simply insert the control key, remove the lock plug, and insert the new lock plug!

Complete Keying Versatility:

- In the plant...furniture can be keyed easily to the customer's requirements at any time
- In the field...key numbers can be readily installed at installation time or easily changed later by your customer.

Ease of Finishing:

Furniture may be finished without lock plug installed, eliminating the need for masking.

Simplified Inventory Management:

One stock of lock plugs fulfills all types of locking requirements.

CAM LOCK DIMENSIONAL DIAGRAM

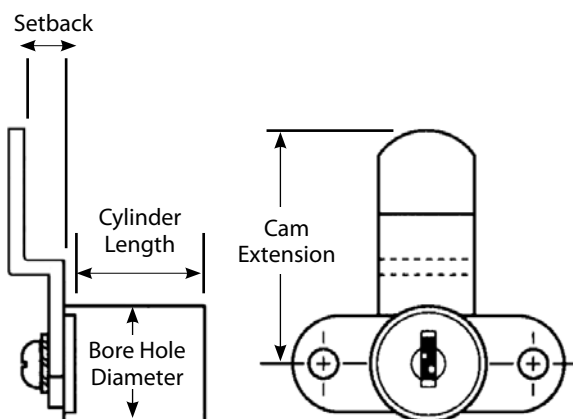

DEADBOLT DIMENSIONAL DIAGRAM

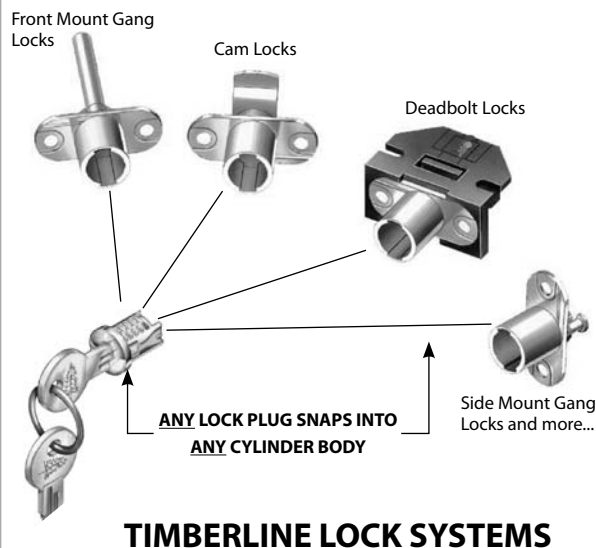
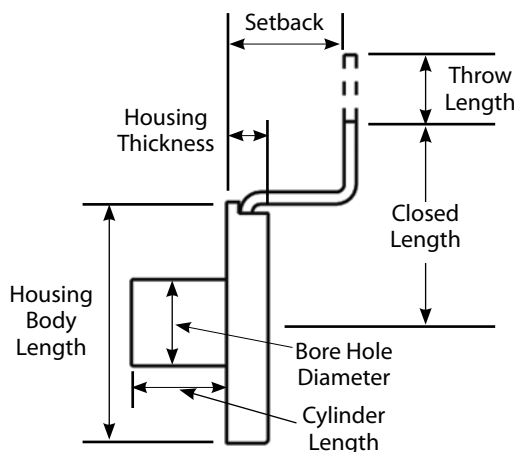

Most Timberline locks are designed for mounting in 3/4" panels, with or without a veneer or laminate face.

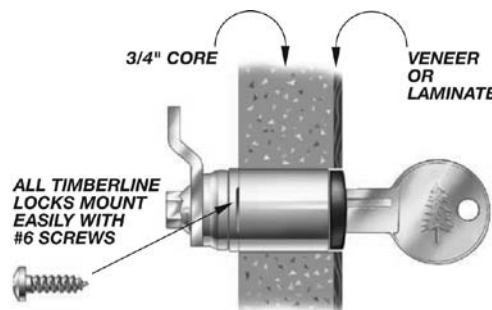

Most Timberline locks are used in a 16.5mm hole (drill bit TLDB165). Optional bezels are available (TLBZ Series, see page D-16) that allow use of locks in holes from 3/4" to 7/8" in diameter.

SECTION D CABINET LOCKS & LATCHES

CAM LOCK CYLINDER BODIES

CAM LOCKS, HORIZONTAL MOUNT 90° or 180° Rotation

- Available with 90° or 180° rotation
- All locks require a 16.5 mm diameter bore hole
- Designed to mount in 3/4" thick material with 3/4" long cylinder
- Locks must be installed to lock in a counter clockwise position

Packing: As shown below. **Sold In:** Both broken and full box quantities. Discount available for full box orders.

Horizontal Mount Rotation

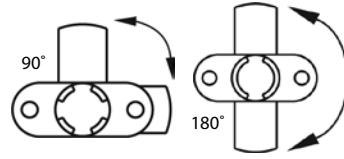

CompX
TIMBERLINE

NOTE: Cam locks must be installed so that they lock in the counter-clockwise position.

	90° ROTATION	180° ROTATION		90° ROTATION	180° ROTATION
TLCB080 & TLCB180	 A	 H	TLCB087 & TLCB187	 D	 K
TLCB083 & TLCB183	 B	 I	TLCB085 & TLCB185	 E	 L
TLCB084 & TLCB184	 C	 J	TLCB088 & TLCB188	 F	 M
 ORDER LOCK PLUG & STRIKE SEPARATELY, SEE PAGE D-15			TLCB089 & TLCB189	 G	 N

		Item#	Cylinder Length	Setback	Cam Extension	Cam Rotation	Box Qty
90° ROTATION	A	TLCB080	3/4"	3/32"	13/16"	90°	25
	B	TLCB083	3/4"	3/32"	1-1/4"	90°	25
	C	TLCB084	3/4"	9/32"	1-1/4"	90°	25
	D	TLCB087	3/4"	9/32"	1-23/32"	90°	25
	E	TLCB085	3/4"	15/32"	13/16"	90°	25
	F	TLCB088	3/4"	15/32"	1-1/4"	90°	25
	G	TLCB089	3/4"	7/8"	1-1/4"	90°	25
180° ROTATION	H	TLCB180	3/4"	3/32"	13/16"	180°	25
	I	TLCB183	3/4"	3/32"	1-1/4"	180°	25
	J	TLCB184	3/4"	9/32"	1-1/4"	180°	25
	K	TLCB187	3/4"	9/32"	1-23/32"	180°	25
	L	TLCB185	3/4"	15/32"	13/16"	180°	25
	M	TLCB188	3/4"	15/32"	1-1/4"	180°	25
	N	TLCB189	3/4"	7/8"	1-1/4"	180°	25

CAM LOCKS, VERTICAL MOUNT

90° or 180° Rotation

- Available with 90° or 180° rotation
- All locks require a 16.5 mm diameter bore hole
- Designed to mount in 3/4" thick material with 3/4" long cylinder
- Locks must be installed to lock in a counter clockwise position

Packing: As shown below. **Sold In:** Both broken and full box quantities. Discount available for full box orders.

Vertical Mount Rotation

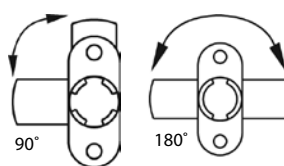

CompX
TIMBERLINE

NOTE: Cam locks must be installed so that they lock in the counter-clockwise position.

	90° ROTATION	180° ROTATION		90° ROTATION	180° ROTATION
TLCB090 & TLCB190			TLCB090	TLCB190	
	A	H			
TLCB093 & TLCB193			TLCB093	TLCB193	
	B	I			
TLCB094 & TLCB194			TLCB094	TLCB194	
	C	J			
TLCB097 & TLCB197			TLCB097	TLCB197	
	D	K			
TLCB095 & TLCB195			TLCB095	TLCB195	
	E	L			
TLCB098 & TLCB198			TLCB098	TLCB198	
	F	M			
TLCB099 & TLCB199			TLCB099	TLCB199	
	G	N			

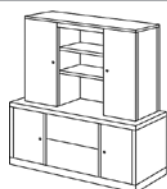

**ORDER LOCK PLUG &
STRIKE SEPARATELY,
SEE PAGE D-15**

		Item#	Cylinder Length	Setback	Cam Extension	Cam Rotation	Box Qty
90° ROTATION	A	TLCB090	3/4"	3/32"	13/16"	90°	25
	B	TLCB093	3/4"	3/32"	1-1/4"	90°	25
	C	TLCB094	3/4"	15/32"	1-1/4"	90°	25
	D	TLCB097	3/4"	9/32"	1-23/32"	90°	25
	E	TLCB095	3/4"	15/32"	13/16"	90°	25
	F	TLCB098	3/4"	15/32"	1-1/4"	90°	25
	G	TLCB099	3/4"	7/8"	1-1/4"	90°	25
180° ROTATION	H	TLCB190	3/4"	3/32"	13/16"	180°	25
	I	TLCB193	3/4"	3/32"	1-1/4"	180°	25
	J	TLCB194	3/4"	9/32"	1-1/4"	180°	25
	K	TLCB197	3/4"	9/32"	1-23/32"	180°	25
	L	TLCB195	3/4"	15/32"	13/16"	180°	25
	M	TLCB198	3/4"	15/32"	1-1/4"	180°	25
	N	TLCB199	3/4"	7/8"	1-1/4"	180°	25

SECTION D CABINET LOCKS & LATCHES

CAM LOCK CYLINDER BODIES

CAM LOCK KIT, CYLINDER BODY WITH 4 CAMS

Mounts in 3/4" Material

- Universal lock for either doors or drawers
- Each kit contains four easily switched cams to accommodate most locking situations
- Counter clockwise to lock
- Requires 16.5mm diameter bore hole
- Cylinder length is 3/4"
- Cylinder supplied with two straight and two bent cams

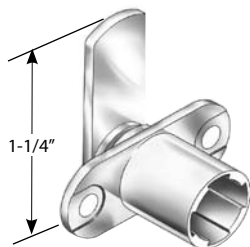

NOTE: Cam locks must be installed so that they lock in the counter-clockwise position.

Cams Included:

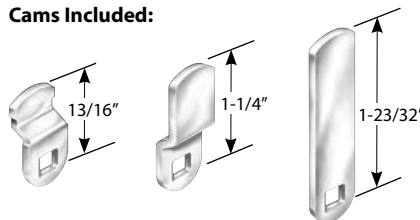

CompX
TIMBERLINE

**ORDER LOCK
PLUG & STRIKE
SEPARATELY, SEE
PAGE D-15**

Packing: As shown below.

Sold in: Both broken and full box quantities.

Discount available for full box orders.

THESE KITS WILL REPLACE THE FOLLOWING TIMBERLINE CAM LOCKS:

Item#	Rotation	Mount	Box Qty						
				TLCB-165 90° Rotation		TLCB168 180° Rotation		TLCB169 180° Rotation	
TLCB165	90°	Horizontal & Vertical	25	TLCB080	TLCB083	TLCB084	TLCB180	TLCB183	TLCB190
TLCB168	180°	Horizontal	25	TLCB085	TLCB087	TLCB088	TLCB184	TLCB185	TLCB194
TLCB169	180°	Vertical	25	TLCB090	TLCB093	TLCB094	TLCB187	TLCB188	TLCB197
				TLCB095	TLCB094	TLCB098			TLCB198

THICK PANEL CYLINDER BODIES

Vertical Material Thickness, 7/8" to 1-1/4"

- Universal type lock for either doors or drawers
- Lock comes packaged with a straight cam extending 1-1/4" and a bent arm cam extending 1-1/2"
- Cylinder length can be adjusted from 7/8" to 1-1/4" lengths by screwing the cylinder body in/out
- Requires 16.5mm diameter bore hole
- Counter-clockwise to lock at a 90° rotation (only)
- Supplied with nickel plated finish cup

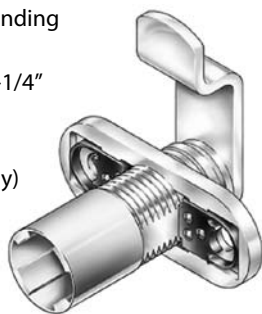

Packing: As shown below.

Sold In: Both broken and full box quantities.

Discount available for full box orders.

Item#	Cam Extension	Cam Rotation	Box Qty
TLCB170	Straight Cam: 1-1/4" Bent Cam: 1-1/2"	90°	25

ORDER LOCK PLUG & STRIKE SEPARATELY, SEE PAGE D-15

CompX
TIMBERLINE

TLCB170 7/8" - 1"

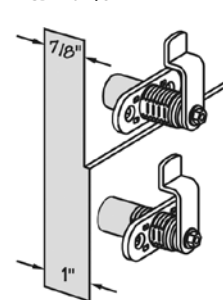

TLCB170 1-1/8" - 1-1/4"

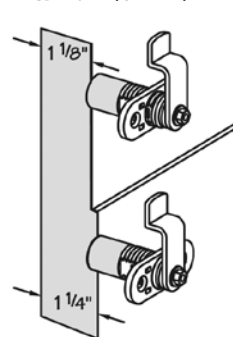

Mounting flange adjusts to allow lock to be mounted in panels from 7/8" to 1-1/4" thick.

TLCB170 3 Orientations:

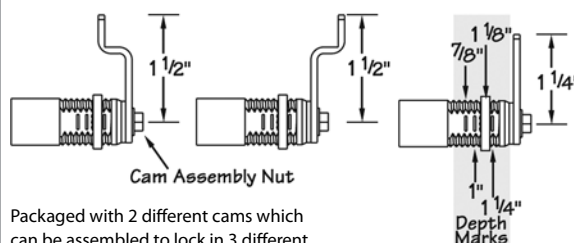

Packaged with 2 different cams which can be assembled to lock in 3 different orientations for added flexibility.

DEADBOLT LOCKS, HORIZONTAL MOUNT

Mounts in 3/4" Material

- Surface mounted lock for locking doors or drawers
- All locks have 3/4" long cylinders
- Requires 16.5mm diameter bore hole
- 180° key rotation
- Key removable in both locked and unlocked positions
- Tough nylon housing

Packing: As shown below.

Sold in: Both broken and full box quantities. Discount available for full box orders.

Applications:

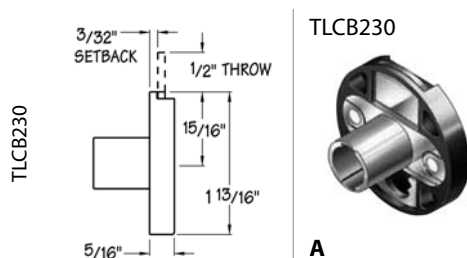
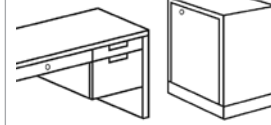

TLCB230



A

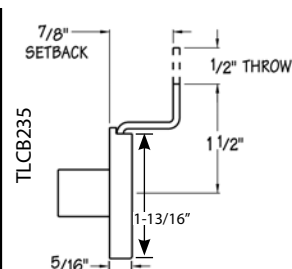

TLCB235



E



Round Cylinder

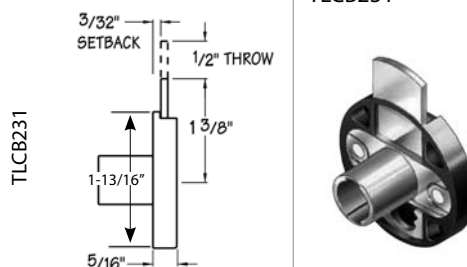

TLCB231



B

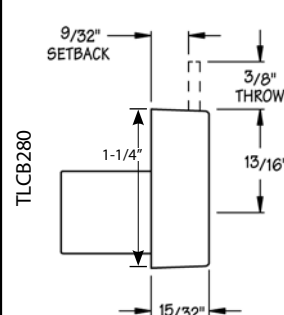

TLCB280

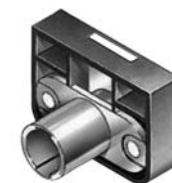

F



Rectangular Cylinder

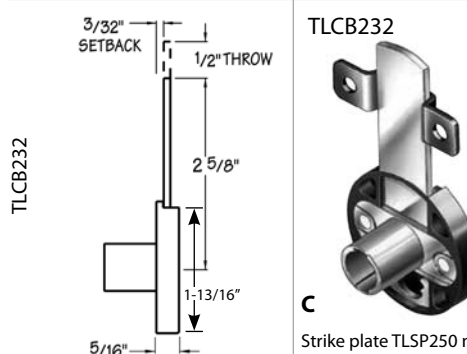

TLCB232



C

Strike plate TLSP250 not included

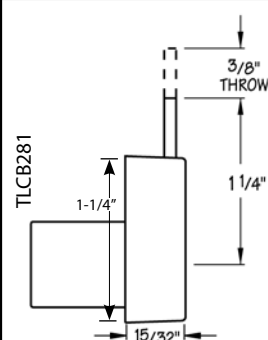

TLCB281

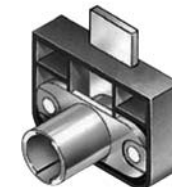

G

**ORDER LOCK
PLUG & STRIKE
SEPARATELY,
SEE PAGE D-15**

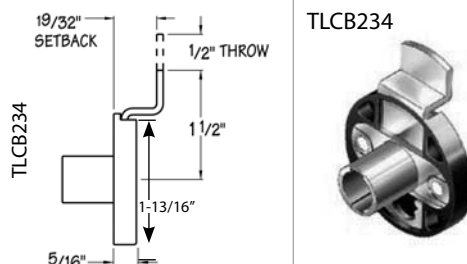

TLCB234



D

	Item#	Cylinder Length	Cam Setback	Cam Extension	Cam Throw	Box Qty
A	TLCB230	3/4"	3/32"	15/16"	1/2"	25
B	TLCB231	3/4"	3/32"	1-3/8"	1/2"	25
C	TLCB232	3/4"	3/32"	2-5/8"	1/2"	25
D	TLCB234	3/4"	19/32"	1-1/2"	1/2"	25
E	TLCB235	3/4"	7/8"	1-1/2"	1/2"	25
F	TLCB280	3/4"	9/32"	13/16"	3/8"	25
G	TLCB281	3/4"	9/32"	1-1/4"	3/8"	25

SECTION D CABINET LOCKS & LATCHES

DEADBOLT LOCK CYLINDER BODIES

DEADBOLT LOCKS, VERTICAL MOUNT

Mounts in 3/4" Material

- Surface mounted lock for locking doors
- All locks have 3/4" long cylinders
- Requires 16.5mm diameter bore hole
- 180° key rotation
- Key removable in both locked and unlocked positions
- Tough nylon housing

Packing: As shown below.

Sold in: Both broken and full box quantities. Discount available for full box orders.



Applications:

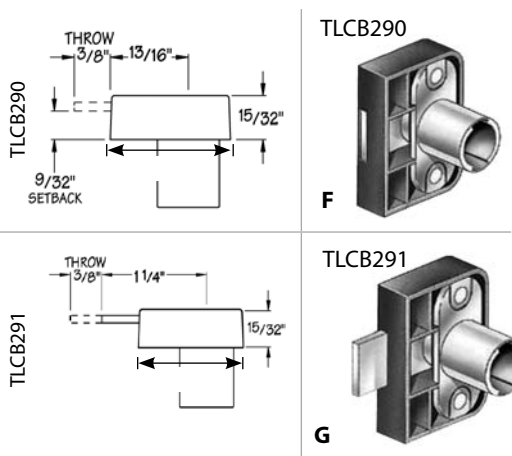
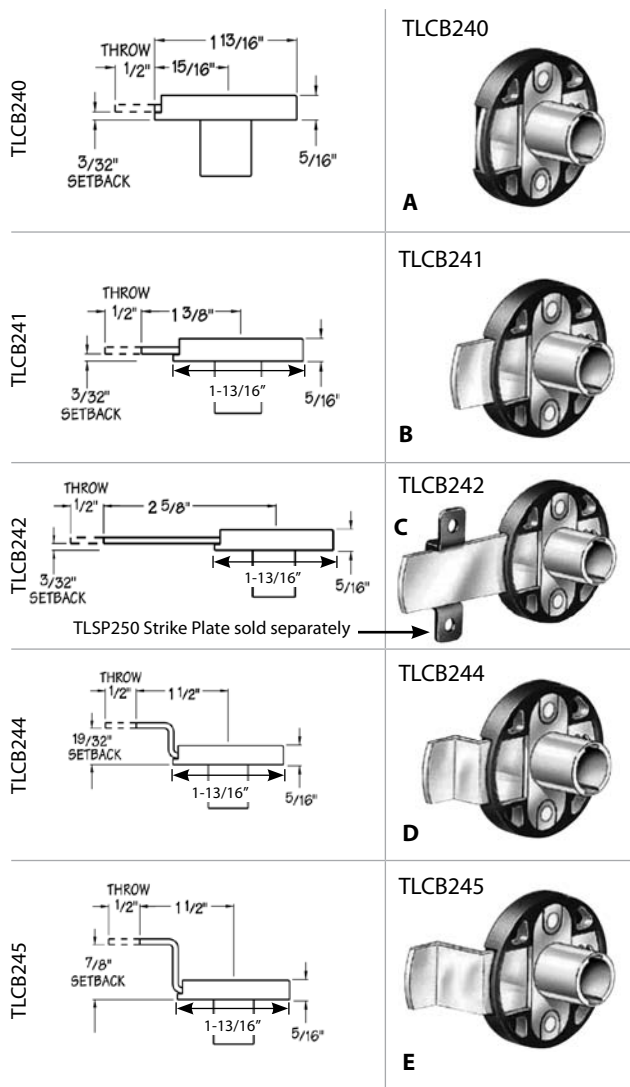
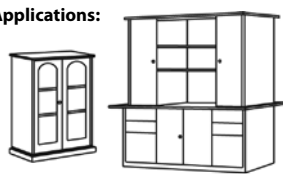

	Item#	Cylinder Length	Cam Setback	Cam Extension	Cam Throw	Box Qty
A	TLCB240	3/4"	3/32"	15 15/16"	1/2"	25
B	TLCB241	3/4"	3/32"	1-3/8"	1/2"	25
C	TLCB242	3/4"	3/32"	2-5/8"	1/2"	25
D	TLCB244	3/4"	19/32"	1-1/2"	1/2"	25
E	TLCB245	3/4"	7/8"	1-1/2"	1/2"	25
F	TLCB290	3/4"	9/32"	13 13/16"	3/8"	25
G	TLCB291	3/4"	9/32"	1-1/4"	3/8"	25



**ORDER LOCK PLUG & STRIKE
SEPARATELY, SEE PAGE D-15**

DOUBLE DOOR CYLINDER BODY Mounts in 3/4" Material

- Timberline Type 250 Double Door Lock
- Surface mounted lock for locking two adjacent doors
- Locks both doors without the use of a spring catch
- Works with either overlay or inset doors
- Requires 16.5mm diameter bore hole
- Turn key counter-clockwise to lock
- Key removable in both locked and unlocked positions
- TLSP100 and TLSP257 strike plates sold separately (1 of each required per lock)

Packing: As shown below.

Sold in: Both broken and full box quantities.

Discount available for full box orders.

Applications:

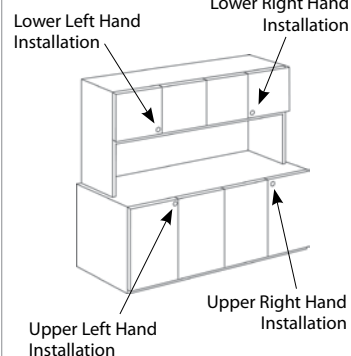

CompX
TIMBERLINE

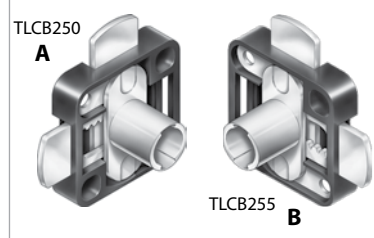

**ORDER LOCK PLUG
SEPARATELY, SEE PAGE D-15**

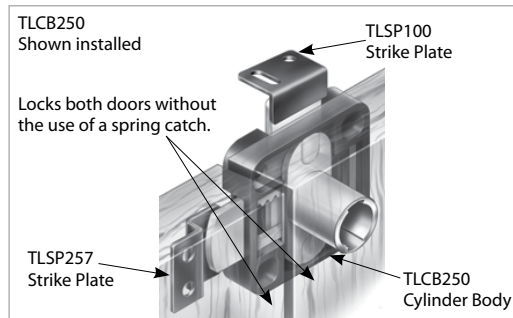
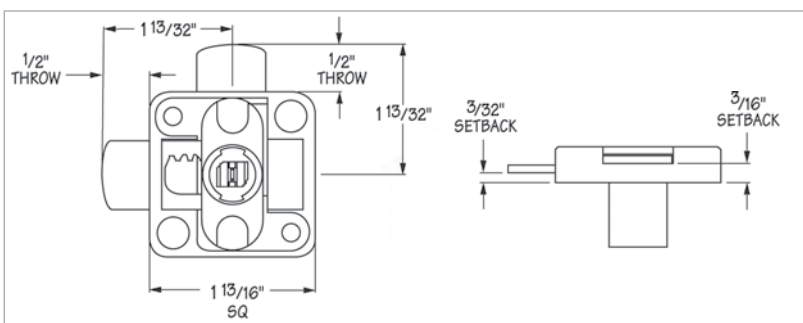

	Item#	Description	Application	Box Qty
A	TLCB250	Double Door Lock	Lower left hand or upper right hand installation	25
B	TLCB255	Opposite Mount Double Door Lock	Lower right hand or upper left hand installation	25

Item #	Description	Box Qty
TLSP100	Strike Plate, Black	25
TLSP100-BN	Strike Plate, Bright Nickel	25
TLSP257	Strike Plate, Black	25
TLSP257-BN	Strike Plate, Bright Nickel	25

WARDROBE LOCK CYLINDER BODY Mounts in 3/4" Material

- For use on vertical wardrobe doors
- Full 1/2" wardrobe bar throw
- Center line of lock must be minimum of 1" from edge of door
- 16.5mm lock hole only machining required
- Wardrobe bars stocked in standard sizes as shown below; can be cut to size by user
- Wardrobe bar supports should be used every 18"

Packing: As shown below.

Sold In: Both broken and full box quantities. Discount available for full box orders.

**ORDER LOCK PLUG & STRIKE
SEPARATELY, SEE PAGE D-15**

CompX
TIMBERLINE

	Item#	Description	Box Qty
A	TLCB260	Wardrobe Lock Cylinder Body	25
	TLWB240	24" Wardrobe Bar	10
B	TLWB360	36" Wardrobe Bar	10
	TLWB480	50" Wardrobe Bar	10
C	TLSP260	Wardrobe Bar Support	100
	TLSP101	Strike Plate, Black	100
D	TLSP101-BN	Strike Plate, Bright Nickel	100

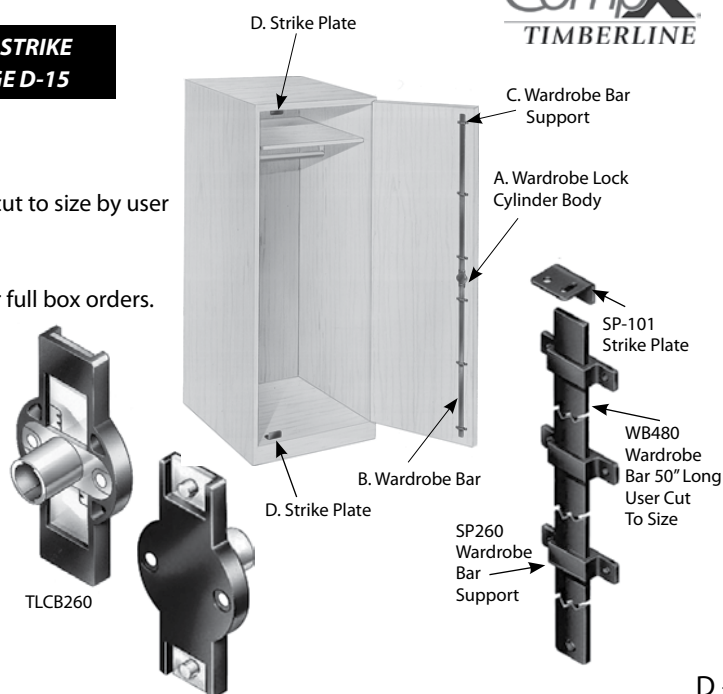

SECTION D CABINET LOCKS & LATCHES

GANG LOCK CYLINDER BODIES

TWO DRAWER GANG LOCK SIDE MOUNT FOR TWO DRAWERS

Mounts in 3/4" Material

- Timberline System 270
- Full 1/2" lockbar throw
- Fits within 1/2" drawer slide clearance
- Lock mounted in side panel
- Lock hole is only machining required
- Not recommended for face frame applications

Packing: As shown below.

Sold In: Both broken and full box quantities.

Discount available for full box orders.

**ORDER LOCK PLUG
& STRIKE SEPARATELY,
SEE PAGE D-15**

Item #	Description	Cylinder Length	Box Qty
TLCB270	Cylinder Body	3/4"	25
TLDC500	Drawer Locking Clip	-	25

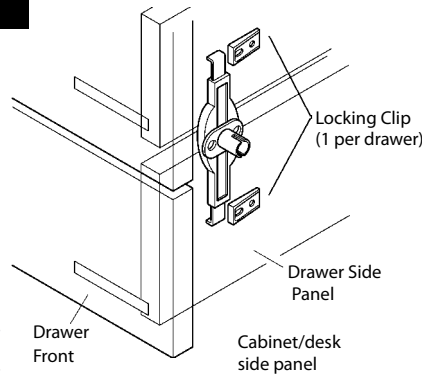
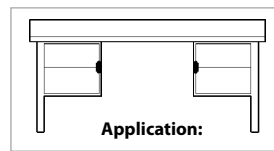

CompX
TIMBERLINE

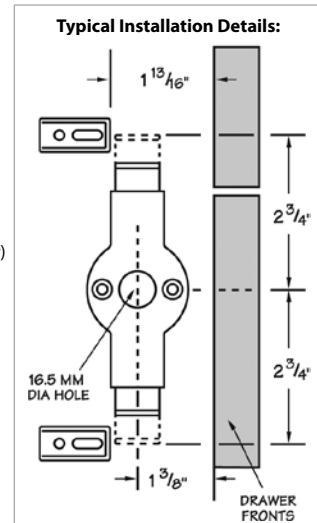

MULTIPLE DRAWER GANG LOCK FRONT TOP RAIL MOUNT

Mounts in 3/4" Material

- Timberline System 100 is designed to have lock cylinder mount into fixed cabinet top rail
- Lockbar stocked in four standard lengths; can be cut to size by user

Packing: As shown below.

Sold In: Both broken and full box quantities.

Discount available for full box orders.

	Item #	Description	Cylinder Length	Box Qty
A	TLCB100	Cylinder Body	3/4"	100
B	TLLC100	Lockbar Clip	-	25
C	TLLB120	Lockbar, 18"	-	10
	TLLB240	Lockbar, 24"	-	10
	TLLB360	Lockbar, 36"	-	10
	TLLB480	Lockbar, 48"	-	10
D	TLAP037	Adjustable Pin, 3/8"	-	100
E	TLLR100	Lockbar Retainer	-	100
F	TLDC500	Drawer Locking Clip	-	25

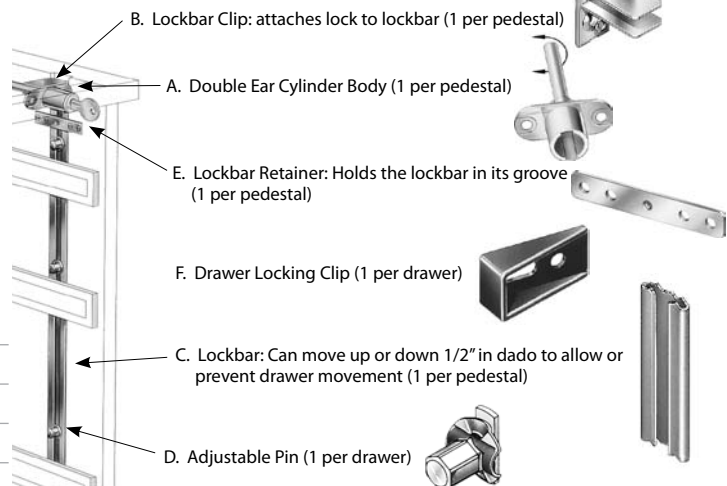

CompX
TIMBERLINE

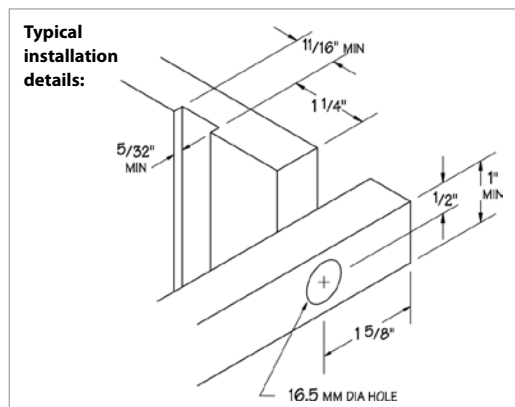

**ORDER LOCK PLUG & STRIKE
SEPARATELY, SEE PAGE D-15**

MULTIPLE DRAWER GANG LOCK, DRAWER FRONT MOUNT

For use with Hanging Files, 3/4" Material



- Timberline System 101 is designed to have lock cylinder mounted in drawer front
- Minimizes interference with hanging files
- Full 1/2" lockbar throw
- Fits within 1/2" drawer slide clearance
- Minimal machining required; drawer front hole for lock and cabinet groove for lockbar
- Lockbar stocked in four standard lengths as shown below; can be cut to size by user
- Lockbar must be restrained from dropping when in the locked position

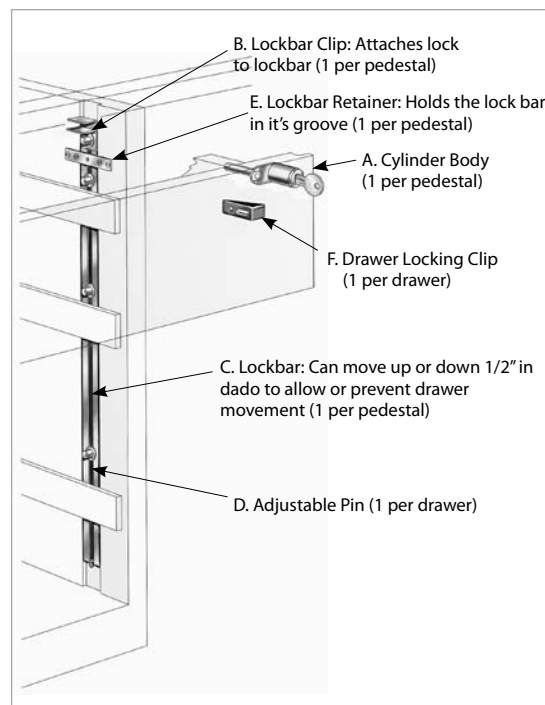
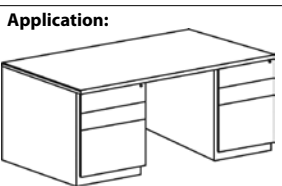

Packing: As shown below.

Sold In: Both broken and full box quantities.

Discount available for full box orders.

	Item #	Description	Cylinder Length	Box Qty
A	TLCB101	Cylinder Body	3/4"	100
B	TLLC106	Lockbar Clip	-	25
C	TLLB120	Lockbar, 18"	-	10
	TLLB240	Lockbar, 24"	-	10
	TLLB360	Lockbar, 36"	-	10
	TLLB480	Lockbar, 48"	-	10
D	TLAP037	Adjustable Pin, 3/8"	-	100
E	TLLR100	Lockbar Retainer	-	100
F	TLDC500	Drawer Locking Clip	-	25

Typical Installation Details:

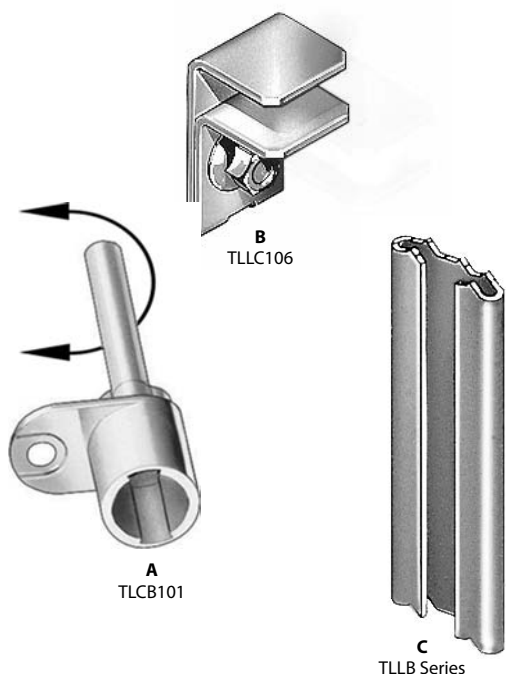
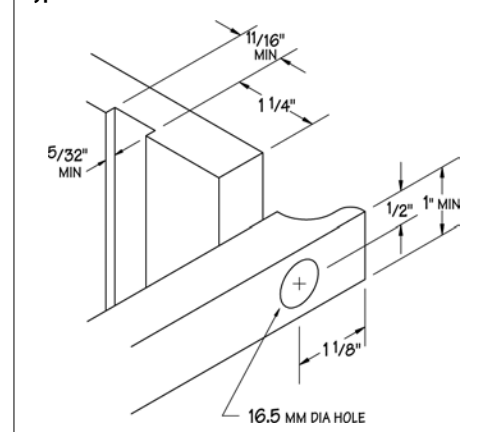

**ORDER LOCK PLUG & STRIKE SEPARATELY,
SEE PAGE D-15**

SECTION D CABINET LOCKS & LATCHES

GANG LOCK CYLINDER BODIES

MULTIPLE DRAWER GANG LOCK, SIDE MOUNT For 3/4" Material



- Timberline System 150
- Full 1/2" lockbar throw
- Fits within 1/2" drawer slide clearance
- Lock cylinder length is 3/4" and mounted in side panel
- Minimal machining required; hole for lock and groove for lockbar
- Lockbar stocked in standard sizes as shown below; can be cut to size by user

Packing: As shown below.

Sold In: Both broken and full box quantities.

Discount available for full box orders.

	Item #	Description	Cylinder Length	Box Qty
A	TLCB150	Cylinder Body	3/4"	25
B	TLLC150	Lockbar Clip	-	25
C	TLLB120	Lockbar, 18"	-	10
	TLLB240	Lockbar, 24"	-	10
	TLLB360	Lockbar, 36"	-	10
	TLLB480	Lockbar, 48"	-	10
D	TLAP037	Adjustable Pin, 3/8"	-	100
E	TLLR100	Lockbar Retainer	-	100
F	TLDC500	Drawer Locking Clip	-	25

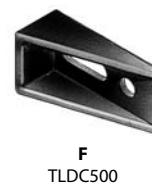
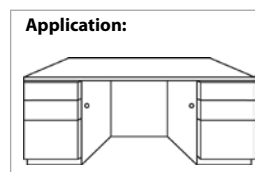
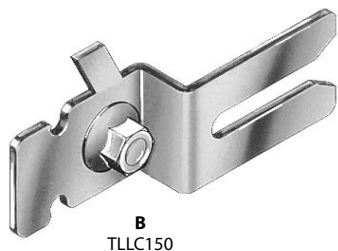
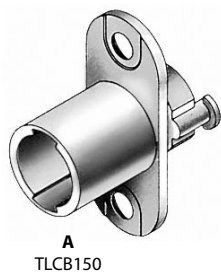
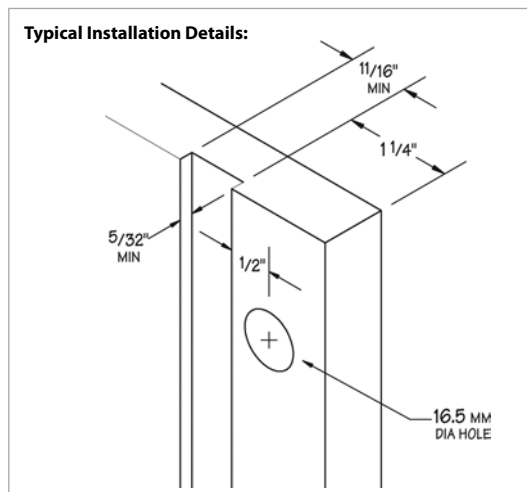
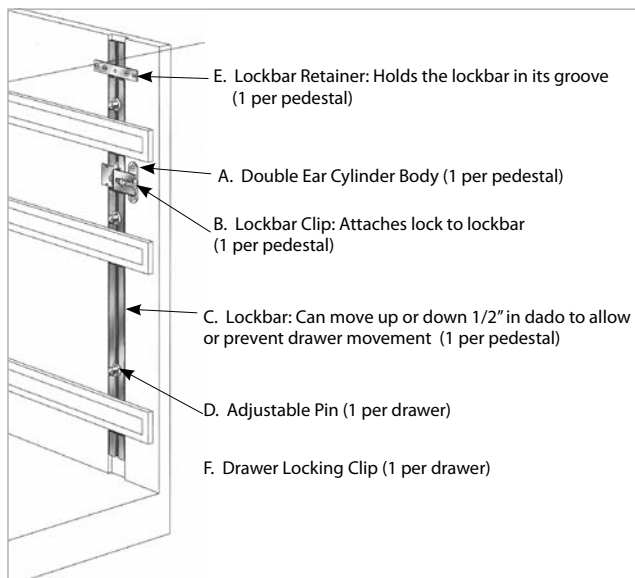

**ORDER LOCK PLUG & STRIKE SEPARATELY,
SEE PAGE D-15**

GLASS DOOR LOCKS

Bore Hole, No Bore Hole & Double Door

CompX
TIMBERLINE



**BORE HOLE STYLE
VERTICAL MOUNT**

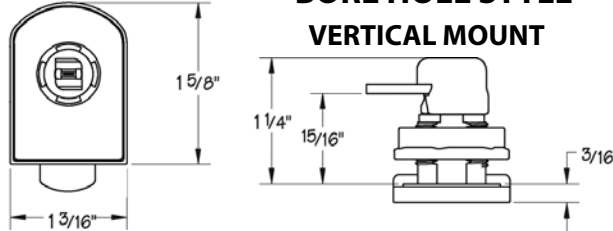

Application:

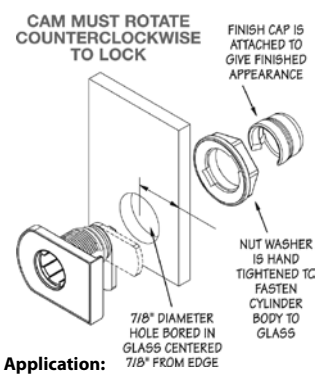



HORIZONTAL MOUNT

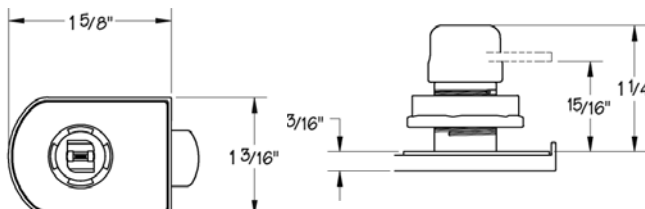

Details on next page →



**NO BORE HOLE STYLE
VERTICAL MOUNT**

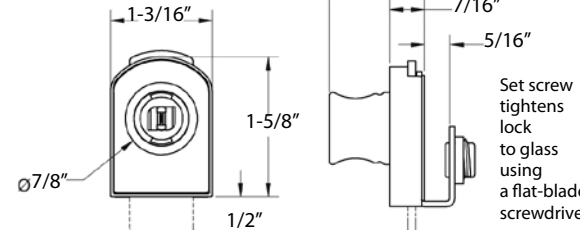

Application:

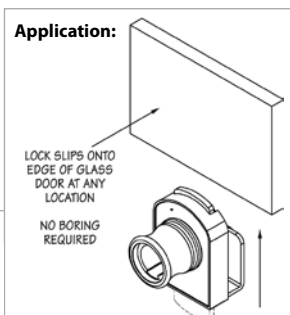



HORIZONTAL MOUNT

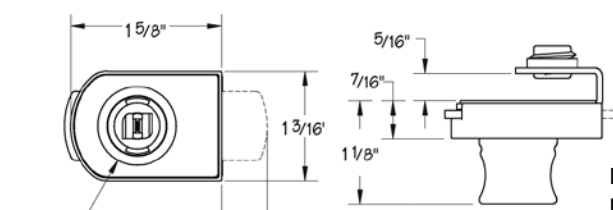

Details on next page →



DOUBLE GLASS DOOR LOCK STYLE

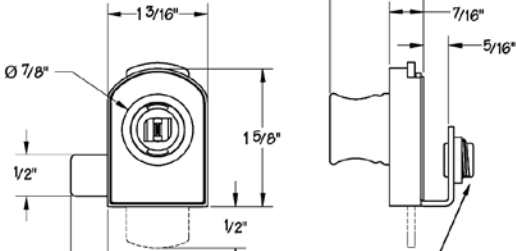

SET SCREW TIGHTENS LOCK TO GLASS DOOR

**ORDER LOCK PLUG & STRIKE
SEPARATELY, SEE PAGE D-15**

SECTION D CABINET LOCKS & LATCHES

GLASS DOOR LOCKS

BORE STYLE, GLASS DOOR LOCK For Glass Doors Up To 3/8" Thick



- Designed for swing style doors
- Fully cushioned lock clamping to avoid glass damage
- Horizontal and vertical mount styles lock to side or bottom of cabinet, respectively
- Lock has 2 piece design for quick mounting-user does not need to assemble cam
- Vertically mounts in glass doors up to 3/8" thick
- Requires 7/8" diameter hole bored in glass centered 7/8" from edge
- Cam must rotate counter clockwise to lock with an extension of 7/8" and a setback of 15/16"
- Available in three lock finishes
- Strike plate sold separately
- Finish cap is attached to give finished appearance

Packing: As shown below.

Sold in: Both broken and full box quantities.

Discount available for full box orders.

Item#	Description	Finish	Box Qty
VERTICAL MOUNT			
TLCB311	Lock Body	Bright Nickel	10
TLCB315	Lock Body	Brass	10
TLCB317	Lock Body	Satin Nickel	10
HORIZONTAL MOUNT			
TLCB301	Lock Body	Bright Nickel	10
TLCB305	Lock Body	Brass	10
TLCB307	Lock Body	Satin Nickel	10
STRIKE PLATES			
TLSP185	Strike Plate	Black	25
TLSP185-BN	Strike Plate	Bright Nickel	25

NO BORE STYLE, GLASS DOOR LOCK For 1/4" - 5/16" Thick Glass Doors



- Designed for swing style doors
- Non-bore glass door locks – lock slips onto edge of glass door at any location
- Lock is fully cushioned to avoid glass damage
- Horizontal and vertical mount styles lock to side or bottom of cabinet, respectively
- Strike plate sold separately
- Lock throw is 1/2"
- Available in three finishes
- Vertically or horizontally mounts on glass doors from 1/4" – 5/16" thick

Packing: As shown below.

Sold in: Both broken and full box quantities.

Discount available for full box orders.

Item#	Description	Finish	Box Qty
VERTICAL MOUNT			
TLCB361	Lock Body	Bright Nickel	10
TLCB365	Lock Body	Brass	10
TLCB367	Lock Body	Satin Nickel	10
HORIZONTAL MOUNT			
TLCB351	Lock Body	Bright Nickel	10
TLCB355	Lock Body	Brass	10
TLCB357	Lock Body	Satin Nickel	10
STRIKE PLATES			
TLSP185	Strike Plate	Black	25
TLSP185-BN	Strike Plate	Bright Nickel	25

DOUBLE GLASS DOOR LOCK For 1/4" - 5/16" Thick Glass Doors



- Designed for swing style doors when left and right doors locking simultaneously is desired
- Non-bore glass door locks – lock slips onto edge of glass door at any location
- Fully cushioned lock to avoid glass damage
- Two lock throws extend 1/2" from bottom and left (as you face the lock) side of lock housing
- Strike plate sold separately
- Vertically mounts on glass doors from 1/4" – 5/16" thick

Packing: As shown below.

Sold in: Both broken and full box quantities.

Item#	Description	Finish	Box Qty
TLCB371	Lock Body	Bright Nickel	10
TLCB375	Lock Body	Brass	10
TLCB377	Lock Body	Satin Nickel	10
STRIKE PLATES			
TLSP185	Strike Plate	Black	25
TLSP185-BN	Strike Plate	Bright Nickel	25

SLIDING DOOR PUSH LOCK CYLINDER BODY

Mounts in 3/4" Material

- For locking sliding, bypass type doors
- Requires 3/4" diameter hole in front door for cylinder
- Pushing in cylinder locks doors, with or without key; 45° key rotation allows cylinder to pop back out to unlock doors
- Lock throw length is 5/16"
- Optional TLBZ110 finish cup for back door requires 1/2" hole

Packing: As shown below.

Sold in: Both broken and full box quantities.

Discount available for full box orders.

CompX
TIMBERLINE



**ORDER LOCK PLUG & STRIKE
SEPARATELY, SEE PAGE D-15**

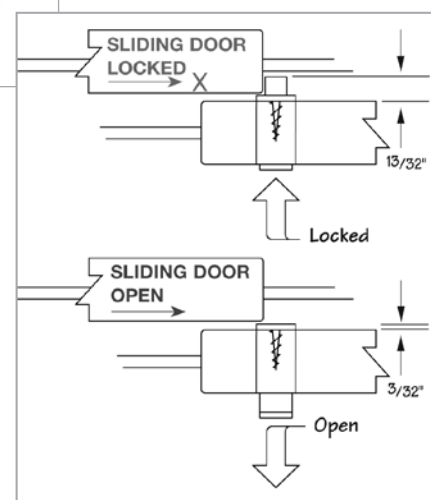

Item#	Description	Cylinder Length	Box Qty
TLCB175	Cylinder Body	3/4"	25
TLBZ110	Optional Finish Cup, Nickel Finish	-	25



TLBZ110

Application:

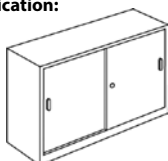

FLIPPER/TAMBOUR DOOR CYLINDER BODY, HORIZONTAL MOUNT

Mounts 3/4" Material

- Cam lock with hooked cam for horizontal flipper or tambour doors
- Lock must be mounted counter-clockwise to lock
- Cylinder length is 3/4"
- Requires 16.5mm diameter bore hole
- TLSP181 Strike Plate sold separately

Packing: As shown below.

Sold in: Both broken and full box quantities.

Discount available for full box orders.

CompX
TIMBERLINE

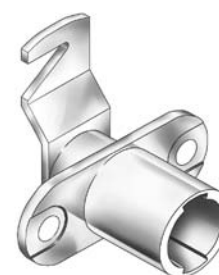
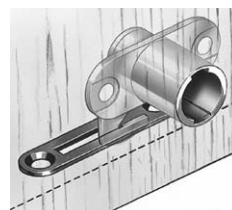

Applications:

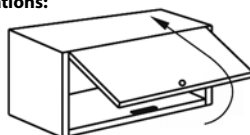

**ORDER LOCK PLUG & STRIKE
SEPARATELY, SEE PAGE D-15**

Item#	Description	Cylinder Length	Set-back	Cam Rotation	Cam Extension	Box Qty
TLCB181	Cylinder Body	3/4"	13/32"	180°	29/32"	25
TLSP181	Strike Plate, Black	-	-	-	-	25
TLSP181-BN	Strike Plate, Bright Nickel	-	-	-	-	25

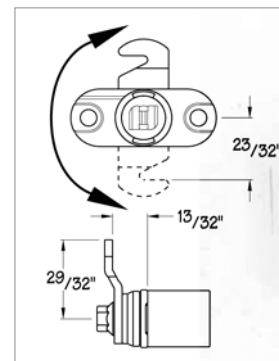

SECTION D CABINET LOCKS & LATCHES

TIMBERLINE LOCK ACCESSORIES

MASTER KEYED LOCK PLUGS

- All lock plugs shown will work with all Timberline cylinder bodies described on pages D-3 through D-14
- Choose lock plug based on finish and key numbers your job requires
- Key number coded on face and keys (two keys included with each lockplug)
- All lock plugs are masterkeyed (masterkeys sold separately on page D-16)
- Additional key numbers available **SPECIAL ORDER**

Packing: 100 per box.

Sold In: Both broken and full box quantities. Discount available for full box orders.



Key#	Bright Nickel Item#	Antique English Item#	Black Item #	Statuary Bronze Item#	Bright Brass Item #	Satin Nickel Item #
Keyed Different	TLLP100KD	-	TLLP300KD	-	-	TLLP700KD
100TA	TLLP100-100TA	TLLP200-100TA	TLLP300-100TA	TLLP400-100TA	TLLP500-100TA	TLLP700-100TA
101TA	TLLP100-101TA	TLLP200-101TA	TLLP300-101TA	TLLP400-101TA	TLLP500-101TA	TLLP700-101TA
102TA	TLLP100-102TA	TLLP200-102TA	TLLP300-102TA	TLLP400-102TA	TLLP500-102TA	TLLP700-102TA
103TA	TLLP100-103TA	TLLP200-103TA	TLLP300-103TA	TLLP400-103TA	TLLP500-103TA	TLLP700-103TA
104TA	TLLP100-104TA	TLLP200-104TA	TLLP300-104TA	TLLP400-104TA	TLLP500-104TA	TLLP700-104TA
105TA	TLLP100-105TA	TLLP200-105TA	TLLP300-105TA	TLLP400-105TA	TLLP500-105TA	TLLP700-105TA
106TA	TLLP100-106TA	TLLP200-106TA	TLLP300-106TA	TLLP400-106TA	TLLP500-106TA	TLLP700-106TA
107TA	TLLP100-107TA	TLLP200-107TA	TLLP300-107TA	TLLP400-107TA	TLLP500-107TA	TLLP700-107TA
108TA	TLLP100-108TA	TLLP200-108TA	TLLP300-108TA	TLLP400-108TA	TLLP500-108TA	TLLP700-108TA
109TA	TLLP100-109TA	TLLP200-109TA	TLLP300-109TA	TLLP400-109TA	TLLP500-109TA	TLLP700-109TA
110TA	TLLP100-110TA					
111TA	TLLP100-111TA					
112TA	TLLP100-112TA					
113TA	TLLP100-113TA					
114TA	TLLP100-114TA					
115TA	TLLP100-115TA					
116TA	TLLP100-116TA					
117TA	TLLP100-117TA					
118TA	TLLP100-118TA					
119TA	TLLP100-119TA					
120TA	TLLP100-120TA					

STRIKE PLATES

- Strike plates are sold without screws
- TLSP181 and TLSP185 use #6 x 1/2" Flathead screws
- All others use #6 x 1/2" Panhead screws

Packing: As shown below.

Sold in: Both broken and full box quantities.
Discount available for full box orders.



	Black Finish Box Qty: 25 Item #	Bright Nickel Finish Box Qty: 25 Item #
A	TLSP100	TLSP100-BN
B	TLSP101	TLSP101-BN
C	TLSP181	TLSP181-BN
D	TLSP185	TLSP185-BN
E	TLSP250	TLSP250-BN
F	TLSP251	TLSP251-BN
G	TLSP255	TLSP255-BN
H	TLSP256	TLSP256-BN
I	TLSP257	TLSP257-BN
J	TLSP258	TLSP258-BN

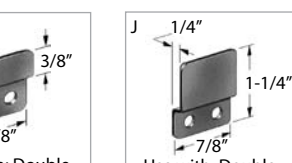
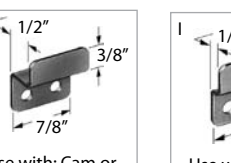
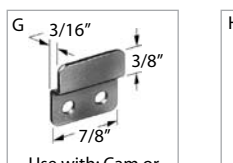
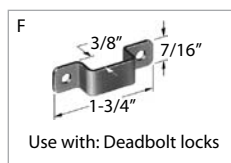
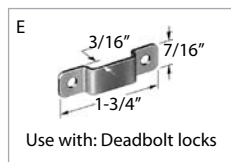
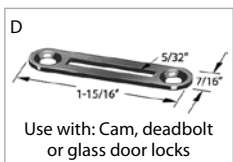
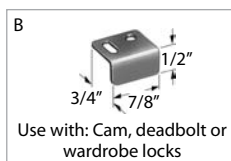
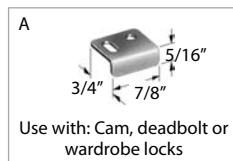

TIMBERLINE KEYS

Packing: As shown below.

Sold in: Both broken and full box quantities.

Discount available for full box orders.

Item#	Description	Box Qty
TLKY500	Lock plug change key required to remove lock plugs from cylinder bodies	5
TLKY101	Masterkey for use with Timberline locks	10

CompX
TIMBERLINE

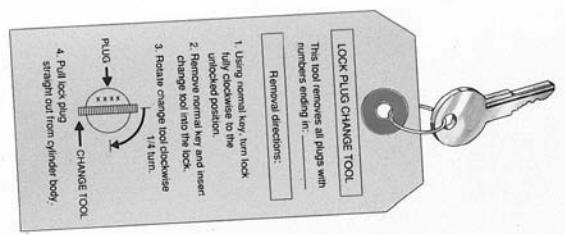

BEZELS

- Allows cylinder bodies to be used with 3/4" through 7/8" diameter holes
- Permits use of locks in 7/8" thick panels

Packing: As shown below.

Sold in: Both broken and full box quantities.

Discount available for full box orders.

Item#	Finish	Box Qty
TLBZ100	Nickel	25
TLBZ200	Old English	25
TLBZ300	Black	25
TLBZ400	Statuary Bronze	25
TLBZ500	Brass	25
TLBZ700	Satin Nickel	25

CompX
TIMBERLINE



SPACER

- Allows cam lock cylinder bodies to be used in 5/8" thick panels

Packing: As shown below.

Sold in: Both broken and full box quantities.

Discount available for full box orders.

Item#	Box Qty
TLSP300	25

CompX
TIMBERLINE



FINISHING CAP For Use With Timberline Cylinder Bodies

- Covers cylinder body during finishing before installing lock plugs
- Allows finishing to take place without masking

Packing: As shown below.

Sold in: Full box quantity only.

Item#	Box Qty
TLCC100	100

CompX
TIMBERLINE



DRILL BIT

For use with Timberline
Cylinder Bodies

- 16.5mm drill bit
- 10mm shank diameter
- Drills the proper diameter hole for most Timberline cylinder bodies

Packing: Each

Item#
TLDB165

CompX
TIMBERLINE

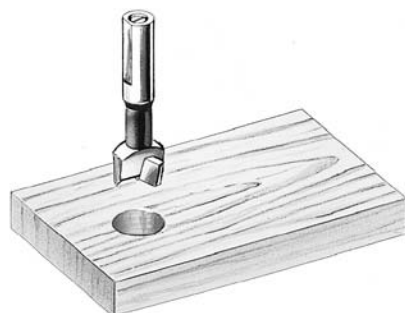

TIMBERLINE TOOL

- Installs adjustable lock pins
- Rotates cylinder bodies and prevents damage to snap fitting
- Cam replacement tool

Packing: Each

Item#
TLTL100

CompX
TIMBERLINE



COMPX NATIONAL DOOR LOCKS - A LOCK.....OR IS IT?

Understanding the World of Cabinet Locks



DISC TUMBLER, PIN TUMBLER, AND DEADBOLT LOCKS:

Disc Tumbler Cam Locks, sometime referred to as “wafer locks” are inexpensive, low security locks with limited keying capabilities. Master keying for disc tumbler locks is limited to only one level. The disc tumbler lock consists of chambers with only one disc per chamber which raises or lowers as the key passes through the window that is cut into the disc. Disc tumblers are not intended for high-use or high security applications because they wear out quicker and are easier to bypass than pin tumbler locks.

Pin Tumbler Cam Locks are medium security utility locks that have greater keying capabilities. In commercial applications where large numbers of locks will be installed within a facility, pin tumbler locks are typically used because they allow the more complex master keying required in larger institutional settings such as schools, banks, and hospitals.

The pin tumbler consists of chambers that contain at least two pins per chamber which raise or lowers as the key passes through. This type of lock is harder to bypass than disc tumbler locks.

Deadbolt Locks are typically longer lasting than disc tumbler locks. A cam lock is chosen many times because it is the least expensive and most versatile alternative available. But cam locks do not stand up to heavy use or provide the same level of security as a lock dedicated specifically for a door or drawer application. Dedicated door and drawer locks have a heavy duty deadbolt to secure the cabinet—a cam lock's security is only as good as the screw which holds the cam in place.

UNDERSTANDING KEYED LOCKS:

1. Keyed Different: (KD) All locks in the item number will have a different key number. Each set of keys will only work with the lock it was supplied with. When ordering Keyed Different (KD) locks from our stock you do not need to choose a key number nor will you be able to specify a key number. The only way to specify certain key numbers is through **SPECIAL ORDER**. An example of an item number for keyed different lock is NLC8173KD-26D. The KD in the part number denotes every lock you receive will have a different key number; **master keys will not work on these locks**.

2. Keyed Alike: (KA) All locks in the item number will have the same key number. Each set of keys will work with ALL locks ordered with the same key number. An example of an item number for keyed different lock is NLC8053KA415-14A. The KA in the part number denotes every lock you receive will have the same key number. There is no need for a master key with these locks as they will all open with each others' key.

3. Keyed Different, Master Keyed: (KDMKD) All locks in the item number will have a different key number. Each set of keys will only work with the lock it was supplied with. A Master Key (sold separately) will open all locks ordered. An example of an item number for keyed different lock is NLC8053KDMKD-14A. The KDMKD in the item number denotes every lock you receive will have a different key number, but you can order a Master Key which will open them all.

4. Keyed Alike, Master Keyed – SPECIAL ORDER ONLY

(KAMKD) Used when locks are required to be keyed alike within groups and a different key number is required for each group. A Master Key (sold separately) will open all locks ordered.

UNDERSTANDING KEY NUMBER PATTERNS:

When ordering a Keyed Alike (KA) lock the key numbers we stock will be listed on the page. If you require a key number other than the ones shown it will need to be **SPECIAL ORDERED**.

Matching Existing Locks: When you ordering a new lock or new groups of keyed alike locks to match existing locks you need to be sure to order the same key number that you already have in order for your locks and keys to all work together.

Original Installation or Replacing Existing Locks: If you are doing an original installation or replacing existing locks, meaning there is no need to match existing key numbers, the key number you receive will have no effect on the application of the locks. The most common key numbers we sell are #415 for disc tumbler locks and #915 for pin tumbler locks.

UNDERSTANDING MASTER KEYS:

When ordering a master keyed (MKD) lock you must know at the time you place your order that a master key is going to be necessary with the locks. A master key only works on locks preset from the factory to allow the use of a master key. Ordering a master key for a lock you already have will not work unless the lock was previously set to accept a master key. **Remember, it is the lock that allows a master key to work, not the key itself.**

UNASSEMBLED DISC TUMBLER CAM LOCKS

CABINET LOCKS & LATCHES



REMOVACORE™ HOUSINGS AND PLUGS

Masterkeyed

- 90° Cam turn locks come with one stop washer allowing cam to turn 90°; 90° and 180° Cam turn locks come with two stop washers to allow cam to turn either 90° or 180° based on application
- Removacore locks are factory masterkeyed
- Once assembled, the masterkey for the Removacores will open any pre-assembled disc tumbler from CompX National that is factory masterkeyed (KAMKD or KDMKD)
- For drawers, RH or LH doors either lipped, flush or overlay
- Separate core plug and cylinder assembly (lock housing)
- Requires 3/4" diameter hole for installation
- Key removable in lock and unlocked positions
- Control key is required to install core plugs into cylinder assembly
- Plugs supplied with 2 keys. Housing supplied with trim washer, spur washer (for wood), mounting nuts and two cams (Straight: 1-1/2" extension; Formed: 1-1/8" extension and 11/32" offset)
- Cannot mix assembled locks (i.e. C8053) with this product, they are not master keyed



NOTE: Order core plug, cylinder assembly and control key separately.

Packing: As shown below.

Sold in: Both broken and full box quantities. Discount available for full box orders.

Item#	Cylinder Length	Max Material Thickness	Keying	Cam Turn	Finish	Same as Assembled Lock	Page #	Box Qty
CYLINDER ASSEMBLIES ONLY								
NLM57054B-14A	15/16"	5/8"	-	90°	Bright Nickel	NLC8054	19	25
NLM57054C-4G	1-3/16"	7/8"	-	90°	Antique Brass	NLC8053	19	25
NLM57054C-3	1-3/16"	7/8"	-	90°	Bright Brass	NLC8053	19	25
NLM57054C-14A	1-3/16"	7/8"	-	90°	Bright Nickel	NLC8053	19	25
NLM57054L-4G	1-7/16"	1-1/8"	-	90°	Antique Brass	NLC8055	19	25
NLM57054L-14A	1-7/16"	1-1/8"	-	90°	Bright Nickel	NLC8055	19	25
NLM57054N-3	1-3/4"	1-7/16"	-	90° & 180°	Bright Brass	NLC8060	20	25
NLM57054N-14A	1-3/4"	1-7/16"	-	90° & 180°	Bright Nickel	NLC8060	20	25
CORE PLUGS FOR ABOVE CYLINDER ASSEMBLIES								
NLM47054KA346-14A	-	-	Keyed Alike Masterkeyed	-	Bright Nickel	-	-	25
NLM47054KA390-14A	-	-		-	Bright Nickel	-	-	25
NLM47054KA413-14A	-	-		-	Bright Nickel	-	-	25
NLM47054KA415-14A	-	-		-	Bright Nickel	-	-	25
NLM47054KA642-14A	-	-		-	Bright Nickel	-	-	25
NLM47054KD-14A	-	-	Keyed Different Masterkeyed	-	Bright Nickel	-	-	25
NLM47054KD-3	-	-	Keyed Different Masterkeyed	-	Bright Brass	-	-	25
NLM47054KA415-4G	-	-	Keyed Alike Masterkeyed	-	Antique Brass	-	-	25
MASTERKEY								
NLD8799-E41A	-	-	-	-	-	-	-	25
CONTROL KEY								
NLM50601116-41A	-	-	-	-	-	-	-	25

SECTION D CABINET LOCKS & LATCHES

DISC TUMBLER CAM LOCKS

FOR DOOR AND DRAWERS

90° Cam Turn, Flush or Lipped/Overlay Construction



- Each lock comes with one stop washer which allows the cam to turn 90°
- For drawers, right-hand or left-hand doors
- Cams included for lipped/overlay construction (straight cam; 1-1/2" extension) or flush construction (formed cam; 1-1/8" extension, 11/32" offset)
- For overlay application, the combined thickness of front and frame cannot exceed the cylinder length listed below. To accommodate an overlay construction using a 3/4" front and a 3/4" frame, order the NLC8053 lock and the NLC7014-2C cam (see page D-27)
- Key removable in both locked and unlocked positions
- Supplied with two keys, trim washer, spur washer (for wood), mounting nut and two cams.
- Unassembled Removacore versions of this lock available on page D-18

• Stock Keying is specified on table below:

KA = All Keyed Alike to key number specified, master key will not work on these locks
 KD = All Keyed Different, various lock numbers, master key will not work on these locks
 KDMKD = All Keyed Different and master keyed, master key will work on these locks

- Other key changes available from National Lock via **SPECIAL ORDER**

Packing: 25 each per box.

Sold in: Both broken and full box quantities.

Discount available for full box orders.

Applications:

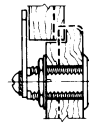

Lipped/Overlay construction with provided straight cam

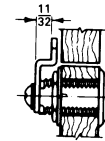

Flush construction with provided formed cam

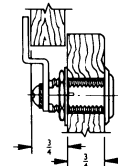

Thick door/drawer construction using NLC8053 with NLC7014-2C cam

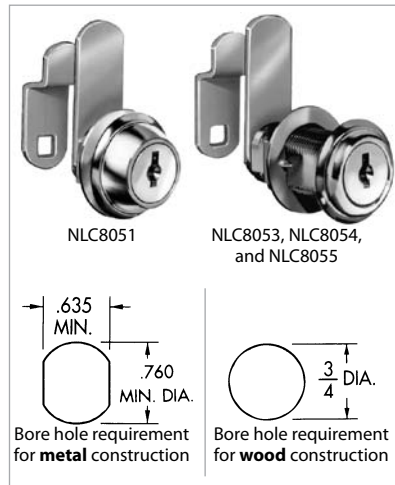
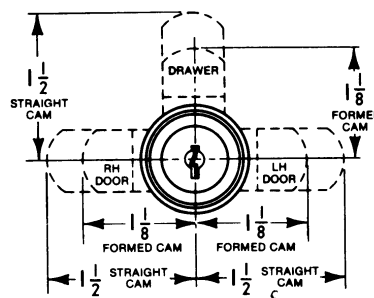

Keying	Cylinder Length	Max Material Thickness	Antique Brass Item #	Bright Brass Item #	Bright Nickel Item#
KA 415	7/16"	7/64"	-	-	NLC8051KA415-14A
KA 346	15/16"	5/8"	-	-	NLC8054KA346-14A
KA 413	15/16"	5/8"	-	-	NLC8054KA413-14A
KA 415	15/16"	5/8"	-	NLC8054KA415-3	NLC8054KA415-14A
KA 346	1-3/16"	7/8"	NLC8053KA346-4G	NLC8053KA346-3	NLC8053KA346-14A
KA 390	1-3/16"	7/8"	NLC8053KA390-4G	NLC8053KA390-3	NLC8053KA390-14A
KA 413	1-3/16"	7/8"	NLC8053KA413-4G	NLC8053KA413-3	NLC8053KA413-14A
KA 415	1-3/16"	7/8"	NLC8053KA415-4G	NLC8053KA415-3	NLC8053KA415-14A
KA 420	1-3/16"	7/8"	NLC8053KA420-4G	NLC8053KA420-3	NLC8053KA420-14A
KA 642	1-3/16"	7/8"	-	NLC8053KA642-3	NLC8053KA642-14A
KD	1-3/16"	7/8"	NLC8053KD-4G	NLC8053KD-3	NLC8053KD-14A
KDMKD	1-3/16"	7/8"	NLC8053KDMKD-4G	NLC8053KDMKD-3	NLC8053KDMKD-14A
KA 346	1-7/16"	1-1/8"	NLC8055KA346-4G	NLC8055KA346-3	NLC8055KA346-14A
KA 390	1-7/16"	1-1/8"	-	-	NLC8055KA390-14A
KA 413	1-7/16"	1-1/8"	-	NLC8055KA413-3	NLC8055KA413-14A
KA 415	1-7/16"	1-1/8"	NLC8055KA415-4G	NLC8055KA415-3	NLC8055KA415-14A
KA 420	1-7/16"	1-1/8"	-	NLC8055KA420-3	NLC8055KA420-14A
KA 642	1-7/16"	1-1/8"	-	NLC8055KA642-3	NLC8055KA642-14A
KD	1-7/16"	1-1/8"	NLC8055KD-4G	NLC8055KD-3	NLC8055KD-14A
KDMKD	1-7/16"	1-1/8"	-	NLC8055KDMKD-3	NLC8055KDMKD-14A

DISC TUMBLER CAM LOCKS

SECTION D CABINET LOCKS & LATCHES



FOR DOORS AND DRAWERS

90° & 180° Cam Turn, Flush or Lipped/Overlay Construction

- Each lock comes with two stop washers allowing cam to turn either 90° or 180° based on application
- For drawers, right-hand or left-hand doors
- Cams included for lipped/overlay construction (straight cam; 1-1/2" extension) or flush construction (formed cam; 1-1/8" extension, 11/32" offset)
- For overlay application, the combined thickness of front and frame cannot exceed the cylinder length listed below. To accommodate an overlay construction using a 3/4" front and a 3/4" frame, order the NLC8073 lock and the NLC7014-2C cam (see page D-27)
- Stop washers provided for both 90° or 180° cam turns
- Key removable in both locked and unlocked positions
- Supplied with two keys, trim washer, spur washer (for wood), mounting nut, two cams and two stop washers
- Unassembled Removacore versions of this lock available on page D-18
- **Stock Keying is specified on table below:**
KA = All Keyed Alike to key number specified, master key will not work on these locks
KD = All Keyed Different, various lock numbers, master key will not work on these locks
KDMKD = All Keyed Different and master keyed, master key will work on these locks
- Other key changes available from National Lock via **SPECIAL ORDER**

Packing: 25 each per box.

Sold in: Both broken and full box quantities. Discount available for full box orders.

Applications:

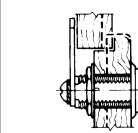

Lipped/Overlay construction with provided straight cam

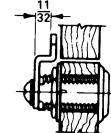

Flush construction with provided formed cam

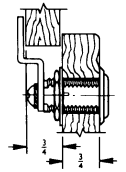

Thick door/drawer construction using NLC8073 with NLC7014-2C cam (sold separately)

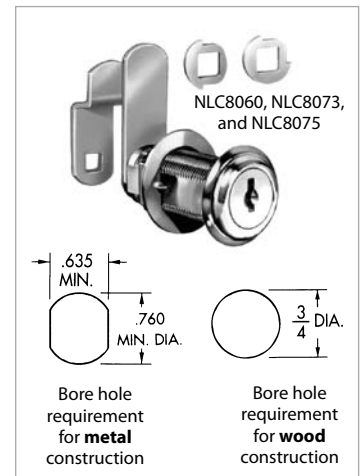
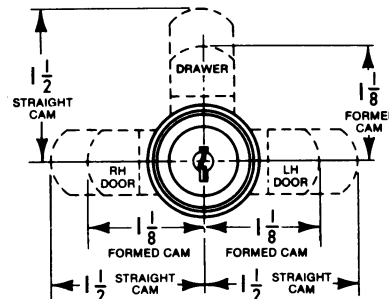

Keying	Cylinder Length	Max Material Thickness	Antique Brass Item #	Bright Brass Item #	Bright Nickel Item#
KA 346	1-3/4"	1-7/16"	NLC8060KA346-4G	NLC8060KA346-3	NLC8060KA346-14A
KA 390	1-3/4"	1-7/16"	-	NLC8060KA390-3	NLC8060KA390-14A
KA 413	1-3/4"	1-7/16"	-	NLC8060KA413-3	NLC8060KA413-14A
KA 415	1-3/4"	1-7/16"	NLC8060KA415-4G	NLC8060KA415-3	NLC8060KA415-14A
KA 420	1-3/4"	1-7/16"	-	NLC8060KA420-3	NLC8060KA420-14A
KA 642	1-3/4"	1-7/16"	-	NLC8060KA642-3	NLC8060KA642-14A
KD	1-3/4"	1-7/16"	-	NLC8060KD-3	NLC8060KD-14A
KDMKD	1-3/4"	1-7/16"	-	NLC8060KDMKD-3	NLC8060KDMKD-14A
KA 346	1-3/16"	7/8"	-	-	NLC8073KA346-14A
KA 390	1-3/16"	7/8"	-	-	NLC8073KA390-14A
KA 413	1-3/16"	7/8"	-	-	NLC8073KA413-14A
KA 415	1-3/16"	7/8"	NLC8073KA415-4G	NLC8073KA415-3	NLC8073KA415-14A
KA 420	1-3/16"	7/8"	-	-	NLC8073KA420-14A
KA 642	1-3/16"	7/8"	-	-	NLC8073KA642-14A
KD	1-3/16"	7/8"	-	-	NLC8073KD-14A
KA 346	1-7/16"	1-1/8"	-	-	NLC8075KA346-14A
KA 390	1-7/16"	1-1/8"	-	-	NLC8075KA390-14A
KA 413	1-7/16"	1-1/8"	-	-	NLC8075KA413-14A
KA 415	1-7/16"	1-1/8"	NLC8075KA415-4G	NLC8075KA415-3	NLC8075KA415-14A
KA 420	1-7/16"	1-1/8"	-	-	NLC8075KA420-14A
KA 642	1-7/16"	1-1/8"	-	-	NLC8075KA642-14A

SECTION D CABINET LOCKS & LATCHES

DISC TUMBLER CAM & SPRINGBOLT LOCKS

SURFACE MOUNTED FOR DOORS AND DRAWERS

90° and 180° Cam Turn, Flush or Lipped/Overlay Construction



- Each lock comes with two stop washers allowing cam to turn either 90° or 180° based on application
- For doors and drawers
- Stop washers provided for either 90° or 180° cam turn
- Key removable in both locked and unlocked positions
- Supplied with two keys, mounting screws, two formed cams (1-1/2" extension; 3/32" inset or 1/4" offset) and two stop washers

• Stock Keying is specified on table below:

KA = All Keyed Alike to key number specified, master key will not work on these locks

KD = All Keyed Different, various lock numbers, master key will not work on these locks

- Other key changes available from National Lock via **SPECIAL ORDER**

Packing: 25 each per box.

Sold In: Both broken and full box quantities. Discount available for full box orders.

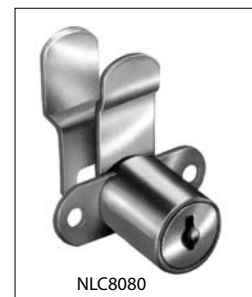
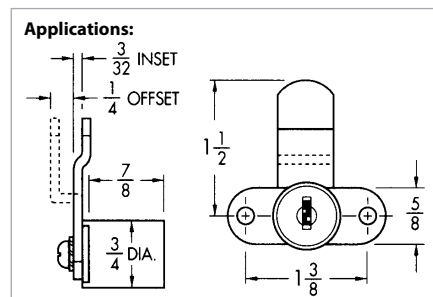

Keying	Cylinder Length	Max Material Thickness	Antique Brass Item#	Bright Brass Item#	Bright Nickel Item#
KA 346	7/8"	7/8"	-	-	NLC8080KA346-14A
KA 390	7/8"	7/8"	-	-	NLC8080KA390-14A
KA 413	7/8"	7/8"	-	-	NLC8080KA413-14A
KA 415	7/8"	7/8"	NLC8080KA415-4G	NLC8080KA415-3	NLC8080KA415-14A
KA 420	7/8"	7/8"	-	-	NLC8080KA420-14A
KD	7/8"	7/8"	-	-	NLC8080KD-14A

SPRINGBOLT LOCKS FOR DRAWERS

Surface Mounted



- Requires 7/8" diameter hole for cylinder
- Key removable in locked position only
- Spring mechanism automatically engages lock when door gets closed
- Supplied with two keys and mounting screws. If trim ring is required, see NLC2017 Series on page D-28

• Stock Keying is specified on table below:

KA = All Keyed Alike to key number specified, master key will not work on these locks

- Other key changes available from National Lock via **SPECIAL ORDER**

Packing: 25 each per box.

Sold In: Both broken and full box quantities. Discount available for full box orders.

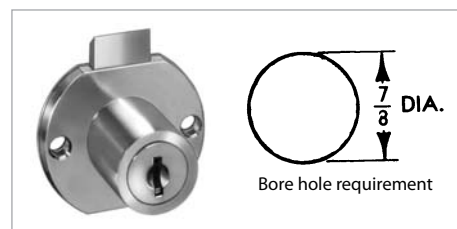

Keying	Cylinder Length	Max Material Thickness	Bright Brass Item #	Bright Nickel Item #
KA 346	15/16"	9/32"	NLC8706KA346-3	-
KA 415	15/16"	9/32"	-	NLC8706KA415-14A

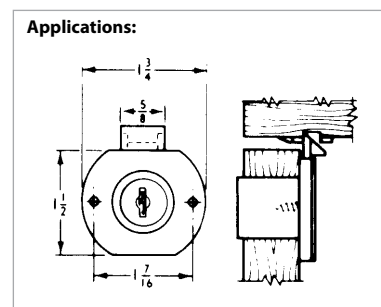

DEADBOLT LOCKS FOR DRAWERS Surface Mounted

- Requires 7/8" diameter hole for cylinder
- Key required to engage lock and is removable in both locked and unlocked positions
- Supplied with two keys and mounting screws. If trim ring is required, see NLC2017 Series on page D-28.
- **Stock Keying is specified on table below:**
 KA = All Keyed Alike to key number specified, master key will not work on these locks
 KD = All Keyed Different, various lock numbers, master key will not work on these locks
 KDMKD = All Keyed Different and master keyed, master key will work on these locks
- Other key changes available from National Lock via **SPECIAL ORDER**

Packing: 25 each per box.

Sold in: Both broken and full box quantities. Discount available for full box orders.

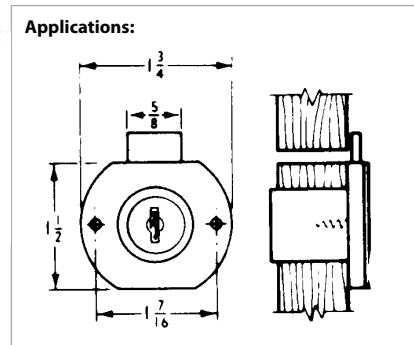

Keying	Cylinder Length	Max Material Thickness	Satin Brass Item #	Bright Brass Item #	Bright Nickel Item #
KA 346	15/16"	11/32"	-	-	NLC8703KA346-14A
KA 413	15/16"	11/32"	-	-	NLC8703KA413-14A
KA 415	15/16"	11/32"	NLC8703KA415-4G	NLC8703KA415-3	NLC8703KA415-14A
KA 420	15/16"	11/32"	-	-	NLC8703KA420-14A
KD	15/16"	11/32"	-	-	NLC8703KD-14A
KDMKD	15/16"	11/32"	-	-	NLC8703KDMKD-14A
KA 415	1-3/16"	11/32"	NLC8705KA415-4G	NLC8705KA415-3	NLC8705KA415-14A
KD	1-3/16"	11/32"	-	-	NLC8705KD-14A

DEADBOLT LOCKS FOR DOORS Surface Mounted

- Requires 7/8" diameter hole for cylinder
- Key required to engage lock and is removable in both locked and unlocked positions
- Supplied with two keys and mounting screws. If trim ring is required, see NLC2017 Series on page D-28
- **Keying is specified on table below:**
 KA = All Keyed Alike to key number specified, master key will not work on these locks
 KD = All Keyed Different, various lock numbers, master key will not work on these locks
- Other key changes available from National Lock via **SPECIAL ORDER**

Packing: 25 each per box.

Sold in: Both broken and full box quantities. Discount available for full box orders.

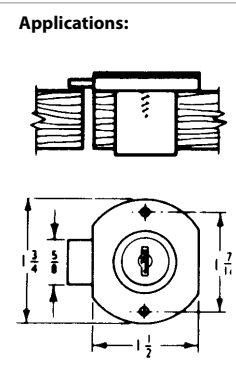
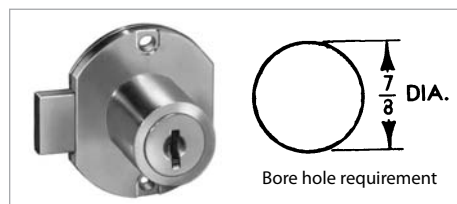

Keying	Cylinder Length	Bolt Travel	Antique Brass Item #	Bright Brass Item #	Bright Nickel Item #
KA 346	15/16"	11/32"	-	-	NLC8704KA346-14A
KA 415	15/16"	11/32"	NLC8704KA415-4G	NLC8704KA415-3	NLC8704KA415-14A
KD	15/16"	11/32"	-	-	NLC8704KD-14A

SECTION D CABINET LOCKS & LATCHES

DISC & PIN TUMBLER LOCKS

DISC TUMBLER GANG LOCK Multiple Drawer Applications

Bore hole requirements; also requires
7/8" x 1/8" deep dado for bar on inside
of panel

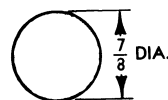

CompX
NATIONAL

- For locking drawers in desk pedestals and other multiple drawer applications
 - Requires 7/8" diameter hole for cylinder, and dado for bar measuring 7/8" x 1/8" deep on inside of panel
 - Key removable in both locked and unlocked positions
 - Turning the key locks all drawers simultaneously (drawers must be in closed position); bar moves studs into notch in drawer or slide, preventing drawer movement
 - Supplied with two keys, three locking studs, three stud slides, saddle and mounting screws. If trim ring is required, see NLC2017 Series on page D-28
 - **Stock Keying is specified on table below:**
KA = *All Keyed Alike* to key number specified, master key will not work on these locks
 - Other key changes available from National Lock via **SPECIAL ORDER**
- Packing:** 5 each per box.
Sold in: Both broken and full box quantities. Discount available for full box orders.

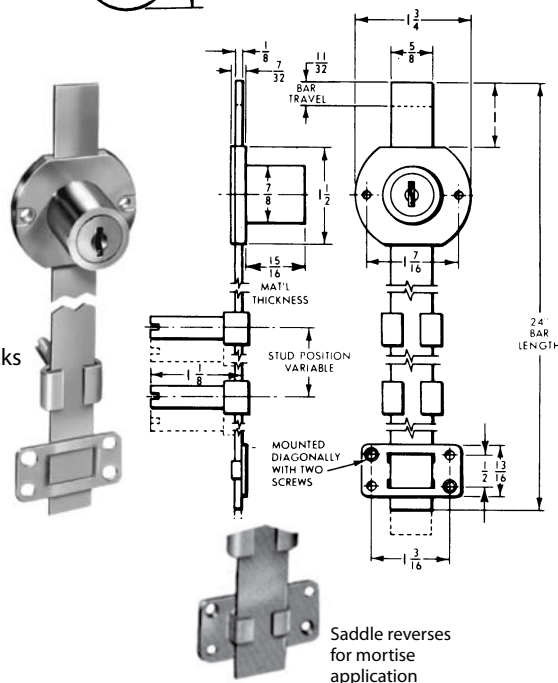

Keying	Cylinder Length	Bar Travel	Bright Brass Item #	Bright Nickel Item #
KA 415	15/16"	11/32"	NLC8090KA415-3	NLC8090KA415-14A

PIN TUMBLER CAM LOCKS FOR DOOR AND DRAWERS 90° Cam Turn, Flush Construction

CompX
NATIONAL

- Each lock comes with one stop washer which allows the cam to turn 90°
 - For drawers, right-hand or left-hand doors
 - Key removable in both locked and unlocked positions
 - Supplied with two keys, trim washer, spur washer (for wood), mounting nut and two cams (1-1/8" extension, 9/32" offset)
 - **Stock Keying is specified on table below:**
KA = *All Keyed Alike* to key number specified, master key will not work on these locks
KD = *All Keyed Different*, various lock numbers, master key will not work on these locks
 - Other key changes available from National Lock via **SPECIAL ORDER**
- Packing:** 10 each per box.
Sold in: Both broken and full box quantities. Discount available for full box orders.

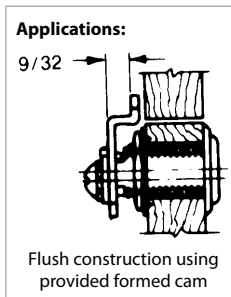

Keying	Cylinder Length	Max Material Thickness	Satin Chrome Item #
KA 101	1-7/16"	1-1/8"	NLC8106KA101-26D
KA 915	1-7/16"	1-1/8"	NLC8106KA915-26D
KA 915	1-3/4"	1-3/8"	NLC8108KA915-26D

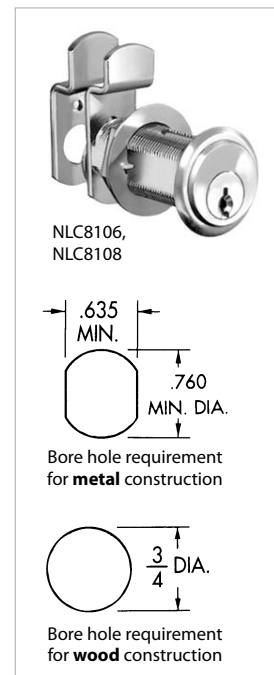

PIN TUMBLER CAM LOCKS

SECTION D CABINET LOCKS & LATCHES

FOR DOOR AND DRAWERS

90° Cam Turn, Lipped/Overlay Construction

- Each lock comes with one stop washer which allows the cam to turn 90°
- For drawers, right-hand or left-hand doors
- For overlay application, the combined thickness of front and frame cannot exceed the cylinder length listed below
- Key removable in both locked and unlocked positions
- Supplied with two keys, trim washer, spur washer (for wood), mounting nut and two cams (1-1/8" extension).

• **Stock Keying is specified on table below:**

KA = All Keyed Alike to key number specified, master key will not work on these locks

KD = All Keyed Different, various lock numbers, master key will not work on these locks

- Other key changes available from National Lock via **SPECIAL ORDER**

Packing: 10 each per box.

Sold in: Both broken and full box quantities. Discount available for full box orders.

Keying	Cylinder Length	Max Material Thickness	Satin Brass Item #	Satin Chrome Item #
KA 101	1-3/16"	7/8"	-	NLC8103KA101-26D
KA 103	1-3/16"	7/8"	-	NLC8103KA103-26D
KA 107	1-3/16"	7/8"	-	NLC8103KA107-26D
KA 915	1-3/16"	7/8"	NLC8103KA915-4	NLC8103KA915-26D
KA 103	1-3/4"	1-1/2"	-	NLC8109KA101-26D
KA 101	1-3/4"	1-1/2"	-	NLC8109KA103-26D
KA 107	1-3/4"	1-1/2"	-	NLC8109KA107-26D
KA 915	1-3/4"	1-1/2"	NLC8109KA915-4	NLC8109KA915-26D
KD	1-3/4"	1-1/2"	-	NLC8109KD-26D

CompX
NATIONAL

Application:

Lipped/Overlay construction using provided straight cam

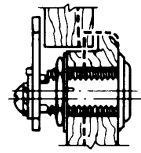

NLC8103,
NLC8109

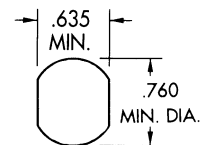

Bore hole requirement for **metal** construction

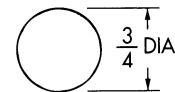

Bore hole requirement for **wood** construction

FOR DOOR AND DRAWERS

90° Cam Turn, Flush or Lipped/Overlay Construction

- Each lock comes with one stop washer which allows the cam to turn 90°
- For drawers, right-hand or left-hand doors
- Multi-Functional pin tumbler cam lock is packaged with four cams (2 straight and 2 formed)
- Allows the lock to be used for multiple applications
- For overlay application, the combined thickness of front and frame cannot exceed the cylinder length listed below
- Key removable in both locked and unlocked positions
- Supplied with two keys, trim washer, spur washer (for wood), mounting nut and two cams (1-1/8" extension; straight or 9/32" offset).

• **Stock Keying is specified on table below:**

KA = All Keyed Alike to key number specified, master key will not work on these locks

- Other key changes available from National Lock via **SPECIAL ORDER**

Packing: 10 each per box.

Sold in: Both broken and full box quantities. Discount available for full box orders.

CompX
NATIONAL



NLC8102
Lipped/overlay construction



NLC8102
Flush application

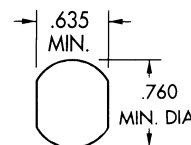

Bore hole requirement for **metal** construction

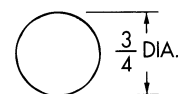

Bore hole requirement for **wood** construction

Keying	Cylinder Length	Max Material Thickness	Satin Brass Item #	Satin Chrome Item #
KA 101	15/16"	5/8"	-	NLC8102KA101-26D
KA 107	15/16"	5/8"	-	NLC8102KA107-26D
KA 915	15/16"	5/8"	NLC8102KA915-4	NLC8102KA915-26D

Applications:

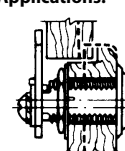

Lipped/Overlay construction with provided straight cam

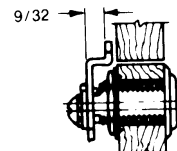

Flush construction using supplied formed cam

SECTION D CABINET LOCKS & LATCHES

PIN TUMBLER CAM & SPRINGBOLT LOCKS

SPRINGBOLT LOCK FOR DRAWERS Surface Mounted



- Requires 57/64" diameter hole for cylinder
 - Key removable only in the locked position
 - Spring mechanism automatically engages the lock when the door gets closed
 - Supplied with two keys, strike and mounting screws.
- If trim ring is required, see NLC2017 Series on page D-28
- **Stock Keying is specified on table below:**
KA = All Keyed Alike to key number specified, master key will not work on these locks
 - Other key changes available from National Lock via **SPECIAL ORDER**
- Packing:** 10 each per box.
Sold in: Both broken and full box quantities.
Discount available for full box orders.

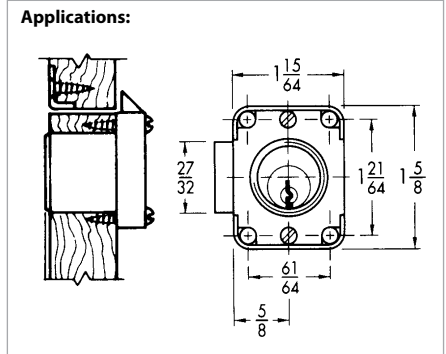
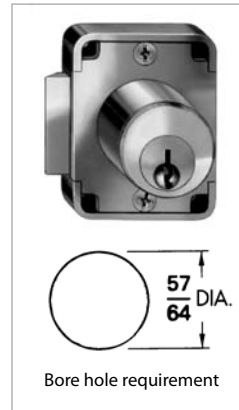

Keying	Cylinder Length	Bolt Travel	Satin Chrome Item #
KA 915	3/4"	7/32"	NLC8139KA915-26D

SPRINGBOLT LOCK FOR DRAWERS Mortise Type



- Half mortise springbolt locks requires mortise for housing and 57/64" diameter hole for cylinder
 - Key removable only in the locked position
 - Spring mechanism automatically engages the lock when the door gets closed
 - Supplied with two keys, strike and mounting screws.
 - If trim ring is required, see NLC2017 Series on page D-28
 - **Stock Keying is specified on table below:**
KA = All Keyed Alike to key number specified, master key will not work on these locks
 - Other key changes available from National Lock via **SPECIAL ORDER**
- Packing:** 10 each per box.
Sold in: Both broken and full box quantities.
Discount available for full box orders.

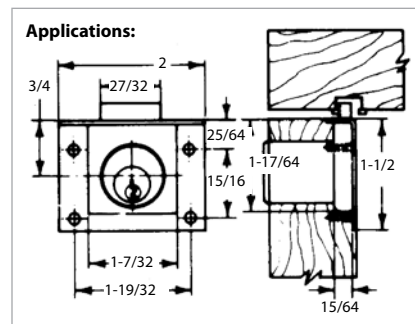
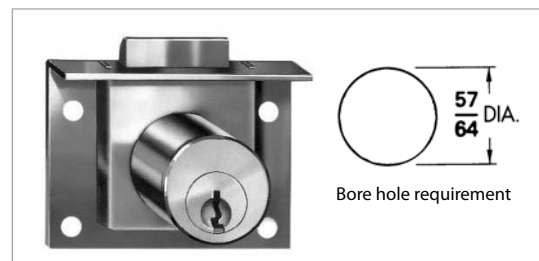

Keying	Cylinder Length	Bolt Travel	Satin Chrome Item #
KA 915	7/8"	7/32"	NLC8131KA915-26D

DEADBOLT LOCKS FOR DRAWERS

Surface Mounted

- Requires 57/64" diameter hole for cylinder
 - Key required to engage lock and is removable in both locked and unlocked positions
 - All are ANSI/BHMA certified Grade 2 A156.11
 - Supplied with two keys, strike and mounting screws.
- If trim ring is required, see NLC2017 Series on page D-28

- **Stock Keying is specified on table below:**

KA = *All Keyed Alike* to key number specified, master key will not work on these locks

KD = All Keyed Different, various lock numbers, master key will not work on these locks

- Other key changes available from National Lock via **SPECIAL ORDER**

Packing: 10 each per box.

Sold in: Both broken and full box quantities. Discount available for full box orders.

Re-Keying Made Easy
ADVANTAGE
+PLUS

Feature makes key changes easier by allowing you to remove the cylinder while the lock remains in place with a 5/64" allen wrench – no mounting screws need to be removed.

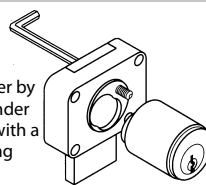

CompX
NATIONAL



57/64 DIA.

Bore hole requirement

Keying	Cylinder Length	Bolt Travel	Satin Brass Item #	Satin Chrome Item #
KA 101	7/8"	3/4"	-	NLC8178KA101-26D
KA 107	7/8"	3/4"	-	NLC8178KA107-26D
KA 915	7/8"	3/4"	NLC8178KA915-4	NLC8178KA915-26D
KD	7/8"	3/4"	-	NLC8178KD-26D
KA 915	1-1/8"	3/4"	-	NLC8177KA915-26D
KA 101	1-3/8"	3/4"	-	NLC8179KA101-26D
KA 107	1-3/8"	3/4"	-	NLC8179KA107-26D
KA 915	1-3/8"	3/4"	-	NLC8179KA915-26D

Applications:

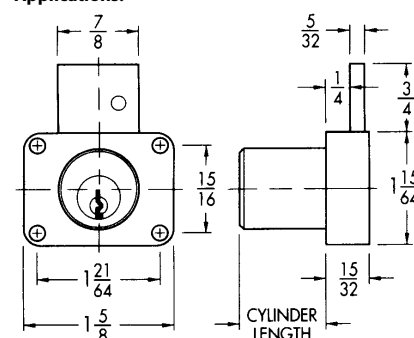

DEADBOLT LOCKS FOR DOORS

Surface Mounted

- For left-hand or right-hand doors
- Requires 57/64" diameter hole for cylinder
- Key required to engage lock and is removable in both locked and unlocked positions
- Advantage PLUS feature makes key changes easier by allowing you to remove the cylinder while the lock remains in place with a 5/64" allen wrench—no mounting screws need to be removed.
- All are ANSI/BHMA certified Grade 2 A156.11
- Supplied with two keys, strike and mounting screws. If trim ring is required, see NLC2017 Series on page D-28
- Other key changes available from National Lock via ***SPECIAL ORDER***
- **Stock Keying is specified on table below:**

KA = All Keyed Alike to key number specified, master key will not work on these locks

KD = *All Keyed Different*, various lock numbers, master key will not work on these locks

Packing: 10 each per box.

Sold in: Both broken and full box quantities. Discount available for full box orders.



Bore hole
requirement

Applications:

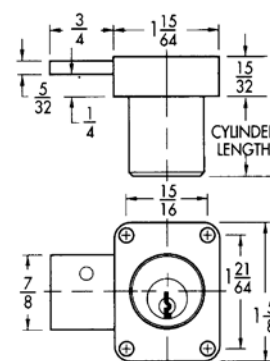

Keying	Cylinder Length	Bolt Travel	Satin Brass Item #	Satin Chrome Item #
KA 101	7/8"	3/4"	-	NLC8173KA101-26D
KA 103	7/8"	3/4"	-	NLC8173KA103-26D
KA 107	7/8"	3/4"	-	NLC8173KA107-26D
KA 915	7/8"	3/4"	NLC8173KA915-4	NLC8173KA915-26D
KD	7/8"	3/4"	-	NLC8173KD-26D
KA 915	1-1/8"	3/4"	-	NLC8174KA915-26D
KA 915	1-1/8"	3/4"	-	NLC8175KA915-26D

SECTION D

CABINET LOCKS & LATCHES

NATIONAL LOCK ACCESSORIES

EXTRA KEYS FOR DISC TUMBLER LOCKS

Packing: As shown below.

Sold in: Both broken and full box quantities.

Discount available for full box orders.



Item#	Description	Box Qty
NLD8784-BLANK	5 disc tumbler master key blank	50
NLD8799-E41A	5 disc tumbler replacement master key	30
NLD8799-346	Cut Key #346	50
NLD8799-390	Cut Key #390	50

Item#	Description	Box Qty
NLD8799-413	Cut Key #413	50
NLD8799-415	Cut Key #415	50
NLD8799-420	Cut Key#420	50
NLD8799-642	Cut Key #642	50

STRIKES FOR DISC & PIN TUMBLER LOCKS

• Optional strikes for both disc and pin tumbler locks

• Furnished with screws to match the strike

Packing: 25 per box with matching screws.

Sold in: Both broken and full box quantities. Discount available for full box orders.

	Bright Brass Item#	Bright Nickel Item #	Description	Overall Dimensions
A	NLC2001-3	NLC2001-14A	Formed strike, no bolt hole	1-3/4" x 1/2" with 3/16" Form
B	NLC2002-3	NLC2002-14A	Formed strike, no bolt hole, countersunk holes reserved	1-3/4" x 1/2" with 3/16" Form
C	NLC2003-3	NLC2003-14A	Flat strike with rounded ends, 3/4" x 7/32" bolt hole	1-5/16" x 3/8"
D	-	NLC2004-14A	Flat strike with square ends, 7/8" x 17/64" bolt hole	2-5/32" x 1/2"
E	NLC2005-3	NLC2005-14A	Flat strike no bolt hole	2-5/32" x 1/2"
F	-	NLC2007-14A	Flat strike with rounded ends, 1-1/16" x 17/64" bolt hole	2-5/32" x 1/2"

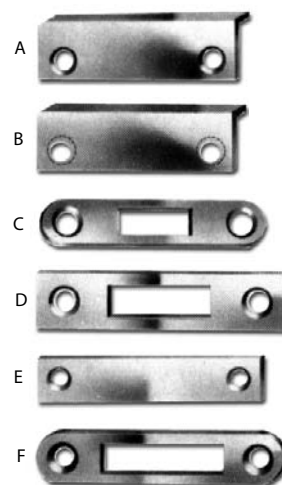

DISC TUMBLER CAMS

Straight and Formed Cams

• Permits adaptation of disc tumbler cam locks to meet nearly every application

• Straight hook cams and double formed cams can be reversed when required

Packing: As shown below.

Sold in: Both broken and full box quantities. Discount available for full box orders.

	Item#	Description	Length	Box Qty
A	NLC7001-2C	Straight Cam	3/4"	25
	NLC7004-2C	Straight Cam	2"	25
	NLC7002-2C	Straight Cam	1"	25
	NLC7005-2C	Straight Cam	3"	25
	NLC7003-2C	Straight Cam	1-1/8"	25
B	NLC7007-2C	Straight Hook Cam	1-1/8"	25
	NLC7008-2C	Straight Hook Cam	1-1/2"	25
C	NLC7011-2C	Single Formed Cam Offset	1-1/8" x 7/16" Offset	25
	NLC7009-2C	Double Formed Cam Offset	1-3/4" x 1/2" Offset	25
D	NLC7013-2C	Double Formed Cam Offset	1-1/8" x 3/8" Offset	25
	NLC7014-2C	Double Formed Cam Offset	1-5/8" x 5/16" Offset	25

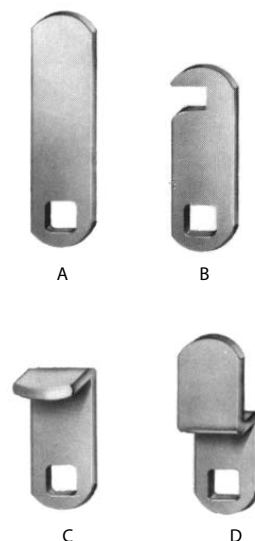

PIN TUMBLER CAM Straight Cam



- Longer straight cam for pin tumbler locks
- Used in lipped/overlay applications with a 3/4" thick front and 3/4" thick frame

Packing: As shown below.

Sold in: Both broken and full box quantities.

Discount available for full box orders.

Item#	Length	Box Qty
NLC7104-2C	3"	20



FLUSH FLAP LOCKS For Drop Or Lift Up Flaps



- Lock fits flush in face; for wood thickness up to 7/8"
- Tab turns 90° to engage right-angled striker
- Key removable only when locked
- Cylinder requires 3/4" hole
- Back of lock may be recessed into 5/32" deep x 1-3/8" diameter bore
- All furnished keyed alike
- Recommended Fasteners: WW40000, sold in multiples of 1,000

Includes: One key, one strike and one trim ring, (screws not included)

Packing: As shown below.

Sold in: Both broken and full box quantities.

Discount available for full box orders.

Item#	Finish	Keying	Box Qty
CN9411CHR	Bright Nickel	Keyed Alike	25



CHEST/LID LOCKS Surface Mounted



- Lid locks for cedar chest application and other lid locking requirements
- Surface mounted and requires a 9/16" diameter hole for cylinder
- Key removable in both locked and unlocked positions
- All furnished keyed alike
- Safety feature requiring operation of pushbutton to lock or latch lid closed

Includes: Lock, one key, strike, and mounting screws.

Packing: As shown below.

Sold In: Both broken and full box quantities.

Discount available for full box orders.

Item #	Bolt Type	Cylinder Length	Finish	Box Qty
NLC8414-4G	Internal, Engages Strike	7/8"	Antique Brass	25



TRIM RINGS



- 7/8" diameter trim ring
- Used to cover ragged edges around bored mounting holes

Packing: As shown below.

Sold in: Both broken and full box quantities.

Discount available for full box orders.

Item#	Finish	Box Qty
NLC2017-14A	Bright Nickel	25
NLC2017-26D	Satin Chrome	25
NLC2017-3	Bright Brass	25
NLC2017-4G	Antique Brass	25



FURNITURE LOCKS Surface Mounted



- Used primarily on furniture and other fine cabinetry
- Surface mounted lock requires hole for key entry
- Key removable in both locked and unlocked positions
- All furnished keyed alike

Includes: Lock, one key, and key hole escutcheon

Packing: As shown below.

Sold In: Both broken and full box quantities. Discount available for full box orders.

Item #	Bolt Type	Bolt Travel	Finish	BoxQty
NLC8826-3	Dead	21/64"	Bright Brass	25



CHEST/LID LOCKS Full Mortise



- Used primarily on furniture and other fine cabinetry
- Surface mounted lock requires hole for key entry
- Key removable in both locked and unlocked positions
- All furnished keyed alike

Includes: Lock, one key, and key hole escutcheon

Packing: As shown below.

Sold In: Both broken and full box quantities.

Discount available for full box orders.

Item #	Bolt Type	Bolt Travel	Finish	Box Qty
NLC8384-3	Hook	5/16" .200" sideshift	Bright Brass	25



SECTION D CABINET LOCKS & LATCHES

BY-PASSING & SHOWCASE DOOR LOCKS

BY-PASSING (SLIDING) DOOR LOCKS

For Doors 3/4"–1-3/4" Thick

- Patented, positive-action design with lock cylinder geared directly to the tonque
- One-half turn of key locks or unlocks the lock
- 2 keys and 1" diameter trim ring included

Packing: Each



Item#	Keying	Finish
SG1068KA-3	Keyed Alike	Bright Brass

BY-PASSING (SLIDING) DOOR LOCK

For Doors up to 1" Thick

- All Keyed Alike; 3 other keyed alike key changes are available **SPECIAL ORDER**

Packing: As shown below.

Sold in: Both broken and full box quantities. Discount available for full box orders.



Item#	Keying	Finish	Box Qty
KV984NP	Keyed Alike	Bright Nickel	12

GLASS DOOR LOCK

HÄFELE

- For glass doors that are 3/16" - 1/4" thick
- Requires 26 mm bore in glass and 5 mm bore in the cabinet for the strike
- Supplied with 2 keys and 3 rubber spacers to compensate for different glass thicknesses

Packing: As shown below.

Sold in: Both broken and full box quantities. Discount available for full box orders.



Item#	Type	Finish	Box Qty
HE233-05-601	Keyed Alike	Bright Nickel	10

SHOWCASE DOOR LOCK

For Glass or Wood Doors,
No Bore



- Designed for sliding glass or wood showcase doors
- For doors 1/8" to 5/16" thick
- All are Keyed Alike

Packing: As shown below.

Sold in: Both broken and full box quantities.

Discount available for full box orders.

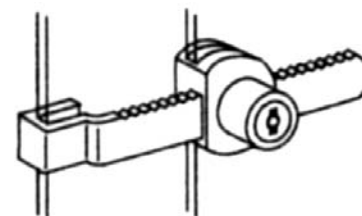

Item#	Keying	Finish	Box Qty
FR1000S	Keyed Alike	Bright Chrome	12

SHOWCASE DOOR LOCKS

For Wood or Glass Doors,
No Bore



- For wood or glass doors up to 3/4" thick
- Features a removable cylinder for re-keying
- Operation - Key removable at 12:00 and 3:00, 90° key turn to open
- Keyed to work with National Lock disc tumbler locks keyed to #415

Packing: As shown below.

Sold in: Both broken and full box quantities. Discount available for full box orders.

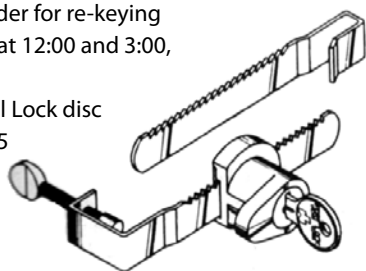

Item#	Keying	Finish	Box Qty
NLMFWSG415-14A	Keyed Alike	Bright Nickel	10

SHOWCASE DOOR LOCKS

For Glass Doors, No Bore



- For plate glass sliding doors up to .22" thick.
- ANSI/BHMA designation E07191
- Key removable in locked position only
- Bolt Type: Internal Spring
- Keyed to work with National Lock pin tumbler locks keyed to #101

Packing: As shown below.

Sold in: Both broken and full box quantities. Discount available for full box orders.



Item#	Keying	Finish	Box Qty
NLC8140KA101-26D	Keyed Alike	Satin Chrome	10

MAGNETIC CABINET DOOR LOCKS



- A magnetic key placed on the outside of the cabinet door releases the catch; remove the magnetic key and the catch springs back
- The lock is not visible on the outside of the cabinet which means it does not disturb the cabinet design
- Accompanying each lock is a release bar which when installed by the end user will disengage the lock; the cabinet door will open normally until the release bar is deactivated
- Maximum Door Thickness: 1 in., requires 9/32 in. diameter plunger hole in door back
- RSRAL101: Starter kit includes 5 locks with strike plates, templates, sets of screws, 2 keys, 1 drill stop and instructions in one carton. Sold as complete kits only.
- RSRL201: Lock is individually polybagged with a strike plate, screws and templates
- RSRL202: Magnetic key

Packing: As shown below.

Sold in: Both broken and full box quantities.

Discount available for full box orders

Item#	Description	Box Qty
RSRAL101	Starter Kit	1
RSRL201	Lock with Strike Plate	25
RSRL202	Magnetic Key	25

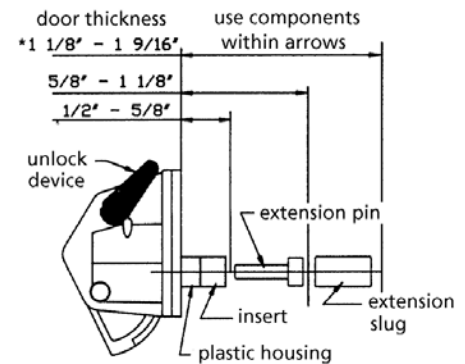

KEYLESS COMBINATION CAM LOCK DualAxxess, 90° Cam Turn



- Access the lock by combination or with a twist of the key
- Replaces any standard cam lock to get instant keyless access
- All come masterkeyed
- 10,000 possible code combinations
- Retrofits into existing 3/4" wood or metal mounting holes – no need for additional drilling or modification
- Small profile fits most doors and drawers
- Combinations are secure – code can only be changed with the proper key and the correct combination
- Heavy duty die case construction
- 100% mechanical – no batteries required

• **Stock Keying is a specified on table below:**

KAMKD = All Keyed Alike, master key sold on right will work on these locks

KD = All Keyed Different, various lock numbers, master key will work on these locks

• Other key changes available from National Lock via **SPECIAL ORDER**

Packing: As shown below.

Sold In: Both broken and full box quantities. Discount available for full box orders.

DUAL AXESS ACCESSORY ITEMS:

Description	Item#	Box Qty
Master key for use with Dual Axxess Locks	NLD8772	10
Lock plug removal key for Dual Axxess Locks	NLD8771	10
Key blank for use with Dual Axxess Locks	NLD8770	10



Keying	Cylinder Length	Max. Material Thickness	Color	Item#	Box Qty
KAMKD 108	7/8"	5/8"	Black	NLD8030KA108-BLK	10
KAMKD 120	7/8"	5/8"	Black	NLD8030KA120-BLK	10
KAMKD 124	7/8"	5/8"	Black	NLD8030KA124-BLK	10
KD	7/8"	5/8"	Black	NLD8030KD-BLK	10
KAMKD 108	1-3/8"	1-1/8"	Black	NLD8031KA108-BLK	10
KAMKD 120	1-3/8"	1-1/8"	Black	NLD8031KA120-BLK	10
KAMKD 124	1-3/8"	1-1/8"	Black	NLD8031KA124-BLK	10
KD	1-3/8"	1-1/8"	Black	NLD8031KD-BLK	10

SECTION D

CABINET LOCKS & LATCHES

KEYLESS LOCKS

KEYLESS CABINET LOCKING SYSTEM

Radio Frequency Controlled



- For use in wood applications such as lockers; closet cabinets and storage; kitchen cabinets, liquor cabinets, and entertainment units; audio visual cabinets; office furniture; reception and conference furniture; healthcare cabinetry; retail display cabinets
- Radio frequency technology permits the Transmitter Pad to be stored anywhere – leaving no trace of visible hardware or signs of being secured
- Allows multiple wood cabinet doors or drawers to be locked from a single transmitter pad within a 15 ft. range
- User programmable codes

Features and Functions:

- Transmitter pad operates within a 15' range
- One transmitter pad can activate an unlimited number of receiver latches
- Separate user and supervisor codes (four to eight digits) to operate the lock(s)
- Receiver latch is easily programmed by user through the transmitter pad
- Receiver latch mounts within 1" drawer suspension clearance
- Uses readily available batteries: 4-AAA (not included) for the receiver latch and a CR2032 coin battery (included) for the transmitter pad
- Low battery indicator on transmitter pad
- Designed to pass the ANSI/BIFMA 50 lb. pull strength specification
- For interior use only – recommended temperature range of 50° F to 120° F
- Transmitter pad mounts with semi-permanent 1 sided tape (included); TLMP700 back mounted bracket sold separately



VERSIONS AVAILABLE:

Standard – Allows any transmitter pad to operate any receiver latch in a 15' range. Standard mode can be used in most general office or residential applications.

Dedicated - This factory programmed feature mates a transmitter pad to a receiver latch or latches by way of a unique transmitter ID. Ideal for assigned lockers or when users are within close proximity of each other (**SPECIAL ORDER** only).

LOCKS MODES AVAILABLE ON BOTH VERSIONS:

Self-Lock Mode – Allows the user to program the receiver latch to automatically re-lock 10 seconds after unlocking.

Passage/Manual Lock Mode (factory default) – User must manually lock.

Single Use Mode – Allows the user to choose their code at time of operation.

Single Use Mode is recommended for shared or day use lockers or cabinets.

Packing: Each.

Item #	Description
TLSSL100	Kit contains all parts necessary to lock one door or drawer. Includes 1 receiver latch, 1 standard transmitter pad, 1 door/drawer strike plate, and 1 installation tool
TLRL110	Add-on Kit is needed to lock each additional door drawer operated by an existing transmitter pad. Includes 1 receiver latch and 1 door/drawer strike plate.
TLMP700	Backmounted bracket for securing transmitter pad, Satin Nickel
TLRL100	Receiver Latch Only
TLTP100	Standard Transmitter Pad only
TLSP600	Door/Drawer Strike Plate only
TLTL600	Installation Tool
TLTP150	Dedicated Transmitter Pad (SPECIAL ORDER only due to factory programmed settings)

ANTI-TIP INTERLOCK SYSTEM

For 2 Drawer or 3-4 Drawer Lateral File



- Prevents more than one drawer from being opened at a time
- Used on file cabinets where no lock is present
- Meets BIFMA standards for strength and durability
- All components are surface mounted
- 1/2" drawer slide clearance required
- Lockbar can be cut to size by user

Packing: As shown below.

Sold in: Both broken and full box quantities.

Discount available for full box orders.



**2-DRAWER
LATERAL
(NO LOCK)**

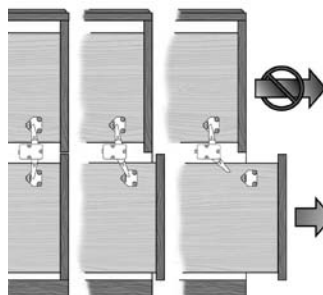

When either drawer is pulled open, the drawer clip on that drawer moves the snapper into a locked position. Thereby preventing any further drawers from being opened.

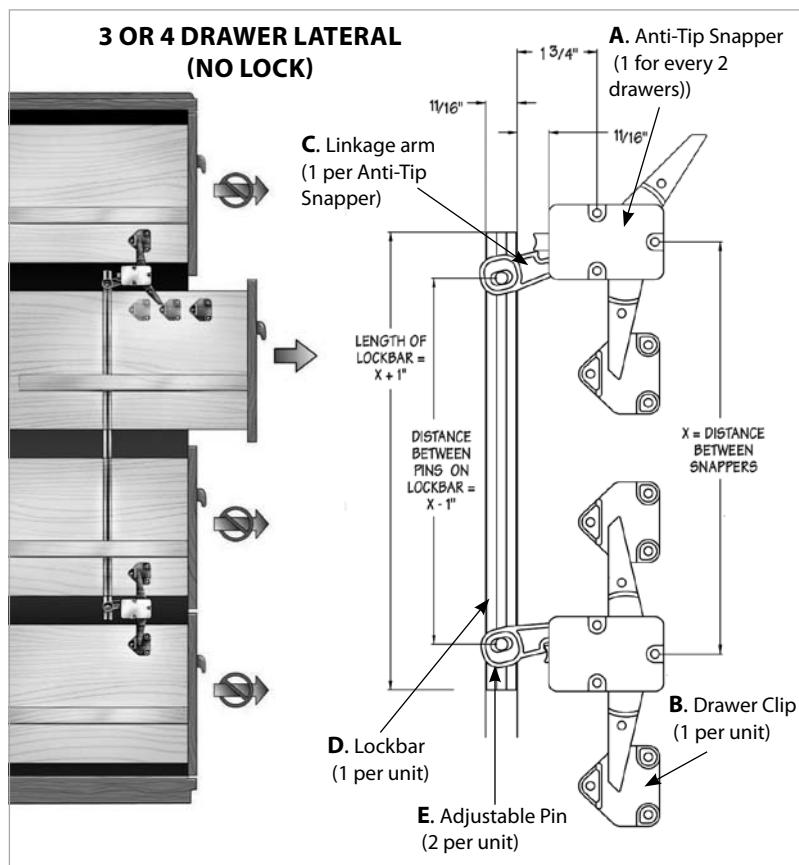
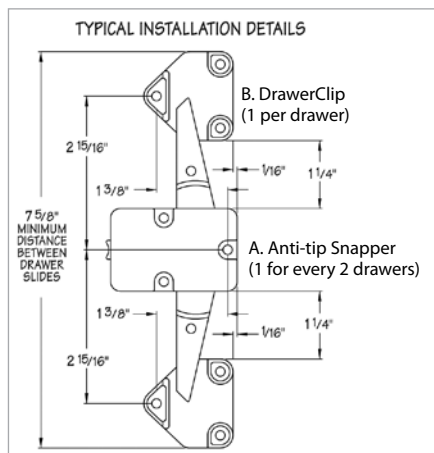

	Item #	Description	2 Drawer Files	3-4 Drawer Files	Box Qty
A	TLSN400	Anti-Tip Snapper	1	2	100
B	TLDC400	Drawer Clip	1 per drawer	1 per drawer	100
C	TLSN410	Linkage Arm	0	1 per Anti-Tip Snapper	100
D	TLLB240	Lockbar, 24"	0	1 per unit	25
	TLLB360	Lockbar, 36"	0	1 per unit	25
E	TLAP037	Adjustable Pin, 3/8"	0	2 per unit	100

SECTION D CABINET LOCKS & LATCHES

MAGNETS & STRIKE PLATES

PLASTIC CASING MAGNETS AND STRIKE PLATES

- All necessary screws included
- Magnets listed in order of pull force

Packing: As shown below.

Sold In: AMCM items sold in full box quantities only, all other sold in both broken and full box quantities. Discount available for full box orders.

Amerock

PRO
VALUE SERIES

EPLO

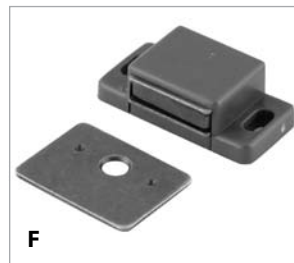
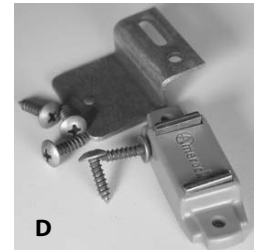
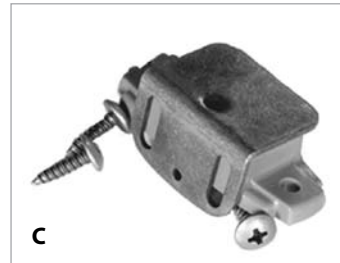
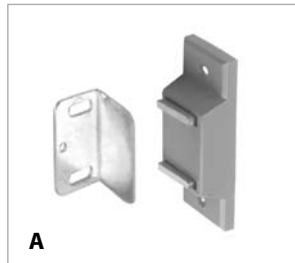

	Pull Force (lbs.)	Magnet Design	Features	Magnet Housing/ Strike Plate Size (Height x Depth x Length)	Case/Strike Finish	Item #	Box Qty
A	5 lbs.	Double Pole	L-shaped strike is designed for overlay door applications	13/32"H x 45/64"D x 1-31/32"L / L Shaped 3/4" H x 1-1/8" L	Tan/Zinc	EP1001T	100
B	5 lbs.	Double Pole	Includes three strike types: Flat for inset, L-shaped for overlay and Z-shaped for full inset doors	1-15/16"H x 3/4"D x 11/16"L/ (Flat) 1-1/8"H x 3/4" L (L-shaped) 1-1/8"H x 7/8"D x 3/4" L (Z-shaped) 1-1/8"H x 1/2"D x 1-1/2" L	Tan/Zinc	AMBP9765-PT	50
					White/Zinc	AMBP9765-W	50
C	5 lbs.	-	L-shaped strike is designed for overlay door applications	1-15/16"H x 3/4"D x 11/16"L/ 1-1/8"H x 7/8"D x 3/4" L	Tan/Zinc	AMCM9765-PT	200
D	5 lbs.	Double Pole	Z-shaped strike for full inset door applications	11/16"H x 3/4"D x 15/16"L/ 1-1/8"H x 1/2"D x 1-1/2" L	Tan/Zinc	AMCM9765F-PT	100
					White/Zinc	AMCM9765F-W	100
E	7.5 lbs.	Double Pole	-	1/2"H x 1-1/8"D x 2"L/ 3/4"H x 1-1/8" L	Tan/ Burnished Brass	AMBP3473-PT	25
						AMCM9773-PT	200
F	9 lbs.	-	-	1/2"H x 7/8"D x 1-3/4"L/ 1/2"H x 1-3/8" L	Brown/Copper	IM5360BN	50
					White/Copper	IM5360WH	50
G	10 lbs.	Double Pole	-	1/2"H x 3/4"D x 2"L/ 3/4"H x 1-1/8" L	Tan / Zinc	AMBP9793-PT	25
						AMCM9793-PT	200
H	10 lbs.	Dual Double Pole	-	17/32" H x 13/16"D x 2-7/8"L/ (2) 1-3/18"H x 7/8" L	White/ Zinc	EP1015-WH	50
					Brown/Copper	IM5363BN	50

ALUMINUM CASING MAGNETS AND STRIKE PLATES

Standard Duty, Light Pull Force

- Light pull force (4 to 7.5 lbs.) magnetic catches
- All necessary screws included
- Magnets listed in order of pull force

Packing: As shown below.

Sold In: AMCM items sold in full box quantities only, all other sold in both broken and full box quantities.

Discount available for full box orders.

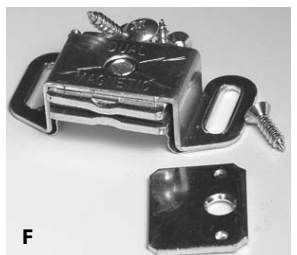
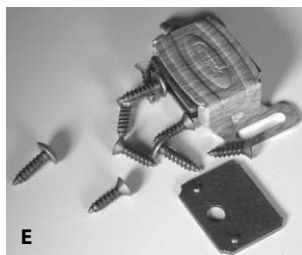
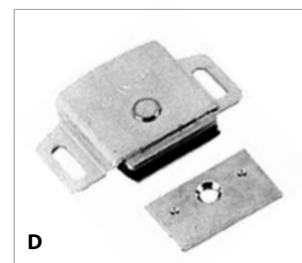

	Pull Force (lbs.)	Magnet Design	Features	Magnet Housing/ Strike Plate Size (Height x Depth x Length)	Casing/ Strike Finish	Item #	Full Box Qty
A	4 lbs.	Double Pole	• Drive in magnet casing	5/8" Dia. x 3/4" Deep/ 3/4" Diameter	Aluminum/ Aluminum	EP600AL	100
B	5 lbs.	Double Pole	• Three finishes	2-1/16"H x 1-1/8" D x 5/8"L / 5/8"H x 1-1/8"L	Brass/Brass	IV325A3	20
					Ant.Brass/Ant.Brass	IV325A5	20
					Alum./Alum.	IV325A92	20
C	6.5 lbs.	Double Pole	• Magnets rotate within casing to maintain maximum contact to strike	47/64"H x 3/4"D x 2-1/16"L / 13/16"H x 1-1/8"L	Aluminum/Zinc	EP591B	100
						EP591WS	500
D	7 lbs.	Double Pole	• Magnets rotate within casing to maintain maximum contact to strikes	7/16"H x 1-1/8"D x 2"L / 1-1/4"H x 13/16"L	Aluminum/Zinc	SHSP41-AL	25
E	7.5 lbs.	Double Pole	• Magnets rotate within casing to maintain maximum contact to strike • Simulated wood grain finish	9/16"H x 1-1/8"D x 1-15/16"L / 3/4"H x 1-1/8"L	Woodgrain/ Burnished Brass	AMBP9753-AW	50
F	7.5 lbs.	Double Pole	• Magnets rotate within casing to maintain maximum contact to strike	5/8"H x 1"D x 2"L / 3/4"H x 1-1/8"L	Aluminum/ Aluminum	AMBP9783-AL	50
						AMCM9783-AL	200

SECTION D CABINET LOCKS & LATCHES

MAGNETS & STRIKE PLATES

ALUMINUM CASING MAGNETS AND STRIKE PLATES

Heavy Duty, Strong Pull Force

- Heavy pull force (9 lbs. to 25 lbs.)
- All necessary screws included
- Magnets listed in order of pull force

Packing: As shown below.

Sold In: AMCM items sold in full box quantities only, all other sold in both broken and full box quantities.

Discount available for full box orders.

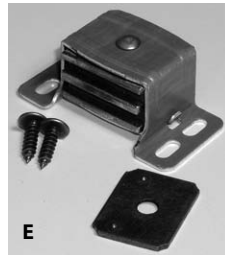
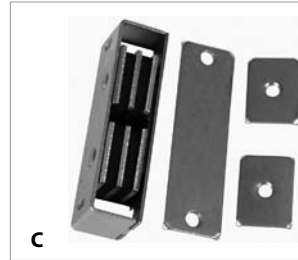

	Pull Force (lbs.)	Magnet Design	Features	Magnet Housing/ Strike Plate Size (Height x Depth x Length)	Casing / Strike Finish -Color	Item #	Full Box Qty
A	9 lbs.	Dual Double Pole	• Magnets rotate within casing to maintain maximum contact to strike	1-1/8"H x 2-1/16"D x 5/8"L/ Strike: (1) 11/16"H x 3-1/8"L Strike: (2) 5/8" H x 1-1/8" L	Aluminum/ Aluminum	IV326A92	10
B	13 lbs.	Triple Pole	• Magnets rotate within casing to maintain maximum contact to strike	47/64" H x 1" D x 2-1/16" L/ 3/4" H x 1-1/8" L	Aluminum / Zinc	EP592+ EP592BWS	100 500
C	14 lbs.	Dual Triple Pole	• Magnets rotate within casing to maintain maximum contact to strikes	3/4" H x 1"D x 3-1/8" L/ Strike: (1) 7/8" H x 3-1/8" L Strike: (2) 13/16"H x 1-1/8" L	Aluminum / Zinc	IV327A92	10
D	15 lbs.	Dual Double Pole	• Magnets rotate within casing to maintain maximum contact to strikes	1/2"H x 1-3/8"D x 3/4"L/ (2 strikes) 3/4" H x 1-1/8" L	Aluminum / Aluminum	SHSP45-AL	25
E	16 lbs.	Triple Pole	• Magnets rotate within casing to maintain maximum contact to strikes • Aluminum casing is a simulated wood grain	13/16"H x 1-1/16"D x 2-1/32"L/ 3/4"H x 1"L	Woodgrain / Burnished Brass	AMBP9798-AW AMCM9798-AW	25 200
F	25 lbs.	Single Pole	• Strong magnetic pull • 13/64" diameter center screw hole	2-1/32" dia. x 9/32" thickness/ 2-1/32" dia. x 9/32" thickness	Aluminum/ Aluminum	MGRB50N	240

SPECIALTY MAGNETIC CATCHES

SECTION D CABINET LOCKS & LATCHES



HERMITICALLY SEALED PLASTIC MAGNET

Pull Force 6.6 lbs.

- Magnet is sealed in white plastic to prevent metal to metal contact
- SLJM49 (Illustration C) strike plate is made of 316 stainless steel and is highly corrosion resistant
- SLJMP45 (Illustration B) is hermitically sealed in white plastic

Packing: As shown below.

Sold in: Both broken and full box quantities.

Discount available for full box orders.

	Item#	Description	Finish	Box Qty
A	SLJM50-W	Sealed Magnet	White	20
B	SLJMP45	Sealed Strike Plate	White	100
C	SLJM49	Strike Plate	316 Stainless Steel	100

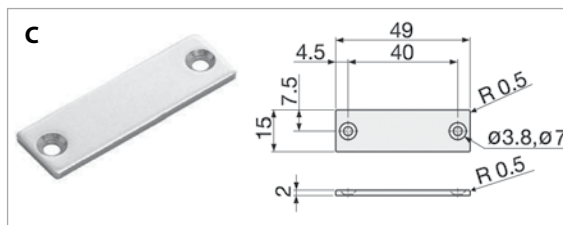
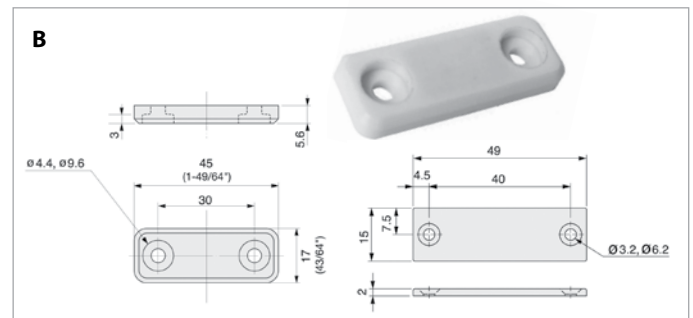
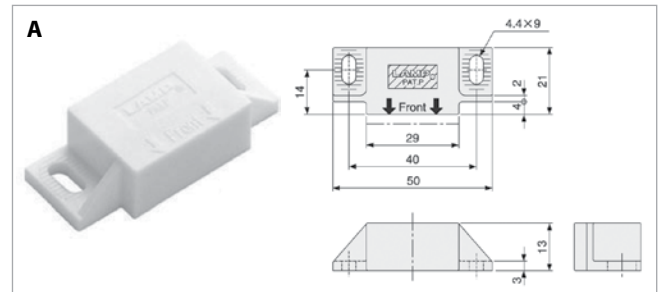

ULTRA THIN MAGNET & CATCH

Pull Force 6.6 lbs.

- Strike plate and catch are only 3.4 mm thick when placed together
- Sold without screws
- Strike included

Packing: Strike and magnet sold together.

Sold in: Both broken and full box quantities.

Discount available for full box orders.

Item#	Finish	Box Qty
SLMCYN001P	Nickel	100

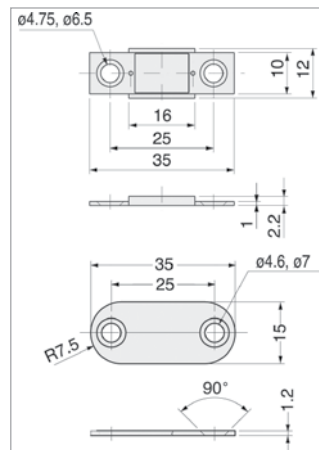

ULTRA THIN MAGNET & CATCH

Pull Force 8.8 lbs.

- Ultra thin magnet design is only 2.6mm thick
- Strike plate (sold separately) is made of 316 stainless steel and is only 0.5mm thick
- Strike and screws sold separately

Packing: Strike and magnet sold separately.

Sold in: Both broken and full box quantities.

Discount available for full box orders.

	Item#	Description	Finish	Box Qty
A	SLMC159	Base	Nickel	100
B	SLMC159-PLATE	Strike Plate	Nickel	200

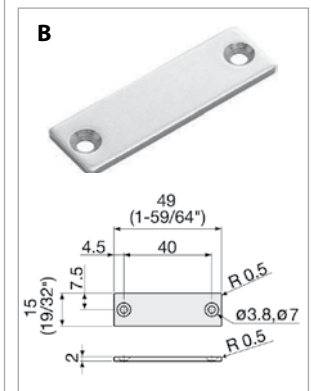
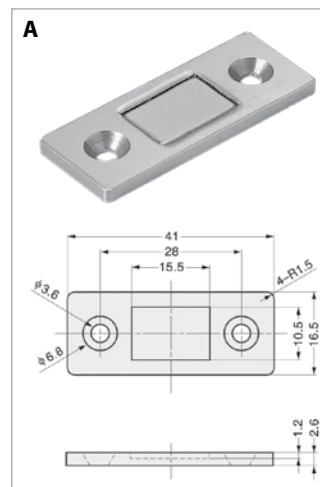

SECTION D CABINET LOCKS & LATCHES

SPECIALTY MAGNETIC CATCHES

MAGNETIC CATCH SYSTEM

Powermags

- High performance neodymium magnets inserts into a hole in cabinet frame
- Cabinet frame hole can be covered over using covercaps
- 3/8" long x .42" diameter "power head" screw is inserted into door to act as magnetic catch

Packing & Sold in: Full box quantity only.

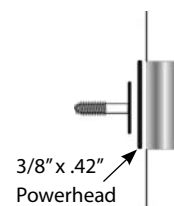

Item#	Magnet Size	Description/Packing
FAPOWERMAG	9/16" x 3/16"	10 each Magnets w/Screws and Covercaps (White & Maple)
FAPOWERMAG-18MM	18mm x 5mm	10 each Magnets only
FAPOWERMAG-3/4	3/4" x 3/8"	2 each Magnets only
FAPHKMET42-200	3/8" x .42"	200 each PowerHead Screws

STRIKE PLATES

For Glass Doors

- Designed to work with 1/4" thick glass doors
- No bore strike plates clamp to glass firmly with use of insulating pads (pads included)
- For use with magnetic push/touch latches
- Available in three finishes

Packing: As shown to the right.

Sold In: Both broken and full box quantities.
Discount available for full box orders.



	Item#	Dimensions (Height x Width x Depth)	Finish	Box Qty
FLUSH STYLE				
A	WY7011	29/32"H x 1-9/16"W x 5/16"D	Black	50
	WY7012		Bright Nickel	50
	WY7013		Bright Brass	50
PULL STYLE				
B	WY7015	15/15"H x 1-9/16"W x 7/16" Projection	Black	50
	WY7016		Bright Nickel	50
	WY7017		Bright Brass	50

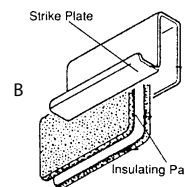
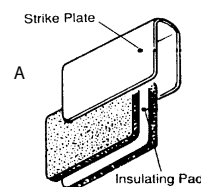

STRIKE PLATES

- Galvanized steel strike plates with zinc finish for use with magnetic push/touch latches
- Recommended screw is WW40205, (screws not included)

Packing: As shown below.

Sold In: Both broken and full box quantities.
Discount available for full box orders.

Item#	Type	Dimensions	Box Qty
WY9460R	Round	15mm Diameter, 1.5mm thick	50
WY9460S	Oval	35mm length x 12mm width, 1.5mm thick	50

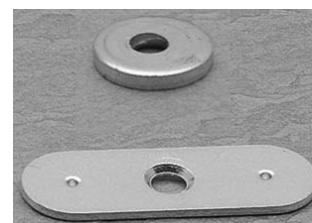

MAGNETIC PUSH/TOUCH LATCHES

Value Priced

- When door is pushed in, spring-loaded mechanism automatically pushes door open
- Strike plate not included

Packing: As shown below.

Sold In: Both broken and full box quantities.
Discount available for full box orders.



Item #	Color	Throw Length	Type	Latch Dimensions (Length x Width x Height)	Box Qty
FRPB9461-WH	White	7/16"	Rectangle/ Single	1-11/16"L x 1-5/8"W x 1/2"H	50

MAGNETIC PUSH/TOUCH LATCHES

Value Priced

- When door is pushed in, spring-loaded mechanism automatically pushes door open
- Open cabinet doors with a single touch
- Single door and double door options available in white and black
- Strike plates and screws included

Packing: As shown below.

Sold In: Both broken and full box quantities. Discount available for full box orders.



	Item #	Color	Throw Length	Type	Latch Dimensions (Length x Width x Height)	Catch Dimensions (Length x Width)	Box Qty
A	FRPB9461R-BLP	Black	7/16"	Single	1-5/16"L x 1-1/8"W x 11/16"H	1-1/16"L x 1/2"W	100
	FRPB9461R-WHP	White	7/16"	Single	1-5/16"L x 1-1/8"W x 11/16"H	1-1/16"L x 1/2"W	100
B	FRPB9462R-BLP	Black	3/8"	Double	1-5/16"L x 2-1/4"W x 5/8"H	1-3/8"L x 1/2"W	50
	FRPB9462R-WHP	White	3/8"	Double	1-5/16"L x 2-1/4"W x 5/8"H	1-3/8"L x 1/2"W	50

MAGNETIC PUSH/TOUCH LATCHES

Varied Throw Distances

- When door is pushed in, spring-loaded mechanism pushes door open
- Latches have short, medium and long throw distances
- Strike plates included with all latches
- Single (one door) and double (two door) types available
- Plastic housing available in brown, black and white colors
- Magnetic pull force: A) 2.6 lbs., B) 2.6 lbs., C) 3.5 lbs., D) 5.2 lbs.
- Mounting screws not included

Packing: As shown below.

Sold In: Both broken and full box quantities.

Discount available for full box orders.

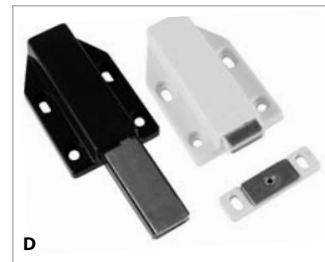
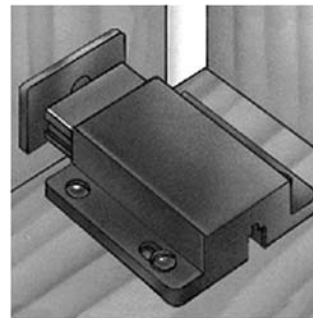

	Item #	Color	Throw Length	Type	Latch Dimensions (Length x Width x Height)	Strike Dimensions (Length x Width x Thickness)	Box Qty
A	SLML30S-WH	White	.33" Short	Single	1.2"L x 1.69"W x .63"H	.91"L x .47"W x .055"Thick	50
	SLML30S-BN	Brown	.33" Short	Single	1.2"L x 1.69"W x .63"H	.91"L x .47"W x .055"Thick	50
B	SLML30W-BN	Brown	.33" Short	Double	1.2"L x 1.69"W x .63"H	.91"L x .47"W x .055"Thick	30
	SLML30W-WH	White	.33" Short	Double	1.2"L x 1.69"W x .63"H	.91"L x .47"W x .055"Thick	30
C	SLML80-BN	Brown	.59" Medium	Single	1.72"L x 1.69"W x .59"H	.91"L x .47"W x .055"Thick	20
	SLML80-BK	Black	.59" Medium	Single	1.72"L x 1.69"W x .59"H	.91"L x .47"W x .055"Thick	20
	SLML80-WH	White	.59" Medium	Single	1.72"L x 1.69"W x .59"H	.91"L x .47"W x .055"Thick	20
D	SLML120-BRN	Brown	1.57" Long	Single	2.97"L x 1.81"W x .67"H	1.34"L x 1.47"W x .20"Thick	20
	SLML120-WHT	White	1.57" Long	Single	2.97"L x 1.81"W x .67"H	1.34"L x 1.47"W x .20"Thick	20

SECTION D CABINET LOCKS & LATCHES

PUSH LATCHES

NON-MAGNETIC TOUCH LATCHES

Standard Retaining Force

- Constructed of ABS plastic
- Floating strike for easy alignment
- Retaining force of 6.6 lbs.
- Touch latch allows door to pop out when door is pushed in
- Allow 3mm (1/8") space for push in release
- Screws included

Packing: Includes latch and catch.

Sold In: Both broken and full box quantities.

Discount available for full box orders.

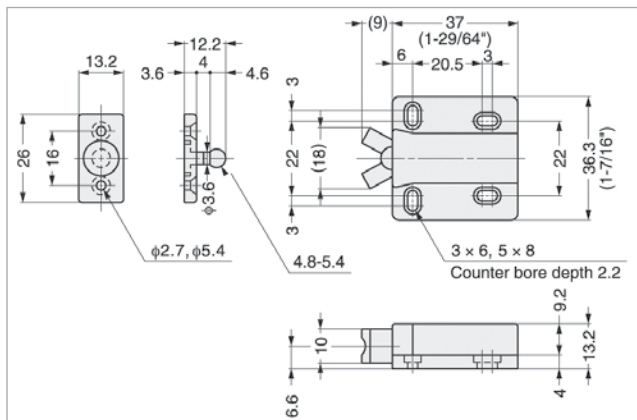

Item#	Color	Box Qty
SLMC28-BL	Black	40

NON-MAGNETIC TOUCH LATCHES

Strong Retaining Force

- Constructed of ABS plastic
- Strong retaining force of 17.6 lbs.
- Floating strike for easy alignment
- Allow 3mm (1/8") space for push in release
- Screws included

Packing: Includes latch and catch.

Sold In: Both broken and full box quantities.

Discount available for full box orders.

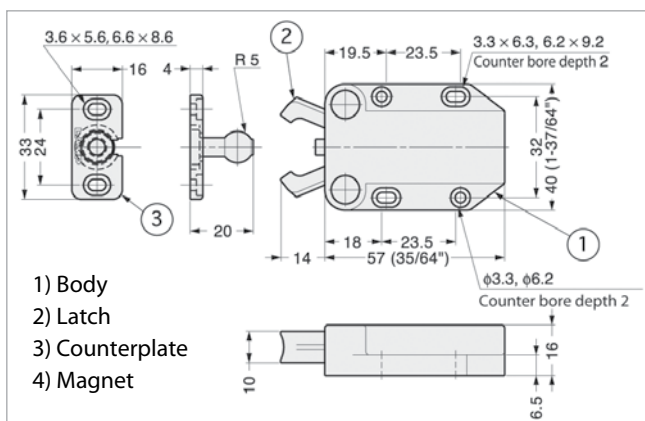

Item#	Color	Box Qty
SLMC37-BL	Black	30
SLMC37-BN	Brown	30
SLMC37-WH	White	30

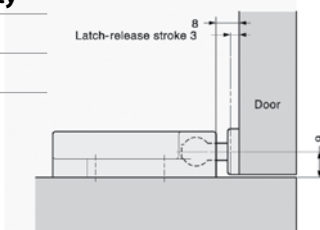

NON-MAGNETIC PUSH/TOUCH LATCHES

Metal Housing

- For use on wood cabinets
- Opens cabinet doors automatically with a gentle touch of finger, arm or elbow
- Individually polypagged with screws

Packing: Includes latch and catch.

Sold in: Both broken and full box quantities.

Discount available for full box orders.

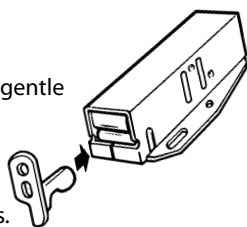

Item#	Finish	Box Qty
FRPB942ZP	Zinc Plated	50

NON-MAGNETIC PUSH/TOUCH LATCHES

- Can be used on overlay, flush, and inset doors
- Mounts either horizontally or vertically
- Individually polypagged with screws

Packing: Latch and strike sold together.

Sold in: Both broken and full box quantities.

Discount available for full box orders.



Item#	Strike Finish	Latch Finish	Box Qty
FRPB944BP	Brown Plastic	Brass Plated	50
FRPB944NP	White Plastic	Nickel Plated	50

TENSION CATCHES

Non-Adjustable Tension

- Precision made tension catches are made of stainless steel and zinc (see table below)
- Fixed/non adjustable pull force is outlined in the table below
- Mounting screws not included

Packing: Strike and catch sold together.

Sold In: Both broken and full box quantities.



SUGATSUNE

	Item #	Pull Force	Catch Dimensions (Length x Width x Depth)	Strike Dimensions (Length x Width x Depth)	Material	Box Qty
A	SLBCTS40	2.9 lbs.	43mm L x 8mm W x 7.5mm D	25mm L x 7.5mm W x 11mm D	Stainless Steel	50
	SLBCTS50	5.0 lbs.	50mm L x 10mm W x 9.3mm D	30mm L x 9mm W x 13.2mm D	Stainless Steel	50
	SLBCTS70	12.5 lbs.	70mm L x 13mm W x 9.3mm D	42mm L x 10.5mm W x 19mm D	Stainless Steel	25
B	SLBCU40	5.5 lbs.	28.5mm L x 8.3mm W x 12.5mm D	24mm L x 8mm W x 12mm D	Zinc	100
	SLBCU70	7.9 lbs.	48mm L x 13.5mm W x 20.5mm D	42mm L x 11mm W x 17mm D	Zinc	50
C	SLBCT60W	5.9 lbs.	58mm L x 13.3mm W x 24mm D	24mm L x 7.5mm W x 10mm D	Zinc	12

TENSION CATCHES

Adjustable Tension

- Solid brass catch and strike is available in four finishes: Bright Brass, Dull Brass, Dull Chrome and Bright Nickel
- Screw on top and bottom provide adjustable tension
- Strike may enter from either side or front

Packing: As shown below.

Sold In: Both broken and full box quantities.

Discount available for full box orders.

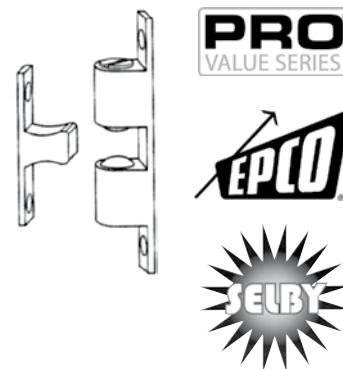

Bright Brass Item#	Finish	Catch Dimensions (Length x Width x Depth)	Strike Dimensions (Length x Width x Depth)	Screws Included	Box Qty
AV511PBR-1	Bright Brass	1-11/16" L x 5/16" W x 3/8" D	1" L x 5/16" W x 3/8" D	No	25
AV511PBR-2	Bright Brass	1-3/16" L x 3/8" W x 7/16" D	1-1/8" L x 5/16" W x 7/16" D	No	25
AV511PBR-3	Bright Brass	2-3/8" L x 7/16" W x 1/2" D	1-7/16" L x 7/16" W x 1/2" D	No	25
AV511PBR-4	Bright Brass	2-3/4" L x 1/2" W x 5/8" D	1-5/8" L x 1/2" W x 5/8" D	No	25
EP1017-DB	Dull Brass	2-23/32" L x 1/2" W x 37/64" D	1-21/32" L x 7/16" W x 37/64" D	Yes	100
EP1017-DC	Dull Chrome	2-23/32" L x 1/2" W x 37/64" D	1-21/32" L x 7/16" W x 37/64" D	Yes	100
FR511NP-3-N	Bright Nickel	2-3/8" L x 1/2" W x 1/2" D	1-7/16" L x 7/16" W x 1/2" D	No	25
FR511NP-4S	Bright Nickel	2-3/4" L x 1/2" W x 5/8" D	1-5/8" L x 1/2" W x 5/8" D	No	25

SECTION D CABINET LOCKS & LATCHES

ROLLER & FRICTION CATCHES

SMALL METAL SINGLE ROLLER CATCHES



- Base Size: 1-1/4" L x 1-3/8" W x 5/8" H
 - Strike Size:
 - (A) For Inset Doors: 1-3/4" L x 1-1/4" W x 1/2" H
 - (B) For Overlay or Flush Doors: 1-3/4" L x 1-1/8" W x 1/2" H
 - Screws and both strikes included
- Packing:** 25 sets (catch and two strikes) per box.
Sold in: Both broken and full box quantities.

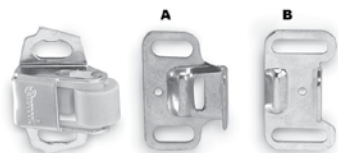

Item#	Finish
AMBP9823-2G	Bright Zinc

LARGE METAL SINGLE ROLLER CATCHES



- Base Size: 1-1/2" L x 2-1/8" W x 7/8" H
 - Strike Size: 1/16" x 1-3/4"
 - Screws included
- Packing:** Catch and strike sold together.
Sold in: AMBP sold in both broken and full box quantities. Discount available for full box orders. AMCM sold in full box quantities only.



Item#	Finish	Box Qty
AMBP9745-2G	Bright Zinc	25
AMCM9745-2G	Bright Zinc	200

PLASTIC DOUBLE ROLLER CATCHES



- Polyacetal plastic catch and polyamide finish strike
 - Durability proven by 3,000,000 cycle test
 - Mounting screws not included
- Packing:** Catch and strike sold together.
Sold In: Both broken and full box quantities. Discount available for full box orders.



Item#	Pull Force	Color	Box Qty
SL6900-WHT	3.5 lbs.	White	100
SL6901-BRN	7.0 lbs.	Brown	100
SL6901-WHT	7.0 lbs.	White	100

METAL DOUBLE ROLLER CATCHES



- Steel with spring-cushioned polyethylene rollers.
 - Screws and strike included
 - Base Size: 1-5/16" L x 1 1/16" W x 5/8" H
 - Strike Size: 1-5/16" L x 1/4" W x 1/2" H
 - Screws included
- Packing:** Catch and strike sold together.
Sold in: "IM" available both broken and full box quantities. Discount available for full box orders. "AM" available full box only.

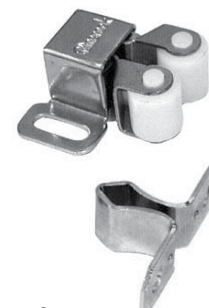

Item#	Finish	Box Qty
IM72-2G	Zinc Plated Steel	50
AMCM9714A-2G	Zinc Plated Steel	400

PLASTIC FRICTION CATCHES Non-Adjustable



- White polyacetal catch and polyamide finish strike
 - Mounting screws not included
- Packing:** Catch and strike sold together.
Sold In: Both broken and full box quantities. Discount available for full box orders.



Item#	Pull Force	Box Qty
SLKCATCH-WHT	15.6 Lbs.	100

PLASTIC FRICTION CATCHES Adjustable



- Heavy duty adjustable knuckle catch
 - Catch force adjustable by turning included adjustment screw
 - Mounting screws not included
- Packing:** Catch and strike sold together.
Sold In: Both broken and full box quantities. Discount available for full box orders.



Item#	Pull Force	Color	Box Qty
SL1-555-2WHT	18-44 lbs.	White	20

METAL FRICTION CATCHES



- Base Size: 1-5/16" L x 1" W x 1/2" H
- Strike Size: 1-1/4" L x 3/8" W x 5/8" H
- Screws included

Packing: Catch and strike sold together.

Sold in: Both broken and full box quantities.
Discount available for full box orders.



Item#	Finish	Box Qty
AMBP3471-2G	Zinc Plated Steel	25

PLASTIC FRICTION CATCHES



- Nylon catch with stainless steel spring clip
- Comes with plated adjustable door strike and screws
- Provides 8 lbs. of pull force

Packing: As shown below.

Sold in: Both broken and full box quantities.
Discount available for full box orders.

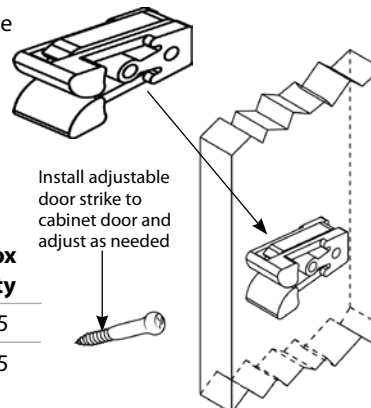

Item#	Color	Box Qty
PL21-BN	Brown	25
PL21-WH	White	25

ELBOW CATCHES

- Both catch and strike have slots to provide adjustment
- Strike plate has extra screw hole to prevent spinning on plastic laminate
- Made of solid brass
- Catch Size: 1-9/64" x 45/64"
- Strike Size: 7/8" length x 45/64" wide
- Individually polybagged with screws

Packing: Catch and strike sold together.

Sold in: Both broken and full box quantities.
Discount available for full box orders.

Item#	Finish	Box Qty
EP1018B+	Bright Brass	25
EP1018N+	Bright Chrome	25



ELBOW CATCHES



- Strike plate has extra screw hole to prevent spinning on plastic laminate
- Catch Size: 1-5/16" L x 1" W x 1" H
- Strike Size: 1" L x 7/16" W x 1/4" H
- Screws included

Packing: Catch and strike sold together.

Sold in: AMBP sold in both broken and full box quantities. Discount available for full box orders. AMCM sold in full box quantities only.



Item#	Finish	Box Qty
AMBP3675-2G	Bright Zinc	25 Pairs (50 Each)
AMCM3675-2G	Bright Zinc	500 Each

ELBOW CATCHES



- Catch Size: 1-3/8" x 5/8"
- Strike Size: 13/16" x 5/8"
- Conforms to design requirements of ANSI/BHMA A156.9

Packing: Catch and strike sold together.

Sold in: Both broken and full box quantities.
Discount available for full box orders.

Item#	Finish	Box Qty
IV2A92	Natural Aluminum	20
IV2A3	Bright Brass	20
IV2A14	Bright Nickel	20



BULLET CATCHES

- Furnished with strike and nail

Packing: Catch and strike sold together.

Sold in: Full box quantities only.

Item#	Bore Diameter	Bore Depth	Finish	Box Qty
FR300BP-3/8S	3/8"	7/16	Bright Brass	144



SECTION D CABINET LOCKS & LATCHES

BALL CATCHES

BALL CATCHES, SMALL Adjustable

- Ideal for cabinets and small interior doors
- Free rolling ball insures smooth, positive and trouble-free action
- Adjustable threaded barrel compensates (up to 1/4") for various door clearances
- Adjustable spring tension
- Made from wrought brass
- Meets ANSI/BHMA A156.9 B23013.

Dimensions:

Face Plate: 3/4" Wide x 1-1/2" High

Bore: 1" Deep x 9/16" Diameter

Strike: 25/32" Wide x 1-1/2" High,

Lip to center – 13/32"

Packing: Catch and strike sold together.

Sold in: Both broken and full box quantities. Discount available for full box orders.

Item#	Finish	Box Qty
IV345B3	Bright Brass	10
IV345B5	Antique Brass	10
IV345B10B	Dark Satin Bronze	10
IV345B26	Bright Chrome	10



BALL CATCHES, LARGE Dual Adjustment

- For catch in door installations where the catch is mounted in the door and the strike is mounted on the jamb
- Dual adjustment for door clearance and holding strength
- Lip strike is designed for use where strike is mounted in jamb
- Free rolling ball insures smooth, positive and trouble-free action
- Adjustable threaded barrel compensates for various door clearances
- Adjustable spring tension
- Made from wrought brass
- Meets ANSI/BHMA A156.9 B23013

Dimensions:

Catch Face Plate: 1" Wide x 2-1/8" High

Bore: 1-3/8" Deep x 7/8" Diameter

Strike: 1-3/8" Wide x 2-1/8" High, Lip to center- 7/8"

Packing: Catch and strike sold together.

Sold In: Both broken and full box quantities. Discount available for full box orders.

Item#	Finish	Box Qty
IV347B5	Antique Brass	10
IV347B26D	Satin Chrome	10



PUSH KNOB CABINET LOCKS

- Pushing in the button activates and secures the latch so the door will not open until the button is pushed again
- Suitable for left or right side use, and inset as well as overlay mounting
- Used for door thickness from 19mm up to 30mm
- Holding force of up to 44 lbs.
- Supplied with stainless steel screws
- Latch body is made from Polyamide; Push button is Solid Brass; and the base is made from Zinc Alloy

NOTE: Latch body and Push Button and Base sold separately.

Packing: As shown below.

Sold in: Both broken and full box quantities.

Discount available for full box orders.

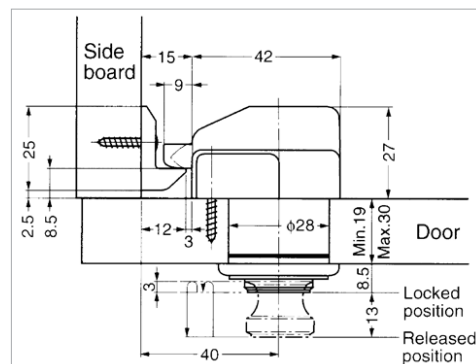
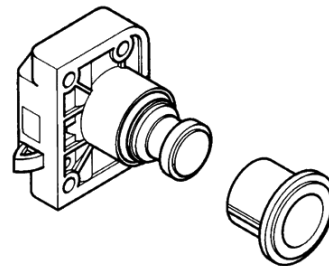

Item#	Description	Finish	Box Qty
SLTLP-CR	Push Button and Base	Chrome	25
SLTLPLB-W	Latch Body	White	10

SLIDE BOLTS

- Flat and compact design
- Mortise and surface mount catches included
- Stainless Steel material and finish
- Stainless steel screws included

Packing: Bolt and two catches sold together.

Sold In: Both broken and full box quantities. Discount available for full box orders.



Item#	Length	Finish	Box Qty
SLFL4-35	1-3/8"	Satin Stainless	30
SLFL4-55	2-11/64"	Satin Stainless	30

SLIDE BOLTS, STEEL

- Solid Brass material
- Mortise and surface mount catches included
- Mounting screws included

Packing: Bolt and two catches sold together.

Sold In: Both broken and full box quantities. Discount available for full box orders.



Item#	Dimensions (Length x Width x Height)	Finish	Box Qty
SLSBL-35	1-27/64"L x 1-9/64"W x 45/64"H	Satin Nickel	20
SLSBL-45	1-25/32"L x 1-3/16"W x 23/32"H	Satin Nickel	10

SLIDE BOLTS

- For use in double doored cabinets to secure the unlocked door from inside the cabinet
- Plastic
- Size: 3" overall length x 1/2" wide x 7/8" overall depth
- Screws not included

Packing: As shown below.

Sold in: Both broken and full box quantities. Discount available for full box orders

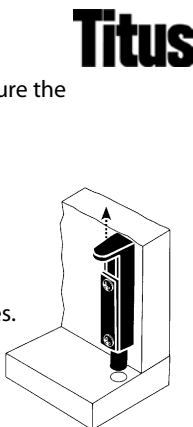

Item#	Color	Box Qty
TT4293BLK	Black	50

SCREW-ON HASPS

- 316 Stainless Steel
- Catch is designed to accept pad lock
- Stainless steel screws included

Packing: Hasp and catch sold together.

Sold In: Both broken and full box quantities. Discount available for full box orders.



Item#	Length	Width	Finish	Box Qty
SLHP635S	3-1/2"	1-1/2"	Bright Steel	10
SLHP645S	4-1/2"	1-1/2"	Bright Steel	10
SLHP660S	6"	2"	Bright Steel	10

MINI DRAW LATCHES WITH LOCK

- 304 Stainless Steel
- Compact size (2-1/64" long x 1-3/16" wide x 1/4" tall) is easy to incorporate into products
- Mounting screws not included
- No key changes available

Packing: Latch, catch and key sold together.

Sold In: Both broken and full box quantities. Discount available for full box orders.



Item#	Finish	Box Qty
SLPN51	Plain Steel	40

DRAW LATCHES WITH TWIST CLOSE

- Stainless Steel finish
- Latch is 2-9/16" long x 2-3/64" wide x 1/2" tall
- Mounting screws not included

Packing: Latches and catch sold together.

Sold In: Both broken and full box quantities. Discount available for full box orders.



Item#	Finish	Box Qty
SLP102H-SS	Bright Steel	60

SECTION D CABINET LOCKS & LATCHES

DRAW LATCHES & CUPBOARD CATCHES

DRAW LATCHES

Spring Loaded

- 304 Stainless Steel
- Mounting screws not included
- Latch body is 1-21/32" long x 5/8" x 1/2" tall
- Catch plate is 39/64" long x 29/32" wide x 21/64" tall

Packing: As shown below.

Sold In: Both broken and full box quantities.
Discount available for full box orders.

Item#	Finish	Box Qty
SLSCC40-SS	Satin Stainless	100



DRAW LATCHES

Spring Loaded

- 304 Stainless Steel
- Latch is 3-5/32" long x 1" wide x 3/4" tall
- Mounting screws not included (M4 recommended)
- Durable against vibration

Packing: As shown below.

Sold In: Both broken and full box quantities.
Discount available for full box orders.

Item#	Finish	Box Qty
SLSTF80	Satin Stainless	12



CUPBOARD CATCHES

- For cabinet or small doors
- A convertible latch that has two settings; functional and strictly decorative
 - Functional – A setting that has the catch operate as a standard catch
 - Strictly Decorative – A setting that has the latch permanently in the "open" position
- Surface mounted, making installation simple
- Latch Dimension: 2-1/8" wide x 1-1/2" long x 9/16" high
- Catch Dimension: 2-1/8" wide x 9/16" long x 5/8" high
- Made of Zinc and available in four finishes
- All catches are poly-bagged with installation screws

Packing: Latch and catch sold together.

Sold In: Both broken and full box quantities.
Discount available for full box orders.

Item#	Finish
BQ5148-14-P	Polished Nickel
BQ5149-VB-P	Venetian Bronze
BQ5150-BPN-P	Brushed Nickel
BQ5151-VTN-P	Vintage Nickel

Berenson



CUPBOARD CATCHES

- For cabinet or small doors
- Surface mounted, making installation simple
- Overall Size: 1-3/4" x 1-1/2"
- Made from cast brass

Packing: Latch and catch sold together.

Sold In: Both broken and full box quantities.

Discount available for full box orders.

Item#	Finish	Box Qty
IV540B19	Flat Black	10

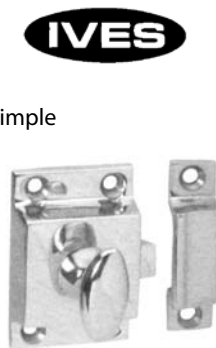

STEEL CHAIN

- Decorative chain can be utilized to keep lids or fronts from opening beyond a certain point
- The angle or distance of the opening can always be easily adjusted by making the chain shorter or longer

Packing: As shown below.

Sold In: Full roll quantities only.

Item#	Finish	Roll Size
LC1001X-BP	Bright Brass	10 feet

