

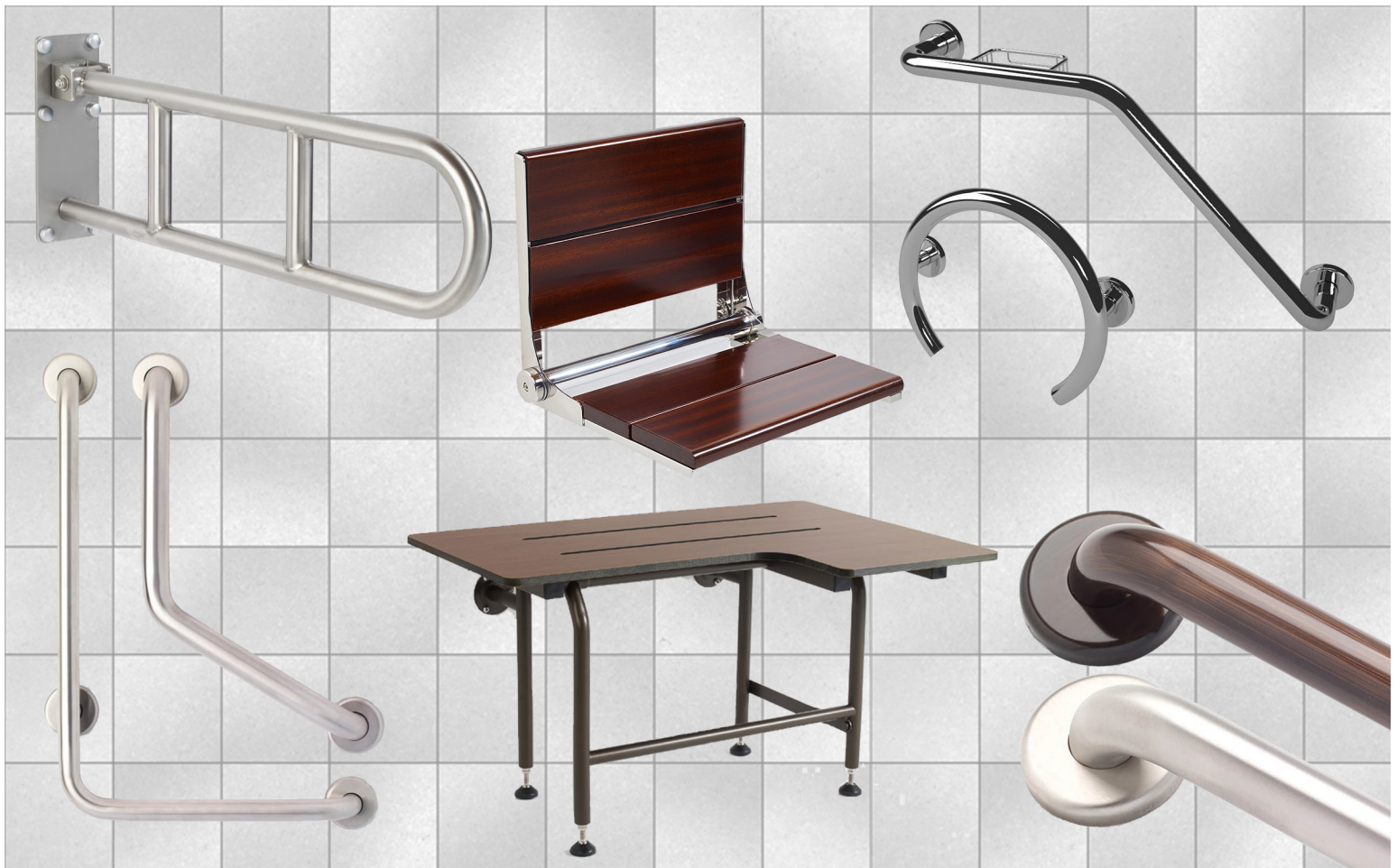

# ELCOMA

Raising the bar since 1988

## Product Catalog - 2017



[www.elcoma.com](http://www.elcoma.com) | [facebook.com/ElcomaMetal](https://www.facebook.com/ElcomaMetal)

Manufacturing A.D.A. compliant products since 1988 | Residential & commercial washroom accessories

521 Lawrence Rd. NE, Canton, OH 44704 | [cservice@elcoma.com](mailto:cservice@elcoma.com) | Toll Free 1.800.352.6625 | Toll Free Fax 1.800.625.5560

# TERMS & CONDITIONS

## **TERMS of SALE:**

All accounts are net thirty (30) days unless otherwise specified. Past due accounts will be subject to a service charge of 1.5% per month. (18% APR)

ALL CLAIMS FOR MATERIAL SHORTAGES OR DAMAGED GOODS MUST BE MADE WITHIN SEVEN (7) DAYS FROM THE DATE OF INVOICE.

## **RETURNED or CANCELED GOODS:**

Prior approval **MUST** be received in writing from Elcoma Meal for the request to return material A detailed list of material to be returned must be submitted, as well as supporting data as to the date purchased and invoice number

All returned material:

- Must be accompanied by a packing list.
- Is subject to our plant count and inspection.
- Is to be shipped freight prepaid.

Credit will only be allowed on resalable material.

Stock products will only be accepted up to thirty (30) days with a restocking charge of 25%.

ONLY ELCOMA'S CREDIT MEMOS WILL BE HONORED. THERE SHOULD NOT BE ANY DEDUCTIONS MADE BY YOU ON YOUR PAYMENTS AGAINST YOUR ACCOUNT WITHOUT OUR CREDIT MEMO NUMBER. ANY SUCH DEDUCTION BEING MADE WILL BE DISREGARDED AND WILL REMAIN OPEN ON YOUR ACCOUNT.

## **RESALE PRICE:**

All Elcoma products will be replaced within one (1) year of shipment if defective in workmanship or material. Elcoma will not be liable for any labor, damage, or other expense of any kind incurred in connection with the sale or use of Elcoma products. There is no warranty as to the durability of finishes.

## **HANDLING CHARGE:**

There is a \$4.00 handling charge for all 90 degree angle, corner, and wall to floor bars, and on custom items.

**CUSTOM CONFIGURATIONS:** Requests for custom items must be accompanied by dimensional drawings and/or specifications provided by the customer. Absolutely no cancellations can be made after fabrication has begun. Elcoma reserves the right to decline manufacture of non-code designs considered to be unsafe. CUSTOM ORDERS REQUIRE FOUR TO SIX (4 - 6) WEEKS FOR DELIVERY.

# LIFE LINE COLLECTION - GRAB BARS

## *LIFE LINE* collection

The **Life Line Collection** is a unique selection of products that will make your bathroom a much safer environment. Combined with simple installation, this makes our **Life Line Collection** the #1 choice for designers and remodelers.

- Features corrosion resistant 1.25" diameter, 18" gauge heavy duty stainless steel.
- Mounting hardware is included for both hollow and stud or block walls.
- Meets and exceeds ADA and ANSI standards (to 500 lbs)



### **TUB / SHOWER VALVE RING - 1 1/4" DIA Grab Bar**

#### OPTIONS:

**Finish:** **(SS)** Stainless Steel, **(PC)** Polished Chrome, **(BN)** Brushed Nickel, **(WH)** White, **(ORB)** Oil Rubbed Bronze

#### PART NUMBER:

#	Finish
LL-2010	- _ _ _



### **TOILET PAPER HOLDER SEMISPHERE - 1 1/4" DIA Grab Bar**

#### OPTIONS:

**Finish:** **(SS)** Stainless Steel, **(PC)** Polished Chrome, **(BN)** Brushed Nickel, **(WH)** White, **(ORB)** Oil Rubbed Bronze

#### PART NUMBER:

#	Finish
LL-2020	- _ _ _



## DESIGNER TOILET PAPER HOLDER - 1 1/4" DIA Grab Bar

### OPTIONS:

**Orientation:** **(RH)** Right Hand, **(LH)** Left Hand

**Finish:** **(SS)** Stainless Steel, **(PC)** Polished Chrome, **(BN)** Brushed Nickel, **(WH)** White, **(ORB)** Oil Rubbed Bronze

### PART NUMBER:

#	Orientation	Finish
LL-2030	__	- __ __



## TOWEL BAR - 1 1/4" DIA Grab Bar

### OPTIONS:

**Finish:** **(SS)** Stainless Steel, **(PC)** Polished Chrome, **(BN)** Brushed Nickel, **(WH)** White, **(ORB)** Oil Rubbed Bronze

### PART NUMBER:

#	Finish
LL-2040	- __ __



## SHAMPOO SHELF - 1 1/4" DIA Grab Bar

### OPTIONS:

**Finish:** **(SS)** Stainless Steel, **(PC)** Polished Chrome, **(BN)** Brushed Nickel, **(WH)** White, **(ORB)** Oil Rubbed Bronze

### PART NUMBER:

#	Finish
LL-2050	- __ __



## SOAP BASKET - 1 1/4" DIA Grab Bar

### OPTIONS:

**Orientation:** (RH) Right Hand, (LH) Left Hand

**Finish:** (SS) Stainless Steel, (PC) Polished Chrome, (BN) Brushed Nickel, (WH) White, (ORB) Oil Rubbed Bronze

### PART NUMBER:

#	Orientation	Finish
LL-2060	--	- ---



## WAVE - 1 1/4" DIA Grab Bar

### OPTIONS:

**Length:** (LL-2070) 18", (LL-2080) 24", (LL-2090) 36"

**Orientation:** (RH) Right Hand, (LH) Left Hand

**Finish:** (SS) Stainless Steel, (PC) Polished Chrome, (BN) Brushed Nickel, (WH) White, (ORB) Oil Rubbed Bronze

### PART NUMBER:

#	Orientation	Finish
LL-20__	--	- ---



## SWEEPING - 1 1/4" DIA Grab Bar

### OPTIONS:

**Finish:** (SS) Stainless Steel, (PC) Polished Chrome, (BN) Brushed Nickel, (WH) White, (ORB) Oil Rubbed Bronze

### PART NUMBER:

#	Finish
LL-2100	- ---



## CORNER SHELF - 1 1/4" DIA Grab Bar

### OPTIONS:

**Finish:** **(SS)** Stainless Steel, **(PC)** Polished Chrome, **(BN)** Brushed Nickel, **(WH)** White, **(ORB)** Oil Rubbed Bronze

### PART NUMBER:

#	Finish
LL-2200	- _ _ _



## SKYLINE - 1 1/4" DIA Grab Bar

### OPTIONS:

**Length:** **(LL-2300)** 18", **(LL-2310)** 24", **(LL-2320)** 36", **(LL-2330)** 42"

**Finish:** **(SS)** Stainless Steel, **(PC)** Polished Chrome, **(BN)** Brushed Nickel, **(WH)** White, **(ORB)** Oil Rubbed Bronze

### PART NUMBER:

#	Finish
LL-23 _ _	- _ _ _



# STRAIGHT GRAB BARS

Elcoma exceeds the highest standards set by federal, state and local codes. The same rigorous standards are applied in the manufacturing and design of our commercial and residential line of grab bars. Along with quality fabrication and modern design our product line is available in a variety of colors and finishes.

## Grips:

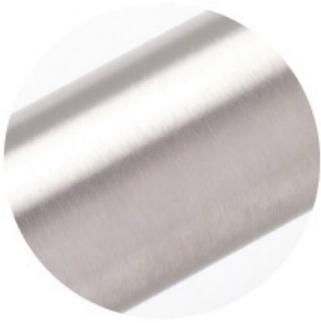

Smooth

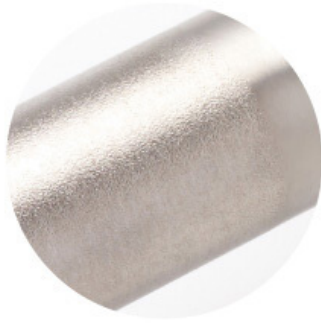

Peened



Knurled



Shurgrip (1.25" only)

## Finishes:



White



White  
textured



Almond



Oil rubbed  
bronze-light



Oil rubbed  
bronze-dark



Old World  
Bronze



Stainless  
steel

## Signature Collection Flanges (1 1/4" bars only):





01-1112SL

## 01 - CHROME - 1" DIA Straight Grab Bar

### OPTIONS:

Length: 12, 16, 18, 24, 30, 32, 36, 42, 48

Grip: **(S)** Smooth, **(K)** Knurled

Flange: **(L)** Low Profile

### PART NUMBER:

#	Length	Grip	Flange
01-11	--	-	L



01-1512SJ02

## 01 - POWDER COATED - 1" DIA Straight Grab Bar

### OPTIONS:

Length: 12, 16, 18, 24, 30, 32, 36, 42, 48

Grip: **(S)** Smooth

Flange: **(J)** 3 Hole Exposed

Color: **(01)** White, **(02)** Almond

### PART NUMBER:

#	Length	Grip	Flange	Color
01-15	--	S	J	--



01-5212SE

## 01 - STAINLESS STEEL - Straight Grab Bar

### OPTIONS:

Diameter: **(01-22)** 1 ¼", **(01-52)** 1 ½"

Length: 12, 16, 18, 24, 30, 32, 36, 42, 48

Grip: **(S)** Smooth, **(K)** Knurled, **(P)** Peened, **(G)** ShurGrip

SHURGRIP ONLY AVAILABLE ON 1 ¼" DIAMETER

Flange: **(T)** Twist Lock, **(E)** 3 Hole Exposed, **(SF-RD)** Signature Round, **(SF-SQ)** Signature Square

SIGNATURE FLANGES ONLY AVAILABLE ON 1 ¼" DIAMETER

### PART NUMBER:

#	Length	Grip	Flange
01 - _ 2	--	-	----





01-2312ST

# 01 - MIRROR FINISH - 1 1/4" DIA Straight Grab Bar

## OPTIONS:

Length: 12, 16, 18, 24, 30, 32, 36, 42, 48

Grip: **(S)** Smooth, **(K)** Knurled, **(P)** Peened

Flange: **(T)** Twist Lock, **(SF-RD)** Signature Round, **(SF-SQ)** Signature Square

## PART NUMBER:

#	Length	Grip	Flange
01-23	--	-	----



01-2612STGSP

# 01 - SPECKLED COATED - 1 1/4" DIA Straight Grab Bar

## OPTIONS:

Length: 12, 16, 18, 24, 36, 42

Grip: **(S)** Smooth

Flange: **(T)** Twist Lock, **(SF-RD)** Signature Round, **(SF-SQ)** Signature Square

Finish: **(GSP)** Gold Speckled, **(SSP)** Silver Speckled, **(BSP)** Bronze Speckled

## PART NUMBER:

#	Length	Grip	Flange	Finish
01-26	--	S	----	---

## Speckled Signature Flanges:



Speckled silver



Speckled gold



Speckled bronze

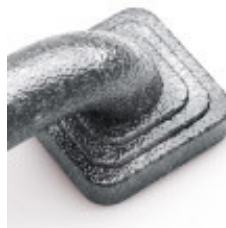

Speckled silver



Speckled gold



Speckled bronze



01-2612ST20

## 01 - POWDER COATED - 1 1/4" DIA Straight Grab Bar

### OPTIONS:

**Length:** 12, 16, 18, 24, 30, 32, 36, 42, 48

**Grip:** **(S)** Smooth, **(K)** Knurled, **(G)** ShurGrip, **(TX)** Textured

TEXTURED GRIP AVAILABLE IN WHITE ONLY!

**Flange:** **(T)** Twist Lock, **(CH)** Chrome Flange, **(BR)** Brass Flange, **(SF-RD)** Signature Round, **(SF-SQ)** Signature Square

CHROME AND BRASS FLANGES WITH SMOOTH AND SHURGRIP GRIPS ONLY!

**Color:** **(01)** White, **(02)** Almond, **(20)** Biscuit

### PART NUMBER:

#	Length	Grip	Flange	Color
01-26	--	-	--	--



01-2712ST-AVBZ-BR

## 01 - ANTIQUE VENETIAN BRONZE - 1 1/4" DIA Straight Grab Bar

### OPTIONS:

**Length:** 12, 16, 18, 24, 30, 32, 36, 42, 48

**Grip:** **(S)** Smooth, **(K)** Knurled, **(G)** ShurGrip

**Flange:** **(T)** Twist Lock, **(SF-RD)** Signature Round, **(SF-SQ)** Signature Square

**Finish:** **(-AVBZ-BR)** Antique Venetian Bronze

### PART NUMBER:

#	Length	Grip	Flange	Finish
01-27	--	-	----	-AVBZ-BR

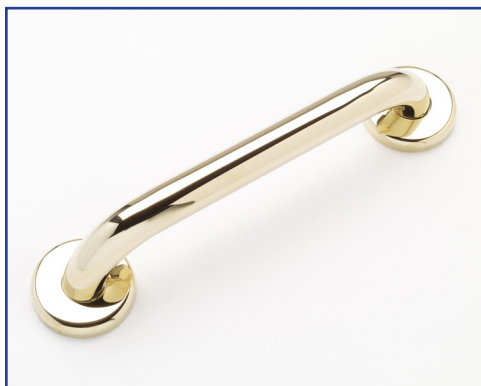

01-2712ST-BS

## 01 - BRASS - 1 1/4" DIA Straight Grab Bar

### OPTIONS:

**Length:** 12, 16, 18, 24, 30, 32, 36, 42, 48

**Grip:** **(S)** Smooth, **(K)** Knurled, **(G)** ShurGrip

**Flange:** **(T)** Twist Lock, **(SF-RD)** Signature Round, **(SF-SQ)** Signature Square

**Finish:** **(-BS)** Brass

### PART NUMBER:

#	Length	Grip	Flange	Finish
01-27	--	-	----	-BS



01-2712ST-NP-BR

## 01 - BRUSHED NICKEL - 1 1/4" DIA Straight Grab Bar

### OPTIONS:

Length: 12, 16, 18, 24, 30, 32, 36, 42, 48

Grip: **(S)** Smooth, **(K)** Knurled, **(G)** ShurGrip

Flange: **(T)** Twist Lock, **(SF-RD)** Signature Round, **(SF-SQ)** Signature Square

Finish: **(-NP-BR)** Brushed Nickel

### PART NUMBER:

#	Length	Grip	Flange	Finish
01-27	--	-	----	-NP-BR



01-2712ST-CH-BR

## 01 - BRUSHED CHROME - 1 1/4" DIA Straight Grab Bar

### OPTIONS:

Length: 12, 16, 18, 24, 30, 32, 36, 42, 48

Grip: **(S)** Smooth, **(K)** Knurled, **(G)** ShurGrip

Flange: **(T)** Twist Lock, **(SF-RD)** Signature Round, **(SF-SQ)** Signature Square

Finish: **(-CH-BR)** Brushed Chrome

### PART NUMBER:

#	Length	Grip	Flange	Finish
01-27	--	-	----	-CH-BR

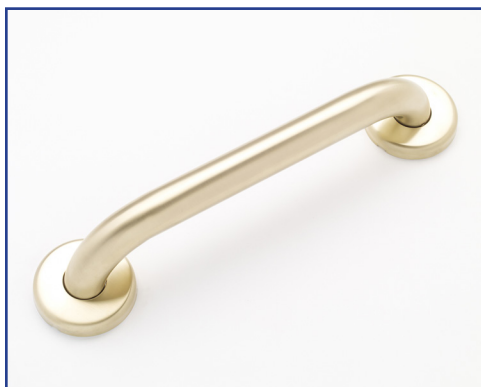

01-2712ST-BS-BR

## 01 - BRUSHED BRASS - 1 1/4" DIA Straight Grab Bar

### OPTIONS:

Length: 12, 16, 18, 24, 30, 32, 36, 42, 48

Grip: **(S)** Smooth, **(K)** Knurled, **(G)** ShurGrip

Flange: **(T)** Twist Lock, **(SF-RD)** Signature Round, **(SF-SQ)** Signature Square

Finish: **(-BS-BR)** Brushed Brass

### PART NUMBER:

#	Length	Grip	Flange	Finish
01-27	--	-	----	-BS-BR



01-2212KT-OWB

## 01 - OIL RUBBED BRONZE - Straight Grab Bar

### OPTIONS:

**Diameter:** (01-22) 1 ¼", (01-52) 1 ½"

**Length:** 12, 16, 18, 24, 30, 32, 36, 42, 48

**Grip:** (S) Smooth, (K) Knurled, (G) ShurGrip

SHURGRIP ONLY AVAILABLE ON 1 ¼" DIAMETER

**Flange:** (T) Twist Lock (SF-RD) Signature Round, (SF-SQ) Signature Square

SIGNATURE FLANGES ONLY AVAILABLE ON 1 ¼" DIAMETER

**Finish:** (ORB-LT) Light Oil Rubbed Bronze, (ORB-DK) Dark Oil Rubbed Bronze, (OWB) Old World Bronze

### PART NUMBER:

#	Length	Grip	Flange	Finish
01 - _ 2	__	_	T	_____



01-2912ST

## 01 - CHROME - 1 ¼" DIA Straight Grab Bar

### OPTIONS:

**Length:** 12, 16, 18, 24, 30, 32, 36, 42, 48

**Grip:** (S) Smooth, (K) Knurled, (G) ShurGrip

**Flange:** (T) Twist Lock

### PART NUMBER:

#	Length	Grip	Flange
01-29	__	_	T



01-5612ST01

## 01 - POWDER COATED - 1 ½" DIA Straight Grab Bar

### OPTIONS:

**Length:** 12, 16, 18, 24, 30, 32, 36, 42, 48

**Grip:** (S) Smooth, (K) Knurled, (TX) Textured

TEXTURED GRIP ONLY AVAILABLE IN WHITE!

**Flange:** (TA) Twist Lock

**Color:** (01) White, (02) Almond

### PART NUMBER:

#	Length	Grip	Flange
01-56	__	_	T

## 02 - STAINLESS STEEL - Grab Bar w/ Post

### OPTIONS:

**Diameter:** (02-22) 1 ¼", (02-52) 1 ½"

**Length:** 36, 42, 48, 52, 54, 60

**Grip:** (S) Smooth, (K) Knurled, (P) Peened, (G) ShurGrip

SHURGRIP ONLY AVAILABLE ON 1 ¼" DIAMETER

**Flange:** (T) Twist Lock

### PART NUMBER:

#	Length	Grip	Flange
02- _ 2	__	_	T

**02** Grab Bars with center post

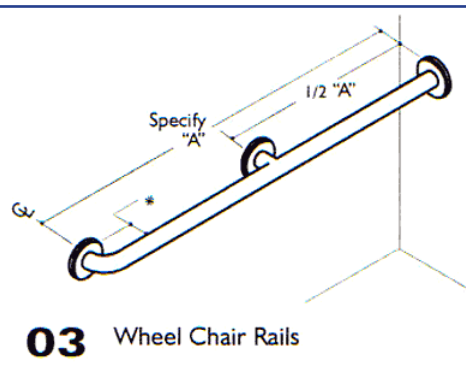

## 03 - STAINLESS STEEL - Wheel Chair Rail

### OPTIONS:

**Diameter:** (03-22) 1 ¼", (03-52) 1 ½"

**Length:** 36, 42, 48, 52, 54, 60

**Grip:** (S) Smooth, (K) Knurled, (P) Peened, (G) ShurGrip

SHURGRIP ONLY AVAILABLE ON 1 ¼" DIAMETER

**Flange:** (T) Twist Lock

### PART NUMBER:

#	Length	Grip	Flange
03- _ 2	__	_	T

**03** Wheel Chair Rails

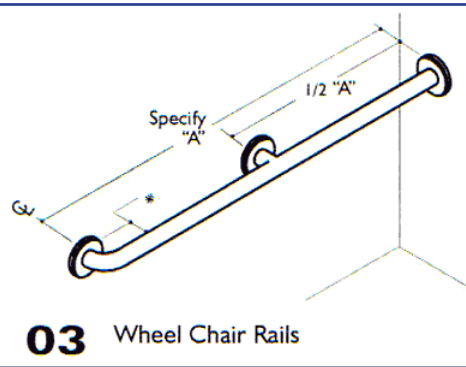

## 04 - STAINLESS STEEL - Straight Bar w/ Posts

### OPTIONS:

**Diameter:** (04-22) 1 ¼", (04-52) 1 ½"

**Length:** 18, 24, 36, 42

**Grip:** (S) Smooth, (K) Knurled, (P) Peened, (G) ShurGrip

SHURGRIP ONLY AVAILABLE ON 1 ¼" DIAMETER

**Flange:** (T) Twist Lock

### PART NUMBER:

#	Length	Grip	Flange
04- _ 2	__	_	T

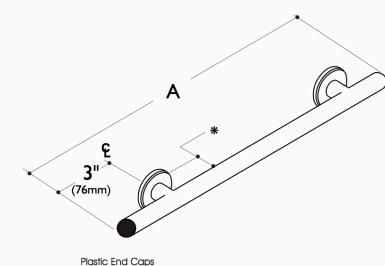

**04** Straight Bar with posts

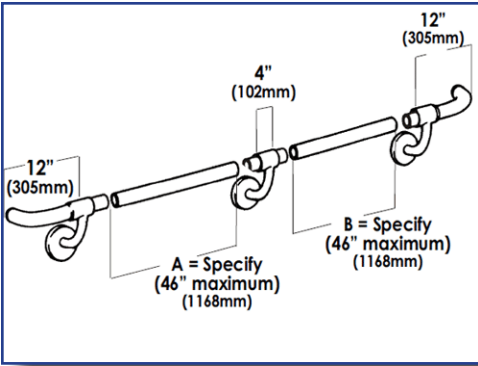

# 05 - STAINLESS STEEL - 1 1/4" DIA Corridor Rail System

## OPTIONS:

**Length:** 36, 48, 60, 72

72" RAIL WITH CENTER POST

**Grip:** (S) Smooth, (K) Knurled, (P) Peened

**Flange:** (T) Twist Lock

## PART NUMBER:

#	Length	Grip	Flange
05-52	--	-	T



06-5212

# 06 - STAINLESS STEEL - 1 1/2" DIA Vandal Proof Straight Grab Bar

## OPTIONS:

**Length:** 12, 16, 18, 24, 30, 32, 36, 42, 48

### Accessories:

- (EL-ONEWAYTOOL) Installation tool
- (EL-ONEWAYPACK) 4 pack of screws

## PART NUMBER:

#	Length
06-52	--



# 90° ANGLE BARS

## 07/08 - CHROME - 1" DIA 90° Angle Bar

### OPTIONS:

**Orientation:** (07) Right Hand, (08) Left Hand

**Length:** (2416) 24" x 16", (3216) 32" x 16"

**Grip:** (S) Smooth, (K) Knurled

**Flange:** (L) Twist Lock

### PART NUMBER:

#	Length	Grip	Flange
__ - 11	__ - __	__	L

## 07/08/09 - STAINLESS STEEL - 90° Angle Bar

### OPTIONS:

**Orientation:** (07) Right Hand, (08) Left Hand, (09) Center

**Diameter:** (22) 1 ¼", (52) 1 ½"

**Length:** (2416) 24" x 16", (3216) 32" x 16", (3030) 30" x 30"

24" AND 32" AVAILABLE IN RIGHT (07) OR LEFT (08), 30" AVAILABLE IN CENTER (09)

**Grip:** (S) Smooth, (K) Knurled, (P) Peened, (G) ShurGrip

SHURGRIP ONLY AVAILABLE ON 1 ¼" DIAMETER

**Flange:** (T) Twist Lock

### PART NUMBER:

#	Length	Grip	Flange
__ - __ 2	__ - __	__	T

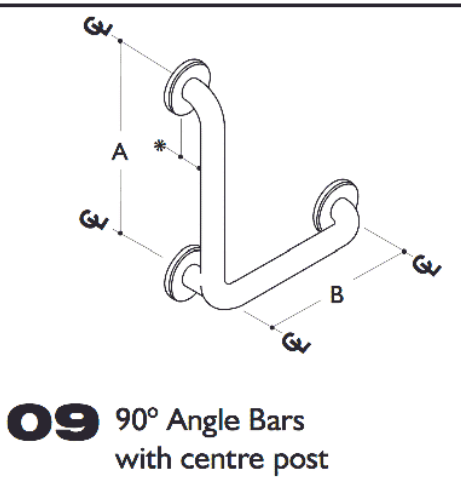
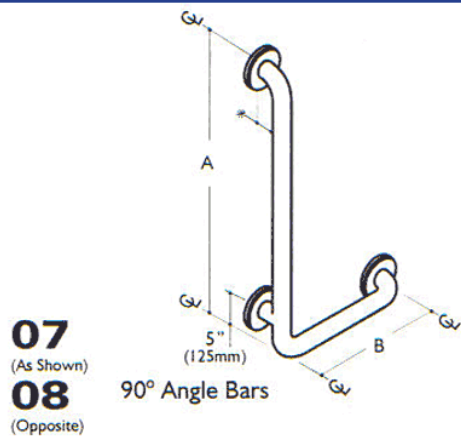

## 07/08 - POWDER COATED - 1" DIA 90° Angle Bar

### OPTIONS:

**Orientation:** (07) Right Hand, (08) Left Hand

**Length:** (2416) 24" x 16", (3216) 32" x 16"

**Grip:** (S) Smooth

**Flange:** (J) 3 Hole Exposed

**Color:** (01) White, (02) Almond

### PART NUMBER:

#	Length	Grip	Flange	Color
-- -15	----	S	J	- --

## 07/08/09 - POWDER COATED - 90° Angle Bar

### OPTIONS:

**Orientation:** (07) Right Hand, (08) Left Hand, (09) Center

**Diameter:** (26) 1 ¼", (56) 1 ½"

**Length:** (2416) 24" x 16", (3216) 32" x 16", (3030) 30" x 30"

24" AND 32" AVAILABLE IN RIGHT (07) OR LEFT (08), 30" AVAILABLE IN CENTER (09)

**Grip:** (S) Smooth, (K) Knurled, (G) ShurGrip

SHURGRIP ONLY AVAILABLE ON 1 ¼" DIAMETER

**Flange:** (T) Twist Lock

**Color:** (01) White, (02) Almond

### PART NUMBER:

#	Length	Grip	Flange	Color
-- - 6	----	S	T	- --

**07**  
(As Shown)  
**08**  
(Opposite)

90° Angle Bars

**09**

90° Angle Bars  
with centre post

## 07/08/09 - PLATED - 1 1/4" DIA 90° Angle Bar

### OPTIONS:

**Orientation:** (07) Right Hand, (08) Left Hand, (09) Center

**Length:** (2416) 24" x 16", (3216) 32" x 16", (3030) 30" x 30"

24" AND 32" AVAILABLE IN RIGHT (07) OR LEFT (08), 30" AVAILABLE IN CENTER (09)

**Grip:** (S) Smooth, (K) Knurled, (G) ShurGrip

**Flange:** (T) Twist Lock

**Finish:** (CH) Chrome, (CH-BR) Brushed Chrome, (BS) Brass, (BS-BR) Brushed Brass, (NP-BR) Brushed Nickel, (AVBZ-BR) Brushed Antique Venetian Bronze

### PART NUMBER:

#	Length	Grip	Flange	Finish
-- -29	----	-	T	----

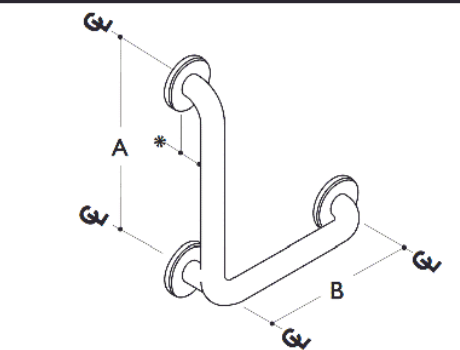

## 10/11 - STAINLESS STEEL - End Angle Bar

### OPTIONS:

**Orientation:** (10) Right Hand, (11) Left Hand

**Diameter:** (22) 1 1/4", (52) 1 1/2"

**Length:** (2424) 24" x 24", (3030) 30" x 30"

**Grip:** (S) Smooth, (K) Knurled, (P) Peened, (G) ShurGrip

SHURGRIP ONLY AVAILABLE ON 1 1/4" DIAMETER

**Flange:** (T) Twist Lock

### PART NUMBER:

#	Length	Grip	Flange
-- -2	----	-	T

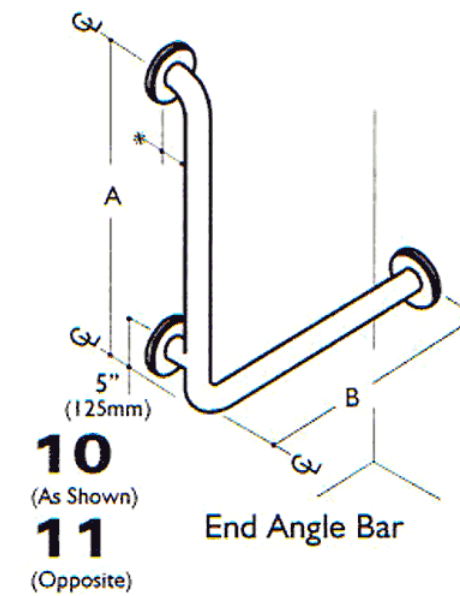

# 120° ANGLE BARS

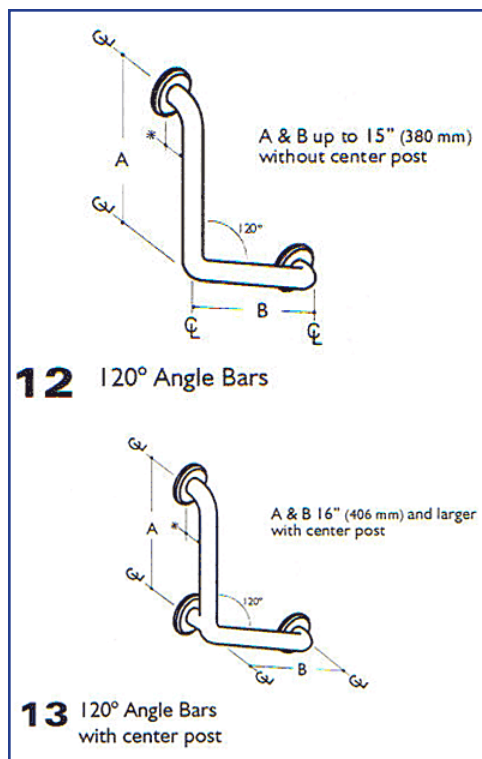

## 12/13 - STAINLESS STEEL - 120° Angle Bar

### OPTIONS:

**Center Post:** (12) No Center Post, (13) With Center Post

12" WITHOUT POST, 16" AND 24" WITH POST

**Diameter:** (22) 1 ¼", (52) 1 ½"

**Length:** (1212) 12" x 12", (1616) 16" x 16", (2424) 24" x 24",

**Grip:** (S) Smooth, (K) Knurled, (P) Peened, (G) ShurGrip

SHURGRIP ONLY AVAILABLE ON 1 ¼" DIAMETER

**Flange:** (T) Twist Lock

### PART NUMBER:

#	Length	Grip	Flange
-- -22	----	-	T

## 12/13 - POWDER COATED - 20° Angle Bar

### OPTIONS:

**Center Post:** (12) No Center Post, (13) With Center Post

12" WITHOUT POST, 16" AND 24" WITH POST

**Diameter:** (26) 1 ¼", (56) 1 ½"

**Length:** (1212) 12" x 12", (1616) 16" x 16", (2424) 24" x 24",

**Grip:** (S) Smooth, (G) ShurGrip

SHURGRIP ONLY AVAILABLE ON 1 ¼" DIAMETER

**Flange:** (T) Twist Lock

**Color:** (01) White, (02) Almond

### PART NUMBER:

#	Length	Grip	Flange	Color
-- - _ 6	----	-	T	--

## 12/13 - PLATED - 1 1/4" DIA 120° Angle Bar

### OPTIONS:

**Center Post:** (12) No Center Post, (13) With Center Post

12" WITHOUT POST, 16" AND 24" WITH POST

**Length:** (1212) 12" x 12", (1616) 16" x 16", (2424) 24" x 24",

**Grip:** (S) Smooth, (K) Knurled, (G) ShurGrip

**Flange:** (T) Twist Lock

**Finish:** (CH) Chrome, (CH-BR) Brushed Chrome, (BS) Brass, (BS-BR) Brushed Brass, (NP-BR) Brushed Nickel, (AVBZ-BR) Brushed Antique Venetian Bronze

### PART NUMBER:

#	Length	Grip	Flange	Finish
-- -29	----	-	T	----

#### 12 120° Angle Bars

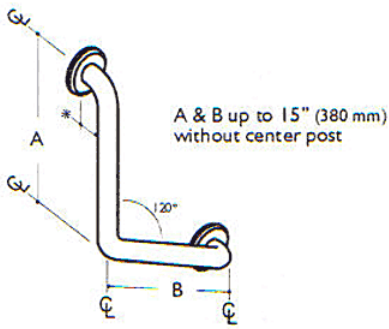

#### 13 120° Angle Bars with center post

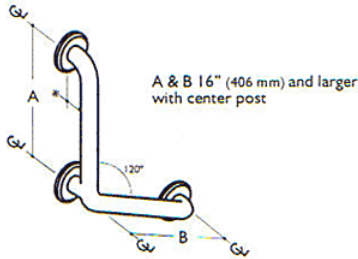

# WALL TO FLOOR RAILS

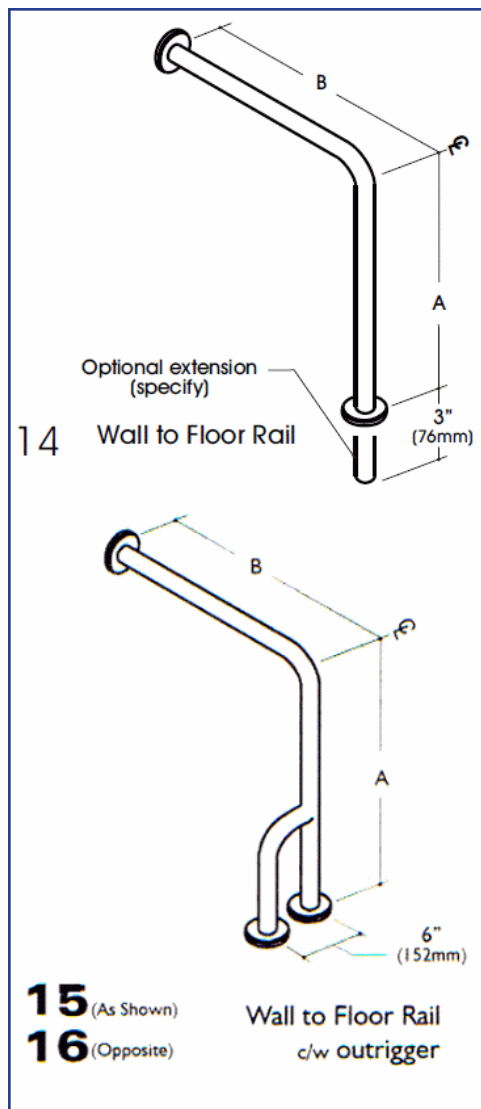

## 15/16 - CHROME - 1" DIA Wall to Floor Rail

### OPTIONS:

**Orientation:** (15) Right Hand, (16) Left Hand

**Length:** (3330) 33" x 30"

**Grip:** (S) Smooth, (K) Knurled

**Flange:** (L) 3 Hole Exposed

### PART NUMBER:

#	Length	Grip	Flange
-- - 11	3330	_	L

## 14/15/16 - STAINLESS STEEL - Wall to Floor Rail

### OPTIONS:

**Orientation:** (14) Center, (15) Right Hand, (16) Left Hand

**Diameter:** (22) 1 1/4", (52) 1 1/2"

**Length:** (3330) 33" x 30"

**Grip:** (S) Smooth, (K) Knurled, (P) Peened, (G) ShurGrip

SHURGRIP ONLY AVAILABLE ON 1 1/4" DIAMETER

**Flange:** (T) Twist Lock

### PART NUMBER:

#	Length	Grip	Flange
-- - _ 2	3330	_	T



## 14/15/16 - POWDER COATED - Wall to Floor Rail

### OPTIONS:

**Orientation:** (14) Center, (15) Right Hand, (16) Left Hand

**Diameter:** (26) 1 ¼", (56) 1 ½"

**Length:** (3330) 33" x 30"

**Grip:** (S) Smooth, (G) ShurGrip

SHURGRIP ONLY AVAILABLE ON 1 ¼" DIAMETER

**Flange:** (T) Twist Lock

**Color:** (01) White, (02) Almond

### PART NUMBER:

#	Length	Grip	Flange	Color
__ - __ 6	3330	_	T	__

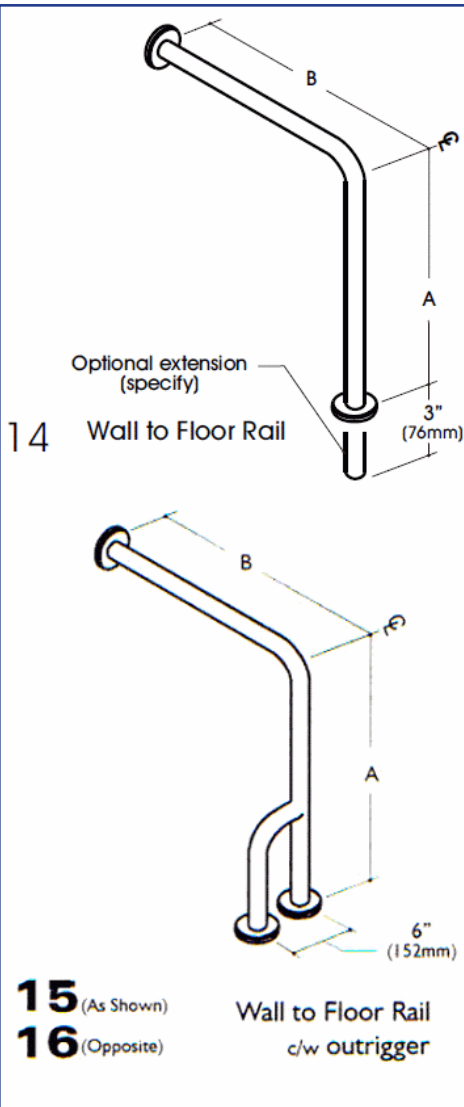

# SIDE & STRADDLE BARS

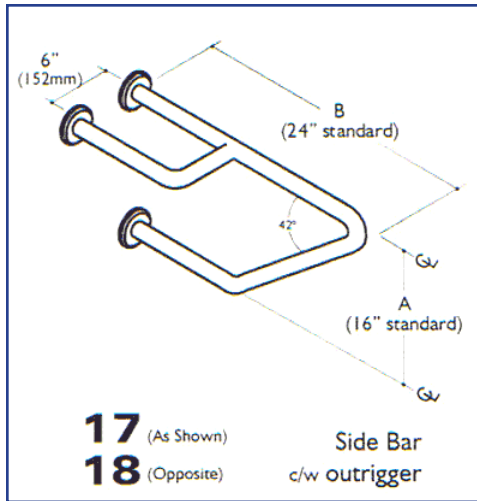

## 17/18 - STAINLESS STEEL - Side Bar with Outrigger

### OPTIONS:

**Orientation:** **(17)** Right Hand, **(18)** Left Hand

**Diameter:** **(22)** 1 1/4", **(52)** 1 1/2"

**Length:** **(1624)** 16" x 24"

**Grip:** **(S)** Smooth, **(K)** Knurled, **(P)** Peened, **(G)** ShurGrip

SHURGRIP ONLY AVAILABLE ON 1 1/4" DIAMETER BARS

**Flange:** **(T)** Twist Lock

### PART NUMBER:

#	Length	Grip	Flange
__ - __ 2	1624	_	T

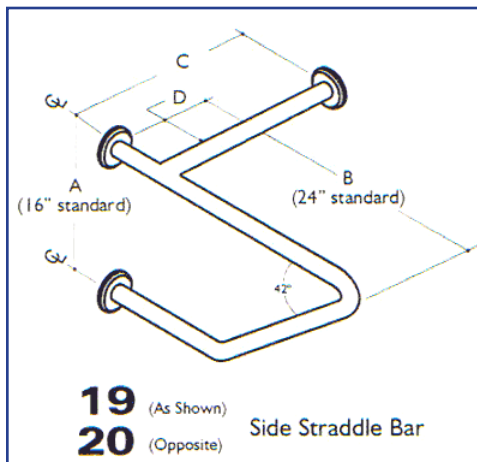

## 19/20 - STAINLESS STEEL - Side Straddle Bar

### OPTIONS:

**Orientation:** **(19)** Right Hand, **(20)** Left Hand

**Diameter:** **(22)** 1 1/4", **(52)** 1 1/2"

**Length:** **(162424)** 16" x 24" x 24"

**Grip:** **(S)** Smooth, **(K)** Knurled, **(P)** Peened, **(G)** ShurGrip

SHURGRIP ONLY AVAILABLE ON 1 1/4" DIAMETER BARS

**Flange:** **(T)** Twist Lock

### PART NUMBER:

#	Length	Grip	Flange
__ - __ 2	162424	_	T

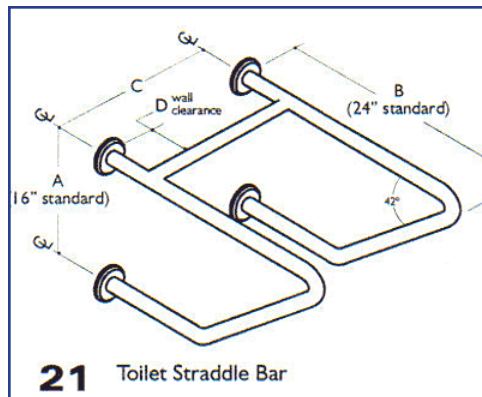

## 21 - STAINLESS STEEL - Toilet Straddle Bar

### OPTIONS:

**Diameter:** (22) 1 ¼", (52) 1 ½"

**Length:** (1624245) 16" x 24" x 24" x 5"

**Grip:** (S) Smooth, (K) Knurled, (P) Peened, (G) ShurGrip

SHURGRIP ONLY AVAILABLE ON 1 1/4" DIAMETER BARS

**Flange:** (T) Twist Lock

### PART NUMBER:

#	Length	Grip	Flange
21 - _ 2	1624245	_	T

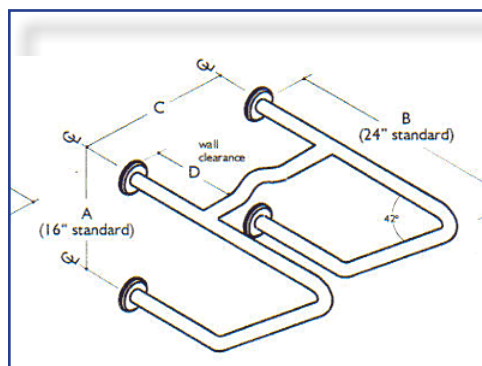

## 22 - STAINLESS STEEL - Toilet Straddle Bar for Flush Valve

### OPTIONS:

**Diameter:** (22) 1 ¼", (52) 1 ½"

**Length:** (1624245) 16" x 24" x 24" x 5"

**Grip:** (S) Smooth, (K) Knurled, (P) Peened, (G) ShurGrip

SHURGRIP ONLY AVAILABLE ON 1 1/4" DIAMETER BARS

**Flange:** (T) Twist Lock

### PART NUMBER:

#	Length	Grip	Flange
22 - _ 2	1624245	_	T

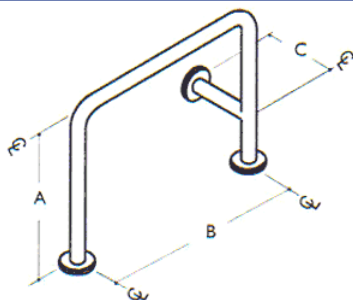

**23** Toilet Straddle Bar  
c/w wall mount

## 23 - STAINLESS STEEL - Toilet Straddle Bar with Wall Mount

### OPTIONS:

**Diameter:** (22) 1 1/4", (52) 1 1/2"

**Length:** (3330518) 33" x 30" x 5" x 18"

**Grip:** (S) Smooth, (P) Peened, (G) ShurGrip

SHURGRIP ONLY AVAILABLE ON 1 1/4" DIAMETER BARS

**Flange:** (T) Twist Lock

### PART NUMBER:

#	Length	Grip	Flange
23 - _ 2	3330518	_	T

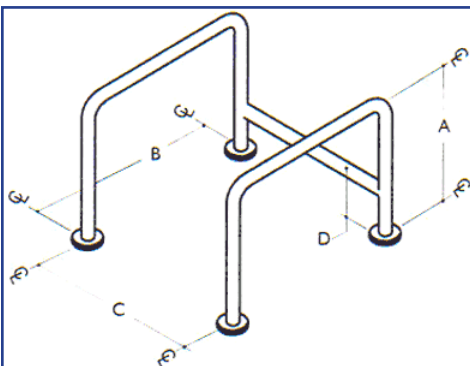

**24** Double Straddle Rail  
c/w wall mount

## 24 - STAINLESS STEEL - Double Straddle Bar

### OPTIONS:

**Diameter:** (22) 1 1/4", (52) 1 1/2"

**Length:** (3330518) 33" x 30" x 24" x 8"

**Grip:** (S) Smooth, (P) Peened, (G) ShurGrip

SHURGRIP ONLY AVAILABLE ON 1 1/4" DIAMETER BARS

**Flange:** (T) Twist Lock

### PART NUMBER:

#	Length	Grip	Flange
24 - _ 2	3330248	_	T

# INSIDE CORNER BARS

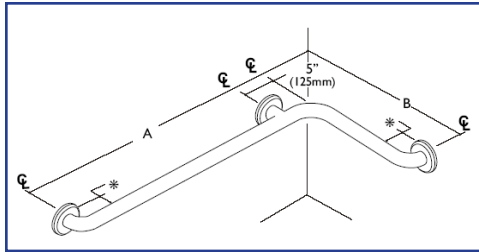

## 25 - CHROME - 1" DIA Inside Corner Bar

### OPTIONS:

Length: **(3418)** 34" x 18"

Grip: **(S)** Smooth, **(K)** Knurled

Flange: **(L)** 3 Hole Exposed

### PART NUMBER:

#	Length	Grip	Flange
25 - 11	3418	_	L

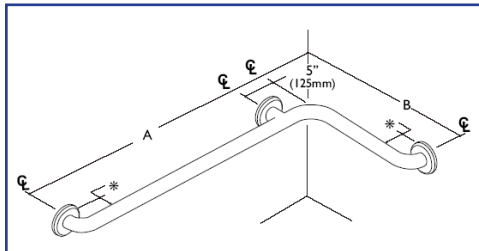

## 25 - STAINLESS STEEL - Inside Corner Bar

### OPTIONS:

Diameter: **(22)** 1 1/4", **(52)** 1 1/2"

Length: **(3418)** 34" x 18"

Grip: **(S)** Smooth, **(P)** Peened, **(K)** Knurled, **(G)** ShurGrip

SHURGRIP ONLY AVAILABLE ON 1 1/4" DIAMETER BARS

Flange: **(T)** Twist Lock

### PART NUMBER:

#	Length	Grip	Flange
25 - _ 2	3418	_	T

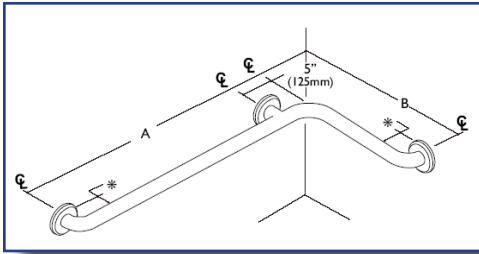

## 25 - POWDER COATED - Inside Corner Bar

### OPTIONS:

**Diameter:** (26) 1 ¼", (56) 1 ½"

**Length:** (3418) 34" x 18"

**Grip:** (S) Smooth, (G) ShurGrip

SHURGRIP ONLY AVAILABLE ON 1 1/4" DIAMETER BARS

**Flange:** (T) Twist Lock

**Color:** (01) White, (02) Almond

### PART NUMBER:

#	Length	Grip	Flange	Color
25 - _ 6	3418	_	T	_ _



# SHOWER BARS

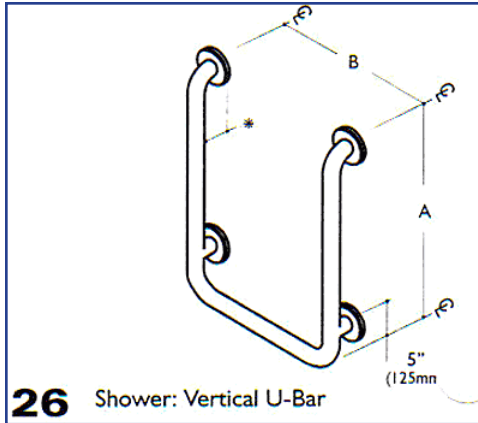

## 26 - STAINLESS STEEL - Vertical U-Bar

### OPTIONS:

Diameter: **(22)** 1 ¼", **(52)** 1 ½"

Length: **(2424)** 24" x 24"

Grip: **(S)** Smooth, **(P)** Peened, **(K)** Knurled, **(G)** ShurGrip

SHURGRIP ONLY AVAILABLE ON 1 1/4" DIAMETER BARS

Flange: **(T)** Twist Lock

### PART NUMBER:

#	Length	Grip	Flange
26 - _ 2	2424	_	T

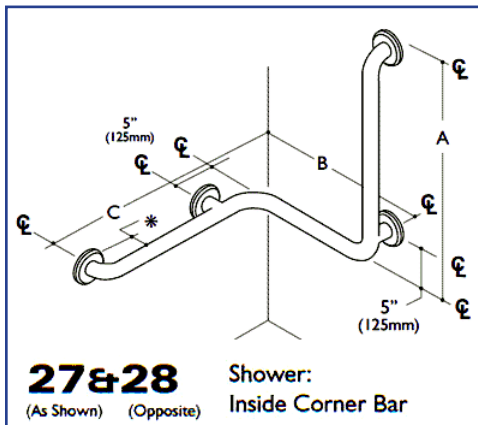

## 27/28 - STAINLESS STEEL - Inside Corner Bar

### OPTIONS:

Orientation: **(27)** Right Hand, **(28)** Left Hand

Diameter: **(22)** 1 ¼", **(52)** 1 ½"

Length: **(242436)** 24" x 24" x 36", **(242448)** 24" x 24" x 48",  
**(242454)** 24" x 24" x 54"

Grip: **(S)** Smooth, **(G)** ShurGrip

SHURGRIP ONLY AVAILABLE ON 1 1/4" DIAMETER BARS

Flange: **(T)** Twist Lock

### PART NUMBER:

#	Length	Grip	Flange
_ - _ 2	_ - _ - _ - _	_	T

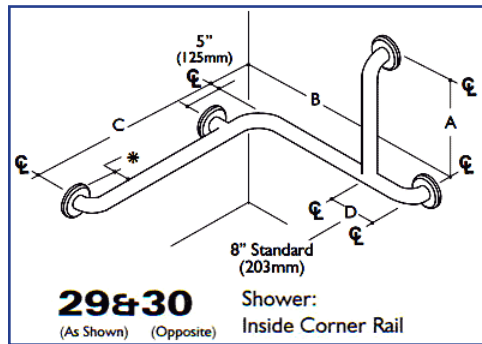

## 29/30 - STAINLESS STEEL - Inside Corner Rail

### OPTIONS:

**Orientation:** (29) Right Hand, (30) Left Hand

**Diameter:** (22) 1 1/4", (52) 1 1/2"

**Length:** (2424) 24" x 24" x 24" x 8"

**Grip:** (S) Smooth, (P) Peened, (K) Knurled, (G) ShurGrip

SHURGRIP ONLY AVAILABLE ON 1 1/4" DIAMETER BARS

**Flange:** (T) Twist Lock

### PART NUMBER:

#	Length	Grip	Flange
_ _ - _ 2	2424248	_	T

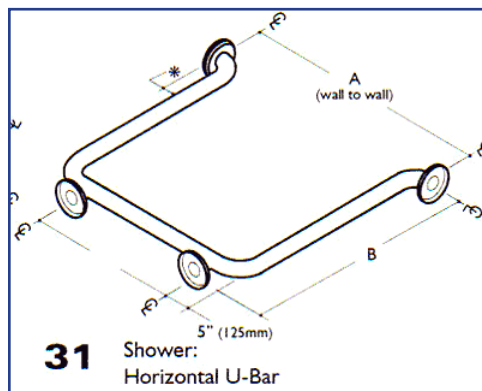

## 31 - STAINLESS STEEL - Horizontal U-Bar

### OPTIONS:

**Diameter:** (22) 1 1/4", (52) 1 1/2"

**Length:** (3630), 36" x 30", (4830), 48" x 30", (5430) 54" x 30", (6030) 60" x 30"

**Grip:** (S) Smooth, (P) Peened, (G) ShurGrip

SHURGRIP ONLY AVAILABLE ON 1 1/4" DIAMETER BARS

**Flange:** (T) Twist Lock

### PART NUMBER:

#	Length	Grip	Flange
31 - _ 2	_ _ _ _	_	T

# WALL SUPPORTS

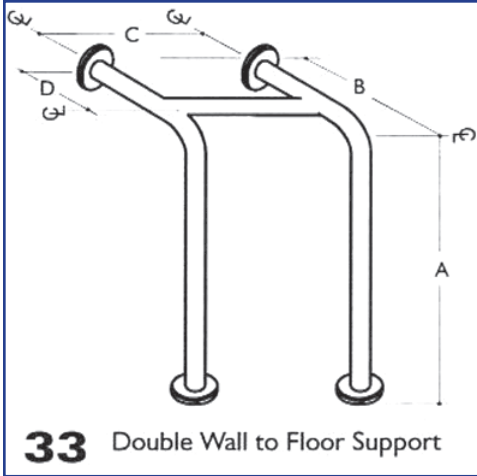

### 33 - STAINLESS STEEL - Double Wall to Floor Support

OPTIONS:

**Diameter:** (22) 1 1/4", (52) 1 1/2"

Length: (3330245) 33" x 30" x 24" x 5"

**Grip:** **(S)** Smooth, **(P)** Peened, **(K)** Knurled, **(G)** ShurGrip

SHURGRIP ONLY AVAILABLE ON 1 1/4" DIAMETER BARS

Flange: (T) Twist Lock

## PART NUMBER:

#	Length	Grip	Flange
33 - _ 2	3330245	_	T

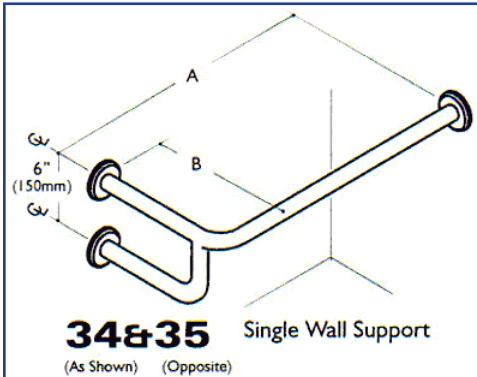

## 34/35 - STAINLESS STEEL - Single Wall Support

OPTIONS:

**Orientation:** (34) Right Hand, (35) Left Hand

**Diameter:** (22) 1 ¼", (52) 1 ½"

Length: **(301412)** 30" x 14" x 12"

**Grip:** **(S)** Smooth, **(P)** Peened, **(K)** Knurled, **(G)** ShurGrip

SHURGRIP ONLY AVAILABLE ON 1 1/4" DIAMETER BARS

Flange: (T) Twist Lock

## PART NUMBER:

#	Length	Grip	Flange
__ - _2	301412	_	T

## 36 - STAINLESS STEEL - Double Wall Support

### OPTIONS:

Diameter: **(22)** 1 ¼", **(52)** 1 ½"

Length: **(331412)** 33" x 14" x 12"

Grip: **(S)** Smooth, **(P)** Peened, **(K)** Knurled, **(G)** ShurGrip

SHURGRIP ONLY AVAILABLE ON 1 1/4" DIAMETER BARS

Flange: **(T)** Twist Lock

### PART NUMBER:

#	Length	Grip	Flange
36 - _ 2	331412	_	T

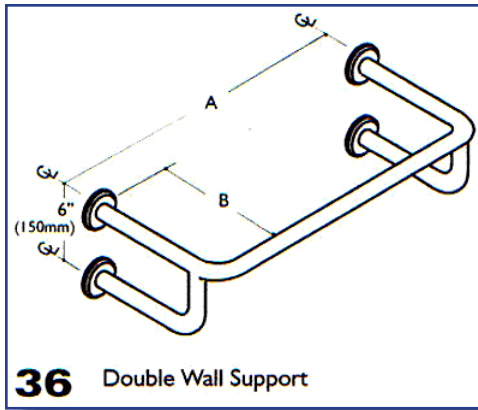

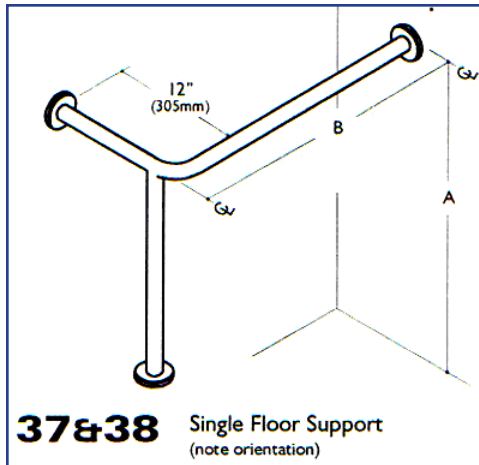

## 37/38 - STAINLESS STEEL - Single Floor Support

### OPTIONS:

**Orientation:** (37) Right Hand, (38) Left Hand

**Diameter:** (22) 1 1/4", (52) 1 1/2"

**Length:** (3330128) 33" x 30" x 12" x 8"

**Grip:** (S) Smooth, (P) Peened, (K) Knurled, (G) ShurGrip

SHURGRIP ONLY AVAILABLE ON 1 1/4" DIAMETER BARS

**Flange:** (T) Twist Lock

### PART NUMBER:

#	Length	Grip	Flange
_ _ - _ 2	3330128	_	T

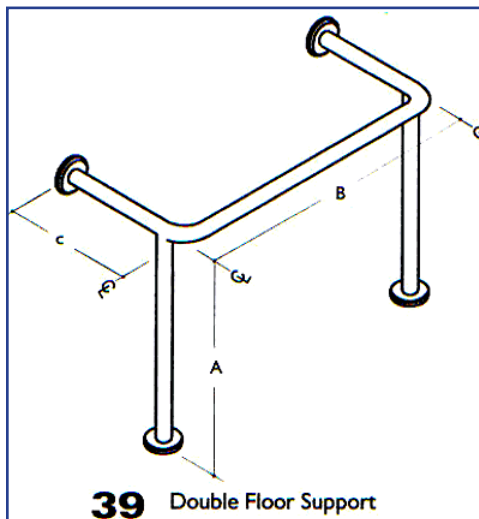

## 39 - STAINLESS STEEL -Double Floor Support

### OPTIONS:

**Diameter:** (22) 1 1/4", (52) 1 1/2"

**Length:** (3330128) 33" x 30" x 12" x 8"

**Grip:** (S) Smooth, (P) Peened, (K) Knurled, (G) ShurGrip

SHURGRIP ONLY AVAILABLE ON 1 1/4" DIAMETER BARS

**Flange:** (T) Twist Lock

### PART NUMBER:

#	Length	Grip	Flange
39 - _ 2	3330128	_	T

## 40 - STAINLESS STEEL - Water Fountain Drinking Bar

### OPTIONS:

**Diameter:** (22) 1 ¼", (52) 1 ½"

**Length:** (3318) 33" x 18"

**Grip:** (S) Smooth, (P) Peened, (K) Knurled, (G) ShurGrip

SHURGRIP ONLY AVAILABLE ON 1 1/4" DIAMETER BARS

**Flange:** (T) Twist Lock

### PART NUMBER:

#	Length	Grip	Flange
40 - _ 2	3318	_	T

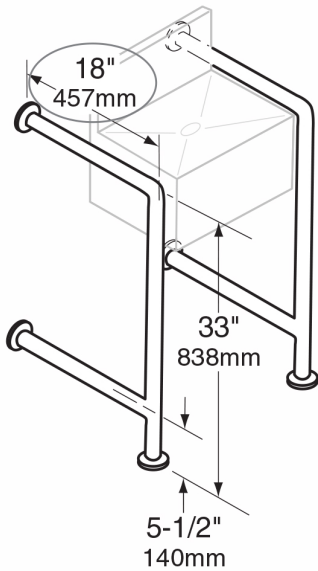

## 43/44 - STAINLESS STEEL - Side Bar for Sitz Bath

### OPTIONS:

**Orientation** (43) Right Hand, (44) Left Hand

**Diameter:** (22) 1 ¼", (52) 1 ½"

**Length:** (3330) 33" x 30"

**Grip:** (S) Smooth, (P) Peened, (K) Knurled, (G) ShurGrip

SHURGRIP ONLY AVAILABLE ON 1 1/4" DIAMETER BARS

**Flange:** (T) Twist Lock

### PART NUMBER:

#	Length	Grip	Flange
_ _ - _ 2	3330	_	T

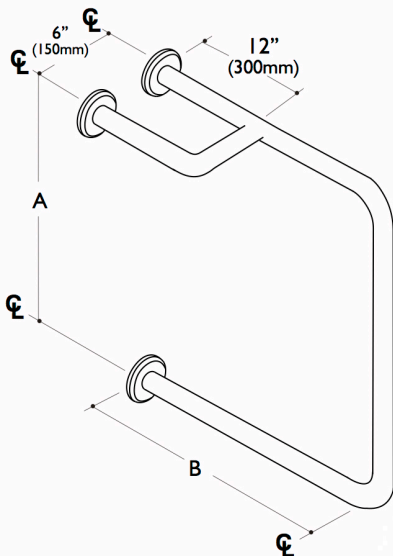

**43** Side Bar  
for Sitz Bath

# MISCELLANEOUS BARS

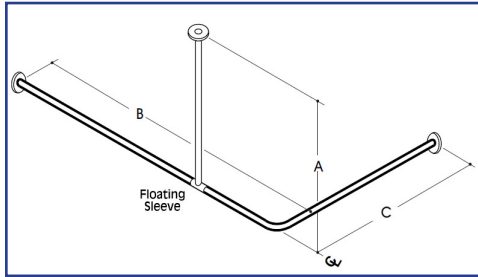

## 48 - STAINLESS STEEL - 1" DIA Ceiling Hung Curtain Rod

### OPTIONS:

**Length:** (66B27C) 66" x 27", (30B30C) 30" x 30", (60B30C) 60" x 30", (36B36C) 36" x 36", (72B36C) 72" x 36", (48B48C) 48" x 48", (60B48C) 60" x 48", (72B48C) 72" x 48"

**Grip:** (S) Smooth

**Flange:** (T) Twist Lock

### PART NUMBER:

#	Length	Grip	Flange
48 - 12	12A__B__C	S	T

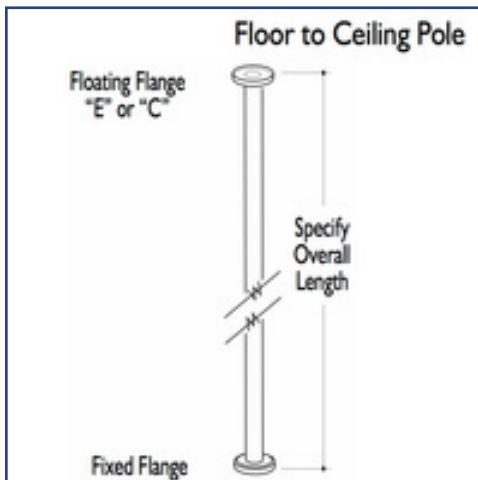

## 50 - STAINLESS STEEL - Floor to Ceiling Pole

### OPTIONS:

**Diameter:** (22) 1 1/4", (52) 1 1/2"

**Length:** 72", 74", 96"

**Grip:** (S) Smooth, (K) Knurled, (P) Peened, (G) ShurGrip

SHURGRIP ONLY AVAILABLE ON 1 1/4" DIAMETER BARS

**Flange:** (T) Twist Lock

### PART NUMBER:

#	Length	Grip	Flange
50 - _ 2	__	_	T



# LIFE LINE COLLECTION - FOLDING SHOWER SEATS

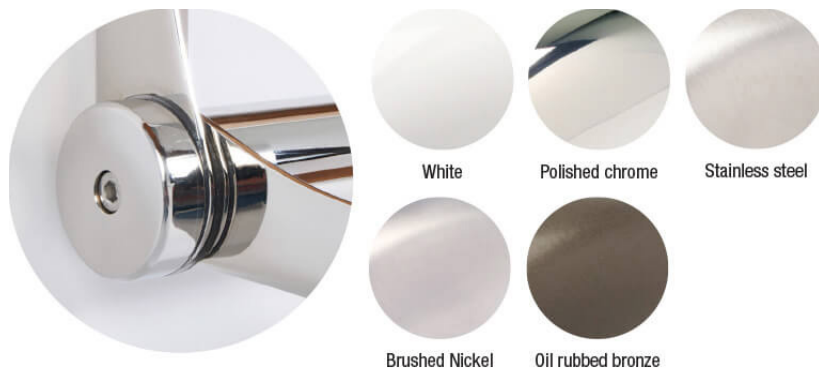

Life Line continues with innovation into a designer world of exquisite Teak Wood & Walnut shower seats. South American teak wood & Walnut paired with a stainless steel framework, truly depicts the beautiful style of our Contour Seats. Our craftsmen hand select the Teak Wood & Walnut to ensure that the beauty of the seat remains throughout.



LL-TK18SS

## TEAK - Folding Contour Shower Seat

### OPTIONS:

**Size:** (18) 18", (26) 26"

**Frame:** (SS) Stainless Steel, (PC) Polished Chrome, (BN) Brushed Nickel, (WH) White, (ORB) Oil Rubbed Bronze

### PART NUMBER:

#	Wood	Size	Frame
LL -	TK	--	--



LL-WAL18SS

## WALNUT - Folding Contour Shower Seat

### OPTIONS:

**Size:** (18) 18", (26) 26"

**Frame:** (SS) Stainless Steel, (PC) Polished Chrome, (BN) Brushed Nickel, (WH) White, (ORB) Oil Rubbed Bronze

### PART NUMBER:

#	Wood	Size	Frame
LL -	WAL	--	--

# FOLD DOWN SHOWER SEATS

## Seat Covers:



## Elite Frame Finishes:



60-TK26

## 60/61 - Fold Down L-Shaped Shower Seat

### OPTIONS:

- Orientation:** (60) Right Hand, (61) Left Hand
- Size:** (26) 26" x 21", (28) 28" x 21", (30), 30" x 21", (32) 32" x 21", (345) 34.5" x 21"
- Material:** (PA)(01) Padded White, (PA)(02) Padded Almond, (PH)(01) Phenolic White, (PH)(15), Phenolic Woodgrain, (PO)(20) HDP White, (TK)( ) Teakwood
- Legs:** (WLEG) Seat with legs, ( ) No legs

### PART NUMBER:

#	Material	Size	Mat. Color	Legs
-- -	--	--	--	----



60-PA2601WLEG-01

## 60/61 - Elite Fold Down L-Shaped Shower Seat with Legs

### OPTIONS:

**Orientation:** (60) Right Hand, (61) Left Hand

**Size:** (26) 26" x 21", (28) 28" x 21", (30), 30" x 21", (32) 32" x 21", (345) 34.5" x 21"

**Material:** (PA)(01) Padded White, (PA)(02) Padded Almond, (PH)(01) Phenolic White, (PH)(15), Phenolic Woodgrain, (PO)(20) HDP White, (TK)( ) Teakwood

**Frame:** (01) White, (02) Almond, (ORB) Oil Rubbed Bronze

### PART NUMBER:

#	Material	Size	Mat. Color	Legs	Frame
-- -	--	--	--	WLEG	--



62-TK26

## 62 - Fold Down Rectangular Shower Seat

### OPTIONS:

**Size:** (24) 24" x 14.5" (26) 26" x 14.5", (28) 28" x 14.5", (30), 30" x 14.5", (32) 32" x 14.5, (345) 34.5" x 14.5"

**Material:** (PA)(01) Padded White, (PA)(02) Padded Almond, (PH)(01) Phenolic White, (PH)(15), Phenolic Woodgrain, (PO)(20) HDP White, (TK)( ) Teakwood

**Legs:** (WLEG) Seat with legs, ( ) No legs

### PART NUMBER:

#	Material	Size	Mat. Color	Legs
62 -	--	--	--	----

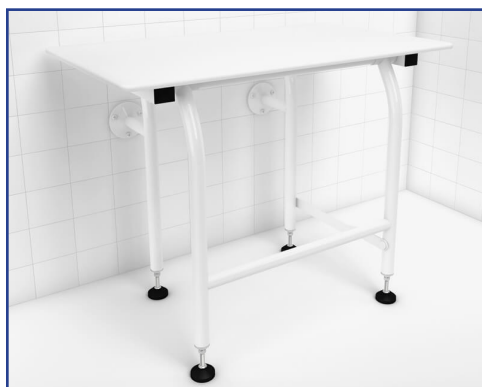

62-PA2601WLEG-01

## 62 - Elite Fold Down Rectangular Shower Seat with Legs

### OPTIONS:

**Size:** (24) 24" x 14.5" (26) 26" x 14.5", (28) 28" x 14.5", (30), 30" x 14.5", (32) 32" x 14.5", (345) 34.5" x 14.5"

**Material:** (PA)(01) Padded White, (PA)(02) Padded Almond, (PH)(01) Phenolic White, (PH)(15), Phenolic Woodgrain, (PO)(20) HDP White, (TK)( ) Teakwood

**Frame:** (01) White, (02) Almond, (ORB) Oil Rubbed Bronze

### PART NUMBER:

#	Material	Size	Mat. Color	Legs	Frame
62 -	--	--	--	WLEG	--



63-PH1451601

## 63 - Junior Fold Down Shower Seat

### OPTIONS:

**Size:** (14516) 14.5" x 16" (14518) 14.5" x 18"

**Material:** (PA)(01) Padded White, (PA)(02) Padded Almond, (PH)(01) Phenolic White, (PH)(15), Phenolic Woodgrain, (PO)(20) HDP White, (TK)( ) Teakwood

**Legs:** (WLEG) Seat with legs, ( ) No legs

### PART NUMBER:

#	Material	Size	Mat. Color	Legs
63 -	--	-----	--	-----



63-PA1451601WLEG-01

## 63 - Elite Fold Down Junior Shower Seat with Legs

### OPTIONS:

**Size:** (14516) 14.5" x 16" (14518) 14.5" x 18"

**Material:** (PA)(01) Padded White, (PA)(02) Padded Almond, (PH)(01) Phenolic White, (PH)(15), Phenolic Woodgrain, (PO)(20) HDP White, (TK)( ) Teakwood

**Frame:** (01) White, (02) Almond, (ORB) Oil Rubbed Bronze

### PART NUMBER:

#	Material	Size	Mat. Color	Legs	Frame
63 -	--	-----	--	WLEG	--



70-PH152801

## 70 - Folding Tub Seat

### OPTIONS:

**Size:** (1528) 15" x 28" (1532) 15" x 32"

**Material:** (PA)(01) Padded White, (PA)(02) Padded Almond, (PH)(01) Phenolic White, (PH)(15), Phenolic Woodgrain, (PO)(20) HDP White, (TK)( ) Teakwood

### PART NUMBER:

#	Material	Size	Mat. Color
70 -	--	-----	--

## FLIP UP SAFETY RAILS

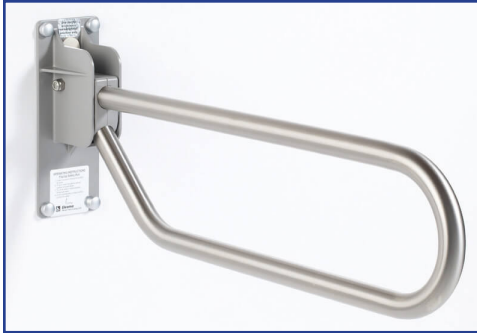

96-2230SW05

### 96 - STAINLESS STEEL - 1 1/4" DIA Locking Hinge Flip Up Rail w/ Zinc Bracket

#### OPTIONS:

Size: **(30)** 30"

Grip: **(S)** Smooth, **(K)** Knurled, **(P)** Peened, **(G)** ShurGrip

#### PART NUMBER:

#	Size	Grip	
96 - 22	30	_	W05



96-2630S01

### 96 - POWDER COATED - 1 1/4" DIA Locking Hinge Flip Up Rail w/ Zinc Bracket

#### OPTIONS:

Size: **(30)** 30"

Grip: **(S)** Smooth **(G)** ShurGrip

Color: **(01)** White, **(02)** Almond

#### PART NUMBER:

#	Size	Grip	Color
96 - 26	30	_	--

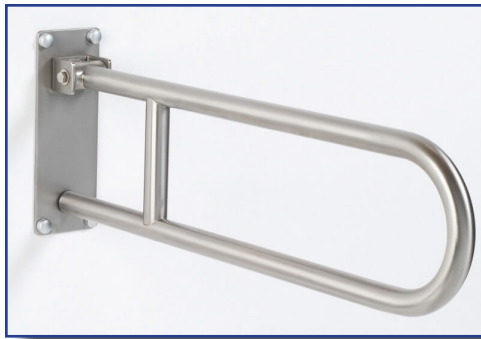

97-2230S

## 97 - STAINLESS STEEL - Friction Hinge Flip Up Rail w/ Stainless Steel Bracket

### OPTIONS:

Diameter: **(22)** 1 ¼", **(52)** 1 ½"

Size: **(30)** 30"

Grip: **(S)** Smooth, **(K)** Knurled, **(P)** Peened, **(G)** ShurGrip

SHURGRIP ONLY AVAILABLE ON 1 1/4" DIAMETER BARS

### PART NUMBER:

#	Size	Grip
97 - _ 2	30	_



97-2630S01

## 97 - POWDER COATED - Friction Hinge Flip Up Rail w/ Stainless Steel Bracket

### OPTIONS:

Diameter: **(26)** 1 ¼", **(56)** 1 ½"

Size: **(30)** 30"

Grip: **(S)** Smooth, **(G)** ShurGrip

SHURGRIP ONLY AVAILABLE ON 1 1/4" DIAMETER BARS

Color: **(01)** White, **(02)** Almond

### PART NUMBER:

#	Size	Grip	Color
97 - _ 6	30	_	_ _



97-2242SLEG

## 97 - STAINLESS STEEL - 1 ¼" DIA Friction Hinge Flip Up Rail w/ Stainless Steel Bracket with Leg

### OPTIONS:

Size: **(42)** 42", **(54)** 54"

Grip: **(S)** Smooth, **(K)** Knurled, **(P)** Peened, **(G)** ShurGrip

### PART NUMBER:

#	Size	Grip	Leg
97 - 22	_ _	_	LEG

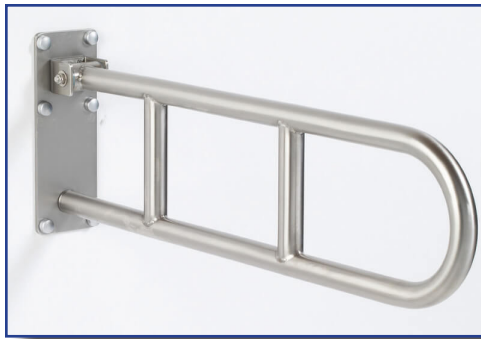

98-2230S

## 98 - STAINLESS STEEL - 1 1/4" DIA HEAVY DUTY Friction Hinge Flip Up Rail (600 lbs)

### OPTIONS:

**Size:** (30) 30"

**Grip:** (S) Smooth, (K) Knurled, (P) Peened

### PART NUMBER:

#	Size	Grip
98 - 22	30	_



99-2230SW05

## 99 - STAINLESS STEEL - Friction Hinge Flip Up Rail w/ Zinc Bracket

### OPTIONS:

**Diameter:** (22) 1 1/4", (52) 1 1/2"

**Size:** (30) 30"

**Grip:** (S) Smooth, (K) Knurled, (P) Peened, (G) ShurGrip

SHURGRIP ONLY AVAILABLE ON 1 1/4" DIAMETER BARS

### PART NUMBER:

#	Size	Grip	
99 - _2	30	_	W05



99-2603S01

## 99 - POWDER COATED - Friction Hinge Flip Up Rail w/ Zinc Bracket

### OPTIONS:

**Diameter:** (26) 1 1/4", (56) 1 1/2"

**Size:** (30) 30"

**Grip:** (S) Smooth, (K) Knurled, (P) Peened, (G) ShurGrip

SHURGRIP ONLY AVAILABLE ON 1 1/4" DIAMETER BARS

**Color:** (01) White, (02) Almond

### PART NUMBER:

#	Size	Grip	Color
99 - 26	30	_	--





## Toilet Tissue Holder

### OPTIONS:

- 1 ¼" DIA Stainless Steel for Locking & Friction Flip Up Rail  
**(96-99T)**
- 1 ¼" DIA Powder Coated for Locking & Friction Flip Up Rail  
**(96-99T01)** White, **(96-99T02)** Almond
- 1 ½" DIA Stainless Steel for Friction Flip Up Rail  
**(99-52T)**
- 1 ½" DIA Stainless Steel for Friction Flip Up Rail  
**(96-56T01)** White, **(96-56T02)** Almond



## Mounting Hardware

### OPTIONS:

- 4-Hex Lag Bolts for Flip Up Rail  
**(999-MH)**
- Mounting Hardware for Support Column  
**(999-CMH)**



## Hex Bolt Covers for 999-MH

### OPTIONS:

- Four Stainless Steel Colored Plastic Caps  
**(999-CAPSS)**
- Four White Colored Plastic Caps  
**(999-CAPWHT)**



## Solid Mount

- Solid Mount fastening system  
(**SOLID-MOUNT**)



## Toggle Bolt

- Fastening Toggle Bolt  
(**TOGGLE-BOLT**)



## Backing for Metal Studs

- 16 gauge backing for metal stud framing  
(**#FLUSH-MOUNT**)

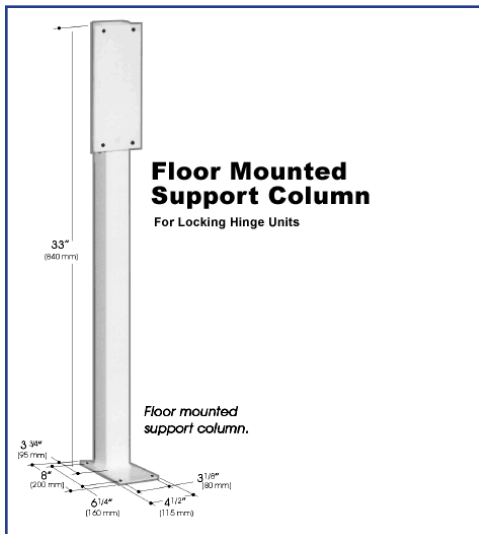

## Floor Mounted Support Column

### OPTIONS:

For Rail: **(96)** Locking Hinge, **(97)** Friction Hinge Stainless Steel bracket,  
**(99)** Friction Hinge Zinc bracket

Color: **(CSS)** SS, **(CSS01)** PC White, **(CSS02)** PC Almond

### PART NUMBER:

#	Color
__ -	__ -

### RESIDENTIAL:

- 1 Pair Residential WingIts  
(WINGIT-RES)

### COMMERCIAL:

- Commercial WingIt, 1 per flange  
(WINGIT-COM)
- WingIt Extended Length Screw  
(WINGIT-COM-E)
- Reverse WingIt  
(WINGIT-COM-R)

### ACCESSORIES

- 2L ½" Hex Shank Hole Saw Arbor  
(#EL-57088)
- 1 ¼" DIA Carbide Tipped Hole Saw  
(#EL-0204926)
- WingIt Drill Bit  
(#EL-APACHE)
- 1 Pair of WingIt Anchors  
(#EL-MAW35)

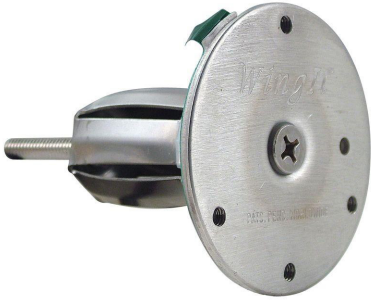



## Shower Curtains

### OPTIONS:

Weighted: **(W)** Weighted, **( )** Non-weighted

Size: **(4872)** 48" x 72", **(7272)** 72" x 72"

### PART NUMBER:

Weighted	#	Size
-	SHOWER-CURT	- - - -

### SHOWER CURTAIN FLANGES:

### OPTIONS:

Type: **(C)** Stainless Steel, **(L)** Chrome, **(EL-BREAK)** Breakaway flange

### PART NUMBER:

#	Type
CURTFLANGE	- -

### SHOWER CURTAIN HOOKS:

- 12 Pack Chrome Curtain Hooks  
**(CURTHOOKS)**



## Tub Safety Bar

- White tub safety bar  
**(2511E)**



## Collapsible Water Dam

Water Retention System for Barrier Free Showers. Control water spillage, help prevent falls, and reduce facility liability and maintenance.

- Sold by the foot  
(**WATER-DAM-\_\_**)



## Collapsible Water Dam Endcaps

- Pair of 90° End Caps  
(**ENDCAP90**)
- Pair of Radius End Caps  
(**ENDCAPRAD**)



ELCOMA  
Raising the bar since 1988



[www.elcoma.com](http://www.elcoma.com) | [facebook.com/ElcomaMetal](https://facebook.com/ElcomaMetal)

Manufacturing A.D.A. compliant products since 1988 | Residential & commercial washroom accessories

521 Lawrence Rd. NE, Canton, OH 44704 | [cservice@elcoma.com](mailto:cservice@elcoma.com) | Toll Free 1.800.352.6625 | Toll Free Fax 1.800.625.5560