

## CRL Cabinet Lock for Hinged Glass Door

- Easy Installation - No Need to Drill a Hole in Glass
- Fits Up to 1/4" (6 mm) Thick Glass

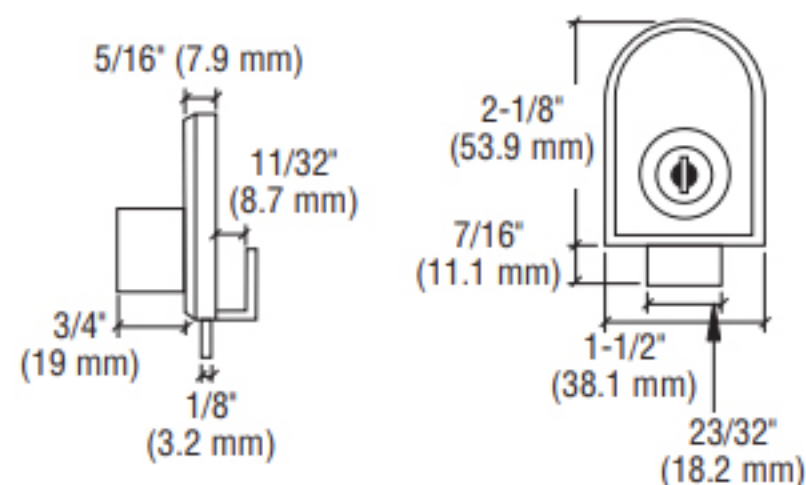

With three beautiful finishes to choose from, CRL's Cabinet Lock for Hinged Glass Doors will add style and security to any showcase or cabinet. Designed for single glass doors, lock installation is easy because no drilling of the glass is necessary. Locks come complete with two keys, strike plate, and mounting plate. Screws for strike plate are not included. Customers needing extra blank keys can order Cat. No. LKEY.

CAT. NO. RANDOM KEYS	CAT. NO. KEYED ALIKE	FINISH
LK10	LK10KA	Chrome
LK12	LK12KA	Black
LK14	LK14KA	Gold Plated

Minimum order: 1 each. All Showcase Locks can be combined for quantity pricing.

## CRL No-Drill Showcase Lock

- Quick and Easy to Install
- Use on Any Swinging Glass Door

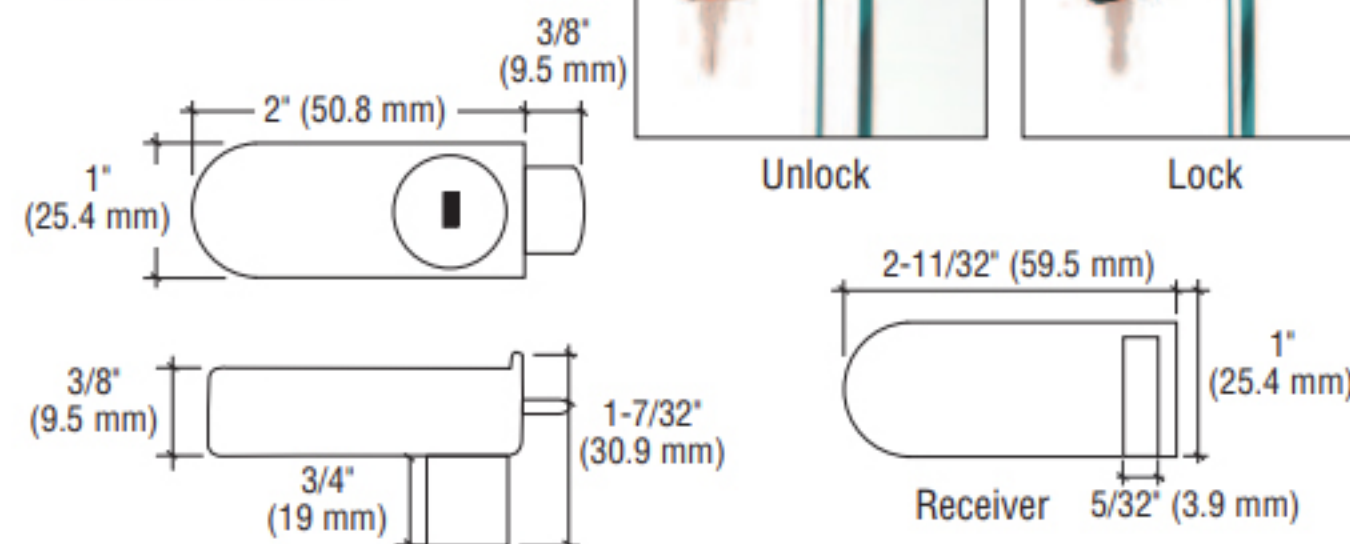

This CRL No-Drill Showcase Lock is designed for swinging glass doors, and is easily installed by peeling off the adhesive liner and placing the Lock and Receiver in the desired location on the glass. No drilling or notching of glass is required. The No-Drill Lock can be used on any thickness of glass door or showcase. Available in several different finishes to match popular showcase extrusions. Can be ordered keyed randomly or alike.

CAT. NO. RANDOM KEYS	CAT. NO. KEYED ALIKE	FINISH
255BN	255BNKA	Brushed Nickel
255BRZ	255BRZKA	Bronze
255CH	255CHKA	Chrome
255GP	255GPKA	Gold Plated

Minimum order: 1 each. All Showcase Locks can be combined for quantity pricing.