

VZ-HDC-2 ADVANTAGES

MODEL #	VZ-HDC-2
SPECIFICATION	
Imaging Sensor	Panasonic 1/3" 2.2 Megapixel Sensor
HD-SDI Scanning System	Progressive Scan
Number of active pixels	1944 (H) x 1092 (V) = 2,122,848 (pixel)
Number of effective pixels	2010 (H) x 1108 (V) = 2,227,080 (pixel)
S/N Ratio	More than 50dB (AGC OFF)
HD-SDI Video Output	HD-SDI: 1920 X 1080
Min. Illumination	0.5Lux (Color), 0.1Lux (BW), 0.02Lux (Sens-up x30)
Lens	Megapixel HD 3.7mm Fixed Focus Lens
Electronic Shutter Speed	Auto, FLK, 1/60 ~ 1/100,000sec
	AWB, AWC-SET, MANUAL, INDOOR, OUTDOOR, ATW
	WDR, BLC, HSBL, Off
	On, Off
	Adjustable 1 ~ 15
	SHARPNESS, MONITOR, LSC, NTSC/PAL
	Auto, B.W, ColorS4IL
	On, Off
INTERFACE	
HD-SDI – BNC	1
WEIGHT & DIMENSIONS	
Dimensions	Ø 4.40 x 3.42(H)inch (Ø 112 x 87(H) mm)
Net Weight	0.33 lbs / Appx. 150g
GENERAL	
Language	English
Construction	Plastic dome & Plastic body
Power	- Supplied Voltage
	DC12V ± 10%
	- Power Consumption
	Max. 120mA
Regulation	CE, FCC, RoHS, KCE
Humidity	0% to 90%
Operating Temperature	14 ~ 122°F / -10°C ~ 50°C
Storage Temperature	-4 ~ 140°F / -20°C ~ 60°C

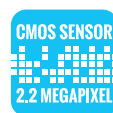

DIMENSIONS

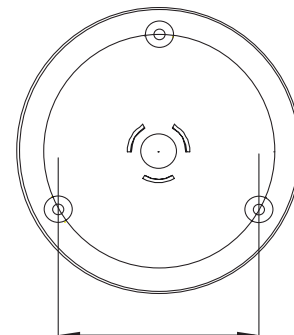
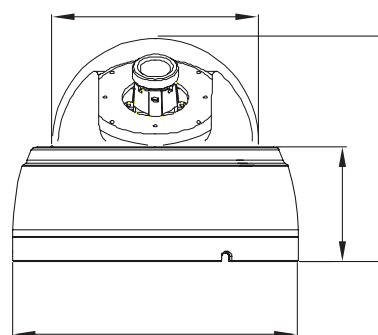

Contact ViewZ

INSTALLATION

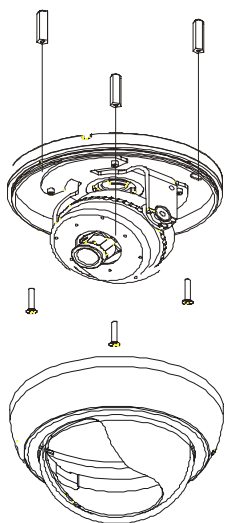

CAMERA ANGLE ADJUSTMENT

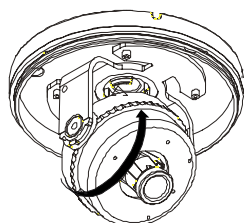
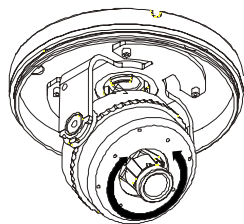
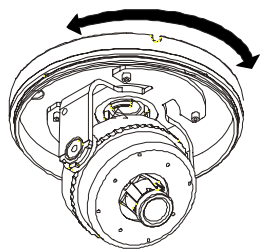

PRECAUTIONS



REGULATORY NOTICE

[Contact ViewZ](#)
